



April 23, 2018

Director Julie Murphy
Colorado Oil and Gas Conservation Commission
1120 Lincoln Street, Suite 801
Denver, Colorado 80203

RE: COGCC Rule 318A.e.: Proposed Wellbore Spacing Unit
EAST AULT M-18-19HN, EAST AULT NA-18-19HN & EAST AULT N-18-19HC, T7N-R65W: E/2W/2 & W/2E/2
SEC 18 & E/2W/2 & W/2E/2 SEC 19, Weld County, Colorado.

Dear Director Murphy:

Bayswater Exploration & Production LLC, (Bayswater) is planning to drill the above referenced wells in accordance with the provisions set forth in COGCC Rule 318A.e. This proposed wellbore spacing unit consists of 640 acres, more or less.

Bayswater is not the only owner within the proposed wellbore spacing unit and on March 19, 2018 sent PSU Notifications & Waivers to the other Operators involved regarding this spacing unit, as required by COGCC Rule 318A.e.(6). As of this date we have not received any objections to this proposed PSU.

Attached is the Proposed Spacing Unit Plat to assist in your review and approval of Bayswater's in process Form 2 for the subject well. Bayswater respectfully requests the COGCC review the enclosed information and approve the proposed PSU.

Respectfully,

Paul Gottlob
Regulatory & Engineering Technician
Integrated Petroleum Technologies, Inc
Consultant to Bayswater Exploration & Production LLC

Attachment: Proposed Spacing Unit Plat

EAST AULT 18-C PAD

PROPOSED 318A.a.(4)D. SPACING UNIT

SEC 18 & 19: E2W2, W2E2

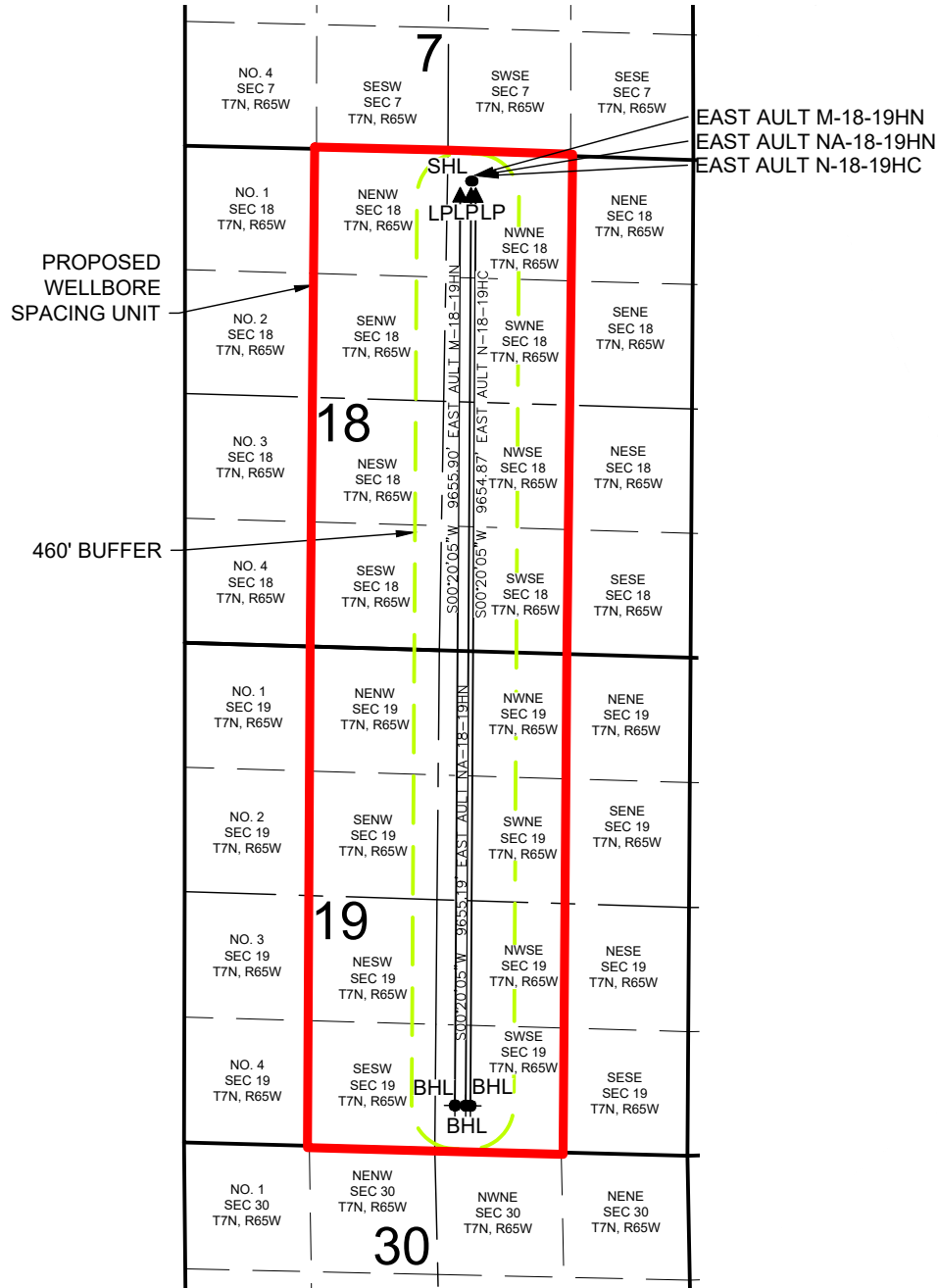

EAST AULT M-18-19HN WELL TO BE LOCATED 301' FNL AND 2367' FEL, SEC 18, T7N, R65W
EAST AULT NA-18-19HN WELL TO BE LOCATED 301' FNL AND 2352' FEL, SEC 18, T7N, R65W
EAST AULT N-18-19HC WELL TO BE LOCATED 301' FNL AND 2337' FEL, SEC 18, T7N, R65W

LEGEND

- = PROPOSED WELL
- = BOTTOM HOLE
- ▲ = LANDING POINT

SHL = SURFACE HOLE LOCATION
 BHL = BOTTOM HOLE LOCATION
 LP = LANDING POINT

DISCLAIMER:
 THIS PLOT DOES NOT REPRESENT A MONUMENTED LAND SURVEY AND SHOULD NOT BE
 RELIED UPON TO DETERMINE BOUNDARY LINES, PROPERTY OWNERSHIP OR OTHER
 PROPERTY INTERESTS. PARCEL LINES, IF DEPICTED HAVE NOT BEEN FIELD VERIFIED AND
 MAY BE BASED UPON PUBLICLY AVAILABLE DATA THAT ALSO HAS NOT BEEN
 INDEPENDENTLY VERIFIED.

