



# FRANE SURVEYING INC.

Physical Address: 34834 Annie Cir.  
Mail to: Box 2372, Elizabeth, CO 80107  
Ph. 303-243-0037  
www.franesurveying.com  
Job # 078-16 The Searchers 1-25

Frane Surveying, in accordance with a request from **Grand Mesa Operating** has determined the location of the Center of the **The Searchers 1-25 Tank Battery** to be **2523 Feet FNL**, and **95 Feet FEL**, (90° off Section lines) of Section **25**, Township **5s**, Range **54w** of the 6th Principal Meridian, **Washington County**, Colorado.

Date: Staked on 09/29/16 drawn on 09/30/16.  
Rev: 05/25/18 - Added Tanks

Re: Staked by Elijah Frane  
Drawn: Drawn by Elijah Frane

## Facility Exhibit

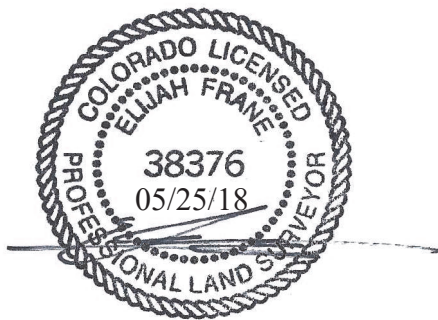

SEARCHERS 1-25  
PRODUCTION FACILITY  
(0.43 ACRES ± GROSS)

- (3) 300BBL  
OIL Tanks
- (3) 400BBL  
OIL TANKS
- (2) 400 BBL  
H2O TANKS

S0°00'00"E  
199.70'  
(1) 4'Ø Treater  
W/ 12'x12' House

48" ECD

60" ECD'S

(1) 6'Ø Treater W/  
12'x12' House

SOUTH LINE, NE1/4

S86°32'37"E  
97.00'

E1/4 COR

C.R. U

N1°12'57"W  
200.00'

