

Great Western Operating Company, LLC

Location Colorado
Field Wattenburg
Installation Tower

Slot Slot S12 - Tower LD 19-259HC
Well Tower LD 19-259HC
Wellbore Tower LD 19-259HC (PWB)

Created by admin
Date plotted 15-May-2017

Plot reference is Tower LD 19-259HC (PWB).
Ref wellpath is Tower LD 19-259HC (PWP#1).
Coordinates are in Feet reference Slot S12 - Tower LD 19-259HC.
True Vertical Depths are reference Rig Datum.
Measured Depths are reference Rig Datum.
Rig Datum: Planned Datum #1
Rig Datum to Mean Sea Level: 5259.60 ft.
Plot North is aligned to TRUE North.

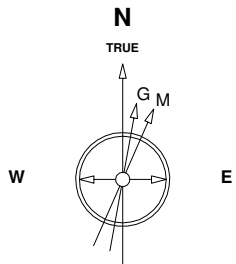

Scale 1 cm = 400 ft

East (Feet) ->

-13600 -12800 -12000 -11200 -10400 -9600 -8800 -8000 -7200 -6400 -5600 -4800 -4000 -3200 -2400 -1600 -800 0 800 1600

10-May-2017
IGRF Model [1900.0-2020.0] Dip: 66.48 deg Field: 52154.2 nT
Lat: N39 57 11.0916 Long: W104 54 7.2792 Elev: 5239.60 ft
Magnetic North is 8.26 deg East of TRUE North
To correct azimuth from Magnetic to TRUE add 8.26 deg

Scale 1 cm = 400 ft

<- True Vertical Depth (Feet)

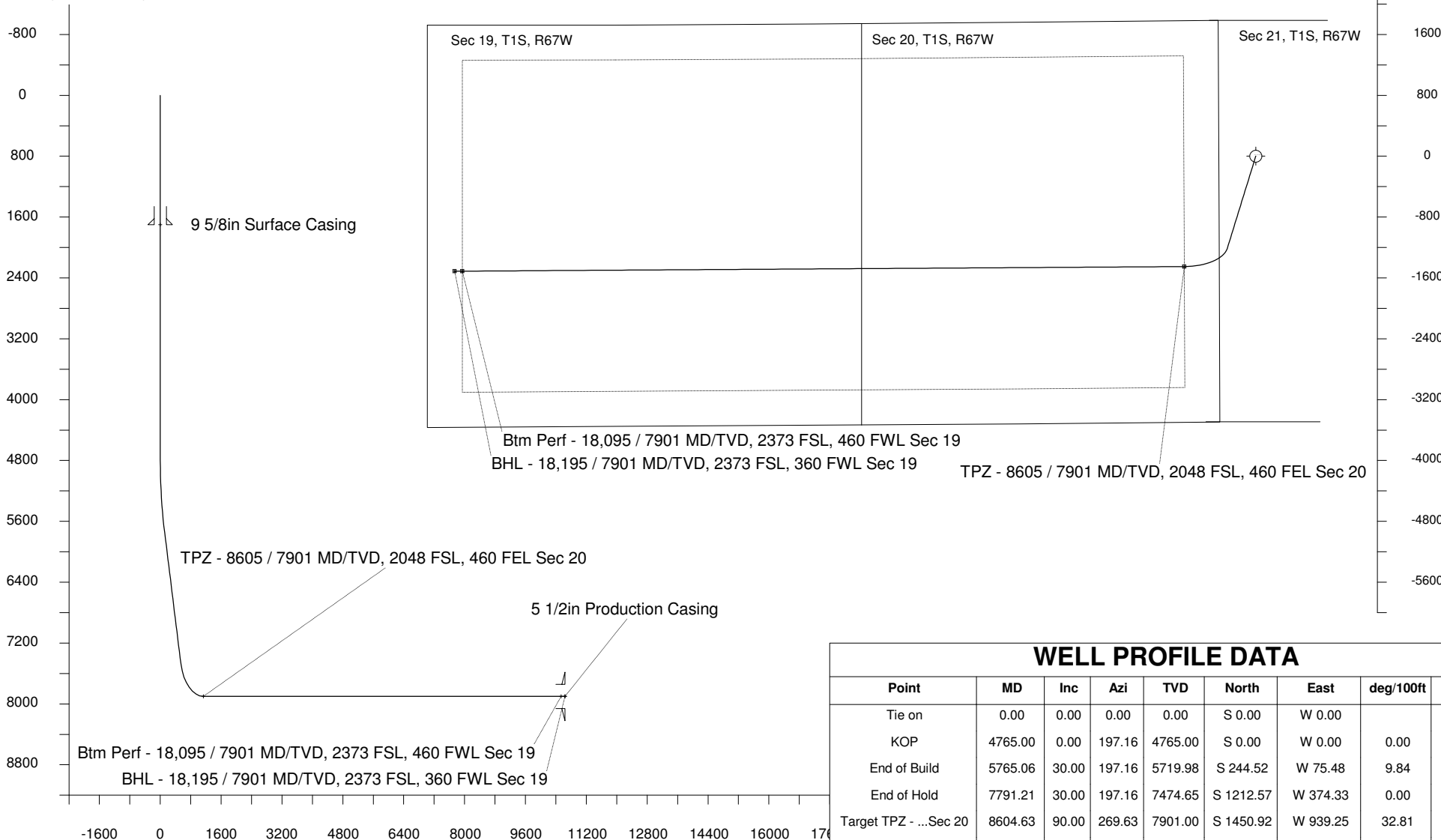

Scale 1 cm = 800 ft

Vertical Section (Feet) ->

Azimuth 261.83 with reference 0.00 N, 0.00 E from Slot S12 - Tower LD 19-259HC

WELL PROFILE DATA

| Point | MD | Inc | Azi | TVD | North | East | deg/100ft | V. Sect |
|-------------------------|----------|-------|--------|---------|-----------|------------|-----------|----------|
| Tie on | 0.00 | 0.00 | 0.00 | 0.00 | S 0.00 | W 0.00 | | -0.00 |
| KOP | 4765.00 | 0.00 | 197.16 | 4765.00 | S 0.00 | W 0.00 | 0.00 | -0.00 |
| End of Build | 5765.06 | 30.00 | 197.16 | 5719.98 | S 244.52 | W 75.48 | 9.84 | 109.46 |
| End of Hold | 7791.21 | 30.00 | 197.16 | 7474.65 | S 1212.57 | W 374.33 | 0.00 | 542.82 |
| Target TPZ - ...Sec 20 | 8604.63 | 90.00 | 269.63 | 7901.00 | S 1450.92 | W 939.25 | 32.81 | 1135.88 |
| Target Btm Pe...Sec 19 | 18094.92 | 90.00 | 269.63 | 7901.00 | S 1511.41 | W 10429.35 | 0.00 | 10538.29 |
| End of Turn | 18097.78 | 90.00 | 270.01 | 7901.00 | S 1511.42 | W 10432.21 | 42.65 | 10541.12 |
| T.D. & Target BHL... 19 | 18194.92 | 90.00 | 270.01 | 7901.00 | S 1511.41 | W 10529.35 | 0.00 | 10637.27 |