

Great Western Operating Company, LLC

Location Colorado
Field Wattenburg
Installation Tower

Slot Slot S07 - Tower LD 19-302HN
Well Tower LD 19-302HN
Wellbore Tower LD 19-302HN (PWB)

Created by admin
Date plotted 15-May-2017

Plot reference is Tower LD 19-302HN (PWB).
Ref wellpath is Tower LD 19-302HN (PWP#1).
Coordinates are in Feet reference Slot S07 - Tower LD 19-302HN.
True Vertical Depths are reference Rig Datum.
Measured Depths are reference Rig Datum.
Rig Datum: Planned Datum #1
Rig Datum to Mean Sea Level: 5259.60 ft.
Plot North is aligned to TRUE North.

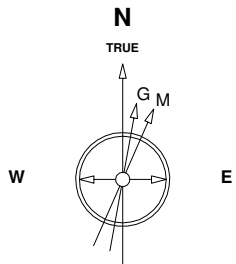

Scale 1 cm = 400 ft

East (Feet) ->

-13600 -12800 -12000 -11200 -10400 -9600 -8800 -8000 -7200 -6400 -5600 -4800 -4000 -3200 -2400 -1600 -800 0 800 1600

10-May-2017
IGRF Model [1900.0-2020.0] Dip: 66.48 deg Field: 52154.2 nT
Lat: N39 57 11.0916 Long: W104 54 7.2792 Elev: 5239.60 ft
Magnetic North is 8.26 deg East of TRUE North
To correct azimuth from Magnetic to TRUE add 8.26 deg

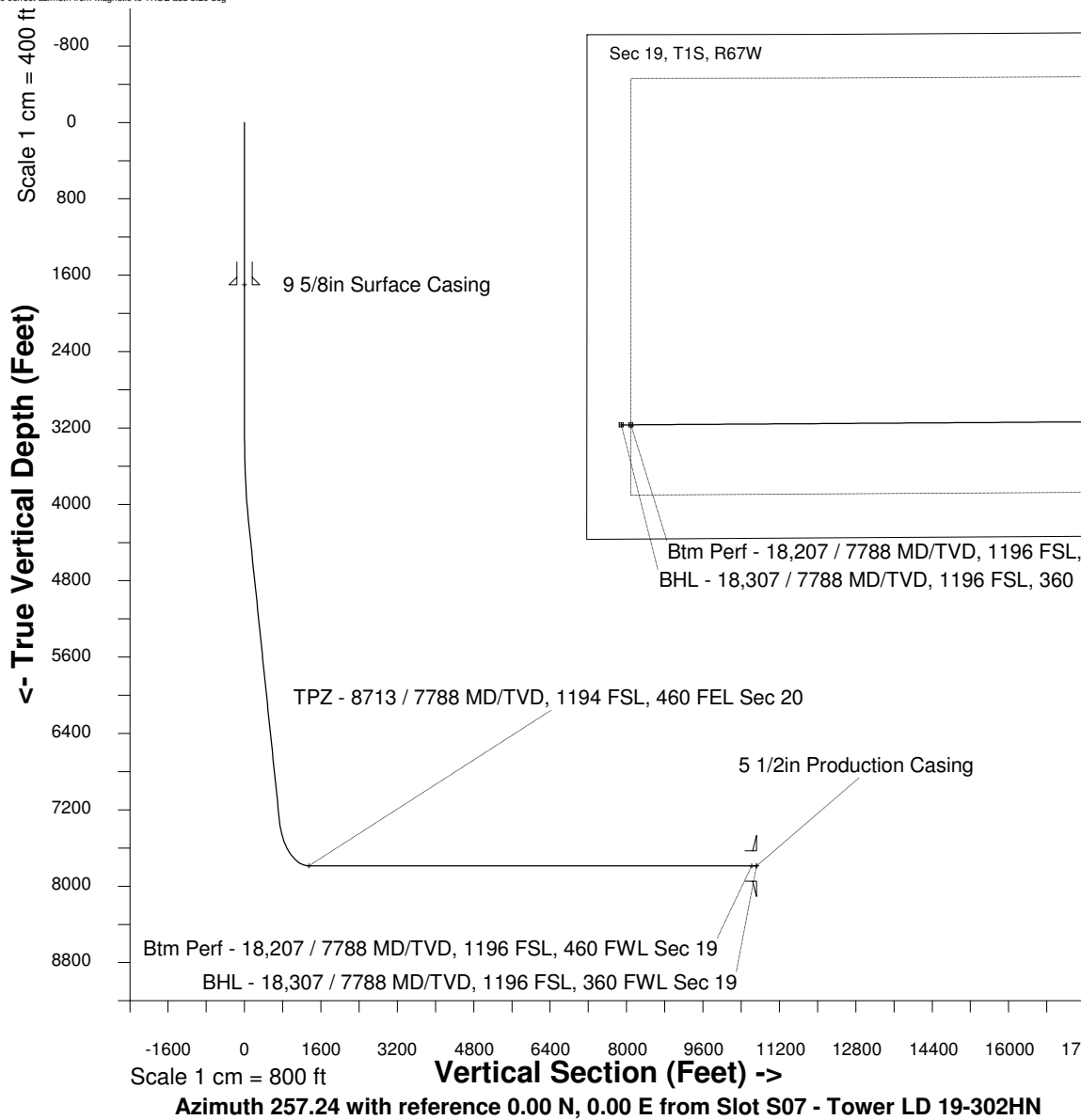

<- North(Feet)

Scale 1 cm = 400 ft

WELL PROFILE DATA

Point	MD	Inc	Azi	TVD	North	East	deg/100ft	V. Sect
Tie on	0.00	0.00	0.00	0.00	S 0.00	W 0.00		-0.00
KOP	3250.00	0.00	188.15	3250.00	S 0.00	W 0.00	0.00	-0.00
End of Build	4250.08	30.00	188.15	4205.00	S 253.33	W 36.26	9.84	91.31
End of Hold	7855.51	30.00	188.15	7327.32	S 2037.98	W 291.70	0.00	734.61
Target TPZ - ...Sec 20	8713.01	90.00	269.62	7788.00	S 2304.81	W 861.34	32.81	1349.10
Target Btm Pe...Sec 19	18206.73	90.00	269.62	7788.00	S 2367.51	W 10354.85	0.00	10622.03
End of Turn	18209.69	90.00	270.01	7788.00	S 2367.52	W 10357.81	42.65	10624.92
T.D. & Target BHL... 19	18306.73	90.00	270.01	7788.00	S 2367.51	W 10454.85	0.00	10719.56