

# Great Western Operating Company, LLC

**Location** Colorado  
**Field** Wattenburg  
**Installation** Tower

**Slot** Slot S06 - Tower LD 19-339HN  
**Well** Tower LD 19-339HN  
**Wellbore** Tower LD 19-339HN (PWB)

Created by admin  
Date plotted 15-May-2017

Plot reference is Tower LD 19-339HN (PWB).  
Ref wellpath is Tower LD 19-339HN (PWP#1).  
Coordinates are in Feet reference Slot S06 - Tower LD 19-339HN.  
True Vertical Depths are reference Rig Datum.  
Measured Depths are reference Rig Datum.  
Rig Datum: Planned Datum #1  
Rig Datum to Mean Sea Level: 5259.60 ft.  
Plot North is aligned to TRUE North.

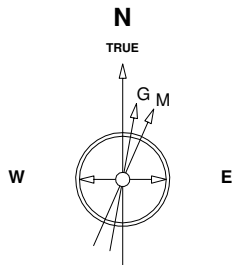

Scale 1 cm = 400 ft

East (Feet) ->

-13600 -12800 -12000 -11200 -10400 -9600 -8800 -8000 -7200 -6400 -5600 -4800 -4000 -3200 -2400 -1600 -800 0 800 1600

10-May-2017  
IGRF Model [1900.0-2020.0] Dip: 66.48 deg Field: 52154.2 nT  
Lat: N39 57 11.0916 Long: W104 54 7.2792 Elev: 5239.60 ft  
Magnetic North is 8.26 deg East of TRUE North  
To correct azimuth from Magnetic to TRUE add 8.26 deg

Scale 1 cm = 400 ft

<- True Vertical Depth (Feet)

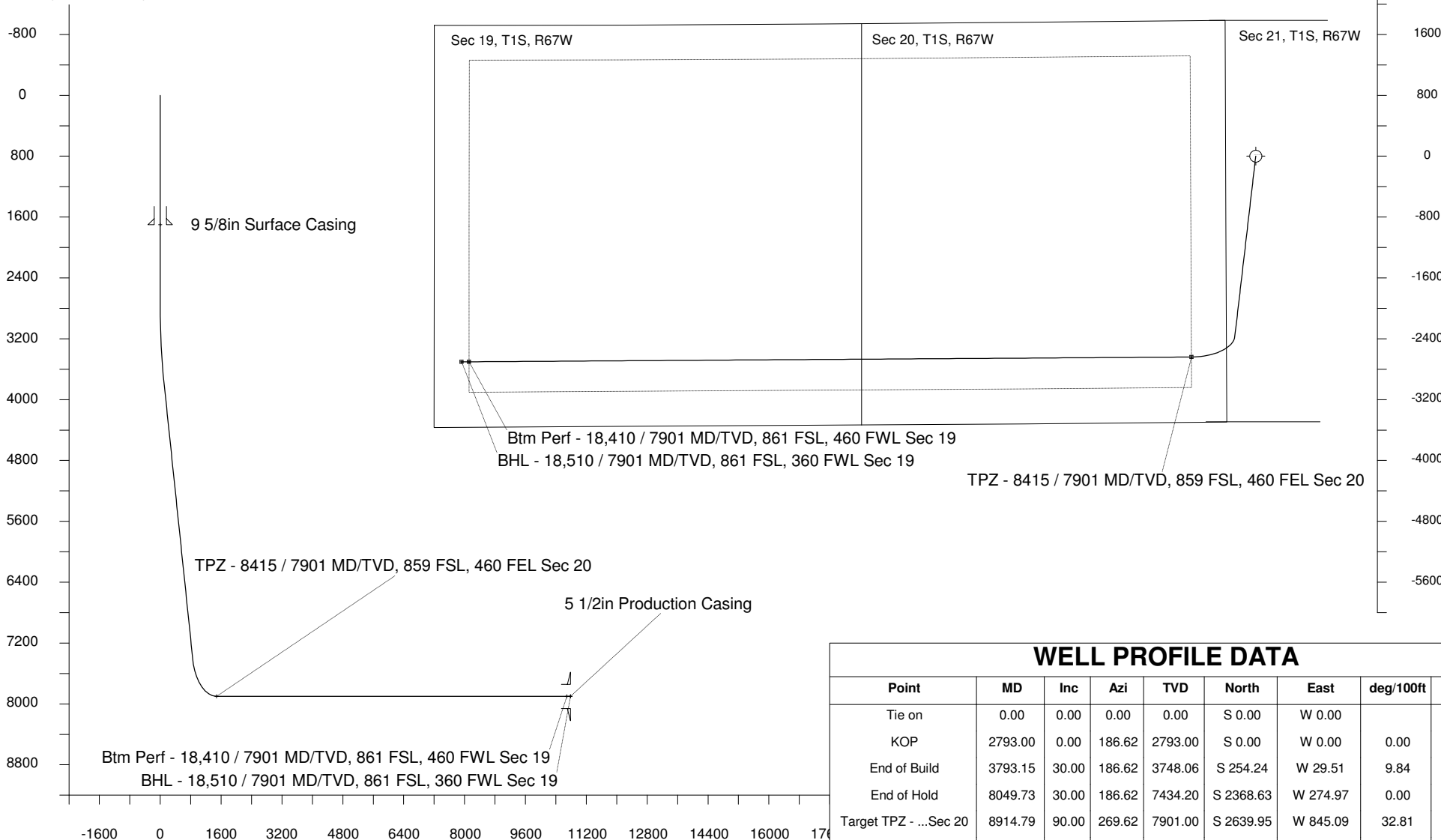

<- North(Feet)

Scale 1 cm = 400 ft

## WELL PROFILE DATA

Point	MD	Inc	Azi	TVD	North	East	deg/100ft	V. Sect
Tie on	0.00	0.00	0.00	0.00	S 0.00	W 0.00		-0.00
KOP	2793.00	0.00	186.62	2793.00	S 0.00	W 0.00	0.00	-0.00
End of Build	3793.15	30.00	186.62	3748.06	S 254.24	W 29.51	9.84	92.29
End of Hold	8049.73	30.00	186.62	7434.20	S 2368.63	W 274.97	0.00	859.80
Target TPZ - ...Sec 20	8914.79	90.00	269.62	7901.00	S 2639.95	W 845.09	32.81	1479.72
Target Btm Pe...Sec 19	18410.04	90.00	269.62	7901.00	S 2702.66	W 10340.13	0.00	10687.47
End of Turn	18412.98	90.00	270.00	7901.00	S 2702.67	W 10343.07	42.65	10690.32
T.D. & Target BHL... 19	18510.05	90.00	270.00	7901.00	S 2702.66	W 10440.13	0.00	10784.28

Scale 1 cm = 800 ft

Vertical Section (Feet) ->

Azimuth 255.49 with reference 0.00 N, 0.00 E from Slot S06 - Tower LD 19-339HN