

Great Western Operating Company, LLC

Location Colorado
Field Wattenburg
Installation Tower

Slot Slot S03 - Tower LD 19-379HN
Well Tower LD 19-379HN
Wellbore Tower LD 19-379HN (PWB)

Created by admin
Date plotted 15-May-2017

Plot reference is Tower LD 19-379HN (PWB).
Ref wellpath is Tower LD 19-379HN (PWP#1).
Coordinates are in Feet reference Slot S03 - Tower LD 19-379HN.
True Vertical Depths are reference Rig Datum.
Measured Depths are reference Rig Datum.
Rig Datum: Planned Datum #1
Rig Datum to Mean Sea Level: 5259.60 ft.
Plot North is aligned to TRUE North.

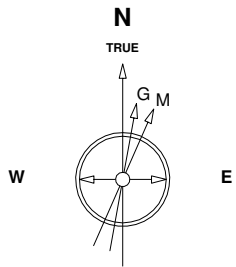

Scale 1 cm = 400 ft

East (Feet) ->

-13600 -12800 -12000 -11200 -10400 -9600 -8800 -8000 -7200 -6400 -5600 -4800 -4000 -3200 -2400 -1600 -800 0 800 1600

10-May-2017
IGRF Model [1900.0-2020.0] Dip: 66.48 deg Field: 52154.2 nT
Lat: N39 57 11.0916 Long: W104 54 7.2792 Elev: 5239.60 ft
Magnetic North is 8.26 deg East of TRUE North
To correct azimuth from Magnetic to TRUE add 8.26 deg

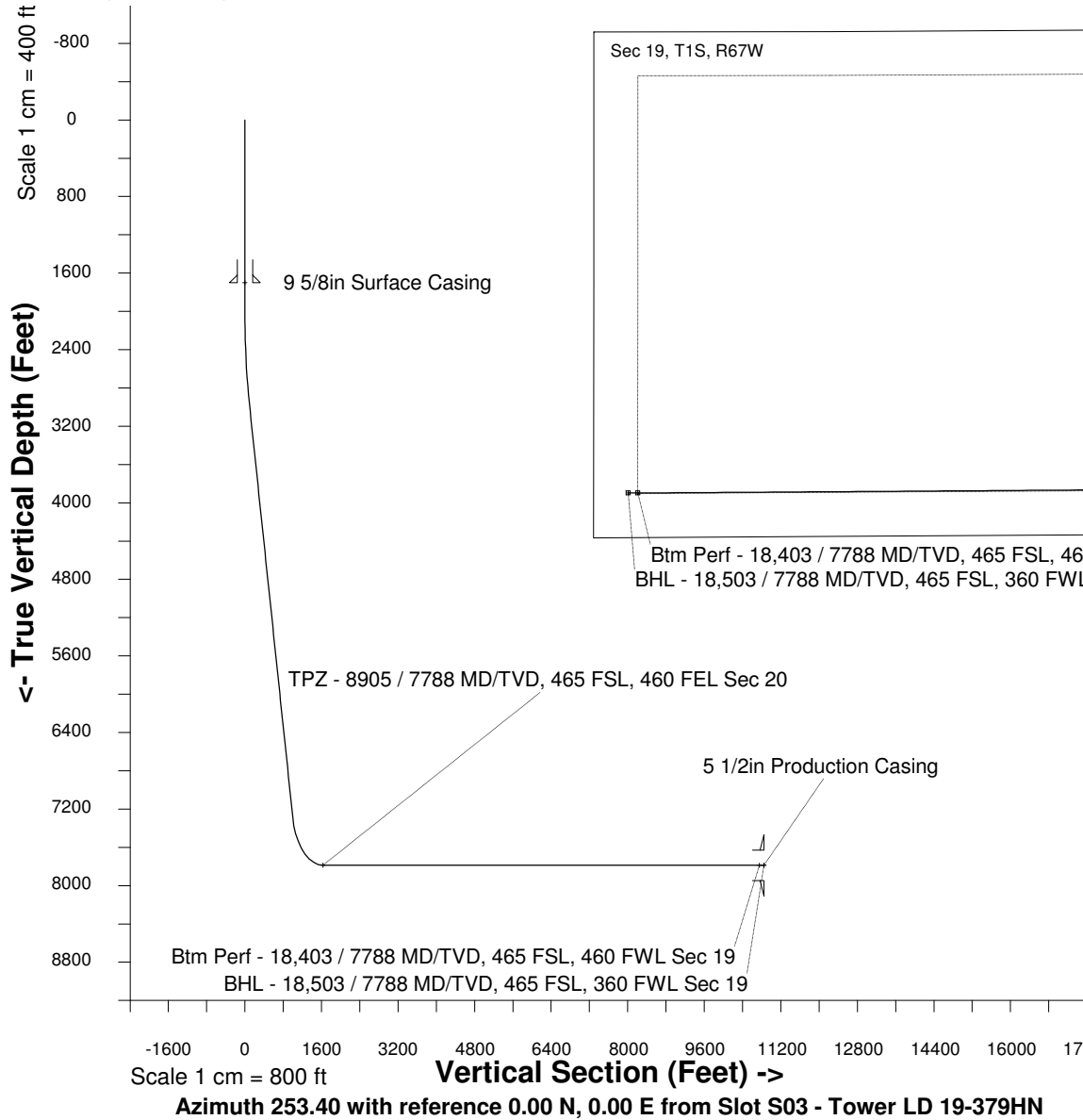

WELL PROFILE DATA								
Point	MD	Inc	Azi	TVD	North	East	deg/100ft	V. Sect
Tie on	0.00	0.00	0.00	0.00	S 0.00	W 0.00		-0.00
KOP	2010.00	0.00	184.72	2010.00	S 0.00	W 0.00	0.00	-0.00
End of Build	3009.85	30.00	184.72	2964.80	S 254.93	W 21.06	9.84	93.00
End of Hold	8030.98	30.00	184.72	7313.43	S 2756.62	W 227.76	0.00	1005.66
Target TPZ - ...Sec 20	8905.43	90.00	269.61	7788.00	S 3033.38	W 798.27	32.81	1631.45
Target Btm Pe...Sec 19	18402.53	90.00	269.61	7788.00	S 3098.29	W 10295.15	0.00	10751.22
End of Turn	18405.58	90.00	270.00	7788.00	S 3098.30	W 10298.20	42.65	10754.14
T.D. & Target BHL... 19	18502.53	90.00	270.00	7788.00	S 3098.29	W 10395.15	0.00	10847.05