

LINE TABLE		
LINE	DIRECTION	LENGTH
L1	S01E	304'
L2	S01E	364'
L3	S01E	368'
L4	S01E	392'
L5	S01E	400'
L6	S01E	431'
L7	S01E	229'
L8	S01E	290'
L9	S01E	293'
L10	S01E	318'
L11	S01E	325'
L12	S01E	355'

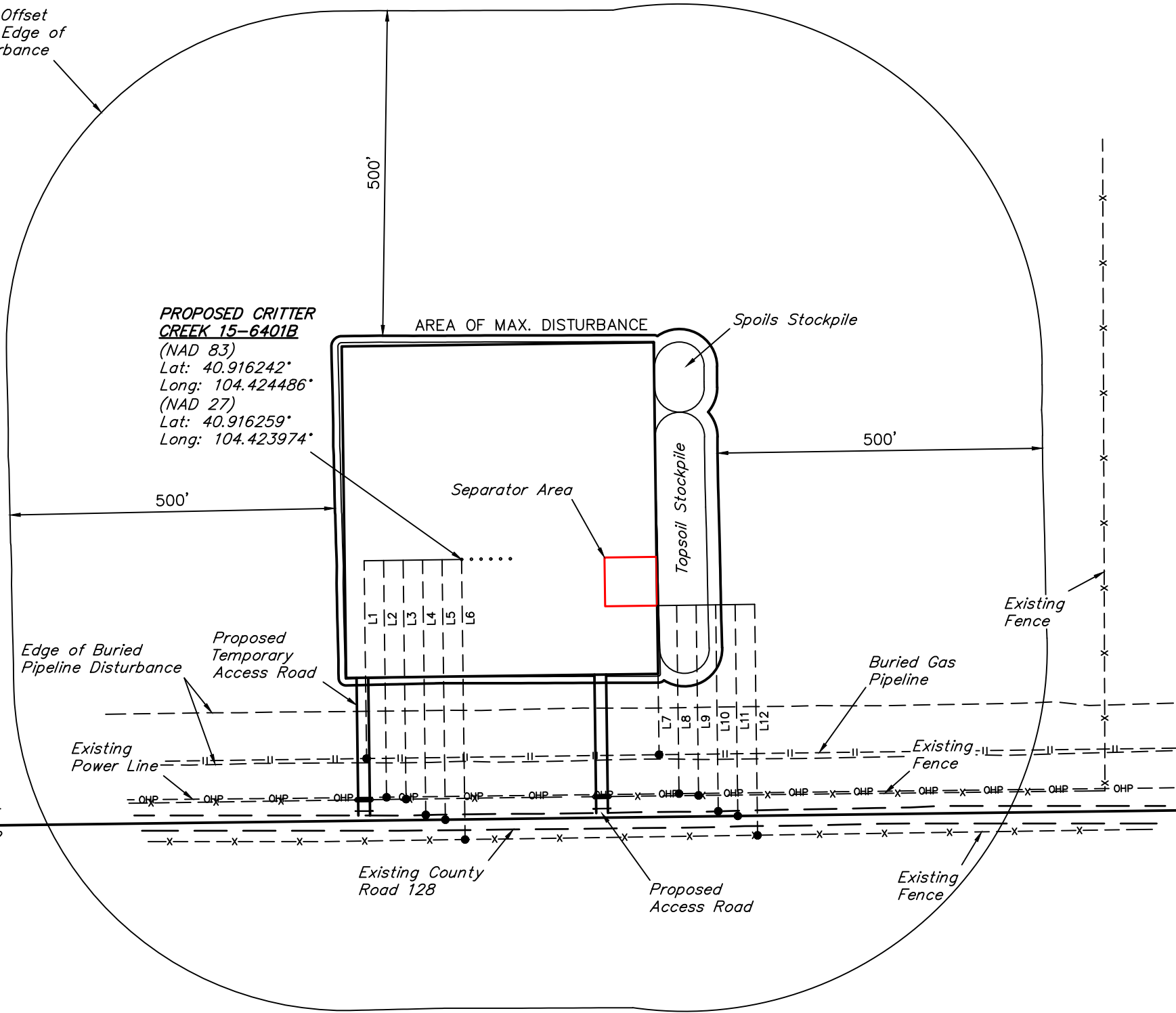

500' Offset from Edge of Disturbance



REV: 3 03-27-18 C.C. (COMPANY NAME, PAD, WELL NAME, SHL, LP & BHL CHANGE)

PLANT COMMUNITY	
<input checked="" type="checkbox"/>	DISTURBED GRASSLAND
<input type="checkbox"/>	NATIVE GRASSLAND
<input type="checkbox"/>	SHRUB LAND
<input type="checkbox"/>	PLAINS RIPARIAN
<input type="checkbox"/>	MOUNTAIN RIPARIAN
<input type="checkbox"/>	FOREST LAND
<input type="checkbox"/>	WETLANDS AQUATIC
<input type="checkbox"/>	ALPINE
<input type="checkbox"/>	OTHER (Describe): _____

CURRENT LAND USE					
CROP LAND:	<input type="checkbox"/> IRRIGATED	<input checked="" type="checkbox"/> DRY LAND	<input type="checkbox"/> IMPROVED PASTURE	<input type="checkbox"/> HAY MEADOW	<input type="checkbox"/> CRP
NON-CROP LAND:	<input type="checkbox"/> RANGELAND	<input type="checkbox"/> TIMBER	<input type="checkbox"/> RECREATIONAL	<input type="checkbox"/> OTHER (Describe) _____	
SUBDIVIDED:	<input type="checkbox"/> INDUSTRIAL	<input type="checkbox"/> COMMERCIAL	<input type="checkbox"/> RESIDENTIAL	_____	

FUTURE LAND USE					
CROP LAND:	<input type="checkbox"/> IRRIGATED	<input checked="" type="checkbox"/> DRY LAND	<input type="checkbox"/> IMPROVED PASTURE	<input type="checkbox"/> HAY MEADOW	<input type="checkbox"/> CRP
NON-CROP LAND:	<input type="checkbox"/> RANGELAND	<input type="checkbox"/> TIMBER	<input type="checkbox"/> RECREATIONAL	<input type="checkbox"/> OTHER (Describe) _____	
SUBDIVIDED:	<input type="checkbox"/> INDUSTRIAL	<input type="checkbox"/> COMMERCIAL	<input type="checkbox"/> RESIDENTIAL	_____	

NOTES:

BILL BARRETT CORPORATION

CRITTER CREEK 15 SW PAD
 SW 1/4 SW 1/4, SECTION 15, T11N, R63W, 6th P.M.
 WELD COUNTY, COLORADO

SURVEYED BY	CHAD MEIERS, M.M.	03-27-18	SCALE
DRAWN BY	M.O.E.	04-03-15	1" = 200'

LOCATION DRAWING **FIGURE #4**



UELS, LLC
 Corporate Office * 85 South 200 East
 Vernal, UT 84078 * (435) 789-1017