

# SRC ENERGY

Location: COLORADO Slot: SLOT#12 FALKEN 34N-9C-L (1739°FSL & 276°FEL, SEC.11)  
Field: WELD COUNTY (NAD83, TRUE NORTH) Well: FALKEN 34N-9C-L  
Facility: SEC.11-T06N-R66W Wellbore: FALKEN 34N-9C-L PWB

Plot reference wellpath is FALKEN 34N-9C-L PWB (REV-B.0)	Grid System: NAD83 / Lambert Colorado SP, Northern Zone (501), US feet
True vertical depths are referenced to PRECISION DRILLING 562 (25') (RKB)	* = Wellpath was transformed from a different geodetic datum
Measured depths are referenced to PRECISION DRILLING 562 (25') (RKB)	North Reference: True north
PRECISION DRILLING 562 (25') (RKB) to Mean Sea Level: 4835 feet	Scale: True distance
Mean Sea Level to Mud line (At Slot: SLOT#12 FALKEN 34N-9C-L (1739°FSL & 276°FEL, SEC.11)): 0 feet	Depths are in feet
Coordinates are in feet referenced to Slot	Created by: doddanna on 2018-02-07
	Database: WellArchitectDB

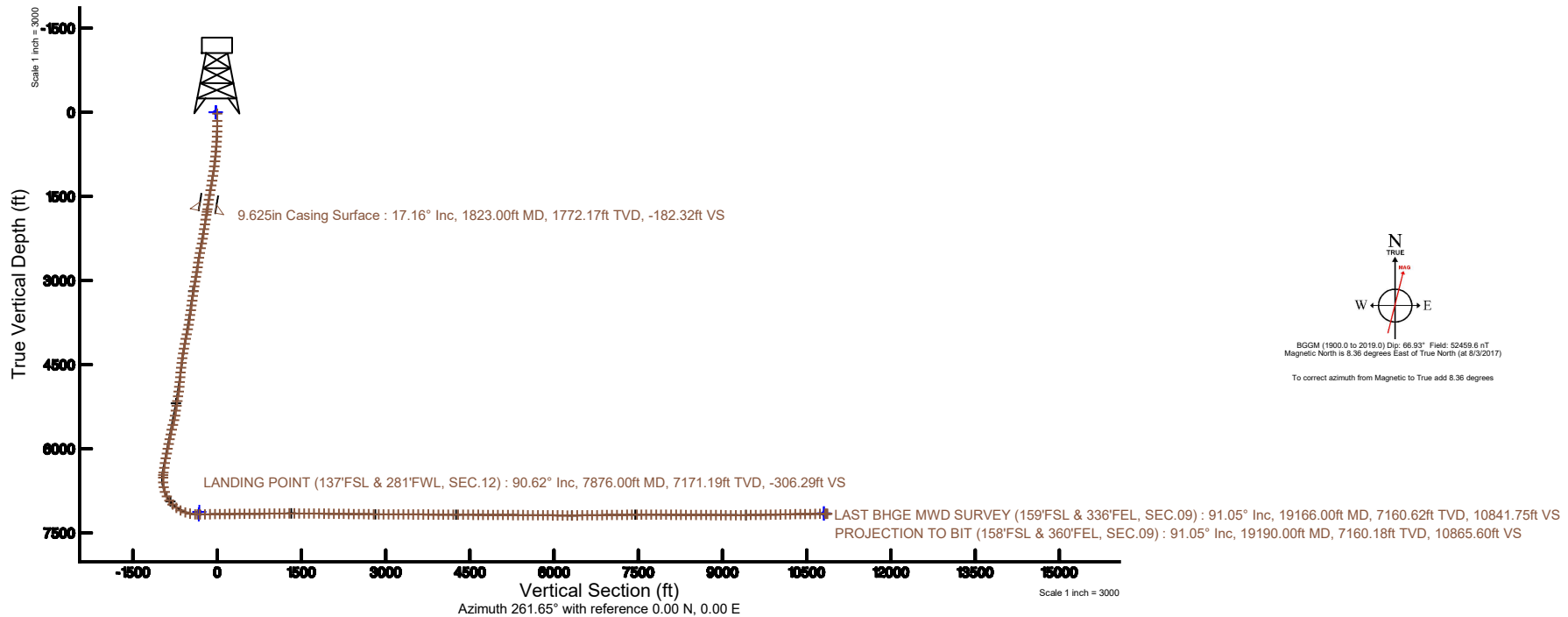

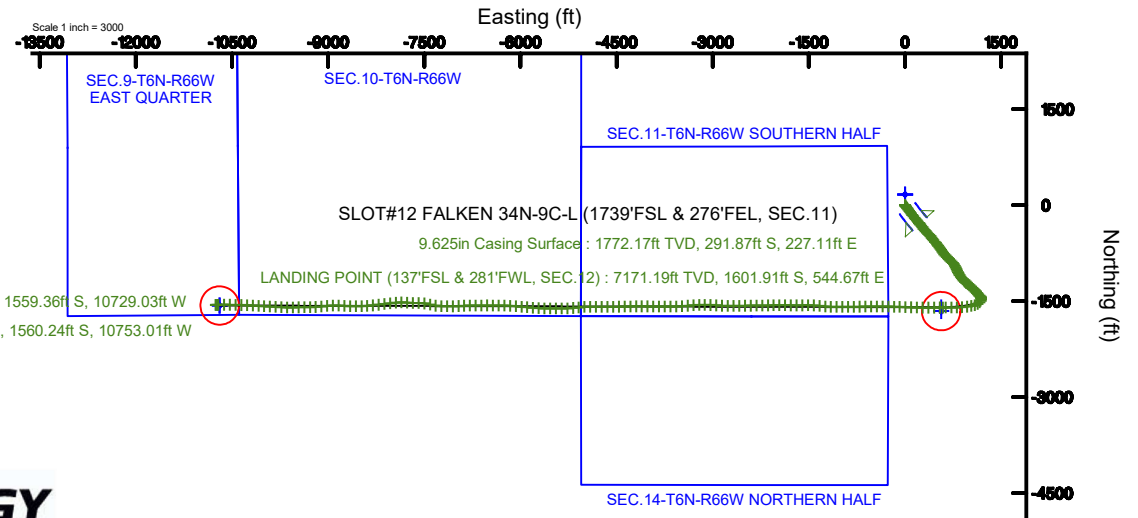

# Actual Wellpath Report

FALKEN 34N-9C-L AWP

Page 1 of 11



## REFERENCE WELLPATH IDENTIFICATION

Operator	SRC ENERGY	Slot	SLOT#12 FALKEN 34N-9C-L (1739'FSL & 276'FEL, SEC.11)
Area	COLORADO	Well	FALKEN 34N-9C-L
Field	WELD COUNTY (NAD83,TRUE NORTH)	Wellbore	FALKEN 34N-9C-L AWB
Facility	SEC.11-T06N-R66W		

## REPORT SETUP INFORMATION

Projection System	NAD83 / Lambert Colorado SP, Northern Zone (501), US feet	Software System	WellArchitect® 5.0
North Reference	True	User	Doddanna
Scale	0.999966	Report Generated	2/7/2018 at 5:17:51 PM
Convergence at slot	0.49° East	Database/Source file	WellArchitectDB/FALKEN_34N-9C-L_AWP.xml

## WELLPATH LOCATION

	Local coordinates		Grid coordinates		Geographic coordinates	
	North[ft]	East[ft]	Easting[US ft]	Northing[US ft]	Latitude	Longitude
Slot Location	-165.04	-1.39	3212478.24	1426031.21	40°30'01.238"N	104°44'09.420"W
Facility Reference Pt			3212478.20	1426196.25	40°30'02.869"N	104°44'09.402"W
Field Reference Pt			3171284.48	1426358.81	40°30'07.643"N	104°53'02.634"W

## WELLPATH DATUM

Calculation method	Minimum curvature	PRECISION DRILLING 562 (25') (RKB) to Facility Vertical Datum	4835.00ft
Horizontal Reference Pt	Slot	PRECISION DRILLING 562 (25') (RKB) to Mean Sea Level	4835.00ft
Vertical Reference Pt	PRECISION DRILLING 562 (25') (RKB)	PRECISION DRILLING 562 (25') (RKB) to Mud Line at Slot (SLOT#12 FALKEN 34N-9C-L (1739'FSL & 276'FEL, SEC.11))	4835.00ft
MD Reference Pt	PRECISION DRILLING 562 (25') (RKB)	Section Origin	N 0.00, E 0.00 ft
Field Vertical Reference	Mean Sea Level	Section Azimuth	261.65°



SRC ENERGY

# Actual Wellpath Report

FALKEN 34N-9C-L AWP

Page 2 of 11

**BAKER  
HUGHES****REFERENCE WELLPATH IDENTIFICATION**

Operator	SRC ENERGY	Slot	SLOT#12 FALKEN 34N-9C-L (1739'FSL & 276'FEL, SEC.11)
Area	COLORADO	Well	FALKEN 34N-9C-L
Field	WELD COUNTY (NAD83,TRUE NORTH)	Wellbore	FALKEN 34N-9C-L AWB
Facility	SEC.11-T06N-R66W		

**WELLPATH DATA (219 stations) † = interpolated/extrapolated station**

MD [ft]	Inclination [°]	Azimuth [°]	TVD [ft]	Vert Sect [ft]	North [ft]	East [ft]	DLS [°/100ft]	Comments
0.00†	0.000	277.150	0.00	0.00	0.00	0.00	0.00	
25.00	0.000	277.150	25.00	0.00	0.00	0.00	0.00	
153.00	0.190	277.150	153.00	0.20	0.03	-0.21	0.15	
247.00	1.140	160.740	246.99	0.18	-0.84	-0.06	1.32	
342.00	2.690	148.970	341.94	-0.86	-3.64	1.40	1.67	
436.00	5.950	143.380	435.66	-4.02	-9.44	5.45	3.49	
526.00	8.760	143.190	524.91	-9.50	-18.67	12.34	3.12	
614.00	9.390	142.570	611.81	-16.18	-29.74	20.72	0.72	
704.00	10.090	144.280	700.51	-23.37	-41.97	29.78	0.84	
793.00	11.680	143.880	787.91	-31.15	-55.58	39.64	1.79	
883.00	13.480	144.320	875.74	-40.22	-71.46	51.13	2.00	
972.00	15.290	142.070	961.95	-50.77	-89.14	64.40	2.13	
1061.00	17.040	143.320	1047.43	-62.75	-108.86	79.40	2.00	
1151.00	18.370	142.390	1133.16	-75.95	-130.67	95.94	1.51	
1240.00	18.920	142.020	1217.49	-89.93	-153.15	113.37	0.63	
1330.00	18.450	141.330	1302.75	-104.34	-175.77	131.25	0.58	
1419.00	18.500	142.200	1387.16	-118.39	-197.93	148.71	0.31	
1509.00	17.710	140.020	1472.70	-132.59	-219.70	166.25	1.16	
1598.00	17.650	140.560	1557.50	-146.66	-240.49	183.52	0.20	
1688.00	17.230	140.650	1643.36	-160.57	-261.34	200.64	0.47	
1777.00	17.630	138.450	1728.28	-174.74	-281.62	217.94	0.87	
1880.00	16.590	137.270	1826.72	-191.58	-304.09	238.26	1.06	
1970.00	17.650	140.490	1912.73	-205.90	-324.06	255.66	1.58	
2059.00	17.690	144.070	1997.53	-219.14	-345.42	272.18	1.22	
2149.00	17.650	144.300	2083.29	-231.74	-367.57	288.17	0.09	
2238.00	17.650	143.100	2168.10	-244.39	-389.32	304.14	0.41	
2328.00	17.770	138.780	2253.84	-258.36	-410.56	321.39	1.47	
2417.00	17.730	134.160	2338.61	-273.98	-430.22	340.06	1.58	
2506.00	17.720	130.400	2423.38	-291.16	-448.44	360.09	1.29	
2595.00	17.280	132.190	2508.26	-308.49	-466.09	380.20	0.78	



SRC ENERGY

# Actual Wellpath Report

FALKEN 34N-9C-L AWP

Page 3 of 11

**BAKER  
HUGHES****REFERENCE WELLPATH IDENTIFICATION**

Operator	SRC ENERGY	Slot	SLOT#12 FALKEN 34N-9C-L (1739'FSL & 276'FEL, SEC.11)
Area	COLORADO	Well	FALKEN 34N-9C-L
Field	WELD COUNTY (NAD83,TRUE NORTH)	Wellbore	FALKEN 34N-9C-L AWB
Facility	SEC.11-T06N-R66W		

**WELLPATH DATA (219 stations)**

MD [ft]	Inclination [°]	Azimuth [°]	TVD [ft]	Vert Sect [ft]	North [ft]	East [ft]	DLS [°/100ft]	Comments
2685.00	17.640	142.850	2594.14	-323.56	-485.94	398.35	3.57	
2774.00	17.650	145.500	2678.95	-336.01	-507.81	414.13	0.90	
2863.00	17.680	145.020	2763.76	-348.01	-530.00	429.52	0.17	
2953.00	17.830	141.000	2849.47	-361.16	-551.91	446.03	1.37	
3043.00	17.970	132.930	2935.13	-376.87	-572.08	464.87	2.76	
3132.00	17.580	138.330	3019.89	-392.84	-591.47	483.86	1.90	
3222.00	17.840	144.360	3105.63	-406.63	-612.83	500.93	2.06	
3311.00	18.090	143.620	3190.29	-419.38	-635.03	517.07	0.38	
3401.00	17.720	143.580	3275.93	-432.39	-657.30	533.49	0.41	
3490.00	17.590	142.810	3360.74	-445.25	-678.92	549.66	0.30	
3580.00	17.530	146.700	3446.55	-457.53	-701.08	565.32	1.31	
3669.00	17.740	145.400	3531.37	-469.18	-723.44	580.38	0.50	
3759.00	17.800	147.830	3617.07	-480.80	-746.37	595.49	0.83	
3848.00	17.750	142.380	3701.83	-492.93	-768.64	611.02	1.87	
3938.00	18.040	137.630	3787.48	-507.43	-789.80	628.78	1.65	
4027.00	17.950	132.210	3872.13	-523.86	-809.20	648.23	1.88	
4117.00	17.990	130.320	3957.74	-541.85	-827.51	669.10	0.65	
4206.00	17.920	130.420	4042.41	-559.95	-845.28	690.00	0.09	
4296.00	17.950	132.830	4128.04	-577.77	-863.68	710.71	0.83	
4385.00	17.850	137.930	4212.74	-593.94	-883.13	729.91	1.76	
4475.00	17.910	141.260	4298.39	-608.60	-904.17	747.81	1.14	
4564.00	17.810	146.130	4383.11	-621.38	-926.14	763.96	1.68	
4654.00	17.740	149.890	4468.81	-632.40	-949.43	778.51	1.28	
4743.00	17.830	152.510	4553.56	-641.89	-973.25	791.61	0.90	
4833.00	17.740	154.110	4639.26	-650.54	-997.81	803.95	0.55	
4923.00	17.710	157.010	4724.99	-658.14	-1022.75	815.29	0.98	
5012.00	17.840	154.630	4809.74	-665.55	-1047.53	826.42	0.83	
5102.00	17.730	152.020	4895.44	-674.19	-1072.09	838.75	0.89	
5191.00	17.980	148.050	4980.16	-684.24	-1095.71	852.38	1.40	
5281.00	17.920	142.650	5065.78	-696.51	-1118.51	868.13	1.85	



SRC ENERGY

# Actual Wellpath Report

FALKEN 34N-9C-L AWP

Page 4 of 11

**BAKER  
HUGHES**

## REFERENCE WELLPATH IDENTIFICATION

Operator	SRC ENERGY	Slot	SLOT#12 FALKEN 34N-9C-L (1739'FSL & 276'FEL, SEC.11)
Area	COLORADO	Well	FALKEN 34N-9C-L
Field	WELD COUNTY (NAD83,TRUE NORTH)	Wellbore	FALKEN 34N-9C-L AWB
Facility	SEC.11-T06N-R66W		

## WELLPATH DATA (219 stations)

MD [ft]	Inclination [°]	Azimuth [°]	TVD [ft]	Vert Sect [ft]	North [ft]	East [ft]	DLS [°/100ft]	Comments
5370.00	17.560	139.910	5150.55	-710.22	-1139.66	885.08	1.02	
5460.00	16.380	143.000	5236.63	-723.44	-1160.18	901.47	1.65	
5549.00	16.560	141.870	5321.98	-735.76	-1180.18	916.85	0.41	
5639.00	17.080	134.060	5408.14	-750.20	-1199.47	934.27	2.57	
5728.00	18.330	126.240	5492.94	-768.14	-1216.83	954.95	3.02	
5818.00	19.800	126.090	5578.00	-789.10	-1234.18	978.69	1.63	
5908.00	19.210	130.860	5662.84	-809.66	-1252.85	1002.20	1.89	
5997.00	19.640	132.990	5746.77	-828.57	-1272.62	1024.22	0.93	
6086.00	19.040	133.860	5830.75	-846.81	-1292.88	1045.63	0.75	
6176.00	17.770	135.000	5916.15	-864.00	-1312.76	1065.92	1.47	
6265.00	18.440	133.550	6000.74	-880.80	-1332.07	1085.73	0.91	
6355.00	19.060	133.970	6085.96	-898.56	-1352.08	1106.62	0.71	
6444.00	18.140	137.290	6170.32	-915.26	-1372.35	1126.48	1.58	
6534.00	17.140	139.720	6256.08	-930.19	-1392.76	1144.56	1.38	
6623.00	16.550	140.590	6341.27	-943.66	-1412.56	1161.08	0.72	
6713.00	14.820	142.310	6427.91	-955.92	-1431.57	1176.26	1.99	
6757.00	13.850	152.250	6470.55	-960.43	-1440.69	1182.15	6.00	
6802.00	13.700	164.230	6514.26	-962.90	-1450.58	1186.11	6.34	
6892.00	13.710	185.420	6601.76	-961.74	-1471.47	1188.00	5.55	
6981.00	16.820	207.000	6687.67	-951.77	-1493.47	1181.15	7.22	
7071.00	22.700	221.980	6772.39	-930.84	-1518.02	1163.60	8.57	
7160.00	29.240	235.300	6852.43	-898.08	-1543.21	1134.18	9.81	
7249.00	36.110	252.810	6927.47	-852.53	-1563.40	1091.11	13.06	
7339.00	45.420	260.340	6995.60	-794.12	-1576.65	1034.02	11.68	
7428.00	53.670	262.310	7053.30	-726.46	-1586.79	967.12	9.42	
7518.00	62.490	265.690	7100.85	-650.23	-1594.66	891.23	10.30	
7607.00	70.940	268.900	7136.01	-568.97	-1598.44	809.66	10.05	
7697.00	78.780	268.880	7159.49	-482.85	-1600.12	722.86	8.71	
7787.00	86.950	269.180	7170.66	-394.37	-1601.63	633.65	9.08	
7831.00	90.520	270.000	7171.64	-350.81	-1601.94	589.67	8.32	



SRC ENERGY

# Actual Wellpath Report

FALKEN 34N-9C-L AWP

Page 5 of 11

**BAKER  
HUGHES****REFERENCE WELLPATH IDENTIFICATION**

Operator	SRC ENERGY	Slot	SLOT#12 FALKEN 34N-9C-L (1739'FSL & 276'FEL, SEC.11)
Area	COLORADO	Well	FALKEN 34N-9C-L
Field	WELD COUNTY (NAD83,TRUE NORTH)	Wellbore	FALKEN 34N-9C-L AWB
Facility	SEC.11-T06N-R66W		

**WELLPATH DATA (219 stations)**

MD [ft]	Inclination [°]	Azimuth [°]	TVD [ft]	Vert Sect [ft]	North [ft]	East [ft]	DLS [°/100ft]	Comments
7876.00	90.620	270.070	7171.19	-306.29	-1601.91	544.67	0.27	LANDING POINT (137'FSL & 281'FWL, SEC.12)
7966.00	90.740	269.350	7170.12	-217.18	-1602.37	454.68	0.81	
8055.00	90.740	269.780	7168.97	-129.04	-1603.05	365.69	0.48	
8145.00	90.650	270.950	7167.88	-40.09	-1602.47	275.70	1.30	
8234.00	90.770	271.690	7166.78	47.64	-1600.42	186.73	0.84	
8324.00	90.680	272.110	7165.64	136.20	-1597.44	96.79	0.48	
8413.00	90.740	271.460	7164.53	223.80	-1594.67	7.84	0.73	
8503.00	90.890	272.290	7163.25	312.36	-1591.72	-82.10	0.94	
8592.00	90.710	272.020	7162.01	399.86	-1588.38	-171.03	0.36	
8682.00	90.370	270.910	7161.16	488.54	-1586.07	-261.00	1.29	
8771.00	90.400	270.430	7160.56	576.44	-1585.03	-349.99	0.54	
8861.00	90.280	269.830	7160.03	665.45	-1584.83	-439.99	0.68	
8950.00	90.400	269.310	7159.50	753.60	-1585.50	-528.98	0.60	
9040.00	90.370	269.320	7158.90	842.80	-1586.57	-618.97	0.04	
9129.00	90.340	269.480	7158.35	930.98	-1587.51	-707.97	0.18	
9219.00	90.400	269.170	7157.77	1020.17	-1588.57	-797.96	0.35	
9309.00	90.710	269.410	7156.89	1109.37	-1589.68	-887.95	0.44	
9398.00	90.770	270.010	7155.74	1197.48	-1590.13	-976.94	0.68	
9488.00	90.800	269.530	7154.51	1286.57	-1590.49	-1066.93	0.53	
9577.00	89.600	271.890	7154.20	1374.45	-1589.39	-1155.91	2.97	
9666.00	89.480	275.720	7154.92	1461.44	-1583.49	-1244.70	4.31	
9756.00	89.600	275.300	7155.64	1548.82	-1574.84	-1334.28	0.49	
9845.00	89.480	273.590	7156.35	1635.60	-1567.95	-1423.01	1.93	
9935.00	89.510	269.140	7157.15	1724.28	-1565.80	-1512.95	4.94	
10024.00	89.600	269.120	7157.84	1812.52	-1567.15	-1601.94	0.10	
10114.00	89.690	270.270	7158.39	1901.64	-1567.63	-1691.94	1.28	
10203.00	89.260	270.870	7159.21	1989.55	-1566.75	-1780.93	0.83	
10293.00	89.260	270.380	7160.37	2078.45	-1565.77	-1870.91	0.54	
10382.00	89.290	269.910	7161.50	2166.46	-1565.54	-1959.91	0.53	
10472.00	89.290	268.950	7162.61	2255.63	-1566.44	-2049.89	1.07	



SRC ENERGY

# Actual Wellpath Report

FALKEN 34N-9C-L AWP

Page 6 of 11

**BAKER  
HUGHES****REFERENCE WELLPATH IDENTIFICATION**

Operator	SRC ENERGY	Slot	SLOT#12 FALKEN 34N-9C-L (1739'FSL & 276'FEL, SEC.11)
Area	COLORADO	Well	FALKEN 34N-9C-L
Field	WELD COUNTY (NAD83,TRUE NORTH)	Wellbore	FALKEN 34N-9C-L AWB
Facility	SEC.11-T06N-R66W		

**WELLPATH DATA (219 stations)**

MD [ft]	Inclination [°]	Azimuth [°]	TVD [ft]	Vert Sect [ft]	North [ft]	East [ft]	DLS [°/100ft]	Comments
10561.00	89.260	268.890	7163.74	2343.90	-1568.11	-2138.87	0.08	
10651.00	89.140	269.240	7165.00	2433.14	-1569.58	-2228.85	0.41	
10740.00	89.350	269.260	7166.17	2521.35	-1570.75	-2317.83	0.24	
10830.00	89.170	269.380	7167.33	2610.54	-1571.82	-2407.82	0.24	
10919.00	89.260	269.450	7168.55	2698.72	-1572.72	-2496.81	0.13	
11009.00	89.170	269.700	7169.78	2787.85	-1573.39	-2586.80	0.30	
11098.00	89.880	270.450	7170.52	2875.88	-1573.27	-2675.79	1.16	
11188.00	89.454	269.000	7171.05	2964.99	-1573.71	-2765.79	1.68	
11277.00	89.820	272.340	7171.61	3052.87	-1572.67	-2854.77	3.78	
11367.00	89.720	274.670	7171.97	3140.95	-1567.16	-2944.59	2.59	
11456.00	89.850	271.800	7172.30	3228.12	-1562.14	-3033.44	3.23	
11546.00	89.850	270.760	7172.54	3316.85	-1560.13	-3123.42	1.16	
11635.00	89.780	268.540	7172.83	3404.98	-1560.68	-3212.41	2.50	
11724.00	89.780	264.920	7173.17	3493.62	-1565.75	-3301.25	4.07	
11814.00	89.850	265.870	7173.46	3583.42	-1572.98	-3390.96	1.06	
11903.00	89.720	266.460	7173.79	3672.15	-1578.93	-3479.76	0.68	
11993.00	89.820	267.630	7174.16	3761.75	-1583.57	-3569.63	1.30	
12082.00	89.600	269.610	7174.61	3850.08	-1585.71	-3658.60	2.24	
12172.00	89.690	270.470	7175.16	3939.12	-1585.65	-3748.60	0.96	
12261.00	89.750	270.780	7175.60	4027.03	-1584.68	-3837.59	0.35	
12351.00	89.850	270.670	7175.91	4115.90	-1583.54	-3927.59	0.17	
12441.00	89.850	270.490	7176.15	4204.81	-1582.63	-4017.58	0.20	
12530.00	89.720	270.300	7176.48	4292.77	-1582.02	-4106.58	0.26	
12619.00	89.540	269.930	7177.06	4380.80	-1581.84	-4195.58	0.46	
12709.00	89.540	268.290	7177.78	4470.03	-1583.23	-4285.56	1.82	
12798.00	89.510	268.520	7178.52	4558.41	-1585.71	-4374.52	0.26	
12888.00	89.660	268.560	7179.17	4647.76	-1588.01	-4464.49	0.17	
12977.00	89.510	269.400	7179.81	4736.03	-1589.59	-4553.47	0.96	
13067.00	89.540	270.350	7180.56	4825.10	-1589.79	-4643.47	1.06	
13156.00	89.750	270.290	7181.11	4913.08	-1589.29	-4732.46	0.25	





SRC ENERGY

# Actual Wellpath Report

FALKEN 34N-9C-L AWP

Page 7 of 11

**BAKER  
HUGHES****REFERENCE WELLPATH IDENTIFICATION**

Operator	SRC ENERGY	Slot	SLOT#12 FALKEN 34N-9C-L (1739'FSL & 276'FEL, SEC.11)
Area	COLORADO	Well	FALKEN 34N-9C-L
Field	WELD COUNTY (NAD83,TRUE NORTH)	Wellbore	FALKEN 34N-9C-L AWB
Facility	SEC.11-T06N-R66W		

**WELLPATH DATA (219 stations)**

MD [ft]	Inclination [°]	Azimuth [°]	TVD [ft]	Vert Sect [ft]	North [ft]	East [ft]	DLS [°/100ft]	Comments
13246.00	89.660	270.650	7181.57	5002.02	-1588.55	-4822.46	0.41	
13335.00	89.720	269.670	7182.06	5090.03	-1588.30	-4911.46	1.10	
13425.00	89.600	266.960	7182.59	5179.42	-1590.95	-5001.41	3.01	
13514.00	89.510	263.690	7183.28	5268.22	-1598.20	-5090.10	3.68	
13604.00	89.540	264.560	7184.03	5358.13	-1607.41	-5179.62	0.97	
13693.00	89.910	267.960	7184.46	5446.83	-1613.22	-5268.42	3.84	
13783.00	89.750	270.780	7184.72	5536.00	-1614.21	-5358.40	3.14	
13872.00	89.320	269.030	7185.44	5624.08	-1614.35	-5447.40	2.02	
13962.00	89.690	268.800	7186.22	5713.35	-1616.06	-5537.38	0.48	
14051.00	89.510	271.700	7186.84	5801.34	-1615.67	-5626.36	3.26	
14141.00	89.480	274.410	7187.64	5889.55	-1610.87	-5716.22	3.01	
14230.00	89.600	274.930	7188.35	5976.26	-1603.63	-5804.92	0.60	
14320.00	89.540	274.710	7189.03	6063.89	-1596.07	-5894.60	0.25	
14409.00	89.750	275.210	7189.58	6150.50	-1588.37	-5983.27	0.61	
14499.00	89.320	275.230	7190.31	6237.98	-1580.18	-6072.89	0.48	
14588.00	90.710	272.950	7190.29	6324.88	-1573.84	-6161.66	3.00	
14678.00	90.680	271.100	7189.19	6413.40	-1570.66	-6251.59	2.06	
14767.00	90.740	270.600	7188.09	6501.25	-1569.34	-6340.57	0.57	
14857.00	90.550	270.490	7187.08	6590.16	-1568.48	-6430.56	0.24	
14946.00	90.710	270.140	7186.10	6678.14	-1567.99	-6519.56	0.43	
15035.00	90.650	269.360	7185.04	6766.25	-1568.38	-6608.55	0.88	
15125.00	90.620	269.290	7184.05	6855.44	-1569.44	-6698.54	0.08	
15214.00	90.580	269.850	7183.11	6943.58	-1570.11	-6787.53	0.63	
15304.00	90.920	266.670	7181.94	7032.96	-1572.84	-6877.47	3.55	
15393.00	90.490	266.510	7180.84	7121.63	-1578.13	-6966.30	0.52	
15483.00	90.650	268.710	7179.94	7211.13	-1581.89	-7056.22	2.45	
15572.00	90.620	271.820	7178.96	7299.11	-1581.47	-7145.20	3.49	
15661.00	90.710	271.250	7177.93	7386.78	-1579.09	-7234.16	0.65	
15751.00	90.400	277.880	7177.05	7474.45	-1571.93	-7323.82	7.37	
15840.00	90.060	285.100	7176.69	7558.11	-1554.21	-7410.98	8.12	





SRC ENERGY

# Actual Wellpath Report

FALKEN 34N-9C-L AWP

Page 8 of 11

**BAKER  
HUGHES****REFERENCE WELLPATH IDENTIFICATION**

Operator	SRC ENERGY	Slot	SLOT#12 FALKEN 34N-9C-L (1739'FSL & 276'FEL, SEC.11)
Area	COLORADO	Well	FALKEN 34N-9C-L
Field	WELD COUNTY (NAD83,TRUE NORTH)	Wellbore	FALKEN 34N-9C-L AWP
Facility	SEC.11-T06N-R66W		

**WELLPATH DATA (219 stations)**

MD [ft]	Inclination [°]	Azimuth [°]	TVD [ft]	Vert Sect [ft]	North [ft]	East [ft]	DLS [°/100ft]	Comments
15930.00	89.380	277.320	7177.14	7642.85	-1536.73	-7499.19	8.68	
16019.00	89.780	270.480	7177.79	7729.77	-1530.68	-7587.93	7.70	
16109.00	89.820	271.370	7178.10	7818.60	-1529.23	-7677.92	0.99	
16198.00	90.310	275.610	7178.00	7905.68	-1523.81	-7766.73	4.80	
16288.00	89.940	268.460	7177.80	7994.15	-1520.62	-7856.62	7.96	
16377.00	89.510	264.450	7178.23	8082.82	-1526.12	-7945.43	4.53	
16467.00	89.820	263.340	7178.76	8172.75	-1535.69	-8034.91	1.28	
16556.00	89.230	263.280	7179.50	8261.71	-1546.06	-8123.30	0.67	
16646.00	89.600	262.970	7180.42	8351.67	-1556.83	-8212.65	0.54	
16735.00	89.630	264.180	7181.01	8440.62	-1566.79	-8301.09	1.36	
16825.00	89.630	266.120	7181.59	8530.44	-1574.40	-8390.76	2.16	
16914.00	89.660	268.380	7182.15	8619.01	-1578.67	-8479.65	2.54	
17004.00	89.540	269.430	7182.77	8708.29	-1580.39	-8569.63	1.17	
17093.00	89.780	271.460	7183.30	8796.23	-1579.70	-8658.62	2.30	
17183.00	89.750	273.360	7183.67	8884.65	-1575.91	-8748.54	2.11	
17272.00	89.600	273.230	7184.18	8971.81	-1570.80	-8837.39	0.22	
17362.00	89.750	267.950	7184.69	9060.69	-1569.87	-8927.35	5.87	
17451.00	89.820	263.570	7185.02	9149.44	-1576.45	-9016.08	4.92	
17540.00	90.060	264.400	7185.11	9238.36	-1585.78	-9104.59	0.97	
17630.00	90.090	267.320	7185.00	9328.11	-1592.27	-9194.35	3.24	
17719.00	90.980	269.110	7184.17	9416.52	-1595.05	-9283.30	2.25	
17809.00	90.710	269.790	7182.84	9505.68	-1595.91	-9373.28	0.81	
17898.00	91.080	268.550	7181.45	9593.90	-1597.20	-9462.26	1.45	
17988.00	90.830	269.400	7179.95	9683.15	-1598.81	-9552.23	0.98	
18077.00	90.770	271.320	7178.71	9771.11	-1598.25	-9641.22	2.16	
18167.00	91.420	272.360	7176.99	9859.67	-1595.36	-9731.15	1.36	
18256.00	91.110	273.540	7175.02	9946.93	-1590.78	-9820.01	1.37	
18345.00	91.110	272.900	7173.30	10034.10	-1585.78	-9908.85	0.72	
18435.00	91.230	273.190	7171.46	10122.31	-1581.00	-9998.71	0.35	
18524.00	91.020	272.830	7169.71	10209.55	-1576.33	-10087.57	0.47	



SRC ENERGY

# Actual Wellpath Report

FALKEN 34N-9C-L AWP

Page 9 of 11

**BAKER  
HUGHES****REFERENCE WELLPATH IDENTIFICATION**

Operator	SRC ENERGY	Slot	SLOT#12 FALKEN 34N-9C-L (1739'FSL & 276'FEL, SEC.11)
Area	COLORADO	Well	FALKEN 34N-9C-L
Field	WELD COUNTY (NAD83,TRUE NORTH)	Wellbore	FALKEN 34N-9C-L AWB
Facility	SEC.11-T06N-R66W		

**WELLPATH DATA (219 stations)**

MD [ft]	Inclination [°]	Azimuth [°]	TVD [ft]	Vert Sect [ft]	North [ft]	East [ft]	DLS [°/100ft]	Comments
18613.00	91.080	273.300	7168.08	10296.77	-1571.57	-10176.43	0.53	
18703.00	90.680	273.150	7166.70	10384.93	-1566.51	-10266.27	0.47	
18792.00	90.490	272.320	7165.79	10472.27	-1562.26	-10355.17	0.96	
18882.00	90.550	271.440	7164.97	10560.83	-1559.31	-10445.11	0.98	
18972.00	90.890	270.660	7163.84	10649.62	-1557.66	-10535.09	0.95	
19061.00	90.990	269.990	7162.38	10737.58	-1557.16	-10624.08	0.76	
19150.00	90.920	267.930	7160.90	10825.84	-1558.77	-10713.04	2.32	
19166.00	91.050	267.880	7160.62	10841.75	-1559.36	-10729.03	0.87	LAST BHGE MWD SURVEY (159'FSL & 336'FEL, SEC.09)
19190.00	91.050	267.880	7160.18	10865.60	-1560.24	-10753.01	0.00	PROJECTION TO BIT (158'FSL & 360'FEL, SEC.09)

**HOLE & CASING SECTIONS - Ref Wellbore: FALKEN 34N-9C-L AWB      Ref Wellpath: FALKEN 34N-9C-L AWP**

String/Diameter	Start MD [ft]	End MD [ft]	Interval [ft]	Start TVD [ft]	End TVD [ft]	Start N/S [ft]	Start E/W [ft]	End N/S [ft]	End E/W [ft]
13.5in Open Hole	25.00	1823.00	1798.00	25.00	1772.17	0.00	0.00	-291.87	227.11
9.625in Casing Surface	25.00	1823.00	1798.00	25.00	1772.17	0.00	0.00	-291.87	227.11
8.5in Open Hole	1823.00	19190.00	17367.00	1772.17	7160.18	-291.87	227.11	-1560.24	-10753.01



# Actual Wellpath Report

## FALKEN 34N-9C-L AWP

Page 10 of 11



REFERENCE WELLPATH IDENTIFICATION				
Operator	SRC ENERGY	Slot	SLOT#12 FALKEN 34N-9C-L (1739'FSL & 276'FEL, SEC.11)	
Area	COLORADO	Well	FALKEN 34N-9C-L	
Field	WELD COUNTY (NAD83,TRUE NORTH)	Wellbore	FALKEN 34N-9C-L AWB	
Facility	SEC.11-T06N-R66W			

TARGETS								
Name	TVD [ft]	North [ft]	East [ft]	Grid East [US ft]	Grid North [US ft]	Latitude	Longitude	Shape
SEC.10-T6N-R66W	0.00	165.04	1.39	3212478.20	1426196.25	40°30'02.869"N	104°44'09.402"W	polygon
SEC.11-T6N-R66W SOUTHERN HALF	0.00	165.04	1.39	3212478.20	1426196.25	40°30'02.869"N	104°44'09.402"W	polygon
SEC.14-T6N-R66W NORTHERN HALF	0.00	165.04	1.39	3212478.20	1426196.25	40°30'02.869"N	104°44'09.402"W	polygon
SEC.9-T6N-R66W EAST QUARTER	0.00	165.04	1.39	3212478.20	1426196.25	40°30'02.869"N	104°44'09.402"W	polygon
FALKEN 34N-9C-L TOP OF PROD ON PLAT (82'FSL & 300'FWL, SEC.12)	7125.00	-1656.91	564.04	3213056.51	1424379.28	40°29'44.866"N	104°44'02.119"W	circle
FALKEN 34N-9C-L BHL ON PLAT (149'FSL & 300'FEL SEC.09)	7152.00	-1569.35	-10693.10	3201799.43	1424369.84	40°29'45.708"N	104°46'27.829"W	circle
FALKEN 34N-9C-L BHL REV-2 (149'FSL & 300'FEL, SEC.09)	7160.39	-1569.35	-10693.10	3201799.44	1424369.85	40°29'45.708"N	104°46'27.829"W	point
FALKEN 34N-9C-L TOP OF PROD REV-2 (142'FSL & 300'FWL, SEC.12)	7171.13	-1596.91	564.04	3213055.99	1424439.28	40°29'45.459"N	104°44'02.119"W	point

WELLPATH COMPOSITION - Ref Wellbore: FALKEN 34N-9C-L AWB Ref Wellpath: FALKEN 34N-9C-L AWP				
Start MD [ft]	End MD [ft]	Positional Uncertainty Model	Log Name/Comment	Wellbore
25.00	1777.00	BHI NaviTrak (Rotating+Axial Corr)	13 1/2" APS EM SURVEYS <153'-1777'>	FALKEN 34N-9C-L AWB
1777.00	19166.00	BHI AutoTrak Curve (IFR1, Short)	8 1/2" AT-CURVE SURVEYS <1880'-19166'>	FALKEN 34N-9C-L AWB
19166.00	19190.00	Blind Drilling (std)	Projection to bit	FALKEN 34N-9C-L AWB



SRC ENERGY

# Actual Wellpath Report

FALKEN 34N-9C-L AWP

Page 11 of 11



**BAKER  
HUGHES**

## REFERENCE WELLPATH IDENTIFICATION

Operator	SRC ENERGY	Slot	SLOT#12 FALKEN 34N-9C-L (1739'FSL & 276'FEL, SEC.11)
Area	COLORADO	Well	FALKEN 34N-9C-L
Field	WELD COUNTY (NAD83,TRUE NORTH)	Wellbore	FALKEN 34N-9C-L AWB
Facility	SEC.11-T06N-R66W		

## WELLPATH COMMENTS

MD [ft]	Inclination [°]	Azimuth [°]	TVD [ft]	Comment
7876.00	90.620	270.070	7171.19	LANDING POINT (137'FSL & 281'FWL, SEC.12)
19166.00	91.050	267.880	7160.62	LAST BHGE MWD SURVEY (159'FSL & 336'FEL, SEC.09)
19190.00	91.050	267.880	7160.18	PROJECTION TO BIT (158'FSL & 360'FEL, SEC.09)