

SRC ENERGY

Location: COLORADO Slot: SLOT#08 FALKEN 33N-9C-L (1799'FSL & 276'FEL, SEC.11)
 Field: WELD COUNTY (NAD83, TRUE NORTH) Well: FALKEN 33N-9C-L
 Facility: SEC.11-T06N-R66W Wellbore: FALKEN 33N-9C-L PWB

Plot reference wellpath is FALKEN 33N-9C-L PWB (REV-B.0)	Grid System: NAD83 / Lambert Colorado SP, Northern Zone (501), US feet
True vertical depths are referenced to PRECISION DRILLING 562 (25') (RKB)	* = Wellpath was transformed from a different geodetic datum
Measured depths are referenced to PRECISION DRILLING 562 (25') (RKB)	North Reference: True north
PRECISION DRILLING 562 (25') (RKB) to Mean Sea Level: 4835 feet	Scale: True distance
Mean Sea Level to Mud line (At Slot: SLOT#08 FALKEN 33N-9C-L (1799'FSL & 276'FEL, SEC.11)): 0 feet	Depths are in feet
Coordinates are in feet referenced to Slot	Created by: doddanna on 2018-02-07
	Database: WellArchitectDB

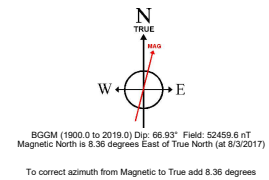

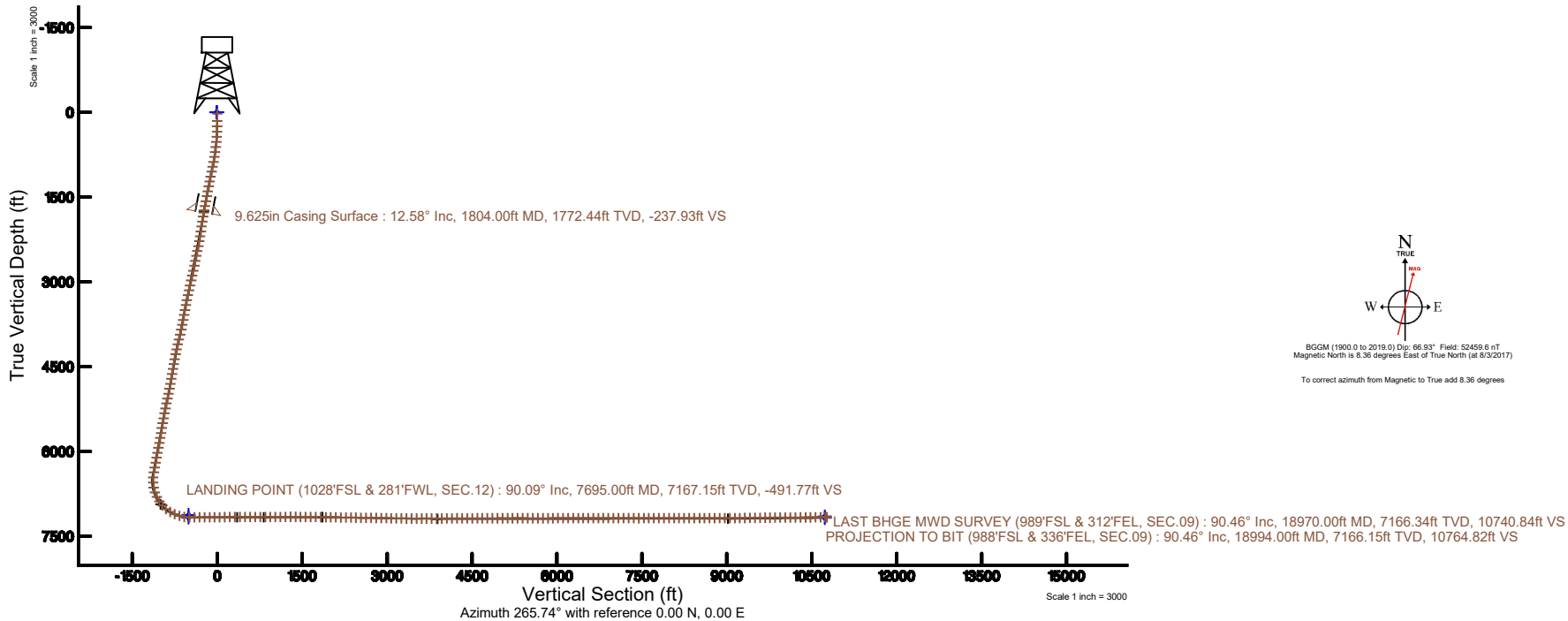
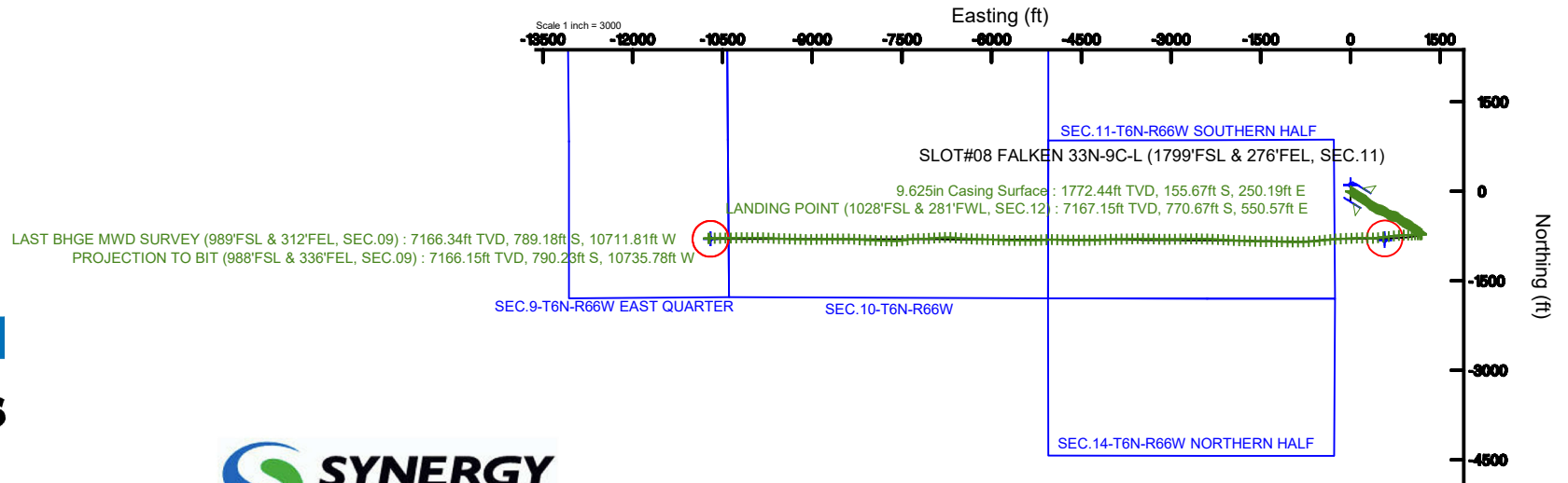

Actual Wellpath Report

FALKEN 33N-9C-L AWP

Page 1 of 11



REFERENCE WELLPATH IDENTIFICATION			
Operator	SRC ENERGY	Slot	SLOT#08 FALKEN 33N-9C-L (1799'FSL & 276'FEL, SEC.11)
Area	COLORADO	Well	FALKEN 33N-9C-L
Field	WELD COUNTY (NAD83,TRUE NORTH)	Wellbore	FALKEN 33N-9C-L AWB
Facility	SEC.11-T06N-R66W		

REPORT SETUP INFORMATION			
Projection System	NAD83 / Lambert Colorado SP, Northern Zone (501), US feet	Software System	WellArchitect® 5.0
North Reference	True	User	Doddanna
Scale	0.999966	Report Generated	2/7/2018 at 2:41:21 PM
Convergence at slot	0.49° East	Database/Source file	WellArchitectDB/FALKEN_33N-9C-L_AWP.xml

WELLPATH LOCATION						
	Local coordinates		Grid coordinates		Geographic coordinates	
	North[ft]	East[ft]	Easting[US ft]	Northing[US ft]	Latitude	Longitude
Slot Location	-104.92	-0.83	3212478.27	1426091.33	40°30'01.832"N	104°44'09.413"W
Facility Reference Pt			3212478.20	1426196.25	40°30'02.869"N	104°44'09.402"W
Field Reference Pt			3171284.48	1426358.81	40°30'07.643"N	104°53'02.634"W

WELLPATH DATUM			
Calculation method	Minimum curvature	PRECISION DRILLING 562 (25') (RKB) to Facility Vertical Datum	4835.00ft
Horizontal Reference Pt	Slot	PRECISION DRILLING 562 (25') (RKB) to Mean Sea Level	4835.00ft
Vertical Reference Pt	PRECISION DRILLING 562 (25') (RKB)	PRECISION DRILLING 562 (25') (RKB) to Mud Line at Slot (SLOT#08 FALKEN 33N-9C-L (1799'FSL & 276'FEL, SEC.11))	4835.00ft
MD Reference Pt	PRECISION DRILLING 562 (25') (RKB)	Section Origin	N 0.00, E 0.00 ft
Field Vertical Reference	Mean Sea Level	Section Azimuth	265.79°



Actual Wellpath Report

FALKEN 33N-9C-L AWP

Page 2 of 11



REFERENCE WELLPATH IDENTIFICATION			
Operator	SRC ENERGY	Slot	SLOT#08 FALKEN 33N-9C-L (1799'FSL & 276'FEL, SEC.11)
Area	COLORADO	Well	FALKEN 33N-9C-L
Field	WELD COUNTY (NAD83,TRUE NORTH)	Wellbore	FALKEN 33N-9C-L AWB
Facility	SEC.11-T06N-R66W		

WELLPATH DATA (214 stations) † = interpolated/extrapolated station								
MD [ft]	Inclination [°]	Azimuth [°]	TVD [ft]	Vert Sect [ft]	North [ft]	East [ft]	DLS ["/100ft]	Comments
0.00†	0.000	110.560	0.00	0.00	0.00	0.00	0.00	
25.00	0.000	110.560	25.00	0.00	0.00	0.00	0.00	
153.00	0.360	110.560	153.00	-0.37	-0.14	0.38	0.28	
247.00	1.010	127.050	246.99	-1.26	-0.74	1.31	0.72	
342.00	1.960	120.910	341.96	-3.21	-2.08	3.38	1.01	
436.00	4.790	116.960	435.79	-7.89	-4.69	8.25	3.02	
526.00	6.930	119.730	525.31	-15.61	-9.09	16.32	2.40	
614.00	8.510	121.730	612.51	-25.29	-15.14	26.47	1.82	
704.00	9.620	123.090	701.39	-36.66	-22.75	38.43	1.26	
793.00	11.480	123.740	788.88	-49.56	-31.73	52.03	2.09	
883.00	13.380	121.700	876.76	-65.06	-42.18	68.34	2.17	
972.00	13.930	123.340	963.25	-81.89	-53.48	86.05	0.76	
1061.00	14.220	123.630	1049.58	-99.02	-65.42	104.10	0.34	
1151.00	13.660	121.250	1136.93	-116.40	-77.05	122.39	0.89	
1240.00	13.480	121.670	1223.44	-133.37	-87.95	140.20	0.23	
1330.00	13.590	121.560	1310.94	-150.45	-98.99	158.14	0.13	
1419.00	13.700	123.720	1397.43	-167.24	-110.32	175.82	0.59	
1509.00	13.100	120.600	1484.98	-184.03	-121.43	193.46	1.04	
1598.00	12.800	118.780	1571.72	-200.58	-131.31	210.78	0.57	
1688.00	13.200	121.400	1659.41	-217.29	-141.46	228.29	0.79	
1763.00	13.030	123.440	1732.46	-230.95	-150.58	242.66	0.66	
1879.00	11.780	127.230	1845.75	-250.18	-164.95	263.00	1.29	
1968.00	13.240	135.300	1932.64	-263.61	-177.70	277.40	2.56	
2058.00	13.090	134.930	2020.27	-276.97	-192.22	291.87	0.19	
2147.00	13.120	137.150	2106.96	-289.87	-206.74	305.87	0.57	
2236.00	13.370	135.290	2193.59	-302.86	-221.46	319.98	0.56	
2326.00	13.420	125.710	2281.15	-317.63	-234.95	335.78	2.46	
2415.00	13.300	118.330	2367.75	-334.18	-245.84	353.18	1.92	
2505.00	13.500	114.760	2455.30	-352.10	-255.15	371.84	0.95	
2594.00	13.640	122.440	2541.82	-369.61	-265.13	390.13	2.03	



Actual Wellpath Report

FALKEN 33N-9C-L AWP

Page 3 of 11



REFERENCE WELLPATH IDENTIFICATION			
Operator	SRC ENERGY	Slot	SLOT#08 FALKEN 33N-9C-L (1799'FSL & 276'FEL, SEC.11)
Area	COLORADO	Well	FALKEN 33N-9C-L
Field	WELD COUNTY (NAD83,TRUE NORTH)	Wellbore	FALKEN 33N-9C-L AWB
Facility	SEC.11-T06N-R66W		

WELLPATH DATA (214 stations)								
MD [ft]	Inclination [°]	Azimuth [°]	TVD [ft]	Vert Sect [ft]	North [ft]	East [ft]	DLS ["/100ft]	Comments
2684.00	13.530	122.630	2629.31	-386.55	-276.50	407.95	0.13	
2773.00	13.710	117.890	2715.81	-403.82	-287.05	426.04	1.27	
2862.00	13.540	114.240	2802.30	-421.91	-296.26	444.86	0.98	
2952.00	13.930	108.730	2889.73	-441.15	-304.07	464.73	1.52	
3041.00	13.420	103.830	2976.21	-460.84	-309.98	484.90	1.42	
3131.00	13.480	108.590	3063.75	-480.44	-315.82	504.99	1.23	
3220.00	13.510	108.850	3150.29	-499.57	-322.48	524.66	0.08	
3309.00	13.470	109.120	3236.83	-518.65	-329.24	544.29	0.08	
3399.00	13.550	118.320	3324.35	-537.17	-337.67	563.48	2.39	
3489.00	13.360	122.560	3411.89	-554.39	-348.27	581.52	1.12	
3578.00	13.690	128.950	3498.42	-570.31	-360.43	598.38	1.72	
3668.00	13.290	129.820	3585.94	-585.51	-373.74	614.61	0.50	
3757.00	13.380	125.830	3672.54	-600.75	-386.32	630.81	1.04	
3847.00	13.670	120.460	3760.05	-617.47	-397.81	648.43	1.43	
3936.00	13.770	109.480	3846.52	-635.83	-406.68	667.48	2.92	
4025.00	13.800	103.960	3932.96	-655.61	-412.77	687.77	1.48	
4115.00	13.570	96.310	4020.42	-676.19	-416.52	708.68	2.03	
4204.00	13.520	95.340	4106.94	-696.72	-418.64	729.42	0.26	
4294.00	13.530	107.160	4194.46	-716.90	-422.72	749.95	3.07	
4384.00	13.520	118.870	4281.98	-735.52	-430.91	769.23	3.04	
4473.00	13.410	124.180	4368.54	-752.33	-441.73	786.88	1.39	
4563.00	13.530	130.400	4456.07	-768.01	-454.42	803.53	1.61	
4652.00	13.540	132.340	4542.60	-782.58	-468.18	819.16	0.51	
4742.00	13.680	128.560	4630.07	-797.64	-481.91	835.27	1.00	
4831.00	13.460	126.100	4716.59	-813.27	-494.58	851.87	0.69	
4921.00	13.630	127.650	4804.09	-829.15	-507.22	868.73	0.45	
5010.00	13.490	124.910	4890.61	-845.01	-519.57	885.54	0.74	
5100.00	13.710	119.490	4978.09	-862.03	-530.83	903.44	1.44	
5189.00	13.000	112.770	5064.68	-879.73	-539.90	921.85	1.92	
5279.00	12.920	110.160	5152.39	-897.92	-547.28	940.63	0.66	



Actual Wellpath Report

FALKEN 33N-9C-L AWP

Page 4 of 11



REFERENCE WELLPATH IDENTIFICATION			
Operator	SRC ENERGY	Slot	SLOT#08 FALKEN 33N-9C-L (1799'FSL & 276'FEL, SEC.11)
Area	COLORADO	Well	FALKEN 33N-9C-L
Field	WELD COUNTY (NAD83,TRUE NORTH)	Wellbore	FALKEN 33N-9C-L AWB
Facility	SEC.11-T06N-R66W		

WELLPATH DATA (214 stations)								
MD [ft]	Inclination [°]	Azimuth [°]	TVD [ft]	Vert Sect [ft]	North [ft]	East [ft]	DLS [°/100ft]	Comments
5368.00	12.700	114.100	5239.18	-915.59	-554.71	958.90	1.01	
5458.00	12.830	120.660	5326.96	-932.50	-563.84	976.53	1.62	
5547.00	12.860	121.290	5413.73	-948.67	-574.02	993.49	0.16	
5637.00	12.790	125.800	5501.49	-964.46	-585.05	1010.13	1.11	
5726.00	13.200	128.470	5588.21	-979.47	-597.14	1026.08	0.82	
5816.00	13.230	135.550	5675.83	-993.68	-610.88	1041.33	1.80	
5905.00	13.200	130.640	5762.48	-1007.46	-624.77	1056.18	1.26	
5995.00	12.980	122.050	5850.15	-1022.90	-636.83	1072.54	2.17	
6084.00	13.470	117.670	5936.79	-1039.76	-646.95	1090.20	1.25	
6174.00	13.290	122.790	6024.35	-1056.93	-657.42	1108.18	1.33	
6263.00	13.200	123.930	6110.98	-1073.09	-668.63	1125.21	0.31	
6353.00	13.170	124.860	6198.61	-1089.13	-680.23	1142.15	0.24	
6442.00	13.420	126.190	6285.22	-1104.87	-692.12	1158.80	0.44	
6532.00	13.080	127.940	6372.83	-1120.37	-704.55	1175.26	0.58	
6621.00	6.680	132.060	6460.46	-1131.43	-714.22	1187.06	7.23	
6711.00	5.870	187.740	6550.00	-1134.10	-722.29	1190.33	6.55	
6801.00	11.260	256.020	6639.15	-1124.46	-728.99	1181.16	11.76	
6890.00	18.890	272.130	6725.06	-1101.53	-730.56	1158.29	9.70	
6979.00	26.400	271.010	6807.14	-1067.46	-729.68	1124.06	8.45	
7069.00	33.800	266.500	6884.96	-1022.43	-730.85	1079.00	8.59	
7158.00	40.520	267.850	6955.85	-968.72	-733.45	1025.33	7.61	
7248.00	49.380	269.630	7019.49	-905.30	-734.77	961.83	9.94	
7337.00	59.400	268.410	7071.24	-833.15	-736.06	889.58	11.31	
7427.00	68.620	266.170	7110.64	-752.37	-739.94	808.87	10.48	
7516.00	72.530	263.000	7140.24	-668.48	-747.88	725.34	5.53	
7606.00	81.380	261.820	7160.54	-581.05	-759.47	638.52	9.92	
7695.00	90.090	263.660	7167.15	-492.51	-770.67	550.57	10.00	LANDING POINT (1028'FSL & 281'FWL, SEC.12)
7784.00	89.910	262.990	7167.15	-403.59	-781.01	462.17	0.78	
7874.00	89.910	268.730	7167.29	-313.63	-787.51	372.44	6.38	
7963.00	89.880	274.930	7167.46	-225.17	-784.67	283.53	6.97	



Actual Wellpath Report

FALKEN 33N-9C-L AWP

Page 5 of 11



REFERENCE WELLPATH IDENTIFICATION

Operator	SRC ENERGY	Slot	SLOT#08 FALKEN 33N-9C-L (1799'FSL & 276'FEL, SEC.11)
Area	COLORADO	Well	FALKEN 33N-9C-L
Field	WELD COUNTY (NAD83,TRUE NORTH)	Wellbore	FALKEN 33N-9C-L AWB
Facility	SEC.11-T06N-R66W		

WELLPATH DATA (214 stations)

MD [ft]	Inclination [°]	Azimuth [°]	TVD [ft]	Vert Sect [ft]	North [ft]	East [ft]	DLS [°/100ft]	Comments
8053.00	89.880	268.390	7167.64	-135.69	-782.06	193.62	7.27	
8142.00	90.920	267.100	7167.02	-46.74	-785.56	104.69	1.86	
8232.00	91.140	267.720	7165.41	43.20	-789.63	14.80	0.73	
8321.00	90.990	268.230	7163.75	132.12	-792.77	-74.13	0.60	
8410.00	90.920	266.810	7162.27	221.07	-796.62	-163.03	1.60	
8500.00	90.370	265.580	7161.25	311.06	-802.59	-252.82	1.50	
8589.00	89.660	264.590	7161.23	400.05	-810.22	-341.49	1.37	
8679.00	89.910	264.400	7161.57	490.03	-818.85	-431.08	0.35	
8768.00	89.970	263.410	7161.66	578.98	-828.30	-519.57	1.11	
8858.00	90.250	263.600	7161.49	668.91	-838.48	-609.00	0.38	
8947.00	90.180	266.820	7161.16	757.89	-845.91	-697.67	3.62	
9037.00	90.120	269.010	7160.92	847.82	-849.19	-787.61	2.43	
9126.00	90.030	269.270	7160.80	936.67	-850.52	-876.60	0.31	
9216.00	90.280	271.360	7160.56	1026.38	-850.03	-966.59	2.34	
9305.00	90.220	271.610	7160.17	1114.94	-847.72	-1055.56	0.29	
9395.00	90.280	271.520	7159.78	1204.49	-845.27	-1145.53	0.12	
9484.00	90.000	271.270	7159.56	1293.06	-843.10	-1234.50	0.42	
9574.00	90.030	270.450	7159.54	1382.71	-841.75	-1324.49	0.91	
9663.00	89.290	269.220	7160.07	1471.48	-842.00	-1413.48	1.61	
9753.00	89.380	271.010	7161.11	1561.22	-841.82	-1503.47	1.99	
9842.00	89.540	272.410	7161.95	1649.73	-839.17	-1592.43	1.58	
9932.00	89.450	273.060	7162.74	1739.07	-834.87	-1682.32	0.73	
10021.00	89.290	272.230	7163.72	1827.43	-830.77	-1771.22	0.95	
10111.00	89.020	272.220	7165.05	1916.85	-827.27	-1861.14	0.30	
10200.00	89.050	272.910	7166.55	2005.22	-823.29	-1950.04	0.78	
10290.00	88.950	273.810	7168.12	2094.42	-818.02	-2039.87	1.01	
10379.00	89.170	273.530	7169.58	2182.57	-812.32	-2128.68	0.40	
10469.00	89.020	271.730	7171.00	2271.91	-808.19	-2218.57	2.01	
10558.00	89.170	272.090	7172.41	2360.39	-805.23	-2307.51	0.44	
10647.00	89.170	272.570	7173.69	2448.80	-801.61	-2396.42	0.54	



Actual Wellpath Report

FALKEN 33N-9C-L AWP

Page 6 of 11



REFERENCE WELLPATH IDENTIFICATION

Operator	SRC ENERGY	Slot	SLOT#08 FALKEN 33N-9C-L (1799'FSL & 276'FEL, SEC.11)
Area	COLORADO	Well	FALKEN 33N-9C-L
Field	WELD COUNTY (NAD83,TRUE NORTH)	Wellbore	FALKEN 33N-9C-L AWB
Facility	SEC.11-T06N-R66W		

WELLPATH DATA (214 stations)

MD [ft]	Inclination [°]	Azimuth [°]	TVD [ft]	Vert Sect [ft]	North [ft]	East [ft]	DLS [°/100ft]	Comments
10737.00	89.200	271.370	7174.98	2538.27	-798.51	-2486.36	1.33	
10826.00	89.010	269.680	7176.37	2626.95	-797.70	-2575.34	1.91	
10916.00	89.080	269.050	7177.87	2716.76	-798.70	-2665.32	0.70	
11005.00	88.920	268.560	7179.42	2805.63	-800.55	-2754.29	0.58	
11095.00	88.770	268.770	7181.23	2895.49	-802.65	-2844.25	0.29	
11185.00	88.800	268.930	7183.14	2985.35	-804.45	-2934.21	0.18	
11274.00	89.080	268.690	7184.79	3074.21	-806.30	-3023.17	0.41	
11363.00	89.350	270.370	7186.01	3163.01	-807.03	-3112.16	1.91	
11453.00	89.050	273.000	7187.26	3252.51	-804.39	-3202.10	2.94	
11542.00	88.980	271.590	7188.79	3340.93	-800.82	-3291.02	1.59	
11632.00	90.280	270.160	7189.38	3430.56	-799.45	-3381.00	2.15	
11721.00	89.970	271.990	7189.18	3519.18	-797.78	-3469.98	2.09	
11811.00	90.490	269.860	7188.82	3608.81	-796.33	-3559.96	2.44	
11900.00	90.340	268.220	7188.18	3697.67	-797.82	-3648.94	1.85	
11990.00	89.630	267.590	7188.20	3787.60	-801.11	-3738.88	1.05	
12079.00	89.450	270.350	7188.91	3876.46	-802.71	-3827.86	3.11	
12169.00	90.860	268.730	7188.67	3966.26	-803.43	-3917.85	2.39	
12259.00	91.200	267.460	7187.05	4056.17	-806.42	-4007.78	1.46	
12348.00	91.080	266.840	7185.28	4145.12	-810.84	-4096.65	0.71	
12438.00	89.880	266.420	7184.53	4235.11	-816.13	-4186.49	1.41	
12527.00	90.000	268.140	7184.62	4324.08	-820.36	-4275.39	1.94	
12617.00	90.000	270.160	7184.62	4413.92	-821.69	-4365.38	2.24	
12706.00	90.000	269.510	7184.62	4502.70	-821.95	-4454.38	0.73	
12796.00	90.150	269.730	7184.50	4592.49	-822.55	-4544.37	0.30	
12885.00	89.910	271.140	7184.46	4681.20	-821.87	-4633.37	1.61	
12975.00	90.120	272.200	7184.43	4770.72	-819.25	-4723.33	1.20	
13064.00	90.150	271.870	7184.22	4859.20	-816.09	-4812.27	0.37	
13154.00	90.250	272.650	7183.91	4948.62	-812.54	-4902.20	0.87	
13243.00	89.820	270.520	7183.85	5037.16	-810.08	-4991.16	2.44	
13333.00	89.970	266.660	7184.02	5127.04	-812.29	-5081.12	4.29	



Actual Wellpath Report

FALKEN 33N-9C-L AWP

Page 7 of 11



REFERENCE WELLPATH IDENTIFICATION

Operator	SRC ENERGY	Slot	SLOT#08 FALKEN 33N-9C-L (1799'FSL & 276'FEL, SEC.11)
Area	COLORADO	Well	FALKEN 33N-9C-L
Field	WELD COUNTY (NAD83,TRUE NORTH)	Wellbore	FALKEN 33N-9C-L AWB
Facility	SEC.11-T06N-R66W		

WELLPATH DATA (214 stations)

MD [ft]	Inclination [°]	Azimuth [°]	TVD [ft]	Vert Sect [ft]	North [ft]	East [ft]	DLS [°/100ft]	Comments
13422.00	90.220	266.750	7183.87	5216.03	-817.41	-5169.97	0.30	
13512.00	89.880	267.630	7183.79	5306.00	-821.82	-5259.86	1.05	
13601.00	90.090	269.230	7183.82	5394.90	-824.26	-5348.82	1.81	
13691.00	89.780	269.790	7183.92	5484.71	-825.03	-5438.82	0.71	
13780.00	89.780	270.030	7184.26	5573.48	-825.17	-5527.82	0.27	
13870.00	89.970	270.610	7184.46	5663.20	-824.66	-5617.82	0.68	
13959.00	89.880	271.190	7184.57	5751.84	-823.27	-5706.81	0.66	
14049.00	90.710	272.920	7184.11	5841.30	-820.04	-5796.74	2.13	
14138.00	90.150	272.800	7183.44	5929.62	-815.60	-5885.63	0.64	
14228.00	90.280	271.660	7183.10	6019.05	-812.10	-5975.56	1.27	
14317.00	90.220	271.840	7182.72	6107.57	-809.38	-6064.52	0.21	
14407.00	90.220	272.240	7182.37	6197.03	-806.17	-6154.46	0.44	
14496.00	89.970	272.210	7182.22	6285.47	-802.72	-6243.39	0.28	
14586.00	89.910	272.150	7182.32	6374.91	-799.30	-6333.33	0.09	
14675.00	90.030	272.040	7182.36	6463.38	-796.04	-6422.27	0.18	
14765.00	89.970	274.750	7182.36	6552.58	-790.71	-6512.10	3.01	
14854.00	89.940	275.860	7182.43	6640.35	-782.48	-6600.72	1.25	
14944.00	90.030	272.120	7182.46	6729.41	-776.22	-6690.48	4.16	
15033.00	89.940	268.320	7182.48	6818.13	-775.88	-6779.47	4.27	
15123.00	89.940	266.950	7182.57	6908.08	-779.60	-6869.39	1.52	
15212.00	89.970	264.750	7182.64	6997.08	-786.04	-6958.15	2.47	
15302.00	90.000	266.700	7182.67	7087.07	-792.74	-7047.89	2.17	
15391.00	89.850	271.120	7182.78	7175.92	-794.44	-7136.86	4.97	
15481.00	90.060	269.150	7182.86	7265.66	-794.22	-7226.85	2.20	
15570.00	89.600	263.310	7183.12	7354.61	-800.07	-7315.62	6.58	
15659.00	90.180	261.820	7183.29	7443.47	-811.59	-7403.87	1.80	
15749.00	90.250	262.140	7182.95	7533.27	-824.15	-7492.99	0.36	
15838.00	90.090	267.320	7182.69	7622.22	-832.32	-7581.58	5.82	
15928.00	90.220	273.500	7182.44	7711.89	-831.68	-7671.53	6.87	
16017.00	90.120	270.020	7182.18	7800.39	-828.94	-7760.48	3.91	



Actual Wellpath Report

FALKEN 33N-9C-L AWP

Page 8 of 11



REFERENCE WELLPATH IDENTIFICATION			
Operator	SRC ENERGY	Slot	SLOT#08 FALKEN 33N-9C-L (1799'FSL & 276'FEL, SEC.11)
Area	COLORADO	Well	FALKEN 33N-9C-L
Field	WELD COUNTY (NAD83,TRUE NORTH)	Wellbore	FALKEN 33N-9C-L AWB
Facility	SEC.11-T06N-R66W		

WELLPATH DATA (214 stations)									
MD [ft]	Inclination [°]	Azimuth [°]	TVD [ft]	Vert Sect [ft]	North [ft]	East [ft]	DLS [°/100ft]	Comments	
16107.00	89.940	270.940	7182.13	7890.09	-828.19	-7850.47	1.04		
16196.00	90.120	272.650	7182.09	7978.60	-825.40	-7939.43	1.93		
16286.00	90.030	272.510	7181.97	8067.97	-821.35	-8029.34	0.18		
16375.00	90.060	273.140	7181.90	8156.30	-816.96	-8118.23	0.71		
16465.00	90.090	273.520	7181.78	8245.52	-811.74	-8208.07	0.42		
16554.00	90.090	273.770	7181.64	8333.68	-806.08	-8296.89	0.28		
16644.00	90.090	272.570	7181.50	8422.93	-801.10	-8386.75	1.33		
16739.00	90.590	270.240	7180.94	8517.47	-798.77	-8481.72	2.51		
16828.00	90.090	269.220	7180.41	8606.26	-799.19	-8570.71	1.28		
16918.00	89.970	269.190	7180.36	8696.10	-800.44	-8660.70	0.14		
17007.00	90.030	269.000	7180.36	8784.95	-801.84	-8749.69	0.22		
17097.00	90.090	269.000	7180.27	8874.81	-803.42	-8839.68	0.07		
17186.00	90.060	268.080	7180.15	8963.70	-805.68	-8928.65	1.03		
17276.00	89.880	268.960	7180.20	9053.60	-808.01	-9018.62	1.00		
17365.00	89.880	270.570	7180.38	9142.38	-808.37	-9107.62	1.81		
17454.00	90.710	272.280	7179.93	9230.95	-806.16	-9196.58	2.14		
17544.00	90.770	272.570	7178.76	9320.34	-802.35	-9286.49	0.33		
17634.00	90.740	271.970	7177.58	9409.76	-798.79	-9376.42	0.67		
17723.00	90.620	271.850	7176.52	9498.24	-795.82	-9465.36	0.19		
17812.00	90.680	271.510	7175.51	9586.77	-793.21	-9554.32	0.39		
17902.00	90.740	271.910	7174.40	9676.28	-790.53	-9644.27	0.45		
17991.00	90.250	273.490	7173.63	9764.63	-786.33	-9733.16	1.86		
18081.00	90.650	273.260	7172.92	9853.84	-781.04	-9823.00	0.51		
18170.00	90.400	270.750	7172.10	9942.30	-777.92	-9911.94	2.83		
18260.00	90.520	269.350	7171.38	10032.05	-777.84	-10001.93	1.56		
18350.00	90.430	269.140	7170.64	10121.88	-779.03	-10091.92	0.25		
18439.00	90.490	268.720	7169.92	10210.74	-780.69	-10180.90	0.48		
18528.00	90.310	268.720	7169.30	10299.63	-782.68	-10269.88	0.20		
18618.00	90.400	269.160	7168.74	10389.49	-784.35	-10359.86	0.50		
18707.00	90.310	269.450	7168.19	10478.32	-785.42	-10448.85	0.34		



Actual Wellpath Report

FALKEN 33N-9C-L AWP

Page 9 of 11



REFERENCE WELLPATH IDENTIFICATION

Operator	SRC ENERGY	Slot	SLOT#08 FALKEN 33N-9C-L (1799'FSL & 276'FEL, SEC.11)
Area	COLORADO	Well	FALKEN 33N-9C-L
Field	WELD COUNTY (NAD83,TRUE NORTH)	Wellbore	FALKEN 33N-9C-L AWB
Facility	SEC.11-T06N-R66W		

WELLPATH DATA (214 stations)

MD [ft]	Inclination [°]	Azimuth [°]	TVD [ft]	Vert Sect [ft]	North [ft]	East [ft]	DLS [°/100ft]	Comments
18797.00	90.340	269.250	7167.68	10568.14	-786.45	-10538.85	0.22	
18886.00	90.490	269.800	7167.04	10656.95	-787.18	-10627.84	0.64	
18970.00	90.460	267.480	7166.34	10740.84	-789.18	-10711.81	2.76	LAST BHGE MWD SURVEY (989'FSL & 312'FEL, SEC.09)
18994.00	90.460	267.480	7166.15	10764.83	-790.23	-10735.78	0.00	PROJECTION TO BIT (988'FSL & 336'FEL, SEC.09)

HOLE & CASING SECTIONS - Ref Wellbore: FALKEN 33N-9C-L AWB Ref Wellpath: FALKEN 33N-9C-L AWP

String/Diameter	Start MD [ft]	End MD [ft]	Interval [ft]	Start TVD [ft]	End TVD [ft]	Start N/S [ft]	Start E/W [ft]	End N/S [ft]	End E/W [ft]
13.5in Open Hole	25.00	1804.00	1779.00	25.00	1772.44	0.00	0.00	-155.67	250.19
9.625in Casing Surface	25.00	1804.00	1779.00	25.00	1772.44	0.00	0.00	-155.67	250.19
8.5in Open Hole	1804.00	18994.00	17190.00	1772.44	7166.15	-155.67	250.19	-790.23	-10735.78



Actual Wellpath Report

FALKEN 33N-9C-L AWP

Page 10 of 11



REFERENCE WELLPATH IDENTIFICATION			
Operator	SRC ENERGY	Slot	SLOT#08 FALKEN 33N-9C-L (1799'FSL & 276'FEL, SEC.11)
Area	COLORADO	Well	FALKEN 33N-9C-L
Field	WELD COUNTY (NAD83,TRUE NORTH)	Wellbore	FALKEN 33N-9C-L AWB
Facility	SEC.11-T06N-R66W		

TARGETS								
Name	TVD [ft]	North [ft]	East [ft]	Grid East [US ft]	Grid North [US ft]	Latitude	Longitude	Shape
SEC.10-T6N-R66W	0.00	104.92	0.83	3212478.20	1426196.25	40°30'02.869"N	104°44'09.402"W	polygon
SEC.11-T6N-R66W SOUTHERN HALF	0.00	104.92	0.83	3212478.20	1426196.25	40°30'02.869"N	104°44'09.402"W	polygon
SEC.14-T6N-R66W NORTHERN HALF	0.00	104.92	0.83	3212478.20	1426196.25	40°30'02.869"N	104°44'09.402"W	polygon
SEC.9-T6N-R66W EAST QUARTER	0.00	104.92	0.83	3212478.20	1426196.25	40°30'02.869"N	104°44'09.402"W	polygon
FALKEN 33N-9C-L TOP OF PROD ON PLAT (973'FSL & 300'FWL, SEC.12)	7125.00	-825.90	569.86	3213055.21	1425270.39	40°29'53.671"N	104°44'02.036"W	circle
FALKEN 33N-9C-L BHL ON PLAT (981'FSL & 300'FEL, SEC.09)	7153.00	-797.36	-10699.41	3201786.51	1425201.84	40°29'53.930"N	104°46'27.908"W	circle
FALKEN 33N-9C-L TOP OF PROD REV-2 (1008'FSL & 300'FWL, SEC.12)	7169.25	-790.90	569.86	3213054.91	1425305.39	40°29'54.017"N	104°44'02.036"W	circle
FALKEN 33N-9C-L BHL REV-2 (981'FSL & 300'FEL, SEC.09)	7177.08	-797.36	-10699.42	3201786.51	1425201.84	40°29'53.930"N	104°46'27.908"W	circle

WELLPATH COMPOSITION - Ref Wellbore: FALKEN 33N-9C-L AWB					Ref Wellpath: FALKEN 33N-9C-L AWP	
Start MD [ft]	End MD [ft]	Positional Uncertainty Model	Log Name/Comment	Wellbore		
25.00	1763.00	Custom BHI NaviTrak (Standard Rotating+Axial Corr) (Rockies 0.03Gt model)	13 1/2" APS EM SURVEYS <153-1763>	FALKEN 33N-9C-L AWB		
1763.00	18970.00	BHI AutoTrak Curve (IFR1, Short)	8 1/2" ATC SURVEYS <1879'-18994'>	FALKEN 33N-9C-L AWB		
18970.00	18994.00	Blind Drilling (std)	Projection to bit	FALKEN 33N-9C-L AWB		



Actual Wellpath Report

FALKEN 33N-9C-L AWP

Page 11 of 11



REFERENCE WELLPATH IDENTIFICATION

Operator	SRC ENERGY	Slot	SLOT#08 FALKEN 33N-9C-L (1799'FSL & 276'FEL, SEC.11)
Area	COLORADO	Well	FALKEN 33N-9C-L
Field	WELD COUNTY (NAD83,TRUE NORTH)	Wellbore	FALKEN 33N-9C-L AWB
Facility	SEC.11-T06N-R66W		

WELLPATH COMMENTS

MD [ft]	Inclination [°]	Azimuth [°]	TVD [ft]	Comment
7695.00	90.090	263.660	7167.15	LANDING POINT (1028'FSL & 281'FWL, SEC.12)
18970.00	90.460	267.480	7166.34	LAST BHGE MWD SURVEY (989'FSL & 312'FEL, SEC.09)
18994.00	90.460	267.480	7166.15	PROJECTION TO BIT (988'FSL & 336'FEL, SEC.09)