

SRC ENERGY

Location: COLORADO Slot: SLOT#02 FALKEN 32N-9B-L (1889'FSL & 276'FEL, SEC.11)
Field: WELD COUNTY (NAD83, TRUE NORTH) Well: FALKEN 32N-9B-L
Facility: SEC.11-T06N-R66W Wellbore: FALKEN 32N-9B-L PWB

| | |
|--|--|
| Plot reference wellpath is FALKEN 32N-9B-L (REV-C.0) PWB | Grid System: NAD83 / Lambert Colorado SP, Northern Zone (501), US feet |
| True vertical depths are referenced to PRECISION 562 (25) (RKB) | * = Wellpath was transformed from a different geodetic datum |
| Measured depths are referenced to PRECISION 562 (25) (RKB) | North Reference: True north |
| PRECISION 562 (25) (RKB) to Mean Sea Level: 4835 feet | Scale: True distance |
| Mean Sea Level to Mud line (At Slot: SLOT#02 FALKEN 32N-9B-L (1889'FSL & 276'FEL, SEC.11)): 0 feet | Depths are in feet |
| Coordinates are in feet referenced to Slot | Created by: doddanna on 2018-02-07 |
| | Database: WellArchitectDB |

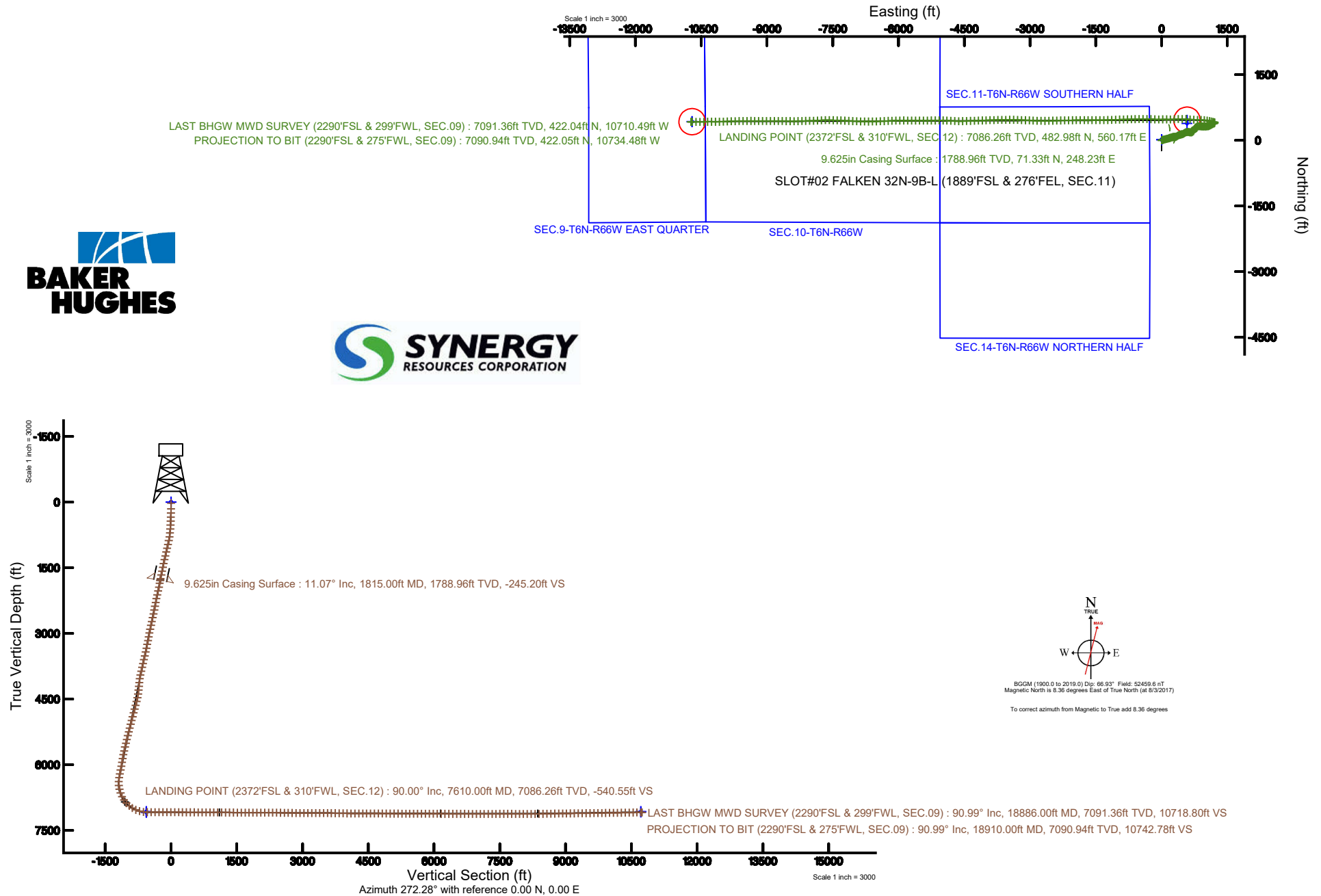



Actual Wellpath Report

FALKEN 32N-9B-L AWP

Page 1 of 11



REFERENCE WELLPATH IDENTIFICATION

| | | | |
|----------|--------------------------------|----------|--|
| Operator | SRC ENERGY | Slot | SLOT#02 FALKEN 32N-9B-L (1889'FSL & 276'FEL, SEC.11) |
| Area | COLORADO | Well | FALKEN 32N-9B-L |
| Field | WELD COUNTY (NAD83,TRUE NORTH) | Wellbore | FALKEN 32N-9B-L AWB |
| Facility | SEC.11-T06N-R66W | | |

REPORT SETUP INFORMATION

| | | | |
|---------------------|---|----------------------|---|
| Projection System | NAD83 / Lambert Colorado SP, Northern Zone (501), US feet | Software System | WellArchitect® 5.0 |
| North Reference | True | User | Doddanna |
| Scale | 0.999966 | Report Generated | 2/7/2018 at 1:02:46 PM |
| Convergence at slot | 0.49° East | Database/Source file | WellArchitectDB/FALKEN_32N-9B-L_AWP.xml |

WELLPATH LOCATION

| | Local coordinates | | Grid coordinates | | Geographic coordinates | |
|-----------------------|-------------------|----------|------------------|-----------------|------------------------|-----------------|
| | North[ft] | East[ft] | Easting[US ft] | Northing[US ft] | Latitude | Longitude |
| Slot Location | -14.94 | 0.00 | 3212478.33 | 1426181.31 | 40°30'02.722"N | 104°44'09.402"W |
| Facility Reference Pt | | | 3212478.20 | 1426196.25 | 40°30'02.869"N | 104°44'09.402"W |
| Field Reference Pt | | | 3171284.48 | 1426358.81 | 40°30'07.643"N | 104°53'02.634"W |

WELLPATH DATUM

| | | | |
|--------------------------|---------------------------|--|-------------------|
| Calculation method | Minimum curvature | PRECISION 562 (25') (RKB) to Facility Vertical Datum | 4835.00ft |
| Horizontal Reference Pt | Slot | PRECISION 562 (25') (RKB) to Mean Sea Level | 4835.00ft |
| Vertical Reference Pt | PRECISION 562 (25') (RKB) | PRECISION 562 (25') (RKB) to Mud Line at Slot (SLOT#02 FALKEN 32N-9B-L (1889'FSL & 276'FEL, SEC.11)) | 4835.00ft |
| MD Reference Pt | PRECISION 562 (25') (RKB) | Section Origin | N 0.00, E 0.00 ft |
| Field Vertical Reference | Mean Sea Level | Section Azimuth | 272.25° |



SRC ENERGY

Actual Wellpath Report

FALKEN 32N-9B-L AWP

Page 2 of 11

**BAKER
HUGHES****REFERENCE WELLPATH IDENTIFICATION**

| | | | |
|----------|--------------------------------|----------|--|
| Operator | SRC ENERGY | Slot | SLOT#02 FALKEN 32N-9B-L (1889'FSL & 276'FEL, SEC.11) |
| Area | COLORADO | Well | FALKEN 32N-9B-L |
| Field | WELD COUNTY (NAD83,TRUE NORTH) | Wellbore | FALKEN 32N-9B-L AWB |
| Facility | SEC.11-T06N-R66W | | |

WELLPATH DATA (213 stations) † = interpolated/extrapolated station

| MD [ft] | Inclination [°] | Azimuth [°] | TVD [ft] | Vert Sect [ft] | North [ft] | East [ft] | DLS [°/100ft] | Comments |
|------------|--------------------|----------------|-------------|-------------------|---------------|--------------|------------------|----------|
| 0.00† | 0.000 | 326.970 | 0.00 | 0.00 | 0.00 | 0.00 | 0.00 | |
| 25.00 | 0.000 | 326.970 | 25.00 | 0.00 | 0.00 | 0.00 | 0.00 | |
| 153.00 | 0.030 | 326.970 | 153.00 | 0.02 | 0.03 | -0.02 | 0.02 | |
| 247.00 | 0.580 | 79.090 | 247.00 | -0.43 | 0.14 | 0.44 | 0.63 | |
| 342.00 | 1.750 | 87.420 | 341.98 | -2.34 | 0.30 | 2.36 | 1.24 | |
| 436.00 | 2.760 | 69.750 | 435.90 | -5.86 | 1.14 | 5.91 | 1.29 | |
| 526.00 | 3.230 | 66.260 | 525.78 | -10.15 | 2.91 | 10.27 | 0.56 | |
| 614.00 | 4.330 | 67.930 | 613.59 | -15.40 | 5.16 | 15.62 | 1.26 | |
| 704.00 | 6.420 | 68.830 | 703.19 | -23.12 | 8.25 | 23.46 | 2.32 | |
| 793.00 | 9.390 | 70.640 | 791.33 | -34.43 | 12.46 | 34.95 | 3.35 | |
| 883.00 | 11.790 | 75.020 | 879.79 | -50.04 | 17.27 | 50.76 | 2.81 | |
| 972.00 | 13.180 | 76.090 | 966.69 | -68.47 | 22.06 | 69.39 | 1.58 | |
| 1061.00 | 13.440 | 76.710 | 1053.30 | -88.19 | 26.88 | 89.31 | 0.33 | |
| 1151.00 | 13.580 | 75.710 | 1140.81 | -108.39 | 31.89 | 109.73 | 0.30 | |
| 1240.00 | 13.150 | 75.020 | 1227.40 | -128.08 | 37.09 | 129.63 | 0.52 | |
| 1330.00 | 13.060 | 74.360 | 1315.05 | -147.53 | 42.47 | 149.32 | 0.19 | |
| 1419.00 | 12.710 | 73.280 | 1401.81 | -166.36 | 48.00 | 168.38 | 0.48 | |
| 1509.00 | 12.290 | 73.410 | 1489.68 | -184.79 | 53.58 | 187.04 | 0.47 | |
| 1598.00 | 12.580 | 74.050 | 1576.59 | -202.96 | 58.95 | 205.44 | 0.36 | |
| 1688.00 | 12.050 | 73.440 | 1664.52 | -221.16 | 64.32 | 223.86 | 0.61 | |
| 1774.00 | 11.300 | 74.290 | 1748.74 | -237.68 | 69.16 | 240.58 | 0.89 | |
| 1883.00 | 10.680 | 73.510 | 1855.74 | -257.40 | 74.92 | 260.54 | 0.58 | |
| 1973.00 | 11.010 | 84.290 | 1944.14 | -273.81 | 78.14 | 277.09 | 2.28 | |
| 2062.00 | 12.880 | 93.480 | 2031.22 | -292.15 | 78.39 | 295.46 | 2.99 | |
| 2152.00 | 13.040 | 84.480 | 2118.93 | -312.24 | 78.76 | 315.58 | 2.25 | |
| 2241.00 | 13.410 | 66.970 | 2205.61 | -331.53 | 83.76 | 335.08 | 4.50 | |
| 2330.00 | 13.970 | 53.040 | 2292.10 | -349.19 | 94.26 | 353.16 | 3.75 | |
| 2420.00 | 12.550 | 52.700 | 2379.70 | -365.14 | 106.72 | 369.62 | 1.58 | |
| 2509.00 | 11.850 | 64.180 | 2466.70 | -380.67 | 116.56 | 385.54 | 2.83 | |
| 2599.00 | 12.890 | 75.920 | 2554.63 | -398.46 | 123.03 | 403.60 | 3.02 | |



SRC ENERGY

Actual Wellpath Report

FALKEN 32N-9B-L AWP

Page 3 of 11

**BAKER
HUGHES****REFERENCE WELLPATH IDENTIFICATION**

| | | | |
|----------|--------------------------------|----------|--|
| Operator | SRC ENERGY | Slot | SLOT#02 FALKEN 32N-9B-L (1889'FSL & 276'FEL, SEC.11) |
| Area | COLORADO | Well | FALKEN 32N-9B-L |
| Field | WELD COUNTY (NAD83,TRUE NORTH) | Wellbore | FALKEN 32N-9B-L AWB |
| Facility | SEC.11-T06N-R66W | | |

WELLPATH DATA (213 stations)

| MD [ft] | Inclination [°] | Azimuth [°] | TVD [ft] | Vert Sect [ft] | North [ft] | East [ft] | DLS [°/100ft] | Comments |
|------------|--------------------|----------------|-------------|-------------------|---------------|--------------|------------------|----------|
| 2688.00 | 12.900 | 72.250 | 2641.38 | -417.32 | 128.47 | 422.69 | 0.92 | |
| 2778.00 | 12.720 | 75.900 | 2729.15 | -436.27 | 133.95 | 441.87 | 0.92 | |
| 2867.00 | 12.720 | 79.770 | 2815.96 | -455.24 | 138.08 | 461.02 | 0.96 | |
| 2956.00 | 13.210 | 76.870 | 2902.70 | -474.61 | 142.13 | 480.56 | 0.92 | |
| 3046.00 | 13.200 | 59.460 | 2990.35 | -493.17 | 149.69 | 499.44 | 4.40 | |
| 3135.00 | 11.910 | 50.500 | 3077.23 | -508.56 | 160.69 | 515.28 | 2.62 | |
| 3224.00 | 13.000 | 63.190 | 3164.15 | -524.17 | 171.05 | 531.30 | 3.30 | |
| 3314.00 | 12.410 | 65.790 | 3251.95 | -541.68 | 179.58 | 549.16 | 0.91 | |
| 3404.00 | 10.970 | 73.150 | 3340.08 | -558.43 | 186.03 | 566.17 | 2.30 | |
| 3493.00 | 12.520 | 87.160 | 3427.23 | -576.04 | 188.97 | 583.92 | 3.63 | |
| 3583.00 | 13.020 | 92.180 | 3515.01 | -595.90 | 189.06 | 603.79 | 1.35 | |
| 3672.00 | 13.080 | 99.830 | 3601.72 | -615.91 | 186.96 | 623.73 | 1.94 | |
| 3762.00 | 13.180 | 101.540 | 3689.37 | -636.13 | 183.17 | 643.82 | 0.45 | |
| 3851.00 | 13.630 | 92.740 | 3775.95 | -656.63 | 180.64 | 664.24 | 2.34 | |
| 3941.00 | 14.190 | 77.950 | 3863.34 | -677.93 | 182.44 | 685.63 | 3.99 | |
| 4030.00 | 14.670 | 58.530 | 3949.58 | -697.89 | 190.60 | 705.92 | 5.44 | |
| 4120.00 | 14.860 | 37.380 | 4036.67 | -714.02 | 205.73 | 722.66 | 5.96 | |
| 4209.00 | 13.290 | 18.150 | 4123.05 | -723.39 | 224.53 | 732.78 | 5.51 | |
| 4299.00 | 13.330 | 24.810 | 4210.63 | -730.21 | 243.78 | 740.36 | 1.70 | |
| 4388.00 | 14.270 | 31.050 | 4297.07 | -739.43 | 262.49 | 750.32 | 1.98 | |
| 4478.00 | 13.010 | 35.440 | 4384.53 | -750.32 | 280.25 | 761.92 | 1.81 | |
| 4567.00 | 15.330 | 50.840 | 4470.85 | -764.63 | 295.85 | 776.85 | 4.95 | |
| 4657.00 | 14.990 | 68.840 | 4557.76 | -784.25 | 307.57 | 796.94 | 5.22 | |
| 4746.00 | 15.360 | 75.780 | 4643.67 | -806.11 | 314.62 | 819.11 | 2.08 | |
| 4836.00 | 15.170 | 79.800 | 4730.49 | -829.04 | 319.64 | 842.25 | 1.19 | |
| 4925.00 | 15.410 | 92.400 | 4816.37 | -852.25 | 321.20 | 865.53 | 3.74 | |
| 5015.00 | 13.740 | 94.020 | 4903.47 | -874.89 | 319.95 | 888.14 | 1.91 | |
| 5104.00 | 14.570 | 98.950 | 4989.77 | -896.57 | 317.47 | 909.75 | 1.64 | |
| 5194.00 | 14.590 | 93.490 | 5076.88 | -919.15 | 315.02 | 932.24 | 1.53 | |
| 5283.00 | 14.130 | 83.550 | 5163.11 | -941.10 | 315.56 | 954.23 | 2.81 | |



SRC ENERGY

Actual Wellpath Report

FALKEN 32N-9B-L AWP

Page 4 of 11

**BAKER
HUGHES****REFERENCE WELLPATH IDENTIFICATION**

| | | | |
|----------|--------------------------------|----------|--|
| Operator | SRC ENERGY | Slot | SLOT#02 FALKEN 32N-9B-L (1889'FSL & 276'FEL, SEC.11) |
| Area | COLORADO | Well | FALKEN 32N-9B-L |
| Field | WELD COUNTY (NAD83,TRUE NORTH) | Wellbore | FALKEN 32N-9B-L AWB |
| Facility | SEC.11-T06N-R66W | | |

WELLPATH DATA (213 stations)

| MD [ft] | Inclination [°] | Azimuth [°] | TVD [ft] | Vert Sect [ft] | North [ft] | East [ft] | DLS [°/100ft] | Comments |
|------------|--------------------|----------------|-------------|-------------------|---------------|--------------|------------------|--|
| 5373.00 | 14.240 | 92.400 | 5250.37 | -963.03 | 316.33 | 976.21 | 2.41 | |
| 5462.00 | 14.400 | 92.070 | 5336.61 | -985.04 | 315.47 | 998.21 | 0.20 | |
| 5552.00 | 14.290 | 83.880 | 5423.81 | -1007.22 | 316.25 | 1020.44 | 2.26 | |
| 5641.00 | 13.970 | 80.940 | 5510.12 | -1028.63 | 319.11 | 1041.97 | 0.88 | |
| 5731.00 | 12.860 | 75.720 | 5597.67 | -1048.88 | 323.29 | 1062.40 | 1.82 | |
| 5820.00 | 12.700 | 71.310 | 5684.46 | -1067.51 | 328.87 | 1081.27 | 1.11 | |
| 5910.00 | 12.770 | 63.110 | 5772.26 | -1085.44 | 336.54 | 1099.51 | 2.01 | |
| 6000.00 | 12.840 | 59.340 | 5860.02 | -1102.53 | 346.14 | 1116.99 | 0.93 | |
| 6089.00 | 11.460 | 54.460 | 5947.03 | -1117.82 | 356.32 | 1132.69 | 1.93 | |
| 6178.00 | 11.810 | 61.680 | 6034.20 | -1132.65 | 365.78 | 1147.90 | 1.68 | |
| 6268.00 | 11.560 | 67.580 | 6122.34 | -1148.77 | 373.59 | 1164.35 | 1.36 | |
| 6357.00 | 11.890 | 67.340 | 6209.48 | -1165.19 | 380.52 | 1181.05 | 0.37 | |
| 6447.00 | 11.860 | 64.540 | 6297.56 | -1181.79 | 388.07 | 1197.96 | 0.64 | |
| 6536.00 | 8.770 | 22.150 | 6385.23 | -1192.21 | 398.30 | 1208.79 | 8.95 | |
| 6626.00 | 10.030 | 319.860 | 6474.23 | -1189.25 | 410.68 | 1206.32 | 10.84 | |
| 6715.00 | 13.000 | 275.440 | 6561.59 | -1174.00 | 417.57 | 1191.33 | 10.21 | |
| 6805.00 | 18.620 | 281.170 | 6648.16 | -1149.68 | 421.32 | 1167.13 | 6.47 | |
| 6895.00 | 25.650 | 285.450 | 6731.48 | -1116.48 | 429.30 | 1134.22 | 8.01 | |
| 6984.00 | 33.960 | 283.510 | 6808.64 | -1073.26 | 440.26 | 1091.40 | 9.40 | |
| 7073.00 | 42.760 | 278.560 | 6878.37 | -1018.74 | 450.58 | 1037.24 | 10.47 | |
| 7163.00 | 50.790 | 275.790 | 6939.97 | -953.45 | 458.66 | 972.22 | 9.20 | |
| 7252.00 | 58.260 | 272.110 | 6991.59 | -881.08 | 463.54 | 899.98 | 9.04 | |
| 7342.00 | 66.640 | 271.470 | 7033.18 | -801.36 | 466.02 | 820.30 | 9.33 | |
| 7431.00 | 74.230 | 274.210 | 7062.97 | -717.57 | 470.21 | 736.61 | 9.01 | |
| 7521.00 | 82.930 | 274.640 | 7080.77 | -629.50 | 477.02 | 648.74 | 9.68 | |
| 7610.00 | 90.000 | 273.060 | 7086.26 | -540.76 | 482.98 | 560.17 | 8.14 | LANDING POINT (2372'FSL & 310'FWL, SEC.12) |
| 7700.00 | 89.970 | 270.690 | 7086.28 | -450.77 | 485.92 | 470.22 | 2.63 | |
| 7789.00 | 89.880 | 267.660 | 7086.40 | -361.91 | 484.64 | 381.24 | 3.41 | |
| 7879.00 | 90.090 | 265.650 | 7086.42 | -272.34 | 479.39 | 291.40 | 2.25 | |
| 7968.00 | 89.720 | 270.080 | 7086.57 | -183.63 | 476.07 | 202.49 | 4.99 | |



SRC ENERGY

Actual Wellpath Report

FALKEN 32N-9B-L AWP

Page 5 of 11

**BAKER
HUGHES****REFERENCE WELLPATH IDENTIFICATION**

| | | | |
|----------|--------------------------------|----------|--|
| Operator | SRC ENERGY | Slot | SLOT#02 FALKEN 32N-9B-L (1889'FSL & 276'FEL, SEC.11) |
| Area | COLORADO | Well | FALKEN 32N-9B-L |
| Field | WELD COUNTY (NAD83,TRUE NORTH) | Wellbore | FALKEN 32N-9B-L AWB |
| Facility | SEC.11-T06N-R66W | | |

WELLPATH DATA (213 stations)

| MD [ft] | Inclination [°] | Azimuth [°] | TVD [ft] | Vert Sect [ft] | North [ft] | East [ft] | DLS [°/100ft] | Comments |
|------------|--------------------|----------------|-------------|-------------------|---------------|--------------|------------------|----------|
| 8057.00 | 89.750 | 272.910 | 7086.98 | -94.64 | 478.39 | 113.53 | 3.18 | |
| 8147.00 | 89.780 | 266.610 | 7087.35 | -4.78 | 478.02 | 23.57 | 7.00 | |
| 8236.00 | 89.780 | 269.370 | 7087.69 | 83.97 | 474.90 | -65.36 | 3.10 | |
| 8326.00 | 89.780 | 274.230 | 7088.04 | 173.94 | 477.72 | -155.29 | 5.40 | |
| 8415.00 | 89.660 | 273.640 | 7088.47 | 262.90 | 483.83 | -244.08 | 0.68 | |
| 8505.00 | 89.820 | 270.730 | 7088.88 | 352.89 | 487.26 | -334.00 | 3.24 | |
| 8594.00 | 89.850 | 269.750 | 7089.14 | 441.83 | 487.63 | -423.00 | 1.10 | |
| 8683.00 | 89.720 | 268.250 | 7089.47 | 530.68 | 486.08 | -511.98 | 1.69 | |
| 8773.00 | 89.630 | 268.300 | 7089.98 | 620.47 | 483.37 | -601.94 | 0.11 | |
| 8862.00 | 89.750 | 268.030 | 7090.47 | 709.24 | 480.52 | -690.89 | 0.33 | |
| 8952.00 | 89.720 | 268.850 | 7090.88 | 799.04 | 478.07 | -780.86 | 0.91 | |
| 9041.00 | 89.780 | 268.360 | 7091.27 | 887.86 | 475.90 | -869.83 | 0.55 | |
| 9131.00 | 89.690 | 268.110 | 7091.69 | 977.63 | 473.13 | -959.79 | 0.30 | |
| 9220.00 | 89.720 | 268.530 | 7092.14 | 1066.42 | 470.52 | -1048.75 | 0.47 | |
| 9310.00 | 89.630 | 267.760 | 7092.65 | 1156.19 | 467.61 | -1138.70 | 0.86 | |
| 9399.00 | 89.660 | 267.560 | 7093.21 | 1244.90 | 463.98 | -1227.62 | 0.23 | |
| 9489.00 | 89.720 | 268.610 | 7093.69 | 1334.66 | 460.97 | -1317.57 | 1.17 | |
| 9578.00 | 89.750 | 269.890 | 7094.10 | 1423.54 | 459.80 | -1406.56 | 1.44 | |
| 9668.00 | 89.600 | 270.080 | 7094.62 | 1513.47 | 459.78 | -1496.56 | 0.27 | |
| 9757.00 | 89.820 | 270.580 | 7095.07 | 1602.41 | 460.29 | -1585.56 | 0.61 | |
| 9847.00 | 89.820 | 269.780 | 7095.35 | 1692.35 | 460.58 | -1675.55 | 0.89 | |
| 9936.00 | 89.970 | 270.310 | 7095.51 | 1781.29 | 460.65 | -1764.55 | 0.62 | |
| 10026.00 | 89.540 | 269.620 | 7095.90 | 1871.21 | 460.59 | -1854.55 | 0.90 | |
| 10116.00 | 89.940 | 269.210 | 7096.30 | 1961.10 | 459.67 | -1944.55 | 0.64 | |
| 10205.00 | 89.820 | 268.910 | 7096.49 | 2049.97 | 458.21 | -2033.53 | 0.36 | |
| 10294.00 | 89.780 | 268.990 | 7096.80 | 2138.82 | 456.58 | -2122.52 | 0.10 | |
| 10384.00 | 89.880 | 268.740 | 7097.07 | 2228.66 | 454.80 | -2212.50 | 0.30 | |
| 10473.00 | 89.780 | 268.810 | 7097.33 | 2317.49 | 452.90 | -2301.48 | 0.14 | |
| 10563.00 | 89.450 | 268.350 | 7097.94 | 2407.31 | 450.67 | -2391.45 | 0.63 | |
| 10652.00 | 89.050 | 267.870 | 7099.10 | 2496.07 | 447.73 | -2480.39 | 0.70 | |



SRC ENERGY

Actual Wellpath Report

FALKEN 32N-9B-L AWP

Page 6 of 11

**BAKER
HUGHES****REFERENCE WELLPATH IDENTIFICATION**

| | | | |
|----------|--------------------------------|----------|--|
| Operator | SRC ENERGY | Slot | SLOT#02 FALKEN 32N-9B-L (1889'FSL & 276'FEL, SEC.11) |
| Area | COLORADO | Well | FALKEN 32N-9B-L |
| Field | WELD COUNTY (NAD83,TRUE NORTH) | Wellbore | FALKEN 32N-9B-L AWB |
| Facility | SEC.11-T06N-R66W | | |

WELLPATH DATA (213 stations)

| MD [ft] | Inclination [°] | Azimuth [°] | TVD [ft] | Vert Sect [ft] | North [ft] | East [ft] | DLS [°/100ft] | Comments |
|------------|--------------------|----------------|-------------|-------------------|---------------|--------------|------------------|----------|
| 10742.00 | 89.140 | 268.270 | 7100.52 | 2585.82 | 444.70 | -2570.33 | 0.46 | |
| 10831.00 | 88.980 | 269.910 | 7101.98 | 2674.67 | 443.29 | -2659.30 | 1.85 | |
| 10921.00 | 89.110 | 271.230 | 7103.48 | 2764.61 | 444.18 | -2749.28 | 1.47 | |
| 11010.00 | 89.050 | 271.720 | 7104.91 | 2853.59 | 446.47 | -2838.24 | 0.55 | |
| 11100.00 | 89.940 | 272.870 | 7105.71 | 2943.59 | 450.08 | -2928.17 | 1.62 | |
| 11189.00 | 89.940 | 273.190 | 7105.80 | 3032.58 | 454.78 | -3017.04 | 0.36 | |
| 11279.00 | 89.880 | 271.840 | 7105.94 | 3122.58 | 458.73 | -3106.95 | 1.50 | |
| 11368.00 | 89.690 | 271.980 | 7106.28 | 3211.57 | 461.70 | -3195.90 | 0.27 | |
| 11457.00 | 89.850 | 272.260 | 7106.63 | 3300.57 | 464.99 | -3284.84 | 0.36 | |
| 11547.00 | 89.820 | 271.220 | 7106.89 | 3390.57 | 467.72 | -3374.80 | 1.16 | |
| 11636.00 | 89.570 | 269.200 | 7107.37 | 3479.50 | 468.05 | -3463.79 | 2.29 | |
| 11726.00 | 89.690 | 269.080 | 7107.95 | 3569.37 | 466.70 | -3553.78 | 0.19 | |
| 11815.00 | 89.750 | 269.540 | 7108.38 | 3658.25 | 465.62 | -3642.77 | 0.52 | |
| 11905.00 | 89.020 | 269.000 | 7109.35 | 3748.12 | 464.48 | -3732.76 | 1.01 | |
| 11995.00 | 89.080 | 268.590 | 7110.84 | 3837.95 | 462.59 | -3822.72 | 0.46 | |
| 12084.00 | 89.080 | 268.100 | 7112.27 | 3926.73 | 460.02 | -3911.68 | 0.55 | |
| 12174.00 | 89.170 | 268.000 | 7113.64 | 4016.48 | 456.95 | -4001.61 | 0.15 | |
| 12263.00 | 88.980 | 267.400 | 7115.08 | 4105.18 | 453.38 | -4090.53 | 0.71 | |
| 12353.00 | 89.850 | 267.600 | 7116.00 | 4194.87 | 449.46 | -4180.44 | 0.99 | |
| 12442.00 | 89.880 | 268.330 | 7116.21 | 4283.62 | 446.30 | -4269.38 | 0.82 | |
| 12532.00 | 90.030 | 268.120 | 7116.28 | 4373.40 | 443.51 | -4359.34 | 0.29 | |
| 12621.00 | 89.970 | 268.300 | 7116.28 | 4462.18 | 440.73 | -4448.29 | 0.21 | |
| 12711.00 | 89.970 | 268.140 | 7116.33 | 4551.95 | 437.93 | -4538.25 | 0.18 | |
| 12800.00 | 89.570 | 270.230 | 7116.68 | 4640.82 | 436.67 | -4627.24 | 2.39 | |
| 12890.00 | 89.690 | 273.560 | 7117.27 | 4730.80 | 439.64 | -4717.17 | 3.70 | |
| 12979.00 | 89.690 | 274.430 | 7117.75 | 4819.76 | 445.84 | -4805.95 | 0.98 | |
| 13069.00 | 89.820 | 272.190 | 7118.13 | 4909.74 | 451.04 | -4895.80 | 2.49 | |
| 13158.00 | 89.600 | 270.940 | 7118.58 | 4998.73 | 453.47 | -4984.76 | 1.43 | |
| 13248.00 | 89.780 | 270.110 | 7119.07 | 5088.69 | 454.29 | -5074.76 | 0.94 | |
| 13337.00 | 89.720 | 269.620 | 7119.46 | 5177.61 | 454.09 | -5163.75 | 0.55 | |



SRC ENERGY

Actual Wellpath Report

FALKEN 32N-9B-L AWP

Page 7 of 11

**BAKER
HUGHES****REFERENCE WELLPATH IDENTIFICATION**

| | | | |
|----------|--------------------------------|----------|--|
| Operator | SRC ENERGY | Slot | SLOT#02 FALKEN 32N-9B-L (1889'FSL & 276'FEL, SEC.11) |
| Area | COLORADO | Well | FALKEN 32N-9B-L |
| Field | WELD COUNTY (NAD83,TRUE NORTH) | Wellbore | FALKEN 32N-9B-L AWB |
| Facility | SEC.11-T06N-R66W | | |

WELLPATH DATA (213 stations)

| MD [ft] | Inclination [°] | Azimuth [°] | TVD [ft] | Vert Sect [ft] | North [ft] | East [ft] | DLS [°/100ft] | Comments |
|------------|--------------------|----------------|-------------|-------------------|---------------|--------------|------------------|----------|
| 13427.00 | 89.660 | 269.480 | 7119.94 | 5267.51 | 453.38 | -5253.75 | 0.17 | |
| 13517.00 | 89.720 | 269.620 | 7120.43 | 5357.40 | 452.67 | -5343.75 | 0.17 | |
| 13606.00 | 89.540 | 269.430 | 7121.01 | 5446.30 | 451.93 | -5432.74 | 0.29 | |
| 13696.00 | 89.660 | 269.470 | 7121.63 | 5536.19 | 451.07 | -5522.73 | 0.14 | |
| 13785.00 | 89.910 | 270.220 | 7121.97 | 5625.11 | 450.83 | -5611.73 | 0.89 | |
| 13874.00 | 89.850 | 270.470 | 7122.15 | 5714.06 | 451.36 | -5700.73 | 0.29 | |
| 13964.00 | 89.880 | 270.870 | 7122.37 | 5804.03 | 452.42 | -5790.72 | 0.45 | |
| 14053.00 | 89.820 | 270.010 | 7122.60 | 5892.98 | 453.10 | -5879.72 | 0.97 | |
| 14143.00 | 89.820 | 269.200 | 7122.88 | 5982.88 | 452.48 | -5969.72 | 0.90 | |
| 14232.00 | 90.030 | 268.260 | 7123.00 | 6071.72 | 450.51 | -6058.69 | 1.08 | |
| 14322.00 | 89.720 | 267.290 | 7123.20 | 6161.44 | 447.01 | -6148.62 | 1.13 | |
| 14411.00 | 89.820 | 267.340 | 7123.55 | 6250.11 | 442.84 | -6237.53 | 0.13 | |
| 14501.00 | 89.690 | 266.920 | 7123.94 | 6339.75 | 438.34 | -6327.41 | 0.49 | |
| 14590.00 | 90.060 | 268.200 | 7124.13 | 6428.45 | 434.55 | -6416.33 | 1.50 | |
| 14680.00 | 89.970 | 268.600 | 7124.11 | 6518.24 | 432.04 | -6506.29 | 0.46 | |
| 14769.00 | 89.780 | 268.720 | 7124.30 | 6607.07 | 429.96 | -6595.27 | 0.25 | |
| 14859.00 | 89.910 | 269.570 | 7124.55 | 6696.94 | 428.61 | -6685.26 | 0.96 | |
| 14948.00 | 89.910 | 271.500 | 7124.69 | 6785.89 | 429.44 | -6774.25 | 2.17 | |
| 15038.00 | 89.880 | 271.600 | 7124.85 | 6875.88 | 431.88 | -6864.22 | 0.12 | |
| 15127.00 | 89.940 | 272.220 | 7124.99 | 6964.88 | 434.84 | -6953.17 | 0.70 | |
| 15217.00 | 90.060 | 273.060 | 7124.99 | 7054.88 | 438.99 | -7043.07 | 0.94 | |
| 15306.00 | 90.030 | 272.980 | 7124.92 | 7143.87 | 443.68 | -7131.95 | 0.10 | |
| 15396.00 | 90.060 | 273.040 | 7124.85 | 7233.86 | 448.40 | -7221.82 | 0.07 | |
| 15486.00 | 90.030 | 272.440 | 7124.78 | 7323.86 | 452.71 | -7311.72 | 0.67 | |
| 15575.00 | 90.150 | 271.530 | 7124.64 | 7412.86 | 455.79 | -7400.67 | 1.03 | |
| 15664.00 | 90.120 | 271.520 | 7124.43 | 7501.85 | 458.16 | -7489.63 | 0.04 | |
| 15754.00 | 90.060 | 271.140 | 7124.29 | 7591.84 | 460.25 | -7579.61 | 0.43 | |
| 15843.00 | 89.970 | 269.160 | 7124.26 | 7680.77 | 460.48 | -7668.60 | 2.23 | |
| 15933.00 | 89.780 | 266.730 | 7124.46 | 7770.51 | 457.25 | -7758.54 | 2.71 | |
| 16022.00 | 89.820 | 266.560 | 7124.77 | 7859.09 | 452.04 | -7847.39 | 0.20 | |



SRC ENERGY

Actual Wellpath Report

FALKEN 32N-9B-L AWP

Page 8 of 11

**BAKER
HUGHES****REFERENCE WELLPATH IDENTIFICATION**

| | | | |
|----------|--------------------------------|----------|--|
| Operator | SRC ENERGY | Slot | SLOT#02 FALKEN 32N-9B-L (1889'FSL & 276'FEL, SEC.11) |
| Area | COLORADO | Well | FALKEN 32N-9B-L |
| Field | WELD COUNTY (NAD83,TRUE NORTH) | Wellbore | FALKEN 32N-9B-L AWB |
| Facility | SEC.11-T06N-R66W | | |

WELLPATH DATA (213 stations)

| MD [ft] | Inclination [°] | Azimuth [°] | TVD [ft] | Vert Sect [ft] | North [ft] | East [ft] | DLS [°/100ft] | Comments |
|------------|--------------------|----------------|-------------|-------------------|---------------|--------------|------------------|----------|
| 16112.00 | 89.820 | 267.830 | 7125.05 | 7948.73 | 447.64 | -7937.28 | 1.41 | |
| 16201.00 | 89.880 | 268.860 | 7125.29 | 8037.53 | 445.07 | -8026.24 | 1.16 | |
| 16291.00 | 89.910 | 268.960 | 7125.45 | 8127.37 | 443.36 | -8116.22 | 0.12 | |
| 16380.00 | 90.030 | 268.400 | 7125.50 | 8216.20 | 441.31 | -8205.20 | 0.64 | |
| 16470.00 | 89.880 | 268.400 | 7125.57 | 8306.00 | 438.79 | -8295.16 | 0.17 | |
| 16559.00 | 91.050 | 270.030 | 7124.85 | 8394.86 | 437.58 | -8384.15 | 2.25 | |
| 16649.00 | 90.980 | 270.440 | 7123.25 | 8484.79 | 437.94 | -8474.13 | 0.46 | |
| 16738.00 | 90.860 | 270.940 | 7121.82 | 8573.75 | 439.02 | -8563.11 | 0.58 | |
| 16828.00 | 90.950 | 271.400 | 7120.40 | 8663.72 | 440.85 | -8653.08 | 0.52 | |
| 16917.00 | 90.980 | 270.530 | 7118.90 | 8752.69 | 442.35 | -8742.06 | 0.98 | |
| 17007.00 | 90.920 | 269.170 | 7117.41 | 8842.59 | 442.12 | -8832.04 | 1.51 | |
| 17096.00 | 90.680 | 269.560 | 7116.17 | 8931.47 | 441.13 | -8921.03 | 0.51 | |
| 17185.00 | 90.580 | 269.970 | 7115.19 | 9020.38 | 440.77 | -9010.02 | 0.47 | |
| 17275.00 | 90.650 | 270.200 | 7114.22 | 9110.31 | 440.90 | -9100.02 | 0.27 | |
| 17364.00 | 90.740 | 270.650 | 7113.14 | 9199.26 | 441.56 | -9189.01 | 0.52 | |
| 17454.00 | 90.860 | 270.630 | 7111.89 | 9289.22 | 442.56 | -9278.99 | 0.14 | |
| 17543.00 | 90.770 | 269.850 | 7110.62 | 9378.15 | 442.94 | -9367.98 | 0.88 | |
| 17633.00 | 90.650 | 269.480 | 7109.51 | 9468.05 | 442.41 | -9457.97 | 0.43 | |
| 17723.00 | 90.770 | 269.120 | 7108.39 | 9557.93 | 441.31 | -9547.96 | 0.42 | |
| 17812.00 | 90.710 | 269.050 | 7107.24 | 9646.78 | 439.89 | -9636.94 | 0.10 | |
| 17901.00 | 90.710 | 268.090 | 7106.14 | 9735.59 | 437.67 | -9725.90 | 1.08 | |
| 17991.00 | 90.770 | 268.400 | 7104.98 | 9825.36 | 434.91 | -9815.85 | 0.35 | |
| 18080.00 | 90.740 | 267.770 | 7103.80 | 9914.12 | 431.94 | -9904.80 | 0.71 | |
| 18170.00 | 90.460 | 266.490 | 7102.86 | 10003.75 | 427.43 | -9994.68 | 1.46 | |
| 18260.00 | 91.110 | 268.890 | 7101.63 | 10093.45 | 423.81 | -10084.59 | 2.76 | |
| 18349.00 | 90.950 | 270.180 | 7100.03 | 10182.34 | 423.08 | -10173.57 | 1.46 | |
| 18438.00 | 90.920 | 270.620 | 7098.58 | 10271.28 | 423.71 | -10262.56 | 0.50 | |
| 18528.00 | 90.860 | 269.240 | 7097.18 | 10361.19 | 423.60 | -10352.54 | 1.53 | |
| 18617.00 | 90.950 | 269.390 | 7095.77 | 10450.06 | 422.53 | -10441.52 | 0.20 | |
| 18707.00 | 90.800 | 270.110 | 7094.40 | 10539.97 | 422.14 | -10531.51 | 0.82 | |



SRC ENERGY

Actual Wellpath Report

FALKEN 32N-9B-L AWP

Page 9 of 11

**BAKER
HUGHES****REFERENCE WELLPATH IDENTIFICATION**

| | | | |
|----------|--------------------------------|----------|--|
| Operator | SRC ENERGY | Slot | SLOT#02 FALKEN 32N-9B-L (1889'FSL & 276'FEL, SEC.11) |
| Area | COLORADO | Well | FALKEN 32N-9B-L |
| Field | WELD COUNTY (NAD83,TRUE NORTH) | Wellbore | FALKEN 32N-9B-L AWB |
| Facility | SEC.11-T06N-R66W | | |

WELLPATH DATA (213 stations)

| MD [ft] | Inclination [°] | Azimuth [°] | TVD [ft] | Vert Sect [ft] | North [ft] | East [ft] | DLS [°/100ft] | Comments |
|------------|--------------------|----------------|-------------|-------------------|---------------|--------------|------------------|---|
| 18796.00 | 91.050 | 269.870 | 7092.96 | 10628.89 | 422.12 | -10620.50 | 0.39 | |
| 18886.00 | 90.990 | 270.020 | 7091.36 | 10718.80 | 422.04 | -10710.49 | 0.18 | LAST BHGW MWD SURVEY (2290'FSL & 299'FWL, SEC.09) |
| 18910.00 | 90.990 | 270.020 | 7090.94 | 10742.78 | 422.05 | -10734.48 | 0.00 | PROJECTION TO BIT (2290'FSL & 275'FWL, SEC.09) |

HOLE & CASING SECTIONS - Ref Wellbore: FALKEN 32N-9B-L AWB Ref Wellpath: FALKEN 32N-9B-L AWP

| String/Diameter | Start MD [ft] | End MD [ft] | Interval [ft] | Start TVD [ft] | End TVD [ft] | Start N/S [ft] | Start E/W [ft] | End N/S [ft] | End E/W [ft] |
|------------------------|------------------|----------------|------------------|-------------------|-----------------|-------------------|-------------------|-----------------|-----------------|
| 13.5in Open Hole | 25.00 | 1815.00 | 1790.00 | 25.00 | 1788.96 | 0.00 | 0.00 | 71.33 | 248.23 |
| 9.625in Casing Surface | 25.00 | 1815.00 | 1790.00 | 25.00 | 1788.96 | 0.00 | 0.00 | 71.33 | 248.23 |
| 8.5in Open Hole | 1815.00 | 18910.00 | 17095.00 | 1788.96 | 7090.94 | 71.33 | 248.23 | 422.05 | -10734.48 |



Actual Wellpath Report

FALKEN 32N-9B-L AWP

Page 10 of 11



REFERENCE WELLPATH IDENTIFICATION

| | | | |
|----------|--------------------------------|----------|--|
| Operator | SRC ENERGY | Slot | SLOT#02 FALKEN 32N-9B-L (1889'FSL & 276'FEL, SEC.11) |
| Area | COLORADO | Well | FALKEN 32N-9B-L |
| Field | WELD COUNTY (NAD83,TRUE NORTH) | Wellbore | FALKEN 32N-9B-L AWB |
| Facility | SEC.11-T06N-R66W | | |

TARGETS

| Name | TVD [ft] | North [ft] | East [ft] | Grid East [US ft] | Grid North [US ft] | Latitude | Longitude | Shape |
|--|-------------|---------------|--------------|----------------------|-----------------------|----------------|-----------------|---------|
| SEC.10-T6N-R66W | 0.00 | 14.94 | 0.00 | 3212478.20 | 1426196.25 | 40°30'02.869"N | 104°44'09.402"W | polygon |
| SEC.11-T6N-R66W SOUTHERN HALF | 0.00 | 14.94 | 0.00 | 3212478.20 | 1426196.25 | 40°30'02.869"N | 104°44'09.402"W | polygon |
| SEC.14-T6N-R66W NORTHERN HALF | 0.00 | 14.94 | 0.00 | 3212478.20 | 1426196.25 | 40°30'02.869"N | 104°44'09.402"W | polygon |
| SEC.9-T6N-R66W EAST QUARTER | 0.00 | 14.94 | 0.00 | 3212478.20 | 1426196.25 | 40°30'02.869"N | 104°44'09.402"W | polygon |
| FALKEN 32N-9B-L TOP OF PROD ON PLAT (2276'FSL & 300'FWL, SEC.12) | 7070.00 | 387.28 | 578.73 | 3213053.68 | 1426573.55 | 40°30'06.548"N | 104°44'01.910"W | point |
| FALKEN 32N-9B-L BHL ON PLAT (2294'FSL & 300'FWL, SEC.09) | 7071.00 | 425.66 | -10709.41 | 3201766.03 | 1426514.67 | 40°30'06.905"N | 104°46'28.034"W | point |
| FALKEN 32N-9B-L BHL REV-2 (2294'FSL & 300'FWL, SEC.09) | 7082.50 | 425.66 | -10709.41 | 3201766.03 | 1426514.67 | 40°30'06.905"N | 104°46'28.034"W | circle |
| FALKEN 32N-9B-L TOP OF PROD REV-3 (2349'FSL & 300'FWL, SEC.12) | 7086.25 | 460.00 | 578.73 | 3213053.06 | 1426646.27 | 40°30'07.267"N | 104°44'01.910"W | point |
| FALKEN 32N-9B-L TOP OF PROD REV-2 (2349'FSL & 300'FWL, SEC.12) | 7090.55 | 460.00 | 578.73 | 3213053.06 | 1426646.27 | 40°30'07.267"N | 104°44'01.910"W | circle |

WELLPATH COMPOSITION - Ref Wellbore: FALKEN 32N-9B-L AWB Ref Wellpath: FALKEN 32N-9B-L AWP

| Start MD [ft] | End MD [ft] | Positional Uncertainty Model | Log Name/Comment | Wellbore |
|------------------|----------------|---|-----------------------------------|---------------------|
| 25.00 | 1774.00 | Custom BHI NaviTrak (Standard Rotating+Axial Corr) (Rockies 0.03Gt model) | 13 1/2" APS EM SURVEYS <153-1774> | FALKEN 32N-9B-L AWB |
| 1774.00 | 18886.00 | Custom BHI AutoTrak Curve (IFR1, Short) (Rockies 0.03Gt model) | 8 1/2" ATC SURVEYS <1883-18886> | FALKEN 32N-9B-L AWB |
| 18886.00 | 18910.00 | Blind Drilling (std) | Projection to bit | FALKEN 32N-9B-L AWB |



SRC ENERGY

Actual Wellpath Report

FALKEN 32N-9B-L AWP

Page 11 of 11



**BAKER
HUGHES**

REFERENCE WELLPATH IDENTIFICATION

| | | | |
|----------|--------------------------------|----------|--|
| Operator | SRC ENERGY | Slot | SLOT#02 FALKEN 32N-9B-L (1889'FSL & 276'FEL, SEC.11) |
| Area | COLORADO | Well | FALKEN 32N-9B-L |
| Field | WELD COUNTY (NAD83,TRUE NORTH) | Wellbore | FALKEN 32N-9B-L AWB |
| Facility | SEC.11-T06N-R66W | | |

WELLPATH COMMENTS

| MD [ft] | Inclination [°] | Azimuth [°] | TVD [ft] | Comment |
|------------|--------------------|----------------|-------------|---|
| 7610.00 | 90.000 | 273.060 | 7086.26 | LANDING POINT (2372'FSL & 310'FWL, SEC.12) |
| 18886.00 | 90.990 | 270.020 | 7091.36 | LAST BHGW MWD SURVEY (2290'FSL & 299'FWL, SEC.09) |
| 18910.00 | 90.990 | 270.020 | 7090.94 | PROJECTION TO BIT (2290'FSL & 275'FWL, SEC.09) |