



CRESTONE PEAK
RESOURCES

April 24, 2018

Ms. Julie Murphy, Director
Colorado Oil and Gas Conservation Commission
1120 Lincoln Street, Suite 801
Denver, Colorado 80203

RE: COGCC Rule 318A.e.: Proposed Spacing Unit
Herren 33H-H367 Pad: SENE Section 33, Township 3 North, Range 67 West
Proposed Wells: Herren 1E-33H-H367 Doc #401578312, Herren 1F-33H-H367 Doc #401578313,
Herren 1G-33H-H367 Doc #401578315, Herren 1H-33H-H367 Doc #401578317,
Herren 1I-33H-H367 Doc #401578316
Weld County, Colorado

Dear Director Murphy:

Crestone Peak Resources Operating LLC (CPR) is planning to drill the above referenced wells in accordance with the provisions of COGCC Rule 318A.e.(6). CPR's proposed spacing unit configuration consists of:

Township 3 North, Range 67 West

N/2 of Section 33

Containing 320 acres, more or less for the Niobrara and Codell formations

CPR is not the only owner within the proposed spacing unit, and as such provided notice to the remaining owner(s) within said proposed spacing unit as required under COGCC Rule 318A.e(6). The required thirty (30) day notice period has elapsed absent the receipt by CPR of an objection to said proposal by the owner(s) within the Proposed Spacing Unit for the subject wells.

Enclosed is a copy of the map illustrating the proposed wellbore spacing unit to assist you in your review of the Applications for Permit to Drill for the Herren 33H-H367 Pad Wells.

CPR requests that the COGCC review the enclosed information and approve the Applications for Permit to Drill for the captioned wells. Many thanks for your time and attention to this matter.

Respectfully,

Erin Lind
Regulatory Analyst

EL:jg

Enclosure: Proposed Spacing Unit Exhibit

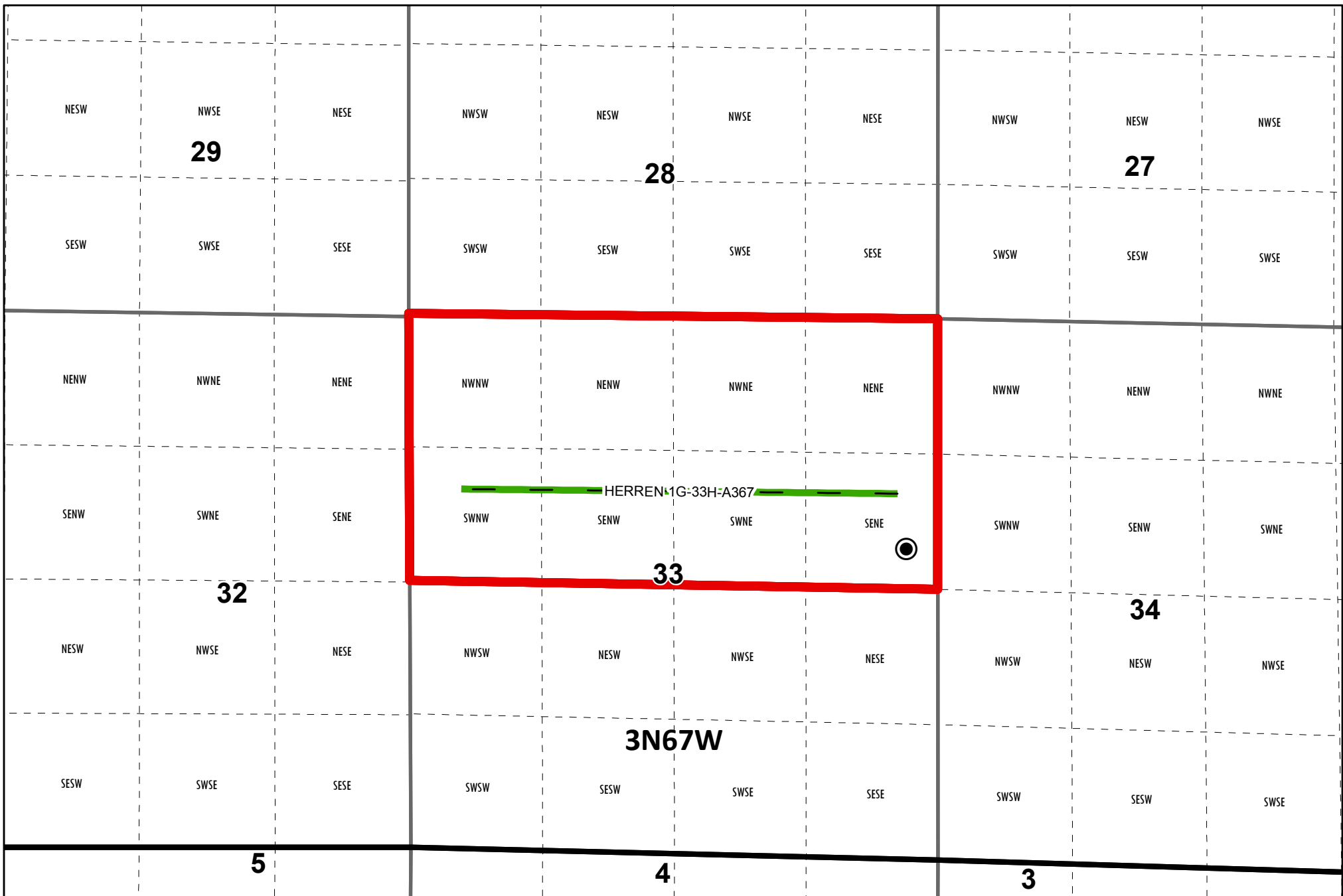

Legend

-  CO Township
-  Preliminary Proposed Spacing Unit
-  CO Section
-  Spaced Wellbore
-  Section QQ

Preliminary Proposed Spacing Unit

HERREN 1G-33H-A367

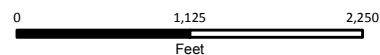

Coordinate System: NAD 1983 BLM Zone 13N



3/27/2018
©Crestone Peak Resources GIS
Created by Julie Long
Disclaimer:
Information depicted on these maps is the sole property of Crestone Peak Resources, LLC (CPR). Electronic reproductions of any portion of this map is strictly prohibited absent the written consent of CPR. This information is to be used for reference purposes only. CPR does not guarantee the accuracy of this material and is not responsible for any misuse or misrepresentation of this information.



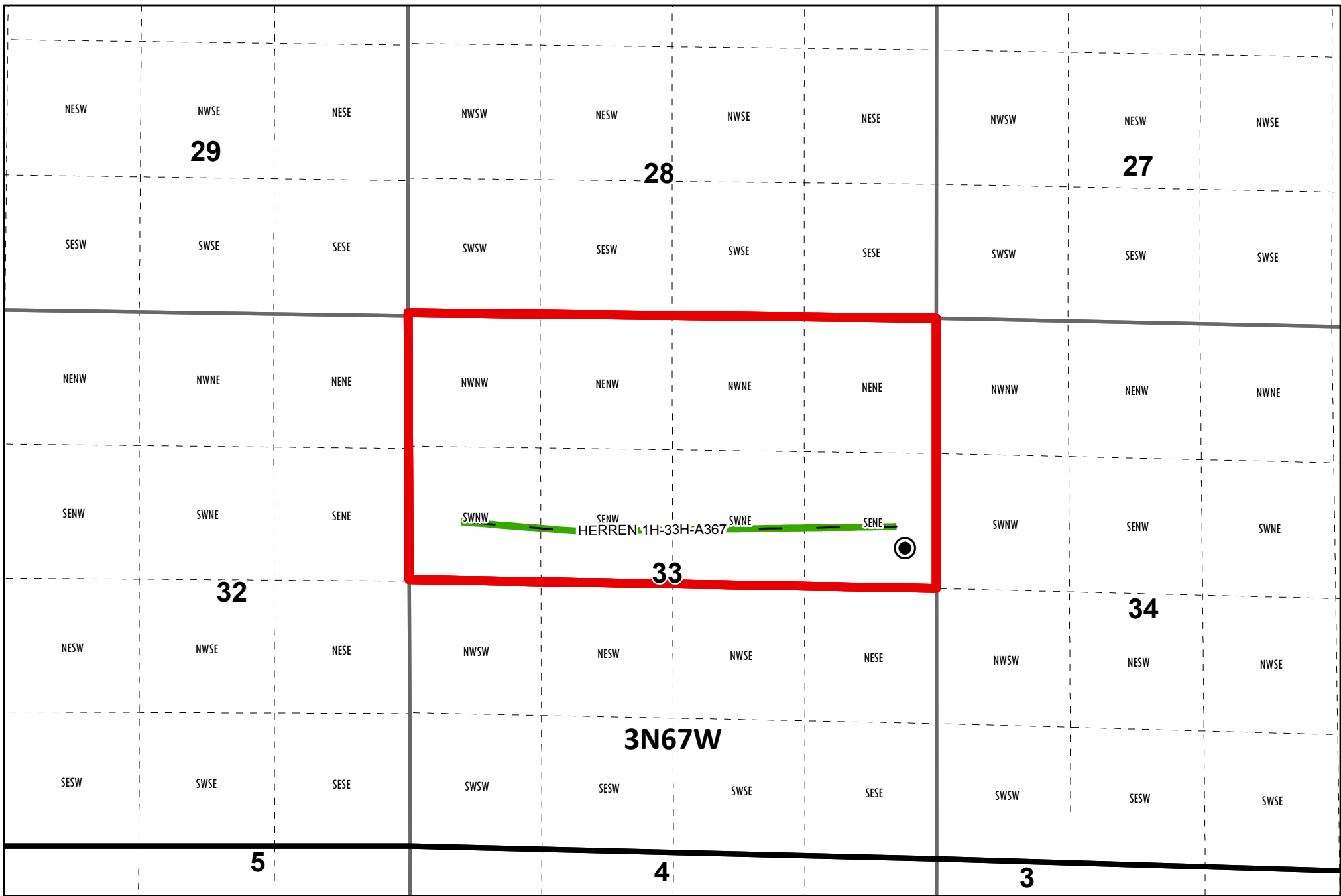

Legend

- CO Township
- Preliminary Proposed Spacing Unit
- CO Section
- Spaced Wellbore
- Section QQ

Preliminary Proposed Spacing Unit

HERREN 1H-33H-A367

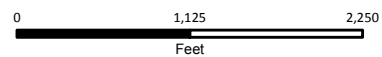

Coordinate System: NAD 1983 BLM Zone 13N

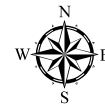

3/27/2018
©Crestone Peak Resources GIS
Created by Julie Long
Disclaimer:
Information depicted on these maps is the sole property of Crestone Peak Resources, LLC (CPR). Electronic reproductions of any portion of this map is strictly prohibited absent the written consent of CPR. This information is to be used for reference purposes only. CPR does not guarantee the accuracy of this material and is not responsible for any misuse or misrepresentation of this information.



