

R. 93 W.



GRID NORTH
SCALE' 1" = 1000'
500' 0 1000'

T. 9 S.

HAYWARD
0993-25-12E
UNGRADED ELEVATION:
8008.0'

BASIS OF ELEVATION: GPS STATIC
OBSERVATION ON DRG CONTROL POINT
CP 16-9-93.
ELEVATION: 7245.29'

BHL/TOG
LATITUDE (NAD 83)
NORTH 39.243719 DEG.
LONGITUDE (NAD 83)
WEST 107.713595 DEG.
NORTHING (NAD 83)
1521296.64
EASTING (NAD 83)
2373145.51

SHL
LATITUDE (NAD 83)
NORTH 39.244788 DEG.
LONGITUDE (NAD 83)
WEST 107.715777 DEG.
NORTHING (NAD 83)
1521701.02
EASTING (NAD 83)
2372537.31

BASIS OF BEARING/DATUM

SPCS COLORADO CENTRAL NAD 27
BASED ON STATIC GPS OBSERVATIONS
ON DRG CONTROL POINT CP 16-9-93
HAVING A POSITION OF:
NAD83(2011)
LAT 39° 16' 16.64" NORTH
LONG 107° 46' 11.24" WEST
NAVD88 ELEVATION: 7245.29'

THE EAST LINE OF THE NE¼ OF SECTION
25, MONUMENTED BY BLM BC'S AND
BEARING S 00°52'09" W.

N00°48'11"E 5283.45'

1999 AC
LS 16413

1999 AC
LS 16413

1999 AC
LS 16413

1921
GLO BC

1921
GLO BC

1921 GLO
BC/WC

NOTES

1. GPS OPERATOR T. SHERRILL OBSERVED A PDOP OF 1.3.
2. ALL GPS OBSERVATIONS ARE IN COMPLIANCE WITH COGCC RULE No.215.
3. EXISTING IMPROVEMENTS WITHIN 500' OF LOCATION. SEE LOC. DRAWING.
4. SURROUNDING SURFACE USE IS NATIVE BRUSH, NON CROP RANGELAND.

SURVEYOR'S STATEMENT

I, DAVID E. HENDERHAN, AN EMPLOYEE AND AGENT ON BEHALF OF D.R. GRIFFIN & ASSOCIATES, INC. STATE THE PLAT HEREON IS A CORRECT REPRESENTATION OF A SURVEY MADE UNDER MY SUPERVISION ON THE 1st DAY OF MARCH, 2018 OF THE SHOWN HAYWARD 0993-25-12E AND THAT THE LOCATION HAS BEEN STAKED ON THE GROUND.

Notice: In accordance with Colorado State Law, any legal action based upon any defect in this survey plat must commence within three (3) years after first discovery of such defect. In no event, may any action based upon any defect in this survey plat be commenced more than ten (10) years from the date of certification shown hereon.

LEGEND

- ◆ WELL LOCATION
- APPROX. BHL
- L DENOTES 90° TIE
- FOUND MONUMENT

HAYWARD 0993-25-09

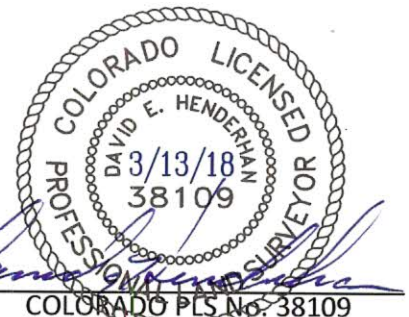

DAVID E. GRIFFIN & ASSOCIATES, INC.
1414 ELK ST., ROCK SPRINGS, WY 82901

DRAWN: 3/8/2018 - TCM

SCALE: 1" = 1000'

REVISED: N/A -

DRG JOB No. 21279

A2-25-12E

PLAT OF DRILLING LOCATION IN
SENE, SECTION 25, FOR
LARAMIE ENERGY, LLC

2569' F/NL, & 859' F/EL, SECTION 25,
T. 9 S., R. 93 W., 6TH P.M.,
MESA COUNTY, COLORADO