

Location:	COLORADO	Slot:	SLOT#11 PAPA JO 2-25 35N-17HZ(1405FSL & 1249FWVL.SEC.08)
Field:	WELD COUNTY (UTM/TRUE NORTH)	Well:	PAPA JO 2-25 35N-17HZ
Facility:	SEC.08-T1N-R68W	Wellbore:	PAPA JO 2-25 35N-17HZ PWB
Plot reference wellpath is PAPA JO 2-25 35N-17HZ PWP RevA.0			
True vertical depths are referenced to PD 564 (26) (RT)			
Measured depths are referenced to PD 564 (26) (RT)			
PD 564 (26) (RT) to Mean Sea Level: 5089 feet			
Mean Sea Level to Mud line (At Slot: SLOT#11 PAPA JO 2-25 35N-17HZ(1405FSL & 1249FWVL.SEC.08)) 0 feet			
Coordinates are in feet referenced to Slot			
		Grid System: NAD83 / UTM Zone 13 North, US feet	
		* = Wellpath was transformed from a different geoid; datum	
		North Reference: True north	
		Scale: True distance	
		Depths are in feet	
		Created by: painsear on 2018-01-31	
		Database: WA_DEN_Anadarko_Defn	

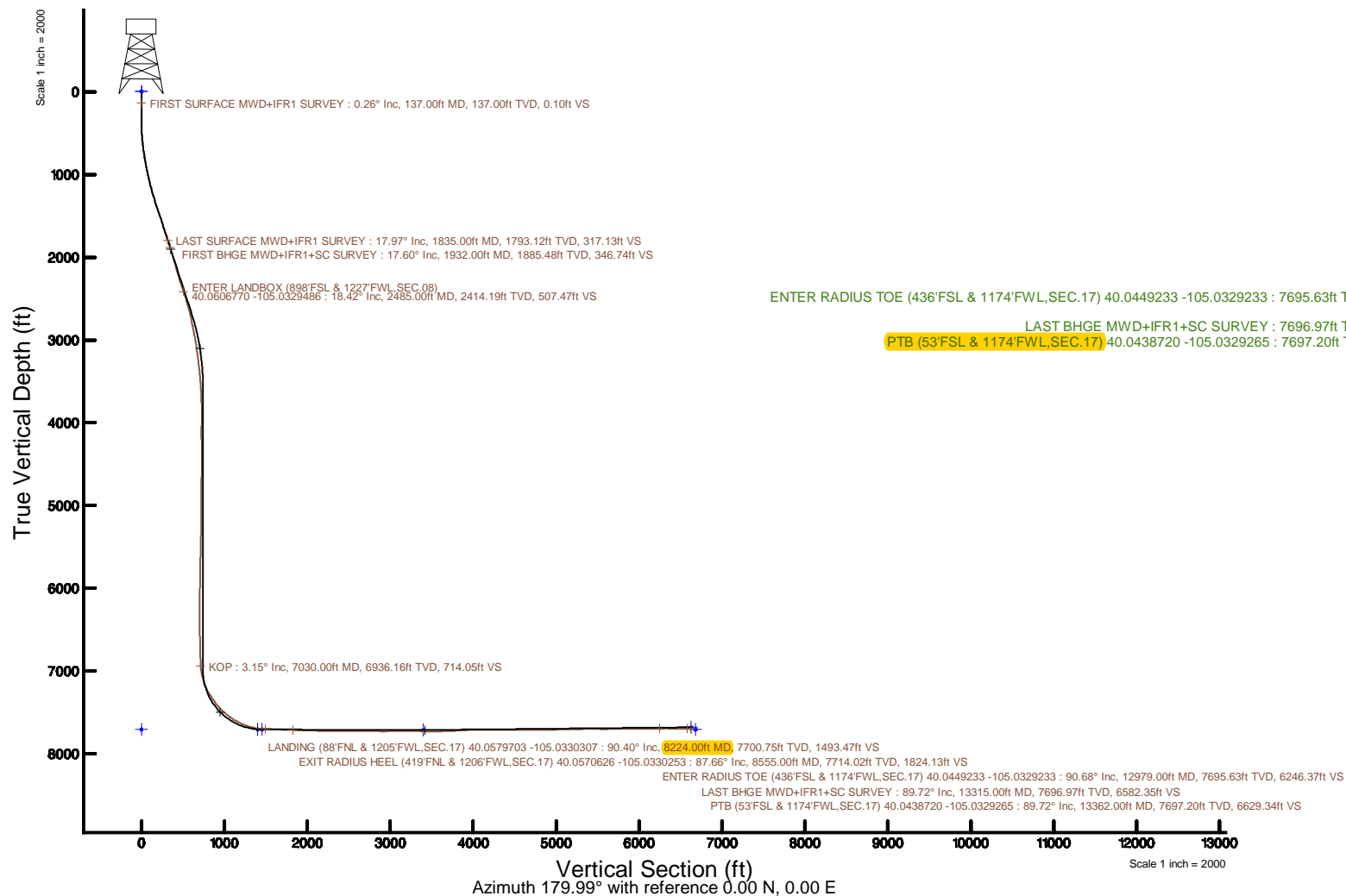

REFERENCE WELLPATH IDENTIFICATION			
Operator	KERR-MCGEE OIL & GAS ONSHORE LP (WA)	Slot	SLOT#11 PAPA JO 2-25 35N-17HZ(1405'FSL & 1249'FWL,SEC.08)
Area	COLORADO	Well	PAPA JO 2-25 35N-17HZ
Field	WELD COUNTY (UTM/TRUE NORTH)	Wellbore	PAPA JO 2-25 35N-17HZ AWB
Facility	SEC.08-T1N-R68W		

REPORT SETUP INFORMATION			
Projection System	NAD83 / UTM Zone 13 North, US feet	Software System	WellArchitect® 5.0
North Reference	True	User	Painsetr
Scale	0.999600	Report Generated	1/31/2018 at 2:14 PM
Convergence at slot	0.03° West	Database/Source file	WA_DEN_Anadarko_Defn/PAPA_JO_2-25_35N-17HZ_AWP.xml

WELLPATH LOCATION						
	Local coordinates		Grid coordinates		Geographic coordinates	
	North[ft]	East[ft]	Easting[US ft]	Northing[US ft]	Latitude	Longitude
Slot Location	-841.49	-988.94	1631218.88	14549337.49	40°03'43.452"N	105°01'58.343"W
Facility Reference Pt			1632207.69	14550178.32	40°03'51.768"N	105°01'45.624"W
Field Reference Pt			1698235.31	14552047.82	40°04'09.600"N	104°47'36.000"W

WELLPATH DATUM			
Calculation method	Minimum curvature	PD 564 (26') (RT) to Facility Vertical Datum	5089.00ft
Horizontal Reference Pt	Slot	PD 564 (26') (RT) to Mean Sea Level	5089.00ft
Vertical Reference Pt	PD 564 (26') (RT)	PD 564 (26') (RT) to Mud Line at Slot (SLOT#11 PAPA JO 2-25 35N-17HZ(1405'FSL & 1249'FWL,SEC.08))	5089.00ft
MD Reference Pt	PD 564 (26') (RT)	Section Origin	N 0.00, E 0.00 ft
Field Vertical Reference	Mean Sea Level	Section Azimuth	179.99°

REFERENCE WELLPATH IDENTIFICATION

Operator	KERR-MCGEE OIL & GAS ONSHORE LP (WA)	Slot	SLOT#11 PAPA JO 2-25 35N-17HZ(1405'FSL & 1249'FWL,SEC.08)
Area	COLORADO	Well	PAPA JO 2-25 35N-17HZ
Field	WELD COUNTY (UTM/TRUE NORTH)	Wellbore	PAPA JO 2-25 35N-17HZ AWP
Facility	SEC.08-T1N-R68W		

WELLPATH DATA (189 stations) † = interpolated/extrapolated station

MD (ft)	Inclination (°)	Azimuth (°)	TVD (ft)	Vert Sect (ft)	North (ft)	East (ft)	Grid East (US ft)	Grid North (US ft)	Latitude	Longitude	DLS (°/100ft)	Comments
0.00†	0.000	112.870	0.00	0.00	0.00	0.00	1631218.88	14549337.49	40°03'43.452"N	105°01'58.343"W	0.00	
26.00	0.000	112.870	26.00	0.00	0.00	0.00	1631218.88	14549337.49	40°03'43.452"N	105°01'58.343"W	0.00	
137.00	0.260	112.870	137.00	0.10	-0.10	0.23	1631219.11	14549337.39	40°03'43.451"N	105°01'58.340"W	0.23	FIRST SURFACE MWD+IFR1 SURVEY
169.00	0.260	81.230	169.00	0.12	-0.12	0.37	1631219.25	14549337.37	40°03'43.451"N	105°01'58.338"W	0.44	
201.00	0.180	125.880	201.00	0.13	-0.13	0.48	1631219.36	14549337.36	40°03'43.451"N	105°01'58.337"W	0.57	
232.00	0.310	35.000	232.00	0.09	-0.09	0.57	1631219.45	14549337.40	40°03'43.451"N	105°01'58.336"W	1.16	
263.00	0.180	7.750	263.00	-0.02	0.02	0.63	1631219.50	14549337.51	40°03'43.452"N	105°01'58.335"W	0.55	
294.00	0.000	98.280	294.00	-0.07	0.07	0.63	1631219.51	14549337.56	40°03'43.453"N	105°01'58.335"W	0.58	
326.00	0.220	141.170	326.00	-0.02	0.02	0.67	1631219.55	14549337.51	40°03'43.452"N	105°01'58.334"W	0.69	
347.00	0.310	124.210	347.00	0.04	-0.04	0.74	1631219.62	14549337.45	40°03'43.452"N	105°01'58.333"W	0.56	
389.00	0.970	152.680	389.00	0.42	-0.42	1.00	1631219.88	14549337.07	40°03'43.448"N	105°01'58.330"W	1.70	
421.00	2.020	166.570	420.98	1.21	-1.21	1.26	1631220.13	14549336.28	40°03'43.440"N	105°01'58.327"W	3.45	
452.00	2.550	170.970	451.96	2.42	-2.42	1.49	1631220.37	14549335.07	40°03'43.428"N	105°01'58.324"W	1.80	
484.00	2.810	169.120	483.92	3.89	-3.89	1.75	1631220.63	14549333.60	40°03'43.414"N	105°01'58.320"W	0.86	
547.00	4.530	172.460	546.79	7.88	-7.88	2.37	1631221.24	14549329.61	40°03'43.374"N	105°01'58.313"W	2.75	
580.00	4.920	173.340	579.68	10.58	-10.57	2.70	1631221.58	14549326.92	40°03'43.347"N	105°01'58.308"W	1.20	
611.00	5.760	175.010	610.55	13.45	-13.44	2.99	1631221.86	14549324.05	40°03'43.319"N	105°01'58.305"W	2.76	
643.00	6.720	177.730	642.36	16.92	-16.92	3.21	1631222.08	14549320.58	40°03'43.285"N	105°01'58.302"W	3.14	
675.00	6.900	178.080	674.13	20.71	-20.71	3.35	1631222.21	14549316.79	40°03'43.247"N	105°01'58.300"W	0.58	
707.00	7.290	175.620	705.89	24.65	-24.65	3.56	1631222.43	14549312.85	40°03'43.208"N	105°01'58.297"W	1.54	
738.00	7.820	176.680	736.62	28.72	-28.72	3.84	1631222.70	14549308.78	40°03'43.168"N	105°01'58.294"W	1.77	
770.00	8.700	182.740	768.28	33.31	-33.31	3.85	1631222.71	14549304.19	40°03'43.123"N	105°01'58.294"W	3.86	
802.00	9.840	184.850	799.87	38.45	-38.45	3.50	1631222.36	14549299.05	40°03'43.072"N	105°01'58.298"W	3.72	
834.00	10.240	182.830	831.38	44.02	-44.02	3.13	1631221.99	14549293.49	40°03'43.017"N	105°01'58.303"W	1.67	
865.00	10.500	183.890	861.87	49.59	-49.59	2.80	1631221.66	14549287.92	40°03'42.962"N	105°01'58.307"W	1.04	
897.00	10.630	184.410	893.33	55.44	-55.44	2.38	1631221.23	14549282.07	40°03'42.904"N	105°01'58.312"W	0.50	
929.00	10.990	182.920	924.76	61.43	-61.43	1.99	1631220.85	14549276.08	40°03'42.845"N	105°01'58.317"W	1.42	
961.00	11.820	181.780	956.13	67.75	-67.75	1.74	1631220.59	14549269.77	40°03'42.782"N	105°01'58.321"W	2.69	
992.00	12.350	182.570	986.44	74.24	-74.24	1.49	1631220.34	14549263.28	40°03'42.718"N	105°01'58.324"W	1.79	
1024.00	12.170	181.510	1017.71	81.03	-81.03	1.25	1631220.09	14549256.49	40°03'42.651"N	105°01'58.327"W	0.90	
1056.00	12.740	181.510	1048.96	87.93	-87.93	1.07	1631219.91	14549249.60	40°03'42.583"N	105°01'58.329"W	1.78	
1087.00	13.710	181.860	1079.13	95.02	-95.01	0.86	1631219.70	14549242.51	40°03'42.513"N	105°01'58.332"W	3.14	
1119.00	13.970	182.480	1110.21	102.66	-102.66	0.57	1631219.40	14549234.87	40°03'42.437"N	105°01'58.336"W	0.94	
1151.00	14.630	181.250	1141.21	110.56	-110.56	0.31	1631219.15	14549226.97	40°03'42.359"N	105°01'58.339"W	2.27	
1183.00	15.820	181.780	1172.09	118.96	-118.96	0.09	1631218.92	14549218.57	40°03'42.276"N	105°01'58.342"W	3.74	
1213.00	16.040	182.740	1200.94	127.19	-127.19	-0.24	1631218.59	14549210.35	40°03'42.195"N	105°01'58.346"W	1.14	
1246.00	15.780	181.340	1232.67	136.23	-136.23	-0.56	1631218.27	14549201.31	40°03'42.106"N	105°01'58.350"W	1.40	
1278.00	15.820	181.420	1263.47	144.94	-144.94	-0.77	1631218.05	14549192.61	40°03'42.020"N	105°01'58.353"W	0.14	
1310.00	16.920	181.950	1294.17	153.96	-153.96	-1.04	1631217.78	14549183.60	40°03'41.931"N	105°01'58.356"W	3.47	
1341.00	17.310	181.600	1323.79	163.07	-163.07	-1.32	1631217.50	14549174.48	40°03'41.840"N	105°01'58.360"W	1.30	
1373.00	17.800	181.420	1354.30	172.72	-172.72	-1.57	1631217.24	14549164.84	40°03'41.745"N	105°01'58.363"W	1.54	
1405.00	18.060	181.160	1384.75	182.57	-182.57	-1.80	1631217.01	14549154.99	40°03'41.648"N	105°01'58.366"W	0.85	
1436.00	18.240	182.390	1414.21	192.22	-192.22	-2.10	1631216.71	14549145.34	40°03'41.552"N	105°01'58.370"W	1.37	
1468.00	18.370	181.250	1444.59	202.27	-202.27	-2.41	1631216.39	14549135.30	40°03'41.453"N	105°01'58.374"W	1.19	
1500.00	18.410	181.780	1474.95	212.36	-212.36	-2.68	1631216.12	14549125.22	40°03'41.353"N	105°01'58.377"W	0.54	

REFERENCE WELLPATH IDENTIFICATION				
Operator	KERR-MCGEE OIL & GAS ONSHORE LP (WA)		Slot	SLOT#11 PAPA JO 2-25 35N-17HZ(1405'FSL & 1249'FWL,SEC.08)
Area	COLORADO		Well	PAPA JO 2-25 35N-17HZ
Field	WELD COUNTY (UTM/TRUE NORTH)		Wellbore	PAPA JO 2-25 35N-17HZ AWP
Facility	SEC.08-T1N-R68W			

WELLPATH DATA (189 stations) † = interpolated/extrapolated station												
MD (ft)	Inclination [°]	Azimuth [°]	TVD (ft)	Vert Sect (ft)	North (ft)	East (ft)	Grid East (US ft)	Grid North (US ft)	Latitude	Longitude	DLS ["/100ft]	Comments
1531.00	18.540	182.570	1504.36	222.18	-222.18	-3.05	1631215.74	14549115.40	40°03'41.256"N	105°01'58.382"W	0.91	
1563.00	18.590	182.650	1534.69	232.35	-232.35	-3.52	1631215.27	14549105.23	40°03'41.156"N	105°01'58.388"W	0.18	
1595.00	18.500	182.920	1565.03	242.52	-242.52	-4.01	1631214.78	14549095.07	40°03'41.055"N	105°01'58.395"W	0.39	
1627.00	18.630	182.740	1595.36	252.69	-252.70	-4.52	1631214.27	14549084.90	40°03'40.955"N	105°01'58.401"W	0.44	
1658.00	18.240	182.220	1624.77	262.49	-262.49	-4.94	1631213.84	14549075.11	40°03'40.858"N	105°01'58.407"W	1.37	
1690.00	18.240	181.250	1655.17	272.50	-272.50	-5.24	1631213.54	14549065.10	40°03'40.759"N	105°01'58.410"W	0.95	
1722.00	18.150	181.860	1685.57	282.49	-282.49	-5.51	1631213.26	14549055.12	40°03'40.660"N	105°01'58.414"W	0.66	
1754.00	17.800	181.950	1716.00	292.36	-292.36	-5.84	1631212.93	14549045.25	40°03'40.563"N	105°01'58.418"W	1.10	
1785.00	17.800	181.950	1745.52	301.83	-301.83	-6.16	1631212.60	14549035.78	40°03'40.469"N	105°01'58.422"W	0.00	
1817.00	17.800	181.950	1775.99	311.61	-311.61	-6.50	1631212.27	14549026.01	40°03'40.373"N	105°01'58.427"W	0.00	
1835.00	17.970	181.500	1793.12	317.13	-317.13	-6.66	1631212.10	14549020.49	40°03'40.318"N	105°01'58.429"W	1.22	LAST SURFACE MWD+IFR1 SURVEY
1932.00	17.600	182.490	1885.48	346.74	-346.74	-7.69	1631211.06	14548990.89	40°03'40.025"N	105°01'58.442"W	0.49	FIRST BHGE MWD+IFR1+SC SURVEY
2022.00	16.800	180.680	1971.46	373.34	-373.34	-8.44	1631210.30	14548964.30	40°03'39.763"N	105°01'58.452"W	1.07	
2111.00	15.250	178.960	2057.00	397.91	-397.91	-8.38	1631210.36	14548939.75	40°03'39.520"N	105°01'58.451"W	1.82	
2201.00	15.770	182.300	2143.72	421.96	-421.96	-8.65	1631210.07	14548915.70	40°03'39.282"N	105°01'58.454"W	1.15	
2290.00	17.520	187.040	2228.99	447.34	-447.34	-10.78	1631207.93	14548890.33	40°03'39.031"N	105°01'58.482"W	2.49	
2380.00	18.410	193.250	2314.61	474.62	-474.62	-15.70	1631203.01	14548863.06	40°03'38.762"N	105°01'58.545"W	2.35	
2470.00	18.620	186.600	2399.96	502.73	-502.73	-20.61	1631198.09	14548834.97	40°03'38.484"N	105°01'58.608"W	2.36	
2485.00†	18.424	186.237	2414.19	507.47	-507.47	-21.14	1631197.56	14548830.23	40°03'38.437"N	105°01'58.615"W	1.51	ENTER LANDBOX (898'FSL & 1227'FWL, SEC.08) 40.0606770 -105.0329486
2559.00	17.470	184.330	2484.59	530.17	-530.17	-23.25	1631195.44	14548807.54	40°03'38.213"N	105°01'58.642"W	1.51	
2649.00	15.680	181.380	2570.84	555.80	-555.80	-24.56	1631194.12	14548781.92	40°03'37.959"N	105°01'58.659"W	2.20	
2738.00	14.040	178.500	2656.87	578.62	-578.62	-24.57	1631194.10	14548759.11	40°03'37.734"N	105°01'58.659"W	2.02	
2828.00	12.350	176.200	2744.49	599.14	-599.14	-23.65	1631195.02	14548738.60	40°03'37.531"N	105°01'58.647"W	1.97	
2917.00	11.170	174.780	2831.62	617.22	-617.22	-22.23	1631196.43	14548720.53	40°03'37.352"N	105°01'58.629"W	1.37	
3007.00	10.990	188.470	2919.95	634.39	-634.39	-22.70	1631195.95	14548703.36	40°03'37.183"N	105°01'58.635"W	2.92	
3096.00	10.000	190.110	3007.47	650.39	-650.39	-25.31	1631193.34	14548687.37	40°03'37.025"N	105°01'58.669"W	1.16	
3186.00	8.670	191.690	3096.27	664.72	-664.72	-28.06	1631190.59	14548673.04	40°03'36.883"N	105°01'58.704"W	1.50	
3275.00	7.780	193.300	3184.36	677.15	-677.16	-30.80	1631187.84	14548660.62	40°03'36.760"N	105°01'58.739"W	1.03	
3365.00	7.010	194.320	3273.61	688.40	-688.41	-33.56	1631185.08	14548649.37	40°03'36.649"N	105°01'58.775"W	0.87	
3455.00	6.150	195.230	3363.01	698.38	-698.38	-36.19	1631182.45	14548639.40	40°03'36.550"N	105°01'58.808"W	0.96	
3544.00	5.060	176.130	3451.59	706.89	-706.90	-37.17	1631181.46	14548630.89	40°03'36.466"N	105°01'58.821"W	2.41	
3634.00	3.710	177.910	3541.33	713.76	-713.77	-36.80	1631181.83	14548624.02	40°03'36.398"N	105°01'58.816"W	1.51	
3724.00	2.900	181.060	3631.18	718.95	-718.95	-36.73	1631181.89	14548618.84	40°03'36.347"N	105°01'58.815"W	0.92	
3813.00	2.360	190.020	3720.08	723.00	-723.01	-37.09	1631181.53	14548614.79	40°03'36.307"N	105°01'58.820"W	0.76	
3902.00	1.960	200.550	3809.02	726.23	-726.24	-37.95	1631180.68	14548611.56	40°03'36.275"N	105°01'58.831"W	0.63	
3992.00	1.580	48.780	3899.00	726.86	-726.86	-37.55	1631181.07	14548610.93	40°03'36.269"N	105°01'58.826"W	3.82	
4082.00	1.140	27.480	3988.98	725.25	-725.25	-36.21	1631182.42	14548612.55	40°03'36.285"N	105°01'58.809"W	0.74	
4171.00	0.390	16.640	4077.97	724.17	-724.17	-35.71	1631182.91	14548613.62	40°03'36.296"N	105°01'58.802"W	0.85	
4261.00	0.550	220.510	4167.97	724.20	-724.21	-35.91	1631182.72	14548613.59	40°03'36.295"N	105°01'58.805"W	1.02	
4350.00	0.880	218.000	4256.96	725.07	-725.07	-36.60	1631182.02	14548612.72	40°03'36.287"N	105°01'58.814"W	0.37	
4440.00	0.730	234.920	4346.95	725.94	-725.95	-37.50	1631181.13	14548611.85	40°03'36.278"N	105°01'58.825"W	0.31	
4529.00	0.370	217.270	4435.95	726.50	-726.50	-38.14	1631180.49	14548611.30	40°03'36.273"N	105°01'58.833"W	0.44	
4619.00	2.920	74.890	4525.91	726.13	-726.13	-36.10	1631182.52	14548611.66	40°03'36.276"N	105°01'58.807"W	3.58	
4708.00	2.960	76.790	4614.80	725.01	-725.02	-31.67	1631186.95	14548612.77	40°03'36.287"N	105°01'58.750"W	0.12	
4822.00	2.650	74.960	4728.66	723.66	-723.66	-26.26	1631192.36	14548614.13	40°03'36.301"N	105°01'58.681"W	0.28	

REFERENCE WELLPATH IDENTIFICATION			
Operator	KERR-MCGEE OIL & GAS ONSHORE LP (WA)	Slot	SLOT#11 PAPA JO 2-25 35N-17HZ(1405'FSL & 1249'FWL,SEC.08)
Area	COLORADO	Well	PAPA JO 2-25 35N-17HZ
Field	WELD COUNTY (UTM/TRUE NORTH)	Wellbore	PAPA JO 2-25 35N-17HZ AWP
Facility	SEC.08-T1N-R68W		

WELLPATH DATA (189 stations) † = interpolated/extrapolated station												
MD (ft)	Inclination (°)	Azimuth (°)	TVD (ft)	Vert Sect (ft)	North (ft)	East (ft)	Grid East (US ft)	Grid North (US ft)	Latitude	Longitude	DLS °/100ft	Comments
4911.00	2.080	75.850	4817.58	722.73	-722.73	-22.71	1631195.91	14548615.06	40°03'36.310"N	105°01'58.635"W	0.64	
5001.00	1.020	53.400	4907.55	721.85	-721.86	-20.48	1631198.14	14548615.93	40°03'36.318"N	105°01'58.606"W	1.34	
5090.00	0.430	359.050	4996.54	721.05	-721.05	-19.85	1631198.77	14548616.74	40°03'36.326"N	105°01'58.598"W	0.95	
5180.00	0.620	328.210	5086.54	720.30	-720.30	-20.11	1631198.50	14548617.49	40°03'36.334"N	105°01'58.602"W	0.37	
5269.00	0.600	325.670	5175.53	719.50	-719.50	-20.63	1631197.99	14548618.28	40°03'36.342"N	105°01'58.608"W	0.04	
5359.00	0.660	316.680	5265.53	718.74	-718.74	-21.25	1631197.37	14548619.05	40°03'36.349"N	105°01'58.616"W	0.13	
5448.00	0.850	305.580	5354.52	717.98	-717.98	-22.14	1631196.48	14548619.81	40°03'36.357"N	105°01'58.628"W	0.27	
5537.00	1.760	3.790	5443.50	716.23	-716.23	-22.59	1631196.03	14548621.55	40°03'36.374"N	105°01'58.633"W	1.68	
5627.00	1.600	351.630	5533.46	713.61	-713.61	-22.68	1631195.94	14548624.17	40°03'36.400"N	105°01'58.635"W	0.43	
5716.00	1.460	342.990	5622.43	711.29	-711.30	-23.19	1631195.43	14548626.49	40°03'36.423"N	105°01'58.641"W	0.30	
5806.00	1.360	345.830	5712.40	709.16	-709.17	-23.79	1631194.84	14548628.62	40°03'36.444"N	105°01'58.649"W	0.14	
5896.00	0.920	335.040	5802.39	707.47	-707.47	-24.36	1631194.27	14548630.31	40°03'36.461"N	105°01'58.656"W	0.54	
5985.00	0.760	340.610	5891.38	706.27	-706.27	-24.85	1631193.77	14548631.51	40°03'36.472"N	105°01'58.663"W	0.20	
6075.00	1.020	345.430	5981.36	704.93	-704.93	-25.25	1631193.37	14548632.85	40°03'36.486"N	105°01'58.668"W	0.30	
6164.00	0.860	110.360	6070.36	704.39	-704.40	-24.83	1631193.80	14548633.38	40°03'36.491"N	105°01'58.662"W	1.87	
6254.00	1.250	68.840	6160.34	704.28	-704.28	-23.28	1631195.35	14548633.50	40°03'36.492"N	105°01'58.642"W	0.92	
6343.00	0.240	303.940	6249.34	703.82	-703.82	-22.53	1631196.10	14548633.96	40°03'36.497"N	105°01'58.633"W	1.57	
6433.00	0.230	332.640	6339.34	703.56	-703.56	-22.77	1631195.86	14548634.22	40°03'36.499"N	105°01'58.636"W	0.13	
6522.00	0.450	326.650	6428.34	703.10	-703.11	-23.04	1631195.59	14548634.67	40°03'36.504"N	105°01'58.639"W	0.25	
6612.00	1.750	243.040	6518.32	703.43	-703.43	-24.46	1631194.17	14548634.35	40°03'36.501"N	105°01'58.658"W	1.95	
6701.00	1.670	193.150	6607.29	705.31	-705.31	-25.97	1631192.66	14548632.47	40°03'36.482"N	105°01'58.677"W	1.62	
6791.00	1.520	186.850	6697.25	707.77	-707.78	-26.41	1631192.22	14548630.01	40°03'36.458"N	105°01'58.683"W	0.26	
6880.00	1.260	180.740	6786.22	709.92	-709.93	-26.56	1631192.07	14548627.86	40°03'36.436"N	105°01'58.685"W	0.34	
6970.00	1.140	176.760	6876.21	711.81	-711.81	-26.52	1631192.10	14548625.98	40°03'36.418"N	105°01'58.684"W	0.16	
7030.00†	3.153	183.696	6936.16	714.05	-714.05	-26.59	1631192.03	14548623.73	40°03'36.396"N	105°01'58.685"W	3.38	KOP
7059.00	4.130	184.620	6965.10	715.89	-715.89	-26.73	1631191.89	14548621.90	40°03'36.377"N	105°01'58.687"W	3.38	
7149.00	14.110	185.750	7053.85	730.07	-730.07	-28.09	1631190.53	14548607.72	40°03'36.237"N	105°01'58.704"W	11.09	
7239.00	18.750	182.710	7140.15	755.45	-755.45	-29.88	1631188.73	14548582.36	40°03'35.986"N	105°01'58.727"W	5.24	
7328.00	25.940	184.030	7222.42	789.20	-789.20	-31.92	1631186.67	14548548.62	40°03'35.653"N	105°01'58.754"W	8.10	
7418.00	33.100	179.140	7300.69	833.47	-833.47	-32.94	1631185.64	14548504.37	40°03'35.215"N	105°01'58.767"W	8.39	
7507.00	37.330	177.550	7373.39	884.75	-884.75	-31.42	1631187.14	14548453.10	40°03'34.709"N	105°01'58.747"W	4.86	
7597.00	41.110	181.970	7443.12	941.62	-941.62	-31.27	1631187.27	14548396.26	40°03'34.147"N	105°01'58.745"W	5.22	
7686.00	48.620	182.600	7506.15	1004.30	-1004.31	-33.80	1631184.72	14548333.60	40°03'33.527"N	105°01'58.778"W	8.45	
7776.00	55.670	179.680	7561.36	1075.29	-1075.30	-35.12	1631183.37	14548262.64	40°03'32.826"N	105°01'58.795"W	8.24	
7865.00	60.960	178.210	7608.09	1150.98	-1150.99	-33.70	1631184.77	14548186.98	40°03'32.078"N	105°01'58.776"W	6.11	
7955.00	67.120	179.870	7647.47	1231.85	-1231.85	-32.38	1631186.06	14548106.14	40°03'31.279"N	105°01'58.759"W	7.04	
8045.00	75.260	182.800	7676.47	1316.94	-1316.94	-34.41	1631183.99	14548021.09	40°03'30.438"N	105°01'58.786"W	9.55	
8134.00	81.490	184.080	7694.40	1403.91	-1403.91	-39.65	1631178.72	14547934.16	40°03'29.578"N	105°01'58.853"W	7.14	
8224.00	90.400	181.670	7700.75	1493.47	-1493.48	-44.14	1631174.21	14547844.63	40°03'28.693"N	105°01'58.911"W	10.25	LANDING (88'FNL & 1205'FWL,SEC.17) 40.0579703 -105.0330307
8313.00	87.480	179.500	7702.40	1582.44	-1582.44	-45.05	1631173.26	14547755.70	40°03'27.814"N	105°01'58.922"W	4.09	
8403.00	86.270	179.340	7707.31	1672.30	-1672.30	-44.14	1631174.14	14547665.88	40°03'26.926"N	105°01'58.911"W	1.36	
8492.00	88.090	179.520	7711.69	1761.18	-1761.19	-43.25	1631174.99	14547577.03	40°03'26.048"N	105°01'58.899"W	2.05	
8555.00†	87.656	179.324	7714.02	1824.13	-1824.14	-42.62	1631175.60	14547514.10	40°03'25.425"N	105°01'58.891"W	0.76	EXIT RADIUS HEEL (419'FNL & 1206'FWL,SEC.17) 40.0570626 -105.0330253
8582.00	87.470	179.240	7715.17	1851.11	-1851.11	-42.28	1631175.93	14547487.14	40°03'25.159"N	105°01'58.887"W	0.76	
8671.00	89.290	179.640	7717.69	1940.06	-1940.07	-41.41	1631176.77	14547398.22	40°03'24.280"N	105°01'58.876"W	2.09	

REFERENCE WELLPATH IDENTIFICATION

Operator	KERR-MCGEE OIL & GAS ONSHORE LP (WA)	Slot	SLOT#11 PAPA JO 2-25 35N-17HZ(1405'FSL & 1249'FWL,SEC.08)
Area	COLORADO	Well	PAPA JO 2-25 35N-17HZ
Field	WELD COUNTY (UTM/TRUE NORTH)	Wellbore	PAPA JO 2-25 35N-17HZ AWB
Facility	SEC.08-T1N-R68W		

WELLPATH DATA (189 stations)

MD [ft]	Inclination [°]	Azimuth [°]	TVD [ft]	Vert Sect [ft]	North [ft]	East [ft]	Grid East [US ft]	Grid North [US ft]	Latitude	Longitude	DLS [°/100ft]	Comments
8761.00	88.680	179.320	7719.28	2030.05	-2030.05	-40.59	1631177.55	14547308.27	40°03'23.391"N	105°01'58.865"W	0.77	
8851.00	87.840	179.330	7722.01	2120.00	-2120.00	-39.53	1631178.58	14547218.35	40°03'22.502"N	105°01'58.851"W	0.93	
8940.00	89.230	181.340	7724.29	2208.96	-2208.96	-40.06	1631178.02	14547129.43	40°03'21.623"N	105°01'58.858"W	2.75	
9030.00	88.060	181.250	7726.42	2298.91	-2298.91	-42.09	1631175.96	14547039.51	40°03'20.734"N	105°01'58.884"W	1.30	
9119.00	90.250	182.930	7727.73	2387.83	-2387.84	-45.33	1631172.68	14546950.63	40°03'19.855"N	105°01'58.926"W	3.10	
9209.00	89.880	179.180	7727.63	2477.80	-2477.81	-46.99	1631170.99	14546860.70	40°03'18.966"N	105°01'58.947"W	4.19	
9298.00	90.120	179.630	7727.63	2566.80	-2566.80	-46.07	1631171.88	14546771.74	40°03'18.086"N	105°01'58.935"W	0.57	
9388.00	89.970	181.050	7727.56	2656.79	-2656.80	-46.60	1631171.31	14546681.78	40°03'17.197"N	105°01'58.942"W	1.59	
9477.00	90.460	180.440	7727.22	2745.78	-2745.79	-47.76	1631170.12	14546592.82	40°03'16.318"N	105°01'58.957"W	0.88	
9567.00	88.890	176.390	7727.73	2835.73	-2835.73	-45.27	1631172.58	14546502.92	40°03'15.429"N	105°01'58.925"W	4.83	
9656.00	89.940	176.930	7728.64	2924.57	-2924.57	-40.08	1631177.73	14546414.11	40°03'14.551"N	105°01'58.858"W	1.33	
9746.00	90.890	178.020	7727.99	3014.48	-3014.48	-36.12	1631181.66	14546324.23	40°03'13.662"N	105°01'58.807"W	1.61	
9835.00	90.770	178.080	7726.70	3103.42	-3103.42	-33.09	1631184.65	14546235.33	40°03'12.783"N	105°01'58.769"W	0.15	
9925.00	89.750	178.950	7726.29	3193.38	-3193.39	-30.76	1631186.95	14546145.40	40°03'11.894"N	105°01'58.739"W	1.49	
10014.00	89.630	179.300	7726.78	3282.37	-3282.37	-29.40	1631188.28	14546056.44	40°03'11.015"N	105°01'58.721"W	0.42	
10104.00	88.190	177.440	7728.49	3372.31	-3372.32	-26.84	1631190.80	14545966.54	40°03'10.126"N	105°01'58.688"W	2.61	
10194.00	89.350	179.730	7730.42	3462.26	-3462.26	-24.62	1631192.99	14545876.63	40°03'09.237"N	105°01'58.660"W	2.85	
10283.00	90.580	180.120	7730.47	3551.26	-3551.26	-24.50	1631193.07	14545787.67	40°03'08.358"N	105°01'58.658"W	1.45	
10373.00	92.460	180.050	7728.09	3641.22	-3641.22	-24.64	1631192.91	14545697.74	40°03'07.469"N	105°01'58.660"W	2.09	
10463.00	92.650	179.630	7724.07	3731.13	-3731.13	-24.39	1631193.12	14545607.87	40°03'06.580"N	105°01'58.657"W	0.51	
10552.00	93.480	179.500	7719.32	3820.00	-3820.00	-23.71	1631193.77	14545519.03	40°03'05.702"N	105°01'58.648"W	0.94	
10642.00	91.600	179.810	7715.33	3909.91	-3909.91	-23.17	1631194.27	14545429.16	40°03'04.813"N	105°01'58.641"W	2.12	
10731.00	91.630	179.880	7712.82	3998.87	-3998.87	-22.93	1631194.48	14545340.23	40°03'03.934"N	105°01'58.638"W	0.09	
10821.00	89.540	180.460	7711.90	4088.86	-4088.86	-23.20	1631194.18	14545250.28	40°03'03.045"N	105°01'58.641"W	2.41	
10910.00	88.770	180.530	7713.21	4177.85	-4177.85	-23.97	1631193.38	14545161.33	40°03'02.166"N	105°01'58.651"W	0.87	
11000.00	90.030	181.600	7714.16	4267.82	-4267.82	-25.64	1631191.67	14545071.39	40°03'01.276"N	105°01'58.673"W	1.84	
11090.00	89.540	181.870	7714.49	4357.78	-4357.78	-28.36	1631188.92	14544981.47	40°03'00.387"N	105°01'58.708"W	0.62	
11179.00	90.740	181.240	7714.28	4446.74	-4446.75	-30.78	1631186.47	14544892.54	40°02'59.508"N	105°01'58.739"W	1.52	
11268.00	89.880	180.740	7713.79	4535.73	-4535.73	-32.32	1631184.90	14544803.59	40°02'58.629"N	105°01'58.759"W	1.12	
11358.00	90.930	180.010	7713.16	4625.72	-4625.72	-32.90	1631184.28	14544713.64	40°02'57.740"N	105°01'58.766"W	1.42	
11448.00	90.430	179.820	7712.09	4715.71	-4715.72	-32.77	1631184.38	14544623.68	40°02'56.850"N	105°01'58.764"W	0.59	
11537.00	89.660	179.290	7712.02	4804.71	-4804.71	-32.08	1631185.04	14544534.72	40°02'55.971"N	105°01'58.756"W	1.05	
11627.00	91.450	179.920	7711.15	4894.70	-4894.70	-31.46	1631185.62	14544444.76	40°02'55.081"N	105°01'58.748"W	2.11	
11717.00	91.510	180.040	7708.82	4984.67	-4984.67	-31.43	1631185.62	14544354.83	40°02'54.192"N	105°01'58.747"W	0.15	
11806.00	91.080	179.400	7706.81	5073.65	-5073.65	-30.99	1631186.02	14544265.89	40°02'53.313"N	105°01'58.742"W	0.87	
11896.00	91.320	178.880	7704.93	5163.62	-5163.62	-29.64	1631187.34	14544175.96	40°02'52.424"N	105°01'58.724"W	0.64	
11985.00	90.960	178.770	7703.16	5252.58	-5252.58	-27.82	1631189.13	14544087.03	40°02'51.545"N	105°01'58.701"W	0.42	
12075.00	90.980	178.960	7701.63	5342.55	-5342.55	-26.04	1631190.88	14543997.09	40°02'50.656"N	105°01'58.678"W	0.21	
12164.00	89.750	178.360	7701.07	5431.52	-5431.52	-23.95	1631192.93	14543908.16	40°02'49.776"N	105°01'58.651"W	1.54	
12254.00	89.410	178.790	7701.73	5521.49	-5521.49	-21.72	1631195.13	14543818.22	40°02'48.887"N	105°01'58.622"W	0.61	
12344.00	90.400	179.520	7701.88	5611.48	-5611.48	-20.39	1631196.43	14543728.27	40°02'47.998"N	105°01'58.605"W	1.37	
12433.00	91.510	179.280	7700.39	5700.46	-5700.46	-19.46	1631197.32	14543639.33	40°02'47.119"N	105°01'58.593"W	1.28	
12523.00	91.360	179.370	7698.14	5790.43	-5790.43	-18.40	1631198.35	14543549.40	40°02'46.230"N	105°01'58.580"W	0.19	
12612.00	90.000	179.190	7697.08	5879.41	-5879.41	-17.28	1631199.43	14543460.45	40°02'45.350"N	105°01'58.565"W	1.54	
12702.00	89.140	178.690	7697.76	5969.39	-5969.39	-15.61	1631201.07	14543370.50	40°02'44.461"N	105°01'58.544"W	1.11	

REFERENCE WELLPATH IDENTIFICATION			
Operator	KERR-MCGEE OIL & GAS ONSHORE LP (WA)	Slot	SLOT#11 PAPA JO 2-25 35N-17HZ(1405'FSL & 1249'FWL,SEC.08)
Area	COLORADO	Well	PAPA JO 2-25 35N-17HZ
Field	WELD COUNTY (UTM/TRUE NORTH)	Wellbore	PAPA JO 2-25 35N-17HZ AWB
Facility	SEC.08-T1N-R68W		

WELLPATH DATA (189 stations) † = interpolated/extrapolated station											
MD [ft]	Inclination [°]	Azimuth [°]	TVD [ft]	Vert Sect [ft]	North [ft]	East [ft]	Grid East [US ft]	Grid North [US ft]	Latitude	Longitude	DLS [°/100ft]
12792.00	90.680	179.900	7697.90	6059.38	-6059.38	-14.51	1631202.14	14543280.55	40°02'43.572"N	105°01'58.530"W	2.18
12881.00	90.680	179.930	7696.84	6148.37	-6148.38	-14.37	1631202.24	14543191.59	40°02'42.692"N	105°01'58.528"W	0.03
12971.00	90.740	179.730	7695.73	6238.37	-6238.37	-14.11	1631202.47	14543101.63	40°02'41.803"N	105°01'58.524"W	0.23
12979.00†	90.676	179.764	7695.63	6246.37	-6246.37	-14.07	1631202.50	14543093.64	40°02'41.724"N	105°01'58.524"W	0.90
13060.00	90.030	180.110	7695.13	6327.36	-6327.37	-13.98	1631202.56	14543012.67	40°02'40.924"N	105°01'58.523"W	0.90
13149.00	89.010	179.720	7695.87	6416.36	-6416.36	-13.85	1631202.66	14542923.71	40°02'40.044"N	105°01'58.521"W	1.23
13239.00	89.910	179.690	7696.72	6506.35	-6506.36	-13.39	1631203.09	14542833.75	40°02'39.155"N	105°01'58.515"W	1.00
13315.00	89.720	181.200	7696.97	6582.35	-6582.35	-13.98	1631202.47	14542757.79	40°02'38.404"N	105°01'58.523"W	2.00
13362.00	89.720	181.200	7697.20	6629.34	-6629.34	-14.96	1631201.47	14542710.82	40°02'37.939"N	105°01'58.535"W	0.00

TARGETS								
Name	TVD [ft]	North [ft]	East [ft]	Grid East [US ft]	Grid North [US ft]	Latitude	Longitude	Shape
SEC.08-T1N-R68W	-2.00	0.40	-45.02	1631173.88	14549337.91	40°03'43.456"N	105°01'58.922"W	polygon
SEC.17-T1N-R68W	-2.00	0.40	-45.02	1631173.88	14549337.91	40°03'43.456"N	105°01'58.922"W	polygon
PAPA JO 2-25 35N-17HZ BHL REV-1(52'FSL & 1164'FWL,SEC.17)	7680.00	-6630.08	-24.90	1631191.54	14542710.08	40°02'37.932"N	105°01'58.663"W	point
PAPA JO 2-25 35N-17HZ HEEL REV-1(50'FNL & 1156'FWL,SEC.17)	7707.00	-1454.98	-25.46	1631192.89	14547883.11	40°03'29.074"N	105°01'58.670"W	point
PAPA JO 2-25 35N-17HZ LANDBOX	7707.00	0.00	0.00	1631218.88	14549337.49	40°03'43.452"N	105°01'58.343"W	polygon
PAPA JO 2-25 35N-17HZ RADIUS 1	7707.00	-6679.72	135.24	1631351.60	14542660.40	40°02'37.441"N	105°01'56.604"W	polygon
PAPA JO 2-25 35N-17HZ RADIUS 2	7707.00	-1403.00	142.50	1631360.80	14547935.00	40°03'29.587"N	105°01'56.510"W	polygon
PAPA JO 2-25 35N-17HZ INT. TARGET@3400°VS	7713.00	-3400.00	-25.25	1631192.38	14545938.87	40°03'09.852"N	105°01'58.668"W	point

WELLPATH COMPOSITION - Ref Wellbore: PAPA JO 2-25 35N-17HZ AWB				Ref Wellpath: PAPA JO 2-25 35N-17HZ AWP	
Start MD [ft]	End MD [ft]	Positional Uncertainty Model	Log Name/Comment		Wellbore
26.00	1835.00	Custom APC ISCWSA REV 2 MWD+IFR1 (approximation)	Custom APC ISCWSA Rev-2 MWD+IFR1 <137 - 1835>		PAPA JO 2-25 35N-17HZ AWB
1835.00	13315.00	Custom APC ISCWSA REV 2 MWD+IFR1+SC (approximation)	BHGE Custom APC ISCWSA Rev-2 MWD+IFR1+SC <1932 - 13315>		PAPA JO 2-25 35N-17HZ AWB
13315.00	13362.00	Blind Drilling (std)	Projection to bit		PAPA JO 2-25 35N-17HZ AWB

REFERENCE WELLPATH IDENTIFICATION			
Operator	KERR-MCGEE OIL & GAS ONSHORE LP (WA)	Slot	SLOT#11 PAPA JO 2-25 35N-17HZ(1405'FSL & 1249'FWL,SEC.08)
Area	COLORADO	Well	PAPA JO 2-25 35N-17HZ
Field	WELD COUNTY (UTM/TRUE NORTH)	Wellbore	PAPA JO 2-25 35N-17HZ AWP
Facility	SEC.08-T1N-R68W		

WELLPATH COMMENTS				
MD [ft]	Inclination [°]	Azimuth [°]	TVD [ft]	Comment
137.00	0.260	112.870	137.00	FIRST SURFACE MWD+IFR1 SURVEY
1835.00	17.970	181.500	1793.12	LAST SURFACE MWD+IFR1 SURVEY
1932.00	17.600	182.490	1885.48	FIRST BHGE MWD+IFR1+SC SURVEY
2485.00	18.424	186.237	2414.19	ENTER LANDBOX (898'FSL & 1227'FWL,SEC.08) 40.0606770 -105.0329486
7030.00	3.153	183.696	6936.16	KOP
8224.00	90.400	181.670	7700.75	LANDING (88'FNL & 1205'FWL,SEC.17) 40.0579703 -105.0330307
8555.00	87.656	179.324	7714.02	EXIT RADIUS HEEL (419'FNL & 1206'FWL,SEC.17) 40.0570626 -105.0330253
12979.00	90.676	179.764	7695.63	ENTER RADIUS TOE (436'FSL & 1174'FWL,SEC.17) 40.0449233 -105.0329233
13315.00	89.720	181.200	7696.97	LAST BHGE MWD+IFR1+SC SURVEY
13362.00	89.720	181.200	7697.20	PTB (53'FSL & 1174'FWL,SEC.17) 40.0438720 -105.0329265