

11N/63W

10

11

15

14

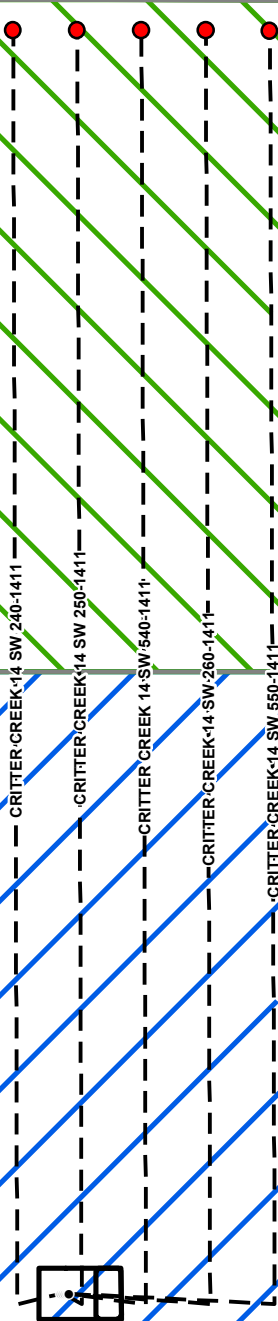

HighPoint

RESOURCES

Lease Boundary Map
Crittter Creek 14 SW
SWSW, Section 14, T11N, R63W
Weld County, Colorado



0 1,000 2,000 Feet

Legend

- Proposed Bottom Hole
- Proposed Surface Hole
- Proposed Well Path

DJ Basin Pad Locations

□ Proposed

Lessor

- KENYON K AYARS ET UX
- SHIRLEY SMITH FONDA

KENYON KAYARS ETUX
T11N - R63W
SEC 14: ALL
SEC 15: ALL
SEC 21: SE
SEC 28: N2
SEC 31: W2
SEC 35: E2
TOTAL GROSS ACRES - 2,720ac
SHIRLEY SMITH FONDA
T11N - R63W
SEC 11: ALL
TOTAL GROSS AC - 640 ac