

KERR-MCGEE OIL & GAS ONSHORE LP (WA)

Location: COLORADO Slot: SLOT#10 PAPA JO 2-25 29N-8HZ(1405'FSL & 1219'FWL,SEC.08)
 Field: WELD COUNTY (UTM/TRUE NORTH) Well: PAPA JO 2-25 29N-8HZ
 Facility: SEC.08-T1N-R68W Wellbore: PAPA JO 2-25 29N-8HZ PWB

Plot reference wellpath is PAPA JO 2-25 29N-8HZ PWP REV-C.0	Grid System: NAD83 / UTM Zone 13 North, US feet
True vertical depths are referenced to PD 564 (26) (RT)	* = Wellpath was transformed from a different geodetic datum
Measured depths are referenced to PD 564 (26) (RT)	North Reference: True north
PD 564 (26) (RT) to Mean Sea Level: 5089 feet	Scale: True distance
Mean Sea Level to Mud line (At Slot: SLOT#10 PAPA JO 2-25 29N-8HZ(1405'FSL & 1219'FWL,SEC.08)): 0 feet	Depths are in feet
Coordinates are in feet referenced to Slot	Created by: painsetr on 2018-01-11
	Database: WA_DEN_Anadarko_Def

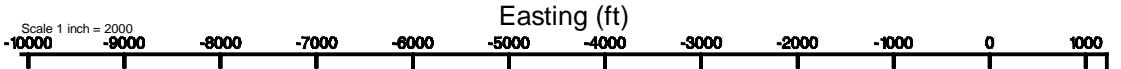

PTB (58'FNL & 1014'FWL,SEC.08) 40.0728435 -105.0337462 : 7716.31ft TVD, 3924.27ft N, 214.43ft W
 LAST BHGE MWD+IFR1+SC SURVEY : 7717.45ft TVD, 3878.41ft N, 211.12ft W
 ENTER RADIUS TOE (299'FNL & 1029'FWL,SEC.08) 40.0721808 -105.0336886 : 7720.97ft TVD, 3682.86ft N, 198.30ft W

EXIT RADIUS HEEL (364'FSL & 1108'FWL,SEC.08) 40.0592147 -105.0333718 : 7707.72ft TVD, 1040.55ft S, 109.68ft W
 LANDING (188'FSL & 1112'FWL,SEC.08) 40.0587318 -105.0333624 : 7710.73ft TVD, 1216.50ft S, 107.05ft W

KOP : 6913.24ft TVD, 2013.80ft S, 102.06ft W

SLOT#10 PAPA JO 2-25 29N-8HZ(1405'FSL & 1219'FWL,SEC.08)

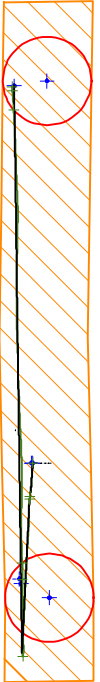
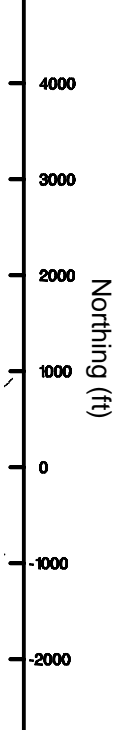
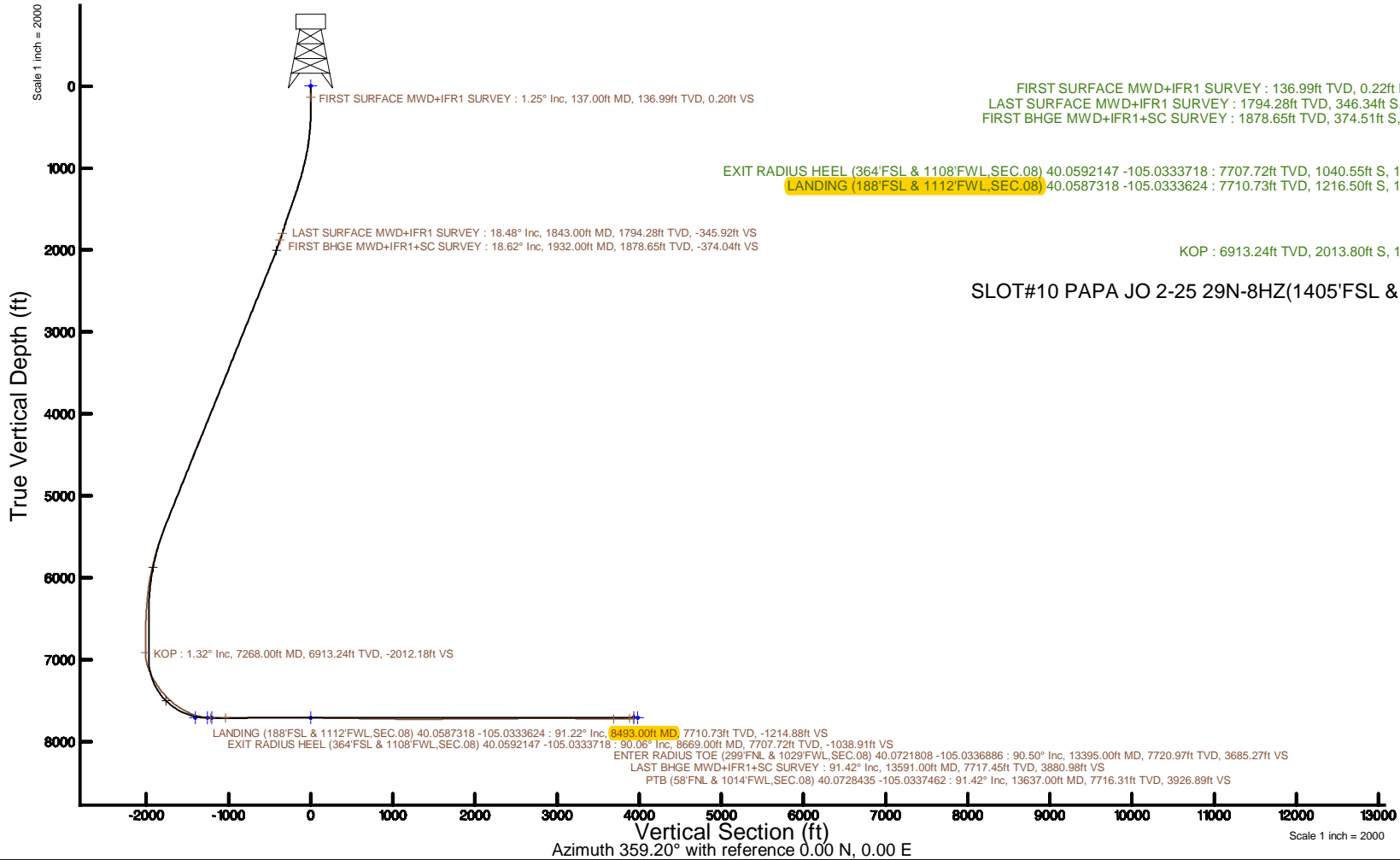

REFERENCE WELLPATH IDENTIFICATION			
Operator	KERR-MCGEE OIL & GAS ONSHORE LP (WA)	Slot	SLOT#10 PAPA JO 2-25 29N-8HZ(1405'FSL & 1219'FWL,SEC.08)
Area	COLORADO	Well	PAPA JO 2-25 29N-8HZ
Field	WELD COUNTY (UTM/TRUE NORTH)	Wellbore	PAPA JO 2-25 29N-8HZ AWB
Facility	SEC.08-T1N-R68W		

REPORT SETUP INFORMATION			
Projection System	NAD83 / UTM Zone 13 North, US feet	Software System	WellArchitect® 5.0
North Reference	True	User	Painsetr
Scale	0.999600	Report Generated	1/11/2018 at 8:32 AM
Convergence at slot	0.03° West	Database/Source file	WA_DEN_Anadarko_Defn/PAPA_JO_2-25_29N-8HZ_AWP.xml

WELLPATH LOCATION						
	Local coordinates		Grid coordinates		Geographic coordinates	
	North[ft]	East[ft]	Easting[US ft]	Northing[US ft]	Latitude	Longitude
Slot Location	-841.09	-1018.87	1631188.96	14549337.91	40°03'43.456"N	105°01'58.728"W
Facility Reference Pt			1632207.69	14550178.32	40°03'51.768"N	105°01'45.624"W
Field Reference Pt			1698235.31	14552047.82	40°04'09.600"N	104°47'36.000"W

WELLPATH DATUM			
Calculation method	Minimum curvature	PD 564 (26') (RT) to Facility Vertical Datum	5089.00ft
Horizontal Reference Pt	Slot	PD 564 (26') (RT) to Mean Sea Level	5089.00ft
Vertical Reference Pt	PD 564 (26') (RT)	PD 564 (26') (RT) to Mud Line at Slot (SLOT#10 PAPA JO 2-25 29N-8HZ(1405'FSL & 1219'FWL,SEC.08))	5089.00ft
MD Reference Pt	PD 564 (26') (RT)	Section Origin	N 0.00, E 0.00 ft
Field Vertical Reference	Mean Sea Level	Section Azimuth	359.20°

REFERENCE WELLPATH IDENTIFICATION			
Operator	KERR-MCGEE OIL & GAS ONSHORE LP (WA)	Slot	SLOT#10 PAPA JO 2-25 29N-8HZ(1405'FSL & 1219'FWL,SEC.08)
Area	COLORADO	Well	PAPA JO 2-25 29N-8HZ
Field	WELD COUNTY (UTM/TRUE NORTH)	Wellbore	PAPA JO 2-25 29N-8HZ AWB
Facility	SEC.08-T1N-R68W		

WELLPATH DATA (196 stations) † = interpolated/extrapolated station												
MD (ft)	Inclination (°)	Azimuth (°)	TVD (ft)	Vert Sect (ft)	North (ft)	East (ft)	Grid East [US ft]	Grid North [US ft]	Latitude	Longitude	DLS (°/100ft)	Comments
0.00†	0.000	79.560	0.00	0.00	0.00	0.00	1631188.95	14549337.91	40°03'43.456"N	105°01'58.728"W	0.00	
26.00	0.000	79.560	26.00	0.00	0.00	0.00	1631188.95	14549337.91	40°03'43.456"N	105°01'58.728"W	0.00	
137.00†	1.248	79.560	136.99	0.20	0.22	1.19	1631190.14	14549338.12	40°03'43.458"N	105°01'58.713"W	1.12	FIRST SURFACE MWD+IFR1 SURVEY
139.00	1.270	79.560	138.99	0.21	0.23	1.23	1631190.19	14549338.13	40°03'43.458"N	105°01'58.712"W	1.12	
171.00	0.970	78.070	170.98	0.32	0.35	1.85	1631190.80	14549338.25	40°03'43.459"N	105°01'58.704"W	0.94	
203.00	0.660	81.580	202.98	0.40	0.43	2.29	1631191.25	14549338.33	40°03'43.460"N	105°01'58.699"W	0.98	
234.00	0.700	76.570	233.98	0.46	0.50	2.65	1631191.61	14549338.40	40°03'43.461"N	105°01'58.694"W	0.23	
265.00	0.480	170.440	264.98	0.38	0.42	2.86	1631191.81	14549338.32	40°03'43.460"N	105°01'58.691"W	2.82	
296.00	0.620	210.600	295.98	0.10	0.14	2.80	1631191.75	14549338.05	40°03'43.457"N	105°01'58.692"W	1.29	
328.00	0.830	190.570	327.97	-0.27	-0.23	2.66	1631191.62	14549337.67	40°03'43.454"N	105°01'58.694"W	1.02	
359.00	0.750	204.980	358.97	-0.67	-0.64	2.54	1631191.49	14549337.27	40°03'43.450"N	105°01'58.695"W	0.69	
391.00	1.540	197.330	390.96	-1.27	-1.24	2.32	1631191.27	14549336.67	40°03'43.444"N	105°01'58.698"W	2.51	
423.00	2.460	182.740	422.95	-2.36	-2.33	2.16	1631191.11	14549335.57	40°03'43.433"N	105°01'58.700"W	3.26	
454.00	2.810	183.800	453.91	-3.79	-3.76	2.08	1631191.03	14549334.15	40°03'43.419"N	105°01'58.701"W	1.14	
486.00	4.000	187.310	485.86	-5.67	-5.65	1.88	1631190.84	14549332.26	40°03'43.400"N	105°01'58.704"W	3.77	
518.00	4.440	189.070	517.77	-8.00	-7.98	1.55	1631190.50	14549329.93	40°03'43.377"N	105°01'58.708"W	1.43	
549.00	5.320	185.380	548.66	-10.61	-10.59	1.22	1631190.17	14549327.32	40°03'43.351"N	105°01'58.712"W	3.01	
582.00	6.420	183.970	581.48	-13.97	-13.96	0.95	1631189.90	14549323.95	40°03'43.318"N	105°01'58.716"W	3.36	
613.00	6.940	182.390	612.27	-17.57	-17.56	0.75	1631189.70	14549320.36	40°03'43.282"N	105°01'58.718"W	1.78	
645.00	7.160	180.020	644.03	-21.49	-21.48	0.67	1631189.62	14549316.43	40°03'43.244"N	105°01'58.719"W	1.14	
677.00	7.730	182.390	675.76	-25.63	-25.63	0.58	1631189.53	14549312.29	40°03'43.203"N	105°01'58.721"W	2.02	
709.00	8.260	186.260	707.45	-30.06	-30.06	0.24	1631189.19	14549307.85	40°03'43.159"N	105°01'58.725"W	2.36	
740.00	8.880	187.750	738.10	-34.64	-34.65	-0.32	1631188.62	14549303.27	40°03'43.114"N	105°01'58.732"W	2.12	
772.00	9.800	187.930	769.68	-39.77	-39.79	-1.03	1631187.91	14549298.13	40°03'43.063"N	105°01'58.741"W	2.88	
804.00	11.210	188.020	801.14	-45.54	-45.57	-1.84	1631187.10	14549292.35	40°03'43.006"N	105°01'58.752"W	4.41	
836.00	12.040	189.420	832.48	-51.90	-51.94	-2.82	1631186.11	14549285.99	40°03'42.943"N	105°01'58.764"W	2.74	
867.00	12.660	187.140	862.77	-58.44	-58.50	-3.77	1631185.16	14549279.43	40°03'42.878"N	105°01'58.777"W	2.54	
899.00	12.960	186.350	893.97	-65.48	-65.55	-4.61	1631184.33	14549272.39	40°03'42.808"N	105°01'58.787"W	1.09	
931.00	12.830	185.990	925.16	-72.57	-72.65	-5.37	1631183.56	14549265.29	40°03'42.738"N	105°01'58.797"W	0.48	
963.00	13.010	185.990	956.35	-79.67	-79.76	-6.12	1631182.81	14549258.18	40°03'42.668"N	105°01'58.807"W	0.56	
994.00	13.800	184.060	986.51	-86.82	-86.92	-6.75	1631182.18	14549251.02	40°03'42.597"N	105°01'58.815"W	2.93	
1026.00	14.590	182.920	1017.53	-94.64	-94.75	-7.22	1631181.70	14549243.19	40°03'42.520"N	105°01'58.821"W	2.62	
1058.00	14.850	183.010	1048.48	-102.76	-102.87	-7.64	1631181.28	14549235.07	40°03'42.439"N	105°01'58.826"W	0.82	
1089.00	15.340	181.780	1078.41	-110.82	-110.94	-7.98	1631180.94	14549227.01	40°03'42.360"N	105°01'58.831"W	1.89	
1121.00	16.040	183.010	1109.22	-119.46	-119.59	-8.34	1631180.57	14549218.37	40°03'42.274"N	105°01'58.835"W	2.42	
1153.00	16.300	183.270	1139.95	-128.35	-128.48	-8.83	1631180.08	14549209.48	40°03'42.186"N	105°01'58.842"W	0.84	
1185.00	17.050	182.040	1170.61	-137.51	-137.66	-9.25	1631179.65	14549200.31	40°03'42.096"N	105°01'58.847"W	2.59	
1216.00	17.450	183.010	1200.21	-146.69	-146.84	-9.66	1631179.24	14549191.13	40°03'42.005"N	105°01'58.852"W	1.59	
1248.00	18.020	183.270	1230.69	-156.41	-156.57	-10.19	1631178.71	14549181.40	40°03'41.909"N	105°01'58.859"W	1.80	
1280.00	18.110	182.830	1261.11	-166.32	-166.48	-10.72	1631178.18	14549171.49	40°03'41.811"N	105°01'58.866"W	0.51	
1312.00	18.280	183.450	1291.51	-176.28	-176.46	-11.27	1631177.62	14549161.52	40°03'41.712"N	105°01'58.873"W	0.81	
1343.00	18.590	184.060	1320.92	-186.06	-186.24	-11.91	1631176.98	14549151.74	40°03'41.616"N	105°01'58.881"W	1.18	
1375.00	18.980	184.060	1351.22	-196.32	-196.52	-12.64	1631176.25	14549141.47	40°03'41.514"N	105°01'58.891"W	1.22	
1407.00	19.420	183.800	1381.44	-206.81	-207.02	-13.36	1631175.52	14549130.98	40°03'41.410"N	105°01'58.900"W	1.40	
1438.00	19.510	184.320	1410.67	-217.10	-217.32	-14.09	1631174.79	14549120.68	40°03'41.308"N	105°01'58.909"W	0.63	

REFERENCE WELLPATH IDENTIFICATION			
Operator	KERR-MCGEE OIL & GAS ONSHORE LP (WA)	Slot	SLOT#10 PAPA JO 2-25 29N-8HZ(1405'FSL & 1219'FWL,SEC.08)
Area	COLORADO	Well	PAPA JO 2-25 29N-8HZ
Field	WELD COUNTY (UTM/TRUE NORTH)	Wellbore	PAPA JO 2-25 29N-8HZ AWB
Facility	SEC.08-T1N-R68W		

WELLPATH DATA (196 stations) † = interpolated/extrapolated station												
MD (ft)	Inclination (°)	Azimuth (°)	TVD (ft)	Vert Sect (ft)	North (ft)	East (ft)	Grid East (US ft)	Grid North (US ft)	Latitude	Longitude	DLS (°/100ft)	Comments
1470.00	19.690	183.800	1440.81	-227.80	-228.03	-14.85	1631174.02	14549109.97	40°03'41.203"N	105°01'58.919"W	0.78	
1502.00	19.940	184.680	1470.92	-238.61	-238.85	-15.66	1631173.22	14549099.16	40°03'41.096"N	105°01'58.929"W	1.22	
1533.00	19.560	186.260	1500.10	-249.02	-249.27	-16.65	1631172.22	14549088.74	40°03'40.993"N	105°01'58.942"W	2.11	
1565.00	19.510	186.430	1530.25	-259.63	-259.91	-17.84	1631171.03	14549078.11	40°03'40.888"N	105°01'58.957"W	0.24	
1597.00	18.540	187.490	1560.51	-269.97	-270.26	-19.10	1631169.76	14549067.76	40°03'40.785"N	105°01'58.974"W	3.22	
1629.00	18.110	187.580	1590.88	-279.92	-280.24	-20.42	1631168.44	14549057.79	40°03'40.687"N	105°01'58.991"W	1.35	
1660.00	18.060	186.170	1620.35	-289.46	-289.79	-21.57	1631167.29	14549048.24	40°03'40.592"N	105°01'59.005"W	1.42	
1692.00	18.280	187.230	1650.76	-299.35	-299.70	-22.73	1631166.12	14549038.33	40°03'40.494"N	105°01'59.020"W	1.24	
1724.00	18.240	186.260	1681.14	-309.29	-309.66	-23.91	1631164.94	14549028.38	40°03'40.396"N	105°01'59.036"W	0.96	
1756.00	17.930	186.260	1711.56	-319.15	-319.53	-24.99	1631163.85	14549018.51	40°03'40.298"N	105°01'59.049"W	0.97	
1787.00	17.840	185.730	1741.07	-328.60	-329.00	-25.99	1631162.85	14549009.05	40°03'40.205"N	105°01'59.062"W	0.60	
1819.00	18.190	186.520	1771.50	-338.43	-338.84	-27.05	1631161.79	14548999.21	40°03'40.108"N	105°01'59.076"W	1.33	
1843.00†	18.476	186.280	1794.28	-345.92	-346.34	-27.89	1631160.95	14548991.71	40°03'40.033"N	105°01'59.087"W	1.23	LAST SURFACE MWD+IFR1 SURVEY
1845.00	18.500	186.260	1796.17	-346.55	-346.97	-27.96	1631160.88	14548991.08	40°03'40.027"N	105°01'59.088"W	1.23	
1932.00†	18.617	185.820	1878.65	-374.04	-374.51	-30.87	1631157.96	14548963.56	40°03'39.755"N	105°01'59.125"W	0.21	FIRST BHGE MWD+IFR1+SC SURVEY
1934.00	18.620	185.810	1880.55	-374.67	-375.14	-30.93	1631157.89	14548962.92	40°03'39.749"N	105°01'59.126"W	0.21	
2024.00	19.680	187.470	1965.57	-403.95	-404.46	-34.36	1631154.46	14548933.62	40°03'39.459"N	105°01'59.170"W	1.32	
2113.00	21.130	184.970	2048.98	-434.74	-435.31	-37.70	1631151.11	14548902.79	40°03'39.154"N	105°01'59.213"W	1.90	
2203.00	21.590	184.030	2132.80	-467.38	-467.99	-40.27	1631148.53	14548870.12	40°03'38.831"N	105°01'59.246"W	0.64	
2292.00	22.060	181.780	2215.42	-500.39	-501.03	-41.94	1631146.85	14548837.10	40°03'38.505"N	105°01'59.267"W	1.08	
2382.00	22.420	178.560	2298.73	-534.44	-535.08	-42.03	1631146.74	14548803.06	40°03'38.168"N	105°01'59.269"W	1.41	
2471.00	22.120	178.890	2381.09	-568.16	-568.80	-41.28	1631147.48	14548769.35	40°03'37.835"N	105°01'59.259"W	0.37	
2561.00	21.830	180.470	2464.55	-601.84	-602.47	-41.09	1631147.66	14548735.69	40°03'37.502"N	105°01'59.256"W	0.73	
2650.00	21.970	182.090	2547.13	-635.01	-635.66	-41.83	1631146.91	14548702.52	40°03'37.174"N	105°01'59.266"W	0.70	
2740.00	22.440	182.800	2630.45	-668.97	-669.64	-43.28	1631145.44	14548668.55	40°03'36.839"N	105°01'59.285"W	0.60	
2830.00	21.610	184.280	2713.89	-702.62	-703.32	-45.36	1631143.35	14548634.88	40°03'36.506"N	105°01'59.311"W	1.11	
2919.00	21.870	184.780	2796.56	-735.44	-736.18	-47.96	1631140.74	14548602.04	40°03'36.181"N	105°01'59.345"W	0.36	
3009.00	22.660	183.750	2879.85	-769.41	-770.19	-50.50	1631138.19	14548568.05	40°03'35.845"N	105°01'59.377"W	0.98	
3098.00	22.040	182.970	2962.16	-803.16	-803.97	-52.48	1631136.20	14548534.28	40°03'35.511"N	105°01'59.403"W	0.77	
3188.00	21.890	181.950	3045.63	-836.77	-837.60	-53.93	1631134.74	14548500.66	40°03'35.179"N	105°01'59.422"W	0.46	
3277.00	22.030	183.120	3128.17	-869.99	-870.85	-55.40	1631133.25	14548467.42	40°03'34.850"N	105°01'59.440"W	0.52	
3367.00	21.890	181.880	3211.64	-903.59	-904.47	-56.87	1631131.77	14548433.82	40°03'34.518"N	105°01'59.459"W	0.54	
3457.00	22.060	184.750	3295.10	-937.17	-938.09	-58.82	1631129.81	14548400.22	40°03'34.186"N	105°01'59.484"W	1.21	
3546.00	20.200	181.030	3378.12	-969.17	-970.11	-60.48	1631128.14	14548368.21	40°03'33.869"N	105°01'59.506"W	2.58	
3636.00	20.820	183.110	3462.42	-1000.66	-1001.62	-61.63	1631126.98	14548336.71	40°03'33.558"N	105°01'59.521"W	1.06	
3725.00	22.660	184.730	3545.08	-1033.51	-1034.50	-63.90	1631124.70	14548303.85	40°03'33.233"N	105°01'59.550"W	2.17	
3815.00	22.670	183.200	3628.13	-1068.06	-1069.09	-66.30	1631122.29	14548269.27	40°03'32.891"N	105°01'59.581"W	0.66	
3904.00	22.170	184.470	3710.41	-1101.90	-1102.96	-68.56	1631120.01	14548235.41	40°03'32.556"N	105°01'59.610"W	0.78	
3994.00	22.140	181.170	3793.76	-1135.76	-1136.85	-70.23	1631118.33	14548201.54	40°03'32.221"N	105°01'59.631"W	1.38	
4083.00	23.190	181.980	3875.89	-1170.02	-1171.13	-71.18	1631117.37	14548167.27	40°03'31.883"N	105°01'59.643"W	1.23	
4173.00	22.770	182.330	3958.75	-1205.11	-1206.24	-72.50	1631116.04	14548132.18	40°03'31.536"N	105°01'59.660"W	0.49	
4263.00	21.890	182.620	4042.00	-1239.25	-1240.40	-73.98	1631114.55	14548098.03	40°03'31.198"N	105°01'59.679"W	0.99	
4352.00	22.200	182.430	4124.49	-1272.60	-1273.77	-75.45	1631113.07	14548064.67	40°03'30.868"N	105°01'59.698"W	0.36	
4442.00	22.400	184.900	4207.76	-1306.64	-1307.85	-77.63	1631110.87	14548030.61	40°03'30.532"N	105°01'59.726"W	1.06	
4531.00	22.760	183.300	4289.94	-1340.68	-1341.93	-80.07	1631108.42	14547996.54	40°03'30.195"N	105°01'59.758"W	0.80	

REFERENCE WELLPATH IDENTIFICATION			
Operator	KERR-MCGEE OIL & GAS ONSHORE LP (WA)	Slot	SLOT#10 PAPA JO 2-25 29N-8HZ(1405'FSL & 1219'FWL,SEC.08)
Area	COLORADO	Well	PAPA JO 2-25 29N-8HZ
Field	WELD COUNTY (UTM/TRUE NORTH)	Wellbore	PAPA JO 2-25 29N-8HZ AWP
Facility	SEC.08-T1N-R68W		

WELLPATH DATA (196 stations) † = interpolated/extrapolated station												
MD (ft)	Inclination (°)	Azimuth (°)	TVD (ft)	Vert Sect (ft)	North (ft)	East (ft)	Grid East (US ft)	Grid North (US ft)	Latitude	Longitude	DLS (r/100ft)	Comments
4621.00	22.650	181.190	4372.97	-1375.37	-1376.64	-81.43	1631107.04	14547961.85	40°03'29.852"N	105°01'59.775"W	0.91	
4710.00	21.620	183.380	4455.41	-1408.85	-1410.14	-82.76	1631105.71	14547928.36	40°03'29.521"N	105°01'59.792"W	1.48	
4799.00	20.320	184.070	4538.51	-1440.60	-1441.92	-84.82	1631103.63	14547896.59	40°03'29.207"N	105°01'59.819"W	1.49	
4914.00	22.110	183.560	4645.71	-1482.08	-1483.44	-87.58	1631100.86	14547855.09	40°03'28.796"N	105°01'59.854"W	1.56	
5004.00	22.030	181.970	4729.12	-1515.83	-1517.22	-89.21	1631099.21	14547821.33	40°03'28.463"N	105°01'59.875"W	0.67	
5093.00	22.600	182.970	4811.45	-1549.56	-1550.98	-90.67	1631097.74	14547787.58	40°03'28.129"N	105°01'59.894"W	0.77	
5183.00	21.020	182.230	4895.01	-1582.94	-1584.38	-92.20	1631096.21	14547754.20	40°03'27.799"N	105°01'59.914"W	1.78	
5272.00	21.680	183.880	4977.90	-1615.26	-1616.73	-93.93	1631094.46	14547721.86	40°03'27.479"N	105°01'59.936"W	1.00	
5361.00	21.710	180.770	5060.60	-1648.10	-1649.59	-95.27	1631093.12	14547689.01	40°03'27.154"N	105°01'59.953"W	1.29	
5451.00	22.030	182.260	5144.12	-1681.60	-1683.11	-96.15	1631092.22	14547655.51	40°03'26.823"N	105°01'59.965"W	0.71	
5540.00	22.190	183.530	5226.58	-1715.03	-1716.56	-97.85	1631090.51	14547622.07	40°03'26.493"N	105°01'59.986"W	0.57	
5630.00	21.960	183.490	5309.98	-1748.75	-1750.32	-99.92	1631088.43	14547588.33	40°03'26.159"N	105°02'00.013"W	0.26	
5719.00	21.490	185.830	5392.66	-1781.54	-1783.15	-102.59	1631086.75	14547555.51	40°03'25.835"N	105°02'00.047"W	1.11	
5809.00	19.590	184.110	5476.94	-1812.95	-1814.60	-105.34	1631082.98	14547524.07	40°03'25.524"N	105°02'00.083"W	2.21	
5898.00	18.060	182.340	5561.17	-1841.60	-1843.27	-106.98	1631081.34	14547495.42	40°03'25.240"N	105°02'00.104"W	1.83	
5988.00	16.980	181.800	5647.00	-1868.65	-1870.34	-107.96	1631080.35	14547468.35	40°03'24.973"N	105°02'00.116"W	1.21	
6078.00	15.090	180.930	5733.49	-1893.49	-1895.19	-108.56	1631079.73	14547443.51	40°03'24.727"N	105°02'00.124"W	2.12	
6167.00	13.830	179.400	5819.67	-1915.71	-1917.42	-108.64	1631079.65	14547421.30	40°03'24.508"N	105°02'00.125"W	1.48	
6257.00	12.550	179.300	5907.30	-1936.25	-1937.95	-108.41	1631079.87	14547400.77	40°03'24.305"N	105°02'00.122"W	1.42	
6346.00	10.860	180.320	5994.44	-1954.30	-1956.00	-108.34	1631079.94	14547382.73	40°03'24.126"N	105°02'00.121"W	1.91	
6436.00	8.830	179.160	6083.11	-1969.69	-1971.39	-108.28	1631079.99	14547367.35	40°03'23.974"N	105°02'00.121"W	2.27	
6525.00	6.370	175.410	6171.32	-1981.45	-1983.14	-107.79	1631080.48	14547355.60	40°03'23.858"N	105°02'00.114"W	2.82	
6615.00	4.950	180.570	6260.88	-1990.31	-1992.00	-107.42	1631080.84	14547346.74	40°03'23.771"N	105°02'00.110"W	1.67	
6704.00	4.620	178.480	6349.57	-1997.73	-1999.43	-107.37	1631080.89	14547339.32	40°03'23.697"N	105°02'00.109"W	0.42	
6793.00	2.980	180.370	6438.37	-2003.63	-2005.32	-107.29	1631080.97	14547333.43	40°03'23.639"N	105°02'00.108"W	1.85	
6883.00	1.370	144.900	6528.31	-2006.86	-2008.54	-106.68	1631081.57	14547330.21	40°03'23.607"N	105°02'00.100"W	2.25	
6972.00	1.360	155.120	6617.29	-2008.70	-2010.37	-105.63	1631082.62	14547328.38	40°03'23.589"N	105°02'00.086"W	0.27	
7062.00	0.800	114.020	6707.27	-2009.94	-2011.60	-104.60	1631083.65	14547327.16	40°03'23.577"N	105°02'00.073"W	1.02	
7152.00	0.960	130.800	6797.26	-2010.71	-2012.35	-103.46	1631084.79	14547326.41	40°03'23.570"N	105°02'00.059"W	0.34	
7241.00	1.330	152.570	6886.24	-2012.12	-2013.75	-102.42	1631085.83	14547325.00	40°03'23.556"N	105°02'00.045"W	0.63	
7268.00†	1.322	42.732	6913.24	-2012.18	-2013.80	-102.06	1631086.19	14547324.95	40°03'23.555"N	105°02'00.041"W	8.04	KOP
7331.00	6.190	14.570	6976.09	-2008.37	-2009.98	-100.72	1631087.53	14547328.77	40°03'23.593"N	105°02'00.023"W	8.04	
7421.00	18.500	7.690	7063.84	-1989.50	-1991.06	-97.57	1631090.68	14547347.69	40°03'23.780"N	105°01'59.983"W	13.75	
7510.00	22.190	2.400	7147.28	-1958.74	-1960.26	-94.98	1631093.29	14547378.47	40°03'24.084"N	105°01'59.949"W	4.63	
7599.00	28.620	357.550	7227.64	-1920.61	-1922.13	-95.19	1631093.10	14547416.59	40°03'24.461"N	105°01'59.952"W	7.59	
7689.00	33.500	357.790	7304.71	-1874.21	-1875.74	-97.07	1631091.23	14547462.95	40°03'24.919"N	105°01'59.976"W	5.42	
7778.00	37.860	358.530	7376.99	-1822.32	-1823.87	-98.71	1631089.60	14547514.80	40°03'25.432"N	105°01'59.998"W	4.92	
7868.00	44.230	359.290	7444.83	-1763.25	-1764.82	-99.81	1631088.53	14547573.84	40°03'26.016"N	105°02'00.012"W	7.10	
7958.00	48.730	358.430	7506.79	-1698.01	-1699.59	-101.13	1631087.24	14547639.04	40°03'26.660"N	105°02'00.029"W	5.05	
8047.00	54.080	356.310	7562.30	-1628.52	-1630.13	-104.37	1631084.03	14547708.47	40°03'27.347"N	105°02'00.070"W	6.29	
8137.00	60.570	358.090	7610.86	-1552.85	-1554.51	-108.02	1631080.40	14547784.06	40°03'28.094"N	105°02'00.117"W	7.40	
8226.00	67.010	0.660	7650.15	-1473.05	-1474.72	-108.84	1631079.61	14547863.82	40°03'28.883"N	105°02'00.128"W	7.68	
8316.00	73.040	0.870	7680.89	-1388.54	-1390.18	-107.71	1631080.77	14547948.33	40°03'29.718"N	105°02'00.113"W	6.70	
8406.00	78.530	0.260	7702.98	-1301.35	-1302.97	-106.86	1631081.66	14548035.50	40°03'30.580"N	105°02'00.102"W	6.14	
8493.00†	91.218	359.497	7710.73	-1214.88	-1216.50	-107.05	1631081.50	14548121.94	40°03'31.434"N	105°02'00.105"W	14.61	LANDING (188'FSL & 1112'FWL,SEC.08) 40.0587318 -105.0333624

REFERENCE WELLPATH IDENTIFICATION			
Operator	KERR-MCGEE OIL & GAS ONSHORE LP (WA)	Slot	SLOT#10 PAPA JO 2-25 29N-8HZ(1405'FSL & 1219'FWL,SEC.08)
Area	COLORADO	Well	PAPA JO 2-25 29N-8HZ
Field	WELD COUNTY (UTM/TRUE NORTH)	Wellbore	PAPA JO 2-25 29N-8HZ AWP
Facility	SEC.08-T1N-R68W		

WELLPATH DATA (196 stations) † = interpolated/extrapolated station												
MD (ft)	Inclination (°)	Azimuth (°)	TVD (ft)	Vert Sect (ft)	North (ft)	East (ft)	Grid East (US ft)	Grid North (US ft)	Latitude	Longitude	DLS (°/100ft)	Comments
8495.00	91.510	359.480	7710.69	-1212.88	-1214.50	-107.07	1631081.48	14548123.94	40°03'31.454"N	105°02'00.105"W	14.61	
8585.00	91.140	358.920	7708.61	-1122.91	-1124.53	-108.32	1631080.26	14548213.87	40°03'32.343"N	105°02'00.121"W	0.75	
8669.00†	90.064	359.222	7707.72	-1038.91	-1040.55	-109.68	1631078.93	14548297.82	40°03'33.173"N	105°02'00.139"W	1.33	EXIT RADIUS HEEL (364'FSL & 1108'FWL,SEC.08) 40.0592147 -105.0333718
8674.00	90.000	359.240	7707.72	-1033.91	-1035.55	-109.75	1631078.87	14548302.81	40°03'33.222"N	105°02'00.139"W	1.33	
8764.00	89.660	358.190	7707.99	-943.92	-945.57	-111.77	1631076.88	14548392.75	40°03'34.112"N	105°02'00.165"W	1.23	
8853.00	88.860	356.890	7709.14	-854.97	-856.66	-115.59	1631073.10	14548481.63	40°03'34.990"N	105°02'00.215"W	1.71	
8943.00	90.860	359.930	7709.36	-764.99	-766.71	-118.08	1631070.63	14548571.54	40°03'35.879"N	105°02'00.247"W	4.04	
9033.00	91.380	359.500	7707.60	-675.01	-676.73	-118.53	1631070.22	14548661.49	40°03'36.768"N	105°02'00.252"W	0.75	
9122.00	90.310	0.550	7706.29	-586.03	-587.75	-118.49	1631070.29	14548750.44	40°03'37.648"N	105°02'00.252"W	1.68	
9212.00	90.830	1.260	7705.39	-496.08	-497.76	-117.07	1631071.75	14548840.39	40°03'38.537"N	105°02'00.234"W	0.98	
9301.00	88.950	0.600	7705.56	-407.12	-408.78	-115.63	1631073.22	14548929.33	40°03'39.416"N	105°02'00.215"W	2.24	
9390.00	89.110	0.580	7707.07	-318.16	-319.80	-114.71	1631074.17	14549018.28	40°03'40.296"N	105°02'00.203"W	0.18	
9480.00	90.150	0.720	7707.65	-228.19	-229.80	-113.69	1631075.23	14549108.24	40°03'41.185"N	105°02'00.190"W	1.17	
9569.00	90.220	0.770	7707.36	-139.23	-140.81	-112.53	1631076.41	14549197.19	40°03'42.064"N	105°02'00.175"W	0.10	
9659.00	90.180	358.940	7707.05	-49.24	-50.82	-112.76	1631076.22	14549287.15	40°03'42.954"N	105°02'00.178"W	2.03	
9749.00	88.950	357.820	7707.73	40.75	39.14	-115.30	1631073.71	14549377.07	40°03'43.843"N	105°02'00.211"W	1.85	
9838.00	89.010	357.940	7709.31	129.71	128.07	-118.60	1631070.45	14549465.96	40°03'44.722"N	105°02'00.253"W	0.15	
9928.00	89.230	357.400	7710.70	219.67	217.98	-122.26	1631066.83	14549555.84	40°03'45.610"N	105°02'00.300"W	0.65	
10017.00	89.380	357.080	7711.78	308.61	306.87	-126.54	1631062.58	14549644.70	40°03'46.489"N	105°02'00.355"W	0.40	
10107.00	89.660	356.750	7712.53	398.53	396.74	-131.38	1631057.77	14549734.53	40°03'47.377"N	105°02'00.418"W	0.48	
10197.00	88.460	358.080	7714.01	488.47	486.63	-135.44	1631053.75	14549824.39	40°03'48.265"N	105°02'00.470"W	1.99	
10286.00	88.670	358.040	7716.24	577.43	575.55	-138.45	1631050.77	14549913.28	40°03'49.144"N	105°02'00.509"W	0.24	
10376.00	89.050	357.910	7718.03	667.39	665.48	-141.63	1631047.62	14550003.17	40°03'50.032"N	105°02'00.550"W	0.45	
10465.00	88.920	357.590	7719.60	756.35	754.39	-145.13	1631044.16	14550092.05	40°03'50.911"N	105°02'00.595"W	0.39	
10555.00	89.230	357.280	7721.06	846.29	844.29	-149.15	1631040.17	14550181.91	40°03'51.799"N	105°02'00.646"W	0.49	
10645.00	89.600	358.150	7721.97	936.26	934.21	-152.74	1631036.62	14550271.80	40°03'52.688"N	105°02'00.693"W	1.05	
10734.00	89.200	359.620	7722.91	1025.25	1023.19	-154.47	1631034.92	14550360.74	40°03'53.567"N	105°02'00.715"W	1.71	
10824.00	90.030	358.900	7723.51	1115.24	1113.18	-155.64	1631033.79	14550450.69	40°03'54.457"N	105°02'00.730"W	1.22	
10913.00	90.090	358.930	7723.42	1204.24	1202.16	-157.32	1631032.14	14550539.64	40°03'55.336"N	105°02'00.751"W	0.08	
11003.00	89.450	357.530	7723.78	1294.23	1292.12	-160.10	1631029.40	14550629.56	40°03'56.225"N	105°02'00.787"W	1.71	
11092.00	90.310	358.690	7723.97	1383.21	1381.07	-163.04	1631026.49	14550718.48	40°03'57.104"N	105°02'00.825"W	1.62	
11182.00	89.940	359.200	7723.77	1473.21	1471.05	-164.69	1631024.87	14550808.42	40°03'57.993"N	105°02'00.846"W	0.70	
11271.00	90.490	359.740	7723.44	1562.20	1560.04	-165.52	1631024.08	14550897.38	40°03'58.873"N	105°02'00.857"W	0.87	
11361.00	90.650	0.030	7722.54	1652.19	1650.04	-165.70	1631023.93	14550987.34	40°03'59.762"N	105°02'00.859"W	0.37	
11451.00	90.370	0.410	7721.74	1742.17	1740.04	-165.35	1631024.31	14551077.30	40°04'00.651"N	105°02'00.855"W	0.52	
11540.00	90.710	0.840	7720.90	1831.14	1829.03	-164.38	1631025.32	14551166.26	40°04'01.531"N	105°02'00.842"W	0.62	
11630.00	89.880	359.830	7720.44	1921.12	1919.02	-163.86	1631025.88	14551256.22	40°04'02.420"N	105°02'00.836"W	1.45	
11719.00	90.400	359.810	7720.22	2010.12	2008.02	-164.14	1631025.63	14551345.18	40°04'03.300"N	105°02'00.839"W	0.58	
11809.00	90.340	0.370	7719.64	2100.10	2098.02	-163.99	1631025.80	14551435.14	40°04'04.189"N	105°02'00.837"W	0.63	
11899.00	90.370	0.940	7719.08	2190.07	2188.01	-162.96	1631026.87	14551525.10	40°04'05.078"N	105°02'00.824"W	0.63	
11988.00	90.460	0.510	7718.44	2279.04	2277.00	-161.84	1631028.02	14551614.05	40°04'05.958"N	105°02'00.810"W	0.49	
12078.00	90.590	1.150	7717.61	2369.00	2366.99	-160.54	1631029.36	14551704.00	40°04'06.847"N	105°02'00.793"W	0.73	
12167.00	90.400	1.880	7716.84	2457.92	2455.95	-158.18	1631031.75	14551792.93	40°04'07.726"N	105°02'00.763"W	0.85	
12257.00	90.400	2.300	7716.21	2547.80	2545.89	-154.90	1631035.06	14551882.83	40°04'08.615"N	105°02'00.720"W	0.47	
12347.00	89.910	357.980	7715.97	2637.77	2635.87	-154.68	1631035.31	14551972.77	40°04'09.504"N	105°02'00.718"W	4.83	

REFERENCE WELLPATH IDENTIFICATION			
Operator	KERR-MCGEE OIL & GAS ONSHORE LP (WA)	Slot	SLOT#10 PAPA JO 2-25 29N-8HZ(1405'FSL & 1219'FWL,SEC.08)
Area	COLORADO	Well	PAPA JO 2-25 29N-8HZ
Field	WELD COUNTY (UTM/TRUE NORTH)	Wellbore	PAPA JO 2-25 29N-8HZ AWB
Facility	SEC.08-T1N-R68W		

WELLPATH DATA (196 stations) † = interpolated/extrapolated station												
MD [ft]	Inclination [°]	Azimuth [°]	TVD [ft]	Vert Sect [ft]	North [ft]	East [ft]	Grid East [US ft]	Grid North [US ft]	Latitude	Longitude	DLS [°/100ft]	Comments
12436.00	90.180	357.320	7715.90	2726.74	2724.79	-158.33	1631031.70	14552061.66	40°04'10.383"N	105°02'00.765"W	0.80	
12526.00	90.490	357.920	7715.37	2816.70	2814.71	-162.07	1631028.00	14552151.55	40°04'11.272"N	105°02'00.813"W	0.75	
12615.00	90.710	357.330	7714.44	2905.66	2903.63	-165.75	1631024.34	14552240.43	40°04'12.150"N	105°02'00.860"W	0.71	
12705.00	89.380	358.200	7714.37	2995.63	2993.56	-169.26	1631020.87	14552330.32	40°04'13.039"N	105°02'00.905"W	1.77	
12794.00	90.370	358.490	7714.57	3084.62	3082.52	-171.83	1631018.33	14552419.25	40°04'13.918"N	105°02'00.938"W	1.16	
12884.00	88.670	357.890	7715.32	3174.60	3172.47	-174.68	1631015.52	14552509.16	40°04'14.807"N	105°02'00.975"W	2.00	
12973.00	88.950	357.880	7717.17	3263.56	3261.39	-177.96	1631012.27	14552598.05	40°04'15.686"N	105°02'01.017"W	0.31	
13063.00	88.890	357.530	7718.86	3353.51	3351.30	-181.56	1631008.70	14552687.93	40°04'16.574"N	105°02'01.063"W	0.39	
13152.00	89.480	357.100	7720.13	3442.45	3440.19	-185.73	1631004.57	14552776.78	40°04'17.453"N	105°02'01.117"W	0.82	
13242.00	89.570	357.040	7720.88	3532.39	3530.07	-190.33	1631000.00	14552866.63	40°04'18.341"N	105°02'01.176"W	0.12	
13331.00	89.970	357.130	7721.23	3621.32	3618.96	-194.86	1630995.51	14552955.48	40°04'19.219"N	105°02'01.235"W	0.46	
13395.00†	90.496	356.703	7720.97	3685.27	3682.86	-198.30	1630992.10	14553019.36	40°04'19.851"N	105°02'01.279"W	1.06	ENTER RADIUS TOE (299'FNL & 1029'FWL,SEC.08) 40.0721808 -105.0336886
13421.00	90.710	356.530	7720.70	3711.24	3708.82	-199.84	1630990.57	14553045.30	40°04'20.107"N	105°02'01.299"W	1.06	
13510.00	91.140	356.170	7719.26	3800.12	3797.62	-205.50	1630984.94	14553134.08	40°04'20.985"N	105°02'01.371"W	0.63	
13591.00	91.420	355.870	7717.45	3880.98	3878.41	-211.12	1630979.35	14553214.83	40°04'21.783"N	105°02'01.444"W	0.51	LAST BHGE MWD+IFR1+SC SURVEY
13637.00	91.420	355.870	7716.31	3926.89	3924.27	-214.43	1630976.06	14553260.68	40°04'22.236"N	105°02'01.486"W	0.00	PTB (58'FNL & 1014'FWL,SEC.08) 40.0728435 -105.0337462

TARGETS								
Name	TVD [ft]	North [ft]	East [ft]	Grid East [US ft]	Grid North [US ft]	Latitude	Longitude	Shape
SEC.08-T1N-R68W	-2.00	0.00	-15.08	1631173.88	14549337.91	40°03'43.456"N	105°01'58.922"W	polygon
PAPA JO 2-25 29N-8HZ BHL REV-1(50'FNL & 1035'FWL,SEC.08)	7705.00	3931.75	-193.39	1630997.10	14553268.15	40°04'22.310"N	105°02'01.216"W	point
PAPA JO 2-25 29N-8HZ HEEL REV-1(200'FSL & 1024'FWL,SEC.08)	7708.00	-1206.94	-136.60	1631051.96	14548131.51	40°03'31.529"N	105°02'00.485"W	point
PAPA JO 2-25 29N-8HZ HEEL REV-3(150'FSL & 1039'FWL,SEC.08)	7708.00	-1256.93	-121.60	1631066.94	14548081.52	40°03'31.035"N	105°02'00.292"W	point
PAPA JO 2-25 29N-8HZ LANDBOX	7708.00	0.00	0.00	1631188.95	14549337.91	40°03'43.456"N	105°01'58.728"W	polygon
PAPA JO 2-25 29N-8HZ RADIUS 1	7708.00	3982.55	149.53	1631339.90	14553318.80	40°04'22.812"N	105°01'56.805"W	polygon
PAPA JO 2-25 29N-8HZ RADIUS 2	7708.00	-1403.41	172.43	1631360.80	14547935.00	40°03'29.587"N	105°01'56.510"W	polygon

WELLPATH COMPOSITION - Ref Wellbore: PAPA JO 2-25 29N-8HZ AWB Ref Wellpath: PAPA JO 2-25 29N-8HZ AWP					
Start MD [ft]	End MD [ft]	Positional Uncertainty Model		Log Name/Comment	Wellbore
26.00	1845.00	Custom APC	ISCWSA REV 2 MWD+IFR1 (approximation)	Custom APC ISCWSA Rev-2 MWD+IFR1 <139 - 1845>	PAPA JO 2-25 29N-8HZ AWB
1845.00	13591.00	Custom APC	ISCWSA REV 2 MWD+SC	BHGE Custom APC ISCWSA Rev-2 MWD+IFR1+SC <1934 - 13591>	PAPA JO 2-25 29N-8HZ AWB
13591.00	13637.00	Blind Drilling	(std)	Projection to bit	PAPA JO 2-25 29N-8HZ AWB

REFERENCE WELLPATH IDENTIFICATION			
Operator	KERR-MCGEE OIL & GAS ONSHORE LP (WA)	Slot	SLOT#10 PAPA JO 2-25 29N-8HZ(1405'FSL & 1219'FWL,SEC.08)
Area	COLORADO	Well	PAPA JO 2-25 29N-8HZ
Field	WELD COUNTY (UTM/TRUE NORTH)	Wellbore	PAPA JO 2-25 29N-8HZ AWB
Facility	SEC.08-T1N-R68W		

WELLPATH COMMENTS				
MD [ft]	Inclination [°]	Azimuth [°]	TVD [ft]	Comment
137.00	1.248	79.560	136.99	FIRST SURFACE MWD+IFR1 SURVEY
1843.00	18.476	186.280	1794.28	LAST SURFACE MWD+IFR1 SURVEY
1932.00	18.617	185.820	1878.65	FIRST BHGE MWD+IFR1+SC SURVEY
7268.00	1.322	42.732	6913.24	KOP
8493.00	91.218	359.497	7710.73	LANDING (188'FSL & 1112'FWL,SEC.08) 40.0587318 -105.0333624
8669.00	90.064	359.222	7707.72	EXIT RADIUS HEEL (364'FSL & 1108'FWL,SEC.08) 40.0592147 -105.0333718
13395.00	90.496	356.703	7720.97	ENTER RADIUS TOE (299'FNL & 1029'FWL,SEC.08) 40.0721808 -105.0336886
13591.00	91.420	355.870	7717.45	LAST BHGE MWD+IFR1+SC SURVEY
13637.00	91.420	355.870	7716.31	PTB (58'FNL & 1014'FWL,SEC.08) 40.0728435 -105.0337462