

Location:	COLORADO	Slot:	SLOT#16 PAPA JO 2-25 29N3-8HZ(1403FSL & 1354FWL,SEC.08)
Field:	WELD COUNTY (UTM/TRUE NORTH)	Well:	PAPA JO 2-25 29N3-8HZ
Facility:	SEC.08-TTN-R68W	Wellbore:	PAPA JO 2-25 29N3-8HZ PWB
Plot reference wellpath is PAPA JO 2-25 29N3-8HZ PWP Rev.C-0		Grid System: NAD83 / UTM Zone 13 North, US feet	
True vertical depths are referenced to PD 564 (26') (RT)		* = Wellpath was transformed from a different geoid's datum	
Measured depths are referenced to PD 564 (26') (RT)		North Reference: True north	
PD 564 (26') (RT) to Mean Sea Level: 5089 feet		Scale: True distance	
Mean Sea Level to Mud line (At Slot: SLOT#16 PAPA JO 2-25 29N3-8HZ(1403FSL & 1354FWL,SEC.08)) : 0 feet		Depths are in feet	
Coordinates are in feet referenced to Slot		Created by: painstmr on 2018-01-11	
		Database: WA_DEN_Anadarko_Delth	

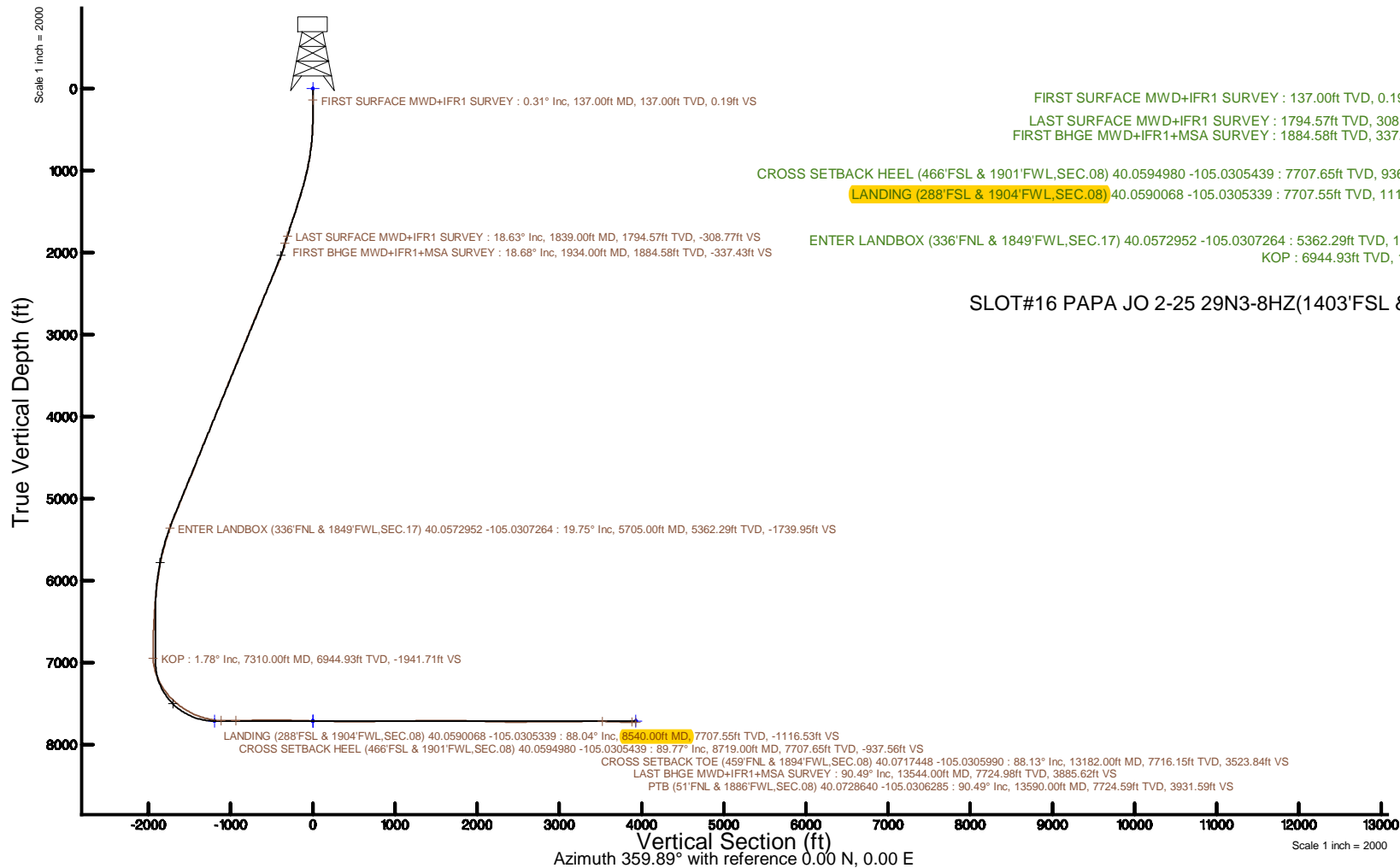

REFERENCE WELLPATH IDENTIFICATION

Operator	KERR-MCGEE OIL & GAS ONSHORE LP (WA)	Slot	SLOT#16 PAPA JO 2-25 29N3-8HZ(1403'FSL & 1354'FWL,SEC.08)
Area	COLORADO	Well	PAPA JO 2-25 29N3-8HZ
Field	WELD COUNTY (UTM/TRUE NORTH)	Wellbore	PAPA JO 2-25 29N3-8HZ AWP
Facility	SEC.08-T1N-R68W		

REPORT SETUP INFORMATION

Projection System	NAD83 / UTM Zone 13 North, US feet	Software System	WellArchitect® 5.0
North Reference	True	User	Painsetr
Scale	0.999600	Report Generated	1/11/2018 at 9:25 AM
Convergence at slot	0.03° West	Database/Source file	WA_DEN_Anadarko_Defn/PAPA_JO_2-25_29N3-8HZ_AWP.xml

WELLPATH LOCATION

	Local coordinates		Grid coordinates		Geographic coordinates	
	North[ft]	East[ft]	Easting[US ft]	Northing[US ft]	Latitude	Longitude
Slot Location	-841.90	-883.97	1631323.80	14549337.05	40°03'43.448"N	105°01'56.993"W
Facility Reference Pt			1632207.69	14550178.32	40°03'51.768"N	105°01'45.624"W
Field Reference Pt			1698235.31	14552047.82	40°04'09.600"N	104°47'36.000"W

WELLPATH DATUM

Calculation method	Minimum curvature	PD 564 (26') (RT) to Facility Vertical Datum	5089.00ft
Horizontal Reference Pt	Slot	PD 564 (26') (RT) to Mean Sea Level	5089.00ft
Vertical Reference Pt	PD 564 (26') (RT)	PD 564 (26') (RT) to Mud Line at Slot (SLOT#16 PAPA JO 2-25 29N3-8HZ(1403'FSL & 1354'FWL,SEC.08))	5089.00ft
MD Reference Pt	PD 564 (26') (RT)	Section Origin	N 0.00, E 0.00 ft
Field Vertical Reference	Mean Sea Level	Section Azimuth	359.89°

REFERENCE WELLPATH IDENTIFICATION

Operator	KERR-MCGEE OIL & GAS ONSHORE LP (WA)	Slot	SLOT#16 PAPA JO 2-25 29N3-8HZ(1403'FSL & 1354'FWL,SEC.08)
Area	COLORADO	Well	PAPA JO 2-25 29N3-8HZ
Field	WELD COUNTY (UTM/TRUE NORTH)	Wellbore	PAPA JO 2-25 29N3-8HZ AWB
Facility	SEC.08-T1N-R68W		

WELLPATH DATA (194 stations) † = interpolated/extrapolated station

MD [ft]	Inclination [°]	Azimuth [°]	TVD [ft]	Vert Sect [ft]	North [ft]	East [ft]	Grid East [US ft]	Grid North [US ft]	Latitude	Longitude	DLS ["/100ft]	Comments
0.00†	0.000	308.430	0.00	0.00	0.00	0.00	1631323.80	14549337.05	40°03'43.448"N	105°01'56.993"W	0.00	
26.00	0.000	308.430	26.00	0.00	0.00	0.00	1631323.80	14549337.05	40°03'43.448"N	105°01'56.993"W	0.00	
137.00	0.310	308.430	137.00	0.19	0.19	-0.24	1631323.57	14549337.23	40°03'43.450"N	105°01'56.996"W	0.28	FIRST SURFACE MWD+IFR1 SURVEY
169.00	0.570	319.500	169.00	0.36	0.36	-0.41	1631323.39	14549337.41	40°03'43.452"N	105°01'56.998"W	0.85	
200.00	0.530	294.980	200.00	0.54	0.54	-0.64	1631323.16	14549337.59	40°03'43.453"N	105°01'57.001"W	0.76	
232.00	0.660	315.370	232.00	0.73	0.73	-0.90	1631322.90	14549337.78	40°03'43.455"N	105°01'57.005"W	0.77	
263.00	0.750	308.070	262.99	0.99	0.99	-1.19	1631322.62	14549338.03	40°03'43.458"N	105°01'57.008"W	0.41	
295.00	0.700	314.490	294.99	1.25	1.25	-1.49	1631322.31	14549338.30	40°03'43.460"N	105°01'57.012"W	0.30	
326.00	0.620	272.650	325.99	1.40	1.39	-1.79	1631322.01	14549338.44	40°03'43.462"N	105°01'57.016"W	1.54	
358.00	0.620	191.970	357.99	1.23	1.23	-2.00	1631321.80	14549338.28	40°03'43.460"N	105°01'57.019"W	2.51	
389.00	1.050	168.240	388.98	0.79	0.79	-1.98	1631321.82	14549337.84	40°03'43.456"N	105°01'57.018"W	1.75	
421.00	1.580	167.980	420.98	0.07	0.07	-1.83	1631321.98	14549337.12	40°03'43.449"N	105°01'57.016"W	1.66	
453.00	2.330	165.340	452.96	-0.99	-0.99	-1.57	1631322.23	14549336.06	40°03'43.438"N	105°01'57.013"W	2.36	
484.00	2.680	177.120	483.93	-2.32	-2.32	-1.37	1631322.43	14549334.72	40°03'43.425"N	105°01'57.011"W	2.00	
516.00	3.030	166.750	515.89	-3.89	-3.90	-1.14	1631322.66	14549333.15	40°03'43.410"N	105°01'57.008"W	1.95	
547.00	3.870	158.400	546.83	-5.66	-5.67	-0.57	1631323.23	14549331.38	40°03'43.392"N	105°01'57.000"W	3.15	
579.00	4.170	156.290	578.75	-7.74	-7.73	0.30	1631324.09	14549329.31	40°03'43.372"N	105°01'56.989"W	1.05	
611.00	5.050	154.790	610.65	-10.08	-10.07	1.36	1631325.16	14549326.98	40°03'43.348"N	105°01'56.975"W	2.78	
643.00	6.110	152.510	642.50	-12.86	-12.86	2.75	1631326.54	14549324.19	40°03'43.321"N	105°01'56.958"W	3.38	
675.00	7.030	156.110	674.29	-16.17	-16.16	4.33	1631328.12	14549320.89	40°03'43.288"N	105°01'56.937"W	3.15	
706.00	7.510	156.990	705.04	-19.77	-19.76	5.89	1631329.68	14549317.29	40°03'43.253"N	105°01'56.917"W	1.59	
738.00	7.650	158.490	736.76	-23.68	-23.67	7.49	1631331.28	14549313.39	40°03'43.214"N	105°01'56.897"W	0.76	
770.00	8.530	158.310	768.44	-27.87	-27.85	9.15	1631332.93	14549309.20	40°03'43.173"N	105°01'56.875"W	2.75	
802.00	9.450	159.280	800.05	-32.54	-32.52	10.95	1631334.74	14549304.54	40°03'43.127"N	105°01'56.852"W	2.91	
834.00	10.240	161.390	831.57	-37.69	-37.67	12.79	1631336.57	14549299.39	40°03'43.076"N	105°01'56.829"W	2.71	
865.00	10.680	163.230	862.06	-43.06	-43.03	14.50	1631338.28	14549294.03	40°03'43.023"N	105°01'56.807"W	1.78	
897.00	10.630	164.110	893.51	-48.74	-48.71	16.16	1631339.94	14549288.35	40°03'42.967"N	105°01'56.785"W	0.53	
929.00	10.990	164.550	924.94	-54.52	-54.49	17.78	1631341.56	14549282.58	40°03'42.910"N	105°01'56.764"W	1.15	
960.00	11.950	164.550	955.32	-60.46	-60.43	19.42	1631343.19	14549276.64	40°03'42.851"N	105°01'56.743"W	3.10	
992.00	12.610	164.020	986.59	-67.02	-66.98	21.27	1631345.04	14549270.09	40°03'42.786"N	105°01'56.719"W	2.09	
1024.00	12.610	163.490	1017.82	-73.73	-73.69	23.22	1631346.99	14549263.38	40°03'42.720"N	105°01'56.694"W	0.36	
1056.00	13.050	164.370	1049.02	-80.56	-80.51	25.19	1631348.95	14549256.56	40°03'42.652"N	105°01'56.669"W	1.50	
1087.00	14.150	163.930	1079.15	-87.58	-87.53	27.18	1631350.94	14549249.55	40°03'42.583"N	105°01'56.643"W	3.56	
1119.00	15.030	164.200	1110.11	-95.33	-95.28	29.39	1631353.15	14549241.80	40°03'42.506"N	105°01'56.615"W	2.76	
1151.00	15.780	164.900	1140.96	-103.53	-103.47	31.66	1631355.41	14549233.61	40°03'42.425"N	105°01'56.586"W	2.41	
1182.00	16.220	163.580	1170.76	-111.76	-111.69	33.98	1631357.72	14549225.39	40°03'42.344"N	105°01'56.556"W	1.84	
1214.00	16.740	164.900	1201.45	-120.50	-120.43	36.44	1631360.18	14549216.65	40°03'42.258"N	105°01'56.524"W	2.00	
1246.00	17.050	163.580	1232.07	-129.45	-129.38	38.97	1631362.71	14549207.70	40°03'42.169"N	105°01'56.492"W	1.54	
1278.00	17.140	163.490	1262.65	-138.48	-138.40	41.63	1631365.37	14549198.69	40°03'42.080"N	105°01'56.458"W	0.29	
1310.00	17.310	163.760	1293.22	-147.58	-147.49	44.31	1631368.04	14549189.60	40°03'41.990"N	105°01'56.423"W	0.59	
1341.00	17.450	163.320	1322.80	-156.46	-156.37	46.93	1631370.65	14549180.72	40°03'41.903"N	105°01'56.389"W	0.62	
1373.00	17.890	163.320	1353.29	-165.77	-165.68	49.72	1631373.44	14549171.42	40°03'41.811"N	105°01'56.354"W	1.37	
1405.00	18.190	163.060	1383.72	-175.26	-175.16	52.58	1631376.30	14549161.93	40°03'41.717"N	105°01'56.317"W	0.97	
1437.00	18.280	162.880	1414.11	-184.84	-184.74	55.52	1631379.23	14549152.36	40°03'41.622"N	105°01'56.279"W	0.33	
1468.00	18.410	162.000	1443.54	-194.15	-194.04	58.46	1631382.17	14549143.06	40°03'41.530"N	105°01'56.241"W	0.99	

REFERENCE WELLPATH IDENTIFICATION			
Operator	KERR-MCGEE OIL & GAS ONSHORE LP (WA)	Slot	SLOT#16 PAPA JO 2-25 29N3-8HZ(1403'FSL & 1354'FWL,SEC.08)
Area	COLORADO	Well	PAPA JO 2-25 29N3-8HZ
Field	WELD COUNTY (UTM/TRUE NORTH)	Wellbore	PAPA JO 2-25 29N3-8HZ AWB
Facility	SEC.08-T1N-R68W		

WELLPATH DATA (194 stations)												
MD [ft]	Inclination [°]	Azimuth [°]	TVD [ft]	Vert Sect [ft]	North [ft]	East [ft]	Grid East [US ft]	Grid North [US ft]	Latitude	Longitude	DLS [°/100ft]	Comments
1500.00	18.330	161.470	1473.91	-203.73	-203.62	61.62	1631385.32	14549133.49	40°03'41.436"N	105°01'56.200"W	0.58	
1531.00	18.540	160.770	1503.32	-213.01	-212.89	64.79	1631388.49	14549124.22	40°03'41.344"N	105°01'56.160"W	0.98	
1563.00	19.030	161.560	1533.61	-222.77	-222.64	68.12	1631391.81	14549114.47	40°03'41.248"N	105°01'56.117"W	1.73	
1595.00	19.200	162.880	1563.85	-232.76	-232.62	71.32	1631395.01	14549104.49	40°03'41.149"N	105°01'56.076"W	1.45	
1627.00	19.420	161.740	1594.05	-242.84	-242.70	74.53	1631398.22	14549094.41	40°03'41.050"N	105°01'56.034"W	1.36	
1658.00	19.420	161.650	1623.28	-252.63	-252.49	77.77	1631401.45	14549084.63	40°03'40.953"N	105°01'55.993"W	0.10	
1690.00	19.380	164.640	1653.47	-262.81	-262.66	80.85	1631404.53	14549074.47	40°03'40.852"N	105°01'55.953"W	3.11	
1722.00	19.250	165.160	1683.67	-273.03	-272.88	83.61	1631407.28	14549064.25	40°03'40.751"N	105°01'55.918"W	0.67	
1754.00	18.590	164.990	1713.94	-283.06	-282.90	86.28	1631409.95	14549054.23	40°03'40.652"N	105°01'55.883"W	2.07	
1785.00	18.330	164.020	1743.34	-292.53	-292.36	88.90	1631412.56	14549044.77	40°03'40.559"N	105°01'55.850"W	1.30	
1817.00	18.410	161.210	1773.71	-302.16	-301.98	91.92	1631415.57	14549035.15	40°03'40.464"N	105°01'55.811"W	2.78	
1839.00	18.630	160.770	1794.57	-308.77	-308.59	94.19	1631417.84	14549028.55	40°03'40.398"N	105°01'55.782"W	1.18	LAST SURFACE MWD+IFR1 SURVEY
1934.00	18.680	160.240	1884.58	-337.43	-337.23	104.33	1631427.97	14548999.91	40°03'40.115"N	105°01'55.651"W	0.19	FIRST BHGE MWD+IFR1+MSA SURVEY
2024.00	18.160	161.700	1969.97	-364.33	-364.11	113.61	1631437.23	14548973.04	40°03'39.850"N	105°01'55.532"W	0.77	
2113.00	20.510	165.790	2053.95	-392.63	-392.40	121.79	1631445.40	14548944.76	40°03'39.570"N	105°01'55.427"W	3.05	
2203.00	22.350	164.120	2137.72	-424.39	-424.15	130.35	1631453.94	14548913.02	40°03'39.256"N	105°01'55.317"W	2.15	
2292.00	23.910	165.060	2219.57	-458.11	-457.85	139.63	1631463.21	14548879.33	40°03'38.923"N	105°01'55.197"W	1.80	
2382.00	24.840	164.370	2301.55	-493.96	-493.68	149.42	1631472.98	14548843.51	40°03'38.569"N	105°01'55.071"W	1.08	
2471.00	23.180	162.910	2382.84	-528.73	-528.43	159.61	1631483.15	14548808.77	40°03'38.226"N	105°01'54.940"W	1.98	
2561.00	23.720	162.400	2465.41	-562.93	-562.61	170.29	1631493.82	14548774.60	40°03'37.888"N	105°01'54.803"W	0.64	
2650.00	23.130	161.080	2547.07	-596.55	-596.21	181.37	1631504.88	14548741.01	40°03'37.556"N	105°01'54.660"W	0.89	
2740.00	23.000	166.580	2629.89	-630.40	-630.04	191.18	1631514.68	14548707.19	40°03'37.222"N	105°01'54.534"W	2.40	
2830.00	24.250	164.920	2712.35	-665.37	-664.99	200.07	1631523.55	14548672.25	40°03'36.876"N	105°01'54.420"W	1.57	
2919.00	22.930	164.420	2793.91	-699.74	-699.34	209.48	1631532.95	14548637.91	40°03'36.537"N	105°01'54.299"W	1.50	
3009.00	22.560	165.290	2876.91	-733.34	-732.93	218.58	1631542.02	14548604.33	40°03'36.205"N	105°01'54.182"W	0.56	
3098.00	23.650	167.510	2958.77	-767.30	-766.87	226.77	1631550.20	14548570.40	40°03'35.870"N	105°01'54.076"W	1.57	
3188.00	21.670	165.930	3041.82	-801.06	-800.62	234.72	1631558.13	14548536.66	40°03'35.536"N	105°01'53.974"W	2.30	
3277.00	23.340	167.730	3124.04	-834.24	-833.79	242.46	1631565.86	14548503.51	40°03'35.208"N	105°01'53.875"W	2.03	
3367.00	23.660	167.130	3206.57	-869.28	-868.81	250.27	1631573.65	14548468.49	40°03'34.862"N	105°01'53.774"W	0.44	
3457.00	21.870	166.560	3289.56	-903.21	-902.73	258.19	1631581.56	14548434.59	40°03'34.527"N	105°01'53.672"W	2.00	
3546.00	22.690	164.210	3371.92	-935.87	-935.37	266.71	1631590.07	14548401.96	40°03'34.204"N	105°01'53.563"W	1.36	
3636.00	23.350	163.420	3454.75	-969.68	-969.17	276.53	1631599.86	14548368.17	40°03'33.870"N	105°01'53.437"W	0.81	
3725.00	23.810	164.190	3536.32	-1003.89	-1003.36	286.45	1631609.77	14548333.99	40°03'33.533"N	105°01'53.309"W	0.62	
3815.00	21.330	163.010	3619.42	-1037.05	-1036.49	296.19	1631619.49	14548300.86	40°03'33.205"N	105°01'53.184"W	2.80	
3904.00	22.780	163.900	3701.90	-1069.10	-1068.53	305.70	1631628.99	14548268.83	40°03'32.889"N	105°01'53.062"W	1.67	
3994.00	23.360	162.710	3784.71	-1102.90	-1102.31	315.83	1631639.10	14548235.07	40°03'32.555"N	105°01'52.931"W	0.83	
4083.00	22.980	163.820	3866.53	-1136.45	-1135.84	325.92	1631649.17	14548201.54	40°03'32.223"N	105°01'52.801"W	0.65	
4173.00	23.050	163.090	3949.36	-1170.20	-1169.57	335.94	1631659.18	14548167.82	40°03'31.890"N	105°01'52.673"W	0.33	
4263.00	22.870	163.500	4032.23	-1203.85	-1203.20	346.03	1631669.25	14548134.21	40°03'31.558"N	105°01'52.543"W	0.27	
4352.00	22.360	164.760	4114.39	-1236.78	-1236.11	355.39	1631678.60	14548101.30	40°03'31.232"N	105°01'52.422"W	0.79	
4442.00	23.960	164.710	4197.14	-1270.94	-1270.26	364.71	1631687.90	14548067.17	40°03'30.895"N	105°01'52.303"W	1.78	
4531.00	24.180	164.630	4278.40	-1305.97	-1305.27	374.31	1631697.48	14548032.17	40°03'30.549"N	105°01'52.179"W	0.25	
4621.00	23.010	164.290	4360.87	-1340.69	-1339.97	383.96	1631707.11	14547997.47	40°03'30.206"N	105°01'52.055"W	1.31	
4710.00	20.840	163.470	4443.43	-1372.64	-1371.90	393.17	1631716.31	14547965.56	40°03'29.891"N	105°01'51.937"W	2.46	
4824.00	21.430	164.380	4549.76	-1412.16	-1411.40	404.55	1631727.67	14547926.07	40°03'29.500"N	105°01'51.790"W	0.59	

REFERENCE WELLPATH IDENTIFICATION			
Operator	KERR-MCGEE OIL & GAS ONSHORE LP (WA)	Slot	SLOT#16 PAPA JO 2-25 29N3-8HZ(1403'FSL & 1354'FWL,SEC.08)
Area	COLORADO	Well	PAPA JO 2-25 29N3-8HZ
Field	WELD COUNTY (UTM/TRUE NORTH)	Wellbore	PAPA JO 2-25 29N3-8HZ AWB
Facility	SEC.08-T1N-R68W		

WELLPATH DATA (194 stations) † = interpolated/extrapolated station												
MD [ft]	Inclination [°]	Azimuth [°]	TVD [ft]	Vert Sect [ft]	North [ft]	East [ft]	Grid East [US ft]	Grid North [US ft]	Latitude	Longitude	DLS [°/100ft]	Comments
4913.00	22.670	163.330	4632.25	-1444.26	-1443.49	413.85	1631736.96	14547893.99	40°03'29.183"N	105°01'51.671"W	1.46	
5002.00	23.390	165.070	4714.16	-1477.78	-1476.99	423.32	1631746.41	14547860.50	40°03'28.852"N	105°01'51.549"W	1.11	
5092.00	24.480	165.380	4796.42	-1513.11	-1512.29	432.63	1631755.70	14547825.20	40°03'28.503"N	105°01'51.429"W	1.22	
5181.00	22.380	164.990	4878.07	-1547.33	-1546.50	441.67	1631764.73	14547791.00	40°03'28.165"N	105°01'51.313"W	2.37	
5271.00	22.250	166.730	4961.33	-1580.48	-1579.64	450.02	1631773.06	14547757.88	40°03'27.838"N	105°01'51.206"W	0.75	
5360.00	22.440	166.410	5043.65	-1613.41	-1612.55	457.88	1631780.91	14547724.98	40°03'27.512"N	105°01'51.104"W	0.25	
5449.00	22.800	164.080	5125.81	-1646.52	-1645.64	466.60	1631789.61	14547691.89	40°03'27.185"N	105°01'50.992"W	1.09	
5539.00	24.020	163.120	5208.40	-1680.84	-1679.94	476.70	1631799.70	14547657.60	40°03'26.846"N	105°01'50.862"W	1.42	
5629.00	21.910	161.990	5291.26	-1714.36	-1713.44	487.22	1631810.20	14547624.11	40°03'26.515"N	105°01'50.727"W	2.39	
5705.00†	19.748	160.246	5362.29	-1739.95	-1739.02	495.94	1631818.91	14547598.55	40°03'26.263"N	105°01'50.615"W	2.96	ENTER LANDBOX (336'FNL & 1849'FWL,SEC.17) 40.0572952 -105.0307264
5718.00	19.380	159.910	5374.54	-1744.04	-1743.11	497.42	1631820.39	14547594.46	40°03'26.222"N	105°01'50.596"W	2.96	
5808.00	17.760	165.220	5459.86	-1771.36	-1770.41	506.06	1631829.01	14547567.16	40°03'25.952"N	105°01'50.485"W	2.60	
5897.00	15.340	162.460	5545.16	-1795.73	-1794.76	513.07	1631836.01	14547542.82	40°03'25.712"N	105°01'50.395"W	2.86	
5987.00	15.410	167.140	5631.95	-1818.75	-1817.77	519.32	1631842.25	14547519.82	40°03'25.484"N	105°01'50.314"W	1.38	
6076.00	13.210	165.510	5718.18	-1840.13	-1839.15	524.49	1631847.41	14547498.45	40°03'25.273"N	105°01'50.248"W	2.51	
6166.00	10.890	162.740	5806.19	-1858.22	-1857.23	529.59	1631852.50	14547480.37	40°03'25.094"N	105°01'50.182"W	2.66	
6255.00	9.390	157.470	5893.80	-1872.97	-1871.96	534.87	1631857.77	14547465.64	40°03'24.949"N	105°01'50.114"W	1.98	
6345.00	8.590	161.810	5982.70	-1886.14	-1885.13	539.78	1631862.67	14547452.48	40°03'24.819"N	105°01'50.051"W	1.16	
6434.00	7.280	171.430	6070.85	-1898.04	-1897.02	542.69	1631865.58	14547440.59	40°03'24.701"N	105°01'50.014"W	2.09	
6524.00	6.090	167.500	6160.23	-1908.34	-1907.32	544.58	1631867.46	14547430.29	40°03'24.599"N	105°01'49.990"W	1.42	
6613.00	5.020	160.480	6248.81	-1916.63	-1915.60	546.90	1631869.78	14547422.02	40°03'24.518"N	105°01'49.960"W	1.42	
6703.00	4.240	155.030	6338.52	-1923.36	-1922.33	549.62	1631872.50	14547415.29	40°03'24.451"N	105°01'49.925"W	0.99	
6792.00	3.650	149.830	6427.31	-1928.80	-1927.76	552.43	1631875.31	14547409.86	40°03'24.397"N	105°01'49.889"W	0.77	
6882.00	2.860	171.950	6517.17	-1933.50	-1932.46	554.19	1631877.06	14547405.16	40°03'24.351"N	105°01'49.866"W	1.63	
6971.00	2.630	164.790	6606.07	-1937.67	-1936.63	555.03	1631877.91	14547400.99	40°03'24.310"N	105°01'49.855"W	0.46	
7061.00	2.480	159.930	6695.98	-1941.50	-1940.45	556.24	1631879.11	14547397.17	40°03'24.272"N	105°01'49.840"W	0.29	
7150.00	0.440	65.070	6784.95	-1943.16	-1942.12	557.21	1631880.08	14547395.51	40°03'24.256"N	105°01'49.827"W	2.87	
7240.00	0.530	71.610	6874.94	-1942.89	-1941.84	557.92	1631880.79	14547395.78	40°03'24.258"N	105°01'49.818"W	0.12	
7310.00†	1.778	9.188	6944.93	-1941.71	-1940.66	558.40	1631881.27	14547396.96	40°03'24.270"N	105°01'49.812"W	2.29	KOP
7330.00	2.220	5.720	6964.92	-1941.02	-1939.97	558.49	1631881.36	14547397.65	40°03'24.277"N	105°01'49.811"W	2.29	
7420.00	12.110	0.670	7054.11	-1929.82	-1928.77	558.78	1631881.65	14547408.85	40°03'24.387"N	105°01'49.807"W	11.00	
7509.00	20.120	1.910	7139.54	-1905.15	-1904.10	559.40	1631882.28	14547433.51	40°03'24.631"N	105°01'49.799"W	9.01	
7598.00	24.510	358.790	7221.86	-1871.37	-1870.32	559.52	1631882.41	14547467.27	40°03'24.965"N	105°01'49.797"W	5.11	
7688.00	33.000	357.930	7300.69	-1828.14	-1827.09	558.24	1631881.15	14547510.49	40°03'25.392"N	105°01'49.814"W	9.44	
7777.00	37.680	358.360	7373.27	-1776.69	-1775.65	556.58	1631879.51	14547561.91	40°03'25.901"N	105°01'49.835"W	5.27	
7867.00	45.650	356.750	7440.45	-1716.97	-1715.93	553.97	1631876.92	14547621.61	40°03'26.491"N	105°01'49.869"W	8.93	
7957.00	50.690	356.610	7500.45	-1650.03	-1649.00	550.08	1631873.06	14547688.51	40°03'27.152"N	105°01'49.919"W	5.60	
8046.00	55.300	358.420	7554.01	-1579.04	-1578.02	547.03	1631870.04	14547759.46	40°03'27.854"N	105°01'49.958"W	5.43	
8136.00	60.930	0.330	7601.53	-1502.66	-1501.64	546.24	1631869.27	14547835.81	40°03'28.608"N	105°01'49.968"W	6.51	
8225.00	67.710	0.380	7640.08	-1422.50	-1421.48	546.74	1631869.80	14547915.94	40°03'29.401"N	105°01'49.962"W	7.62	
8315.00	73.420	0.650	7670.01	-1337.67	-1336.64	547.50	1631870.60	14548000.74	40°03'30.239"N	105°01'49.952"W	6.35	
8405.00	78.250	1.250	7692.03	-1250.45	-1249.42	548.95	1631872.08	14548087.93	40°03'31.101"N	105°01'49.933"W	5.41	
8494.00	85.190	0.000	7704.84	-1162.44	-1161.41	549.91	1631873.06	14548175.91	40°03'31.971"N	105°01'49.921"W	7.92	
8540.00†	88.042	359.780	7707.55	-1116.53	-1115.49	549.82	1631872.99	14548221.80	40°03'32.424"N	105°01'49.922"W	6.22	LANDING (288'FSL & 1904'FWL,SEC.08) 40.0590068 -105.0305339
8584.00	90.770	359.570	7708.01	-1072.53	-1071.50	549.57	1631872.76	14548265.78	40°03'32.859"N	105°01'49.925"W	6.22	

REFERENCE WELLPATH IDENTIFICATION			
Operator	KERR-MCGEE OIL & GAS ONSHORE LP (WA)	Slot	SLOT#16 PAPA JO 2-25 29N3-8HZ(1403'FSL & 1354'FWL,SEC.08)
Area	COLORADO	Well	PAPA JO 2-25 29N3-8HZ
Field	WELD COUNTY (UTM/TRUE NORTH)	Wellbore	PAPA JO 2-25 29N3-8HZ AWB
Facility	SEC.08-T1N-R68W		

WELLPATH DATA (194 stations) † = interpolated/extrapolated station												
MD (ft)	Inclination [°]	Azimuth [°]	TVD (ft)	Vert Sect (ft)	North (ft)	East (ft)	Grid East (US ft)	Grid North (US ft)	Latitude	Longitude	DLS °/100ft	Comments
8673.00	89.880	358.630	7707.50	-983.54	-982.51	548.17	1631871.39	14548354.73	40°03'33.739"N	105°01'49.943"W	1.45	
8719.00†	89.768	358.492	7707.65	-937.56	-936.53	547.01	1631870.25	14548400.70	40°03'34.193"N	105°01'49.958"W	0.39	CROSS SETBACK HEEL (466'FSL & 1901'FWL,SEC.08) 40.0594980 -105.0305439
8763.00	89.660	358.360	7707.87	-893.57	-892.54	545.81	1631869.06	14548444.66	40°03'34.628"N	105°01'49.973"W	0.39	
8852.00	92.000	1.120	7706.58	-804.60	-803.57	545.40	1631868.69	14548533.60	40°03'35.507"N	105°01'49.979"W	4.07	
8942.00	92.250	1.150	7703.24	-714.68	-713.65	547.18	1631870.50	14548623.48	40°03'36.396"N	105°01'49.956"W	0.28	
9031.00	89.780	359.520	7701.66	-625.71	-624.67	547.70	1631871.06	14548712.42	40°03'37.275"N	105°01'49.949"W	3.32	
9121.00	90.090	359.930	7701.76	-535.71	-534.68	547.27	1631870.66	14548802.39	40°03'38.164"N	105°01'49.955"W	0.57	
9210.00	88.950	0.320	7702.51	-446.71	-445.68	547.46	1631870.88	14548891.34	40°03'39.044"N	105°01'49.952"W	1.35	
9300.00	90.800	0.820	7702.71	-356.72	-355.69	548.36	1631871.81	14548981.30	40°03'39.933"N	105°01'49.940"W	2.13	
9389.00	88.030	359.690	7703.62	-267.74	-266.71	548.76	1631872.24	14549070.25	40°03'40.812"N	105°01'49.935"W	3.36	
9479.00	87.840	359.270	7706.86	-177.80	-176.77	547.94	1631871.46	14549160.15	40°03'41.701"N	105°01'49.946"W	0.51	
9568.00	88.860	359.370	7709.42	-88.84	-87.81	546.88	1631870.43	14549249.07	40°03'42.580"N	105°01'49.959"W	1.15	
9658.00	88.610	358.980	7711.41	1.13	2.16	545.59	1631869.17	14549339.00	40°03'43.469"N	105°01'49.976"W	0.51	
9747.00	88.340	358.430	7713.78	90.08	91.10	543.58	1631867.19	14549427.91	40°03'44.348"N	105°01'50.002"W	0.69	
9837.00	89.290	358.790	7715.64	180.03	181.05	541.40	1631865.04	14549517.83	40°03'45.237"N	105°01'50.030"W	1.13	
9926.00	88.150	358.290	7717.63	268.99	270.00	539.13	1631862.81	14549606.74	40°03'46.116"N	105°01'50.059"W	1.40	
10016.00	88.770	358.480	7720.04	358.92	359.93	536.59	1631860.31	14549696.64	40°03'47.005"N	105°01'50.092"W	0.72	
10106.00	90.550	359.850	7720.58	448.91	449.92	535.28	1631859.03	14549786.59	40°03'47.894"N	105°01'50.108"W	2.50	
10195.00	90.580	359.120	7719.70	537.90	538.91	534.48	1631858.26	14549875.54	40°03'48.774"N	105°01'50.119"W	0.82	
10285.00	90.920	359.670	7718.52	627.89	628.89	533.53	1631857.35	14549965.49	40°03'49.663"N	105°01'50.131"W	0.72	
10375.00	90.220	359.080	7717.63	717.88	718.88	532.55	1631856.40	14550055.45	40°03'50.552"N	105°01'50.144"W	1.02	
10464.00	90.800	358.290	7716.84	806.85	807.86	530.51	1631854.39	14550144.38	40°03'51.431"N	105°01'50.170"W	1.10	
10554.00	91.630	357.680	7714.93	896.78	897.78	527.34	1631851.26	14550234.27	40°03'52.320"N	105°01'50.210"W	1.14	
10643.00	91.390	359.070	7712.58	985.72	986.71	524.82	1631848.77	14550323.17	40°03'53.199"N	105°01'50.243"W	1.58	
10733.00	90.060	0.380	7711.44	1075.71	1076.70	524.39	1631848.37	14550413.12	40°03'54.088"N	105°01'50.248"W	2.07	
10822.00	90.340	359.690	7711.13	1164.71	1165.70	524.44	1631848.46	14550502.08	40°03'54.968"N	105°01'50.248"W	0.84	
10912.00	90.340	2.400	7710.60	1254.68	1255.67	526.08	1631850.13	14550592.02	40°03'55.857"N	105°01'50.227"W	3.01	
11001.00	90.340	1.230	7710.07	1343.62	1344.62	528.90	1631852.98	14550680.94	40°03'56.736"N	105°01'50.190"W	1.31	
11091.00	90.890	0.480	7709.10	1433.61	1434.61	530.25	1631854.36	14550770.88	40°03'57.625"N	105°01'50.173"W	1.03	
11181.00	91.720	0.140	7707.05	1523.58	1524.58	530.73	1631854.88	14550860.82	40°03'58.514"N	105°01'50.167"W	1.00	
11270.00	90.340	0.780	7705.45	1612.56	1613.56	531.45	1631855.62	14550949.77	40°03'59.394"N	105°01'50.157"W	1.71	
11360.00	88.550	0.660	7706.33	1702.54	1703.55	532.58	1631856.79	14551039.71	40°04'00.283"N	105°01'50.143"W	1.99	
11449.00	88.640	0.110	7708.51	1791.51	1792.52	533.18	1631857.42	14551128.65	40°04'01.162"N	105°01'50.135"W	0.63	
11539.00	88.280	359.530	7710.93	1881.48	1882.48	532.89	1631857.17	14551218.58	40°04'02.051"N	105°01'50.139"W	0.76	
11628.00	88.610	359.280	7713.34	1970.44	1971.45	531.97	1631856.28	14551307.51	40°04'02.930"N	105°01'50.151"W	0.47	
11718.00	88.210	358.790	7715.84	2060.40	2061.40	530.45	1631854.79	14551397.42	40°04'03.819"N	105°01'50.170"W	0.70	
11808.00	88.030	358.760	7718.79	2150.33	2151.33	528.53	1631852.91	14551487.32	40°04'04.708"N	105°01'50.195"W	0.20	
11897.00	88.710	0.280	7721.32	2239.29	2240.29	527.79	1631852.19	14551576.24	40°04'05.587"N	105°01'50.204"W	1.87	
11987.00	88.240	359.720	7723.72	2329.26	2330.25	527.79	1631852.23	14551666.17	40°04'06.476"N	105°01'50.204"W	0.81	
12076.00	89.040	1.550	7725.83	2418.22	2419.22	528.77	1631853.24	14551755.10	40°04'07.355"N	105°01'50.192"W	2.24	
12166.00	91.050	1.790	7725.76	2508.17	2509.18	531.40	1631855.90	14551845.02	40°04'08.244"N	105°01'50.158"W	2.25	
12256.00	91.050	1.810	7724.11	2598.11	2599.12	534.22	1631858.76	14551934.92	40°04'09.133"N	105°01'50.121"W	0.02	
12345.00	91.140	1.860	7722.41	2687.04	2688.06	537.07	1631861.64	14552023.83	40°04'10.012"N	105°01'50.085"W	0.12	
12435.00	90.430	0.630	7721.18	2777.00	2778.02	539.03	1631863.62	14552113.76	40°04'10.901"N	105°01'50.060"W	1.58	
12525.00	90.060	359.790	7720.79	2867.00	2868.02	539.36	1631863.99	14552203.72	40°04'11.790"N	105°01'50.055"W	1.02	

REFERENCE WELLPATH IDENTIFICATION			
Operator	KERR-MCGEE OIL & GAS ONSHORE LP (WA)	Slot	SLOT#16 PAPA JO 2-25 29N3-8HZ(1403'FSL & 1354'FWL,SEC.08)
Area	COLORADO	Well	PAPA JO 2-25 29N3-8HZ
Field	WELD COUNTY (UTM/TRUE NORTH)	Wellbore	PAPA JO 2-25 29N3-8HZ AWB
Facility	SEC.08-T1N-R68W		

WELLPATH DATA (194 stations) † = interpolated/extrapolated station												
MD (ft)	Inclination (°)	Azimuth (°)	TVD (ft)	Vert Sect (ft)	North (ft)	East (ft)	Grid East (US ft)	Grid North (US ft)	Latitude	Longitude	DLS (°/100ft)	Comments
12614.00	90.120	359.260	7720.65	2956.00	2957.02	538.62	1631863.28	14552292.68	40°04'12.670"N	105°01'50.065"W	0.60	
12704.00	90.310	359.070	7720.32	3045.99	3047.01	537.31	1631862.00	14552382.63	40°04'13.559"N	105°01'50.082"W	0.30	
12793.00	90.620	358.770	7719.59	3134.97	3135.99	535.63	1631860.36	14552471.58	40°04'14.438"N	105°01'50.103"W	0.48	
12883.00	91.110	358.610	7718.23	3224.94	3225.95	533.57	1631858.34	14552561.51	40°04'15.327"N	105°01'50.130"W	0.57	
12972.00	91.660	358.570	7716.08	3313.89	3314.90	531.38	1631856.18	14552650.42	40°04'16.206"N	105°01'50.158"W	0.62	
13062.00	90.400	0.330	7714.47	3403.87	3404.88	530.52	1631855.35	14552740.36	40°04'17.096"N	105°01'50.169"W	2.40	
13151.00	88.580	0.640	7715.26	3492.86	3493.87	531.27	1631856.14	14552829.31	40°04'17.975"N	105°01'50.159"W	2.07	
13182.00†	88.125	0.151	7716.15	3523.84	3524.85	531.49	1631856.36	14552860.29	40°04'18.281"N	105°01'50.156"W	2.15	CROSS SETBACK TOE (459'FNL & 1894'FWL,SEC.08) 40.0717448 -105.0305990
13241.00	87.260	359.220	7718.52	3582.80	3583.80	531.16	1631856.06	14552919.21	40°04'18.864"N	105°01'50.161"W	2.15	
13330.00	88.030	359.240	7722.18	3671.71	3672.72	529.97	1631854.90	14553008.10	40°04'19.743"N	105°01'50.176"W	0.87	
13420.00	89.080	358.920	7724.45	3761.67	3762.68	528.52	1631853.49	14553098.02	40°04'20.632"N	105°01'50.194"W	1.22	
13509.00	90.030	358.130	7725.14	3850.64	3851.64	526.23	1631851.23	14553186.95	40°04'21.511"N	105°01'50.224"W	1.39	
13544.00	90.490	357.800	7724.98	3885.62	3886.62	524.99	1631850.00	14553221.91	40°04'21.856"N	105°01'50.240"W	1.62	LAST BHGE MWD+IFR1+MSA SURVEY
13590.00	90.490	357.800	7724.59	3931.59	3932.59	523.22	1631848.25	14553267.86	40°04'22.311"N	105°01'50.263"W	0.00	PTB (51'FNL & 1886'FWL,SEC.08) 40.0728640 -105.0306285

TARGETS								
Name	TVD (ft)	North (ft)	East (ft)	Grid East (US ft)	Grid North (US ft)	Latitude	Longitude	Shape
SEC.08-T1N-R68W	-2.00	0.81	-149.98	1631173.88	14549337.91	40°03'43.456"N	105°01'58.922"W	polygon
PAPA JO 2-25 29N3-8HZ BHL REV-1(50'FNL & 1893'FWL,SEC.08)	7712.00	3933.66	530.36	1631855.38	14553268.93	40°04'22.321"N	105°01'50.171"W	point
PAPA JO 2-25 29N3-8HZ HEEL REV-1(200'FSL & 1835'FWL,SEC.08)	7712.00	-1196.65	539.99	1631863.13	14548140.68	40°03'31.622"N	105°01'50.048"W	point
PAPA JO 2-25 29N3-8HZ LANDBOX	7712.00	0.00	0.00	1631323.80	14549337.05	40°03'43.448"N	105°01'56.993"W	polygon
PAPA JO 2-25 29N3-8HZ SETBACK 1	7712.00	0.00	0.00	1631323.80	14549337.05	40°03'43.448"N	105°01'56.993"W	polygon
PAPA JO 2-25 29N3-8HZ SETBACK 2	7712.00	0.00	0.00	1631323.80	14549337.05	40°03'43.448"N	105°01'56.993"W	polygon

WELLPATH COMPOSITION - Ref Wellbore: PAPA JO 2-25 29N3-8HZ AWB				Ref Wellpath: PAPA JO 2-25 29N3-8HZ AWP			
Start MD (ft)	End MD (ft)	Positional Uncertainty Model		Log Name/Comment		Wellbore	
26.00	1839.00	Custom APC	ISCWSA REV 2 MWD+IFR1 (approximation)	Custom APC	ISCWSA Rev-2 MWD+IFR1 <137 - 1839>	PAPA JO 2-25 29N3-8HZ AWB	
1839.00	13544.00	Custom APC	ISCWSA REV 2 MWD+IFR1+MSA (approximation)	BHGE Custom APC	ISCWSA Rev-2 MWD+IFR1+MSA <1934 - 13544>	PAPA JO 2-25 29N3-8HZ AWB	
13544.00	13590.00	Blind Drilling	(std)	Projection to bit		PAPA JO 2-25 29N3-8HZ AWB	

REFERENCE WELLPATH IDENTIFICATION			
Operator	KERR-MCGEE OIL & GAS ONSHORE LP (WA)	Slot	SLOT#16 PAPA JO 2-25 29N3-8HZ(1403'FSL & 1354'FWL,SEC.08)
Area	COLORADO	Well	PAPA JO 2-25 29N3-8HZ
Field	WELD COUNTY (UTM/TRUE NORTH)	Wellbore	PAPA JO 2-25 29N3-8HZ AWB
Facility	SEC.08-T1N-R68W		

WELLPATH COMMENTS				
MD [ft]	Inclination [°]	Azimuth [°]	TVD [ft]	Comment
137.00	0.310	308.430	137.00	FIRST SURFACE MWD+IFR1 SURVEY
1839.00	18.630	160.770	1794.57	LAST SURFACE MWD+IFR1 SURVEY
1934.00	18.680	160.240	1884.58	FIRST BHGE MWD+IFR1+MSA SURVEY
5705.00	19.748	160.246	5362.29	ENTER LANDBOX (336'FNL & 1849'FWL,SEC.17) 40.0572952 -105.0307264
7310.00	1.778	9.188	6944.93	KOP
8540.00	88.042	359.780	7707.55	LANDING (288'FSL & 1904'FWL,SEC.08) 40.0590068 -105.0305339
8719.00	89.768	358.492	7707.65	CROSS SETBACK HEEL (466'FSL & 1901'FWL,SEC.08) 40.0594980 -105.0305439
13182.00	88.125	0.151	7716.15	CROSS SETBACK TOE (459'FNL & 1894'FWL,SEC.08) 40.0717448 -105.0305990
13544.00	90.490	357.800	7724.98	LAST BHGE MWD+IFR1+MSA SURVEY
13590.00	90.490	357.800	7724.59	PTB (51'FNL & 1886'FWL,SEC.08) 40.0728640 -105.0306285