



Lat40°, Inc. 6250 W. 10th Street, Unit 2, Greeley, CO 970-515-5294

PROPOSED SCALED FACILITY DRAWING

RIDGWAY 3N66W1 1-6 PAD

SECTION: 1
TOWNSHIP: 3N
RANGE: 66W
6TH. P.M.
WELD COUNTY, CO

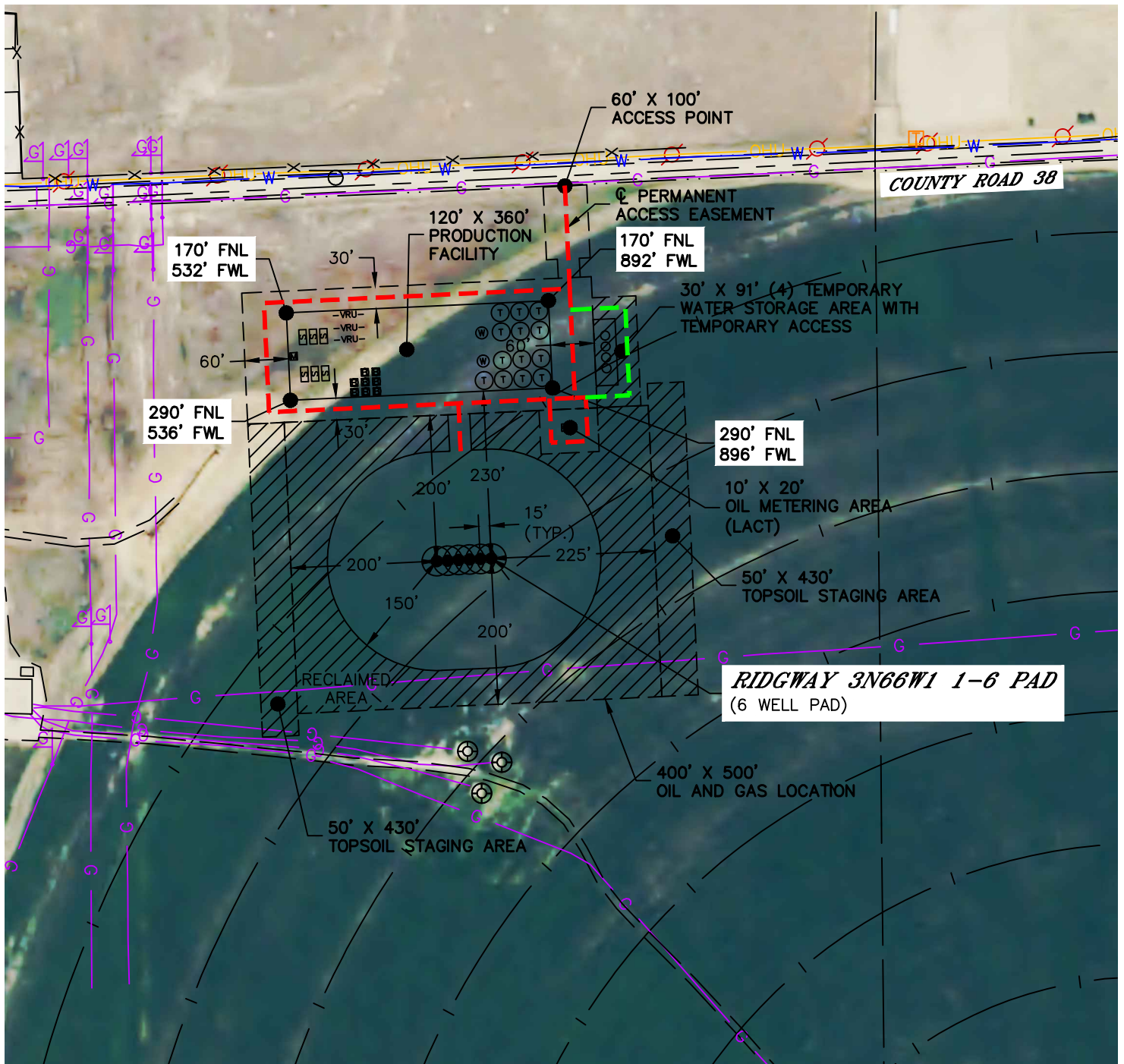

LEGEND

- PROPOSED WELL HEAD
- T TANK BATTERY
- W WATER TANK
- W WATER VAULT
- S SEPARATOR
- ECD ECD
- M METER
- VRU- VAPOR RECOVERY UNIT

TOTAL DISTURBED AREA OF LOCATION: ±7.9 ACRES
TOTAL SIZE OF LOCATION AFTER RECLAMATION: ±4.2 ACRES

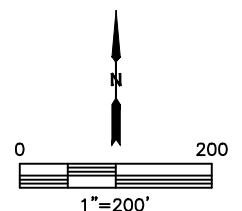

DATE: 12/13/2017
PROJECT#: 2017110