

# HESTER FARMS II PAD HYDROLOGY MAP

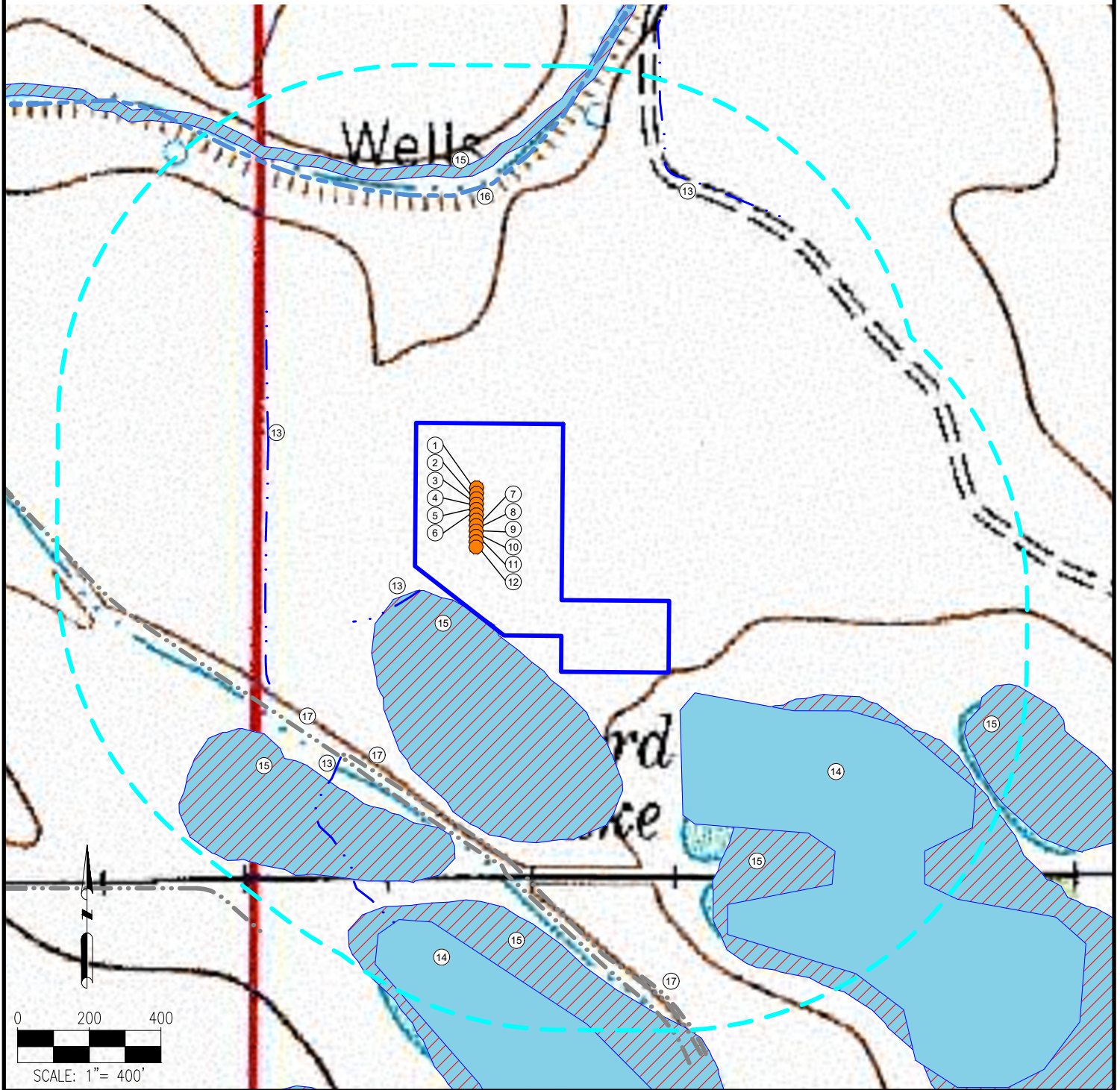

MEASUREMENTS ARE MADE FROM THE NEAREST EDGE OF THE DISTURBANCE AREA.

- |                              |  |
|------------------------------|--|
| 1. HESTER FARMS II A-31-32HN | 10. HESTER FARMS II J-31-32HN  |
| 2. HESTER FARMS II B-31-32HN | 11. HESTER FARMS II K-31-32N   |
| 3. HESTER FARMS II C-31-32HN | 12. HESTER FARMS II L-31-32HC  |
| 4. HESTER FARMS II D-31-32HC | 13. DITCHES ARE $\pm 420'$ W, $\pm 46'$ SW, $\pm 761'$ NE, $\pm 548'$ SW                               |
| 5. HESTER FARMS II E-31-32HN | 14. PONDS ARE $\pm 93'$ SE, $\pm 786'$ SW  |
| 6. HESTER FARMS II F-31-32HN | 15. WETLANDS ARE $\pm 0'$ SW, $\pm 551'$ SW, $\pm 676'$ SW, $\pm 843'$ SE, $\pm 271'$ SE, $\pm 685'$ N |
| 7. HESTER FARMS II G-31-32HN | 16. LARIMER AND WELD CANAL IS $\pm 635'$ N   |
| 8. HESTER FARMS II H-31-32HC | 17. CONCRETE DITCHES ARE $\pm 540'$ SW, $\pm 516'$ SW, $\pm 850'$ S                                    |
| 9. HESTER FARMS II I-31-32HN |  |

## LEGEND:

- |                  |            |                    |
|------------------|------------|--------------------|
| = PROPOSED WELL  | = POND     | = DISTURBANCE AREA |
| = DITCH          | = WETLANDS | = 1000' RADIUS     |
| = CONCRETE DITCH | = CANAL    |                    |

DISCLAIMER:  
THIS PLOT DOES NOT REPRESENT A MONUMENTED LAND SURVEY AND SHOULD NOT BE RELIED UPON TO DETERMINE BOUNDARY LINES, PROPERTY OWNERSHIP OR OTHER PROPERTY INTERESTS. PARCEL LINES, IF DEPICTED HAVE NOT BEEN FIELD VERIFIED AND MAY BE BASED UPON PUBLICLY AVAILABLE DATA THAT ALSO HAS NOT BEEN INDEPENDENTLY VERIFIED.

DATA SOURCE:  
TOPO MAP: USGS  
NHD: USGS

PUBLICLY AVAILABLE DATA SOURCES HAVE NOT BEEN INDEPENDENTLY VERIFIED BY ASCENT.



7535 Hilltop Circle  
Denver, CO 80221  
(303) 928-7128  
www.ascentgeomatics.com

FIELD DATE:  
06-01-17

DRAWING DATE:  
12-07-17

BY:  
AS

CHECKED:  
IJM

SITE NAME:  
HESTER FARMS II 31-H PAD

SURFACE LOCATION:

LOT 2 NW 1/4 SEC. 31, T7N, R66W, 6TH P.M.  
WELD COUNTY, COLORADO

PREPARED FOR:



BAYSWATER  
EXPLORATION AND PRODUCTION, LLC