

# HYDROLOGY MAP

## DEHAAN 7N65W16 SOUTH PAD

SECTION: 17  
TOWNSHIP: 7N  
RANGE: 65W  
6TH P.M.  
WELD COUNTY, CO

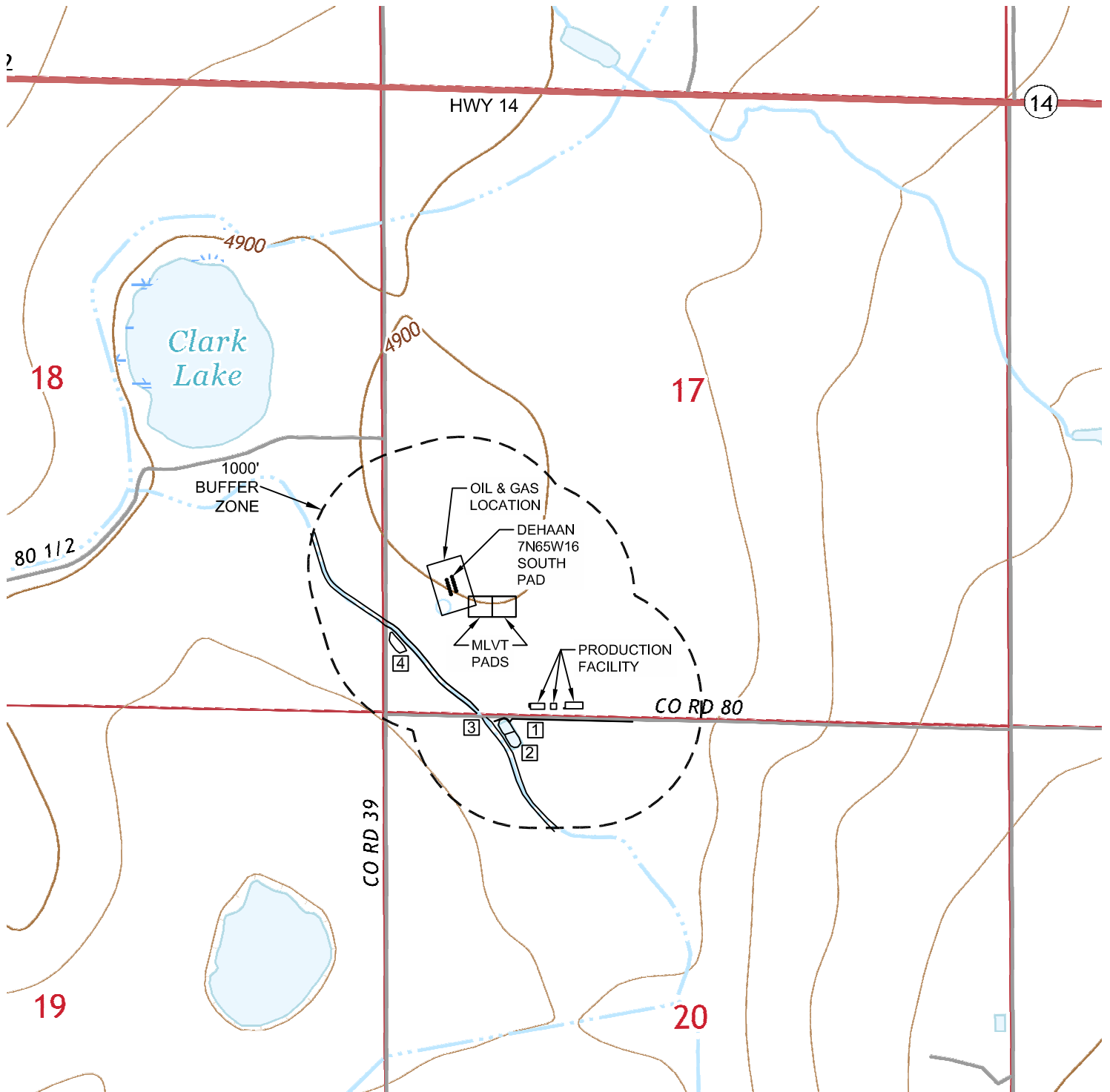

DISTANCES BELOW MEASURED FROM THE PROPOSED EDGE OF DISTURBANCE OF THE OIL AND GAS LOCATION

- ① IRRIGATION DITCH (CONCRETE): 84' S (NEAREST DOWN GRADIENT WATER FEATURE)
- ② HOLDING POND: 210' SW
- ③ IRRIGATION DITCH (LATERAL DITCH): 327' SW
- ④ HOLDING POND: 411' SW

