



March 25, 2018

Ms. Julie Murphy, Director
Colorado Oil & Gas Conservation Commission
1120 Lincoln Street, Ste. 801
Denver, Colorado 80203

RE: Rule 318.A.e.
LIND 26W-30-6N well

Surface Location: NENE, Section 26, Township 7 North, Range 67 West, Weld County, CO

Dear Ms. Murphy,

Extraction Oil and Gas, Inc. (Extraction) is planning to drill the captioned horizontal wells in accordance with the provision of COGCC Rule 318A.e.

The proposed wellbore spacing unit consists of:

Section 26-7N-67W: S/2N/2 & N/2S/2
Section 27-7N-67W: S/2N/2 & N/2S/2
Section 28-7N-67W: S/2N/2 & N/2S/2

The spacing unit is a 960-acre wellbore spacing unit for the Niobrara formation.

Extraction hereby certifies to the Director that all Owners within the proposed spacing unit above were notified and 30 days have passed without objection.

If you have any questions or issues regarding this permit, please contact Alyssa Andrews at (720) 481-2379.

Sincerely,

Alyssa Andrews
Regulatory Analyst
Extraction Oil & Gas, Inc.

LIND 26-D PAD
PROPOSED 318A.a.(4)D. SPACING UNIT
 SEC 26: S2N2, N2S2
 SEC 27: S2N2, N2S2
 SEC 28: S2N2, N2S2

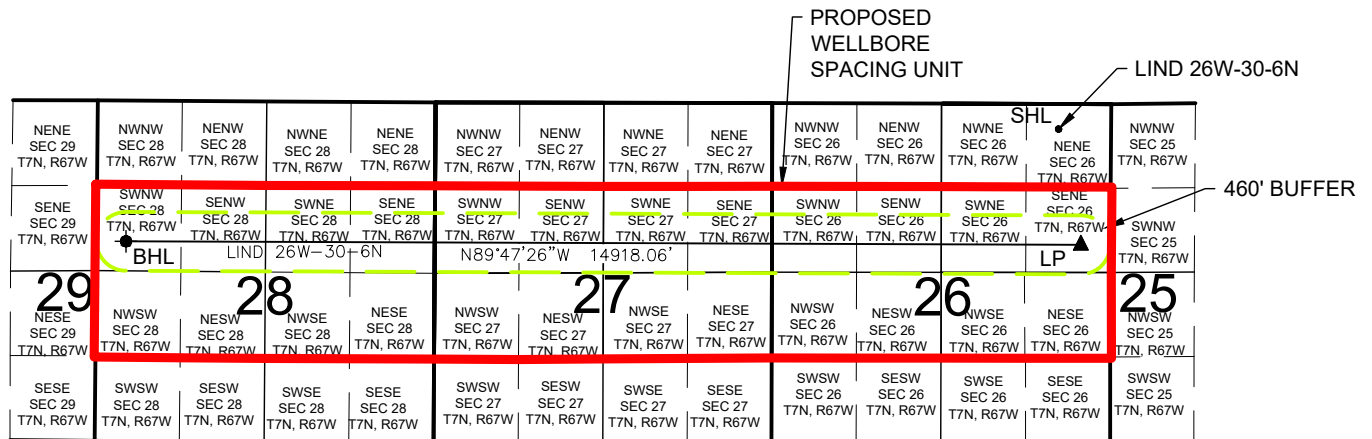

LIND 26W-30-6N WELL TO BE LOCATED 393' FNL AND 821' FEL, SEC 26, T7N, R67W

LEGEND

- = PROPOSED WELL
- = BOTTOM HOLE
- ▲ = LANDING POINT

SHL = SURFACE HOLE LOCATION
 BHL = BOTTOM HOLE LOCATION
 LP = LANDING POINT

DISCLAIMER:
 THIS PLOT DOES NOT REPRESENT A MONUMENTED LAND SURVEY AND SHOULD NOT BE
 RELIED UPON TO DETERMINE BOUNDARY LINES, PROPERTY OWNERSHIP OR OTHER
 PROPERTY INTERESTS. PARCEL LINES, IF DEPICTED HAVE NOT BEEN FIELD VERIFIED AND
 MAY BE BASED UPON PUBLICLY AVAILABLE DATA THAT ALSO HAS NOT BEEN
 INDEPENDENTLY VERIFIED.

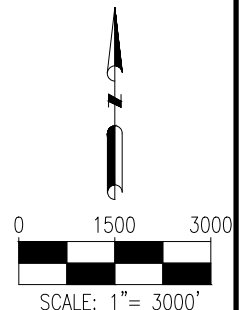

7535 Hilltop Circle
 Denver, CO 80221
 (303) 928-7128
 www.ascentgeomatics.com

FIELD DATE:
 10-09-17

DRAWING DATE:
 01-22-18

BY:
 MJW

CHECKED:
 IJM

SITE NAME:
 LIND 26-D PAD

SURFACE LOCATION:

NE 1/4 NE 1/4 SEC. 26, T7N, R67W, 6TH P.M.
 WELD COUNTY, COLORADO

PREPARED FOR:

