

SRC ENERGY

Location: COLORADO Slot: SLOT#04 HOOD 11N-22A-M (705'FSL & 1122'FEL SEC.20)
 Field: WELD COUNTY (NAD83, TRUE NORTH) Well: HOOD 11N-22A-M
 Facility: SEC.20-T06N-R66W Wellbore: HOOD 11N-22A-M PWB

Plot reference wellpath is HOOD 11N-22A-M REV-C.0 PWP	Grid System: NAD83 / Lambert Colorado SP, Northern Zone (501), US feet
True vertical depths are referenced to PRECISION 562 (25) (RKB)	* = Wellpath was transformed from a different geoidic datum
Measured depths are referenced to PRECISION 562 (25) (RKB)	North Reference: True north
PRECISION 562 (25) (RKB) to Mean Sea Level: 4759 feet	Scale: True distance
Mean Sea Level to Mud line (At Slot: SLOT#04 HOOD 11N-22A-M (705'FSL & 1122'FEL SEC.20)): 0 feet	Depths are in feet
Coordinates are in feet referenced to Slot	Created by: doddanna on 2017-06-30
	Database: WA_Denver

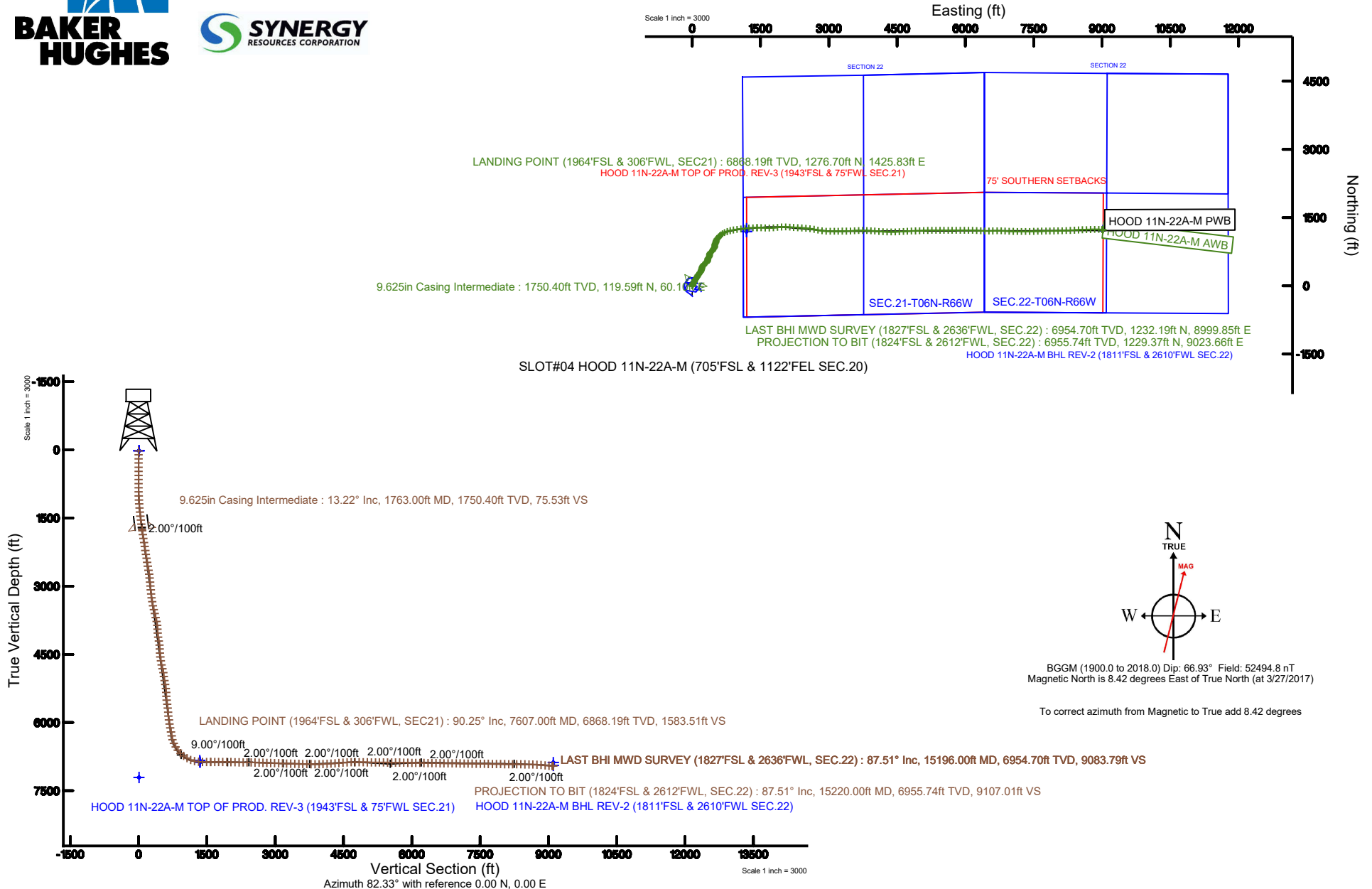

Actual Wellpath Report

HOOD 11N-22A-M AWP

Page 1 of 11



REFERENCE WELLPATH IDENTIFICATION

Operator	SRC ENERGY	Slot	SLOT#04 HOOD 11N-22A-M (705'FSL & 1122'FEL SEC.20)
Area	COLORADO	Well	HOOD 11N-22A-M
Field	WELD COUNTY (NAD83,TRUE NORTH)	Wellbore	HOOD 11N-22A-M AWB
Facility	SEC.20-T06N-R66W		

REPORT SETUP INFORMATION

Projection System	NAD83 / Lambert Colorado SP, Northern Zone (501), US feet	Software System	WellArchitect® 5.0
North Reference	True	User	Doddanna
Scale	0.999964	Report Generated	6/30/2017 at 5:47:40 PM
Convergence at slot	0.46° East	Database/Source file	WA_Denver/HOOD_11N-22A-M_AWP.xml

WELLPATH LOCATION

	Local coordinates		Grid coordinates		Geographic coordinates	
	North[ft]	East[ft]	Easting[US ft]	Northing[US ft]	Latitude	Longitude
Slot Location	-60.11	0.31	3195754.30	1414219.06	40°28'05.884"N	104°47'47.119"W
Facility Reference Pt			3195753.51	1414279.17	40°28'06.478"N	104°47'47.123"W
Field Reference Pt			3171284.48	1426358.81	40°30'07.643"N	104°53'02.634"W

WELLPATH DATUM

Calculation method	Minimum curvature	PRECISION 562 (25') (RKB) to Facility Vertical Datum	4759.00ft
Horizontal Reference Pt	Slot	PRECISION 562 (25') (RKB) to Mean Sea Level	4759.00ft
Vertical Reference Pt	PRECISION 562 (25') (RKB)	PRECISION 562 (25') (RKB) to Mud Line at Slot (SLOT#04 HOOD 11N-22A-M (705'FSL & 1122'FEL SEC.20))	4759.00ft
MD Reference Pt	PRECISION 562 (25') (RKB)	Section Origin	N 0.00, E 0.00 ft
Field Vertical Reference	Mean Sea Level	Section Azimuth	82.33°

Actual Wellpath Report

HOOD 11N-22A-M AWP

Page 2 of 11



REFERENCE WELLPATH IDENTIFICATION

Operator	SRC ENERGY	Slot	SLOT#04 HOOD 11N-22A-M (705'FSL & 1122'FEL SEC.20)
Area	COLORADO	Well	HOOD 11N-22A-M
Field	WELD COUNTY (NAD83,TRUE NORTH)	Wellbore	HOOD 11N-22A-M AWB
Facility	SEC.20-T06N-R66W		

WELLPATH DATA (173 stations) † = interpolated/extrapolated station

MD [ft]	Inclination [°]	Azimuth [°]	TVD [ft]	Vert Sect [ft]	North [ft]	East [ft]	DLS [°/100ft]	Comments
0.00†	0.000	286.750	0.00	0.00	0.00	0.00	0.00	
25.00	0.000	286.750	25.00	0.00	0.00	0.00	0.00	
109.00	0.220	286.750	109.00	-0.15	0.05	-0.15	0.26	
199.00	0.460	60.410	199.00	0.03	0.27	-0.01	0.70	
291.00	0.330	47.750	291.00	0.59	0.64	0.51	0.17	
384.00	0.200	237.470	384.00	0.66	0.73	0.57	0.57	
474.00	0.410	121.780	474.00	0.77	0.47	0.71	0.59	
564.00	0.150	303.020	563.99	0.93	0.37	0.89	0.62	
654.00	0.500	226.240	653.99	0.52	0.16	0.51	0.54	
744.00	0.060	33.990	743.99	0.24	-0.07	0.25	0.62	
834.00	0.240	157.920	833.99	0.32	-0.21	0.35	0.31	
924.00	1.680	23.480	923.98	1.05	0.83	0.94	2.06	
1014.00	3.770	21.470	1013.87	3.17	4.79	2.55	2.32	
1104.00	5.410	31.490	1103.58	7.29	11.16	5.85	2.02	
1194.00	6.440	31.130	1193.10	13.13	19.10	10.68	1.15	
1284.00	8.160	27.810	1282.37	20.00	29.07	16.27	1.97	
1374.00	9.880	28.810	1371.25	28.30	41.49	22.97	1.92	
1464.00	11.410	26.960	1459.70	37.95	56.19	30.73	1.74	
1554.00	13.850	23.910	1547.52	48.66	73.98	39.13	2.81	
1644.00	14.210	24.220	1634.83	60.13	93.90	48.03	0.41	
1712.00	13.820	25.410	1700.81	68.98	108.85	54.94	0.71	
1792.00	12.880	26.280	1778.65	79.17	125.47	62.98	1.20	
1882.00	13.640	35.770	1866.26	92.07	143.08	73.63	2.56	
1971.00	13.690	35.880	1952.74	106.54	160.13	85.94	0.06	
2061.00	13.670	35.510	2040.18	121.16	177.41	98.36	0.10	
2150.00	13.500	27.690	2126.70	134.37	195.17	109.29	2.07	
2240.00	13.520	28.480	2214.21	146.66	213.72	119.19	0.21	
2329.00	13.020	33.500	2300.84	159.39	231.23	129.68	1.41	
2419.00	14.090	35.950	2388.33	173.63	248.55	141.71	1.35	
2508.00	13.090	32.850	2474.84	187.65	265.79	153.54	1.39	

Actual Wellpath Report

HOOD 11N-22A-M AWP

Page 3 of 11



REFERENCE WELLPATH IDENTIFICATION

Operator	SRC ENERGY	Slot	SLOT#04 HOOD 11N-22A-M (705'FSL & 1122'FEL SEC.20)
Area	COLORADO	Well	HOOD 11N-22A-M
Field	WELD COUNTY (NAD83,TRUE NORTH)	Wellbore	HOOD 11N-22A-M AWB
Facility	SEC.20-T06N-R66W		

WELLPATH DATA (173 stations)

MD [ft]	Inclination [°]	Azimuth [°]	TVD [ft]	Vert Sect [ft]	North [ft]	East [ft]	DLS [°/100ft]	Comments
2598.00	13.210	41.140	2562.49	202.01	282.10	165.83	2.10	
2687.00	13.810	39.000	2649.02	217.39	298.01	179.21	0.88	
2777.00	14.870	25.870	2736.24	231.59	316.75	191.01	3.79	
2866.00	13.160	17.510	2822.60	242.21	336.69	199.04	2.97	
2956.00	13.840	20.560	2910.11	251.67	356.54	205.91	1.09	
3045.00	13.980	12.150	2996.51	260.35	377.02	211.91	2.28	
3134.00	11.710	9.970	3083.28	266.73	396.43	215.74	2.61	
3224.00	13.070	20.110	3171.19	274.24	414.99	220.82	2.85	
3312.00	14.720	32.110	3256.63	286.04	433.80	230.18	3.76	
3402.00	14.200	35.820	3343.78	300.95	452.44	242.72	1.18	
3491.00	12.930	43.570	3430.30	316.23	468.51	255.98	2.49	
3581.00	13.840	52.350	3517.87	333.41	482.38	271.44	2.47	
3670.00	14.300	66.300	3604.22	353.20	493.30	289.94	3.84	
3760.00	15.600	57.950	3691.18	374.91	504.20	310.38	2.79	
3849.00	18.760	34.480	3776.30	395.45	522.37	328.65	8.49	
3938.00	17.670	11.640	3860.95	409.54	547.43	339.49	8.06	
4028.00	13.490	1.230	3947.64	415.68	571.32	342.47	5.57	
4117.00	11.630	8.450	4034.51	419.78	590.57	344.01	2.73	
4206.00	12.870	34.600	4121.55	428.95	607.62	350.97	6.33	
4296.00	14.400	45.580	4209.03	444.66	623.71	364.65	3.33	
4386.00	14.380	19.810	4296.29	458.80	642.07	376.45	7.06	
4475.00	14.250	358.460	4382.59	465.07	663.43	379.90	5.90	
4565.00	13.980	8.040	4469.89	469.20	685.27	381.12	2.61	
4654.00	13.760	18.970	4556.31	476.86	705.93	386.07	2.95	
4743.00	13.130	36.910	4642.90	488.71	724.03	395.58	4.72	
4833.00	13.720	52.470	4730.47	505.14	738.71	410.19	4.05	
4922.00	14.700	56.520	4816.75	524.46	751.37	427.98	1.57	
5012.00	15.110	36.120	4903.78	542.87	767.16	444.43	5.82	
5101.00	14.400	16.700	4989.90	555.48	787.14	454.46	5.59	
5191.00	13.780	38.070	5077.25	567.78	806.31	464.29	5.79	

Actual Wellpath Report

HOOD 11N-22A-M AWP

Page 4 of 11



REFERENCE WELLPATH IDENTIFICATION

Operator	SRC ENERGY	Slot	SLOT#04 HOOD 11N-22A-M (705'FSL & 1122'FEL SEC.20)
Area	COLORADO	Well	HOOD 11N-22A-M
Field	WELD COUNTY (NAD83,TRUE NORTH)	Wellbore	HOOD 11N-22A-M AWB
Facility	SEC.20-T06N-R66W		

WELLPATH DATA (173 stations)

MD [ft]	Inclination [°]	Azimuth [°]	TVD [ft]	Vert Sect [ft]	North [ft]	East [ft]	DLS [°/100ft]	Comments
5280.00	14.750	41.990	5163.51	584.01	823.08	478.40	1.54	
5370.00	14.750	22.410	5250.60	598.49	842.20	490.44	5.51	
5460.00	14.870	4.440	5337.65	606.66	864.31	495.71	5.09	
5549.00	14.710	359.390	5423.71	610.45	887.00	496.47	1.46	
5638.00	14.030	17.640	5509.97	616.45	908.59	499.62	5.12	
5728.00	14.790	31.790	5597.16	628.42	928.76	508.98	3.99	
5817.00	14.740	18.890	5683.25	640.71	949.13	518.64	3.69	
5907.00	13.740	5.460	5770.51	648.26	970.61	523.36	3.83	
5996.00	13.320	15.500	5857.05	654.70	991.02	527.11	2.68	
6086.00	13.740	33.940	5944.59	665.88	1009.88	535.85	4.80	
6176.00	13.650	34.980	6032.03	680.17	1027.45	547.91	0.29	
6265.00	13.750	44.360	6118.51	695.63	1043.62	561.32	2.50	
6355.00	13.810	40.770	6205.92	712.10	1059.40	575.82	0.95	
6444.00	13.800	30.650	6292.36	726.63	1076.58	588.17	2.71	
6533.00	20.110	41.990	6377.47	744.90	1097.11	603.83	7.97	
6622.00	25.010	53.540	6459.68	773.08	1119.69	629.23	7.40	
6712.00	32.800	59.940	6538.43	812.37	1143.25	665.69	9.30	
6801.00	39.480	64.220	6610.27	861.61	1167.66	712.09	8.02	
6891.00	46.630	69.450	6676.01	920.79	1191.62	768.58	8.87	
6980.00	52.810	75.830	6733.56	987.65	1211.69	833.34	8.83	
7070.00	59.000	81.410	6784.01	1061.95	1226.25	906.35	8.58	
7159.00	68.490	82.600	6823.34	1141.67	1237.30	985.31	10.73	
7249.00	78.950	81.410	6848.54	1227.94	1249.32	1070.73	11.69	
7338.00	82.500	83.410	6862.88	1315.76	1260.92	1157.78	4.56	
7428.00	89.350	84.550	6869.27	1405.44	1270.32	1247.01	7.72	
7517.00	90.890	90.060	6869.09	1494.07	1274.50	1335.87	6.43	
7607.00	90.250	87.140	6868.19	1583.51	1276.70	1425.83	3.32	LANDING POINT (1964'FSL & 306'FWL, SEC21)
7696.00	90.060	92.890	6867.95	1671.68	1276.68	1514.79	6.46	
7786.00	89.570	93.760	6868.24	1760.02	1271.46	1604.64	1.11	
7875.00	90.650	88.120	6868.07	1847.98	1270.00	1693.59	6.45	

Actual Wellpath Report

HOOD 11N-22A-M AWP

Page 5 of 11



REFERENCE WELLPATH IDENTIFICATION

Operator	SRC ENERGY	Slot	SLOT#04 HOOD 11N-22A-M (705'FSL & 1122'FEL SEC.20)
Area	COLORADO	Well	HOOD 11N-22A-M
Field	WELD COUNTY (NAD83,TRUE NORTH)	Wellbore	HOOD 11N-22A-M AWP
Facility	SEC.20-T06N-R66W		

WELLPATH DATA (173 stations)

MD [ft]	Inclination [°]	Azimuth [°]	TVD [ft]	Vert Sect [ft]	North [ft]	East [ft]	DLS [°/100ft]	Comments
7966.00	88.430	86.070	6868.80	1938.65	1274.61	1784.46	3.32	
8056.00	88.460	83.070	6871.24	2028.54	1283.12	1874.01	3.33	
8146.00	88.430	85.830	6873.68	2118.44	1291.82	1963.55	3.07	
8235.00	88.460	90.880	6876.10	2206.88	1294.38	2052.45	5.67	
8325.00	88.650	95.450	6878.37	2295.23	1289.41	2142.26	5.08	
8414.00	89.970	94.000	6879.44	2382.14	1282.08	2230.95	2.20	
8503.00	89.880	92.640	6879.56	2469.51	1276.93	2319.80	1.53	
8593.00	88.920	93.930	6880.50	2557.86	1271.77	2409.64	1.79	
8683.00	88.150	94.790	6882.80	2645.85	1264.93	2499.35	1.28	
8772.00	88.370	97.920	6885.51	2732.15	1255.08	2587.75	3.52	
8861.00	88.180	100.650	6888.19	2817.23	1240.73	2675.54	3.07	
8951.00	88.250	101.290	6890.99	2902.47	1223.62	2763.85	0.72	
9040.00	88.460	97.550	6893.55	2987.49	1209.06	2851.60	4.21	
9130.00	88.250	93.610	6896.13	3075.04	1200.31	2941.11	4.38	
9219.00	88.460	88.740	6898.69	3162.91	1198.49	3030.03	5.47	
9309.00	87.350	90.530	6901.98	3252.12	1199.06	3119.96	2.34	
9398.00	88.280	88.990	6905.37	3340.30	1199.43	3208.90	2.02	
9488.00	88.180	89.140	6908.15	3429.64	1200.90	3298.84	0.20	
9577.00	88.490	90.090	6910.74	3517.88	1201.50	3387.80	1.12	
9667.00	87.970	86.470	6913.52	3607.34	1204.20	3477.70	4.06	
9756.00	90.310	85.950	6914.85	3696.12	1210.08	3566.49	2.69	
9846.00	89.050	87.990	6915.36	3785.81	1214.84	3656.36	2.66	
9935.00	88.830	90.780	6917.00	3874.12	1215.79	3745.33	3.14	
10024.00	91.420	92.740	6916.81	3961.90	1213.06	3834.27	3.65	
10114.00	93.570	93.380	6912.89	4050.24	1208.26	3924.05	2.49	
10203.00	93.360	94.450	6907.51	4137.26	1202.20	4012.68	1.22	
10293.00	93.660	94.680	6902.00	4225.05	1195.05	4102.23	0.42	
10382.00	93.480	93.370	6896.46	4312.03	1188.81	4190.83	1.48	
10472.00	93.630	91.560	6890.88	4400.45	1184.95	4280.57	2.01	
10561.00	93.940	89.720	6885.00	4488.32	1183.96	4369.37	2.09	

Actual Wellpath Report

HOOD 11N-22A-M AWP

Page 6 of 11



REFERENCE WELLPATH IDENTIFICATION

Operator	SRC ENERGY	Slot	SLOT#04 HOOD 11N-22A-M (705'FSL & 1122'FEL SEC.20)
Area	COLORADO	Well	HOOD 11N-22A-M
Field	WELD COUNTY (NAD83,TRUE NORTH)	Wellbore	HOOD 11N-22A-M AWB
Facility	SEC.20-T06N-R66W		

WELLPATH DATA (173 stations)

MD [ft]	Inclination [°]	Azimuth [°]	TVD [ft]	Vert Sect [ft]	North [ft]	East [ft]	DLS [°/100ft]	Comments
10651.00	93.420	88.250	6879.23	4577.53	1185.55	4459.17	1.73	
10740.00	92.060	87.480	6874.97	4666.01	1188.86	4548.00	1.76	
10830.00	89.850	86.310	6873.47	4755.70	1193.73	4637.85	2.78	
10919.00	89.450	86.960	6874.01	4844.45	1198.96	4726.69	0.86	
11009.00	89.480	87.610	6874.86	4934.11	1203.22	4816.59	0.72	
11098.00	89.510	87.370	6875.64	5022.74	1207.12	4905.50	0.27	
11187.00	89.290	88.690	6876.57	5111.30	1210.18	4994.44	1.50	
11277.00	89.380	87.490	6877.62	5200.83	1213.18	5084.38	1.34	
11366.00	89.320	87.730	6878.63	5289.45	1216.89	5173.30	0.28	
11456.00	89.260	89.470	6879.74	5378.90	1219.09	5263.26	1.93	
11545.00	89.720	90.460	6880.53	5467.11	1219.14	5352.26	1.23	
11635.00	89.940	90.500	6880.80	5556.20	1218.39	5442.25	0.25	
11724.00	89.750	89.970	6881.04	5644.35	1218.02	5531.25	0.63	
11814.00	89.940	90.400	6881.28	5733.51	1217.73	5621.25	0.52	
11903.00	88.280	89.800	6882.67	5821.67	1217.57	5710.24	1.98	
11993.00	88.430	89.100	6885.25	5910.94	1218.44	5800.20	0.80	
12082.00	89.380	90.440	6886.95	5999.17	1218.80	5889.18	1.85	
12172.00	89.140	89.350	6888.11	6088.38	1218.96	5979.17	1.24	
12262.00	89.170	88.890	6889.44	6177.74	1220.34	6069.15	0.51	
12351.00	89.200	92.570	6890.71	6265.76	1219.21	6158.11	4.13	
12441.00	89.260	93.600	6891.92	6354.17	1214.37	6247.97	1.15	
12530.00	89.420	93.480	6892.94	6441.46	1208.87	6336.80	0.22	
12619.00	89.050	90.690	6894.13	6529.16	1205.63	6425.72	3.16	
12709.00	89.140	89.350	6895.55	6618.34	1205.60	6515.71	1.49	
12798.00	89.350	89.090	6896.73	6706.69	1206.81	6604.69	0.38	
12888.00	89.450	89.580	6897.67	6796.01	1207.86	6694.68	0.56	
12978.00	89.350	91.320	6898.61	6885.10	1207.15	6784.67	1.94	
13067.00	89.170	93.110	6899.76	6972.76	1203.71	6873.59	2.02	
13156.00	89.050	92.770	6901.14	7060.23	1199.15	6962.47	0.41	
13246.00	89.080	91.250	6902.61	7148.93	1195.99	7052.40	1.69	

Actual Wellpath Report

HOOD 11N-22A-M AWP

Page 7 of 11



REFERENCE WELLPATH IDENTIFICATION

Operator	SRC ENERGY	Slot	SLOT#04 HOOD 11N-22A-M (705'FSL & 1122'FEL SEC.20)
Area	COLORADO	Well	HOOD 11N-22A-M
Field	WELD COUNTY (NAD83,TRUE NORTH)	Wellbore	HOOD 11N-22A-M AWB
Facility	SEC.20-T06N-R66W		

WELLPATH DATA (173 stations)

MD [ft]	Inclination [°]	Azimuth [°]	TVD [ft]	Vert Sect [ft]	North [ft]	East [ft]	DLS [°/100ft]	Comments
13335.00	89.230	90.490	6903.92	7236.94	1194.64	7141.37	0.87	
13425.00	89.080	90.140	6905.25	7326.05	1194.15	7231.36	0.42	
13514.00	89.260	89.600	6906.54	7414.27	1194.35	7320.35	0.64	
13604.00	89.110	89.410	6907.82	7503.56	1195.12	7410.34	0.27	
13693.00	89.140	88.870	6909.18	7591.92	1196.46	7499.32	0.61	
13783.00	89.140	88.540	6910.53	7681.35	1198.49	7589.29	0.37	
13872.00	89.080	88.530	6911.91	7769.82	1200.77	7678.25	0.07	
13962.00	89.110	89.060	6913.33	7859.24	1202.66	7768.22	0.59	
14051.00	89.110	89.020	6914.72	7947.62	1204.15	7857.19	0.04	
14141.00	89.140	88.950	6916.09	8037.00	1205.75	7947.17	0.08	
14231.00	89.080	88.710	6917.49	8126.41	1207.58	8037.14	0.27	
14320.00	88.980	88.110	6919.00	8214.90	1210.05	8126.09	0.68	
14408.00	90.340	88.550	6919.52	8302.41	1212.62	8214.05	1.62	
14498.00	89.450	86.420	6919.68	8392.04	1216.57	8303.96	2.56	
14587.00	88.860	86.770	6921.00	8480.78	1221.85	8392.79	0.77	
14677.00	88.980	87.070	6922.69	8570.48	1226.69	8482.64	0.36	
14766.00	88.920	86.340	6924.32	8659.20	1231.80	8571.48	0.82	
14856.00	88.250	89.450	6926.55	8748.74	1235.11	8661.38	3.53	
14945.00	84.140	88.720	6932.45	8836.91	1236.52	8750.15	4.69	
15034.00	83.890	88.770	6941.73	8924.87	1238.46	8838.65	0.29	
15124.00	85.320	92.130	6950.19	9013.55	1237.75	8928.23	4.04	
15196.00	87.510	96.750	6954.70	9083.79	1232.19	8999.85	7.09	LAST BHI MWD SURVEY (1827'FSL & 2636'FWL, SEC.22)
15220.00	87.510	96.750	6955.74	9107.01	1229.37	9023.66	0.00	PROJECTION TO BIT (1824'FSL & 2612'FWL, SEC.22)

Actual Wellpath Report

HOOD 11N-22A-M AWP

Page 8 of 11



REFERENCE WELLPATH IDENTIFICATION

Operator	SRC ENERGY	Slot	SLOT#04 HOOD 11N-22A-M (705'FSL & 1122'FEL SEC.20)
Area	COLORADO	Well	HOOD 11N-22A-M
Field	WELD COUNTY (NAD83,TRUE NORTH)	Wellbore	HOOD 11N-22A-M AWB
Facility	SEC.20-T06N-R66W		

HOLE & CASING SECTIONS - Ref Wellbore: HOOD 11N-22A-M AWB Ref Wellpath: HOOD 11N-22A-M AWP

String/Diameter	Start MD [ft]	End MD [ft]	Interval [ft]	Start TVD [ft]	End TVD [ft]	Start N/S [ft]	Start E/W [ft]	End N/S [ft]	End E/W [ft]
13.5in Open Hole	25.00	1763.00	1738.00	25.00	1750.40	0.00	0.00	119.59	60.10
9.625in Casing Intermediate	25.00	1763.00	1738.00	25.00	1750.40	0.00	0.00	119.59	60.10
8.5in Open Hole	1763.00	15220.00	13457.00	1750.40	6955.74	119.59	60.10	1229.37	9023.66

Actual Wellpath Report

HOOD 11N-22A-M AWP

Page 9 of 11



REFERENCE WELLPATH IDENTIFICATION

Operator	SRC ENERGY	Slot	SLOT#04 HOOD 11N-22A-M (705'FSL & 1122'FEL SEC.20)
Area	COLORADO	Well	HOOD 11N-22A-M
Field	WELD COUNTY (NAD83,TRUE NORTH)	Wellbore	HOOD 11N-22A-M AWB
Facility	SEC.20-T06N-R66W		

TARGETS

Name	TVD [ft]	North [ft]	East [ft]	Grid East [US ft]	Grid North [US ft]	Latitude	Longitude	Shape
SEC.21-T06N-R66W	21.00	60.11	-0.31	3195753.51	1414279.17	40°28'06.478"N	104°47'47.123"W	polygon
SEC.21-T06N-R66W 1/4 LINES	21.00	60.11	-0.31	3195753.51	1414279.17	40°28'06.478"N	104°47'47.123"W	polygon
SEC.22-T06N-R66W	21.00	60.11	-0.31	3195753.51	1414279.17	40°28'06.478"N	104°47'47.123"W	polygon
SEC.22-T06N-R66W 1/4 LINES	21.00	60.11	-0.31	3195753.51	1414279.17	40°28'06.478"N	104°47'47.123"W	polygon
HOOD 11N-22A-M TOP OF PROD. REV-1 (1880'FSL & 75'FWL SEC.21)	6834.00	1192.03	1194.69	3196939.45	1415420.49	40°28'17.663"N	104°47'31.661"W	point
HOOD 11N-22A-M TOP OF PROD. REV-2 (1880'FSL & 75'FWL SEC.21)	6870.95	1192.03	1194.69	3196939.45	1415420.49	40°28'17.663"N	104°47'31.661"W	point
HOOD 11N-22A-M TOP OF PROD. REV-3 (1943'FSL & 75'FWL SEC.21)	6870.95	1255.00	1194.69	3196938.95	1415483.45	40°28'18.285"N	104°47'31.661"W	point
HOOD 11N-22A-M BHL REV-1 (1811'FSL & 2610'FWL SEC.22)	6879.00	1215.88	9025.66	3204769.68	1415506.46	40°28'17.882"N	104°45'50.335"W	point
HOOD 11N-22A-M BHL REV-2 (1811'FSL & 2610'FWL SEC.22)	6944.33	1215.88	9025.66	3204769.68	1415506.46	40°28'17.882"N	104°45'50.335"W	point
SEC.21&22-T06N-R66W 75' SOUTHERN SETBACKS	7209.00	60.11	-0.31	3195753.51	1414279.17	40°28'06.478"N	104°47'47.123"W	polygon

Actual Wellpath Report

HOOD 11N-22A-M AWP

Page 10 of 11



REFERENCE WELLPATH IDENTIFICATION

Operator	SRC ENERGY	Slot	SLOT#04 HOOD 11N-22A-M (705'FSL & 1122'FEL SEC.20)
Area	COLORADO	Well	HOOD 11N-22A-M
Field	WELD COUNTY (NAD83,TRUE NORTH)	Wellbore	HOOD 11N-22A-M AWB
Facility	SEC.20-T06N-R66W		

WELLPATH COMPOSITION - Ref Wellbore: HOOD 11N-22A-M AWB Ref Wellpath: HOOD 11N-22A-M AWP

Start MD [ft]	End MD [ft]	Positional Uncertainty Model	Log Name/Comment	Wellbore
25.00	1712.00	Custom BHI NaviTrak (Standard Rotating+Axial Corr) (Rockies 0.03Gt model)	BHI NAVITRAK 13.5 (STD ROTATING, AXIAL, ROCKIES GT)<109-1712>	HOOD 11N-22A-M AWB
1712.00	15196.00	Custom BHI AutoTrak Curve (IFR1, Short) (Rockies 0.03Gt model)	BHI ATC 8.5" (IFR, SHORT, ROCKIES GT)<1792-15196>	HOOD 11N-22A-M AWB
15196.00	15220.00	Blind Drilling (std)	Projection to bit	HOOD 11N-22A-M AWB

Actual Wellpath Report

HOOD 11N-22A-M AWP

Page 11 of 11



REFERENCE WELLPATH IDENTIFICATION

Operator	SRC ENERGY	Slot	SLOT#04 HOOD 11N-22A-M (705'FSL & 1122'FEL SEC.20)
Area	COLORADO	Well	HOOD 11N-22A-M
Field	WELD COUNTY (NAD83,TRUE NORTH)	Wellbore	HOOD 11N-22A-M AWB
Facility	SEC.20-T06N-R66W		

WELLPATH COMMENTS

MD [ft]	Inclination [°]	Azimuth [°]	TVD [ft]	Comment
7607.00	90.250	87.140	6868.19	LANDING POINT (1964'FSL & 306'FWL, SEC21)
15196.00	87.510	96.750	6954.70	LAST BHI MWD SURVEY (1827'FSL & 2636'FWL, SEC.22)
15220.00	87.510	96.750	6955.74	PROJECTION TO BIT (1824'FSL & 2612'FWL, SEC.22)