

CANADIAN SLANG PAD RECLAIMED PAD LAYOUT

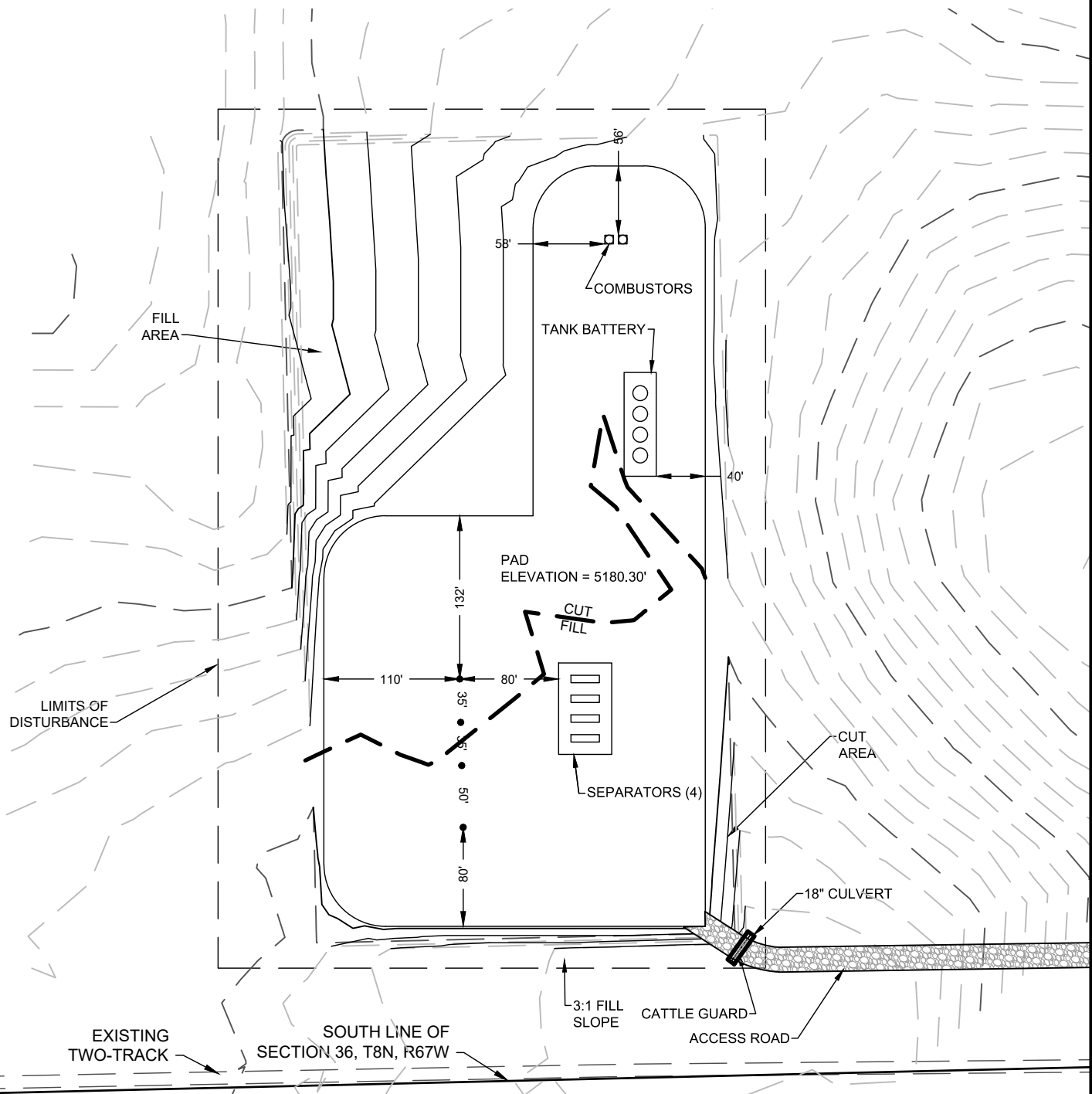

NOTES:

1. A COMPLETE UTILITIES LOCATION IS RECOMMENDED BEFORE CONSTRUCTION.
2. GEOGRAPHIC POSITIONS/COORDINATES SHOWN HEREON ARE IN NAD83 DATUM.
3. EARTHWORK QUANTITIES ARE APPROXIMATE & FOR INFORMATION ONLY. 6" OF TOPSOIL HAS BEEN SUBTRACTED FROM EXISTING SURFACE PRIOR TO PERFORMING EARTHWORK CALCULATIONS.
4. STOCKPILES ARE ASSUMED TO BE 10' IN HEIGHT WITH 2:1 SIDE SLOPES.

DISCLAIMER:
THIS PLOT DOES NOT REPRESENT A MONUMENTED LAND SURVEY AND SHOULD NOT BE RELIED UPON TO DETERMINE BOUNDARY LINES, PROPERTY OWNERSHIP OR OTHER PROPERTY INTERESTS. PARCEL LINES, IF DEPICTED HAVE NOT BEEN FIELD VERIFIED AND MAY BE BASED UPON PUBLICLY AVAILABLE DATA THAT ALSO HAS NOT BEEN INDEPENDENTLY VERIFIED.

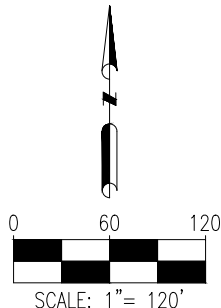

SITE QUANTITIES

FINISHED GRADE ELEVATION	5180.30'
TOTAL CUT FOR RECLAMATION	4,533 CY
FILL FOR RECLAMATION	4,533 CY
10% FILL FACTOR	453 CY
TOTAL FILL	4,986 CY
NET EXCESS MATERIAL	0 CY
TOPSOIL FOR RECLAIMED AREA	1,708 CY
TOTAL INTERIM PAD AREA	3.2 ACRES
TOTAL DISTURBANCE AREA	7.1 ACRES
SEEDING QUANTITIES	167,997 SQ FT

PREPARED BY:



7535 Hilltop Circle
Denver, CO 80221
(303) 928-7128
www.ascentgeomatics.com

FIELD DATE:
12-29-16

DRAWING DATE:
03-26-18

BY:
IJM

CHECKED BY:
RMC

SITE NAME:

CANADIAN SLANG PAD

SURFACE LOCATION:

SE 1/4 SW 1/4 SEC. 36, T8N, R67W, 6TH P.M.

WELD COUNTY, COLORADO

PREPARED FOR:

enerPLUS