



CERTIFICATE OF SURVEY
for
Chandler and Associates Inc.
Larimer County, Colorado

RECEIVED.

DEC 29 1972

COLORADO OIL & GAS COMMISSION

T9N R68W6PM

old line to be at 130' No. of present R.R.
and bend in road

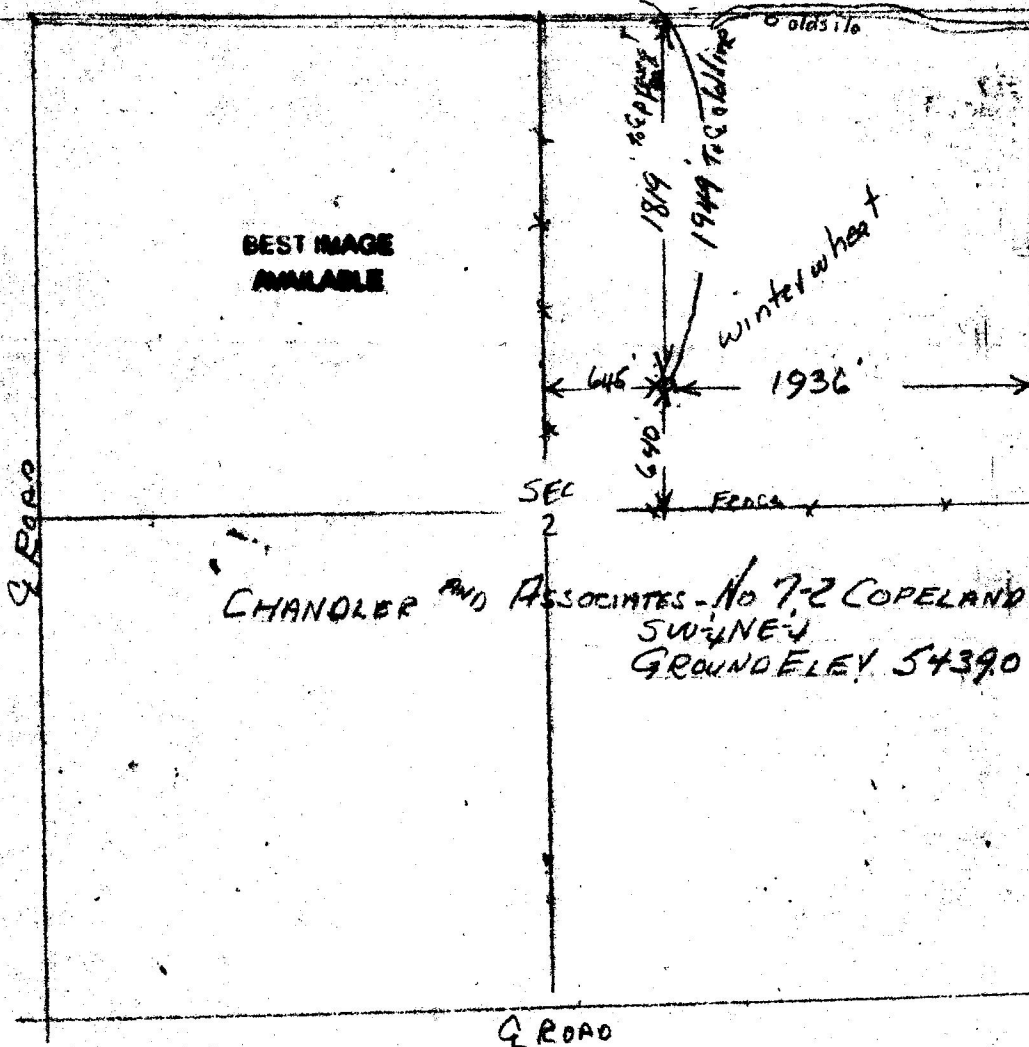

I hereby certify that above plat is an accurate representation of a correct survey showing the location of Chandler and Associates Inc. No. 7-2 Copeland Oilwell in ~~SW 1/4~~ Sec. 2 T9N R68W 6PM. The elevation of the ground at the stake is 5439.0 feet above sea level from U.S.G.S. Mark.

Fort Morgan, Colorado
Dec. 24, 1972

Becil J. Osborne
Registered Professional Engineer
State of Colorado