

BEST COPY
AVAILABLE

R. 97 W

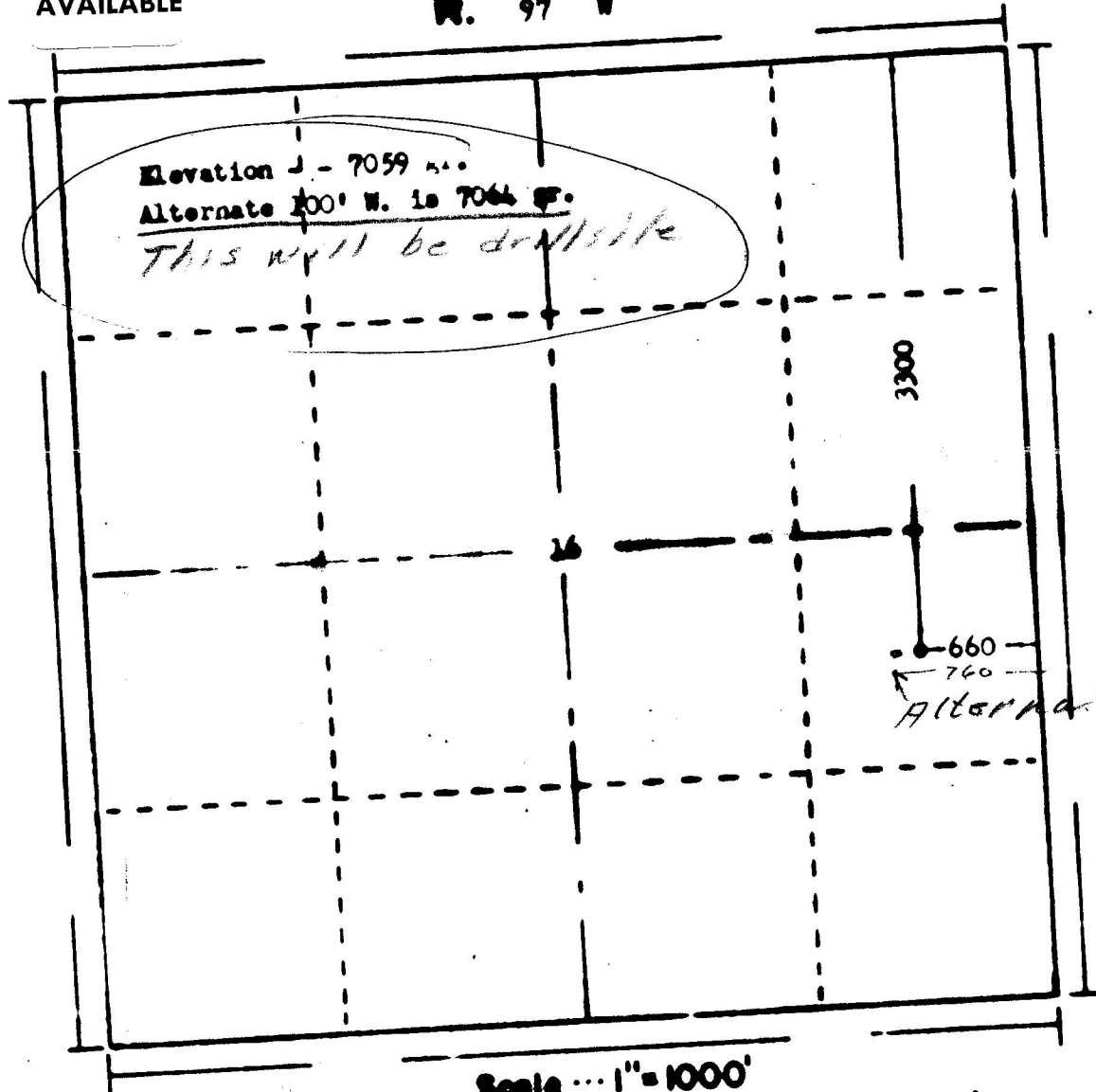

T. 11 N

Scale ... 1" = 1000'

Powers Surveyor, Inc. of Denver, Colorado
has in accordance with a request from Mr. Peays
for J. M. Huber Corporation determined the
Location of #1 Chapman-State
to be C NE SE Section 16 Township 11 N
Range 97 W. of the Sixth Principal Meridian
Moffat County, Colorado

RECEIVED
FEB 21 1966
OIL & GAS
COMMISSION

I hereby certify that this plot is an
accurate representation of a correct
vey showing the location of
Chapman-State

66 64



Date: 2-16-66

J. Nelson
Licensed Land Surveyor No. 2188
State of Colorado

BEST COPY
AVAILABLE