

ESTIMATED EARTHWORK

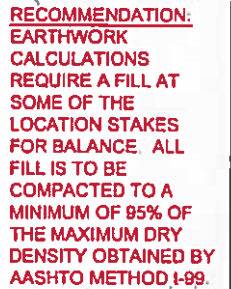

ITEM	CUT	FILL	TOPSOIL	EXCESS
PAD	7,440 CY	5,611 CY	1,819 CY	10 CY
PIT	NONE			NONE
TOTALS	7,440 CY	5,611 CY	1,819 CY	10 CY

01 ETHWRK

UNGRADED ELEVATION: 7390.9'
 FINAL ELEVATION: 7392.9'
 PROPOSED AREA OF DISTURBANCE: 4.2± ACRES
 DRAINS TO BUZZARD CREEK

RIG LAYOUT

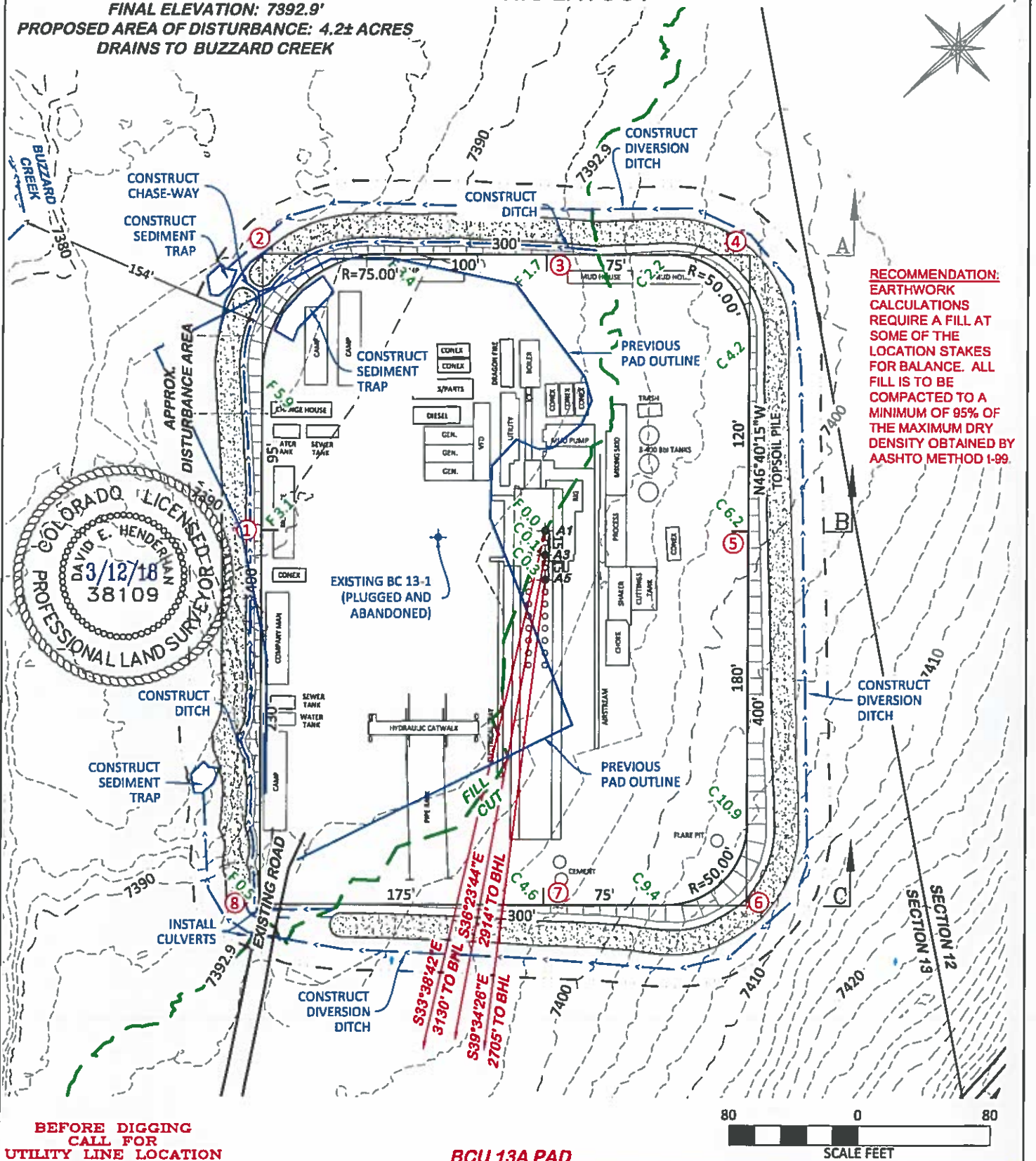

RECOMMENDATION:
 EARTHWORK
 CALCULATIONS
 REQUIRE A FILL AT
 SOME OF THE
 LOCATION STAKES
 FOR BALANCE. ALL
 FILL IS TO BE
 COMPACTED TO A
 MINIMUM OF 95% OF
 THE MAXIMUM DRY
 DENSITY OBTAINED BY
 AASHTO METHOD 1-99.

**BEFORE DIGGING
 CALL FOR
 UTILITY LINE LOCATION**

BCU 13A PAD

80 0 80
 SCALE FEET

CONSTRUCTION LAYOUT DRAWING 2 OF 6

DRG **RIFFIN & ASSOCIATES, INC.**
 (307) 362-5028 1414 ELK ST., ROCK SPRINGS, WY 82901

DRAWN: 1/22/2018 - TCM	SCALE: 1" = 80'
REVISED: 3/12/2018 - DEH	DRG JOB No. 21205
MISC. REVISIONS	02 RIG

RIG LAYOUT
LARAMIE ENERGY, LLC.
BCU 13A
NENE, SECTION 13, T.9 S., R.93 W., 6th P.M.,
MESA COUNTY, COLORADO

UNGRADED ELEVATION: 7390.9'
 FINAL ELEVATION: 7392.9'
 PROPOSED AREA OF DISTURBANCE: 4.2± ACRES
 DRAINS TO BUZZARD CREEK

RIG DETAIL

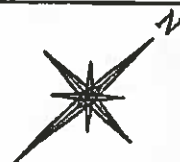

RECOMMENDATION:
 EARTHWORK
 CALCULATIONS
 REQUIRE A FILL AT
 SOME OF THE
 LOCATION STAKES
 FOR BALANCE. ALL
 FILL IS TO BE
 COMPACTED TO A
 MINIMUM OF 95% OF
 THE MAXIMUM DRY
 DENSITY OBTAINED BY
 AASHTO METHOD 1-99.

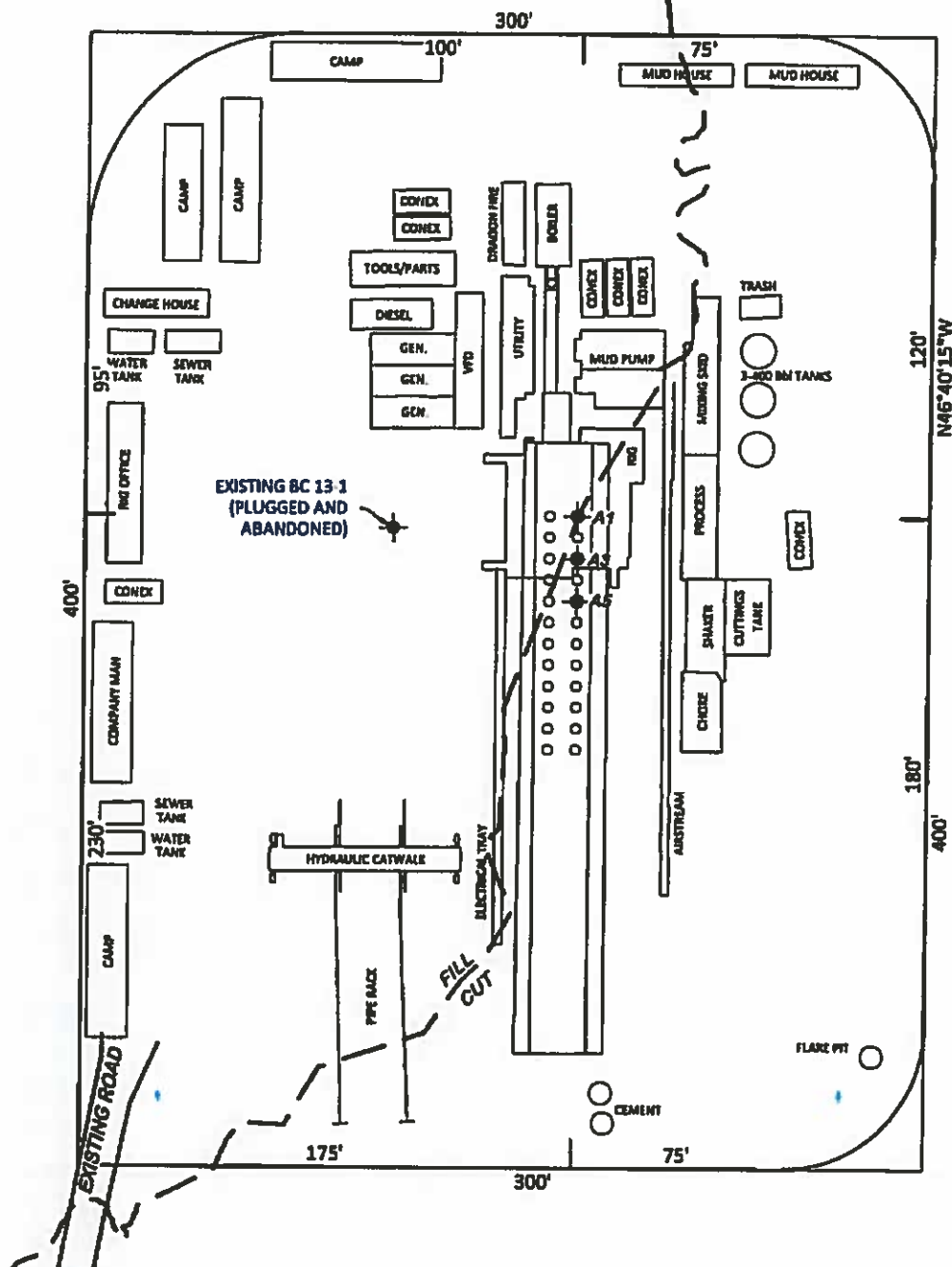

**BEFORE DIGGING
 CALL FOR
 UTILITY LINE LOCATION**

BCU 13A PAD



CONSTRUCTION LAYOUT DRAWING 3 OF 6

DRG RIFFIN & ASSOCIATES, INC. (307) 363-5025 1414 ELK ST., ROCK SPRINGS, WY 82901	
DRAWN: 1/22/2018 - TCM	SCALE: 1" = 50'
REVISED: 1/24/2018 - DEH	DRG JOB No. 21205
MISC. REVISIONS	02 RIG DET

**RIG DETAIL
 LARAMIE ENERGY, LLC.
 BCU 13A
 NENE, SECTION 13, T.9 S., R.93 W., 6th P.M.,
 MESA COUNTY, COLORADO**

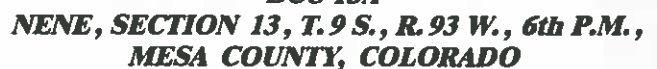
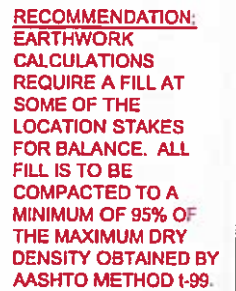

DRAWN: 1/22/2018 - TCM	SCALE: 1" = 80'
REVISED: 3/12/2018 - DEH	DRG JOB No. 21205
MISC. REVISIONS	03 DSGN CONT

APPROXIMATE DISTURBANCE AREA 4.2± ACRES
 PROPOSED RECLAMATION AREA: 2.7± ACRES
 INTERIM RECLAMATION DISTURBANCE: 1.5± ACRES

PROPOSED RECLAMATION

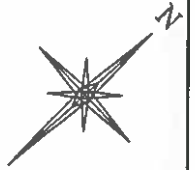

RECOMMENDATION:
 EARTHWORK
 CALCULATIONS
 REQUIRE A FILL AT
 SOME OF THE
 LOCATION STAKES
 FOR BALANCE. ALL
 FILL IS TO BE
 COMPACTED TO A
 MINIMUM OF 95% OF
 THE MAXIMUM DRY
 DENSITY OBTAINED BY
 AASHTO METHOD 1-99.

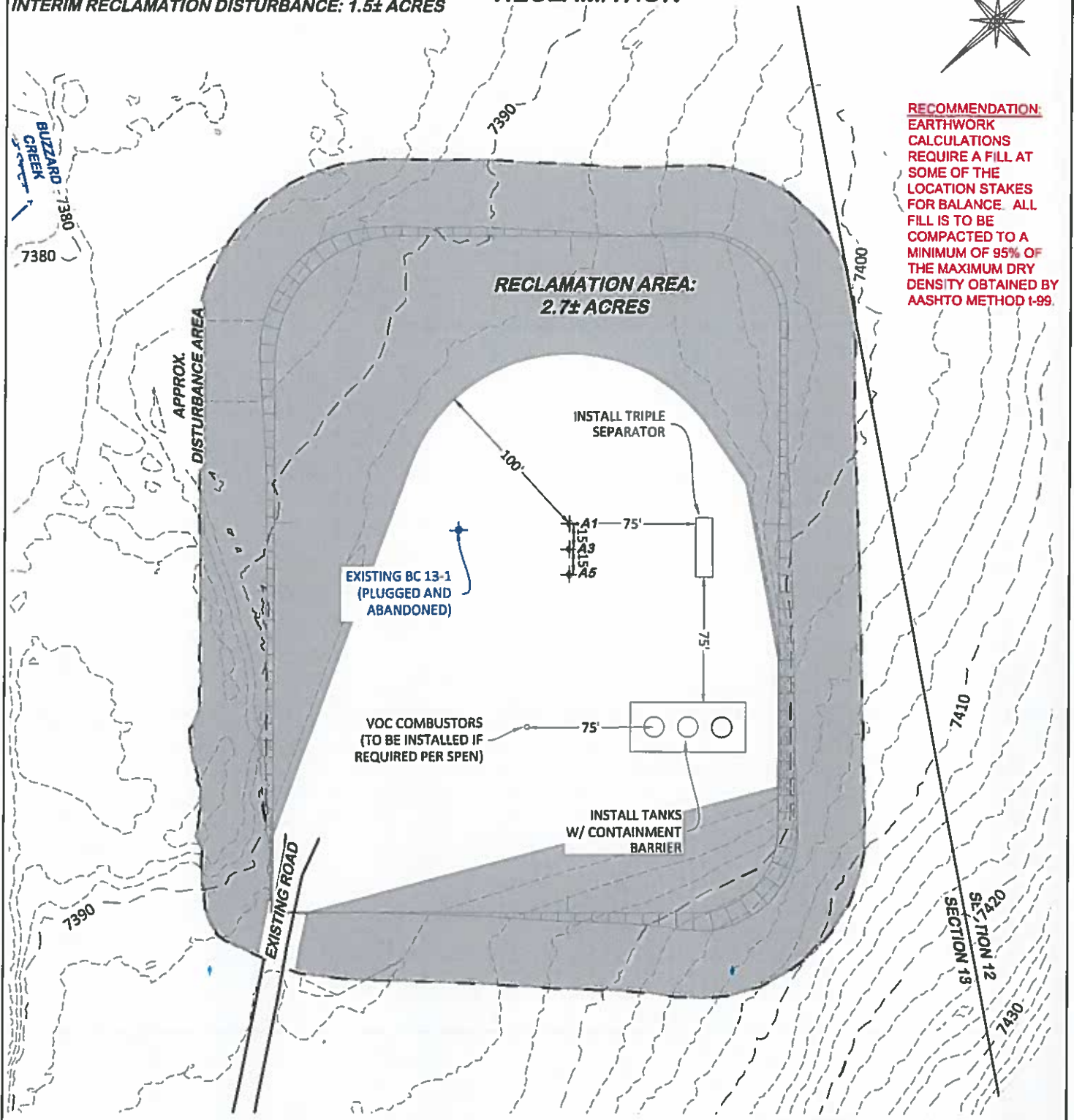

**BEFORE DIGGING
 CALL FOR
 UTILITY LINE LOCATION**

BCU 13A PAD



CONSTRUCTION LAYOUT DRAWING 5 OF 6

DRG RIFFIN & ASSOCIATES, INC.
 (307) 362-5028 1414 ELK ST., ROCK SPRINGS, WY 82901

DRAWN: 1/22/2018 - TCM	SCALE: 1" = 80'
REVISED: 3/12/2018 - DEH	DRG JOB No. 21205
REVISED RECLAMATION	04 REC

**PROPOSED RECLAMATION
 LARAMIE ENERGY, LLC.
 BCU 13A
 NENE, SECTION 13, T.9 S., R.93 W., 6th P.M.,
 MESA COUNTY, COLORADO**

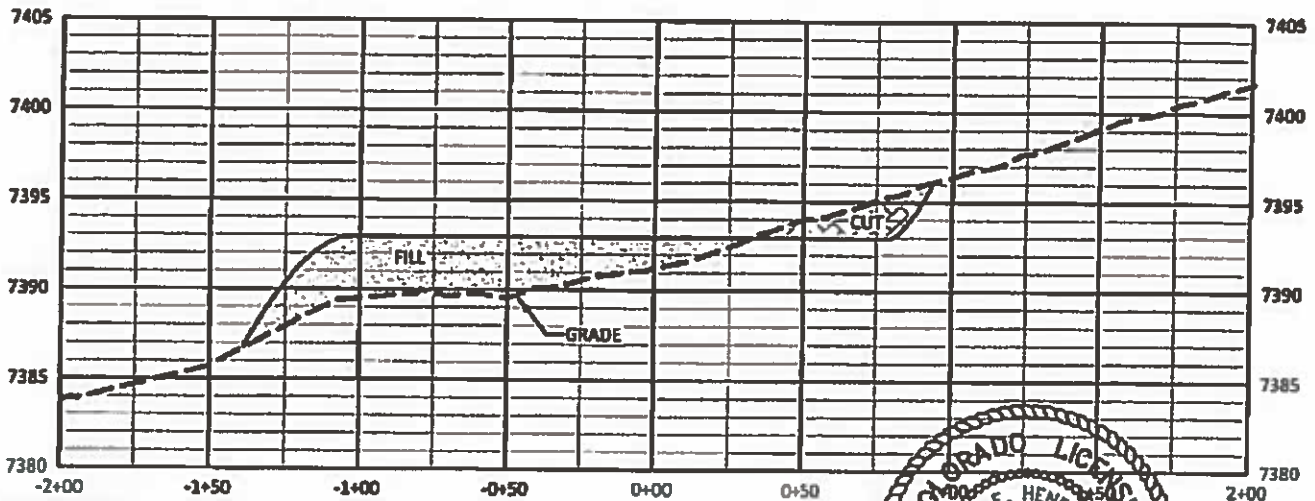

RECOMMENDATION:
EARTHWORK CALCULATIONS REQUIRE A FILL AT SOME OF THE LOCATION STAKES FOR BALANCE. ALL FILL IS TO BE COMPACTED TO A MINIMUM OF 85% OF THE MAXIMUM DRY DENSITY OBTAINED BY AASHTO METHOD T-99.

A

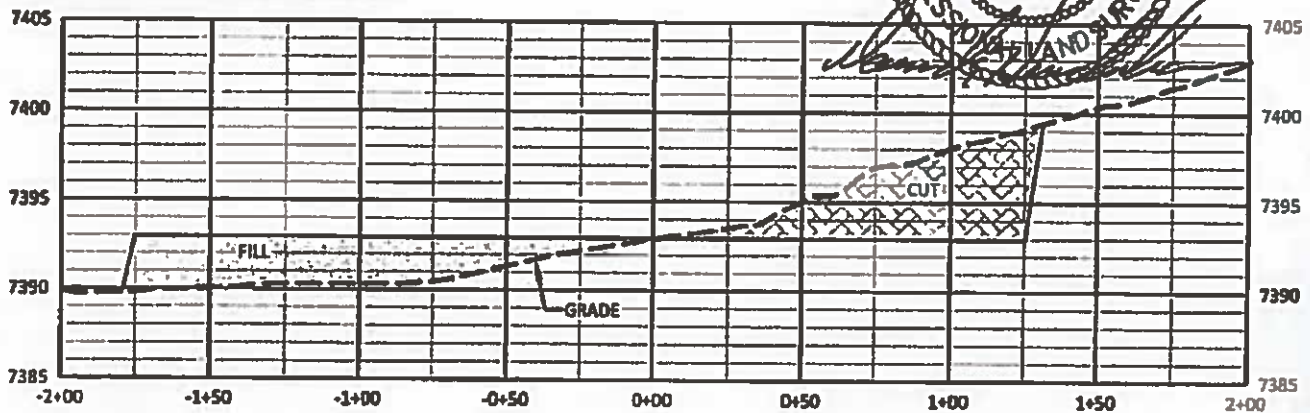

B

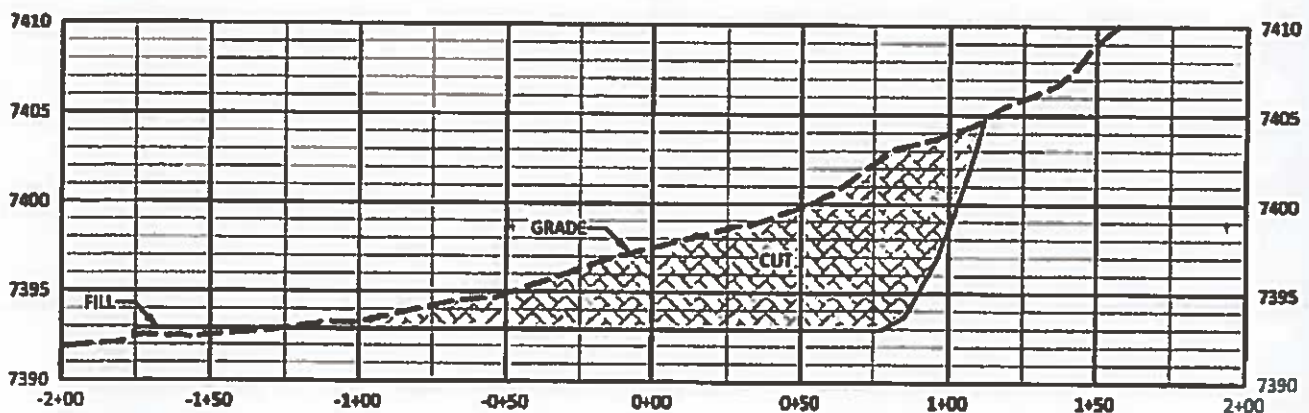

C

BCU 13A PAD

CONSTRUCTION LAYOUT DRAWING 6 OF 6



(307) 362-6222

RIFFIN & ASSOCIATES, INC.
1414 ELK ST., ROCK SPRINGS, WY 82901

DRAWN: 1/22/2018 - TCM

SCALE: H - 1" = 60' V - 1" = 10'

REVISED: N/A -

DRG JOB No. 21205

06 XSEC

LARAMIE ENERGY, LLC.
BCU 13A

NENE, SECTION 13, T. 9 S., R. 93 W., 6th P.M.,
MESA COUNTY, COLORADO