

R
67
W

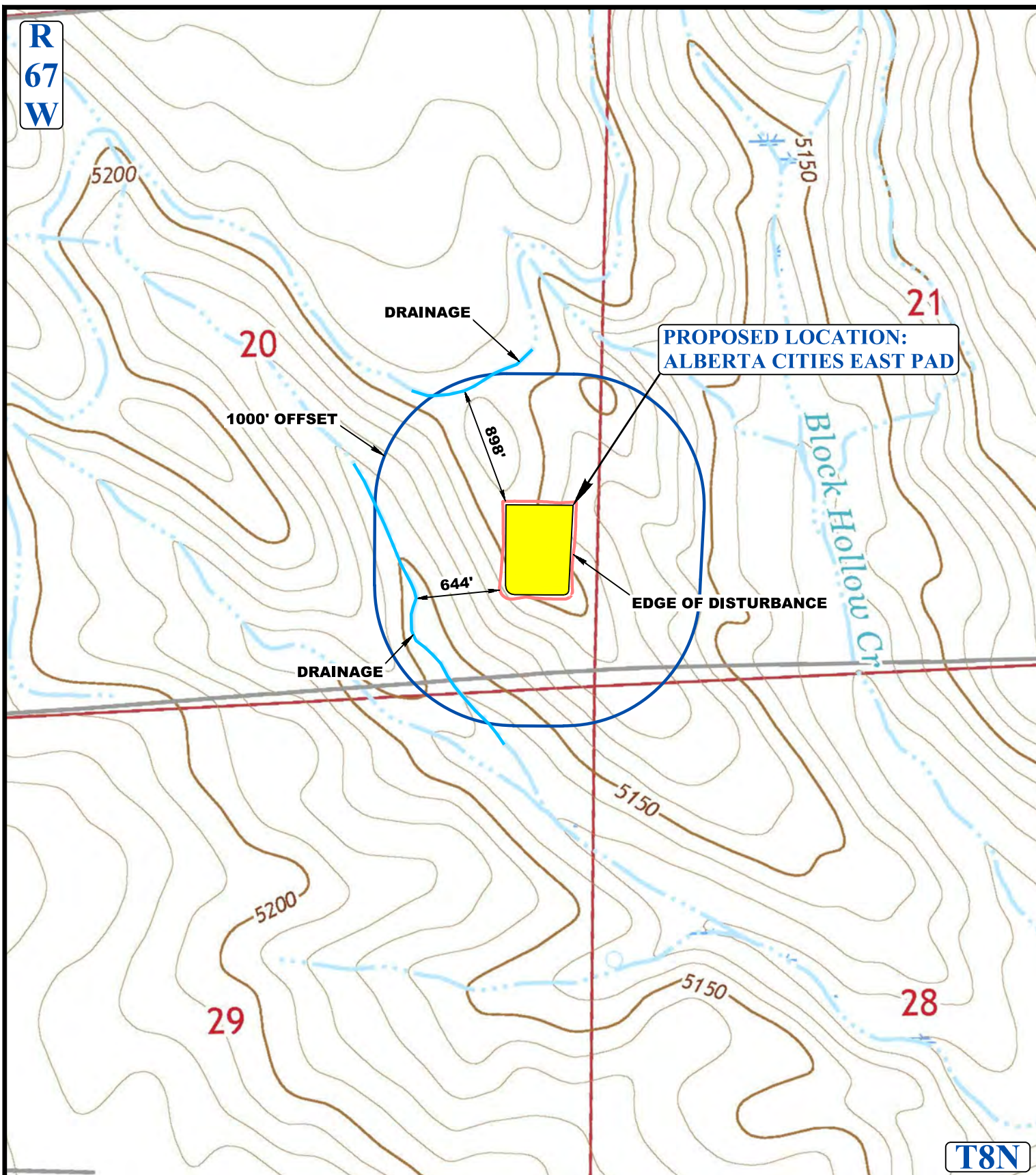

LEGEND:

- EXISTING DRAINAGE
- 1000' OFFSET BOUNDARY
- EDGE OF DISTURBANCE
- WATER WELLS



UELS, LLC
Corporate Office * 85 South 200 East
Vernal, UT 84078 * (435) 789-1017



ENERPLUS RESOURCES (USA) CORPORATION

ALBERTA CITIES PAD EAST
SE 1/4 SE 1/4, SECTION 20, T8N, R67W, 6th P.M.
WELD COUNTY, COLORADO

SURVEYED BY	C. MEIERS, J.B.	12-06-17	SCALE
DRAWN BY	T.L.	01-10-18	1 : 12,000
HYDROLOGY MAP			TOPO W