

LEGEND:

● PROPOSED LOCATION



UELS, LLC
Corporate Office * 85 South 200 East
Vernal, UT 84078 * (435) 789-1017



ConocoPhillips Company

ARKANSAS #4-64 3-2 3AH, 3BH, 3CH & 3DH
NW 1/4 SW 1/4, SECTION 3, T4S, R64W, 6th P.M.
ARAPAHOE COUNTY, COLORADO

| | | | |
|-----------------|------------|----------|-------------|
| SURVEYED BY | C.M., G.B. | 10-20-17 | SCALE |
| DRAWN BY | J.L.G. | 09-07-17 | 1 : 100,000 |
| ACCESS ROAD MAP | | | TOPO A |

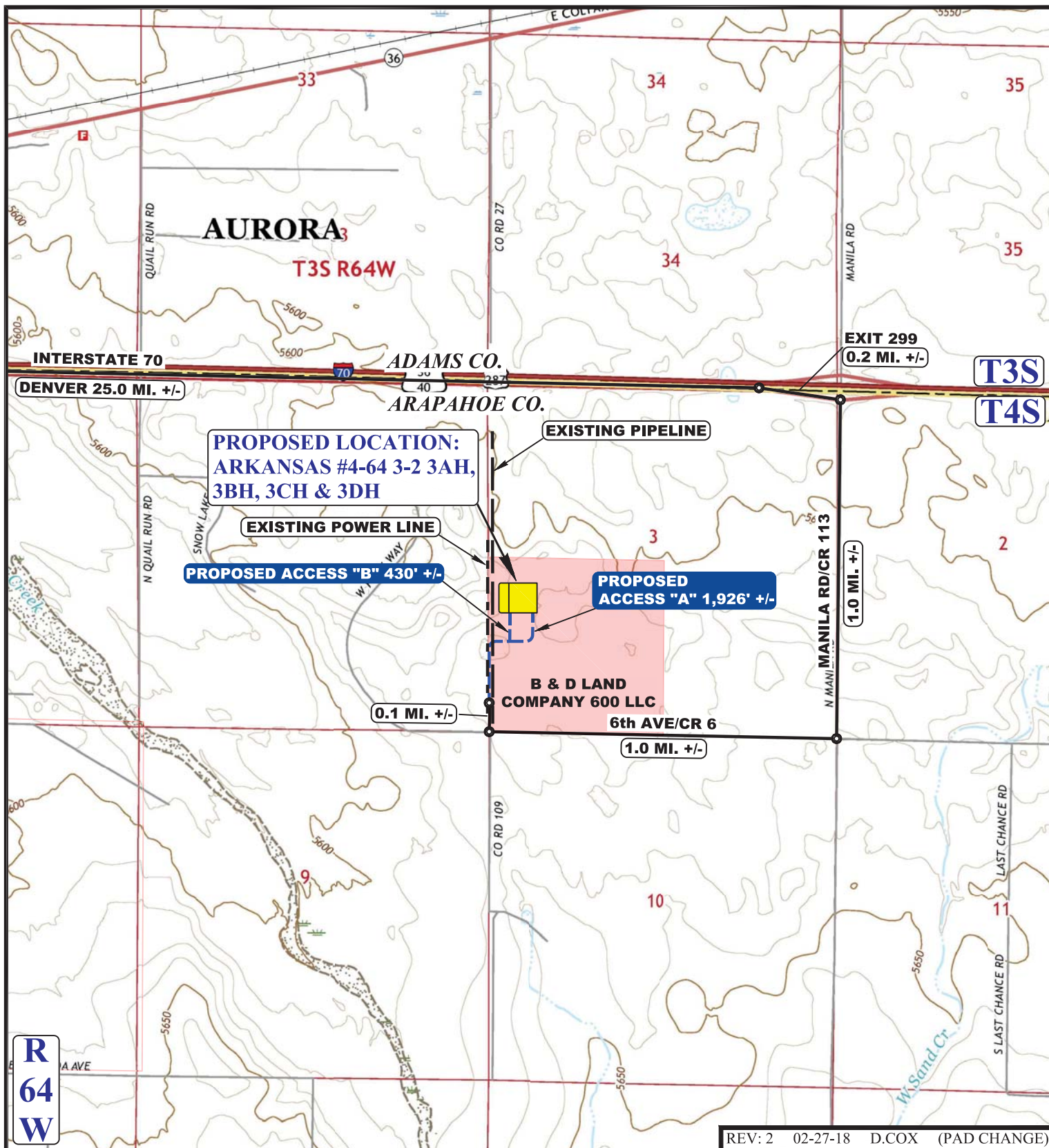

NOTE: PARCEL DATA SHOWN HAS BEEN OBTAINED FROM VARIOUS SOURCES AND SHOULD BE USED FOR MAPPING, GRAPHIC AND PLANNING PURPOSES ONLY. NO WARRANTY IS MADE BY UINTAH ENGINEERING AND LAND SURVEYING (UELS) FOR ACCURACY OF THE PARCEL DATA.

LEGEND:

- EXISTING ROAD
- - - PROPOSED ROAD
- - - EXISTING POWER LINE
- - - EXISTING PIPELINE



UELS, LLC
Corporate Office * 85 South 200 East
Vernal, UT 84078 * (435) 789-1017



ConocoPhillips Company

ARKANSAS #4-64 3-2 3AH, 3BH, 3CH & 3DH
NW 1/4 SW 1/4, SECTION 3, T4S, R64W, 6th P.M.
ARAPAHOE COUNTY, COLORADO

| | | | |
|------------------------|------------|----------|---------------|
| SURVEYED BY | C.M., G.B. | 10-20-17 | SCALE |
| DRAWN BY | J.L.G. | 09-07-17 | 1 : 24,000 |
| ACCESS ROAD MAP | | | TOPO B |