

NOBLE ENERGY, INC

Location: COLORADO Slot: SLOT#09 HULLABALOO Y21-726(445'FNL&930'FEL,SEC.16)
Field: WELD COUNTY (NOBLE NAD 83 GRID) Well: HULLABALOO Y21-726
Facility: SEC.16-T02N-R64W Wellbore: HULLABALOO Y21-726 PWB

Plot reference wellpath is HULLABALOO Y21-726 (REV-A.0) PWP	Grid System: NAD83 / Lambert Colorado SP, Northern Zone (501), US feet
True vertical depths are referenced to RIG (30'KB) (RKB)	* = Wellpath was transformed from a different geodetic datum
Measured depths are referenced to RIG (30'KB) (RKB)	North Reference: Grid north
RIG (30'KB) (RKB) to Mean Sea Level: 4975 feet	Scale: True distance
Mean Sea Level to Ground level (At Slot: SLOT#09 HULLABALOO Y21-726(445'FNL&930'FEL,SEC.16)): 0 feet	Depths are in feet
Coordinates are in feet referenced to Slot	Created by: guenaler on 2017-11-07
	Database: WA_DEN_Denver_Defn

Comments

SURFACE LOCATION: NENE

40.14452 N

104.55031 W

API: 05-123-45234

Location Information

Facility Name				Grid East (US R)	Grid North (US R)	Latitude	Longitude
SEC.16-T02N-R64W				3261942.561	1296894.275	40°08'40.452"N	104°33'46.800"W
Slot	Local N (R)	Local E (R)	Grid East (US R)	Grid North (US R)	Latitude	Longitude	
SLOT#09 HULLABALOO Y21-726(445'FNL&930'FEL,SEC.16)	19.53	3547.76	3265490.167	1296913.802	40°08'40.272"N	104°33'01.116"W	
RIG (30'KB) (RKB) to Ground level (At Slot: SLOT#09 HULLABALOO Y21-726(445'FNL&930'FEL,SEC.16))						4975R	
Mean Sea Level to Ground level (At Slot: SLOT#09 HULLABALOO Y21-726(445'FNL&930'FEL,SEC.16))						0R	
RIG (30'KB) (RKB) to Mean Sea Level						4975R	

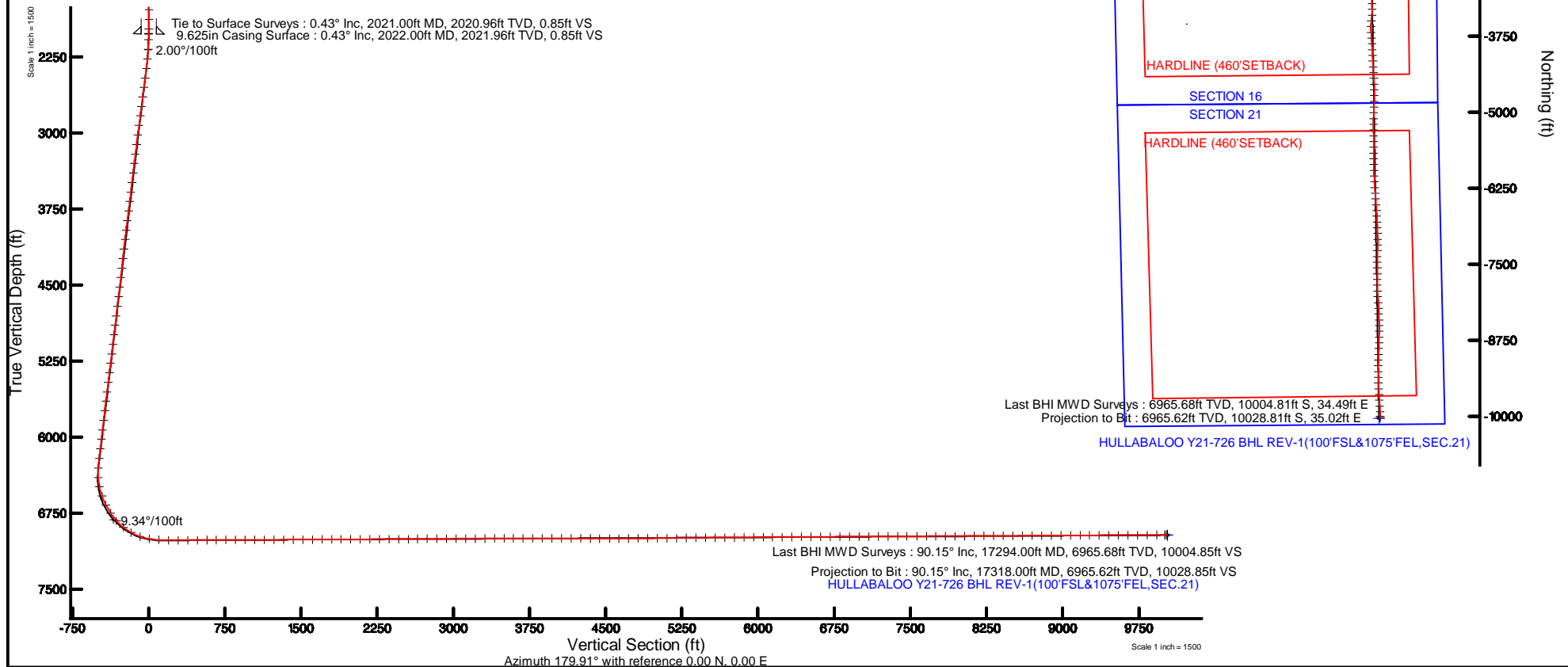

REFERENCE WELLPATH IDENTIFICATION			
Operator	NOBLE ENERGY, INC	Slot	SLOT#09 HULLABALOO Y21-726(445'FNL&930'FEL,SEC.16)
Area	COLORADO	Well	HULLABALOO Y21-726
Field	WELD COUNTY (NOBLE NAD 83 GRID)	Wellbore	HULLABALOO Y21-726 AWB
Facility	SEC.16-T02N-R64W		

REPORT SETUP INFORMATION			
Projection System	NAD83 / Lambert Colorado SP, Northern Zone (501), US feet	Software System	WellArchitect® 5.0
North Reference	Grid	User	Guenaler
Scale	0.999959	Report Generated	11/7/2017 at 2:46:17 PM
Convergence at slot	0.62° East	Database/Source file	WA_DEN_Denver_Defn/HULLABALOO_Y21-726_AWP.xml

WELLPATH LOCATION						
	Local coordinates		Grid coordinates		Geographic coordinates	
	North[ft]	East[ft]	Easting[US ft]	Northing[US ft]	Latitude	Longitude
Slot Location	19.53	3547.76	3265490.17	1296913.80	40°08'40.272"N	104°33'01.116"W
Facility Reference Pt			3261942.56	1296894.28	40°08'40.452"N	104°33'46.800"W
Field Reference Pt			3000000.00	4454105.15	48°46'34.315"N	105°30'00.000"W

WELLPATH DATUM			
Calculation method	Minimum curvature	RIG (30'KB) (RKB) to Facility Vertical Datum	4975.00ft
Horizontal Reference Pt	Slot	RIG (30'KB) (RKB) to Mean Sea Level	4975.00ft
Vertical Reference Pt	RIG (30'KB) (RKB)	RIG (30'KB) (RKB) to Ground Level at Slot (SLOT#09 HULLABALOO Y21-726 (445'FNL&930'FEL,SEC.16))	4975.00ft
MD Reference Pt	RIG (30'KB) (RKB)	Section Origin	N 0.00, E 0.00 ft
Field Vertical Reference	Mean Sea Level	Section Azimuth	179.91°



Actual Wellpath Report

HULLABALOO Y21-726 AWP



REFERENCE WELLPATH IDENTIFICATION			
Operator	NOBLE ENERGY, INC	Slot	SLOT#09 HULLABALOO Y21-726(445'FNL&930'FEL,SEC.16)
Area	COLORADO	Well	HULLABALOO Y21-726
Field	WELD COUNTY (NOBLE NAD 83 GRID)	Wellbore	HULLABALOO Y21-726 AWP
Facility	SEC.16-T02N-R64W		

WELLPATH DATA (186 stations)										
MD [ft]	Inclination [°]	Azimuth [°]	TVD [ft]	Vert Sect [ft]	North [ft]	East [ft]	Latitude	Longitude	DLS [°/100ft]	Comments
0.00	0.000	129.630	0.00	0.00	0.00	0.00	40°08'40.272"N	104°33'01.116"W	0.00	
82.60	0.600	129.630	82.60	0.28	-0.28	0.33	40°08'40.269"N	104°33'01.112"W	0.73	
176.42	0.410	110.660	176.41	0.71	-0.71	1.03	40°08'40.265"N	104°33'01.103"W	0.27	
268.83	0.330	156.550	268.82	1.07	-1.07	1.44	40°08'40.261"N	104°33'01.098"W	0.32	
363.40	0.420	96.330	363.39	1.36	-1.36	1.89	40°08'40.258"N	104°33'01.092"W	0.41	
458.10	0.360	123.710	458.09	1.56	-1.56	2.49	40°08'40.256"N	104°33'01.084"W	0.20	
552.96	0.830	110.940	552.94	1.98	-1.97	3.38	40°08'40.252"N	104°33'01.073"W	0.51	
647.68	0.450	182.380	647.66	2.59	-2.59	4.00	40°08'40.246"N	104°33'01.065"W	0.85	
742.44	0.330	144.150	742.42	3.19	-3.18	4.15	40°08'40.240"N	104°33'01.063"W	0.29	
837.08	0.150	108.440	837.06	3.45	-3.44	4.42	40°08'40.238"N	104°33'01.060"W	0.24	
931.66	0.150	276.000	931.64	3.47	-3.47	4.42	40°08'40.237"N	104°33'01.060"W	0.32	
1026.24	0.020	98.810	1026.22	3.46	-3.46	4.31	40°08'40.237"N	104°33'01.061"W	0.18	
1121.00	0.430	19.090	1120.98	3.13	-3.12	4.44	40°08'40.241"N	104°33'01.059"W	0.45	
1215.61	0.410	89.050	1215.58	2.79	-2.78	4.90	40°08'40.244"N	104°33'01.053"W	0.51	
1310.27	0.520	102.640	1310.24	2.88	-2.87	5.66	40°08'40.243"N	104°33'01.044"W	0.16	
1404.60	0.330	349.470	1404.57	2.71	-2.70	6.02	40°08'40.245"N	104°33'01.039"W	0.76	
1499.07	0.240	343.490	1499.04	2.25	-2.24	5.92	40°08'40.249"N	104°33'01.040"W	0.10	
1593.74	0.380	213.910	1593.71	2.32	-2.31	5.69	40°08'40.249"N	104°33'01.043"W	0.60	
1688.63	0.150	50.920	1688.60	2.50	-2.49	5.61	40°08'40.247"N	104°33'01.044"W	0.55	
1783.09	0.250	296.710	1783.06	2.33	-2.32	5.52	40°08'40.248"N	104°33'01.045"W	0.36	
1877.64	0.470	329.120	1877.60	1.90	-1.90	5.14	40°08'40.253"N	104°33'01.050"W	0.31	
1972.14	0.470	18.520	1972.10	1.20	-1.20	5.06	40°08'40.260"N	104°33'01.051"W	0.42	
2021.00	0.430	28.650	2020.96	0.85	-0.85	5.21	40°08'40.263"N	104°33'01.049"W	0.18	Tie to Surface Surveys
2081.00	0.870	320.920	2080.96	0.30	-0.29	5.03	40°08'40.269"N	104°33'01.051"W	1.35	
2175.00	4.070	331.970	2174.86	-3.20	3.20	3.01	40°08'40.303"N	104°33'01.077"W	3.43	
2270.00	7.200	331.280	2269.39	-11.41	11.40	-1.43	40°08'40.385"N	104°33'01.133"W	3.30	
2364.00	7.540	336.190	2362.61	-22.22	22.21	-6.75	40°08'40.492"N	104°33'01.200"W	0.76	
2459.00	7.590	344.260	2456.79	-33.97	33.95	-10.97	40°08'40.609"N	104°33'01.253"W	1.12	
2553.00	7.550	351.140	2549.97	-46.05	46.03	-13.61	40°08'40.728"N	104°33'01.285"W	0.96	
2648.00	7.630	355.270	2644.14	-58.51	58.48	-15.09	40°08'40.851"N	104°33'01.302"W	0.58	



Actual Wellpath Report

HULLABALOO Y21-726 AWP



REFERENCE WELLPATH IDENTIFICATION			
Operator	NOBLE ENERGY, INC	Slot	SLOT#09 HULLABALOO Y21-726(445'FNL&930'FEL,SEC.16)
Area	COLORADO	Well	HULLABALOO Y21-726
Field	WELD COUNTY (NOBLE NAD 83 GRID)	Wellbore	HULLABALOO Y21-726 AWP
Facility	SEC.16-T02N-R64W		

WELLPATH DATA (186 stations)										
MD [ft]	Inclination [°]	Azimuth [°]	TVD [ft]	Vert Sect [ft]	North [ft]	East [ft]	Latitude	Longitude	DLS [°/100ft]	Comments
2743.00	7.580	4.270	2738.31	-71.04	71.02	-15.14	40°08'40.975"N	104°33'01.301"W	1.25	
2837.00	7.160	1.910	2831.53	-83.08	83.05	-14.48	40°08'41.094"N	104°33'01.291"W	0.55	
2932.00	7.260	355.980	2925.78	-94.98	94.96	-14.71	40°08'41.212"N	104°33'01.292"W	0.79	
3026.00	7.350	350.850	3019.02	-106.85	106.82	-16.08	40°08'41.329"N	104°33'01.308"W	0.70	
3121.00	7.220	345.560	3113.25	-118.63	118.60	-18.54	40°08'41.446"N	104°33'01.338"W	0.72	
3216.00	7.220	341.380	3207.50	-130.07	130.04	-21.93	40°08'41.559"N	104°33'01.380"W	0.55	
3310.00	7.190	341.330	3300.76	-141.25	141.21	-25.70	40°08'41.670"N	104°33'01.427"W	0.03	
3405.00	7.150	343.850	3395.01	-152.57	152.52	-29.25	40°08'41.782"N	104°33'01.472"W	0.33	
3499.00	7.150	342.750	3488.28	-163.78	163.73	-32.61	40°08'41.893"N	104°33'01.513"W	0.15	
3594.00	7.140	345.100	3582.54	-175.13	175.08	-35.88	40°08'42.006"N	104°33'01.554"W	0.31	
3688.00	7.210	343.700	3675.81	-186.45	186.39	-39.04	40°08'42.118"N	104°33'01.593"W	0.20	
3783.00	7.100	347.580	3770.07	-197.91	197.84	-41.97	40°08'42.231"N	104°33'01.629"W	0.52	
3877.00	7.200	346.310	3863.34	-209.31	209.24	-44.62	40°08'42.344"N	104°33'01.662"W	0.20	
3972.00	7.310	345.410	3957.58	-220.94	220.87	-47.55	40°08'42.460"N	104°33'01.698"W	0.17	
4067.00	7.320	339.740	4051.81	-232.48	232.40	-51.17	40°08'42.574"N	104°33'01.743"W	0.76	
4161.00	7.400	332.350	4145.03	-243.46	243.38	-56.05	40°08'42.683"N	104°33'01.804"W	1.01	
4256.00	6.860	326.280	4239.30	-253.61	253.52	-62.04	40°08'42.784"N	104°33'01.880"W	0.97	
4351.00	6.940	331.900	4333.61	-263.40	263.30	-67.89	40°08'42.881"N	104°33'01.954"W	0.72	
4445.00	6.960	340.120	4426.92	-273.77	273.67	-72.50	40°08'42.984"N	104°33'02.012"W	1.06	
4540.00	6.970	348.320	4521.23	-284.84	284.72	-75.63	40°08'43.093"N	104°33'02.051"W	1.05	
4635.00	6.960	349.460	4615.53	-296.14	296.03	-77.85	40°08'43.205"N	104°33'02.078"W	0.15	
4729.00	7.020	350.590	4708.83	-307.41	307.29	-79.83	40°08'43.317"N	104°33'02.102"W	0.16	
4824.00	6.910	346.220	4803.13	-318.69	318.57	-82.14	40°08'43.429"N	104°33'02.130"W	0.57	
4918.00	6.870	346.970	4896.45	-329.67	329.54	-84.75	40°08'43.537"N	104°33'02.162"W	0.10	
5013.00	6.840	349.290	4990.77	-340.76	340.63	-87.09	40°08'43.647"N	104°33'02.190"W	0.29	
5108.00	6.530	352.910	5085.12	-351.69	351.55	-88.80	40°08'43.755"N	104°33'02.211"W	0.55	
5202.00	7.270	351.230	5178.44	-362.87	362.73	-90.37	40°08'43.866"N	104°33'02.230"W	0.82	
5296.00	7.280	348.550	5271.69	-374.59	374.45	-92.46	40°08'43.982"N	104°33'02.255"W	0.36	
5391.00	7.340	345.670	5365.91	-386.37	386.23	-95.16	40°08'44.099"N	104°33'02.288"W	0.39	
5486.00	7.140	346.360	5460.16	-397.99	397.85	-98.05	40°08'44.214"N	104°33'02.324"W	0.23	



Actual Wellpath Report

HULLABALOO Y21-726 AWP



REFERENCE WELLPATH IDENTIFICATION			
Operator	NOBLE ENERGY, INC	Slot	SLOT#09 HULLABALOO Y21-726(445'FNL&930'FEL,SEC.16)
Area	COLORADO	Well	HULLABALOO Y21-726
Field	WELD COUNTY (NOBLE NAD 83 GRID)	Wellbore	HULLABALOO Y21-726 AWB
Facility	SEC.16-T02N-R64W		

WELLPATH DATA (186 stations)										
MD [ft]	Inclination [°]	Azimuth [°]	TVD [ft]	Vert Sect [ft]	North [ft]	East [ft]	Latitude	Longitude	DLS [°/100ft]	Comments
5580.00	7.300	348.640	5553.41	-409.53	409.38	-100.60	40°08'44.328"N	104°33'02.355"W	0.35	
5675.00	7.040	343.280	5647.67	-421.03	420.87	-103.47	40°08'44.442"N	104°33'02.390"W	0.76	
5769.00	6.850	345.690	5740.98	-431.98	431.82	-106.51	40°08'44.550"N	104°33'02.428"W	0.37	
5864.00	6.820	348.960	5835.30	-443.01	442.85	-108.99	40°08'44.660"N	104°33'02.458"W	0.41	
5958.00	6.790	351.160	5928.64	-453.98	453.82	-110.91	40°08'44.768"N	104°33'02.482"W	0.28	
6053.00	6.860	343.860	6022.97	-464.99	464.81	-113.35	40°08'44.877"N	104°33'02.511"W	0.92	
6148.00	6.800	345.110	6117.30	-475.88	475.70	-116.38	40°08'44.985"N	104°33'02.549"W	0.17	
6242.00	6.790	340.250	6210.64	-486.49	486.31	-119.68	40°08'45.090"N	104°33'02.590"W	0.61	
6337.00	6.440	329.230	6305.01	-496.36	496.17	-124.31	40°08'45.188"N	104°33'02.648"W	1.38	
6431.00	7.030	233.510	6398.60	-497.48	497.28	-131.65	40°08'45.200"N	104°33'02.743"W	10.62	
6526.00	14.600	212.450	6491.87	-483.91	483.70	-142.77	40°08'45.067"N	104°33'02.888"W	8.86	
6621.00	20.890	198.560	6582.35	-457.73	457.50	-154.60	40°08'44.809"N	104°33'03.044"W	7.94	
6715.00	26.480	186.120	6668.45	-420.97	420.72	-162.18	40°08'44.447"N	104°33'03.146"W	7.95	
6810.00	32.930	177.020	6750.96	-374.05	373.80	-163.10	40°08'43.983"N	104°33'03.165"W	8.27	
6905.00	42.150	174.630	6826.21	-316.39	316.15	-158.76	40°08'43.413"N	104°33'03.117"W	9.82	
6999.00	51.470	173.330	6890.48	-248.31	248.08	-151.52	40°08'42.739"N	104°33'03.033"W	9.97	
7093.00	60.340	174.020	6943.12	-171.00	170.79	-142.98	40°08'41.975"N	104°33'02.933"W	9.46	
7188.00	71.230	174.970	6982.03	-84.88	84.67	-134.71	40°08'41.123"N	104°33'02.839"W	11.50	
7282.00	80.660	177.560	7004.84	6.01	-6.21	-128.82	40°08'40.224"N	104°33'02.776"W	10.38	
7377.00	87.290	179.720	7014.80	100.41	-100.60	-126.59	40°08'39.291"N	104°33'02.760"W	7.34	
7471.00	90.220	179.290	7016.84	194.37	-194.56	-125.78	40°08'38.363"N	104°33'02.762"W	3.15	
7566.00	89.910	179.290	7016.74	289.37	-289.56	-124.60	40°08'37.424"N	104°33'02.760"W	0.33	
7661.00	90.150	180.020	7016.69	384.37	-384.55	-124.03	40°08'36.485"N	104°33'02.766"W	0.81	
7755.00	90.120	179.980	7016.47	478.37	-478.55	-124.03	40°08'35.556"N	104°33'02.779"W	0.05	
7850.00	90.220	180.460	7016.18	573.36	-573.55	-124.39	40°08'34.618"N	104°33'02.797"W	0.52	
7944.00	90.280	181.250	7015.77	667.35	-667.54	-125.80	40°08'33.689"N	104°33'02.828"W	0.84	
8039.00	90.150	179.980	7015.42	762.34	-762.53	-126.82	40°08'32.750"N	104°33'02.854"W	1.34	
8133.00	90.150	180.780	7015.17	856.33	-856.53	-127.44	40°08'31.822"N	104°33'02.875"W	0.85	
8228.00	90.030	181.200	7015.02	951.32	-951.51	-129.08	40°08'30.883"N	104°33'02.909"W	0.46	
8322.00	90.000	181.520	7015.00	1045.29	-1045.49	-131.31	40°08'29.955"N	104°33'02.951"W	0.34	



Actual Wellpath Report

HULLABALOO Y21-726 AWP



REFERENCE WELLPATH IDENTIFICATION			
Operator	NOBLE ENERGY, INC	Slot	SLOT#09 HULLABALOO Y21-726(445'FNL&930'FEL,SEC.16)
Area	COLORADO	Well	HULLABALOO Y21-726
Field	WELD COUNTY (NOBLE NAD 83 GRID)	Wellbore	HULLABALOO Y21-726 AWB
Facility	SEC.16-T02N-R64W		

WELLPATH DATA (186 stations)										
MD [ft]	Inclination [°]	Azimuth [°]	TVD [ft]	Vert Sect [ft]	North [ft]	East [ft]	Latitude	Longitude	DLS [°/100ft]	Comments
8417.00	90.460	181.090	7014.62	1140.26	-1140.46	-133.48	40°08'29.017"N	104°33'02.992"W	0.66	
8511.00	90.370	179.910	7013.93	1234.25	-1234.45	-134.30	40°08'28.088"N	104°33'03.015"W	1.26	
8606.00	90.340	178.550	7013.35	1329.24	-1329.44	-133.02	40°08'27.149"N	104°33'03.012"W	1.43	
8701.00	90.340	178.520	7012.78	1424.21	-1424.41	-130.59	40°08'26.211"N	104°33'02.994"W	0.03	
8795.00	90.430	178.340	7012.15	1518.18	-1518.37	-128.02	40°08'25.282"N	104°33'02.974"W	0.21	
8889.00	90.430	176.940	7011.45	1612.10	-1612.29	-124.14	40°08'24.353"N	104°33'02.937"W	1.49	
8984.00	90.710	176.490	7010.50	1706.94	-1707.12	-118.70	40°08'23.416"N	104°33'02.880"W	0.56	
9079.00	90.490	173.310	7009.50	1801.56	-1801.73	-110.26	40°08'22.480"N	104°33'02.784"W	3.36	
9173.00	90.150	169.490	7008.98	1894.51	-1894.66	-96.20	40°08'21.560"N	104°33'02.616"W	4.08	
9268.00	90.180	175.340	7008.71	1988.65	-1988.78	-83.67	40°08'20.629"N	104°33'02.468"W	6.16	
9363.00	90.000	177.310	7008.56	2083.46	-2083.58	-77.58	40°08'19.691"N	104°33'02.402"W	2.08	
9457.00	90.120	176.800	7008.46	2177.35	-2177.46	-72.75	40°08'18.763"N	104°33'02.353"W	0.56	
9552.00	90.150	177.360	7008.23	2272.23	-2272.33	-67.91	40°08'17.825"N	104°33'02.304"W	0.59	
9646.00	90.180	179.940	7007.96	2366.20	-2366.30	-65.70	40°08'16.896"N	104°33'02.288"W	2.74	
9741.00	90.340	183.690	7007.53	2461.13	-2461.23	-68.71	40°08'15.959"N	104°33'02.340"W	3.95	
9836.00	90.490	187.050	7006.84	2555.68	-2555.80	-77.60	40°08'15.025"N	104°33'02.467"W	3.54	
9930.00	90.520	188.340	7006.02	2648.81	-2648.95	-90.18	40°08'14.106"N	104°33'02.642"W	1.37	
10025.00	90.370	185.880	7005.28	2743.05	-2743.21	-101.94	40°08'13.176"N	104°33'02.807"W	2.59	
10120.00	90.250	181.060	7004.76	2837.84	-2838.01	-107.69	40°08'12.240"N	104°33'02.894"W	5.08	
10214.00	90.490	179.460	7004.16	2931.83	-2932.00	-108.11	40°08'11.311"N	104°33'02.912"W	1.72	
10309.00	90.490	178.240	7003.34	3026.81	-3026.97	-106.21	40°08'10.372"N	104°33'02.901"W	1.28	
10404.00	90.400	177.950	7002.61	3121.76	-3121.92	-103.05	40°08'09.434"N	104°33'02.873"W	0.32	
10498.00	90.490	178.210	7001.88	3215.71	-3215.86	-99.90	40°08'08.505"N	104°33'02.846"W	0.29	
10593.00	90.400	178.380	7001.14	3310.67	-3310.82	-97.07	40°08'07.566"N	104°33'02.822"W	0.20	
10687.00	90.310	186.080	7000.55	3404.52	-3404.67	-100.73	40°08'06.639"N	104°33'02.882"W	8.19	
10782.00	90.310	186.300	7000.04	3498.95	-3499.12	-110.97	40°08'05.707"N	104°33'03.027"W	0.23	
10876.00	90.400	180.410	6999.46	3592.74	-3592.92	-116.47	40°08'04.781"N	104°33'03.111"W	6.27	
10971.00	90.250	176.970	6998.92	3687.70	-3687.87	-114.30	40°08'03.842"N	104°33'03.096"W	3.62	
11065.00	89.940	174.230	6998.76	3781.42	-3781.59	-107.09	40°08'02.916"N	104°33'03.016"W	2.93	
11160.00	89.750	177.150	6999.02	3876.15	-3876.31	-99.95	40°08'01.979"N	104°33'02.937"W	3.08	



Actual Wellpath Report

HULLABALOO Y21-726 AWP



REFERENCE WELLPATH IDENTIFICATION			
Operator	NOBLE ENERGY, INC	Slot	SLOT#09 HULLABALOO Y21-726(445'FNL&930'FEL,SEC.16)
Area	COLORADO	Well	HULLABALOO Y21-726
Field	WELD COUNTY (NOBLE NAD 83 GRID)	Wellbore	HULLABALOO Y21-726 AWB
Facility	SEC.16-T02N-R64W		

WELLPATH DATA (186 stations)										
MD [ft]	Inclination [°]	Azimuth [°]	TVD [ft]	Vert Sect [ft]	North [ft]	East [ft]	Latitude	Longitude	DLS [°/100ft]	Comments
11255.00	89.690	177.600	6999.48	3971.06	-3971.21	-95.60	40°08'01.041"N	104°33'02.894"W	0.48	
11349.00	89.720	176.440	6999.97	4064.94	-4065.08	-90.71	40°08'00.112"N	104°33'02.844"W	1.23	
11443.00	89.910	177.280	7000.27	4158.80	-4158.94	-85.56	40°07'59.184"N	104°33'02.791"W	0.92	
11538.00	89.750	177.100	7000.55	4253.69	-4253.82	-80.91	40°07'58.246"N	104°33'02.744"W	0.25	
11633.00	89.720	175.880	7000.99	4348.52	-4348.64	-75.09	40°07'57.309"N	104°33'02.682"W	1.28	
11727.00	89.630	176.580	7001.53	4442.33	-4442.43	-68.91	40°07'56.381"N	104°33'02.616"W	0.75	
11822.00	89.660	178.060	7002.11	4537.22	-4537.33	-64.47	40°07'55.443"N	104°33'02.572"W	1.56	
11916.00	90.580	179.390	7001.92	4631.20	-4631.30	-62.38	40°07'54.514"N	104°33'02.558"W	1.72	
12011.00	90.710	180.410	7000.85	4726.19	-4726.29	-62.21	40°07'53.576"N	104°33'02.569"W	1.08	
12106.00	90.550	181.670	6999.80	4821.17	-4821.27	-63.93	40°07'52.637"N	104°33'02.604"W	1.34	
12200.00	90.460	182.460	6998.98	4915.10	-4915.20	-67.32	40°07'51.709"N	104°33'02.660"W	0.85	
12295.00	90.360	181.980	6998.30	5010.02	-5010.13	-71.00	40°07'50.772"N	104°33'02.721"W	0.52	
12390.00	90.390	180.890	6997.67	5104.98	-5105.10	-73.38	40°07'49.834"N	104°33'02.765"W	1.15	
12484.00	90.520	180.160	6996.93	5198.97	-5199.09	-74.24	40°07'48.905"N	104°33'02.789"W	0.79	
12579.00	90.490	179.210	6996.09	5293.96	-5294.08	-73.72	40°07'47.966"N	104°33'02.795"W	1.00	
12673.00	90.760	179.370	6995.06	5387.95	-5388.07	-72.55	40°07'47.037"N	104°33'02.793"W	0.33	
12768.00	90.640	179.000	6993.90	5482.94	-5483.05	-71.20	40°07'46.099"N	104°33'02.789"W	0.41	
12862.00	90.610	179.960	6992.88	5576.93	-5577.04	-70.35	40°07'45.170"N	104°33'02.791"W	1.02	
12957.00	90.640	180.510	6991.84	5671.92	-5672.03	-70.74	40°07'44.231"N	104°33'02.809"W	0.58	
13052.00	90.390	180.150	6990.99	5766.91	-5767.03	-71.29	40°07'43.293"N	104°33'02.829"W	0.46	
13146.00	90.860	178.980	6989.96	5860.91	-5861.02	-70.57	40°07'42.364"N	104°33'02.833"W	1.34	
13241.00	90.760	178.070	6988.62	5955.87	-5955.98	-68.13	40°07'41.425"N	104°33'02.814"W	0.96	
13336.00	90.390	177.190	6987.67	6050.79	-6050.89	-64.20	40°07'40.487"N	104°33'02.777"W	1.00	
13430.00	90.390	176.660	6987.03	6144.66	-6144.75	-59.16	40°07'39.559"N	104°33'02.725"W	0.56	
13525.00	90.420	176.150	6986.36	6239.47	-6239.56	-53.20	40°07'38.621"N	104°33'02.661"W	0.54	
13620.00	90.360	175.620	6985.71	6334.24	-6334.32	-46.38	40°07'37.684"N	104°33'02.586"W	0.56	
13714.00	90.210	175.650	6985.24	6427.97	-6428.04	-39.23	40°07'36.757"N	104°33'02.507"W	0.16	
13809.00	90.300	175.980	6984.82	6522.73	-6522.79	-32.30	40°07'35.820"N	104°33'02.431"W	0.36	
13903.00	90.300	176.270	6984.33	6616.52	-6616.57	-25.94	40°07'34.893"N	104°33'02.362"W	0.31	
13998.00	90.360	177.280	6983.78	6711.38	-6711.42	-20.60	40°07'33.955"N	104°33'02.306"W	1.07	



Actual Wellpath Report
HULLABALOO Y21-726 AWP
Page 7 of 10



REFERENCE WELLPATH IDENTIFICATION			
Operator	NOBLE ENERGY, INC	Slot	SLOT#09 HULLABALOO Y21-726(445'FNL&930'FEL,SEC.16)
Area	COLORADO	Well	HULLABALOO Y21-726
Field	WELD COUNTY (NOBLE NAD 83 GRID)	Wellbore	HULLABALOO Y21-726 AWB
Facility	SEC.16-T02N-R64W		

WELLPATH DATA (186 stations)										
MD [ft]	Inclination [°]	Azimuth [°]	TVD [ft]	Vert Sect [ft]	North [ft]	East [ft]	Latitude	Longitude	DLS [°/100ft]	Comments
14093.00	90.460	177.280	6983.10	6806.28	-6806.31	-16.09	40°07'33.017"N	104°33'02.262"W	0.11	
14187.00	90.240	177.310	6982.52	6900.18	-6900.20	-11.66	40°07'32.089"N	104°33'02.217"W	0.24	
14282.00	90.210	178.300	6982.15	6995.11	-6995.13	-8.02	40°07'31.150"N	104°33'02.184"W	1.04	
14377.00	90.360	179.130	6981.68	7090.09	-7090.10	-5.89	40°07'30.212"N	104°33'02.169"W	0.89	
14471.00	90.330	181.440	6981.11	7184.08	-7184.09	-6.35	40°07'29.283"N	104°33'02.188"W	2.46	
14566.00	90.330	184.270	6980.57	7278.94	-7278.97	-11.09	40°07'28.346"N	104°33'02.262"W	2.98	
14661.00	90.330	178.810	6980.02	7373.86	-7373.89	-13.64	40°07'27.408"N	104°33'02.308"W	5.75	
14755.00	90.390	178.820	6979.43	7467.85	-7467.87	-11.69	40°07'26.479"N	104°33'02.296"W	0.06	
14850.00	90.240	179.460	6978.91	7562.83	-7562.86	-10.27	40°07'25.541"N	104°33'02.291"W	0.69	
14945.00	90.360	180.580	6978.41	7657.83	-7657.86	-10.30	40°07'24.602"N	104°33'02.304"W	1.19	
15039.00	90.240	180.470	6977.92	7751.83	-7751.85	-11.16	40°07'23.673"N	104°33'02.328"W	0.17	
15134.00	90.420	179.540	6977.37	7846.82	-7846.85	-11.17	40°07'22.734"N	104°33'02.342"W	1.00	
15229.00	90.210	178.280	6976.85	7941.80	-7941.83	-9.36	40°07'21.796"N	104°33'02.331"W	1.34	
15323.00	90.490	174.680	6976.27	8035.62	-8035.63	-3.59	40°07'20.868"N	104°33'02.270"W	3.84	
15418.00	90.360	176.200	6975.57	8130.32	-8130.33	3.96	40°07'19.932"N	104°33'02.186"W	1.61	
15513.00	90.210	177.590	6975.09	8225.19	-8225.18	9.10	40°07'18.994"N	104°33'02.133"W	1.47	
15607.00	90.390	177.120	6974.60	8319.09	-8319.08	13.44	40°07'18.065"N	104°33'02.090"W	0.54	
15702.00	90.240	178.050	6974.08	8414.01	-8414.00	17.45	40°07'17.127"N	104°33'02.051"W	0.99	
15797.00	90.180	179.750	6973.73	8508.99	-8508.97	19.27	40°07'16.188"N	104°33'02.041"W	1.79	
15892.00	90.300	180.540	6973.33	8603.99	-8603.97	19.03	40°07'15.250"N	104°33'02.057"W	0.84	
15986.00	90.360	180.850	6972.79	8697.98	-8697.96	17.89	40°07'14.321"N	104°33'02.085"W	0.34	
16080.00	90.330	182.240	6972.23	8791.94	-8791.92	15.35	40°07'13.393"N	104°33'02.130"W	1.48	
16175.00	90.460	182.340	6971.57	8886.85	-8886.85	11.56	40°07'12.455"N	104°33'02.192"W	0.17	
16270.00	90.270	182.490	6970.97	8981.76	-8981.76	7.56	40°07'11.518"N	104°33'02.257"W	0.25	
16364.00	90.420	182.070	6970.40	9075.68	-9075.68	3.82	40°07'10.590"N	104°33'02.318"W	0.47	
16459.00	90.270	180.410	6969.83	9170.65	-9170.66	1.76	40°07'09.652"N	104°33'02.358"W	1.75	
16553.00	90.490	178.980	6969.20	9264.64	-9264.65	2.26	40°07'08.723"N	104°33'02.364"W	1.54	
16648.00	90.420	179.330	6968.45	9359.63	-9359.64	3.66	40°07'07.784"N	104°33'02.359"W	0.38	
16742.00	90.420	178.140	6967.76	9453.61	-9453.61	5.74	40°07'06.855"N	104°33'02.345"W	1.27	
16837.00	90.360	176.770	6967.11	9548.52	-9548.51	9.95	40°07'05.917"N	104°33'02.304"W	1.44	



Actual Wellpath Report
HULLABALOO Y21-726 AWP
Page 8 of 10



REFERENCE WELLPATH IDENTIFICATION			
Operator	NOBLE ENERGY, INC	Slot	SLOT#09 HULLABALOO Y21-726(445'FNL&930'FEL,SEC.16)
Area	COLORADO	Well	HULLABALOO Y21-726
Field	WELD COUNTY (NOBLE NAD 83 GRID)	Wellbore	HULLABALOO Y21-726 AWB
Facility	SEC.16-T02N-R64W		

WELLPATH DATA (186 stations)										
MD [ft]	Inclination [°]	Azimuth [°]	TVD [ft]	Vert Sect [ft]	North [ft]	East [ft]	Latitude	Longitude	DLS [°/100ft]	Comments
16932.00	89.990	176.610	6966.82	9643.37	-9643.35	15.44	40°07'04.979"N	104°33'02.247"W	0.42	
17026.00	90.240	176.700	6966.64	9737.21	-9737.19	20.92	40°07'04.051"N	104°33'02.189"W	0.28	
17121.00	90.150	175.880	6966.31	9832.02	-9831.99	27.07	40°07'03.114"N	104°33'02.123"W	0.87	
17215.00	90.270	177.910	6965.97	9925.89	-9925.85	32.16	40°07'02.186"N	104°33'02.070"W	2.16	
17294.00	90.150	178.720	6965.68	10004.85	-10004.81	34.49	40°07'01.406"N	104°33'02.051"W	1.04	Last BHI MWD Surveys
17318.00	90.150	178.720	6965.62	10028.85	-10028.81	35.02	40°07'01.168"N	104°33'02.048"W	0.00	Projection to Bit

HOLE & CASING SECTIONS - Ref Wellbore: HULLABALOO Y21-726 AWB Ref Wellpath: HULLABALOO Y21-726 AWP									
String/Diameter	Start MD [ft]	End MD [ft]	Interval [ft]	Start TVD [ft]	End TVD [ft]	Start N/S [ft]	Start E/W [ft]	End N/S [ft]	End E/W [ft]
13.5in Open Hole	30.00	2022.00	1992.00	30.00	2021.96	-0.04	0.04	-0.84	5.21
9.625in Casing Surface	30.00	2022.00	1992.00	30.00	2021.96	-0.04	0.04	-0.84	5.21
8.5in Open Hole	2022.00	17318.00	15296.00	2021.96	6965.62	-0.84	5.21	-10028.81	35.02



Actual Wellpath Report

HULLABALOO Y21-726 AWP

Page 9 of 10



REFERENCE WELLPATH IDENTIFICATION			
Operator	NOBLE ENERGY, INC	Slot	SLOT#09 HULLABALOO Y21-726(445'FNL&930'FEL,SEC.16)
Area	COLORADO	Well	HULLABALOO Y21-726
Field	WELD COUNTY (NOBLE NAD 83 GRID)	Wellbore	HULLABALOO Y21-726 AWB
Facility	SEC.16-T02N-R64W		

TARGETS								
Name	TVD [ft]	North [ft]	East [ft]	Grid East [US ft]	Grid North [US ft]	Latitude	Longitude	Shape
HULLABALOO Y21-787 SECTION 16	62.00	-19.53	-3547.76	3261942.56	1296894.28	40°08'40.452"N	104°33'46.800"W	polygon
HULLABALOO Y21-787 SECTION 21	62.00	-19.53	-3547.76	3261942.56	1296894.28	40°08'40.452"N	104°33'46.800"W	polygon
HULLABALOO Y21-726 BHL REV-1(100'FSL&1075'FEL,SEC.21)	6968.06	-10033.10	15.16	3265505.32	1286881.13	40°07'01.128"N	104°33'02.304"W	point
HULLABALOO Y21-726 Landing Point(550'FNL&1075'FEL,SEC.16)	7020.00	-115.00	-145.00	3265345.17	1296798.81	40°08'39.151"N	104°33'02.999"W	point
HULLABALOO Y21-787 SECTION 16 HARDLINE (460'SETBACK)	7252.00	-19.53	-3547.76	3261942.56	1296894.28	40°08'40.452"N	104°33'46.800"W	polygon
HULLABALOO Y21-787 SECTION 21 HARDLINE(460'SETBACK)	7252.00	-19.53	-3547.76	3261942.56	1296894.28	40°08'40.452"N	104°33'46.800"W	polygon

WELLPATH COMPOSITION - Ref Wellbore: HULLABALOO Y21-726 AWB Ref Wellpath: HULLABALOO Y21-726 AWP				
Start MD [ft]	End MD [ft]	Positional Uncertainty Model	Log Name/Comment	Wellbore
0.00	2021.00	OWSG MWD rev2 + IFR1 + Multi-Station Correction	3rd Party Surface Gyros <82.6'-2021'>	HULLABALOO Y21-726 AWB
2021.00	17294.00	OWSG MWD rev2 + IFR1 + Multi-Station Correction	BHI/ATC 8.5" OWSG, MWD+IFR+MSA <2081'-17294'>	HULLABALOO Y21-726 AWB
17294.00	17318.00	Blind Drilling (std)	Projection to bit	HULLABALOO Y21-726 AWB



Actual Wellpath Report

HULLABALOO Y21-726 AWP

Page 10 of 10



REFERENCE WELLPATH IDENTIFICATION			
Operator	NOBLE ENERGY, INC	Slot	SLOT#09 HULLABALOO Y21-726(445'FNL&930'FEL,SEC.16)
Area	COLORADO	Well	HULLABALOO Y21-726
Field	WELD COUNTY (NOBLE NAD 83 GRID)	Wellbore	HULLABALOO Y21-726 AWB
Facility	SEC.16-T02N-R64W		

WELLPATH COMMENTS				
MD [ft]	Inclination [°]	Azimuth [°]	TVD [ft]	Comment
2021.00	0.430	28.650	2020.96	Tie to Surface Surveys
17294.00	90.150	178.720	6965.68	Last BHI MWD Surveys
17318.00	90.150	178.720	6965.62	Projection to Bit

COMMENTS
<div>Wellpath general comments</div> <div>SURFACE LOCATION: NENE</div> <div>40.14452 N</div> <div>104.55031 W</div> <div>API: 05-123-45234</div>