

906033

FIELD INSPECTION SHEET

Operator Mexican  
 Well Name & # 1 Hanna Canyon 14-26  
 Lease # COC-20434  
 OIL GAS CO<sub>2</sub> WC DEV  
 Formation -  
 Pool -  
 Circulation Medium W/O Gas Air  
 Road Length -  
 Width - Cut -  
 NEW - REHAB - W/W P/L  
 New Road on Lease Length -  
 New Road off lease R/W Length -  
 Existing Road R/W Needed -  
 Length -  
 Inspected P/L on Lease: Yes No  
 Length - Width -  
 Surface - Underground -  
 Inspected off Lease/Unit Pipeline:  
 Yes No  
 Length - Width -  
 Surface Ownership BLM  
 Topography slope  
 Arroyo/wash - Base of Cliff -  
 Bench - Canyon rim - Mesa -  
 Cliff/scarp - Valley bottom -  
 Hill top slope low rise  
 Plain/flat - Ridge - Saddle -  
 Terrace -  
 Existing Vegetation Russian Thistle,  
Rabbit brush, sage, grasses.  
 Soil Rocky Gravelly  
Sandy Clayey  
 Other -  
 Slope West  
 Drainage West  
 Land Use Rec. mining, etc.  
 Special Stipulations  
Beams around equip. ok  
Fencing ok.  
Health/ Safety ok.  
Need to install birdcage on  
separator unit.  
Facilities need to be  
painted.  
Well-logs need to be replaced.

Date 09/15/05  
 Inspector LUCAS VARGO  
 EA # -  
 County, State San Miguel, CO  
 Location NW5W  
 S. 26 T. 45 N., R. 18 W.  
 Location Moved? Yes No  
 From: - To: -  
 Laydown - Pit -  
 Pad Size 1/3 original  
 \* Paint Color SB Seed -  
 Start Date - Drill Time -  
 Cut - Direction -  
 Fill - Direction -  
 Water Source -  
 Dwelling -  
 Well -  
 Utility R/W -  
 Water -  
 Arch - Paleo -  
 RMP 1985 SJRA T & E -  
 SMA BLM  
 Names of Individuals on Joint  
 Inspection:  
 \_\_\_\_\_  
 \_\_\_\_\_  
 \_\_\_\_\_  
 \_\_\_\_\_  
 \_\_\_\_\_

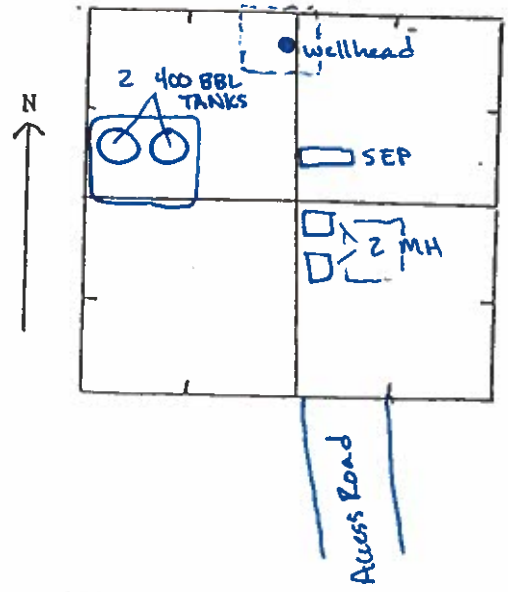

AFMS  
 1/1