



Anadarko
Petroleum Corporation



**BAKER
HUGHES**

INTEQ

Location:	COLORADO	Slot:	SLOT#09 WEICHEL 36-14 (1049/FSL & 1045/FWL)
Field:	WELD COUNTY (ANADARKO)	Well:	WEICHEL 36-14
Facility:	SEC. 14-T2N-R65W	Wellbore:	WEICHEL 36-14 PWB



RECEIVED

JUL 24 2009

COGCC

Plot reference wellpath is WEICHEL 36-14 (REV-C.9) PWP	Grid System: NAD83 / Lambert Colorado State Planes, Northern Zone (501), US feet
True vertical depths are referenced to XTREME 8 (RT)	North Reference: True north
Measured depths are referenced to XTREME 8 (RT)	Scale: True distance
XTREME 8 (RT) to Mean Sea Level: 4903 feet	Depths are in feet
Mean Sea Level to Mud line (Facility: SEC 14-T2N-R6SW): 0 feet	Created by: cooldanm on 8/16/2009
Coordinates are in feet referenced to Siot	

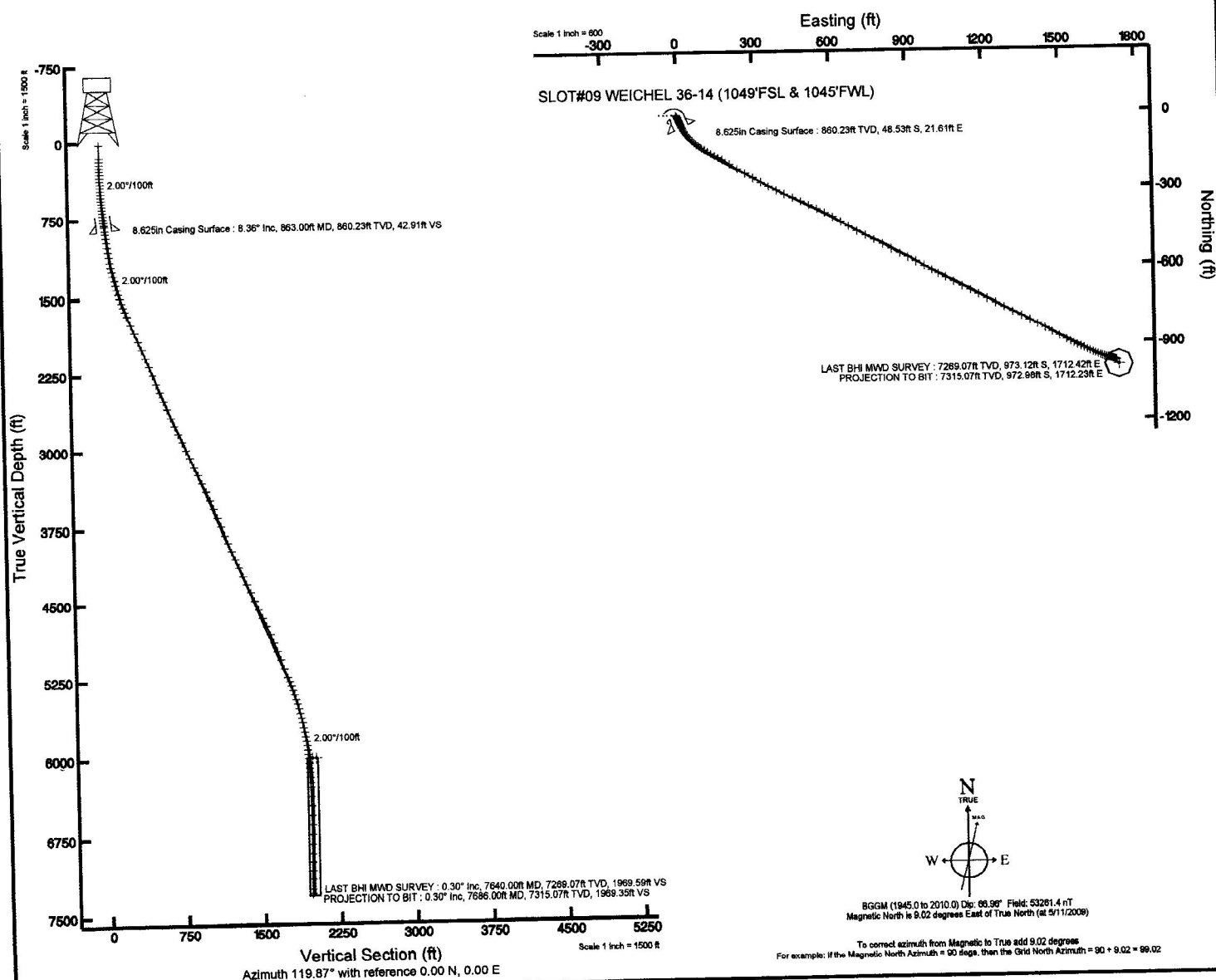

Actual Wellpath Report

WEICHEL 36-14 AWP

Page 1 of 8

INTEQ

REFERENCE WELLPATH IDENTIFICATION

Operator	ANADARKO PETROLEUM	Slot	SLOT#09 WEICHEL 36-14 (1049'FSL & 1045'FWL)
Area	COLORADO	Well	WEICHEL 36-14
Field	WELD COUNTY (ANADARKO)	Wellbore	WEICHEL 36-14 AWB
Facility	SEC.14-T2N-R65W		

REPORT SETUP INFORMATION

Projection System	NAD83 / Lambert Colorado State Planes, Northern Zone (501), US feet	Software System	WellArchitect® 2.0
North Reference	True	User	Cookdanm
Scale	0.999959	Report Generated	6/16/2009 at 12:09:29 PM
Convergence at slot	0.56° East	Database/Source file	WellArchitect_Denver/WEICHEL_36-14_AWB.xml

WELLPATH LOCATION

	Local coordinates		Grid coordinates		Geographic coordinates	
	North[ft]	East[ft]	Easting[USft]	Northing[USft]	Latitude	Longitude
Slot Location	-3588.29	-981.45	3241326.42	1292918.16	40°08'03.228"N	104°38'12.768"W
Facility Reference Pt			3242272.71	1296515.72	40°08'38.688"N	104°38'00.132"W
Field Reference Pt			3197771.84	1268891.29	40°04'09.600"N	104°47'36.000"W

WELLPATH DATUM

Calculation method	Minimum curvature	XTREME 8 (RT) to Facility Vertical Datum	4903.00ft
Horizontal Reference Pt	Slot	XTREME 8 (RT) to Mean Sea Level	4903.00ft
Vertical Reference Pt	XTREME 8 (RT)	Facility Vertical Datum to Mud Line (Facility)	0.00ft
MD Reference Pt	XTREME 8 (RT)	Section Origin	N 0.00, E 0.00 ft
Field Vertical Reference	Mean Sea Level	Section Azimuth	119.87°

RECEIVED

JUL 24 2009

COGCC

Actual Wellpath Report

WEICHEL 36-14 AWP

Page 7 of 8

INTEQ

REFERENCE WELLPATH IDENTIFICATION

Operator	ANADARKO PETROLEUM	Slot	SLOT#09 WEICHEL 36-14 (1049'FSL & 1045'FWL)
Area	COLORADO	Well	WEICHEL 36-14
Field	WELD COUNTY (ANADARKO)	Wellbore	WEICHEL 36-14 AWB
Facility	SEC.14-T2N-R65W		

TARGETS

Name	MD [ft]	TVD [ft]	North [ft]	East [ft]	Grid East [srv ft]	Grid North [srv ft]	Latitude	Longitude	Shape
HSR-WEICHEL 13-14 (999'FSL & 1012'FWL)		-1.00	-50.00	-33.31	3241293.60	1292867.84	40°08'02.734"N	104°38'13.197"W	circle
WEICHEL 36-14 GEO TARGET 50' RADIUS (75'FSL & 2545'FEL, REV-1.0)		6000.00	-990.82	1725.29	3243061.19	1291944.22	40°07'53.436"N	104°37'50.556"W	circle
WEICHEL 36-14 HARDLINE 106'W OF GEO TARGET		6000.00	-990.82	1625.34	3242961.25	1291943.25	40°07'53.436"N	104°37'51.843"W	point
WEICHEL 36-14 HARDLINE 75'S OF GEO TARGET		6000.00	-1065.82	1725.29	3243061.92	1291869.23	40°07'52.695"N	104°37'50.556"W	point

WELLPATH COMPOSITION Ref Wellbore: WEICHEL 36-14 AWB Ref Wellpath: WEICHEL 36-14 AWP

Start MD [ft]	End MD [ft]	Positional Uncertainty Model	Log Name/Comment	Wellbore
20.00	821.00	MTC (Collar, post-2000) (Standard)	BHI/MTC-POST-2000 12.25"HOLE <155-821>	WEICHEL 36-14 AWB
821.00	7640.00	MTC (Collar, post-2000) (Standard)	BHI/MTC-POST-2000 7.875"HOLE <891-7640>	WEICHEL 36-14 AWB
7640.00	7686.00	Blind Drilling (std)	Projection to bit	WEICHEL 36-14 AWB

RECEIVED

JUL 24 2009

COGCC

Actual Wellpath Report

WEICHEL 36-14 AWP

Page 8 of 8

INTEQ

REFERENCE WELLPATH IDENTIFICATION

Operator	ANADARKO PETROLEUM	Slot	SLOT#09 WEICHEL 36-14 (1049'FSL & 1045'FWL)
Area	COLORADO	Well	WEICHEL 36-14
Field	WELD COUNTY (ANADARKO)	Wellbore	WEICHEL 36-14 AWB
Facility	SEC.14-T2N-R65W		

WELLPATH COMMENTS

MD [ft]	Inclination [°]	Azimuth [°]	TVD [ft]	Comment
7640.00	0.300	306.400	7269.07	LAST BHI MWD SURVEY
7686.00	0.300	306.400	7315.07	PROJECTION TO BIT

RECEIVED

JUL 24 2009

COGCC

REFERENCE WELLPATH IDENTIFICATION

Operator	ANADARKO PETROLEUM	Slot	SLOT#09 WEICHEL 36-14 (1049'FSL & 1045'FWL)
Area	COLORADO	Well	WEICHEL 36-14
Field	WELD COUNTY (ANADARKO)	Wellbore	WEICHEL 36-14 AWB
Facility	SEC.14-T2N-R65W		

WELLPATH DATA (123 stations) † = interpolated/extrapolated station

MD [ft]	Inclination [°]	Azimuth [°]	TVD [ft]	Vert Sect [ft]	North [ft]	East [ft]	DLS [°/100ft]	Comments
0.00†	0.000	34.000	0.00	0.00	0.00	0.00	0.00	
20.00	0.000	34.000	20.00	0.00	0.00	0.00	0.00	
155.00	0.300	34.000	155.00	0.03	0.29	0.20	0.22	
186.00	0.200	71.600	186.00	0.07	0.38	0.29	0.60	
217.00	0.400	125.400	217.00	0.21	0.33	0.43	1.05	
248.00	1.000	127.900	248.00	0.59	0.10	0.74	1.94	
281.00	1.500	145.400	280.99	1.26	-0.43	1.21	1.89	
312.00	1.800	151.400	311.98	2.04	-1.19	1.67	1.12	
343.00	1.900	151.800	342.96	2.89	-2.07	2.15	0.33	
374.00	2.600	154.200	373.94	3.91	-3.16	2.70	2.28	
405.00	3.000	159.100	404.90	5.12	-4.55	3.29	1.50	
436.00	3.300	159.500	435.85	6.44	-6.14	3.89	0.97	
467.00	3.900	159.800	466.79	7.93	-7.97	4.57	1.94	
498.00	4.300	160.900	497.71	9.62	-10.05	5.31	1.31	
529.00	4.800	159.500	528.61	11.49	-12.37	6.15	1.65	
560.00	5.300	158.100	559.49	13.61	-14.91	7.14	1.66	
591.00	5.700	158.800	590.35	15.94	-17.67	8.23	1.31	
622.00	6.100	158.100	621.19	18.43	-20.64	9.40	1.31	
653.00	6.300	157.400	652.00	21.07	-23.74	10.67	0.69	
683.00	6.600	156.700	681.81	23.76	-26.84	11.98	1.03	
714.00	6.800	157.000	712.60	26.65	-30.17	13.40	0.65	
745.00	7.300	156.000	743.37	29.70	-33.65	14.92	1.66	
776.00	7.700	156.300	774.10	32.96	-37.35	16.56	1.30	
807.00	7.900	155.600	804.82	36.36	-41.20	18.27	0.71	
821.00	8.300	156.000	818.68	37.96	-43.00	19.08	2.89	
891.00	8.400	154.200	887.93	46.26	-52.21	23.36	0.40	
936.00	8.600	152.200	932.44	51.82	-58.15	26.36	0.79	
980.00	8.600	149.300	975.95	57.46	-63.89	29.57	0.99	
1025.00	9.200	146.500	1020.40	63.61	-69.78	33.28	1.64	
1071.00	10.200	144.000	1065.75	70.61	-76.14	37.70	2.36	

RECEIVED

JUL 24 2009

COGCC

Actual Wellpath Report

WEICHEL 36-14 AWP

Page 3 of 8

INTEQ

REFERENCE WELLPATH IDENTIFICATION

Operator	ANADARKO PETROLEUM	Slot	SLOT#09 WEICHEL 36-14 (1049'FSL & 1045'FWL)
Area	COLORADO	Well	WEICHEL 36-14
Field	WELD COUNTY (ANADARKO)	Wellbore	WEICHEL 36-14 AWP
Facility	SEC.14-T2N-R65W		

WELLPATH DATA (123 stations)

MD [ft]	Inclination [°]	Azimuth [°]	TVD [ft]	Vert Sect [ft]	North [ft]	East [ft]	DLS [°/100ft]	Comments
1116.00	10.900	141.900	1109.98	78.19	-82.72	42.67	1.77	
1161.00	11.500	138.000	1154.13	86.40	-89.40	48.30	2.15	
1206.00	12.800	137.000	1198.12	95.43	-96.38	54.70	2.93	
1252.00	13.500	134.900	1242.91	105.48	-103.89	61.98	1.84	
1295.00	14.200	132.800	1284.66	115.47	-111.02	69.40	2.00	
1341.00	14.900	129.300	1329.19	126.81	-118.60	78.12	2.44	
1386.00	15.800	126.400	1372.58	138.60	-125.90	87.53	2.63	
1430.00	16.900	125.000	1414.80	150.92	-133.12	97.59	2.66	
1475.00	18.500	121.900	1457.67	164.57	-140.65	109.01	4.13	
1519.00	19.600	121.200	1499.26	178.93	-148.16	121.25	2.55	
1564.00	20.700	120.800	1541.51	194.42	-156.14	134.53	2.46	
1610.00	21.300	120.500	1584.45	210.91	-164.55	148.72	1.33	
1655.00	21.700	119.800	1626.32	227.40	-172.83	162.98	1.06	
1701.00	22.500	121.200	1668.94	244.70	-181.61	177.89	2.08	
1791.00	22.900	122.600	1751.97	279.41	-199.97	207.37	0.75	
1881.00	23.200	121.200	1834.79	314.62	-218.59	237.28	0.69	
1972.00	22.300	118.700	1918.71	349.81	-236.16	267.76	1.45	
2061.00	23.300	118.700	2000.75	384.29	-252.73	298.01	1.12	
2151.00	22.700	119.400	2083.60	419.45	-269.80	328.76	0.73	
2240.00	22.200	117.300	2165.85	453.42	-285.94	358.66	1.06	
2331.00	22.200	117.300	2250.11	487.77	-301.71	389.21	0.00	
2421.00	22.500	114.100	2333.35	521.89	-316.54	420.04	1.39	
2512.00	23.600	114.100	2417.08	557.34	-331.09	452.57	1.21	
2601.00	23.300	115.900	2498.73	592.62	-346.05	484.66	0.87	
2688.00	22.800	116.600	2578.79	626.62	-361.12	515.21	0.66	
2779.00	22.200	116.600	2662.86	661.39	-376.71	546.35	0.66	
2870.00	22.600	117.700	2746.99	696.02	-392.54	577.21	0.64	
2960.00	24.100	119.800	2829.62	731.68	-409.71	608.46	1.91	
3051.00	23.600	122.200	2912.85	768.46	-428.65	640.00	1.20	
3139.00	24.300	120.500	2993.28	804.17	-447.23	670.51	1.12	

RECEIVED

JUL 24 2009

COGCC

Actual Wellpath Report

WEICHEL 36-14 AWP

Page 4 of 8

REFERENCE WELLPATH IDENTIFICATION

Operator	ANADARKO PETROLEUM	Slot	SLOT#09 WEICHEL 36-14 (1049'FSL & 1045'FWL)
Area	COLORADO	Well	WEICHEL 36-14
Field	WELD COUNTY (ANADARKO)	Wellbore	WEICHEL 36-14 AWP
Facility	SEC.14-T2N-R65W		

WELLPATH DATA (123 stations)

MD [ft]	Inclination [°]	Azimuth [°]	TVD [ft]	Vert Sect [ft]	North [ft]	East [ft]	DLS [°/100ft]	Comments
3228.00	24.300	116.600	3074.40	840.77	-464.72	702.66	1.80	
3318.00	25.400	118.400	3156.06	878.55	-482.19	736.20	1.48	
3408.00	25.100	118.700	3237.46	916.93	-500.54	769.93	0.36	
3497.00	24.600	118.000	3318.22	954.32	-518.30	802.84	0.65	
3588.00	25.300	118.700	3400.73	992.69	-536.53	836.62	0.83	
3679.00	22.900	115.200	3483.80	1029.79	-553.41	869.70	3.07	
3768.00	22.200	113.100	3565.99	1063.74	-567.38	900.84	1.20	
3858.00	23.800	117.000	3648.84	1098.77	-582.30	932.66	2.45	
3949.00	23.300	118.000	3732.26	1135.09	-599.09	964.91	0.70	
4040.00	20.300	121.200	3816.75	1168.87	-615.72	994.31	3.54	
4127.00	18.700	117.700	3898.76	1197.90	-630.02	1019.57	2.28	
4218.00	22.700	118.700	3983.87	1230.05	-645.24	1047.90	4.41	
4308.00	24.500	118.000	4066.34	1266.06	-662.34	1079.61	2.02	
4398.00	24.400	115.900	4148.27	1303.26	-679.22	1112.81	0.97	
4489.00	23.000	117.300	4231.59	1339.77	-695.59	1145.52	1.66	
4577.00	24.200	117.000	4312.23	1374.96	-711.66	1176.87	1.37	
4667.00	24.400	116.300	4394.25	1411.94	-728.27	1209.97	0.39	
4758.00	24.400	115.900	4477.13	1449.45	-744.81	1243.73	0.18	
4848.00	24.400	117.700	4559.09	1486.57	-761.57	1276.91	0.83	
4937.00	25.600	116.600	4639.75	1524.14	-778.73	1310.38	1.45	
5026.00	25.000	116.300	4720.21	1562.11	-795.67	1344.44	0.69	
5115.00	22.900	116.600	4801.55	1598.17	-811.76	1376.78	2.36	
5205.00	21.900	118.000	4884.75	1632.43	-827.48	1407.26	1.26	
5296.00	20.700	119.400	4969.54	1665.47	-843.34	1436.26	1.43	
5387.00	19.800	119.400	5054.91	1696.97	-858.80	1463.70	0.99	
5478.00	20.700	118.700	5140.29	1728.46	-874.09	1491.23	1.02	
5568.00	22.000	118.700	5224.11	1761.22	-889.83	1519.97	1.44	
5614.00	21.100	117.700	5266.89	1778.11	-897.81	1534.86	2.11	
5659.00	20.000	118.400	5309.03	1793.90	-905.24	1548.80	2.50	
5704.00	19.500	115.500	5351.38	1809.08	-912.13	1562.35	2.44	

RECEIVED

JUL 24 2009

COGCC

Actual Wellpath Report

WEICHEL 36-14 AWP

Page 5 of 8

INTEQ

REFERENCE WELLPATH IDENTIFICATION

Operator	ANADARKO PETROLEUM	Slot	SLOT#09 WEICHEL 36-14 (1049'FSL & 1045'FWL)
Area	COLORADO	Well	WEICHEL 36-14
Field	WELD COUNTY (ANADARKO)	Wellbore	WEICHEL 36-14 AWP
Facility	SEC.14-T2N-R65W		

WELLPATH DATA (123 stations)

MD [ft]	Inclination [°]	Azimuth [°]	TVD [ft]	Vert Sect [ft]	North [ft]	East [ft]	DLS [°/100ft]	Comments
5749.00	19.000	115.200	5393.87	1823.87	-918.49	1575.76	1.13	
5795.00	18.400	115.500	5437.44	1838.57	-924.80	1589.09	1.32	
5840.00	16.600	117.000	5480.35	1852.07	-930.78	1601.23	4.12	
5885.00	15.400	114.500	5523.61	1864.44	-936.17	1612.39	3.07	
5931.00	14.700	113.100	5568.03	1876.32	-941.00	1623.32	1.71	
5976.00	14.400	113.400	5611.59	1887.55	-945.46	1633.71	0.69	
6021.00	12.800	112.700	5655.33	1898.06	-949.60	1643.44	3.57	
6066.00	11.700	111.300	5699.30	1907.51	-953.19	1652.29	2.53	
6111.00	11.000	111.000	5743.42	1916.27	-956.38	1660.55	1.56	
6155.00	10.600	109.900	5786.64	1924.40	-959.26	1668.27	1.02	
6199.00	9.100	106.100	5829.99	1931.77	-961.61	1675.42	3.71	
6244.00	8.000	102.900	5874.49	1938.22	-963.29	1681.89	2.66	
6289.00	7.300	101.500	5919.09	1943.93	-964.56	1687.75	1.61	
6333.00	6.100	104.300	5962.79	1948.83	-965.70	1692.75	2.83	
6378.00	5.200	107.800	6007.57	1953.13	-966.91	1697.01	2.14	
6423.00	4.000	112.700	6052.42	1956.68	-968.14	1700.40	2.80	
6469.00	3.300	113.100	6098.33	1959.59	-969.28	1703.10	1.52	
6514.00	3.000	110.300	6143.26	1962.04	-970.19	1705.39	0.75	
6559.00	2.600	106.400	6188.21	1964.19	-970.89	1707.48	0.98	
6605.00	2.100	108.500	6234.17	1966.03	-971.45	1709.28	1.10	
6650.00	1.800	106.400	6279.14	1967.53	-971.91	1710.74	0.69	
6741.00	1.200	102.200	6370.11	1969.82	-972.52	1713.04	0.67	
6827.00	0.900	103.900	6456.10	1971.33	-972.87	1714.58	0.35	
6916.00	0.500	108.500	6545.09	1972.38	-973.16	1715.62	0.45	
7006.00	0.300	166.200	6635.09	1972.93	-973.52	1716.05	0.47	
7096.00	0.500	218.200	6725.09	1973.04	-974.05	1715.87	0.44	
7187.00	0.600	246.700	6816.08	1972.69	-974.55	1715.18	0.32	
7277.00	0.400	293.100	6906.08	1972.10	-974.62	1714.46	0.48	
7366.00	0.500	326.500	6995.08	1971.44	-974.17	1713.96	0.31	
7456.00	0.400	290.600	7085.07	1970.78	-973.73	1713.45	0.33	

RECEIVED

JUL 24 2009

COGCC

Actual Wellpath Report

WEICHEL 36-14 AWP

Page 6 of 8

INTEQ

REFERENCE WELLPATH IDENTIFICATION

Operator	ANADARKO PETROLEUM	Slot	SLOT#09 WEICHEL 36-14 (1049'FSL & 1045'FWL)
Area	COLORADO	Well	WEICHEL 36-14
Field	WELD COUNTY (ANADARKO)	Wellbore	WEICHEL 36-14 AWB
Facility	SEC.14-T2N-R65W		

WELLPATH DATA (123 stations) † = interpolated/extrapolated station

MD [ft]	Inclination [°]	Azimuth [°]	TVD [ft]	Vert Sect [ft]	North [ft]	East [ft]	DLS [°/100ft]	Comments
7546.00	0.400	303.600	7175.07	1970.16	-973.45	1712.89	0.10	
7640.00	0.300	306.400	7269.07	1969.59	-973.12	1712.42	0.11	LAST BHI MWD SURVEY
√7686.00†	0.300	306.400	√7315.07	1969.35	√-972.98	√1712.23	0.00	PROJECTION TO BIT

HOLE & CASING SECTIONS Ref Wellbore: WEICHEL 36-14 AWB Ref Wellpath: WEICHEL 36-14 AWP

String/Diameter	Start MD [ft]	End MD [ft]	Interval [ft]	Start TVD [ft]	End TVD [ft]	Start N/S [ft]	Start E/W [ft]	End N/S [ft]	End E/W [ft]
12.25in Open Hole	20.00	873.00	853.00	20.00	870.13	0.00	0.00	-49.85	22.23
8.625in Casing Surface	20.00	863.00	843.00	20.00	860.23	0.00	0.00	-48.53	21.61
7.875in Open Hole	863.00	7686.00	6823.00	860.23	7315.07	-48.53	21.61	-972.98	1712.23

RECEIVED

JUL 24 2009

COGCC