

**PROPOSED LOCATION:  
RSU ANSCHUTZ FED 4-61-4  
NW PAD**

**LEGEND:**

 **PROPOSED LOCATION**



**BILL BARRETT CORPORATION**

**RSU ANSCHUTZ FED 4-61-4 NW PAD  
W 1/2 NW 1/4, SECTION 4, T4N, R61W, 6th P.M.  
WELD COUNTY, COLORADO**



**UELS, LLC**  
Corporate Office \* 85 South 200 East  
Vernal, UT 84078 \* (435) 789-1017

SURVEYED BY	R.F., C.M.	06-15-17	SCALE
DRAWN BY	J.L.G.	01-15-18	1 : 100,000
<b>ACCESS ROAD MAP</b>			<b>TOPO A</b>

R  
61  
W

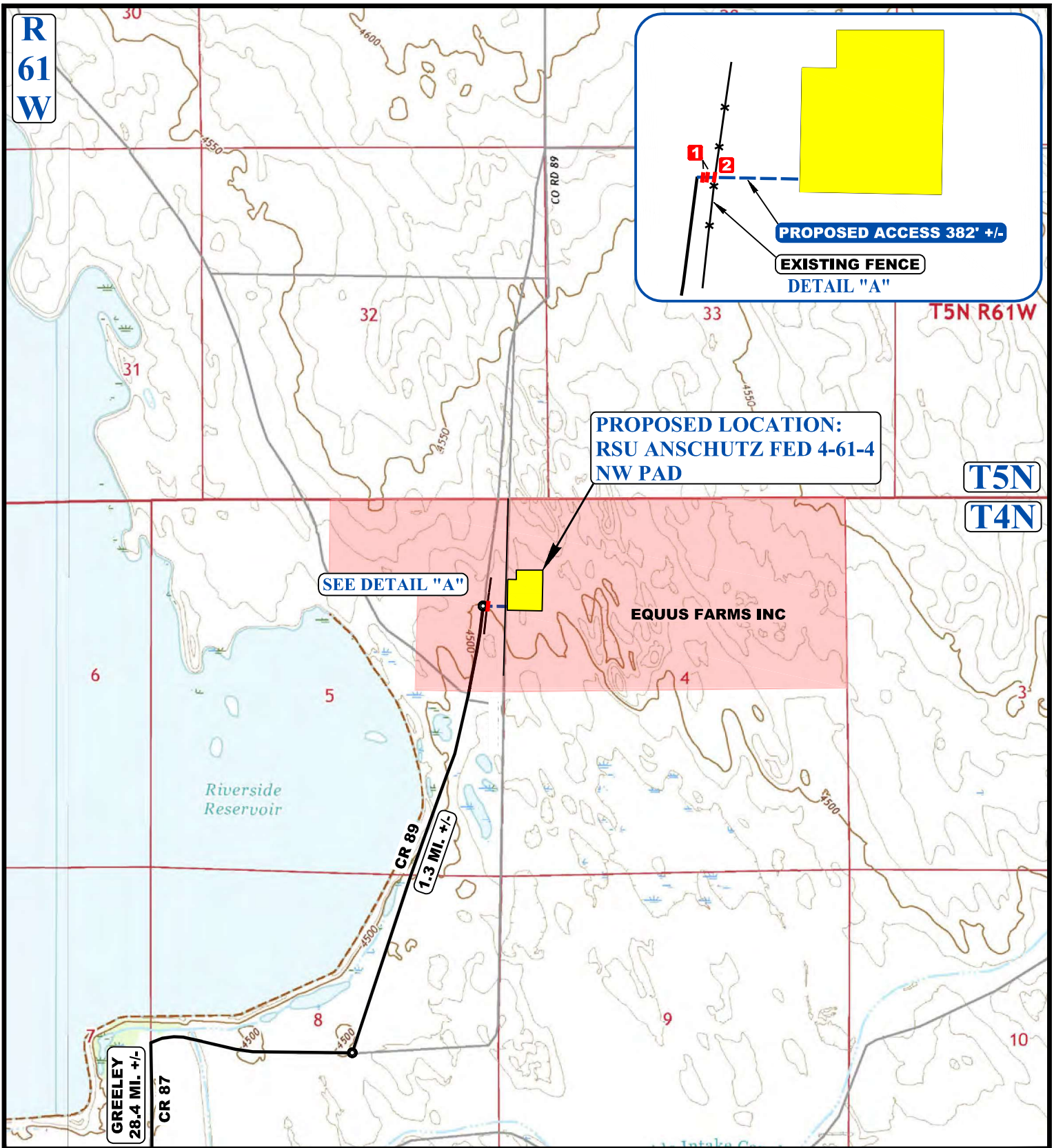

NOTE: PARCEL DATA SHOWN HAS BEEN OBTAINED FROM VARIOUS SOURCES AND SHOULD BE USED FOR MAPPING, GRAPHIC AND PLANNING PURPOSES ONLY. NO WARRANTY IS MADE BY UINTAH ENGINEERING AND LAND SURVEYING (UELS) FOR ACCURACY OF THE PARCEL DATA.

- LEGEND:**
- EXISTING ROAD
  - PROPOSED ROAD
  - 1 INSTALL 18" CULVERT
  - 2 INSTALL CATTLE GUARD



**BILL BARRETT CORPORATION**

**RSU ANSCHUTZ FED 4-61-4 NW PAD**  
 W 1/2 NW 1/4, SECTION 4, T4N, R61W, 6th P.M.  
 WELD COUNTY, COLORADO

SURVEYED BY	R.F., C.M.	06-15-17	SCALE
DRAWN BY	J.L.G.	01-15-18	1 : 24,000
<b>ACCESS ROAD MAP</b>			<b>TOPO B</b>



**UELS, LLC**  
 Corporate Office \* 85 South 200 East  
 Vernal, UT 84078 \* (435) 789-1017