

BUNKER 3A PAD LOCATION DRAWING

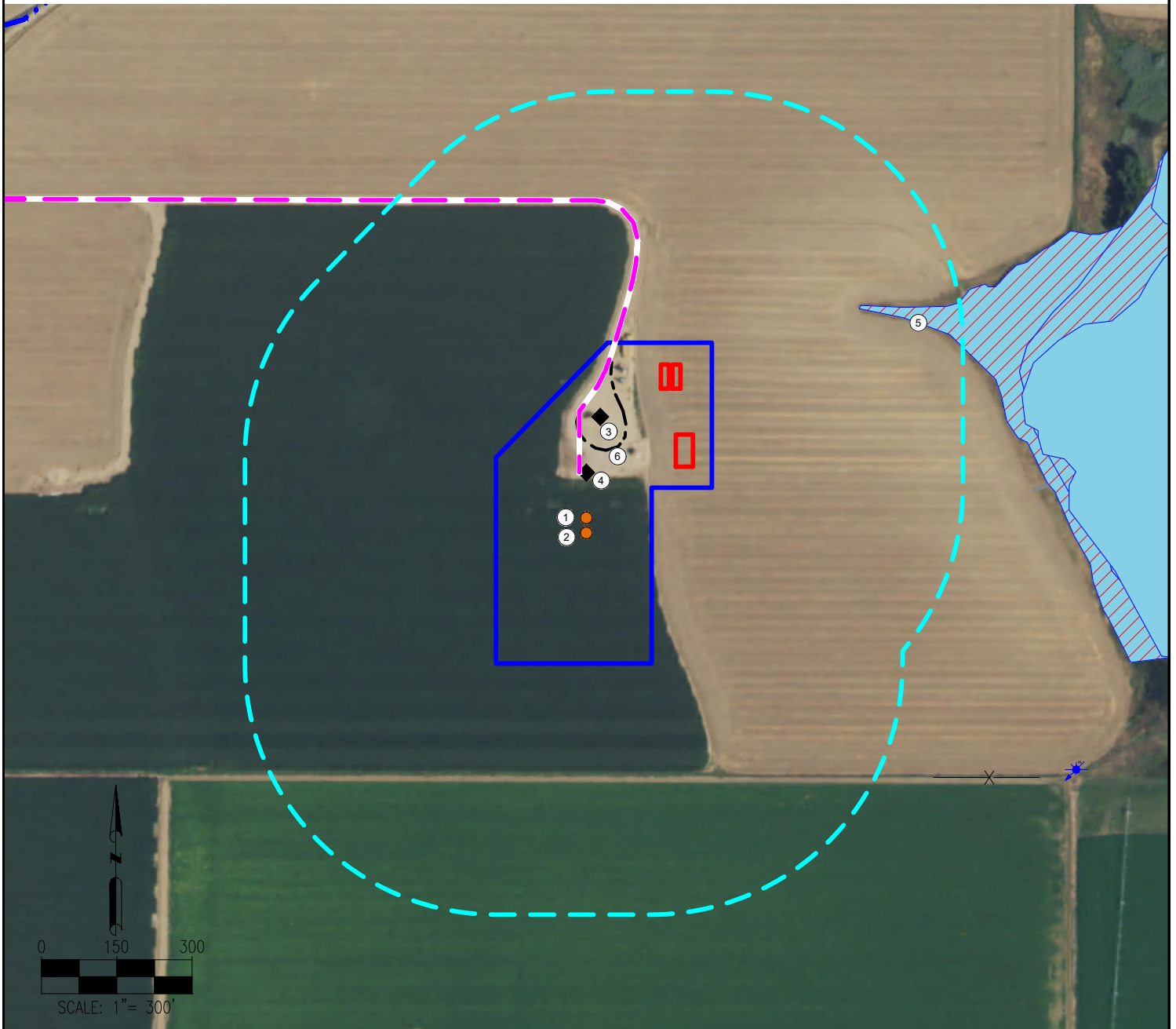

1. PROPOSED BUNKER 3A-1H
2. PROPOSED BUNKER 3A-2H
3. EXISTING BUNKER 3
4. EXISTING BUNKER 3A
5. WETLAND IS $\pm 685'$ NE
6. PRIVATE ROAD IS $\pm 140'$ N

LEGEND:

- = PROPOSED WELL
- ✱ = WATER WELL
- ◆ = PRODUCING WELL
- = PROPOSED ACCESS ROAD
- = DITCH
- = PROPOSED FACILITY BERM
- X = FENCE
- = CONCRETE DITCH
- = DISTURBANCE AREA
- = 500' RADIUS
- = WETLANDS
- = POND

DISCLAIMER:
THIS PLOT DOES NOT REPRESENT A MONUMENTED LAND SURVEY AND SHOULD NOT BE RELIED UPON TO DETERMINE BOUNDARY LINES, PROPERTY OWNERSHIP OR OTHER PROPERTY INTERESTS. PARCEL LINES, IF DEPICTED HAVE NOT BEEN FIELD VERIFIED AND MAY BE BASED UPON PUBLICLY AVAILABLE DATA THAT ALSO HAS NOT BEEN INDEPENDENTLY VERIFIED.

DATA SOURCE:
AERIAL IMAGERY: NAIP 2015
WATER WELLS: COLORADO DWR
NHD: USGS

PUBLICLY AVAILABLE DATA SOURCES HAVE NOT BEEN INDEPENDENTLY VERIFIED BY ASCENT.

MEASURED FROM NEAREST WELL OR FACILITY:

BUILDING $\pm 1470'$ NW
BUILDING UNIT $\pm 1636'$ NW
PUBLIC ROAD (COUNTY ROAD 11) $\pm 1648'$ W
PROPERTY LINE (SWANSON FARM) $\pm 514'$ S
UTILITY (POWERLINE) $\pm 1656'$ NW
RAILROAD $\pm 5280'$ W

MEASURED FROM NEAREST EDGE OF DISTURBANCE:
SURFACE WATER (WETLANDS) $\pm 301'$ E

MEASURED FROM NEAREST EDGE OF DISTURBANCE:
WATER WELL $\pm 872'$ SE SWL = 11.5'
PERMIT: 44-WCB RECEIPT: C350044

REFERENCE LOCATION

****BUNKER 3A-1H****

LAT: 40.357961° N
LONG: 105.034328° W
ELEVATION: 5053'
2151' FNL & 1651' FWL
PDOP: 1.3
GPS OPERATOR: IAN CARABAJAL

DISTURBANCE ACREAGE:
4.00 ACRES DRILLING OPERATIONS
2.00 ACRES INTERIM RECLAIM

CURRENT SURFACE USE: IRRIGATED CROP
FUTURE SURFACE USE: IRRIGATED CROP



FIELD DATE:
09-14-17

DRAWING DATE:
01-09-18

BY:
MJE

CHECKED:
IJM

SITE NAME:
BUNKER 3A PAD

SURFACE LOCATION:

**SE 1/4 NW 1/4 SEC. 32, T5N, R68W, 6TH P.M.
LARIMER COUNTY, COLORADO**

PREPARED FOR:

**MAGPIE
OPERATING, INC.**