

Project: Conceptual Wells
 Site: DP 408
 Well: Emmy State H36-787
 Wellbore: Wellbore #1
 Design: Prelim - Rev 2

Northern Region Drilling - DJ Basin

Geodetic System: US State Plane 1983
 Datum: North American Datum 1983
 Ellipsoid: GRS 1980
 Zone: Colorado Northern Zone
 System Datum: Mean Sea Level

SECTION DETAILS

Sec	MD	Inc	Azi	TVD	+N/-S	+E/-W	Dleg	TFace	VSec	Target
1	0.0	0.00	0.00	0.0	0.0	0.0	0.00	0.00	0.0	
2	2000.0	0.00	0.00	2000.0	0.0	0.0	0.00	0.00	0.0	
3	2725.0	14.50	311.00	2717.3	59.9	-68.9	2.00	311.00	-45.7	
4	6425.6	14.50	311.00	6300.0	667.7	-768.1	0.00	0.00	-509.9	
5	6449.4	15.20	319.59	6323.0	672.1	-772.4	9.69	76.50	-513.3	
6	7494.9	90.00	181.19	7019.0	95.0	-910.0	9.69	-137.38	79.4	
7	12821.8	90.00	181.20	7019.0	-5230.8	-1021.0	0.00	88.63	5329.5	Emmy State H35-787 BHL

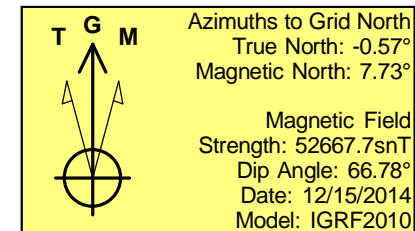
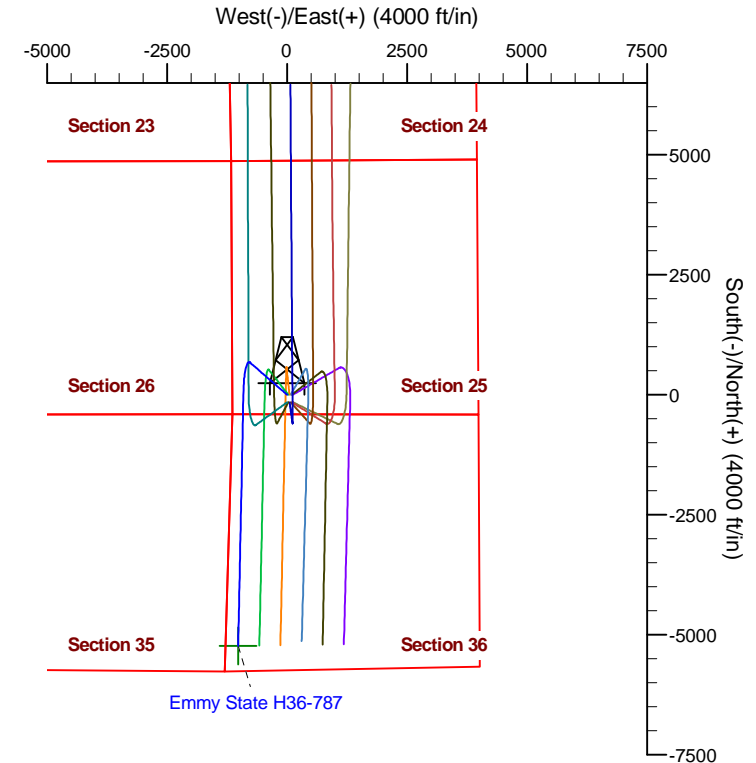
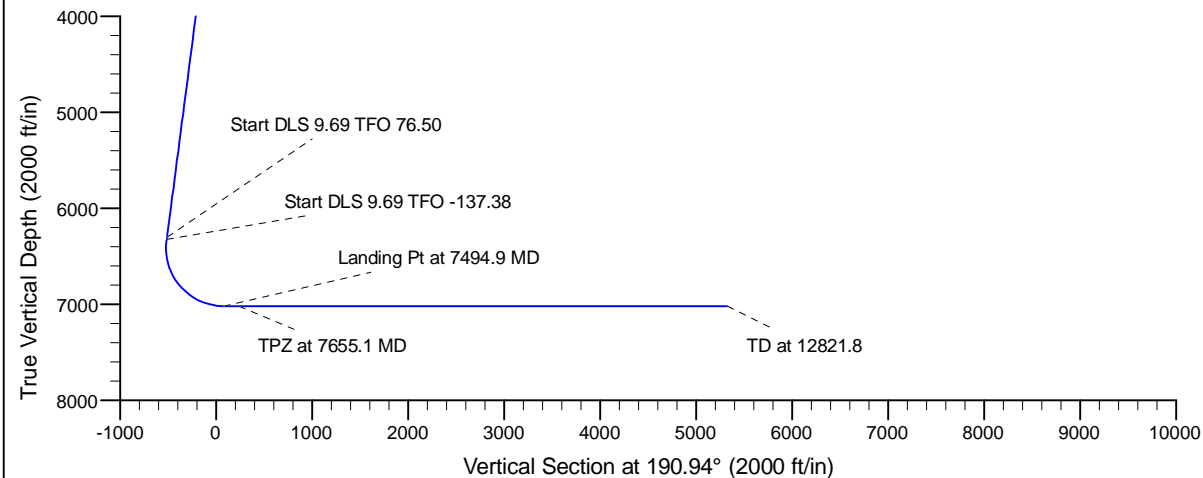
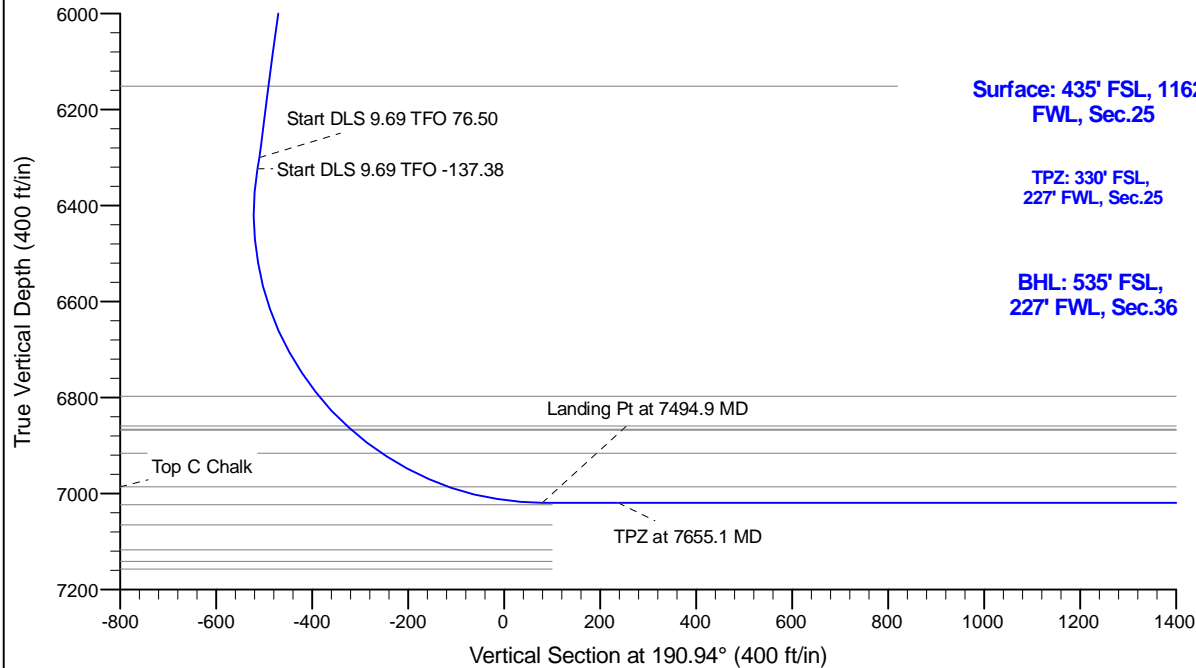

WELL DETAILS: Emmy State H36-787

0.00.0	Ground Level: 4819.0	Latitude	Longitude
1313320.40	Easting 3246659.67	40.190090	-104.617080
1313320.40	3246659.67	40.190090	-104.617080

Plan: Prelim - Rev 2 (Emmy State H36-787/Wellbore #1)

Created By: Colby Baxter

Date: 14:59, November 02 2017

OK to submit with 2A as per Noble Drilling

11/2/2017