



Lat40°, Inc. 6250 W. 10th Street, Unit 2, Greeley, CO 970-515-5294

HYDROLOGY MAP

H25-15 PAD

SECTION: 25
TOWNSHIP: 3N
RANGE: 65W
6TH. P.M.
WELD COUNTY, CO

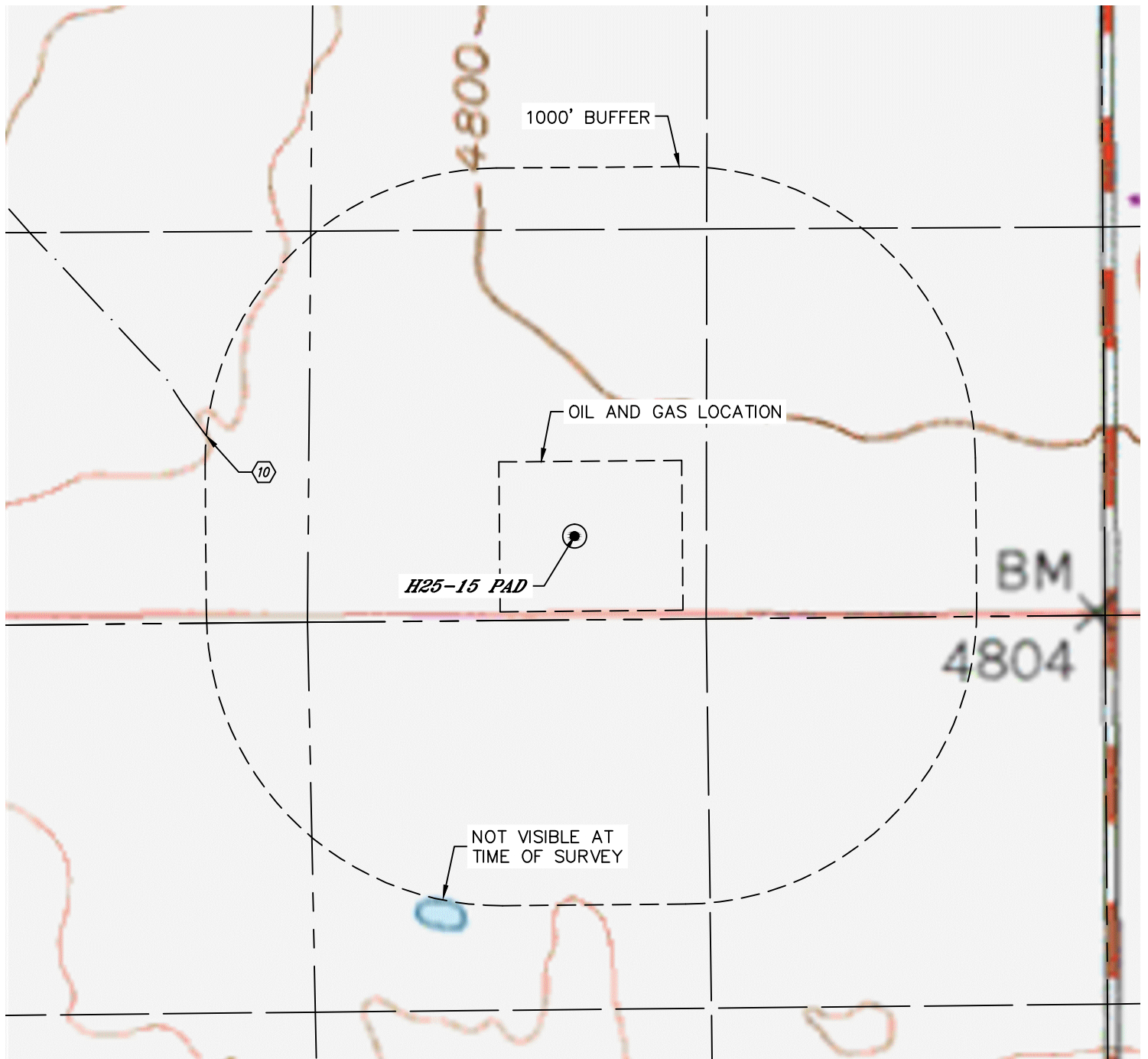

DISTANCES MEASURED FROM THE EDGE OF THE OIL AND GAS LOCATION.

10 DITCH 1000' NW

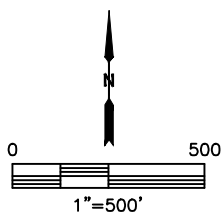

DATE: 8/30/2017
PROJECT#: 2017022