



# Kerr-McGee Oil & Gas Onshore LP

A subsidiary of Anadarko Petroleum Corporation

1099 18<sup>th</sup> Street  
Denver, CO 80202  
720-929-6000

November 14, 2017

Matt Lepore  
Director, Colorado Oil and Gas Conservation Commission  
Department of Natural Resources  
The Chancery Building  
1120 Lincoln Street, Suite 801  
Denver, CO 80203

Re: **30 Day Certification Letter - 318A.e**  
ZELDA 25-11HZ (Doc No. 401455513)  
Township 2 North, Range 65 West  
Section 25: NWNW  
Unit Acreage: 720 Acres  
Unit Spacing: 01N65W SEC 1: NENW, NWNE  
02N65W SEC 25: E2W2, W2E2; SEC 36: E2W2, W2E2  
Weld County, Colorado

Dear Director Lepore:

Kerr-McGee Oil and Gas Onshore LP ("KMG") hereby certifies that a thirty (30) day notice has been given by certified mail to all mineral owners in the proposed wellbore spacing unit. We have not received any objections to this spacing unit or location. KMG hereby respectfully requests approval of this well.

If you have any questions or issues regarding this permit, please contact me at (720) 929-6907.

Sincerely,

**Kerr-McGee Oil and Gas Onshore LP**

A handwritten signature in blue ink, appearing to read 'Craig Richardson'.

Craig Richardson  
Regulatory Analyst II

Enclosure

DISTANCE FROM COMPLETED  
PORTION OF WELLBORE TO  
NEAREST UNIT BOUNDARY= 928'

# ZELDA 25-11HZ WELLBORE SPACING UNIT

**SURFACE LOCATION: NAD 83**  
GROUND ELEVATION= 4902.5'  
LATITUDE= 40.115727°  
LONGITUDE= -104.617064°  
LATITUDE= 40°06'56.618"  
LONGITUDE= -104°37'01.431"  
**HEEL LOCATION: NAD 83**  
LATITUDE= 40.114146°  
LONGITUDE= -104.611385°  
LATITUDE= 40°06'50.925"  
LONGITUDE= -104°36'40.985"  
**BOTTOM HOLE LOCATION: NAD 83**  
LATITUDE= 40.086556°  
LONGITUDE= -104.610996°  
LATITUDE= 40°05'11.602"  
LONGITUDE= -104°36'39.586"

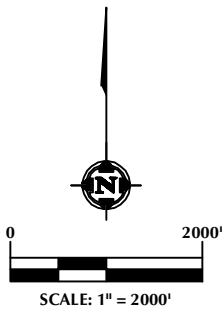

## NOTES:

1. DRAWING LATITUDE AND LONGITUDE COORDINATES ARE NAD 83 (2011)(EPOCH:2010)
2. ELEVATION BASED ON NAVD88 (GEOID12B)
3. BASIS OF BEARING DERIVED FROM COLORADO COORDINATE SYSTEM OF 1983 NORTH ZONE.
4. ALL MEASURED DISTANCES ARE GRID.  
COMBINED SCALE FACTOR: .99972880  
CALCULATED FROM THE N. 1/4 CORNER OF SECTION 25, T2N, R65W

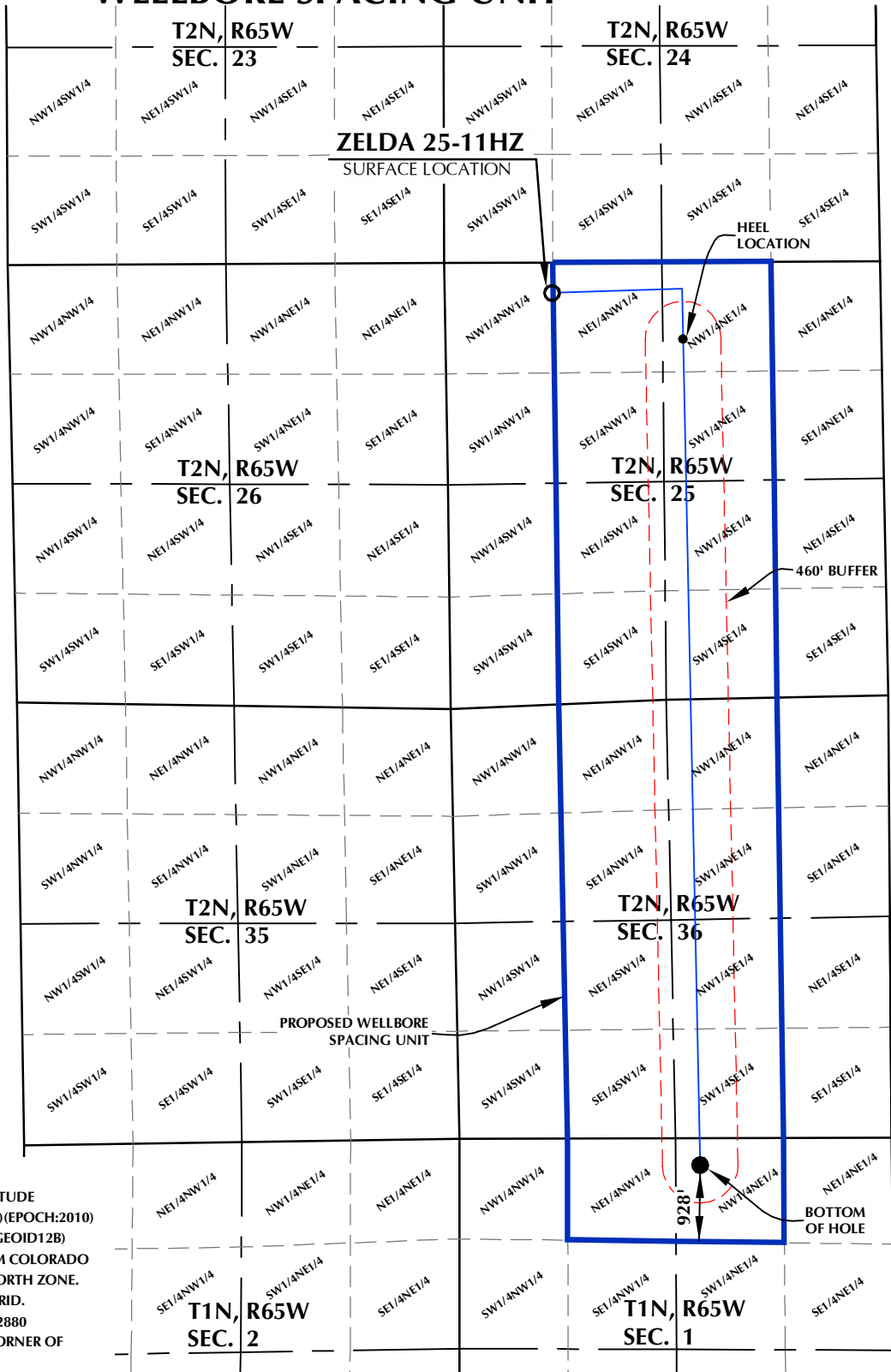

## WELL PAD - ZELDA 25-6HZ

ZELDA 25-11HZ  
WELLBORE SPACING UNIT  
374' FNL & 1309' FWL NNWN (SURFACE)  
940' FNL & 2412' FEL NNWN (HEEL)  
LOCATED IN SECTION 25  
T2N, R65W, 6TH P.M.  
331' FNL & 2328' FEL LOT 1 (NWNE) (BOTTOM)  
LOCATED IN SECTION 1  
T1N, R65W, 6TH P.M.  
WELD COUNTY, COLORADO

**Kerr-McGee Oil &  
Gas Onshore L.P.**  
1099 18th Street  
Denver, Colorado 80202



## CONSULTING, LLC

**SHERIDAN OFFICE**  
1095 Saberton Avenue  
Sheridan, Wyoming 82801  
Phone 307-674-0609

**LOVELAND OFFICE**  
1635 Foxtrail Drive, Suite 204  
Loveland, Colorado 80538  
Phone 970-776-4331

DRAFTED BY:	LMO	CHECKED BY:	RKF
DATE DRAFTED:	9/15/17	DATE SURVEYED:	7/27/17
REVISED:		FILE NAME:	16-188