

BONANZA CREEK OIL COMPANY

Location: COLORADO Slot: SLOT#02 MUSTANG B11-23-24XRLNB (195°FNL & 483°FEL, SEC.22)
Field: WELD COUNTY Well: MUSTANG B11-23-24XRLNB
Facility: SEC.22-T04N-R63W Wellbore: MUSTANG B11-23-24XRLNB PWB

| | |
|--|--|
| Plot reference wellpath is MUSTANG B11-23-24XRLNB PWP (REV-A.0) | Grid System: NAD83 / Lambert Colorado SP, Northern Zone (501), US feet |
| True vertical depths are referenced to XTREME 19 (17KB) (RKB) | * = Wellpath was transformed from a different geoidic datum |
| Measured depths are referenced to XTREME 19 (17KB) (RKB) | North Reference: True north |
| XTREME 19 (17KB) (RKB) to Mean Sea Level: 4724 feet | Scale: True distance |
| Mean Sea Level to Mud line (At Slot: SLOT#02 MUSTANG B11-23-24XRLNB (195°FNL & 483°FEL, SEC.22)): 0 feet | Depths are in feet |
| Coordinates are in feet referenced to Slot | Created by: ingmjmr on 2018-01-16 |
| | Database: Denver |

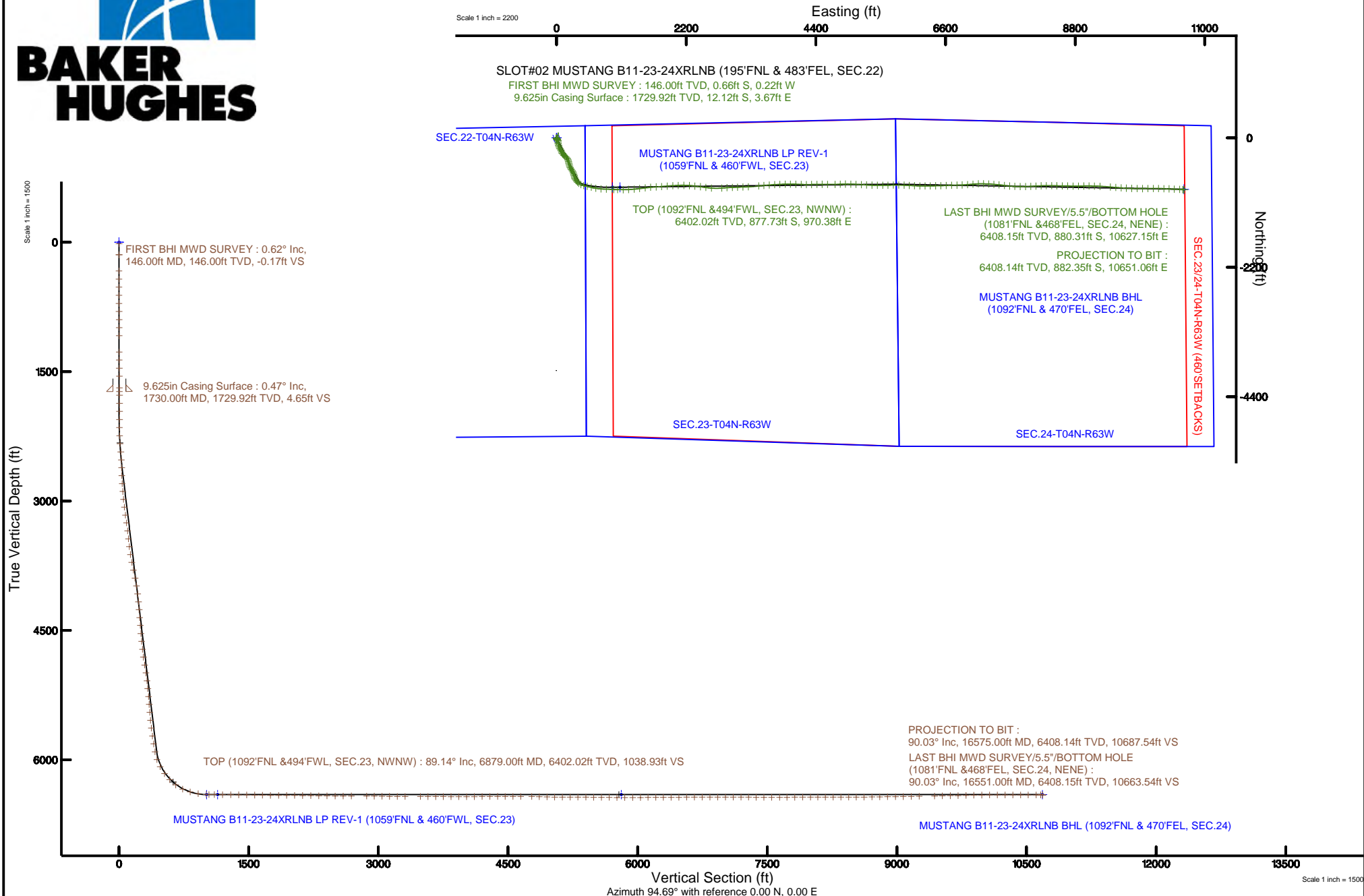

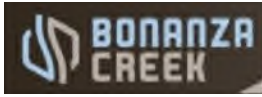

Actual Wellpath Report

MUSTANG B11-23-24XRLNB AWP

Page 1 of 9



REFERENCE WELLPATH IDENTIFICATION

| | | | |
|----------|---------------------------|----------|--|
| Operator | BONANZA CREEK OIL COMPANY | Slot | SLOT#02 MUSTANG B11-23-24XRLNB (195'FNL & 483'FEL, SEC.22) |
| Area | COLORADO | Well | MUSTANG B11-23-24XRLNB |
| Field | WELD COUNTY | Wellbore | MUSTANG B11-23-24XRLNB AWP |
| Facility | SEC.22-T04N-R63W | | |

REPORT SETUP INFORMATION

| | | | |
|---------------------|---|----------------------|---------------------------------------|
| Projection System | NAD83 / Lambert Colorado SP, Northern Zone (501), US feet | Software System | WellArchitect® 5.0 |
| North Reference | True | User | Ingmjmr |
| Scale | 0.999957 | Report Generated | 1/16/2018 at 1:07:29 PM |
| Convergence at slot | 0.71° East | Database/Source file | Denver/MUSTANG_B11-23-24XRLNB_AWP.xml |

WELLPATH LOCATION

| | Local coordinates | | Grid coordinates | | Geographic coordinates | |
|-----------------------|-------------------|----------|------------------|-----------------|------------------------|-----------------|
| | North[ft] | East[ft] | Easting[US ft] | Northing[US ft] | Latitude | Longitude |
| Slot Location | 4150.05 | 20.14 | 3302219.17 | 1355680.76 | 40°18'16.830"N | 104°24'58.930"W |
| Facility Reference Pt | | | 3302249.74 | 1351530.96 | 40°17'35.820"N | 104°24'59.190"W |
| Field Reference Pt | | | 3224525.77 | 1254425.87 | 40°01'44.400"N | 104°41'53.556"W |

WELLPATH DATUM

| | | | |
|--------------------------|-------------------------|--|-------------------|
| Calculation method | Minimum curvature | XTREME 19 (17'KB) (RKB) to Facility Vertical Datum | 4724.00ft |
| Horizontal Reference Pt | Slot | XTREME 19 (17'KB) (RKB) to Mean Sea Level | 4724.00ft |
| Vertical Reference Pt | XTREME 19 (17'KB) (RKB) | XTREME 19 (17'KB) (RKB) to Mud Line at Slot (SLOT#02 MUSTANG B11-23-24XRLNB (195'FNL & 483'FEL, SEC.22)) | 4724.00ft |
| MD Reference Pt | XTREME 19 (17'KB) (RKB) | Section Origin | N 0.00, E 0.00 ft |
| Field Vertical Reference | Mean Sea Level | Section Azimuth | 94.69° |



Actual Wellpath Report

MUSTANG B11-23-24XRLNB AWP

Page 2 of 9



REFERENCE WELLPATH IDENTIFICATION

| | | | |
|----------|---------------------------|----------|--|
| Operator | BONANZA CREEK OIL COMPANY | Slot | SLOT#02 MUSTANG B11-23-24XRLNB (195'FNL & 483'FEL, SEC.22) |
| Area | COLORADO | Well | MUSTANG B11-23-24XRLNB |
| Field | WELD COUNTY | Wellbore | MUSTANG B11-23-24XRLNB AWP |
| Facility | SEC.22-T04N-R63W | | |

WELLPATH DATA (178 stations) † = interpolated/extrapolated station

| MD [ft] | Inclination [°] | Azimuth [°] | TVD [ft] | Vert Sect [ft] | North [ft] | East [ft] | Latitude | Longitude | DLS [°/100ft] | Comments |
|------------|--------------------|----------------|-------------|-------------------|---------------|--------------|----------------|-----------------|------------------|----------------------|
| 0.00† | 0.000 | 198.620 | 0.00 | 0.00 | 0.00 | 0.00 | 40°18'16.830"N | 104°24'58.930"W | 0.00 | |
| 17.00 | 0.000 | 198.620 | 17.00 | 0.00 | 0.00 | 0.00 | 40°18'16.830"N | 104°24'58.930"W | 0.00 | |
| 146.00 | 0.620 | 198.620 | 146.00 | -0.17 | -0.66 | -0.22 | 40°18'16.823"N | 104°24'58.933"W | 0.48 | FIRST BHI MWD SURVEY |
| 333.00 | 0.840 | 192.190 | 332.98 | -0.59 | -2.96 | -0.84 | 40°18'16.801"N | 104°24'58.941"W | 0.13 | |
| 427.00 | 0.880 | 191.520 | 426.97 | -0.77 | -4.34 | -1.12 | 40°18'16.787"N | 104°24'58.945"W | 0.04 | |
| 521.00 | 0.720 | 194.060 | 520.96 | -0.95 | -5.62 | -1.41 | 40°18'16.774"N | 104°24'58.948"W | 0.17 | |
| 615.00 | 0.790 | 160.540 | 614.95 | -0.78 | -6.80 | -1.34 | 40°18'16.763"N | 104°24'58.947"W | 0.47 | |
| 709.00 | 0.710 | 153.160 | 708.95 | -0.21 | -7.94 | -0.86 | 40°18'16.752"N | 104°24'58.941"W | 0.13 | |
| 803.00 | 0.760 | 149.630 | 802.94 | 0.45 | -8.99 | -0.28 | 40°18'16.741"N | 104°24'58.934"W | 0.07 | |
| 897.00 | 0.330 | 193.590 | 896.93 | 0.77 | -9.79 | -0.03 | 40°18'16.733"N | 104°24'58.930"W | 0.61 | |
| 991.00 | 0.430 | 143.690 | 990.93 | 0.96 | -10.34 | 0.11 | 40°18'16.728"N | 104°24'58.929"W | 0.35 | |
| 1084.00 | 0.240 | 152.830 | 1083.93 | 1.29 | -10.80 | 0.41 | 40°18'16.723"N | 104°24'58.925"W | 0.21 | |
| 1273.00 | 0.260 | 149.310 | 1272.93 | 1.75 | -11.52 | 0.81 | 40°18'16.716"N | 104°24'58.920"W | 0.01 | |
| 1366.00 | 0.090 | 105.960 | 1365.93 | 1.94 | -11.72 | 0.99 | 40°18'16.714"N | 104°24'58.917"W | 0.22 | |
| 1460.00 | 0.460 | 91.740 | 1459.93 | 2.39 | -11.75 | 1.43 | 40°18'16.714"N | 104°24'58.911"W | 0.40 | |
| 1554.00 | 0.340 | 106.370 | 1553.93 | 3.04 | -11.84 | 2.08 | 40°18'16.713"N | 104°24'58.903"W | 0.17 | |
| 1687.00 | 0.680 | 99.080 | 1686.92 | 4.21 | -12.08 | 3.24 | 40°18'16.711"N | 104°24'58.888"W | 0.26 | |
| 1773.00 | 0.280 | 75.270 | 1772.92 | 4.92 | -12.10 | 3.94 | 40°18'16.710"N | 104°24'58.879"W | 0.51 | |
| 1867.00 | 0.030 | 207.660 | 1866.92 | 5.13 | -12.07 | 4.16 | 40°18'16.711"N | 104°24'58.876"W | 0.32 | |
| 1961.00 | 0.110 | 28.660 | 1960.92 | 5.16 | -12.01 | 4.19 | 40°18'16.711"N | 104°24'58.876"W | 0.15 | |
| 2055.00 | 0.600 | 193.170 | 2054.92 | 5.12 | -12.41 | 4.12 | 40°18'16.707"N | 104°24'58.877"W | 0.75 | |
| 2149.00 | 2.180 | 194.920 | 2148.88 | 4.73 | -14.62 | 3.55 | 40°18'16.686"N | 104°24'58.884"W | 1.68 | |
| 2243.00 | 3.510 | 153.550 | 2242.78 | 5.90 | -18.92 | 4.37 | 40°18'16.643"N | 104°24'58.874"W | 2.51 | |
| 2337.00 | 6.170 | 125.090 | 2336.44 | 11.75 | -24.40 | 9.78 | 40°18'16.589"N | 104°24'58.804"W | 3.73 | |
| 2431.00 | 7.700 | 140.800 | 2429.76 | 20.47 | -32.19 | 17.90 | 40°18'16.512"N | 104°24'58.699"W | 2.58 | |
| 2525.00 | 11.060 | 169.230 | 2522.54 | 27.25 | -45.94 | 23.57 | 40°18'16.376"N | 104°24'58.626"W | 5.99 | |
| 2619.00 | 12.810 | 182.840 | 2614.52 | 29.99 | -65.21 | 24.74 | 40°18'16.186"N | 104°24'58.611"W | 3.51 | |
| 2713.00 | 13.050 | 177.320 | 2706.14 | 31.69 | -86.22 | 24.72 | 40°18'15.978"N | 104°24'58.611"W | 1.34 | |
| 2807.00 | 12.800 | 162.550 | 2797.79 | 36.98 | -106.76 | 28.34 | 40°18'15.775"N | 104°24'58.564"W | 3.52 | |
| 2901.00 | 13.010 | 164.070 | 2889.41 | 44.63 | -126.87 | 34.36 | 40°18'15.576"N | 104°24'58.486"W | 0.42 | |



Actual Wellpath Report

MUSTANG B11-23-24XRLNB AWP

Page 3 of 9



REFERENCE WELLPATH IDENTIFICATION

| | | | |
|----------|---------------------------|----------|--|
| Operator | BONANZA CREEK OIL COMPANY | Slot | SLOT#02 MUSTANG B11-23-24XRLNB (195'FNL & 483'FEL, SEC.22) |
| Area | COLORADO | Well | MUSTANG B11-23-24XRLNB |
| Field | WELD COUNTY | Wellbore | MUSTANG B11-23-24XRLNB AWB |
| Facility | SEC.22-T04N-R63W | | |

WELLPATH DATA (178 stations)

| MD [ft] | Inclination [°] | Azimuth [°] | TVD [ft] | Vert Sect [ft] | North [ft] | East [ft] | Latitude | Longitude | DLS ["/100ft] | Comments |
|------------|--------------------|----------------|-------------|-------------------|---------------|--------------|----------------|-----------------|------------------|----------|
| 2994.00 | 13.580 | 163.200 | 2979.92 | 52.31 | -147.38 | 40.39 | 40°18'15.374"N | 104°24'58.409"W | 0.65 | |
| 3087.00 | 13.680 | 154.180 | 3070.31 | 61.90 | -167.74 | 48.34 | 40°18'15.172"N | 104°24'58.306"W | 2.29 | |
| 3182.00 | 13.100 | 145.320 | 3162.74 | 74.43 | -186.71 | 59.36 | 40°18'14.985"N | 104°24'58.164"W | 2.24 | |
| 3276.00 | 12.640 | 150.470 | 3254.38 | 86.98 | -204.42 | 70.49 | 40°18'14.810"N | 104°24'58.020"W | 1.31 | |
| 3370.00 | 13.140 | 154.650 | 3346.01 | 98.11 | -223.02 | 80.13 | 40°18'14.626"N | 104°24'57.896"W | 1.13 | |
| 3464.00 | 13.490 | 159.820 | 3437.49 | 108.07 | -242.97 | 88.49 | 40°18'14.429"N | 104°24'57.788"W | 1.32 | |
| 3558.00 | 13.560 | 156.300 | 3528.88 | 117.92 | -263.35 | 96.70 | 40°18'14.228"N | 104°24'57.682"W | 0.88 | |
| 3652.00 | 13.580 | 142.000 | 3620.29 | 130.65 | -282.14 | 107.93 | 40°18'14.042"N | 104°24'57.537"W | 3.56 | |
| 3745.00 | 14.010 | 127.740 | 3710.63 | 147.49 | -297.64 | 123.56 | 40°18'13.889"N | 104°24'57.335"W | 3.68 | |
| 3839.00 | 13.500 | 123.090 | 3801.94 | 166.68 | -310.60 | 141.75 | 40°18'13.761"N | 104°24'57.100"W | 1.29 | |
| 3933.00 | 13.400 | 132.990 | 3893.37 | 184.89 | -324.01 | 158.91 | 40°18'13.628"N | 104°24'56.879"W | 2.45 | |
| 4027.00 | 13.610 | 141.110 | 3984.78 | 201.06 | -340.05 | 173.82 | 40°18'13.470"N | 104°24'56.686"W | 2.03 | |
| 4121.00 | 12.850 | 148.340 | 4076.29 | 214.88 | -357.56 | 186.25 | 40°18'13.297"N | 104°24'56.526"W | 1.94 | |
| 4215.00 | 13.060 | 162.320 | 4167.92 | 225.12 | -376.58 | 194.97 | 40°18'13.109"N | 104°24'56.414"W | 3.33 | |
| 4309.00 | 13.420 | 168.150 | 4259.43 | 232.27 | -397.37 | 200.43 | 40°18'12.903"N | 104°24'56.343"W | 1.47 | |
| 4403.00 | 13.640 | 166.560 | 4350.82 | 238.83 | -418.83 | 205.25 | 40°18'12.691"N | 104°24'56.281"W | 0.46 | |
| 4497.00 | 13.390 | 167.040 | 4442.21 | 245.58 | -440.22 | 210.27 | 40°18'12.480"N | 104°24'56.216"W | 0.29 | |
| 4593.00 | 13.960 | 167.790 | 4535.49 | 252.31 | -462.37 | 215.21 | 40°18'12.261"N | 104°24'56.152"W | 0.62 | |
| 4687.00 | 13.830 | 159.590 | 4626.75 | 260.38 | -483.98 | 221.53 | 40°18'12.047"N | 104°24'56.071"W | 2.10 | |
| 4782.00 | 13.700 | 156.560 | 4719.02 | 270.50 | -504.95 | 229.96 | 40°18'11.840"N | 104°24'55.962"W | 0.77 | |
| 4876.00 | 13.920 | 149.610 | 4810.31 | 282.25 | -524.91 | 240.11 | 40°18'11.643"N | 104°24'55.831"W | 1.78 | |
| 4970.00 | 13.830 | 141.660 | 4901.58 | 296.41 | -543.48 | 252.80 | 40°18'11.459"N | 104°24'55.667"W | 2.03 | |
| 5064.00 | 13.750 | 146.340 | 4992.87 | 311.01 | -561.59 | 265.96 | 40°18'11.280"N | 104°24'55.497"W | 1.19 | |
| 5157.00 | 12.060 | 154.000 | 5083.53 | 322.83 | -579.52 | 276.35 | 40°18'11.103"N | 104°24'55.363"W | 2.58 | |
| 5251.00 | 13.720 | 163.690 | 5175.16 | 331.84 | -599.05 | 283.78 | 40°18'10.910"N | 104°24'55.267"W | 2.89 | |
| 5345.00 | 13.110 | 158.070 | 5266.60 | 340.61 | -619.64 | 290.90 | 40°18'10.707"N | 104°24'55.175"W | 1.53 | |
| 5439.00 | 12.980 | 162.660 | 5358.18 | 349.35 | -639.61 | 298.03 | 40°18'10.509"N | 104°24'55.083"W | 1.11 | |
| 5533.00 | 13.020 | 167.920 | 5449.77 | 356.37 | -660.04 | 303.39 | 40°18'10.308"N | 104°24'55.014"W | 1.26 | |
| 5627.00 | 13.360 | 164.580 | 5541.29 | 363.16 | -680.86 | 308.49 | 40°18'10.102"N | 104°24'54.948"W | 0.89 | |
| 5720.00 | 13.210 | 151.140 | 5631.83 | 372.73 | -700.53 | 316.48 | 40°18'09.907"N | 104°24'54.845"W | 3.32 | |



Actual Wellpath Report

MUSTANG B11-23-24XRLNB AWP

Page 4 of 9



REFERENCE WELLPATH IDENTIFICATION

| | | | |
|----------|---------------------------|----------|--|
| Operator | BONANZA CREEK OIL COMPANY | Slot | SLOT#02 MUSTANG B11-23-24XRLNB (195'FNL & 483'FEL, SEC.22) |
| Area | COLORADO | Well | MUSTANG B11-23-24XRLNB |
| Field | WELD COUNTY | Wellbore | MUSTANG B11-23-24XRLNB AWB |
| Facility | SEC.22-T04N-R63W | | |

WELLPATH DATA (178 stations) † = interpolated/extrapolated station

| MD [ft] | Inclination [°] | Azimuth [°] | TVD [ft] | Vert Sect [ft] | North [ft] | East [ft] | Latitude | Longitude | DLS [°/100ft] | Comments |
|------------|--------------------|----------------|-------------|-------------------|---------------|--------------|----------------|-----------------|------------------|--|
| 5815.00 | 13.310 | 143.190 | 5724.30 | 385.97 | -718.80 | 328.27 | 40°18'09.727"N | 104°24'54.693"W | 1.92 | |
| 5909.00 | 13.270 | 143.390 | 5815.79 | 400.26 | -736.12 | 341.19 | 40°18'09.556"N | 104°24'54.526"W | 0.06 | |
| 6003.00 | 14.160 | 141.790 | 5907.10 | 415.21 | -753.81 | 354.73 | 40°18'09.381"N | 104°24'54.352"W | 1.03 | |
| 6097.00 | 22.300 | 129.010 | 5996.35 | 437.82 | -774.12 | 375.75 | 40°18'09.180"N | 104°24'54.080"W | 9.60 | |
| 6191.00 | 30.480 | 113.450 | 6080.58 | 475.23 | -794.89 | 411.58 | 40°18'08.975"N | 104°24'53.618"W | 11.33 | |
| 6285.00 | 36.260 | 104.910 | 6159.09 | 525.23 | -811.55 | 460.38 | 40°18'08.810"N | 104°24'52.988"W | 7.91 | |
| 6378.00 | 44.720 | 102.130 | 6229.76 | 584.85 | -825.53 | 519.06 | 40°18'08.672"N | 104°24'52.231"W | 9.30 | |
| 6472.00 | 53.880 | 101.780 | 6290.99 | 655.47 | -840.26 | 588.71 | 40°18'08.527"N | 104°24'51.332"W | 9.75 | |
| 6566.00 | 63.620 | 101.020 | 6339.70 | 735.19 | -856.10 | 667.39 | 40°18'08.370"N | 104°24'50.316"W | 10.38 | |
| 6660.00 | 75.030 | 95.010 | 6372.86 | 822.80 | -868.16 | 754.31 | 40°18'08.251"N | 104°24'49.194"W | 13.53 | |
| 6754.00 | 80.410 | 90.540 | 6392.86 | 914.54 | -872.57 | 845.99 | 40°18'08.207"N | 104°24'48.011"W | 7.37 | |
| 6849.00 | 89.080 | 93.610 | 6401.55 | 1008.94 | -876.01 | 940.43 | 40°18'08.173"N | 104°24'46.792"W | 9.68 | |
| 6879.00† | 89.137 | 92.959 | 6402.02 | 1038.93 | -877.73 | 970.38 | 40°18'08.156"N | 104°24'46.406"W | 2.18 | TOP (1092'FNL & 494'FWL, SEC.23, NWNW) |
| 6943.00 | 89.260 | 91.570 | 6402.91 | 1102.86 | -880.26 | 1034.32 | 40°18'08.131"N | 104°24'45.580"W | 2.18 | |
| 7038.00 | 89.170 | 89.130 | 6404.21 | 1197.58 | -880.84 | 1129.30 | 40°18'08.125"N | 104°24'44.354"W | 2.57 | |
| 7132.00 | 89.480 | 87.330 | 6405.32 | 1290.97 | -877.93 | 1223.25 | 40°18'08.154"N | 104°24'43.142"W | 1.94 | |
| 7226.00 | 89.170 | 84.780 | 6406.43 | 1383.89 | -871.47 | 1317.01 | 40°18'08.218"N | 104°24'41.932"W | 2.73 | |
| 7320.00 | 89.260 | 83.750 | 6407.72 | 1476.32 | -862.08 | 1410.53 | 40°18'08.311"N | 104°24'40.725"W | 1.10 | |
| 7414.00 | 89.080 | 82.450 | 6409.08 | 1568.40 | -850.79 | 1503.84 | 40°18'08.422"N | 104°24'39.520"W | 1.40 | |
| 7507.00 | 88.830 | 84.240 | 6410.77 | 1659.56 | -840.01 | 1596.19 | 40°18'08.529"N | 104°24'38.328"W | 1.94 | |
| 7601.00 | 89.750 | 87.410 | 6411.94 | 1752.42 | -833.17 | 1689.92 | 40°18'08.596"N | 104°24'37.119"W | 3.51 | |
| 7695.00 | 89.480 | 85.610 | 6412.57 | 1845.45 | -827.45 | 1783.74 | 40°18'08.653"N | 104°24'35.908"W | 1.94 | |
| 7789.00 | 89.600 | 85.320 | 6413.33 | 1938.23 | -820.01 | 1877.44 | 40°18'08.726"N | 104°24'34.698"W | 0.33 | |
| 7883.00 | 90.370 | 86.810 | 6413.35 | 2031.17 | -813.56 | 1971.22 | 40°18'08.790"N | 104°24'33.488"W | 1.78 | |
| 7977.00 | 89.140 | 87.580 | 6413.75 | 2124.36 | -808.96 | 2065.10 | 40°18'08.835"N | 104°24'32.276"W | 1.54 | |
| 8071.00 | 88.950 | 90.600 | 6415.32 | 2217.89 | -807.47 | 2159.07 | 40°18'08.850"N | 104°24'31.063"W | 3.22 | |
| 8165.00 | 89.080 | 94.170 | 6416.94 | 2311.78 | -811.38 | 2252.96 | 40°18'08.811"N | 104°24'29.852"W | 3.80 | |
| 8259.00 | 89.380 | 95.610 | 6418.20 | 2405.77 | -819.39 | 2346.60 | 40°18'08.732"N | 104°24'28.643"W | 1.56 | |
| 8353.00 | 89.380 | 97.610 | 6419.22 | 2499.71 | -830.21 | 2439.97 | 40°18'08.625"N | 104°24'27.438"W | 2.13 | |
| 8447.00 | 90.370 | 98.170 | 6419.42 | 2593.56 | -843.12 | 2533.08 | 40°18'08.497"N | 104°24'26.236"W | 1.21 | |



Actual Wellpath Report

MUSTANG B11-23-24XRLNB AWP

Page 5 of 9



REFERENCE WELLPATH IDENTIFICATION

| | | | |
|----------|---------------------------|----------|--|
| Operator | BONANZA CREEK OIL COMPANY | Slot | SLOT#02 MUSTANG B11-23-24XRLNB (195'FNL & 483'FEL, SEC.22) |
| Area | COLORADO | Well | MUSTANG B11-23-24XRLNB |
| Field | WELD COUNTY | Wellbore | MUSTANG B11-23-24XRLNB AWB |
| Facility | SEC.22-T04N-R63W | | |

WELLPATH DATA (178 stations)

| MD [ft] | Inclination [°] | Azimuth [°] | TVD [ft] | Vert Sect [ft] | North [ft] | East [ft] | Latitude | Longitude | DLS [°/100ft] | Comments |
|------------|--------------------|----------------|-------------|-------------------|---------------|--------------|----------------|-----------------|------------------|----------|
| 8541.00 | 90.220 | 93.950 | 6418.94 | 2687.51 | -853.04 | 2626.53 | 40°18'08.399"N | 104°24'25.030"W | 4.49 | |
| 8719.00 | 89.140 | 85.620 | 6419.93 | 2864.69 | -852.37 | 2804.36 | 40°18'08.405"N | 104°24'22.735"W | 4.72 | |
| 8808.00 | 89.260 | 87.130 | 6421.18 | 2952.75 | -846.74 | 2893.18 | 40°18'08.461"N | 104°24'21.589"W | 1.70 | |
| 8898.00 | 89.140 | 87.250 | 6422.43 | 3041.97 | -842.33 | 2983.06 | 40°18'08.504"N | 104°24'20.428"W | 0.19 | |
| 8987.00 | 89.110 | 87.630 | 6423.79 | 3130.25 | -838.36 | 3071.96 | 40°18'08.544"N | 104°24'19.281"W | 0.43 | |
| 9077.00 | 90.150 | 88.850 | 6424.37 | 3219.67 | -835.59 | 3161.91 | 40°18'08.571"N | 104°24'18.120"W | 1.78 | |
| 9168.00 | 89.970 | 87.100 | 6424.28 | 3310.04 | -832.38 | 3252.85 | 40°18'08.602"N | 104°24'16.946"W | 1.93 | |
| 9347.00 | 89.320 | 83.250 | 6425.39 | 3486.54 | -817.33 | 3431.18 | 40°18'08.751"N | 104°24'14.645"W | 2.18 | |
| 9436.00 | 89.940 | 85.170 | 6425.96 | 3574.05 | -808.35 | 3519.72 | 40°18'08.840"N | 104°24'13.502"W | 2.27 | |
| 9526.00 | 89.940 | 85.850 | 6426.06 | 3662.90 | -801.30 | 3609.44 | 40°18'08.909"N | 104°24'12.344"W | 0.76 | |
| 9616.00 | 89.850 | 87.010 | 6426.22 | 3751.96 | -795.70 | 3699.27 | 40°18'08.964"N | 104°24'11.184"W | 1.29 | |
| 9706.00 | 89.850 | 87.470 | 6426.46 | 3841.20 | -791.36 | 3789.16 | 40°18'09.007"N | 104°24'10.024"W | 0.51 | |
| 9796.00 | 89.940 | 88.810 | 6426.62 | 3930.61 | -788.44 | 3879.11 | 40°18'09.036"N | 104°24'08.863"W | 1.49 | |
| 9887.00 | 89.750 | 90.060 | 6426.87 | 4021.22 | -787.55 | 3970.10 | 40°18'09.044"N | 104°24'07.689"W | 1.39 | |
| 9977.00 | 90.710 | 92.230 | 6426.51 | 4111.04 | -789.34 | 4060.08 | 40°18'09.027"N | 104°24'06.527"W | 2.64 | |
| 10067.00 | 90.220 | 91.370 | 6425.78 | 4200.93 | -792.17 | 4150.03 | 40°18'08.998"N | 104°24'05.367"W | 1.10 | |
| 10156.00 | 91.140 | 90.620 | 6424.72 | 4289.73 | -793.72 | 4239.01 | 40°18'08.983"N | 104°24'04.218"W | 1.33 | |
| 10246.00 | 90.000 | 88.330 | 6423.82 | 4379.35 | -792.89 | 4328.99 | 40°18'08.991"N | 104°24'03.057"W | 2.84 | |
| 10335.00 | 89.600 | 88.730 | 6424.14 | 4467.83 | -790.61 | 4417.96 | 40°18'09.013"N | 104°24'01.908"W | 0.64 | |
| 10425.00 | 89.690 | 90.440 | 6424.69 | 4557.47 | -789.96 | 4507.96 | 40°18'09.020"N | 104°24'00.747"W | 1.90 | |
| 10515.00 | 90.490 | 91.290 | 6424.55 | 4647.27 | -791.32 | 4597.94 | 40°18'09.006"N | 104°23'59.585"W | 1.30 | |
| 10642.00 | 89.200 | 88.890 | 6424.90 | 4773.85 | -791.51 | 4724.93 | 40°18'09.004"N | 104°23'57.946"W | 2.15 | |
| 10731.00 | 88.150 | 87.650 | 6426.95 | 4862.26 | -788.83 | 4813.86 | 40°18'09.030"N | 104°23'56.799"W | 1.83 | |
| 10821.00 | 88.060 | 88.860 | 6429.93 | 4951.64 | -786.09 | 4903.77 | 40°18'09.057"N | 104°23'55.638"W | 1.35 | |
| 10910.00 | 89.480 | 92.000 | 6431.84 | 5040.36 | -786.76 | 4992.74 | 40°18'09.050"N | 104°23'54.490"W | 3.87 | |
| 11000.00 | 89.780 | 92.500 | 6432.42 | 5130.28 | -790.29 | 5082.66 | 40°18'09.015"N | 104°23'53.329"W | 0.65 | |
| 11089.00 | 90.370 | 93.520 | 6432.30 | 5219.24 | -794.96 | 5171.54 | 40°18'08.969"N | 104°23'52.182"W | 1.32 | |
| 11179.00 | 89.450 | 93.220 | 6432.45 | 5309.21 | -800.26 | 5261.38 | 40°18'08.917"N | 104°23'51.023"W | 1.08 | |
| 11270.00 | 89.540 | 92.110 | 6433.25 | 5400.15 | -804.49 | 5352.28 | 40°18'08.875"N | 104°23'49.849"W | 1.22 | |
| 11362.00 | 89.140 | 89.980 | 6434.31 | 5491.95 | -806.16 | 5444.25 | 40°18'08.858"N | 104°23'48.662"W | 2.36 | |



Actual Wellpath Report

MUSTANG B11-23-24XRLNB AWP

Page 6 of 9



REFERENCE WELLPATH IDENTIFICATION

| | | | |
|----------|---------------------------|----------|--|
| Operator | BONANZA CREEK OIL COMPANY | Slot | SLOT#02 MUSTANG B11-23-24XRLNB (195'FNL & 483'FEL, SEC.22) |
| Area | COLORADO | Well | MUSTANG B11-23-24XRLNB |
| Field | WELD COUNTY | Wellbore | MUSTANG B11-23-24XRLNB AWB |
| Facility | SEC.22-T04N-R63W | | |

WELLPATH DATA (178 stations)

| MD [ft] | Inclination [°] | Azimuth [°] | TVD [ft] | Vert Sect [ft] | North [ft] | East [ft] | Latitude | Longitude | DLS [°/100ft] | Comments |
|------------|--------------------|----------------|-------------|-------------------|---------------|--------------|----------------|-----------------|------------------|----------|
| 11452.00 | 90.220 | 90.580 | 6434.81 | 5581.68 | -806.60 | 5534.25 | 40°18'08.853"N | 104°23'47.501"W | 1.37 | |
| 11542.00 | 88.610 | 88.020 | 6435.73 | 5671.27 | -805.50 | 5624.23 | 40°18'08.864"N | 104°23'46.339"W | 3.36 | |
| 11632.00 | 89.910 | 89.430 | 6436.89 | 5760.77 | -803.50 | 5714.19 | 40°18'08.883"N | 104°23'45.178"W | 2.13 | |
| 11723.00 | 90.060 | 89.970 | 6436.92 | 5851.43 | -803.03 | 5805.19 | 40°18'08.888"N | 104°23'44.004"W | 0.62 | |
| 11814.00 | 90.310 | 91.890 | 6436.62 | 5942.22 | -804.50 | 5896.17 | 40°18'08.873"N | 104°23'42.829"W | 2.13 | |
| 11904.00 | 90.180 | 93.150 | 6436.24 | 6032.16 | -808.46 | 5986.08 | 40°18'08.834"N | 104°23'41.669"W | 1.41 | |
| 11993.00 | 90.620 | 93.570 | 6435.62 | 6121.13 | -813.68 | 6074.93 | 40°18'08.782"N | 104°23'40.522"W | 0.68 | |
| 12083.00 | 90.340 | 90.850 | 6434.86 | 6211.03 | -817.15 | 6164.85 | 40°18'08.748"N | 104°23'39.362"W | 3.04 | |
| 12170.00 | 90.000 | 89.620 | 6434.60 | 6297.77 | -817.50 | 6251.85 | 40°18'08.744"N | 104°23'38.239"W | 1.47 | |
| 12261.00 | 90.340 | 89.160 | 6434.33 | 6388.38 | -816.53 | 6342.84 | 40°18'08.753"N | 104°23'37.064"W | 0.63 | |
| 12350.00 | 90.400 | 88.680 | 6433.76 | 6476.93 | -814.86 | 6431.82 | 40°18'08.769"N | 104°23'35.916"W | 0.54 | |
| 12440.00 | 90.340 | 88.570 | 6433.18 | 6566.42 | -812.70 | 6521.80 | 40°18'08.791"N | 104°23'34.755"W | 0.14 | |
| 12530.00 | 89.880 | 87.980 | 6433.01 | 6655.85 | -809.99 | 6611.75 | 40°18'08.817"N | 104°23'33.594"W | 0.83 | |
| 12622.00 | 90.090 | 87.930 | 6433.03 | 6747.22 | -806.70 | 6703.70 | 40°18'08.849"N | 104°23'32.407"W | 0.23 | |
| 12713.00 | 89.970 | 88.630 | 6432.98 | 6837.65 | -803.97 | 6794.65 | 40°18'08.876"N | 104°23'31.233"W | 0.78 | |
| 12803.00 | 89.850 | 87.410 | 6433.12 | 6927.04 | -800.86 | 6884.60 | 40°18'08.907"N | 104°23'30.072"W | 1.36 | |
| 12893.00 | 90.090 | 85.330 | 6433.17 | 7016.09 | -795.17 | 6974.41 | 40°18'08.963"N | 104°23'28.913"W | 2.33 | |
| 12985.00 | 89.940 | 84.790 | 6433.15 | 7106.79 | -787.24 | 7066.07 | 40°18'09.041"N | 104°23'27.730"W | 0.61 | |
| 13076.00 | 90.150 | 88.050 | 6433.07 | 7196.83 | -781.56 | 7156.88 | 40°18'09.097"N | 104°23'26.558"W | 3.59 | |
| 13164.00 | 89.600 | 91.790 | 6433.27 | 7284.51 | -781.44 | 7244.86 | 40°18'09.097"N | 104°23'25.422"W | 4.30 | |
| 13251.00 | 89.450 | 92.240 | 6433.99 | 7371.41 | -784.50 | 7331.81 | 40°18'09.067"N | 104°23'24.300"W | 0.55 | |
| 13340.00 | 89.940 | 94.940 | 6434.46 | 7460.38 | -790.07 | 7420.62 | 40°18'09.012"N | 104°23'23.154"W | 3.08 | |
| 13430.00 | 89.910 | 96.770 | 6434.58 | 7550.36 | -799.25 | 7510.15 | 40°18'08.921"N | 104°23'21.998"W | 2.03 | |
| 13522.00 | 90.280 | 96.700 | 6434.43 | 7642.30 | -810.04 | 7601.51 | 40°18'08.814"N | 104°23'20.819"W | 0.41 | |
| 13608.00 | 90.280 | 95.020 | 6434.01 | 7728.28 | -818.82 | 7687.06 | 40°18'08.727"N | 104°23'19.715"W | 1.95 | |
| 13697.00 | 90.340 | 93.430 | 6433.52 | 7817.27 | -825.38 | 7775.81 | 40°18'08.662"N | 104°23'18.569"W | 1.79 | |
| 13789.00 | 90.370 | 91.100 | 6432.95 | 7909.18 | -829.01 | 7867.73 | 40°18'08.625"N | 104°23'17.383"W | 2.53 | |
| 13881.00 | 90.460 | 88.440 | 6432.29 | 8000.83 | -828.64 | 7959.72 | 40°18'08.629"N | 104°23'16.196"W | 2.89 | |
| 13967.00 | 89.970 | 86.360 | 6431.97 | 8086.13 | -824.74 | 8045.63 | 40°18'08.667"N | 104°23'15.087"W | 2.48 | |
| 14055.00 | 90.000 | 86.790 | 6431.99 | 8173.25 | -819.49 | 8133.47 | 40°18'08.719"N | 104°23'13.953"W | 0.49 | |



Actual Wellpath Report

MUSTANG B11-23-24XRLNB AWP

Page 7 of 9



REFERENCE WELLPATH IDENTIFICATION

| | | | |
|----------|---------------------------|----------|--|
| Operator | BONANZA CREEK OIL COMPANY | Slot | SLOT#02 MUSTANG B11-23-24XRLNB (195'FNL & 483'FEL, SEC.22) |
| Area | COLORADO | Well | MUSTANG B11-23-24XRLNB |
| Field | WELD COUNTY | Wellbore | MUSTANG B11-23-24XRLNB AWB |
| Facility | SEC.22-T04N-R63W | | |

WELLPATH DATA (178 stations)

| MD [ft] | Inclination [°] | Azimuth [°] | TVD [ft] | Vert Sect [ft] | North [ft] | East [ft] | Latitude | Longitude | DLS "/(100ft) | Comments |
|------------|--------------------|----------------|-------------|-------------------|---------------|--------------|----------------|-----------------|------------------|---|
| 14144.00 | 90.060 | 87.710 | 6431.94 | 8261.50 | -815.22 | 8222.37 | 40°18'08.761"N | 104°23'12.806"W | 1.04 | |
| 14234.00 | 90.150 | 89.350 | 6431.78 | 8350.98 | -812.91 | 8312.34 | 40°18'08.783"N | 104°23'11.645"W | 1.82 | |
| 14325.00 | 90.150 | 90.650 | 6431.54 | 8441.67 | -812.91 | 8403.33 | 40°18'08.783"N | 104°23'10.470"W | 1.43 | |
| 14412.00 | 89.780 | 91.770 | 6431.59 | 8528.51 | -814.74 | 8490.31 | 40°18'08.764"N | 104°23'09.348"W | 1.36 | |
| 14504.00 | 90.220 | 91.040 | 6431.59 | 8620.35 | -817.00 | 8582.28 | 40°18'08.742"N | 104°23'08.161"W | 0.93 | |
| 14596.00 | 90.800 | 90.780 | 6430.77 | 8712.15 | -818.46 | 8674.27 | 40°18'08.727"N | 104°23'06.973"W | 0.69 | |
| 14685.00 | 90.920 | 90.670 | 6429.44 | 8800.93 | -819.59 | 8763.25 | 40°18'08.716"N | 104°23'05.825"W | 0.18 | |
| 14777.00 | 90.890 | 89.590 | 6427.98 | 8892.62 | -819.80 | 8855.24 | 40°18'08.713"N | 104°23'04.638"W | 1.17 | |
| 14869.00 | 90.490 | 88.910 | 6426.88 | 8984.20 | -818.59 | 8947.22 | 40°18'08.725"N | 104°23'03.450"W | 0.86 | |
| 14959.00 | 90.680 | 90.440 | 6425.96 | 9073.85 | -818.08 | 9037.21 | 40°18'08.730"N | 104°23'02.289"W | 1.71 | |
| 15051.00 | 91.140 | 91.590 | 6424.50 | 9165.64 | -819.71 | 9129.19 | 40°18'08.713"N | 104°23'01.102"W | 1.35 | |
| 15143.00 | 90.950 | 93.160 | 6422.82 | 9257.55 | -823.52 | 9221.09 | 40°18'08.675"N | 104°22'59.916"W | 1.72 | |
| 15322.00 | 91.020 | 95.110 | 6419.74 | 9436.51 | -836.43 | 9399.59 | 40°18'08.547"N | 104°22'57.612"W | 1.09 | |
| 15411.00 | 91.260 | 94.600 | 6417.97 | 9525.49 | -843.96 | 9488.25 | 40°18'08.472"N | 104°22'56.468"W | 0.63 | |
| 15503.00 | 90.950 | 93.740 | 6416.20 | 9617.47 | -850.65 | 9579.99 | 40°18'08.406"N | 104°22'55.284"W | 0.99 | |
| 15594.00 | 91.260 | 92.760 | 6414.44 | 9708.42 | -855.80 | 9670.82 | 40°18'08.354"N | 104°22'54.111"W | 1.13 | |
| 15685.00 | 91.110 | 91.930 | 6412.56 | 9799.32 | -859.53 | 9761.73 | 40°18'08.317"N | 104°22'52.938"W | 0.93 | |
| 15776.00 | 91.200 | 90.870 | 6410.72 | 9890.15 | -861.75 | 9852.68 | 40°18'08.295"N | 104°22'51.764"W | 1.17 | |
| 15868.00 | 91.170 | 89.910 | 6408.82 | 9981.87 | -862.38 | 9944.66 | 40°18'08.288"N | 104°22'50.577"W | 1.04 | |
| 15958.00 | 90.030 | 89.390 | 6407.88 | 10071.52 | -861.83 | 10034.65 | 40°18'08.293"N | 104°22'49.415"W | 1.39 | |
| 16050.00 | 89.970 | 89.780 | 6407.88 | 10163.15 | -861.16 | 10126.65 | 40°18'08.300"N | 104°22'48.228"W | 0.43 | |
| 16139.00 | 89.910 | 90.820 | 6407.97 | 10251.89 | -861.63 | 10215.64 | 40°18'08.295"N | 104°22'47.079"W | 1.17 | |
| 16229.00 | 89.910 | 91.710 | 6408.11 | 10341.73 | -863.61 | 10305.62 | 40°18'08.275"N | 104°22'45.918"W | 0.99 | |
| 16318.00 | 90.000 | 92.280 | 6408.18 | 10430.63 | -866.71 | 10394.57 | 40°18'08.244"N | 104°22'44.770"W | 0.65 | |
| 16407.00 | 90.060 | 92.860 | 6408.14 | 10519.57 | -870.70 | 10483.48 | 40°18'08.204"N | 104°22'43.623"W | 0.66 | |
| 16498.00 | 89.940 | 94.050 | 6408.14 | 10610.55 | -876.19 | 10574.31 | 40°18'08.149"N | 104°22'42.450"W | 1.31 | |
| 16551.00 | 90.030 | 94.880 | 6408.15 | 10663.54 | -880.31 | 10627.15 | 40°18'08.108"N | 104°22'41.768"W | 1.58 | LAST BHI MWD SURVEY/5.5'/BOTTOM HOLE (1081'FNL & 468'FEL, SEC.24, NENE) |
| 16575.00 | 90.030 | 94.880 | 6408.14 | 10687.54 | -882.35 | 10651.06 | 40°18'08.088"N | 104°22'41.460"W | 0.00 | PROJECTION TO BIT |



Actual Wellpath Report

MUSTANG B11-23-24XRLNB AWP

Page 8 of 9



REFERENCE WELLPATH IDENTIFICATION

| | | | |
|----------|---------------------------|----------|--|
| Operator | BONANZA CREEK OIL COMPANY | Slot | SLOT#02 MUSTANG B11-23-24XRLNB (195'FNL & 483'FEL, SEC.22) |
| Area | COLORADO | Well | MUSTANG B11-23-24XRLNB |
| Field | WELD COUNTY | Wellbore | MUSTANG B11-23-24XRLNB AWB |
| Facility | SEC.22-T04N-R63W | | |

TARGETS

| Name | TVD [ft] | North [ft] | East [ft] | Grid East [US ft] | Grid North [US ft] | Latitude | Longitude | Shape |
|---|-------------|---------------|--------------|----------------------|-----------------------|----------------|-----------------|---------|
| SEC.22-T04N-R63W 10.11.17 | 0.00 | 0.00 | 0.00 | 3302219.17 | 1355680.76 | 40°18'16.830"N | 104°24'58.930"W | polygon |
| SEC.23-T04N-R63W | 0.00 | 0.00 | 0.00 | 3302219.17 | 1355680.76 | 40°18'16.830"N | 104°24'58.930"W | polygon |
| SEC.24-T04N-R63W | 0.00 | 0.00 | 0.00 | 3302219.17 | 1355680.76 | 40°18'16.830"N | 104°24'58.930"W | polygon |
| MUSTANG B11-23-24XRLNB BHL (1092'FNL & 470'FEL, SEC.24) | 6403.00 | -874.07 | 10648.71 | 3312877.29 | 1354936.92 | 40°18'08.170"N | 104°22'41.490"W | point |
| MUSTANG B11-23-24XRLNB LP (1059'FNL & 589'FWL, SEC.23) | 6403.00 | -839.90 | 1075.41 | 3303304.72 | 1354854.10 | 40°18'08.530"N | 104°24'45.050"W | point |
| MUSTANG B11-23-24XRLNB LP REV-1 (1059'FNL & 460'FWL, SEC.23) | 6403.00 | -839.90 | 946.41 | 3303175.73 | 1354852.52 | 40°18'08.530"N | 104°24'46.715"W | point |
| MUSTANG B11-23-24XRLNB MID-LATERAL (1112'FNL & 0'FEL, SEC.23) | 6403.00 | -787.65 | 5765.19 | 3307993.30 | 1354963.65 | 40°18'09.040"N | 104°23'44.520"W | point |
| SEC.23/24-T04N-R63W (460'SETBACKS) | 6403.00 | 0.00 | 0.00 | 3302219.17 | 1355680.76 | 40°18'16.830"N | 104°24'58.930"W | polygon |

WELLPATH COMPOSITION - Ref Wellbore: MUSTANG B11-23-24XRLNB AWB Ref Wellpath: MUSTANG B11-23-24XRLNB AWP

| Start MD [ft] | End MD [ft] | Positional Uncertainty Model | Log Name/Comment | Wellbore |
|------------------|----------------|--|--|----------------------------|
| 17.00 | 1687.00 | Custom BHI NaviTrak (Standard Rotating) (Rockies 0.03Gt model) | BHI NAVITRAK +SR+ROCKIES <146-1687> | MUSTANG B11-23-24XRLNB AWB |
| 1687.00 | 16551.00 | Custom BHI AutoTrak Curve (Short) (Rockies 0.03Gt model) | BHI ATCURVE + SHORT+ROCKIES <1773-16551> | MUSTANG B11-23-24XRLNB AWB |
| 16551.00 | 16575.00 | Blind Drilling (std) | Projection to bit | MUSTANG B11-23-24XRLNB AWB |



Actual Wellpath Report

MUSTANG B11-23-24XRLNB AWP

Page 9 of 9



REFERENCE WELLPATH IDENTIFICATION

| | | | |
|----------|---------------------------|----------|--|
| Operator | BONANZA CREEK OIL COMPANY | Slot | SLOT#02 MUSTANG B11-23-24XRLNB (195'FNL & 483'FEL, SEC.22) |
| Area | COLORADO | Well | MUSTANG B11-23-24XRLNB |
| Field | WELD COUNTY | Wellbore | MUSTANG B11-23-24XRLNB AWB |
| Facility | SEC.22-T04N-R63W | | |

WELLPATH COMMENTS

| MD [ft] | Inclination [°] | Azimuth [°] | TVD [ft] | Comment |
|------------|--------------------|----------------|-------------|--|
| 146.00 | 0.620 | 198.620 | 146.00 | FIRST BHI MWD SURVEY |
| 6879.00 | 89.137 | 92.959 | 6402.02 | TOP (1092'FNL &494'FWL, SEC.23, NWNW) |
| 16551.00 | 90.030 | 94.880 | 6408.15 | LAST BHI MWD SURVEY/5.5"/BOTTOM HOLE (1081'FNL &468'FEL, SEC.24, NENE) |
| 16575.00 | 90.030 | 94.880 | 6408.14 | PROJECTION TO BIT |