

**TOTAL PIT VOLUME
(INCLUDES 2' FREEBOARD) 23,466 CU. YDS.**

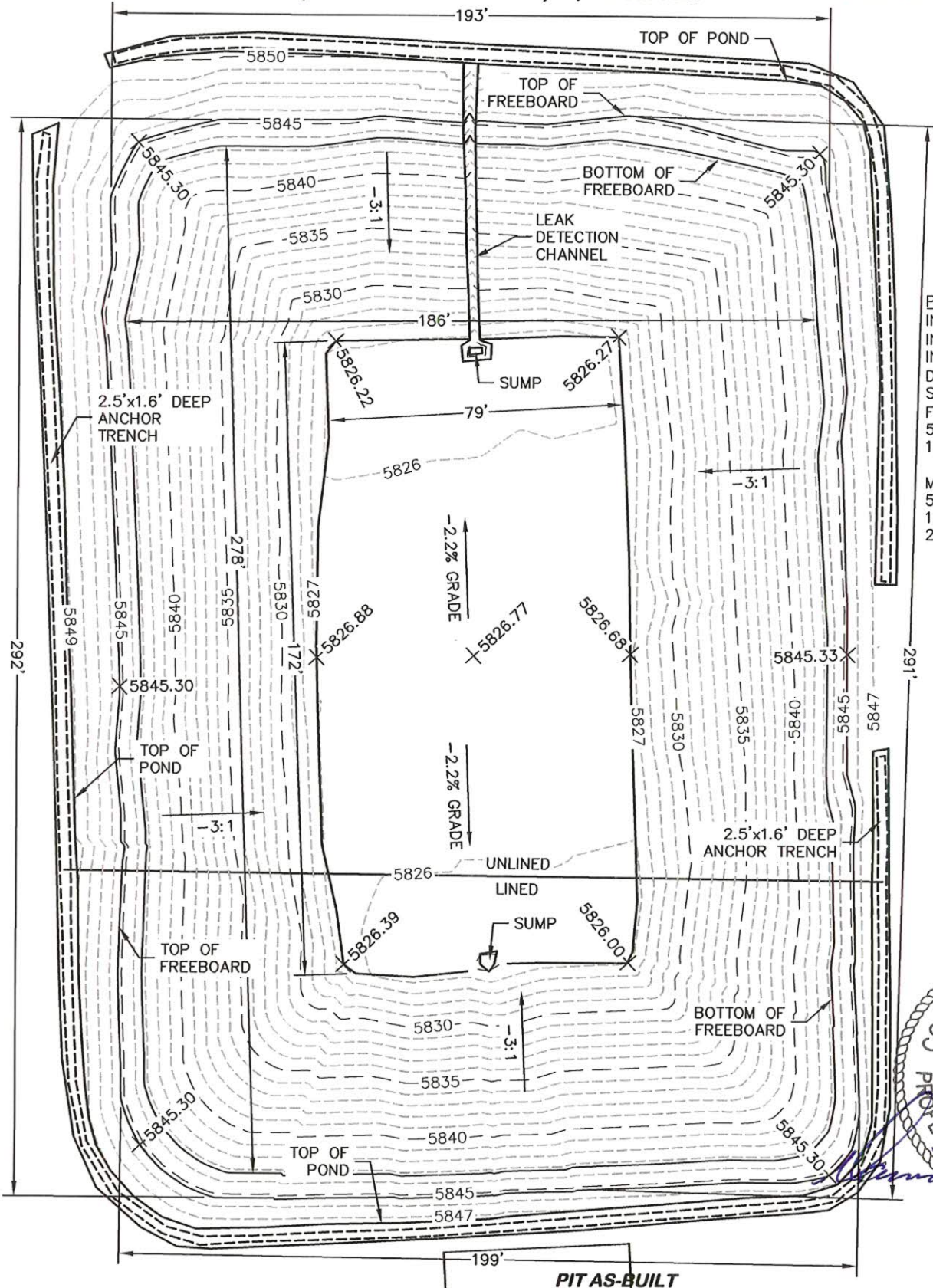

PRIMARY PIT
 INSIDE TOP: 292'±x199'±
 INSIDE BOTTOM: 172'±x79'±
 INSIDE SLOPES: 3:1
 DEPTH OF PIT: 19.0'
 SURFACE AREA AT TOP OF FREEBOARD, DEPTH: 19.0'
 58,108 SQ. FT.
 1.334± ACRES

 MAX LIQUID DEPTH: 17.0'
 51,708 SQ. FT.
 1.187± ACRES
 20,709 CU. YDS.

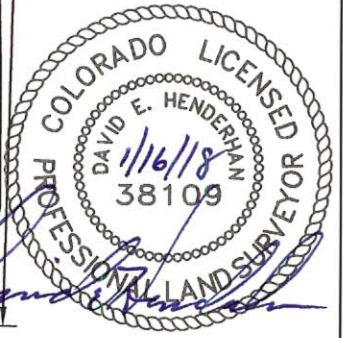

PIT AS-BUILT



RIFFIN & ASSOCIATES, INC.
 1414 ELK ST., ROCK SPRINGS, WY 82901

(307) 362-5028

DRAWN: 9/11/2014 - TCM

SCALE: 1" = 40'

REVISED: 1/16/2018 - DEH

DRG JOB No. 20347

REVIEWED AND STAMPED

FIGURE 1

OXY USA, WTP LP

POND 10

AS-BUILT

**SESW, SECTION 5, T. 7S., R97W., 6TH P.M.,
GARFIELD COUNTY, COLORADO**

**TOP OF PIT ELEVATION: 5845.3'
BOTTOM OF PIT ELEVATION: 5826.3'**