

Location Drawing

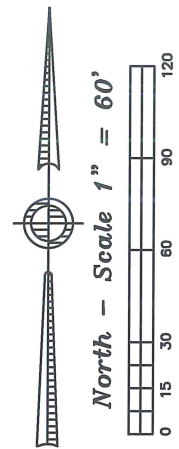
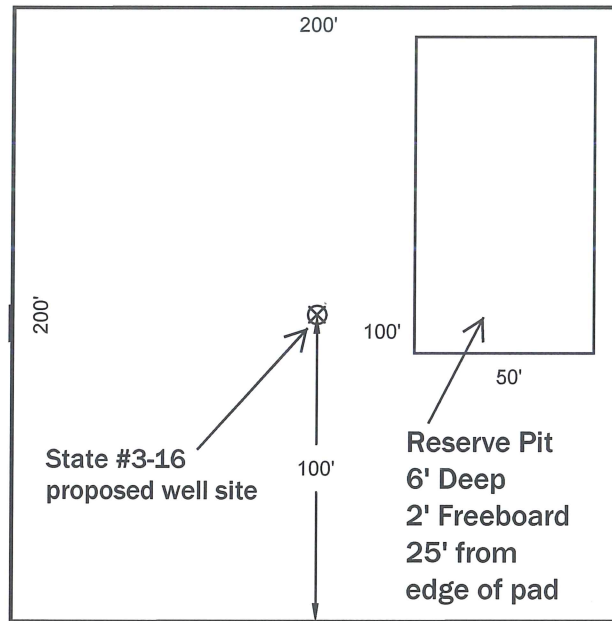

Size of location (well pad) and pit disturbance in acres: 0.9 acres
 Estimated location ground elevation: 4821' [NAVD88]

P:\Project\2017\17149\dwg\17149_Lay.dwg December 13, 2017 - 8:48am

Well Name: State #3-16	Field Date 12.11.2017	Prepared for: Project#: 17149.001 St. Croix Operating, Inc.
Section 16-T3S-R52W-6th PM, NE-NW	Party Chief DCB	
Washington County, Colorado	Proj. Manager ZNB	PLS Group 6843 North Franklin Avenue Loveland, Colorado 80538 970.669.2100 office - 970.669.3652 fax
	Drawing Date 12.13.2017	