

# Location Drawing

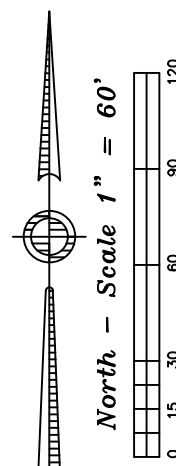
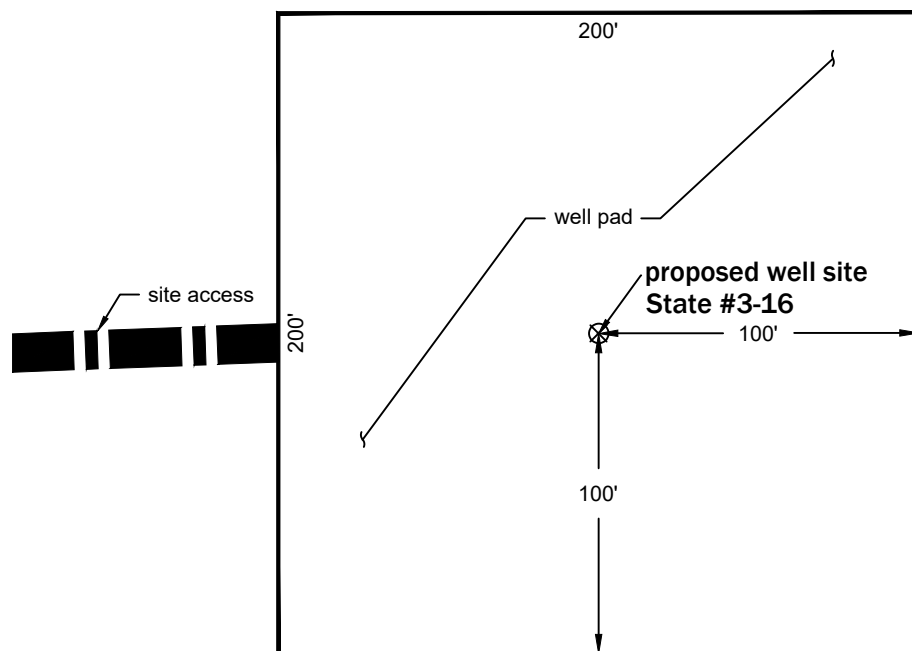

Size of location (well pad) and pit disturbance in acres: 0.9 acres  
Estimated location ground elevation: 4821' [NAVD88]

P:\Project\2017\17149\dwg\17149\_Lay.dwg December 13, 2017 - 8:46am

Well Name:  <b>State #3-16</b>	Field Date <b>12.11.2017</b>	Prepared for:  <b>St. Croix Operating, Inc.</b>	Project#: <b>17149.001</b>
	Party Chief <b>DCB</b>		
Section 16-T3S-R52W-6th PM, NE-NW	Proj. Manager <b>ZNB</b>	PLS Group 6843 North Franklin Avenue Loveland, Colorado 80538 970.669.2100 office - 970.669.3652 fax	
Washington County, Colorado	Drawing Date <b>12.13.2017</b>		