

HARLEQUIN NORTH PAD LOCATION DRAWING

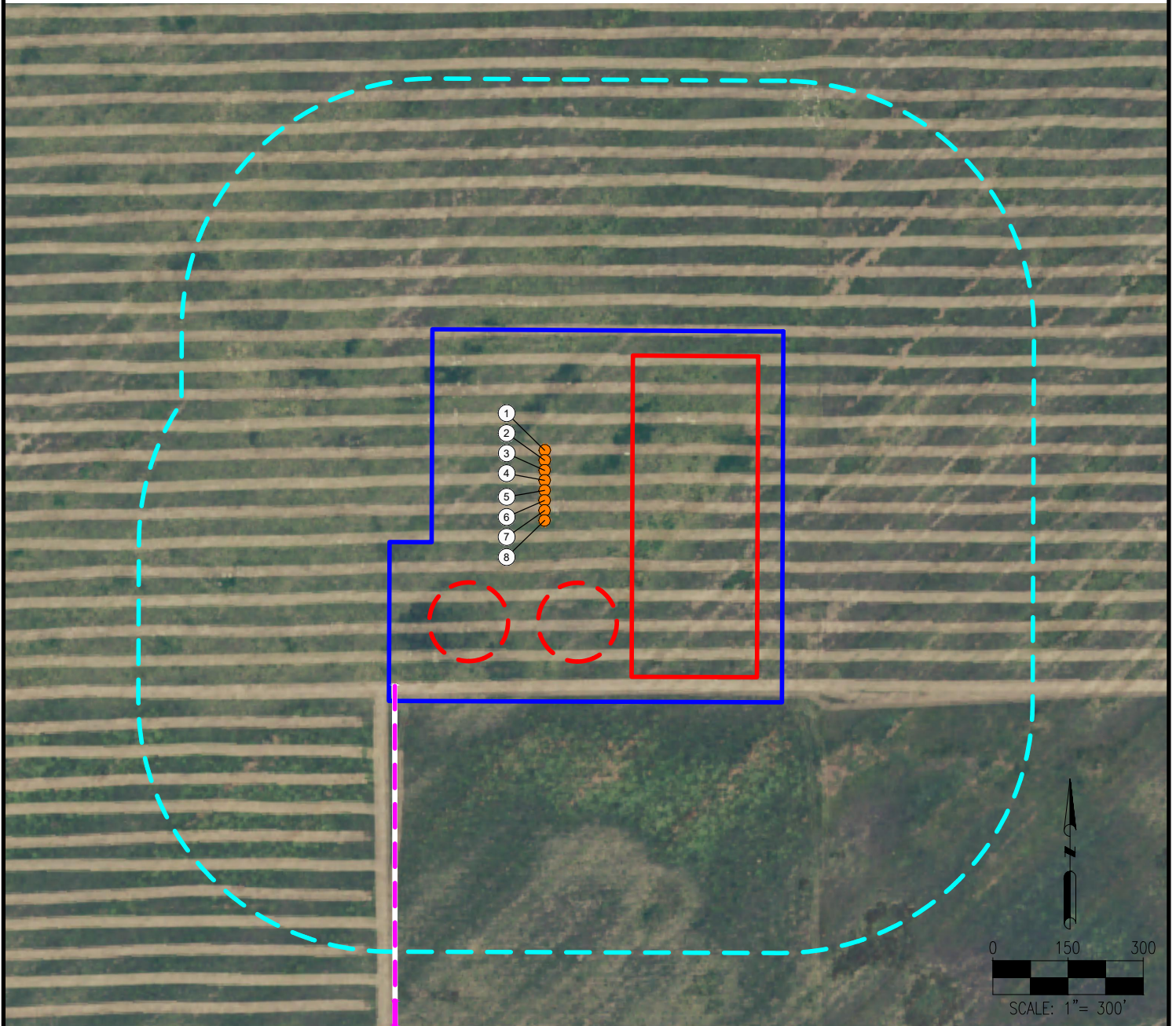





1. HARLEQUIN 33-32-1HN
2. HARLEQUIN 33-32-2HC
3. HARLEQUIN 33-32-3HN
4. HARLEQUIN 33-32-4HN
5. HARLEQUIN 33-32-5HN
6. HARLEQUIN 33-32-6HC
7. HARLEQUIN 33-32-7HN
8. HARLEQUIN 33-32-8HN

LEGEND:

● = PROPOSED WELL

--- = PROPOSED ACCESS ROAD

 = DISTURBANCE AREA
 = PROPOSED FACILITY
 = PROPOSED MLVT
 = 500' RADIUS

MEASURED FROM NEAREST WELL OR FACILITY:

BUILDING ±4311' SE
 BUILDING UNIT ±4922' NE
 PUBLIC ROAD (COUNTY ROAD 89) ±4741' W
 PROPERTY LINE (LUEKING JAMES B) ±114' E
 UTILITY (POWERLINE) +5280' N
 RAILROAD +5280' SW

MEASURED FROM NEAREST EDGE OF DISTURBANCE:
 SURFACE WATER (WETLAND) ±4981' NW

MEASURED FROM NEAREST EDGE OF DISTURBANCE:
 WATER WELL ±1751' NW SWL = 185'
 PERMIT: 232399--A RECEIPT: 0473815B

REFERENCE LOCATION

****HARLEQUIN 33-32-4HN****

LAT: 40.622056° N
 LONG: 104.203761° W
 ELEVATION: 5028'
 1232' FNL & 545' FEL
 PDOP: 1.1
 GPS OPERATOR: ALAN HNIZDO

DISCLAIMER:
 THIS PLOT DOES NOT REPRESENT A MONUMENTED LAND SURVEY AND SHOULD NOT BE RELIED UPON TO DETERMINE BOUNDARY LINES, PROPERTY OWNERSHIP OR OTHER PROPERTY INTERESTS. PARCEL LINES, IF DEPICTED HAVE NOT BEEN FIELD VERIFIED AND MAY BE BASED UPON PUBLICLY AVAILABLE DATA THAT ALSO HAS NOT BEEN INDEPENDENTLY VERIFIED.

DATA SOURCE:
 AERIAL IMAGERY: NAIP 2015
 WATER WELLS: COLORADO DWR
 NHD: USGS

PUBLICLY AVAILABLE DATA SOURCES HAVE NOT BEEN INDEPENDENTLY VERIFIED BY ASCENT.

DISTURBANCE ACREAGE:

12.5 ACRES DRILLING OPERATIONS
 7.4 ACRES INTERIM RECLAIM

CURRENT SURFACE USE: IMPROVED PASTURE
 FUTURE SURFACE USE: IMPROVED PASTURE

PREPARED FOR:



7535 Hilltop Circle
 Denver, CO 80221
 (303) 928-7128
www.ascentgeomatics.com

FIELD DATE:
 12-13-17

DRAWING DATE:
 12-14-17

BY: DJP

CHECKED: CSG

SITE NAME:
 HARLEQUIN NORTH PAD

SURFACE LOCATION:

NE 1/4 NE 1/4 SEC. 33, T8N, R61W, 6TH P.M.
 WELD COUNTY, COLORADO

