

SWMP LEGEND:

- CB - CATCH BASIN
- CD - CHECK DAM (GRAVEL)
- ECB - EROSION CONTROL BLANKET
- LS - LEVEL SPREADER
- M - CERTIFIED STRAW MULCH
- SCE - STABILIZED CONSTRUCTION ENTRANCE

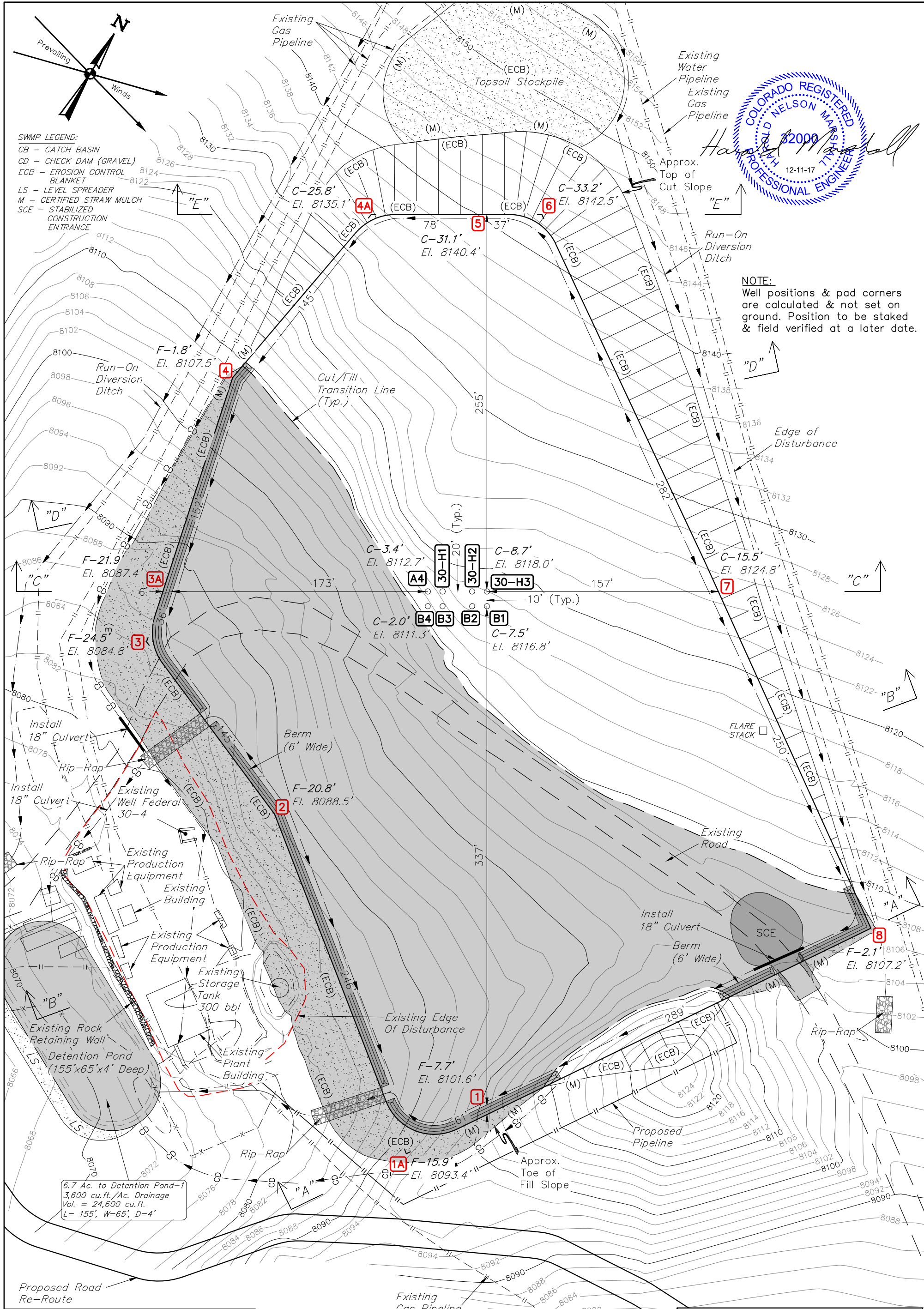

NOTE:
Well positions & pad corners are calculated & not set on ground. Position to be staked & field verified at a later date.

FINISHED GRADE ELEVATION = 8109.3'

REV: 3 12-07-17 M.D. (PAD & SHL CHANGE)

- NOTES:**
- Flare Stack is to be located a min. of 100' from the wellhead.
 - Round corners at 35' radius or as needed.
 - Contours shown at 2' intervals.
 - Cut/Fill slopes 1 1/2:1 (Typ.).
 - Production Facility to be Removed and Relocated.

Gunnison Energy LLC

TRAIL GULCH UNIT 1090 30-H1 PAD
SW 1/4 SE 1/4, SECTION 30, T10S, R90W, 6th P.M.
GUNNISON COUNTY, COLORADO



UELS, LLC
Corporate Office * 85 South 200 East
Vernal, UT 84078 * (435) 789-1017

SURVEYED BY	MARTIN PIERCE	11-03-16	SCALE
DRAWN BY	C.D.L.	03-29-17	1" = 60'

CONSTRUCTION LAYOUT FIGURE #2

6.7 Ac. to Detention Pond=1
3,600 cu.ft./Ac. Drainage
Vol. = 24,600 cu.ft.
L= 155', W=65', D=4'