

MW13

MW14

Location Map:

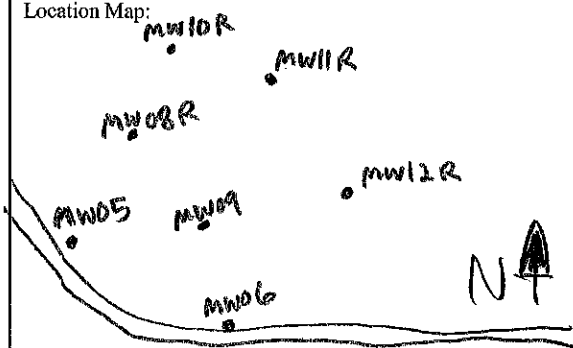

Compliance , Engineering , Remediation
 LT Environmental, Inc.
 4400 West 46th Ave.
 Denver, Colorado 80212

BORING LOG/MONITORING WELL COMPLETION DIAGRAM

Boring/Well Number:	MW08R	Project:	Anderson 12-27/ Bohlander 1-27
Date:	2-18-11	Project Number:	KMB-OS162
Logged By:	Chris Roy	Drilled By:	ACI
Drilling Method:	Direct Push	Sampling Method:	Continuous
Seal:	Bentonite	Grout:	Concrete
Diameter:	Length:	Hole Diameter:	Depth to Liquid:
		2.25"	11'
Diameter:	Length:	Total Depth:	Depth to Water:
		30'	24'

Penetration Resistance	Moisture Content	Vapor (ppm)	Staining	Sample #	Depth (ft. bgs.)	Sample Run	Soil/Rock Type	Lithology/Remarks	Well Completion
	dry			NA	0			0'-7' Fine Sand, Tan, Trace Silt, Dry, No stain, No odor	
		0.7			2				
					4	S'			
					6			7'-11' Clayey Silt, Brown, Dry, No stain, No odor, Low plasticity, Moderately cohesive	
		0.1			8	S'			
					10				
	moist	0.4			12	S'		11'-14' M-F Sand, Light Brown, Moist, No stain, No odor	
					14				
					16			14'-28' Clayey Sand and Gravel, Black, odor, moist, red cohesive, crumbly, No plasticity, wet @ 24'	
		1781			18	S'			
					20				
		2716			22	S'			
	wet				24				
					26				
		1109			28	S'		28'-30' Clay, Stained, odor, wet, very cohesive, high plasticity	
					30				

See MW08R



**Compliance , Engineering , Remediation
LT Environmental, Inc.
4400 West 46th Ave.
Denver, Colorado 80212**

Boring/Well Number: MW10R	Project: Anderson 12-27/ Bohlander 1-27
Date: 2-18-11	Project Number: KMG 05162
Logged By: Chris Roy	Drilled By: ACI

Elevation:	Detector:	Drilling Method:	Sampling Method:
	MiniRae 2000 PID	Direct Push	Continuous
Gravel Pack:	Seal:	Grout:	
	Bentonite	Concrete	
Casing Type:	Diameter:	Length:	Hole Diameter:
			2.25"
Screen Type:	Slot:	Diameter:	Depth to Liquid:
			NM
			Depth to Water:
			NM

Penetration Resistance	Moisture Content	Vapor (ppm)	Staining	Sample #	Depth (ft. bgs.)	Sample Run	Soil/Rock Type	Lithology/Remarks	Well Completion
					0			Not sampled	
					2				
					4				
					6				
					8				
					10				
					12				
					14				
					16				
					18				
					20				
					22				
					24				
					26				
					28				
					30				

Location Map:

See MW08R



Compliance , Engineering , Remediation
LT Environmental, Inc.
4400 West 46th Ave.
Denver, Colorado 80212

BORING LOG/MONITORING WELL COMPLETION DIAGRAM

Boring/Well Number: MW11R	Project: Anderson 12-27/ Bohlender 1-27
Date: 2-18-11	Project Number: KMG 05162
Logged By: Chris Roy	Drilled By: ACT
Elevation:	Detector: MiniRae 2000 PID
Gravel Pack:	Drilling Method: Direct Push
Casing Type:	Seal: Bentonite
Screen Type:	Grout: Concrete
Slot:	Sampling Method: Continuous
Diameter:	Hole Diameter: 2.25"
Length:	Depth to Liquid: NM
	Total Depth: 30'
	Depth to Water: NM

Penetration Resistance	Moisture Content	Vapor (ppm)	Staining	Sample #	Depth (ft. bgs.)	Sample Run	Soil/Rock Type	Lithology/Remarks	Well Completion
					0			Not sampled	Flush
					2				
					4				
					6				
					8				
					10				
					12				
					14				
					16				
					18				
					20				
					22				
					24				
					26				
					28				
					30				

Location Map:

See
MW08R



Compliance , Engineering , Remediation
LT Environmental, Inc.
4400 West 46th Ave.
Denver, Colorado 80212

BORING LOG/MONITORING WELL COMPLETION DIAGRAM

Boring/Well Number: **MW 12R** Project: **Anderson 12-27 / Bohlander 1-27**
Date: **2-18-11** Project Number: **KMG-05162**
Logged By: **Chris Roy** Drilled By: **ACI**

Elevation: Detector: **MiniRae 2000 PID** Drilling Method: **Direct Push** Sampling Method: **Continuous**
Gravel Pack: Seal: **Bentonite** Grout: **Concrete**
Casing Type: Diameter: Length: Hole Diameter: **2.25"** Depth to Liquid: **NM**
Screen Type: Slot: Diameter: Length: Total Depth: **30'** Depth to Water: **NM**

Penetration Resistance	Moisture Content	Vapor (ppm)	Staining	Sample #	Depth (ft. bgs.)	Sample Run	Soil/Rock Type	Lithology/Remarks	Well Completion
					0			Not Sampled	Flush
					2				
					4				
					6				
					8				
					10				
					12				
					14				
					16				
					18				
					20				
					22				
					24				
					26				
					28				
					30				

Location Map:

See MWOBR



Compliance , Engineering , Remediation
LT Environmental, Inc.
4400 West 46th Ave.
Denver, Colorado 80212

BORING LOG/MONITORING WELL COMPLETION DIAGRAM

Boring/Well Number: MW13 Project: Anderson 12-27 /
Pohlender 1-27

Date: 2-18-11 Project Number: KMG 05162

Logged By: Chris Roy Drilled By: ACI

Elevation: Detector: MiniRae 2000 PID Drilling Method: Direct Push Sampling Method: Continuous

Gravel Pack: Seal: Bentonite Grout: Concrete

Casing Type: Diameter: Length: Hole Diameter: 2.25" Depth to Liquid: NM

Screen Type: Slot: Diameter: Length: Total Depth: 30' Depth to Water: NM

Penetration Resistance	Moisture Content	Vapor (ppm)	Staining	Sample #	Depth (ft. bgs.)	Sample Run	Soil/Rock Type	Lithology/Remarks	Well Completion
					0			Not Sampled	
					2				
					4				
					6				
					8				
					10				
					12				
					14				
					16				
					18				
					20				
					22				
					24				
					26				
					28				
					30				

Location Map:

See MW08R



Compliance , Engineering , Remediation
LT Environmental, Inc.
4400 West 46th Ave.
Denver, Colorado 80212

BORING LOG/MONITORING WELL COMPLETION DIAGRAM

Boring/Well Number: MW14	Project: Anderson 12-271 Boulder 1-27
Date: 2-18-11	Project Number: KMG05162
Logged By: Chris Roy	Drilled By: ACI
Elevation:	Drilling Method: Direct Push
Detector: MiniRae 2000 PID	Sampling Method: Continuous
Gravel Pack:	Seal: Bentonite
	Grout: Concrete
Casing Type:	Diameter: Length:
	Hole Diameter: 2.25"
	Depth to Liquid: 17'
Screen Type:	Slot: Diameter: Length:
	Total Depth: 30'
	Depth to Water: 24'

Penetration Resistance	Moisture Content	Vapor (ppm)	Staining	Sample #	Depth (ft. bgs.)	Sample Run	Soil/Rock Type	Lithology/Remarks	Well Completion
	dry	0.4		NA	0			0'-5' Fine Sand, Tan Dry, No stain, No odor	
					2	5'			
					4			5'-17' Clayey Silt, Brown Dry, No stain, No odor, slightly cohesive, low plasticity	
		0.5			6				
					8	5'			
					10				
		0.1			12	5'		17'-20' Fine Sand, Dark Brown, Moist, No stain, No odor	
					14				
					16			20'-24' Silty Clay, Light Brown, No stain, No odor, soft, cohesive, med plasticity, moist	
		0.4			18	5'			
					20				
					22	5'			
					24	5'		24'-29' clayey silt, Some Sand and Gravel, Black, odor, cohesive, med plasticity, wet	
		346.5			26				
					28	5'		29'-30' clayey silt, Brown, soft, wet, very plastic, cohesive, no stain, no odor	
		177.4			30				

Location Map:

MW15
⊗MW16
⊗

N ↑

MW14
⊗MW17
⊗

Compliance | Engineering | Remediation
 LT Environmental, Inc.
 4400 West 46th Ave.
 Denver, Colorado 80212

BORING LOG/MONITORING WELL COMPLETION DIAGRAM

Boring/Well Number:

MW15

Project:

Anderson 12-27,
Bohlender 1-27

Date:

6-21-11

Project Number:

05/62

Logged By:

Chris Roy

Drilled By:

ACI

Elevation:

Detector:

MiniRae 2000 PID

Drilling Method:

Direct Push

Sampling Method:

Continuous

Gravel Pack:

Silica Sand

Seal:

Bentonite

Grout:

Concrete

Casing Type:

PVC

Diameter:

1"

Length:

10'

Hole Diameter:

2.25"

Depth to Liquid:

18.5'

Screen Type:

PVC

Slot:

0.020

Diameter:

1"

Length:

20'

Total Depth:

30'

Depth to Water:

25'

Penetration Resistance	Moisture Content	Vapor (ppm)	Staining	Sample #	Depth (ft. bgs.)	Sample Run	Soil/Rock Type	Lithology/Remarks	Well Completion
	dry			NA	0			0'-2.5' Silty Sand, Dark Brown, Dry, No stain, No odor	FLUSH
low		14.6			2	5'		2.5'-6' Sandy Silt, Light Brown, Dry, No stain, No odor	
					4				
low		14.3			6	5'		6'-11' Silty & Fine Sandy Clay, Brown, Dry, No stain, No odor, Med Plasticity, Med. Cohesiveness, Silt	
					8				
med-High		16.2			10	5'		11'-17' Clayey Fine Sand, Brown, Dry, No stain, No odor, soft	
					12				
med-High	moist	16.2			14	5'		17'-27' Coarse Sandy Clay, Tan-Brown, moist @ 18.5', No stain, No odor, Low Plasticity, Low Cohesiveness, soft, wet @ 25'	
					16				
med-High		1.8			18	5'		27'-30' Gravelly Sand, Black stained w/ odor, wet	
					20				
med-High		208			22	5'			
					24				
					26				
					28	5'			
					30				

Location Map:



Compliance | Engineering | Remediation
 LT Environmental, Inc.
 4400 West 46th Ave.
 Denver, Colorado 80212

See MW15

BORING LOG/MONITORING WELL COMPLETION DIAGRAM

Boring/Well Number: MW16 Project: Anderson 12-27,
 Bohlander 1-27
 Date: 6-21-2011 Project Number: KMG 05162
 Logged By: Chris Roy Drilled By: ACI

Elevation: Detector: MiniRae 2000 PID

Drilling Method: Direct Push Sampling Method: Continuous

Gravel Pack: Silica sand

Seal: Bentonite

Grout: Concrete

Casing Type: PVC

Diameter: 1" Length: 10'

Hole Diameter: 2.25" Depth to Liquid: 18'

Screen Type: PVC Slot: 0.020

Diameter: 1" Length: 20'

Total Depth: 30' Depth to Water: 20'

Penetration Resistance	Moisture Content	Vapor (ppm)	Staining	Sample #	Depth (ft. bgs.)	Sample Run	Soil/Rock Type	Lithology/Remarks	Well Completion
									FLUSH
	dry			NA	0			0'-17' Silty Sand, Brown, Dry, No stain, No odor.	
Low		15.6			2	5'			
					4			17'-20' Silty & Gravelly Clay, Brown, Moist @ 18', No stain, No odor, Slight Plasticity, Slight cohesive, soft	
Low		11.3			6				
					8	5'			
					10				
Med		17.1			12			20'-28' Clayey silt, Brown, wet @ 20', stained @ 24.5', soft, med Plasticity, Med Cohesiveness, odor @ 24.5'	
					14	5'			
					16				
Med-High	moist	15.5			18	5'			
					20				
Med-High	wet	12.9			22	5'		28'-30' Gravelly sand, wet, stained Black w/ odor	
					24				
					26				
High		9.73			28	5'			
					30				

Location Map:

See MW15



Compliance , Engineering , Remediation
LT Environmental, Inc.
4400 West 46th Ave.
Denver, Colorado 80212

BORING LOG/MONITORING WELL COMPLETION DIAGRAM

Boring/Well Number: MW17	Project: Anderson 12-27 Bohlender 1-27
Date: 6-21-11	Project Number: KMG 05162
Logged By: Chris Roy	Drilled By: ACI
Elevation:	Drilling Method: Direct Push
Detector: MiniRae 2000 PID	Sampling Method: Continuous
Gravel Pack: silica sand	Seal: Bentonite
Casing Type: PVC	Grout: Concrete
Screen Type: PVC	Diameter: 1" Length: 10'
Slot: 0.020	Hole Diameter: 2.25"
Diameter: 1" Length: 20'	Depth to Liquid: NM
	Total Depth: 30'
	Depth to Water: NM

Penetration Resistance	Moisture Content	Vapor (ppm)	Staining	Sample #	Depth (ft. bgs.)	Sample Run	Soil/Rock Type	Lithology/Remarks	Well Completion
					0			Not Sampled	FLUSH
					2				
					4				
					6				
					8				
					10				
					12				
					14				
					16				
					18				
					20				
					22				
					24				
					26				
					28				
					30				

Location Map:



Compliance, Engineering, Remediation
LT Environmental, Inc.
4400 West 46th Ave.
Denver, Colorado 80212

see MW01/MW08R

BORING LOG/MONITORING WELL COMPLETION DIAGRAM

Boring/Well Number: **MW09R** Project: **Anderson 12-29 / Bohlender 1-27**

Date: **1/12/12** Project Number: **KMG 05162**

Logged By: **Andy Verbonitz** Drilled By: **ACI**

Elevation: _____ Detector: **MiniRae 2000 PID** Drilling Method: **GeoProbe Direct Push** Sampling Method: **Continuous**

Gravel Pack: **sand** Seal: **Bentonite** Grout: _____

Casing Type: **PVC** Diameter: **1"** Length: **10'** Hole Diameter: **2.25"** Depth to Liquid: _____

Screen Type: **PVC** Slot: **0.010** Diameter: **1"** Length: **20'** Total Depth: **30'** Depth to Water: _____

Penetration Resistance	Moisture Content	Vapor (ppm)	Staining	Sample #	Depth (ft. bgs.)	Sample Run	Soil/Rock Type	Lithology/Remarks	Well Completion
					0				Flush
					2			not sampled	
					4				
					6				
					8				
					10				
					12				
					14				
					16				
					18				
					20				
					22				
					24				
					26				
					28				
					30				

Location Map:

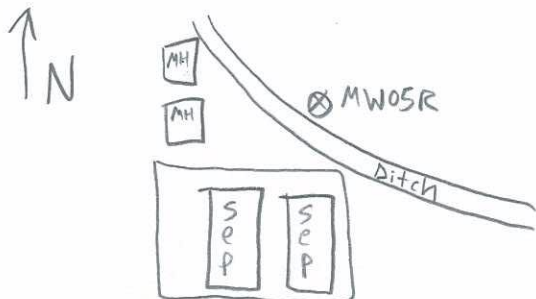

Compliance « Engineering « Remediation
LT Environmental, Inc.
 4600 W. 60th Avenue
 Arvada, Colorado 80003

BORING LOG/MONITORING WELL COMPLETION DIAGRAM

Boring/Well Number: MW05R		Project: Anderson 12-27 Bohlender 1-27	
Date: 5/14/14		Project Number: KMG05162	
Logged By: D. Burns		Drilled By: High Plains Drilling	
Drilling Method: Direct Push		Sampling Method: Continuous	
Seal: Bentonite chips		Grout: NA	
Diameter: 1"	Length:	Hole Diameter: 2.25"	Depth to Liquid:
Diameter: 1"	Length: 10'	Total Depth: 33'	Depth to Water: 29'

Penetration Resistance	Moisture Content	Vapor (ppm)	Staining	Sample #	Depth (ft. bgs.)	Sample Run	Soil/Rock Type	Lithology/Remarks	Well Completion
					0			Potholed	Flush Mount
					2			No Recovery	
					4				
					6				
	Moist	Ø	No		8			Brown clayey sand No s/o	
					10				
	Moist	Ø	No		12			" " No s/o	
					14				
	Moist	2.4	Yes		16			- Black/dark gray clayey med. sand mod stain	
					18			slight odor. Sour smell.	
	Moist	2.6	Yes		20			Dark gray/black clayey sand	
					22			- Black med sand, strong s/o	
	Moist	678	Yes		24			Gray/Olive sand, med-coarse, mod s/o	
		1,874	Yes		26			" " strong s/o	
	Moist	6,766	Yes		28			- Gray gravelly sand w/ fines, strong s/o	
	Dry	5,473	Yes		30			- Black sand + gravel, strong s/o	
	Wet	1,850							
	moist	3,969	Yes		32			30-32 Gray/Olive fn. sandy clay, mod. s/o	
	moist/dry	35	NO		34			32-34 olive to Brown clay slight s/o	

Location Map:

↑N

⊗ MW08R2



Compliance « Engineering « Remediation
LT Environmental, Inc.
 4600 W. 60th Avenue
 Arvada, Colorado 80003

BORING LOG/MONITORING WELL COMPLETION DIAGRAM

Boring/Well Number:	MW08R2	Project:	Anderson 12-27 Bohlender 1-27
Date:	5/14/14	Project Number:	KMG05162
Logged By:	D. Burns	Drilled By:	High Plains Drilling
Drilling Method:	Direct Push	Sampling Method:	Continuous
Gravel Pack:	10-20 Silica Sand	Seal:	Bentonite chips
Casing Type:	Sch 40 PVC	Grout:	NA
Screen Type:	Sch 40 PVC	Diameter:	1"
Slot:	0.010"	Length:	15'
		Hole Diameter:	2.25"
		Depth to Liquid:	
		Total Depth:	33'
		Depth to Water:	29'

Penetration Resistance	Moisture Content	Vapor (ppm)	Staining	Sample #	Depth (ft. bgs.)	Sample Run	Soil/Rock Type	Lithology/Remarks	Well Completion
					0			Potholed	
					2			No Recovery	
					4				
					6				
					8			Brown sandy clay, no s/o	
					10			" "	
	Dry	Ø			12			Brown med. sand no s/o	
		Ø			14			" "	
	Dry				16			Brown med-coarse sand/gravel, no s/o	
		Ø			18			" "	
	Dry	369	yes		20			Black gravelly sand, cobbles, slight s/o	
		178			22			Gray/olive fn. sandy clay, mod s/o	
	Dry	886	yes		24			Unconsolidated gravelly sand w/fines, dark gray + black mod. s/o	
					26			clayey gravelly sand	
	Dry	1,073	yes		28			gravelly sand w/fines	
	v. moist				30			Olive gray clayey fn. sand. mod s/o	
	moist	243	yes						
			slight		32			-32-34 Brown sandy clay no s/o	
	Moist	17.3	No		34				

Location Map:

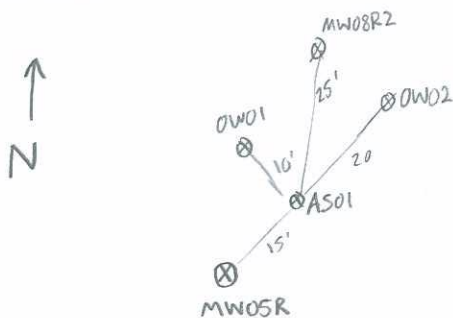

Compliance « Engineering « Remediation
LT Environmental, Inc.
 4600 W. 60th Avenue
 Arvada, Colorado 80003

BORING LOG/MONITORING WELL COMPLETION DIAGRAM

Boring/Well Number:	OW 01	Project:	Anderson 12-27 Bohlender 1-27	
Date:	5/14/14	Project Number:	KMG05162	
Logged By:	D. Burns	Drilled By:	High Plains Drilling	
Drilling Method:	Direct Push	Sampling Method:	Continuous	
Seal:	Bentonite chips	Grout:	NA	
Diameter:	Length:	Hole Diameter:	2.25"	Depth to Liquid:
1"				
Diameter:	Length:	Total Depth:	33'	Depth to Water:
1"	10'			27'

Penetration Resistance	Moisture Content	Vapor (ppm)	Staining	Sample #	Depth (ft. bgs.)	Sample Run	Soil/Rock Type	Lithology/Remarks	Well Completion
					0			Pot holed	Flush Maint
					2			No Recovery	
					4				
					6				
	Dry	Ø			8			Brown clayey sand. No s/o	
					10			" "	
	Dry	Ø			12			Brown med. sand, No s/o	
					14			Brown med.-coarse sand No s/o	
	Dry				16				
	Dry	Ø			18			" "	
					20			Gray gravelly sand	
	Dry	284	yes		22			Black gravelly sand mod. s/o	
	Barely Moist	1,553	yes		24			Dark gray clayey fn. sand mod. s/o	
		1,789			26			Olive clayey sand mod. s/o	
	Moist	3,448	yes		28			Gray gravelly sand mod. s/o	
	V. moist wet	2,645	yes		30			Gray olive fn.-med sand mod. s/o	
	Barely Moist	265	yes		32			Olive fn. med. sandy clay mod. s/o	
			slight		34			-31-34 Olive/grayish brown v. fn. sandy clay, slight s/o	

Location Map:

↑ N

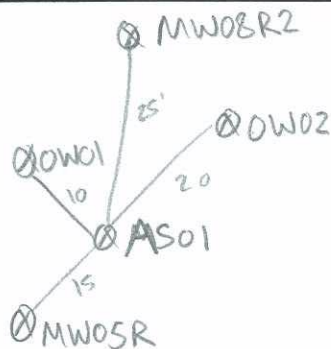

Compliance « Engineering « Remediation
LT Environmental, Inc.
 4600 W. 60th Avenue
 Arvada, Colorado 80003

BORING LOG/MONITORING WELL COMPLETION DIAGRAM

Boring/Well Number: OW02 Project: Anderson 12-27 Bohlender 1-27

Date: 5/14/14 Project Number: KMG05162

Logged By: D. Burns Drilled By: High Plains Drilling

Drilling Method: Direct Push Sampling Method: Continuous

Gravel Pack: 10-20 Silica Sand Seal: Bentonite chips Grout: NA

Casing Type: Sch 40 PVC Diameter: 1" Length: Hole Diameter: 2.25" Depth to Liquid:

Screen Type: Sch 40 PVC Slot: 0.010" Diameter: 1" Length: 10' Total Depth: 33' Depth to Water: 29'

Penetration Resistance	Moisture Content	Vapor (ppm)	Staining	Sample #	Depth (ft. bgs.)	Sample Run	Soil/Rock Type	Lithology/Remarks	Well Completion
					0			Potholed	Flush Mount
					2			No Recovery	
					4				
					6				
	Dry				8			Brown clayey sand No s/o	
	Dry				10				
	Moist				12			Brown med. coarse sand No s/o	
					14			Brown med sand	
					16				
	Dry	98.7			18			Gray/Black gravelly sand w/cobbles, mod s/o	
		718	yes		20			" " strong s/o, sour smell	
	Dry				22				
	Moist	1,347			24			Gray Olive med fn sand, mod s/o	
		2,666	yes		26			Gray gravelly sand w/fines, clay mod s/o	
	Moist	1,339			28			Gray Olive sandy clay Mod s/o	
		2,281	yes		30			1" gravel layer @ 30'	
	Wet	350	yes		32			32-33 Gray sandy clay w/gravel, slight s/o	
			slight		34			33-34 Brown med. fn sandy clay no s/o	

Moist 203

37

Location Map:



Q MW14

SB01

Q MW17

Q MW11R



Compliance « Engineering » Remediation
LT Environmental, Inc.
 4600 W. 60th Avenue
 Arvada, Colorado 80003

BORING LOG/MONITORING WELL COMPLETION DIAGRAM

Boring/Well Number:	SB01			Project:	Anderson 12-27 Bohlender 1-27		
Date:	5/14/15			Project Number:	KMG05162		
Logged By:	D. Burns			Drilled By:	High Plains Drilling		
Drilling Method:	Direct Push			Sampling Method:	Continuous		
Gravel Pack:	10-20 Silica Sand			Seal:	Bentonite chips		
Casing Type:	Sch 40 PVC			Grout:	NA		
Screen Type:	Sch 40 PVC			Diameter:	1"	Hole Diameter:	2.25"
Slot:	0.010"			Length:	—		Depth to Liquid:
				Diameter:	1"	Total Depth:	33'
						Depth to Water:	29'

Penetration Resistance	Moisture Content	Vapor (ppm)	Staining	Sample #	Depth (ft. bgs.)	Sample Run	Soil/Rock Type	Lithology/Remarks	Well Completion
					0			Potholed	
					2			No Recovery	
					4				
					6				
	Dry	Ø	No		8			Brown clayey med. fn. sand. No s/o	
					10				
	Moist	Ø	No		12			Brown fn-med sand, No s/o	
					14				
	Moist	Ø	No		16			Brown clayey fn. sand. No s/o	
					18			gravelly sand w/ fines	
					20			Gray gravelly sand w/ fines, slight s/o	
	Moist	22.7	Slight	X	22			darker gray gravelly sand w/ fines mod s/o	
		686	yes	X	24			gray/olive unconsolidated gravelly sand/fines mod s/o	
	Moist	1,198	yes	X	26				
		478	yes	X	28			Dark gray/olive clayey fn. sand, mod s/o	
	Slightly wet	94.9	Slight	X	30				
					32				
					34				

61.2 No

31.5-33 Olive fn. sand w/ gravel + fines slight s/o

33-34 Brown clayey fn. sand no s/o

Location Map:



Compliance « Engineering « Remediation
LT Environmental, Inc.
 4600 W. 60th Avenue
 Arvada, Colorado 80003

BORING LOG/MONITORING WELL COMPLETION DIAGRAM

Boring/Well Number:	MW18	Project:	Anderson 12-27 Bohlender 1-27
Date:	5/15/14	Project Number:	KMG05162
Logged By:	D. Burns	Drilled By:	High Plains Drilling
Drilling Method:	Direct Push	Sampling Method:	Continuous
Gravel Pack:	10-20 Silica Sand	Seal:	Bentonite chips
Casing Type:	Sch 40 PVC	Grout:	NA
Screen Type:	Sch 40 PVC	Diameter:	1"
Slot:	0.010"	Length:	19'
		Hole Diameter:	2.25"
		Depth to Liquid:	
		Total Depth:	29'
		Depth to Water:	26'

Penetration Resistance	Moisture Content	Vapor (ppm)	Staining	Sample #	Depth (ft. bgs.)	Sample Run	Soil/Rock Type	Lithology/Remarks	Well Completion
					0			Potholed	Flush Mount
					2			No Recovery	
					4				
					6				
	Dry	Ø	No		8			Brown sand clay. No s/o	
	Dry	Ø	No		10			Brown clayey sand. No s/o	
					12			Brown med sand No s/o	
	Dry	Ø	No		14			" " No s/o	
	Moist	Ø	No		16				
	Moist	Ø	No		18			Gravelly sand, No s/o	
					20			Brown clayey sand No s/o	
	Moist	Ø	No		22			Gravelly sand w/ fines No s/o	
					24			Gray/olive staining, gravelly sand w/ fines	
	Moist	107.6	yes		26			Brown clayey sand, slight s/o	
	Moist	38.9	slight		28			Black gravel/sand, unconsolidated, fines, strand s/o	
	Dry				30			Dark gray/olive fn sand w/ gravel, strong s/o	
	Wet	175	yes					Gray/Brown sand/gravel, slight s/o	
	Wet							Brown fn. sandy clay, no s/o	
	Moist	17.3	slight						
			No						

Well Location Sketch:

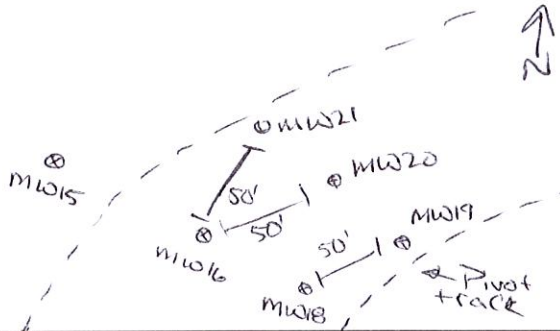

Compliance • Engineering • Remediation

LT Environmental, Inc.

4600 W. 60th Avenue

Arvada, Colorado 80003

BORING LOG/MONITORING WELL COMPLETION DIAGRAM

Boring/Well Number:	MW19	Project:	Anderson 12-27 Bollender 1-7
Date:	10/16/16	Project Number:	142
Logged By:	Kris Shepherd	Drilled By:	Drill Pro

Elevation:	Detector:	PID	Drilling Method:	Direct Push	Sampling Method:	Continuous
Gravel Pack:	Silica Sand		Seal:	Bentonite	Grout:	-
Casing Type:	PVC		Diameter:	1"	Length:	10'
Screen Type:	Slot:		Diameter:	1"	Length:	20'
PVC	0.01				Total Depth:	30'
					Depth to Liquid:	-
					Depth to Water:	~19'

Penetration Resistance	Moisture Content	Vapor (ppm)	Staining	Sample #	Depth (ft. bgs.)	Sample Run	Recovery	Soil/Rock Type	Lithology/Remarks	Well Completion Diagram
					0					
					2				Hydrovac, Not Logged	
					4					
					6					
	Moist	0.0	none		8	2'	2'		6' → 11.75' silty, clayey fg sand, brown, no odor, no stain, moist	
		0.1			10	4'	4'		11.75' → 17' fg → coarse sand, tan, no odor, no stain, moist	
		0.0			12				→ trace angular gravels 15' → 17'	
		0.0			14	4'	2'		17' → 19' sandy clay, brown, low cohesion, low plasticity, no odor, no stain, moist	
		0.0			16					
		0.2			18	4'	4'		19' → 23' clayey fg → coarse sand, brown, no odor, no stain, wet	
		0.1			20				23' → 27' fg → coarse sand, trace gravels, trace clay, brown/red, wet	
		0.1			22	4'	4'		27' → 30' fg sandy clay, olive, mod cohesion, mod. plasticity, no odor, no stain, wet	
		0.3			24					
		0.1			26	4'	4'			
		0.1			28					
		0.1			30	2'	2'			
					32					
					34					
					36					
					38					
					40					

- flush mount

Well Location Sketch:



Compliance • Engineering • Remediation

LT Environmental, Inc.

4600 W. 60th Avenue

Arvada, Colorado 80003

BORING LOG/MONITORING WELL COMPLETION DIAGRAM

Boring/Well Number:

MW20

Project:

Andersen 12-27/Bowland 1-27

Date:

10/19/2015

Project Number:

142

Logged By:

Kris Shepherd

Drilled By:

Drill Pro

Elevation:

Detector:

PID

Drilling Method:

Direct Push

Sampling Method:

Continuous

Gravel Pack:

Silica Sand

Seal:

Bentonite

Grout:

-

Casing Type:

PVC

Diameter:

1"

Length:

10'

Hole Diameter:

3"

Depth to Liquid:

-

Screen Type:

PVC

Slot:

0.01

Diameter:

1"

Length:

20'

Total Depth:

30'

Depth to Water:

~22'

Penetration Resistance	Moisture Content	Vapor (ppm)	Staining	Sample #	Depth (ft. bgs.)	Sample Run	Recovery	Soil/Rock Type	Lithology/Remarks	Well Completion Diagram
					0					
					2				Hydrovac, Not Logged	
					4					
					6					
	Moist	0.5	none		8	2'	2'		6' → 11.5' silty, clayey, fg sand, brown, no odor, no stain, moist	
		0.6			10	4'	4'		→ 3" sandy clay stringer @ 10.5', brown, no odor/stain, mod. cohesion, mod. plasticity, moist	
		0.2			12					
		0.4			14	4'	4'		11.5' → 15.5' fg → Mg sand, brown, no odor, no stain, moist	
		0.3			16				→ trace gravel 14.5' → 15'	
		0.3			18	4'			15.5' → 22' v. sandy clay, light brown, no odor, no stain, low cohesion, low plasticity, moist	
		0.2			20				→ 1" fg → coarse sand stringer @ 18', brown, no odor/stain, moist	
	Wet	1.4	Stain		22	4'	4'		22' → 25.5' fg → coarse sand, black, odor, wet	
		60.4			24				25.5' → 27' silty clay, gray, odor, low cohesion, low plasticity, wet	
		205			26	4'	4'		27' → 30' gravelly fg → coarse sand, black stain + odor, wet	
		607			28					
		126			30	2'	2'			
					32					
					34					
					36					
					38					
					40					

NOTES:

Page ____ of ____

Well Location Sketch:



Compliance • Engineering • Remediation

LT Environmental, Inc.

4600 W. 60th Avenue

Arvada, Colorado 80003

BORING LOG/MONITORING WELL COMPLETION DIAGRAM

Boring/Well Number:

MW 21

Project:

Anderson 12-27/Baldwin 1-27

Date:

10/19/2015

Project Number:

142

Logged By:

Kris Shepherd

Drilled By:

Drill Pro

Drilling Method:

Direct Push

Sampling Method:

Continuous

Gravel Pack:

Silica Sand

Seal:

Bentonite

Grout:

-

Casing Type:

PVC

Diameter:

1"

Length:

10'

Hole Diameter:

3"

Depth to Liquid:

-

Screen Type:

PVC

Slot:

0.01

Diameter:

1"

Length:

20'

Total Depth:

30'

Depth to Water:

~20.5'

Penetration Resistance	Moisture Content	Vapor (ppm)	Staining	Sample #	Depth (ft. bgs.)	Sample Run	Recovery	Soil/Rock Type	Lithology/Remarks	Well Completion Diagram
					0					
					2				Hydrovac, Not Logged	
					4					
					6					
	Moist	0.5	None		8	2'	2'		6' → 12.5' silty, clayey, fg sand, brown, no odor, no stain, moist	
		0.4			10				12.5' → 15.5' fg → mg sand, brown, no odor, no stain, moist	
		0.4			12	4'	4'		— trace gravel 13.25' → 13.75'	
		0.5			14				15.5' → 17.5' Sandy clay, light brown, low cohesion, low plasticity	
		0.4			16	4'	4'		no odor, no stain, moist	
		0.6			18				17.5' → 20.5' fg → coarse sand, brown, no stain, no odor, moist	
		0.7			20	4'	4'		20.5' → 23' Sandy clay, brown to tan, low cohesion, low plasticity, no odor, no stain, wet	
		0.6			22				23' → 26' clayey fg → coarse sand, brown, no odor/stain, wet	
		0.4			24	4'	4'		26' → 27' silty sandy clay, brown, no odor/stain, low cohesion, low plasticity, wet	
		0.4			26				27' → fg → coarse sand, brown, no odor, no stain, wet	
		0.6			28	4'	4'		→ trace gravel 29.5' → 30'	
		1.1			30	2'	2'		— flush mount	
					32					
					34					
					36					
					38					
					40					

NOTES:

Page 1 of 1

Well Location Sketch:

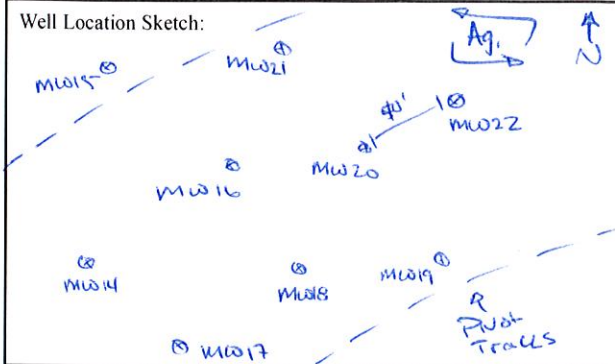

Compliance • Engineering • Remediation

LT Environmental, Inc.

4600 W. 60th Avenue

Arvada, Colorado 80003

BORING LOG/MONITORING WELL COMPLETION DIAGRAM

Boring/Well Number: MW 22 Project: Anderson 12-27, Bohlender 1-27

Date: 10/17/2016 Project Number: KMG05162

Logged By: Kris Shepherd Drilled By: Drill Pro

Elevation: Detector: PID Drilling Method: Direct Push Sampling Method: Continuous

Gravel Pack: Silica Sand Seal: Bentonite Grout: -

Casing Type: PVC Diameter: 1" Length: 10' Hole Diameter: 3" Depth to Liquid: -

Screen Type: PVC Slot: 0.01 Diameter: 1" Length: 20' Total Depth: ~30' Depth to Water: ~18'

Penetration Resistance	Moisture Content	Vapor (ppm)	Staining	Sample #	Depth (ft. bgs.)	Sample Run	Recovery	Soil/Rock Type	Lithology/Remarks	Well Completion Diagram
					0					
					2				Hand Auger	
					4				Hydrovac, Not Logged	
					6					
	moist	0.0	none		8	2'	2'		6' → 11.5' silty, clayey fg sand, brown, no stain, no odor, moist	
		0.0			10			SC	11.5' → 14.5' fg → Mg sand, light brown, no stain, no odor, moist	
		0.1			12	4'	4'		14.5' → 16' Sandy clay, trace coarse sand, brown, cohesive, low plasticity, no stain, no odor, moist	
		0.0			14			SP		
		0.0			16	4'	4'	CL	16' → 19.5' fg → coarse sand, trace gravel, tan, no stain, no odor, moist	
	wet	0.0			18			SW	→ wet @ ~18'	
		0.0			20	4'	4'		→ trace silt & clay ~18.5' → 19.5'	
		0.1			22			SC	19.5' → 23.5' clayey fg sand, trace gravel, brown w/ red Fe staining, no stain, no odor, wet	
		0.0			24					
		0.3			26	4'	4'	SW	23.5' → 26' fg → coarse sand, tan, no stain, no odor, wet	
		0.0			28					
	moist	0.1			30	2'	2'	CL	26' → 30' sandy, silty clay, light brown, cohesive, med. plasticity, no stain, no odor, wet	
					32				→ moist @ ~27.5'	
					34				→ flush mount	
					36					
					38					
					40					

NOTES:

Page ____ of ____

Location Map:

Alfalfa

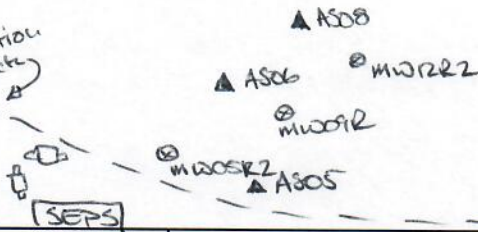
Irrigation
Ditch

Compliance _m Engineering _m Remediation
 LT Environmental, Inc.
 4400 W. 46th Avenue
 Denver, Colorado 80212

BORING LOG/MONITORING WELL COMPLETION DIAGRAM

Boring/Well Number:

MW00SR2

Project:

Anderson 12-21 Bonander 1-23

Date:

1/30/2017

Project Number:

KM GOS162

Logged By:

Kris Shepherd

Drilled By:

Elite Drilling

Elevation:

Detector:

MiniRae 3000 PID

Drilling Method:

Hollow-Stem Auger

Sampling Method:

Cuttings
Continuous

Gravel Pack:

10-20 Silica Sand

Seal:

Bentonite

Grout:

Casing Type:

Schedule 40 PVC

Diameter:

2"

Length:

10'

Hole Diameter:

8"

Depth to Liquid:

Screen Type:

Schedule 40 PVC

Slot:

0.01

Diameter:

2"

Length:

20'

Total Depth:

30'

Depth to Water:

~24'

Penetration Resistance	Moisture Content	Vapor (ppm)	Staining	Sample #	Depth (ft. bgs.)	Sample Run	Soil/Rock Type	Lithology/Remarks	Well Completion
	moist	0.1	none		0			0' → 1' (hand auger) Sandy (fg)	
		0.1			4	Hand Auger	SP	Clay, brown, cohesive, low plasticity, no stain, no odor, moist	
		0.3			8			1' → 9' (0.6" hand auger) fg	
		1.0			12			Sand, light brown, no stain, no odor, moist	
		0.4			16		CL	9' → 18' Sandy clay, brown, cohesive, med. plasticity, no odor, no stain, moist	
		1.0			20				
		1.2			24		SW	18' → 24' fg → v. coarse sand, brown, no stain, no odor, moist	
	Wet	3.8			28		SW	24' → 30' gravelly fg → coarse sand, gray stain, odor, wet	
		5.7	Stain		32				
		24.2			36				
		16.1			40				
					44				
					48				
					52				
					56				
					60				

→ flush mount

Location Map:



Compliance _m Engineering _m Remediation
LT Environmental, Inc.
4400 W. 46th Avenue
Denver, Colorado 80212

BORING LOG/MONITORING WELL COMPLETION DIAGRAM

Boring/Well Number: **MW12R2** Project: **Anderson 12-27/Balanced 1-27**

Date: **1/30/2017** Project Number: **KMG05162**

Logged By: **Kris Shepherd** Drilled By: **Elite Drilling**

Elevation: Detector: **MiniRae 3000 PID** Drilling Method: **Hollow-Stem Auger** Sampling Method: **Cuttings**
~~Continuous~~

Gravel Pack: **10-20 Silica Sand** Seal: **Bentonite** Grout:

Casing Type: **Schedule 40 PVC** Diameter: **2"** Length: **10'** Hole Diameter: **8"** Depth to Liquid:

Screen Type: **Schedule 40 PVC** Slot: **0.01** Diameter: **2"** Length: **20'** Total Depth: **30'** Depth to Water: **~25'**

Penetration Resistance	Moisture Content	Vapor (ppm)	Staining	Sample #	Depth (ft. bgs.)	Sample Run	Soil/Rock Type	Lithology/Remarks	Well Completion
	Moist	0.0	None		0		CL	0' → 1' Sandy clay, brown, cohesive, low plasticity, no odor, no stain, moist	
		0.1			4	Hand Auger	SP	1' → 7' fg-silty sand, tan to brown, no odor, no stain, moist	
		0.0			8			7' → 23' Sandy clay, brown, cohesive, mod. plasticity, no odor, no stain, moist	
		0.3			12		CL	23' → 30' gravelly fg-coarse sand, tan, no odor, no stain, moist	
		0.3			16	Cuttings		→ wet @ ~25'	
		0.1			20				
		0.0			24		SW		
		5.1			28				
		8.7			32				
		5.4			36				
		5.1			40				
					44				
					48				
					52				
					56				
					60				

Location Map:

MW08R2

OW01

OW02

AS01

MW05R



Compliance « Engineering » Remediation
 LT Environmental, Inc.
 4600 W. 60th Avenue
 Arvada, Colorado 80003

BORING LOG/MONITORING WELL COMPLETION DIAGRAM

Boring/Well Number:	AS 01		Project:	Anderson 12-27 Bohlender 1-27	
Date:	5/15/14		Project Number:	KMG05162	
Logged By:	D. Burns		Drilled By:	High Plains Drilling	
Elevation:			Drilling Method:	Direct Push	
Detector:	PID		Sampling Method:	Continuous	
Gravel Pack:	10-20 Silica Sand 31'-28.5'		Seal:	Bentonite chips 28.5'-18.5'	
Casing Type:	Sch 40 PVC		Grout:	18.5'-Top NA	
Screen Type:	Sch 40 PVC		Diameter:	1"	
Slot:	0.010"		Length:	1.5'	
			Hole Diameter:	2.25"	
			Depth to Liquid:		
			Total Depth:	31	
			Depth to Water:	26	

Penetration Resistance	Moisture Content	Vapor (ppm)	Staining	Sample #	Depth (ft. bgs.)	Sample Run	Soil/Rock Type	Lithology/Remarks	Well Completion
					0			Pot holed	
					2			No Recovery	
					4				
					6				
	Dry	Ø			8			Brown clayey sand no s/o	
	Dry	Ø			10			" " no s/o	
	Moist	Ø			12				
					14			Brown med-coarse sand no s/o	
	Moist	Ø			16			" " No s/o	
		54.7			18			Gray med, fn sand with fines, slight s/o	
	Dry	335	yes		20			Dark gray coarse gravelly sand, med s/o	
					22			" " mod s/o	
	Dry	916	yes		24				
	Moist	1004	yes		26			Black gravelly coarse sand, strong s/o	
	wet	3,546	yes		28			Gray fn-med sand, strong s/o	
					30			" " strong s/o	
	wet	2006	yes						
					32				
	moist	894	slight		34			Gray gravelly clayey sand	
								Gray fn sandy clay slight s/o	

Well Location Sketch:

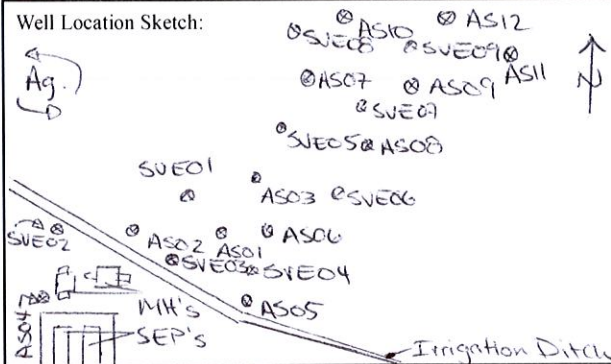

Compliance • Engineering • Remediation

LT Environmental, Inc.

4600 W. 60th Avenue

Arvada, Colorado 80003

BORING LOG/MONITORING WELL COMPLETION DIAGRAM

Boring/Well Number:	AS02	Project:	Anderson 12-27, Boulder 1-27
Date:	10/12/2015	Project Number:	KWG05162.3
Logged By:	Kris Shepherd	Drilled By:	Drill Pro
Drilling Method:	Hollow Stem Auger	Sampling Method:	Cuttings
Seal:	Bentonite Pellets	Grout:	10% bentonite 90% Portland
Casing Type:	PVC	Diameter:	2"
Screen Type:	PVC	Length:	33'
Slot:	0.01	Hole Diameter:	8"
Diameter:	2"	Depth to Liquid:	-
Length:	2'	Total Depth:	35'
		Depth to Water:	~28'

Penetration Resistance	Moisture Content	Vapor (ppm)	Staining	Sample #	Depth (ft. bgs.)	Sample Run	Recovery	Soil/Rock Type	Lithology/Remarks	Well Completion Diagram
					0					
					2				Hydrovac, Not Logged	
					4					
					6					
					8				No staining/color was obs. in cuttings @ surface	
					10					
					12				27' of grout, native to surface	
					14					
					16					
					18					
					20					
					22					
					24					
					26					
					28					
					30					
					32					
					34					
					36					
					38					
					40					

Well Location Sketch:



Compliance • Engineering • Remediation

LT Environmental, Inc.

4600 W. 60th Avenue

Arvada, Colorado 80003

BORING LOG/MONITORING WELL COMPLETION DIAGRAM

Boring/Well Number:

ASO3

Project:

Anderson 12-27 Schelder 1-27

Date:

10/12/2015

Project Number:

KMG05162.3

Logged By:

Kris Shepherd

Drilled By:

Drill Pro

Elevation:

Detector:

PID

Drilling Method:

Hollow Stem Auger

Sampling Method:

Cuttings

Gravel Pack:

Silica Sand

Seal:

Bentonite Pellets

Grout:

10% bentonite @ 90% Portland

Casing Type:

PVC

Diameter:

2"

Length:

33'

Hole Diameter:

8"

Depth to Liquid:

-

Screen Type:

PVC

Slot:

0.01

Diameter:

2"

Length:

2'

Total Depth:

35'

Depth to Water:

~28'

Penetration Resistance	Moisture Content	Vapor (ppm)	Staining	Sample #	Depth (ft. bgs.)	Sample Run	Recovery	Soil/Rock Type	Lithology/Remarks	Well Completion Diagram
					0					
					2				Hydrovac, Not Logged	
					4					
					6					
					8				Stain & odor obs. in cuttings @ surface from ~18' bgs → TD	
					10					
					12				15' of grout, native to surface	
					14					
					16					
					18					
					20					
					22					
					24					
					26					
					28					
					30					
					32					
					34					
					36					
					38					
					40					

Well Location Sketch:



Compliance • Engineering • Remediation

LT Environmental, Inc.

4600 W. 60th Avenue

Arvada, Colorado 80003

BORING LOG/MONITORING WELL COMPLETION DIAGRAM

Boring/Well Number:

AS04

Project:

Anderson 12-27, Bohlendes 1-27

Date:

10/13/2015

Project Number:

KMG05162.3

Logged By:

Kris Shepherd

Drilled By:

Drill Pro

Elevation:

Detector:

PID

Drilling Method:

Hollow Stem Auger

Sampling Method:

Cuttings

Gravel Pack:

Silica Sand

Seal:

Bentonite Pellets

Grout:

10% bentonite - 90% Portland

Casing Type:

PVC

Diameter:

2"

Length:

33'

Hole Diameter:

8"

Depth to Liquid:

-

Screen Type:

PVC

Slot:

0.01

Diameter:

2"

Length:

2'

Total Depth:

35'

Depth to Water:

~25'

Penetration Resistance	Moisture Content	Vapor (ppm)	Staining	Sample #	Depth (ft. bgs.)	Sample Run	Recovery	Soil/Rock Type	Lithology/Remarks	Well Completion Diagram
					0					
					2				Hydrovac, Not Logged	
					4					
					6					
					8				— stain & odor observed in cuttings from ~25' → TD	
					10					
					12					
					14				— 15' of grout, native to surface.	
					16					
					18					
					20					
					22					
					24					
					26					
					28					
					30					
					32					
					34					
					36					
					38					
					40					

Well Location Sketch:



Compliance • Engineering • Remediation

LT Environmental, Inc.

4600 W. 60th Avenue

Arvada, Colorado 80003

BORING LOG/MONITORING WELL COMPLETION DIAGRAM

Boring/Well Number:

AS05

Project:

Anderson 12-24, Baldender 1-27

Date:

10/13/2015

Project Number:

KMG05162-3

Logged By:

Kris Shepherd

Drilled By:

Drill Pro

Elevation:

Detector:

PID

Drilling Method:

Hollow Stem Auger

Sampling Method:

Cuttings

Gravel Pack:

Silica Sand

Seal:

Bentonite Pellets

Grout:

100% Bentonite - 90% Portland

Casing Type:

PVC

Diameter:

2"

Length:

33'

Hole Diameter:

8"

Depth to Liquid:

-

Screen Type:

PVC

Slot:

0.01

Diameter:

2"

Length:

2'

Total Depth:

35'

Depth to Water:

~25'

Penetration Resistance	Moisture Content	Vapor (ppm)	Staining	Sample #	Depth (ft. bgs.)	Sample Run	Recovery	Soil/Rock Type	Lithology/Remarks	Well Completion Diagram
					0					
					2				Hydrovac, Not Logged	
					4					
					6					
					8				All cuttings @ surface had odor + stain	
					10					
					12					
					14				15' of grout, native to surface	
					16					
					18					
					20					
					22					
					24					
					26					
					28					
					30					
					32					
					34					
					36					
					38					
					40					

Well Location Sketch:



Compliance • Engineering • Remediation

LT Environmental, Inc.

4600 W. 60th Avenue

Arvada, Colorado 80003

BORING LOG/MONITORING WELL COMPLETION DIAGRAM

Boring/Well Number:

AS06

Project:

Anderson 12-27, Bohlenders 1-27

Date:

10/14/2015

Project Number:

KILGOS162.3

Logged By:

Kris Shepherd

Drilled By:

Drill Pro

Elevation:

Detector:

PID

Drilling Method:

Hollow Stem Auger

Sampling Method:

Cuttings

Gravel Pack:

Silica Sand

Seal:

Bentonite Pellets

Grout:

10% Bentonite - 90% Portland

Casing Type:

PVC

Diameter:

2"

Length:

33'

Hole Diameter:

8"

Depth to Liquid:

-

Screen Type:

PVC

Slot:

0.01

Diameter:

2"

Length:

2'

Total Depth:

35'

Depth to Water:

~25'

Penetration Resistance	Moisture Content	Vapor (ppm)	Staining	Sample #	Depth (ft. bgs.)	Sample Run	Recovery	Soil/Rock Type	Lithology/Remarks	Well Completion Diagram
					0					
					2				Hydrovac, Not Logged	
					4					
					6					
					8				Stain & odor observed in all cuttings @ surface	
					10					
					12				15' of grout, native to surface	
					14					
					16					
					18					
					20					
					22					
					24					
					26					
					28					
					30					
					32					
					34					
					36					
					38					
					40					

NOTES:

Page ____ of ____

Well Location Sketch:



Compliance • Engineering • Remediation

LT Environmental, Inc.

4600 W. 60th Avenue

Arvada, Colorado 80003

BORING LOG/MONITORING WELL COMPLETION DIAGRAM

Boring/Well Number:

ASO7

Project:

Anderson 12-24, Ballender 1-27

Date:

10/14/2015

Project Number:

EW1605162.3

Logged By:

Kris Shepherd

Drilled By:

Drill Pro

Elevation:

Detector:

PID

Drilling Method:

Hollow stem Auger

Sampling Method:

Cuttings

Gravel Pack:

Silica Sand

Seal:

Bentonite Pellets

Grout:

10% Bentonite - 90% Portland

Casing Type:

PVC

Diameter:

2"

Length:

33'

Hole Diameter:

8"

Depth to Liquid:

-

Screen Type:

PVC

Slot:

0.01

Diameter:

2"

Length:

2'

Total Depth:

35'

Depth to Water:

~20'

Penetration Resistance	Moisture Content	Vapor (ppm)	Staining	Sample #	Depth (ft. bgs.)	Sample Run	Recovery	Soil/Rock Type	Lithology/Remarks	Well Completion Diagram
					0					
					2				Hydrovac, Not Logged	
					4					
					6					
					8				— Stain & odor observed in all cuttings @ surface	
					10					
					12				— 15' of grout native to surface.	
					14					
					16					
					18					
					20					
					22					
					24					
					26					
					28					
					30					
					32					
					34					
					36					
					38					
					40					

Well Location Sketch:



Compliance • Engineering • Remediation

LT Environmental, Inc.

4600 W. 60th Avenue

Arvada, Colorado 80003

BORING LOG/MONITORING WELL COMPLETION DIAGRAM

Boring/Well Number:

AS08

Project:

Anderson 12-27, Bohlendorf 1-27

Date:

10/15/15

Project Number:

KMG05162.3

Logged By:

Kris Shepherd

Drilled By:

Drill Pro

Elevation:

Detector:

PID

Drilling Method:

Hollow Stem Auger

Sampling Method:

Cuttings

Gravel Pack:

Silica Sand

Seal:

Bentonite Pellets

Grout:

10% Bentonite - 90% Portland

Casing Type:

PVC

Diameter:

2"

Length:

33'

Hole Diameter:

8"

Depth to Liquid:

-

Screen Type:

PVC

Slot:

0.01

Diameter:

2"

Length:

2'

Total Depth:

35'

Depth to Water:

~ 25'

Penetration Resistance	Moisture Content	Vapor (ppm)	Staining	Sample #	Depth (ft. bgs.)	Sample Run	Recovery	Soil/Rock Type	Lithology/Remarks	Well Completion Diagram
					0					
					2				Hydrovac, Not Logged	
					4					
					6					
					8				Stain + odor observed in all cuttings @ surface	
					10					
					12					
					14				15' of grout, native to surface	
					16					
					18					
					20					
					22					
					24					
					26					
					28					
					30					
					32					
					34					
					36					
					38					
					40					

NOTES:

Page ____ of ____

Well Location Sketch:



Compliance • Engineering • Remediation

LT Environmental, Inc.

4600 W. 60th Avenue

Arvada, Colorado 80003

BORING LOG/MONITORING WELL COMPLETION DIAGRAM

Boring/Well Number: AS001 Project: Anderson 12-27, Boulder 1-27Date: 10/15/15 Project Number: KMG05162.3Logged By: Kris Shepherd Drilled By: Drill ProElevation: Detector: PID Drilling Method: Hollow Stem Auger Sampling Method: CuttingsGravel Pack: Silica Sand Seal: Bentonite Pellets Grout: 10% Bentonite - 90% PortlandCasing Type: PVC Diameter: 2" Length: 33' Hole Diameter: 8" Depth to Liquid: -Screen Type: PVC Slot: 0.01 Diameter: 2" Length: 2' Total Depth: 35' Depth to Water: ~25'

Penetration Resistance	Moisture Content	Vapor (ppm)	Staining	Sample #	Depth (ft. bgs.)	Sample Run	Recovery	Soil/Rock Type	Lithology/Remarks	Well Completion Diagram
					0					
					2				Hydrovac, Not Logged	
					4					
					6					
					8				Stain + odor observed in all cuttings @ surface.	
					10					
					12					
					14				grout to 15', native to surface.	
					16					
					18					
					20					
					22					
					24					
					26					
					28					
					30					
					32					
					34					
					36					
					38					
					40					

Well Location Sketch:



Compliance • Engineering • Remediation

LT Environmental, Inc.

4600 W. 60th Avenue

Arvada, Colorado 80003

BORING LOG/MONITORING WELL COMPLETION DIAGRAM

Boring/Well Number:

AS10

Project:

Anderson 12-27, Boulder 1-27

Date:

10/15/15

Project Number:

KMG05162-3

Logged By:

Kris Shepherd

Drilled By:

Drill Pro

Elevation:

Detector:

PID

Drilling Method:

Hollow Stem Auger

Sampling Method:

Cuttings

Gravel Pack:

Silica Sand

Seal:

Bentonite Pellets

Grout:

10% Bentonite - 90% Portland

Casing Type:

PVC

Diameter:

1"

Length:

33'

Hole Diameter:

3"

Depth to Liquid:

-

Screen Type:

PVC

Slot:

0.01

Diameter:

1"

Length:

2'

Total Depth:

35'

Depth to Water:

~25'

Penetration Resistance	Moisture Content	Vapor (ppm)	Staining	Sample #	Depth (ft. bgs.)	Sample Run	Recovery	Soil/Rock Type	Lithology/Remarks	Well Completion Diagram
					0					
					2				Hydrovac, Not Logged	
					4					
					6					
					8				All cuttings @ surface had odor + stain	
					10					
					12					
					14				15' of grout, Native to surface	
					16					
					18					
					20					
					22					
					24					
					26					
					28					
					30					
					32					
					34					
					36					
					38					
					40					

Well Location Sketch:



Compliance • Engineering • Remediation

LT Environmental, Inc.

4600 W. 60th Avenue

Arvada, Colorado 80003

BORING LOG/MONITORING WELL COMPLETION DIAGRAM

Boring/Well Number:

AS11

Project:

Anderson 12-27/Baldwin 1-27

Date:

10/15/15

Project Number:

KMG105162.3

Logged By:

Kris Shepherd

Drilled By:

Drill Pro

Elevation:

Detector:

PID

Drilling Method:

Hollow Stem Auger

Sampling Method:

Cuttings

Gravel Pack:

Silica Sand

Seal:

Bentonite Pellets

Grout:

10% bentonite - 90% Portland

Casing Type:

PVC

Diameter:

2"

Length:

33'

Hole Diameter:

8"

Depth to Liquid:

-

Screen Type:

PVC

Slot:

0.01

Diameter:

2"

Length:

2'

Total Depth:

35'

Depth to Water:

~25'

Penetration Resistance	Moisture Content	Vapor (ppm)	Staining	Sample #	Depth (ft. bgs.)	Sample Run	Recovery	Soil/Rock Type	Lithology/Remarks	Well Completion Diagram
					0					
					2				Hydrovac, Not Logged	
					4					
					6					
					8				- stain + odor from ~25'	
					10				→ TD	
					12				- 15' of grout, native to surface.	
					14					
					16					
					18					
					20					
					22					
					24					
					26					
					28					
					30					
					32					
					34					
					36					
					38					
					40					

Well Location Sketch:



Compliance • Engineering • Remediation

LT Environmental, Inc.

4600 W. 60th Avenue

Arvada, Colorado 80003

BORING LOG/MONITORING WELL COMPLETION DIAGRAM

Boring/Well Number: <i>AS12</i>	Project: <i>Anderson 12-27, Boulder 1-27</i>
Date: <i>10/16/16</i>	Project Number: <i>KMG05162.3</i>
Logged By: <i>Kris Shepherd</i>	Drilled By: <i>Drill Pro</i>
Elevation:	Drilling Method: <i>Hollow Stem Auger</i>
Detector: <i>PID</i>	Sampling Method: <i>Cuttings</i>
Gravel Pack: <i>Silica Sand</i>	Seal: <i>Bentonite Pellets</i>
Casing Type: <i>PVC</i>	Grout: <i>10% Bentonite - 90% Portland</i>
Screen Type: <i>PVC</i>	Diameter: <i>2"</i>
Slot: <i>0.01</i>	Length: <i>33'</i>
	Hole Diameter: <i>8"</i>
	Depth to Liquid: <i>-</i>
	Total Depth: <i>35'</i>
	Depth to Water: <i>-25'</i>

Penetration Resistance	Moisture Content	Vapor (ppm)	Staining	Sample #	Depth (ft. bgs.)	Sample Run	Recovery	Soil/Rock Type	Lithology/Remarks	Well Completion Diagram
					0					
					2				Hydrovac, Not Logged	
					4					
					6					
					8					
					10					
					12					
					14					
					16					
					18					
					20					
					22					
					24					
					26					
					28					
					30					
					32					
					34					
					36					
					38					
					40					

Well Location Sketch:

2MW18
 AS13
 SVE10
 AS10
 SVE09
 AS12
 AS11
 AS07
 AS09



Compliance • Engineering • Remediation

LT Environmental, Inc.

4600 W. 60th Avenue

Arvada, Colorado 80003

BORING LOG/MONITORING WELL COMPLETION DIAGRAM

Boring/Well Number:	AS13	Project:	Anderson 12-22/Baldwin 1-27
Date:	10/19/2015	Project Number:	KMG05162-3
Logged By:	Kris Shepherd	Drilled By:	Drill Pro
Drilling Method:	Hollow Stem Auger	Sampling Method:	Cuttings
Seal:	Bentonite Pellets	Grout:	100% Bentonite - 90% Portland
Casing Type:	PVC	Diameter:	2"
Screen Type:	PVC	Length:	33'
Slot:	0.01	Hole Diameter:	8"
		Total Depth:	35'
		Depth to Liquid:	-
		Depth to Water:	~25'

Penetration Resistance	Moisture Content	Vapor (ppm)	Staining	Sample #	Depth (ft. bgs.)	Sample Run	Recovery	Soil/Rock Type	Lithology/Remarks	Well Completion Diagram
					0					
					2				Hydrovac, Not Logged	
					4					
					6					
					8				Stain color observed in cuttings from ~20' → 25'	
					10					
					12				15' of grout, Native to surface	
					14					
					16					
					18					
					20					
					22					
					24					
					26					
					28					
					30					
					32					
					34					
					36					
					38					
					40					

Well Location Sketch:

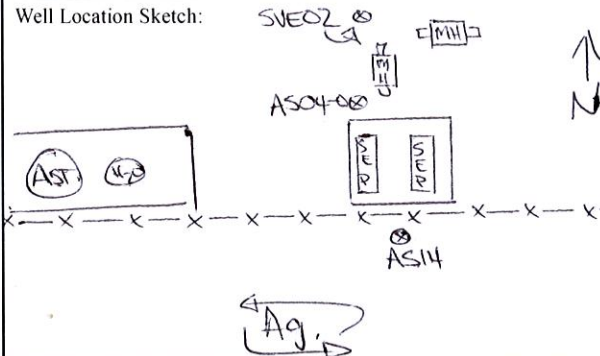

Compliance • Engineering • Remediation

LT Environmental, Inc.

4600 W. 60th Avenue

Arvada, Colorado 80003

BORING LOG/MONITORING WELL COMPLETION DIAGRAM

Boring/Well Number:	AS14	Project:	Anderson 12-27/Bonhamer 1-27
Date:	10/19/2015	Project Number:	KMG05162.3
Logged By:	Kris Shepherd	Drilled By:	Drill Pro
Elevation:		Drilling Method:	Hollow Stem Auger
Detector:	PID	Sampling Method:	Cuttings
Gravel Pack:	Silica Sand	Seal:	Bentonite Pellets
Casing Type:	PVC	Grout:	10% Bentonite - 90% Portland
Screen Type:	PVC	Diameter:	2"
Slot:	0.01	Length:	30'
		Hole Diameter:	3"
		Depth to Liquid:	-
		Total Depth:	32'
		Depth to Water:	

Penetration Resistance	Moisture Content	Vapor (ppm)	Staining	Sample #	Depth (ft. bgs.)	Sample Run	Recovery	Soil/Rock Type	Lithology/Remarks	Well Completion Diagram
					0					
					2				Hydrovac, Not Logged	
					4					
					6					
					8				No staining / odor observed in cuttings @ surface	
					10					
					12				Only Drilled to 32' due to a very hard layer	
					14					
					16				well set @ 32' bgs	
					18					
					20				15' of grout, native to surface.	
					22					
					24					
					26					
					28					
					30					
					32					
					34					
					36					
					38					
					40					

Well Location Sketch:

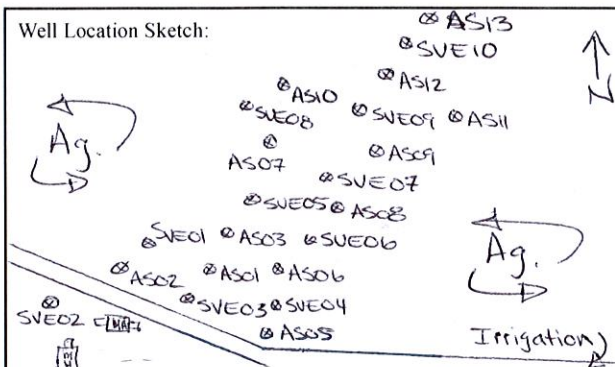

Compliance • Engineering • Remediation

LT Environmental, Inc.

4600 W. 60th Avenue

Arvada, Colorado 80003

BORING LOG/MONITORING WELL COMPLETION DIAGRAM

Boring/Well Number:	SVE01	Project:	Anderson 12-27, Bentler 1-27
Date:	10/12/2015	Project Number:	KMG05162.3
Logged By:	Kris Shepherd	Drilled By:	Drill Pro

Elevation:	Detector:	PID	Drilling Method:	Hollow Stem Auger	Sampling Method:	Cuttings
------------	-----------	-----	------------------	-------------------	------------------	----------

Gravel Pack:	Seal:	Grout:
Silica Sand	Bentonite	10% bentonite - 90% Portland

Casing Type:	Diameter:	Length:	Hole Diameter:	Depth to Liquid:
PVC	2"	14'	3"	-

Screen Type:	Slot:	Diameter:	Length:	Total Depth:	Depth to Water:
PVC	0.01	2"	6'	20'	-

Penetration Resistance	Moisture Content	Vapor (ppm)	Staining	Sample #	Depth (ft. bgs.)	Sample Run	Recovery	Soil/Rock Type	Lithology/Remarks	Well Completion Diagram
					0					
					2				Hydrovac, Not Logged	
					4					
					6					
					8				No staining/color obs. in cuttings @ surface	
					10					
					12				1' of grout, Native to surface	
					14					
					16					
					18					
					20					
					22					
					24					
					26					
					28					
					30					
					32					
					34					
					36					
					38					
					40					

NOTES:

Page ____ of ____

Well Location Sketch:



Compliance • Engineering • Remediation

LT Environmental, Inc.

4600 W. 60th Avenue

Arvada, Colorado 80003

BORING LOG/MONITORING WELL COMPLETION DIAGRAM

Boring/Well Number:

SVE02

Project:

Anderson 12-27, Bentlender 1-27

Date:

10/13/2015

Project Number:

KMG05162.3

Logged By:

Kris Shepherd

Drilled By:

Drill Pro

Elevation:

Detector:

PID

Drilling Method:

Hollow Stem Auger

Sampling Method:

Cuttings

Gravel Pack:

Silica Sand

Seal:

Bentonite

Grout:

10% Bentonite - 90% Portland

Casing Type:

PVC

Diameter:

2"

Length:

14'

Hole Diameter:

8"

Depth to Liquid:

-

Screen Type:

PVC

Slot:

0.01

Diameter:

2"

Length:

6'

Total Depth:

20'

Depth to Water:

-

Penetration Resistance	Moisture Content	Vapor (ppm)	Staining	Sample #	Depth (ft. bgs.)	Sample Run	Recovery	Soil/Rock Type	Lithology/Remarks	Well Completion Diagram
					0					
					2				Hydrovac, Not Logged	
					4					
					6					
					8				No staining/odor observed in soil cuttings @ surface.	
					10					
					12				1' grout, native to surface.	
					14					
					16					
					18					
					20					
					22					
					24					
					26					
					28					
					30					
					32					
					34					
					36					
					38					
					40					

NOTES:

Page ____ of ____

Well Location Sketch:



Compliance • Engineering • Remediation

LT Environmental, Inc.

4600 W. 60th Avenue

Arvada, Colorado 80003

BORING LOG/MONITORING WELL COMPLETION DIAGRAM

Boring/Well Number: SVE03 Project: Anderson 12-27, Bowler 1-27

Date: 10/13/2015 Project Number: KM1705162.3

Logged By: Kris Shepherd Drilled By: Drill Pro

Elevation: Detector: PID Drilling Method: Hollow Stem Auger Sampling Method: Cuttings

Gravel Pack: Silica Sand Seal: Bentonite Grout: 10% Bentonite - 90% Portland

Casing Type: PVC Diameter: 2" Length: 14' Hole Diameter: 8" Depth to Liquid: -

Screen Type: PVC Slot: 0.01 Diameter: 2" Length: 6' Total Depth: 20' Depth to Water: -

Penetration Resistance	Moisture Content	Vapor (ppm)	Staining	Sample #	Depth (ft. bgs.)	Sample Run	Recovery	Soil/Rock Type	Lithology/Remarks	Well Completion Diagram
					0					
					2				Hydrovac, Not Logged	
					4					
					6					
					8				- stain color observed in cuttings @ surface from ~17' → TD	
					10					
					12					
					14				- 1' grout, native to surface.	
					16					
					18					
					20					
					22					
					24					
					26					
					28					
					30					
					32					
					34					
					36					
					38					
					40					

NOTES:

Page ____ of ____

Well Location Sketch:



Compliance • Engineering • Remediation

LT Environmental, Inc.

4600 W. 60th Avenue

Arvada, Colorado 80003

BORING LOG/MONITORING WELL COMPLETION DIAGRAM

Boring/Well Number:

SVE04

Project:

Anderson 12-27, Boulder 1-27

Date:

10/14/15

Project Number:

KMG05162-3

Logged By:

Kris Shepherd

Drilled By:

Drill Pro

Elevation:

Detector:

PID

Drilling Method:

Hollow Stem Auger

Sampling Method:

Cuttings

Gravel Pack:

Silica Sand

Seal:

Bentonite

Grout:

10% bentonite - 90% Portland

Casing Type:

PVC

Diameter:

2"

Length:

14'

Hole Diameter:

8"

Depth to Liquid:

-

Screen Type:

PVC

Slot:

0.01

Diameter:

2"

Length:

6'

Total Depth:

20'

Depth to Water:

-

Penetration Resistance	Moisture Content	Vapor (ppm)	Staining	Sample #	Depth (ft. bgs.)	Sample Run	Recovery	Soil/Rock Type	Lithology/Remarks	Well Completion Diagram
					0					
					2				Hydrovac, Not Logged	
					4					
					6					
					8				- Stain + odor observed in all cuttings @ surface	
					10					
					12				- 1' of grout, native to surface	
					14					
					16					
					18					
					20					
					22					
					24					
					26					
					28					
					30					
					32					
					34					
					36					
					38					
					40					

NOTES:

Page ____ of ____

Well Location Sketch:



Compliance • Engineering • Remediation

LT Environmental, Inc.

4600 W. 60th Avenue

Arvada, Colorado 80003

BORING LOG/MONITORING WELL COMPLETION DIAGRAM

Boring/Well Number:

SVEOS

Project:

Anderson 12-27, Boulder 1-27

Date:

10/14/15

Project Number:

KMG05162.3

Logged By:

Kris Shepherd

Drilled By:

Drill Pro

Elevation:

Detector:

PID

Drilling Method:

Hollow Stem Auger

Sampling Method:

Cuttings

Gravel Pack:

Silica Sand

Seal:

Bentonite

Grout:

10% Bentonite - 90% Portland

Casing Type:

PVC

Diameter:

2"

Length:

14'

Hole Diameter:

8"

Depth to Liquid:

-

Screen Type:

PVC

Slot:

0.01

Diameter:

2"

Length:

6'

Total Depth:

20'

Depth to Water:

-

Penetration Resistance	Moisture Content	Vapor (ppm)	Staining	Sample #	Depth (ft. bgs.)	Sample Run	Recovery	Soil/Rock Type	Lithology/Remarks	Well Completion Diagram
					0					
					2				Hydrovac, Not Logged	
					4					
					6					
					8				No odor or stain observed in cuttings @ surface.	
					10					
					12				1' of grout, native to surface.	
					14					
					16					
					18					
					20					
					22					
					24					
					26					
					28					
					30					
					32					
					34					
					36					
					38					
					40					

Well Location Sketch:



Compliance • Engineering • Remediation

LT Environmental, Inc.

4600 W. 60th Avenue

Arvada, Colorado 80003

BORING LOG/MONITORING WELL COMPLETION DIAGRAM

Boring/Well Number: <i>SVE06</i>	Project: <i>Anderson 12-27, Benham 1-27</i>
Date: <i>10/14/2015</i>	Project Number: <i>KMG015162.3</i>
Logged By: <i>Kris Shepherd</i>	Drilled By: <i>Drill Pro</i>

Elevation:	Detector: <i>PID</i>	Drilling Method: <i>Hollow Stem Auger</i>	Sampling Method: <i>Cuttings</i>
------------	-------------------------	--	-------------------------------------

Gravel Pack: <i>Silica Sand</i>	Seal: <i>Bentonite</i>	Grout: <i>10% Bentonite - 90% Portland</i>
------------------------------------	---------------------------	---

Casing Type: <i>PVC</i>	Diameter: <i>2"</i>	Length: <i>14'</i>	Hole Diameter: <i>8"</i>	Depth to Liquid: <i>-</i>
----------------------------	------------------------	-----------------------	-----------------------------	------------------------------

Screen Type: <i>PVC</i>	Slot: <i>0.01</i>	Diameter: <i>2"</i>	Length: <i>6'</i>	Total Depth: <i>20'</i>	Depth to Water: <i>-</i>
----------------------------	----------------------	------------------------	----------------------	----------------------------	-----------------------------

Penetration Resistance	Moisture Content	Vapor (ppm)	Staining	Sample #	Depth (ft. bgs.)	Sample Run	Recovery	Soil/Rock Type	Lithology/Remarks	Well Completion Diagram
					0					
					2				Hydrovac, Not Logged	
					4					
					6					
					8				— Stain + odor observed in all cuttings @ surface.	
					10					
					12				— 1' of grout, native to surface.	
					14					
					16					
					18					
					20					
					22					
					24					
					26					
					28					
					30					
					32					
					34					
					36					
					38					
					40					

NOTES:

Page ____ of ____

Well Location Sketch:



Compliance • Engineering • Remediation

LT Environmental, Inc.

4600 W. 60th Avenue

Arvada, Colorado 80003

BORING LOG/MONITORING WELL COMPLETION DIAGRAM

Boring/Well Number:

SVE07

Project:

Anderson 12-273 Bldg 1-27

Date:

10/16/15

Project Number:

KMHOS162.3

Logged By:

Kris Shepherd

Drilled By:

Drill Pro

Elevation:

Detector:

PID

Drilling Method:

Hollow Stem Auger

Sampling Method:

Cuttings

Gravel Pack:

Silica Sand

Seal:

Bentonite

Grout:

10% Bentonite - 90% Portland

Casing Type:

PVC

Diameter:

2"

Length:

14'

Hole Diameter:

8"

Depth to Liquid:

-

Screen Type:

PVC

Slot:

0.01

Diameter:

2"

Length:

6'

Total Depth:

20'

Depth to Water:

-

Penetration Resistance	Moisture Content	Vapor (ppm)	Staining	Sample #	Depth (ft. bgs.)	Sample Run	Recovery	Soil/Rock Type	Lithology/Remarks	Well Completion Diagram
					0					
					2				Hydrovac, Not Logged	
					4					
					6					
					8				Stain & odor observed in all cuttings @ surface	
					10				1' of grout, native to surface	
					12					
					14					
					16					
					18					
					20					
					22					
					24					
					26					
					28					
					30					
					32					
					34					
					36					
					38					
					40					

NOTES:

Page ____ of ____

Well Location Sketch:



Compliance • Engineering • Remediation

LT Environmental, Inc.

4600 W. 60th Avenue

Arvada, Colorado 80003

BORING LOG/MONITORING WELL COMPLETION DIAGRAM

Boring/Well Number:

SVE08

Project:

Anderson 12-27/Boulders 1-27

Date:

10/16/16

Project Number:

KMG05162-3

Logged By:

Kris Shepherd

Drilled By:

Drill Pro

Elevation:

Detector:

PID

Drilling Method:

Hollow Stem Auger

Sampling Method:

Cuttings

Gravel Pack:

Silica Sand

Seal:

Bentonite

Grout:

10% Bentonite - 90% Portland

Casing Type:

PVC

Diameter:

1"

Length:

20'14"

Hole Diameter:

8"

Depth to Liquid:

-

Screen Type:

PVC

Slot:

0.01

Diameter:

1"

Length:

6'

Total Depth:

20'

Depth to Water:

-

Penetration Resistance	Moisture Content	Vapor (ppm)	Staining	Sample #	Depth (ft. bgs.)	Sample Run	Recovery	Soil/Rock Type	Lithology/Remarks	Well Completion Diagram
					0					
					2				Hydrovac, Not Logged	
					4					
					6					
					8				No staining or odor obs. in soil cuttings	
					10					
					12				1' of grout, native to surface	
					14					
					16					
					18					
					20					
					22					
					24					
					26					
					28					
					30					
					32					
					34					
					36					
					38					
					40					

NOTES:

Page ____ of ____

Well Location Sketch:



Compliance • Engineering • Remediation

LT Environmental, Inc.

4600 W. 60th Avenue

Arvada, Colorado 80003

BORING LOG/MONITORING WELL COMPLETION DIAGRAM

Boring/Well Number:

SVE01

Project:

Anderson 12-27 & Boulevard 1-29

Date:

10/16/16

Project Number:

KMG05162.3

Logged By:

Kris Shepherd

Drilled By:

Drill Pro

Elevation:

Detector:

PID

Drilling Method:

Hollow Stem Auger

Sampling Method:

Cuttings

Gravel Pack:

Silica Sand

Seal:

Bentonite

Grout:

10% Bentonite - 90% Portland

Casing Type:

PVC

Diameter:

2"

Length:

14'

Hole Diameter:

8"

Depth to Liquid:

-

Screen Type:

PVC

Slot:

0.01

Diameter:

2"

Length:

6'

Total Depth:

20'

Depth to Water:

-

Penetration Resistance	Moisture Content	Vapor (ppm)	Staining	Sample #	Depth (ft. bgs.)	Sample Run	Recovery	Soil/Rock Type	Lithology/Remarks	Well Completion Diagram
					0					
					2				Hydrovac, Not Logged	
					4					
					6					
					8				— stain + odor observed from ~18' → TD (20')	
					10					
					12				— 1' of grout, native to surface	
					14					
					16					
					18					
					20					
					22					
					24					
					26					
					28					
					30					
					32					
					34					
					36					
					38					
					40					

NOTES:

Page ____ of ____

Well Location Sketch:



Compliance • Engineering • Remediation

LT Environmental, Inc.

4600 W. 60th Avenue

Arvada, Colorado 80003

BORING LOG/MONITORING WELL COMPLETION DIAGRAM

Boring/Well Number:

SVE10

Project:

10/16

Date:

10/16/16

Project Number:

KMG05162.3

Logged By:

Kris Shepherd

Drilled By:

Drill Pro

Elevation:

Detector:

PID

Drilling Method:

Hollow Stem Auger

Sampling Method:

Cuttings

Gravel Pack:

Silica Sand

Seal:

Bentonite

Grout:

10% Bentonite - 90% Portland

Casing Type:

PVC

Diameter:

2"

Length:

14'

Hole Diameter:

8"

Depth to Liquid:

-

Screen Type:

PVC

Slot:

0.01

Diameter:

2"

Length:

6'

Total Depth:

20'

Depth to Water:

-

Penetration Resistance	Moisture Content	Vapor (ppm)	Staining	Sample #	Depth (ft. bgs.)	Sample Run	Recovery	Soil/Rock Type	Lithology/Remarks	Well Completion Diagram
					0					
					2				Hydrovac, Not Logged	
					4					
					6					
					8				No stain or color observed in cuttings @ surface	
					10					
					12				1' of grout, native to surface.	
					14					
					16					
					18					
					20					
					22					
					24					
					26					
					28					
					30					
					32					
					34					
					36					
					38					
					40					

NOTES:

Page 1 of 1

Well Location Sketch:

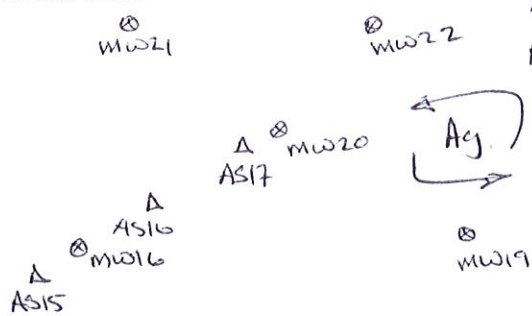

Compliance • Engineering • Remediation

LT Environmental, Inc.

4600 W. 60th Avenue

Arvada, Colorado 80003

BORING LOG/MONITORING WELL COMPLETION DIAGRAM

Boring/Well Number: AS15 — AS17 Project: Anderson 12-27, Bohlender 1-27Date: 10/17/2016 & 10/18/2016Project Number: KMG05162Logged By: Kris ShepherdDrilled By: Drill ProElevation: Detector: PIDDrilling Method: CME H.S.A.Sampling Method: N/AGravel Pack:
Silica SandSeal: BentoniteGrout: 90% Portland & 10% BentoniteCasing Type: PVC Diameter: 2" Length: 33'Hole Diameter: 8" Depth to Liquid: -Screen Type: PVC Slot: 0.01 Diameter: 2" Length: 2'Total Depth: 35' Depth to Water: -

Penetration Resistance	Moisture Content	Vapor (ppm)	Staining	Sample #	Depth (ft. bgs.)	Sample Run	Recovery	Soil/Rock Type	Lithology/Remarks	Well Completion Diagram
					0					
					2				Hydrovac, Not Logged	
					4					
					6					
					8				→ Not Sampled & Not logged	
					10					
					12					
					14					
					16					
					18					
					20					
					22					
					24					
					26					
					28					
					30					
					32					
					34					
					36					
					38					
					40					

NOTES:

Page ____ of ____