



Project: SEC 33 T2N R64W
Site: Jackson 02N-64W-33 Pad
Well: Jackson 33-1H
Wellbore: OH
Design: Plan 2
Lat: 40.1015659
Long: -104.5619070

LP_Jackson 33-1H(0 FNL 480 FWL)

9 5/8" Surface

500

0

-500

-1000

-1500

-2000

-2500

-3000

-3500

-4000

-4500

-5000

-5500

South(-)/North(+) (1000 ft/in)

SEC 33

PBHL_Jackson 33-1H(0 FSL 480 FWL)

-3000 -2500 -2000 -1500 -1000 -500 0 500

West(-)/East(+) (1000 ft/in)

Vertical Section at 186.15° (1300 ft/in)

SECTION DETAILS

MD	Inc	Azi	TVD	+N/-S	+E/-W	Dleg	TFace	VSect	Target
0.00	0.00	0.00	0.00	0.00	0.00	0.00	0.00	0.00	
200.00	0.00	0.00	200.00	0.00	0.00	0.00	0.00	0.00	
751.25	11.03	330.53	747.86	46.03	-26.02	2.00	330.53	-42.98	
5543.99	11.03	330.53	5452.14	843.97	-476.98	0.00	0.00	-788.05	
6095.25	0.00	0.00	6000.00	890.00	-503.00	2.00	180.00	-831.03	
6508.63	0.00	0.00	6413.38	890.00	-503.00	0.00	0.00	-831.03	
7511.02	90.22	180.41	7050.00	251.01	-507.63	9.00	180.41	-195.22	
12834.39	90.22	180.41	7030.00	-5072.19	-546.16	0.00	0.00	5101.51	PBHL

DESIGN TARGET DETAILS

Name	TVD	+N/-S	+E/-W	Northing	Easting	Latitude	Longitude	Shape
PBHL	7030.00	-5072.19	-546.16	1276155.24	3261921.36	40.0876420	-104.5638590	Point
- plan hits target center								
LP	7050.00	251.37	-507.44	1281478.90	3261903.76	40.1022560	-104.5637210	Point
- plan misses target center by 0.19ft at 7510.65ft MD (7050.00 TVD, 251.38 N, -507.62 E)								

PROJECT DETAILS: SEC 33 T2N R64W

Geodetic System: US State Plane 1983
Datum: North American Datum 1983
Ellipsoid: GRS 1980
Zone: Colorado Northern Zone
Colorado Northern Zone
System Datum: Mean Sea Level

CASING DETAILS

TVD	MD	Name	Size
1700.00	1721.30	9 5/8" Surface	9.625
	12834.40	5 1/2"	5.500



Azimuths to True North
Magnetic North: 8.09°

Magnetic Field
Strength: 52264.2snT
Dip Angle: 66.65°
Date: 5/24/2017
Model: IGRF2015

Start Build 2.00

Start 4792.74 hold at 751.25 MD

9 5/8" Surface

Start Drop -2.00

Start 413.38 hold at 6095.25 MD

Start DLS 9.00 TFO 180.41

Start 5323.38 hold at 7511.02 MD

LP_Jackson 33-1H(0 FNL 480 FWL)

PBHL_Jackson 33-1H(0 FSL 480 FWL)

Jackson 33-1H/Plan 2

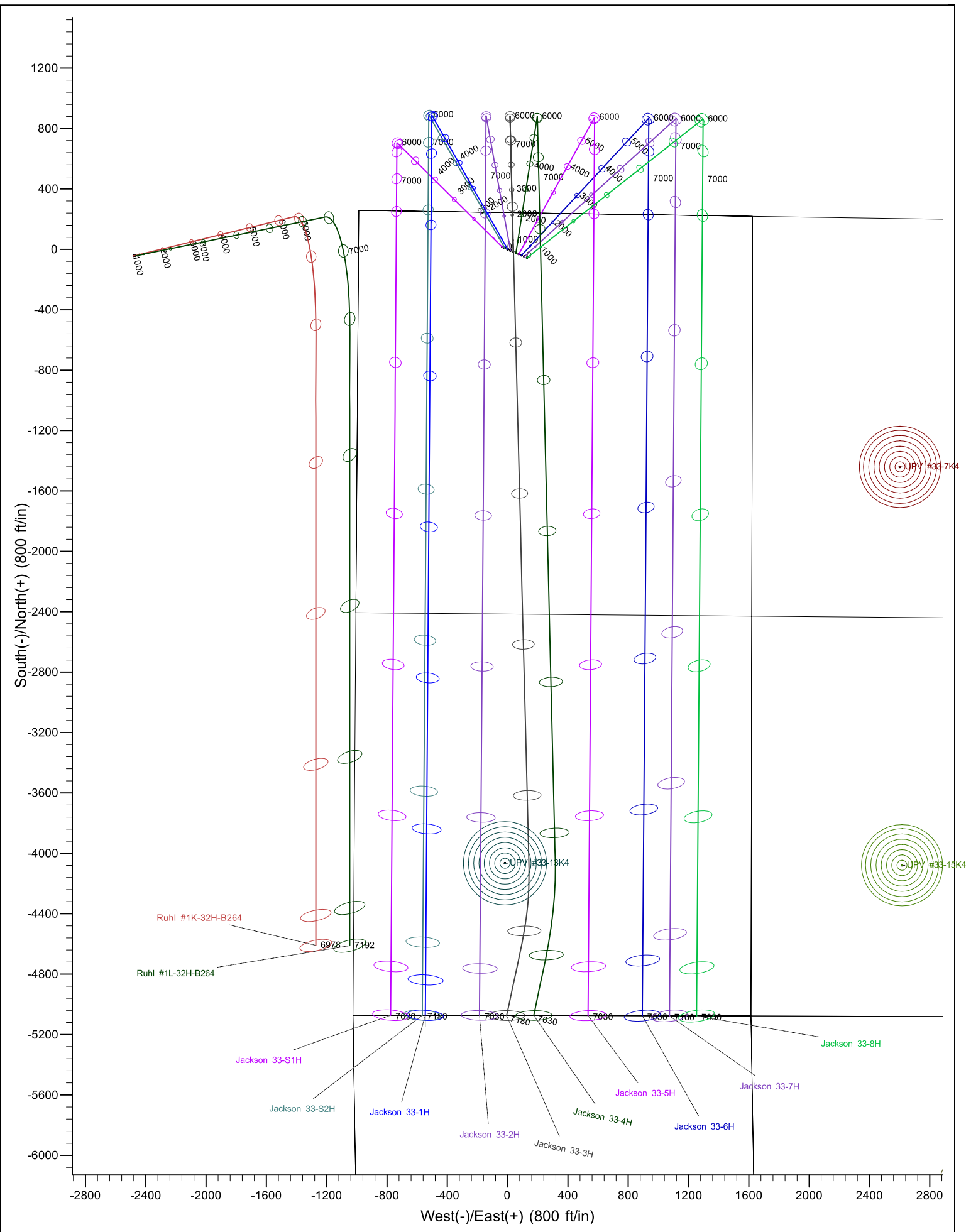



Verdad Resources LLC

SEC 33 T2N R64W

Jackson 02N-64W-33 Pad

Jackson 33-1H

OH

Plan: Plan 2

Standard Planning Report

28 December, 2017





Database:	EDM 5000.14 Single User Db	Local Co-ordinate Reference:	Well Jackson 33-1H
Company:	Verdad Resources LLC	TVD Reference:	WELL @ 5017.00ft (Original Well Elev)
Project:	SEC 33 T2N R64W	MD Reference:	WELL @ 5017.00ft (Original Well Elev)
Site:	Jackson 02N-64W-33 Pad	North Reference:	True
Well:	Jackson 33-1H	Survey Calculation Method:	Minimum Curvature
Wellbore:	OH		
Design:	Plan 2		

Project	SEC 33 T2N R64W		
Map System:	US State Plane 1983	System Datum:	Mean Sea Level
Geo Datum:	North American Datum 1983		
Map Zone:	Colorado Northern Zone		

Site	Jackson 02N-64W-33 Pad			
Site Position:		Northing:	1,281,248.57 usft	Latitude: 40.1016100
From:	Lat/Long	Easting:	3,262,377.29 usft	Longitude: -104.5620370
Position Uncertainty:	3.28 ft	Slot Radius:	13.200 in	Grid Convergence: 0.61 °

Well	Jackson 33-1H, SEC 33 T2N R64W			
Well Position	+N/-S	-16.04 ft	Northing:	1,281,232.91 usft
	+E/-W	36.37 ft	Easting:	3,262,413.83 usft
Position Uncertainty		3.28 ft	Wellhead Elevation:	Ground Level: 5,017.00 ft

Wellbore	OH				
Magnetics	Model Name	Sample Date	Declination (°)	Dip Angle (°)	Field Strength (nT)
	IGRF2015	5/24/2017	8.08	66.65	52,264

Design	Plan 2			
Audit Notes:				
Version:	Phase:	PLAN	Tie On Depth:	0.00
Vertical Section:	Depth From (TVD) (ft)	+N/-S (ft)	+E/-W (ft)	Direction (°)
	0.00	0.00	0.00	186.15

Plan Survey Tool Program	Date	12/28/2017		
Depth From (ft)	Depth To (ft)	Survey (Wellbore)	Tool Name	Remarks
1	0.00	12,834.14 Plan 2 (OH)	MWD	
			OWSG MWD - Standard	

Plan Sections										
Measured Depth (ft)	Inclination (°)	Azimuth (°)	Vertical Depth (ft)	+N/-S (ft)	+E/-W (ft)	Dogleg Rate (°/100ft)	Build Rate (°/100ft)	Turn Rate (°/100ft)	TFO (°)	Target
0.00	0.00	0.00	0.00	0.00	0.00	0.00	0.00	0.00	0.00	
200.00	0.00	0.00	200.00	0.00	0.00	0.00	0.00	0.00	0.00	
751.25	11.03	330.53	747.86	46.03	-26.02	2.00	2.00	0.00	330.53	
5,543.99	11.03	330.53	5,452.14	843.97	-476.98	0.00	0.00	0.00	0.00	
6,095.25	0.00	0.00	6,000.00	890.00	-503.00	2.00	-2.00	0.00	180.00	
6,508.63	0.00	0.00	6,413.38	890.00	-503.00	0.00	0.00	0.00	0.00	
7,511.02	90.22	180.41	7,050.00	251.01	-507.63	9.00	9.00	-17.92	180.41	
12,834.39	90.22	180.41	7,030.00	-5,072.19	-546.16	0.00	0.00	0.00	0.00	PBHL_Jackson 02N-6



Database: EDM 5000.14 Single User Db
Company: Verdad Resources LLC
Project: SEC 33 T2N R64W
Site: Jackson 02N-64W-33 Pad
Well: Jackson 33-1H
Wellbore: OH
Design: Plan 2

Local Co-ordinate Reference:
TVD Reference:
MD Reference:
North Reference:
Survey Calculation Method:

Well Jackson 33-1H
 WELL @ 5017.00ft (Original Well Elev)
 WELL @ 5017.00ft (Original Well Elev)
 True
 Minimum Curvature

Planned Survey

Measured Depth (ft)	Inclination (°)	Azimuth (°)	Vertical Depth (ft)	+N/-S (ft)	+E/-W (ft)	Vertical Section (ft)	Dogleg Rate (°/100ft)	Build Rate (°/100ft)	Turn Rate (°/100ft)
0.00	0.00	0.00	0.00	0.00	0.00	0.00	0.00	0.00	0.00
100.00	0.00	0.00	100.00	0.00	0.00	0.00	0.00	0.00	0.00
200.00	0.00	0.00	200.00	0.00	0.00	0.00	0.00	0.00	0.00
300.00	2.00	330.53	299.98	1.52	-0.86	-1.42	2.00	2.00	0.00
400.00	4.00	330.53	399.84	6.08	-3.43	-5.67	2.00	2.00	0.00
500.00	6.00	330.53	499.45	13.66	-7.72	-12.76	2.00	2.00	0.00
600.00	8.00	330.53	598.70	24.27	-13.72	-22.66	2.00	2.00	0.00
700.00	10.00	330.53	697.47	37.89	-21.41	-35.38	2.00	2.00	0.00
751.25	11.03	330.53	747.86	46.03	-26.02	-42.98	2.00	2.00	0.00
800.00	11.03	330.53	795.71	54.15	-30.60	-50.56	0.00	0.00	0.00
900.00	11.03	330.53	893.86	70.80	-40.01	-66.11	0.00	0.00	0.00
1,000.00	11.03	330.53	992.02	87.44	-49.42	-81.65	0.00	0.00	0.00
1,100.00	11.03	330.53	1,090.17	104.09	-58.83	-97.20	0.00	0.00	0.00
1,200.00	11.03	330.53	1,188.32	120.74	-68.24	-112.74	0.00	0.00	0.00
1,300.00	11.03	330.53	1,286.48	137.39	-77.65	-128.29	0.00	0.00	0.00
1,400.00	11.03	330.53	1,384.63	154.04	-87.06	-143.83	0.00	0.00	0.00
1,500.00	11.03	330.53	1,482.79	170.69	-96.47	-159.38	0.00	0.00	0.00
1,600.00	11.03	330.53	1,580.94	187.34	-105.88	-174.93	0.00	0.00	0.00
1,700.00	11.03	330.53	1,679.10	203.99	-115.29	-190.47	0.00	0.00	0.00
1,721.30	11.03	330.53	1,700.00	207.53	-117.29	-193.78	0.00	0.00	0.00
9 5/8" Surface									
1,800.00	11.03	330.53	1,777.25	220.64	-124.70	-206.02	0.00	0.00	0.00
1,900.00	11.03	330.53	1,875.41	237.29	-134.11	-221.56	0.00	0.00	0.00
2,000.00	11.03	330.53	1,973.56	253.93	-143.52	-237.11	0.00	0.00	0.00
2,100.00	11.03	330.53	2,071.72	270.58	-152.92	-252.66	0.00	0.00	0.00
2,200.00	11.03	330.53	2,169.87	287.23	-162.33	-268.20	0.00	0.00	0.00
2,300.00	11.03	330.53	2,268.02	303.88	-171.74	-283.75	0.00	0.00	0.00
2,400.00	11.03	330.53	2,366.18	320.53	-181.15	-299.29	0.00	0.00	0.00
2,500.01	11.03	330.53	2,464.33	337.18	-190.56	-314.84	0.00	0.00	0.00
2,600.01	11.03	330.53	2,562.49	353.83	-199.97	-330.39	0.00	0.00	0.00
2,700.01	11.03	330.53	2,660.64	370.48	-209.38	-345.93	0.00	0.00	0.00
2,800.01	11.03	330.53	2,758.80	387.13	-218.79	-361.48	0.00	0.00	0.00
2,900.01	11.03	330.53	2,856.95	403.77	-228.20	-377.02	0.00	0.00	0.00
3,000.01	11.03	330.53	2,955.11	420.42	-237.61	-392.57	0.00	0.00	0.00
3,100.01	11.03	330.53	3,053.26	437.07	-247.02	-408.11	0.00	0.00	0.00
3,200.01	11.03	330.53	3,151.42	453.72	-256.43	-423.66	0.00	0.00	0.00
3,300.01	11.03	330.53	3,249.57	470.37	-265.84	-439.21	0.00	0.00	0.00
3,400.01	11.03	330.53	3,347.72	487.02	-275.25	-454.75	0.00	0.00	0.00
3,500.01	11.03	330.53	3,445.88	503.67	-284.66	-470.30	0.00	0.00	0.00
3,600.01	11.03	330.53	3,544.03	520.32	-294.07	-485.84	0.00	0.00	0.00
3,700.01	11.03	330.53	3,642.19	536.97	-303.48	-501.39	0.00	0.00	0.00
3,800.01	11.03	330.53	3,740.34	553.61	-312.89	-516.94	0.00	0.00	0.00
3,900.01	11.03	330.53	3,838.50	570.26	-322.30	-532.48	0.00	0.00	0.00
4,000.01	11.03	330.53	3,936.65	586.91	-331.70	-548.03	0.00	0.00	0.00
4,100.01	11.03	330.53	4,034.81	603.56	-341.11	-563.57	0.00	0.00	0.00
4,200.01	11.03	330.53	4,132.96	620.21	-350.52	-579.12	0.00	0.00	0.00
4,300.01	11.03	330.53	4,231.12	636.86	-359.93	-594.67	0.00	0.00	0.00
4,400.01	11.03	330.53	4,329.27	653.51	-369.34	-610.21	0.00	0.00	0.00
4,500.01	11.03	330.53	4,427.42	670.16	-378.75	-625.76	0.00	0.00	0.00
4,600.01	11.03	330.53	4,525.58	686.81	-388.16	-641.30	0.00	0.00	0.00
4,700.01	11.03	330.53	4,623.73	703.45	-397.57	-656.85	0.00	0.00	0.00
4,800.01	11.03	330.53	4,721.89	720.10	-406.98	-672.39	0.00	0.00	0.00
4,900.01	11.03	330.53	4,820.04	736.75	-416.39	-687.94	0.00	0.00	0.00
5,000.01	11.03	330.53	4,918.20	753.40	-425.80	-703.49	0.00	0.00	0.00



Database: EDM 5000.14 Single User Db
 Company: Verdad Resources LLC
 Project: SEC 33 T2N R64W
 Site: Jackson 02N-64W-33 Pad
 Well: Jackson 33-1H
 Wellbore: OH
 Design: Plan 2

Local Co-ordinate Reference: Well Jackson 33-1H
 TVD Reference: WELL @ 5017.00ft (Original Well Elev)
 MD Reference: WELL @ 5017.00ft (Original Well Elev)
 North Reference: True
 Survey Calculation Method: Minimum Curvature

Planned Survey

Measured Depth (ft)	Inclination (°)	Azimuth (°)	Vertical Depth (ft)	+N/-S (ft)	+E/-W (ft)	Vertical Section (ft)	Dogleg Rate (°/100ft)	Build Rate (°/100ft)	Turn Rate (°/100ft)
5,100.01	11.03	330.53	5,016.35	770.05	-435.21	-719.03	0.00	0.00	0.00
5,200.01	11.03	330.53	5,114.51	786.70	-444.62	-734.58	0.00	0.00	0.00
5,300.01	11.03	330.53	5,212.66	803.35	-454.03	-750.12	0.00	0.00	0.00
5,400.01	11.03	330.53	5,310.82	820.00	-463.44	-765.67	0.00	0.00	0.00
5,500.01	11.03	330.53	5,408.97	836.65	-472.85	-781.22	0.00	0.00	0.00
5,543.99	11.03	330.53	5,452.14	843.97	-476.98	-788.05	0.00	0.00	0.00
5,600.01	9.90	330.53	5,507.23	852.83	-481.99	-796.32	2.00	-2.00	0.00
5,700.01	7.90	330.53	5,606.02	866.30	-489.61	-808.91	2.00	-2.00	0.00
5,800.01	5.90	330.53	5,705.29	876.77	-495.52	-818.68	2.00	-2.00	0.00
5,900.01	3.90	330.53	5,804.91	884.21	-499.73	-825.63	2.00	-2.00	0.00
6,000.01	1.90	330.53	5,904.78	888.62	-502.22	-829.75	2.00	-2.00	0.00
6,095.25	0.00	0.00	6,000.00	890.00	-503.00	-831.03	2.00	-2.00	0.00
6,100.01	0.00	0.00	6,004.76	890.00	-503.00	-831.03	0.00	0.00	0.00
6,200.01	0.00	0.00	6,104.76	890.00	-503.00	-831.03	0.00	0.00	0.00
6,300.01	0.00	0.00	6,204.76	890.00	-503.00	-831.03	0.00	0.00	0.00
6,400.01	0.00	0.00	6,304.76	890.00	-503.00	-831.03	0.00	0.00	0.00
6,500.01	0.00	0.00	6,404.76	890.00	-503.00	-831.03	0.00	0.00	0.00
6,508.63	0.00	0.00	6,413.38	890.00	-503.00	-831.03	0.00	0.00	0.00
6,600.01	8.22	180.41	6,504.45	883.45	-503.05	-824.52	9.00	9.00	0.00
6,700.01	17.22	180.41	6,601.90	861.45	-503.21	-802.63	9.00	9.00	0.00
6,800.01	26.22	180.41	6,694.70	824.47	-503.47	-765.83	9.00	9.00	0.00
6,900.01	35.22	180.41	6,780.57	773.44	-503.84	-715.05	9.00	9.00	0.00
7,000.01	44.22	180.41	6,857.41	709.59	-504.31	-651.52	9.00	9.00	0.00
7,100.01	53.22	180.41	6,923.31	634.52	-504.85	-576.82	9.00	9.00	0.00
7,200.01	62.22	180.41	6,976.65	550.06	-505.46	-492.78	9.00	9.00	0.00
7,300.01	71.22	180.41	7,016.12	458.29	-506.12	-401.47	9.00	9.00	0.00
7,400.01	80.22	180.41	7,040.76	361.48	-506.83	-305.14	9.00	9.00	0.00
7,500.02	89.22	180.41	7,049.94	262.01	-507.55	-206.17	9.00	9.00	0.00
7,510.65	90.18	180.41	7,050.00	251.38	-507.62	-195.59	9.01	9.01	0.00
LP_Jackson 02N-64W-33-1H(0 FNL 480 FWL)									
7,511.02	90.22	180.41	7,050.00	251.01	-507.63	-195.22	9.01	9.01	0.00
7,600.02	90.22	180.41	7,049.66	162.01	-508.27	-106.67	0.00	0.00	0.00
7,700.02	90.22	180.41	7,049.29	62.02	-508.99	-7.17	0.00	0.00	0.00
7,800.02	90.22	180.41	7,048.91	-37.98	-509.72	92.33	0.00	0.00	0.00
7,900.02	90.22	180.41	7,048.53	-137.98	-510.44	191.83	0.00	0.00	0.00
8,000.02	90.22	180.41	7,048.16	-237.97	-511.17	291.33	0.00	0.00	0.00
8,100.02	90.22	180.41	7,047.78	-337.97	-511.89	390.83	0.00	0.00	0.00
8,200.02	90.22	180.41	7,047.41	-437.97	-512.61	490.33	0.00	0.00	0.00
8,300.02	90.22	180.41	7,047.03	-537.97	-513.34	589.83	0.00	0.00	0.00
8,400.02	90.22	180.41	7,046.66	-637.96	-514.06	689.33	0.00	0.00	0.00
8,500.02	90.22	180.41	7,046.28	-737.96	-514.78	788.83	0.00	0.00	0.00
8,600.02	90.22	180.41	7,045.91	-837.96	-515.51	888.33	0.00	0.00	0.00
8,700.02	90.22	180.41	7,045.53	-937.95	-516.23	987.83	0.00	0.00	0.00
8,800.02	90.22	180.41	7,045.15	-1,037.95	-516.96	1,087.33	0.00	0.00	0.00
8,900.02	90.22	180.41	7,044.78	-1,137.95	-517.68	1,186.83	0.00	0.00	0.00
9,000.02	90.22	180.41	7,044.40	-1,237.94	-518.40	1,286.33	0.00	0.00	0.00
9,100.02	90.22	180.41	7,044.03	-1,337.94	-519.13	1,385.83	0.00	0.00	0.00
9,200.02	90.22	180.41	7,043.65	-1,437.94	-519.85	1,485.33	0.00	0.00	0.00
9,300.02	90.22	180.41	7,043.28	-1,537.93	-520.57	1,584.83	0.00	0.00	0.00
9,400.02	90.22	180.41	7,042.90	-1,637.93	-521.30	1,684.33	0.00	0.00	0.00
9,500.02	90.22	180.41	7,042.52	-1,737.93	-522.02	1,783.83	0.00	0.00	0.00
9,600.02	90.22	180.41	7,042.15	-1,837.92	-522.75	1,883.33	0.00	0.00	0.00
9,700.02	90.22	180.41	7,041.77	-1,937.92	-523.47	1,982.83	0.00	0.00	0.00



Database: EDM 5000.14 Single User Db
Company: Verdad Resources LLC
Project: SEC 33 T2N R64W
Site: Jackson 02N-64W-33 Pad
Well: Jackson 33-1H
Wellbore: OH
Design: Plan 2

Local Co-ordinate Reference: Well Jackson 33-1H
TVD Reference: WELL @ 5017.00ft (Original Well Elev)
MD Reference: WELL @ 5017.00ft (Original Well Elev)
North Reference: True
Survey Calculation Method: Minimum Curvature

Planned Survey

Measured Depth (ft)	Inclination (°)	Azimuth (°)	Vertical Depth (ft)	+N/-S (ft)	+E/-W (ft)	Vertical Section (ft)	Dogleg Rate (°/100ft)	Build Rate (°/100ft)	Turn Rate (°/100ft)
9,800.02	90.22	180.41	7,041.40	-2,037.92	-524.19	2,082.33	0.00	0.00	0.00
9,900.02	90.22	180.41	7,041.02	-2,137.92	-524.92	2,181.82	0.00	0.00	0.00
10,000.02	90.22	180.41	7,040.65	-2,237.91	-525.64	2,281.32	0.00	0.00	0.00
10,100.02	90.22	180.41	7,040.27	-2,337.91	-526.37	2,380.82	0.00	0.00	0.00
10,200.02	90.22	180.41	7,039.90	-2,437.91	-527.09	2,480.32	0.00	0.00	0.00
10,300.02	90.22	180.41	7,039.52	-2,537.90	-527.81	2,579.82	0.00	0.00	0.00
10,400.02	90.22	180.41	7,039.14	-2,637.90	-528.54	2,679.32	0.00	0.00	0.00
10,500.02	90.22	180.41	7,038.77	-2,737.90	-529.26	2,778.82	0.00	0.00	0.00
10,600.02	90.22	180.41	7,038.39	-2,837.89	-529.98	2,878.32	0.00	0.00	0.00
10,700.02	90.22	180.41	7,038.02	-2,937.89	-530.71	2,977.82	0.00	0.00	0.00
10,800.02	90.22	180.41	7,037.64	-3,037.89	-531.43	3,077.32	0.00	0.00	0.00
10,900.02	90.22	180.41	7,037.27	-3,137.88	-532.16	3,176.82	0.00	0.00	0.00
11,000.02	90.22	180.41	7,036.89	-3,237.88	-532.88	3,276.32	0.00	0.00	0.00
11,100.02	90.22	180.41	7,036.51	-3,337.88	-533.60	3,375.82	0.00	0.00	0.00
11,200.02	90.22	180.41	7,036.14	-3,437.87	-534.33	3,475.32	0.00	0.00	0.00
11,300.02	90.22	180.41	7,035.76	-3,537.87	-535.05	3,574.82	0.00	0.00	0.00
11,400.02	90.22	180.41	7,035.39	-3,637.87	-535.78	3,674.32	0.00	0.00	0.00
11,500.02	90.22	180.41	7,035.01	-3,737.87	-536.50	3,773.82	0.00	0.00	0.00
11,600.02	90.22	180.41	7,034.64	-3,837.86	-537.22	3,873.32	0.00	0.00	0.00
11,700.02	90.22	180.41	7,034.26	-3,937.86	-537.95	3,972.82	0.00	0.00	0.00
11,800.02	90.22	180.41	7,033.89	-4,037.86	-538.67	4,072.32	0.00	0.00	0.00
11,900.02	90.22	180.41	7,033.51	-4,137.85	-539.39	4,171.82	0.00	0.00	0.00
12,000.02	90.22	180.41	7,033.13	-4,237.85	-540.12	4,271.32	0.00	0.00	0.00
12,100.02	90.22	180.41	7,032.76	-4,337.85	-540.84	4,370.82	0.00	0.00	0.00
12,200.02	90.22	180.41	7,032.38	-4,437.84	-541.57	4,470.32	0.00	0.00	0.00
12,300.02	90.22	180.41	7,032.01	-4,537.84	-542.29	4,569.82	0.00	0.00	0.00
12,400.03	90.22	180.41	7,031.63	-4,637.84	-543.01	4,669.32	0.00	0.00	0.00
12,500.03	90.22	180.41	7,031.26	-4,737.83	-543.74	4,768.82	0.00	0.00	0.00
12,600.03	90.22	180.41	7,030.88	-4,837.83	-544.46	4,868.32	0.00	0.00	0.00
12,700.03	90.22	180.41	7,030.50	-4,937.83	-545.19	4,967.82	0.00	0.00	0.00
12,800.03	90.22	180.41	7,030.13	-5,037.82	-545.91	5,067.32	0.00	0.00	0.00
12,834.39	90.22	180.41	7,030.00	-5,072.19	-546.16	5,101.51	0.00	0.00	0.00

PBHL_Jackson 02N-64W-33-1H(0 FSL 480 FWL)

Design Targets

Target Name	Dip Angle (°)	Dip Dir. (°)	TVD (ft)	+N/-S (ft)	+E/-W (ft)	Northing (usft)	Easting (usft)	Latitude	Longitude
- hit/miss target - Shape									
PBHL_Jackson 02N-64v	0.00	0.00	7,030.00	-5,072.19	-546.16	1,276,155.23	3,261,921.36	40.0876420	-104.5638590
- plan hits target center									
- Point									
LP_Jackson 02N-64W-3	0.00	0.00	7,050.00	251.37	-507.44	1,281,478.90	3,261,903.76	40.1022560	-104.5637210
- plan misses target center by 0.19ft at 7510.65ft MD (7050.00 TVD, 251.38 N, -507.62 E)									
- Point									



Database:	EDM 5000.14 Single User Db	Local Co-ordinate Reference:	Well Jackson 33-1H
Company:	Verdad Resources LLC	TVD Reference:	WELL @ 5017.00ft (Original Well Elev)
Project:	SEC 33 T2N R64W	MD Reference:	WELL @ 5017.00ft (Original Well Elev)
Site:	Jackson 02N-64W-33 Pad	North Reference:	True
Well:	Jackson 33-1H	Survey Calculation Method:	Minimum Curvature
Wellbore:	OH		
Design:	Plan 2		

Casing Points					
Measured Depth (ft)	Vertical Depth (ft)	Name	Casing Diameter (in)	Hole Diameter (in)	
1,721.30	1,700.00	9 5/8" Surface	9.625	13.500	
12,834.40		5 1/2"	5.500	8.500	

Plan Annotations					
Measured Depth (ft)	Vertical Depth (ft)	Local Coordinates			
		+N/-S (ft)	+E/-W (ft)	Comment	
200.00	200.00	0.00	0.00	Start Build 2.00	
751.25	747.86	46.03	-26.02	Start 4792.74 hold at 751.25 MD	
5,543.99	5,452.14	843.97	-476.98	Start Drop -2.00	
6,095.25	6,000.00	890.00	-503.00	Start 413.38 hold at 6095.25 MD	
6,508.63	6,413.38	890.00	-503.00	Start DLS 9.00 TFO 180.41	
7,511.02	7,050.00	251.01	-507.63	Start 5323.38 hold at 7511.02 MD	
12,834.39	7,030.00	-5,072.19	-546.16	TD at 12834.40	