



Project: SEC 33 T2N R64W
Site: Jackson 02N-64W-33 Pad
Well: Jackson 33-3H
Wellbore: OH
Design: Plan 3
Lat: 40.1015220
Long: -104.5617760

LP_Jackson 33-3H(0 FNL 1020 FWL)

9 5/8"

-500

0

-500

-1000

-1500

-2000

-2500

-3000

-3500

-4000

-4500

-5000

-5500

South(-)/North(+) (1000 ft/in)

SEC 33

PBHL_Jackson 33-3H(0 FSL 1020 FWL)

5 1/2"

-3000 -2500 -2000 -1500 -1000 -500 0 500

West(-)/East(+) (1000 ft/in)

Vertical Section at 180.49° (1300 ft/in)

SECTION DETAILS

MD	Inc	Azi	TVD	+N/-S	+E/-W	Dleg	TFace	VSect	Target
0.00	0.00	0.00	0.00	0.00	0.00	0.00	0.00	0.00	
200.00	0.00	0.00	200.00	0.00	0.00	0.00	0.00	0.00	
679.52	9.59	358.68	677.29	40.03	-0.92	2.00	358.68	-40.02	
5593.63	9.59	358.68	5522.71	858.52	-19.75	0.00	0.00	-858.32	
6073.15	0.00	0.00	6000.00	898.55	-20.67	2.00	180.00	-898.34	
6636.54	0.00	0.00	6563.39	898.55	-20.67	0.00	0.00	-898.34	
7639.31	90.25	178.55	7200.00	259.37	-4.48	9.00	178.55	-259.32	
11963.10	90.25	178.55	7181.20	-4063.00	105.00	0.00	0.00	4061.96	
12494.30	90.00	191.99	7180.03	-4590.73	56.31	2.53	91.03	4590.09	
12971.24	90.00	191.99	7180.00	-5057.27	-42.81	0.00	0.00	5057.45	PBHL

DESIGN TARGET DETAILS

Name	TVD	+N/-S	+E/-W	Northing	Easting	Latitude	Longitude	Shape
PBHL	7180.00	-5057.27	-42.81	1276159.85	3262461.34	40.0876390	-104.5619290	Point
- plan hits target center								
LP	7200.00	259.38	-4.48	1281476.59	3262443.42	40.1022340	-104.5617920	Point
- plan misses target center by 0.01ft at 7639.30ft MD (7200.00 TVD, 259.38 N, -4.48 E)								

PROJECT DETAILS: SEC 33 T2N R64W

Geodetic System: US State Plane 1983
Datum: North American Datum 1983
Ellipsoid: GRS 1980
Zone: Colorado Northern Zone
Colorado Northern Zone
System Datum: Mean Sea Level

CASING DETAILS

TVD	MD	Name	Size
1700.00	1716.73	9 5/8"	9.625
7180.00	12971.25	5 1/2"	5.500



Azimuths to True North
Magnetic North: 8.09°

Magnetic Field
Strength: 52264.2snT
Dip Angle: 66.65°
Date: 5/24/2017
Model: IGRF2015

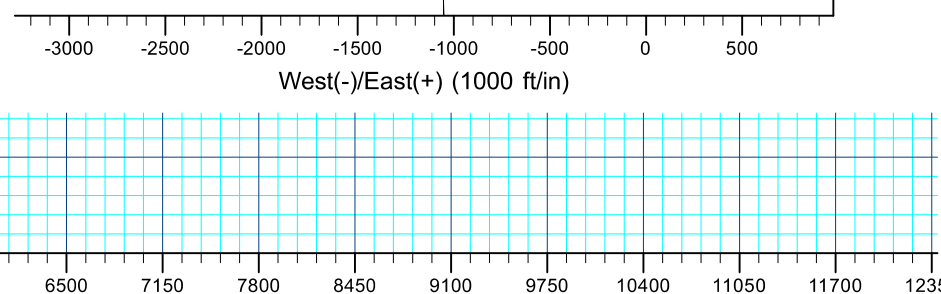
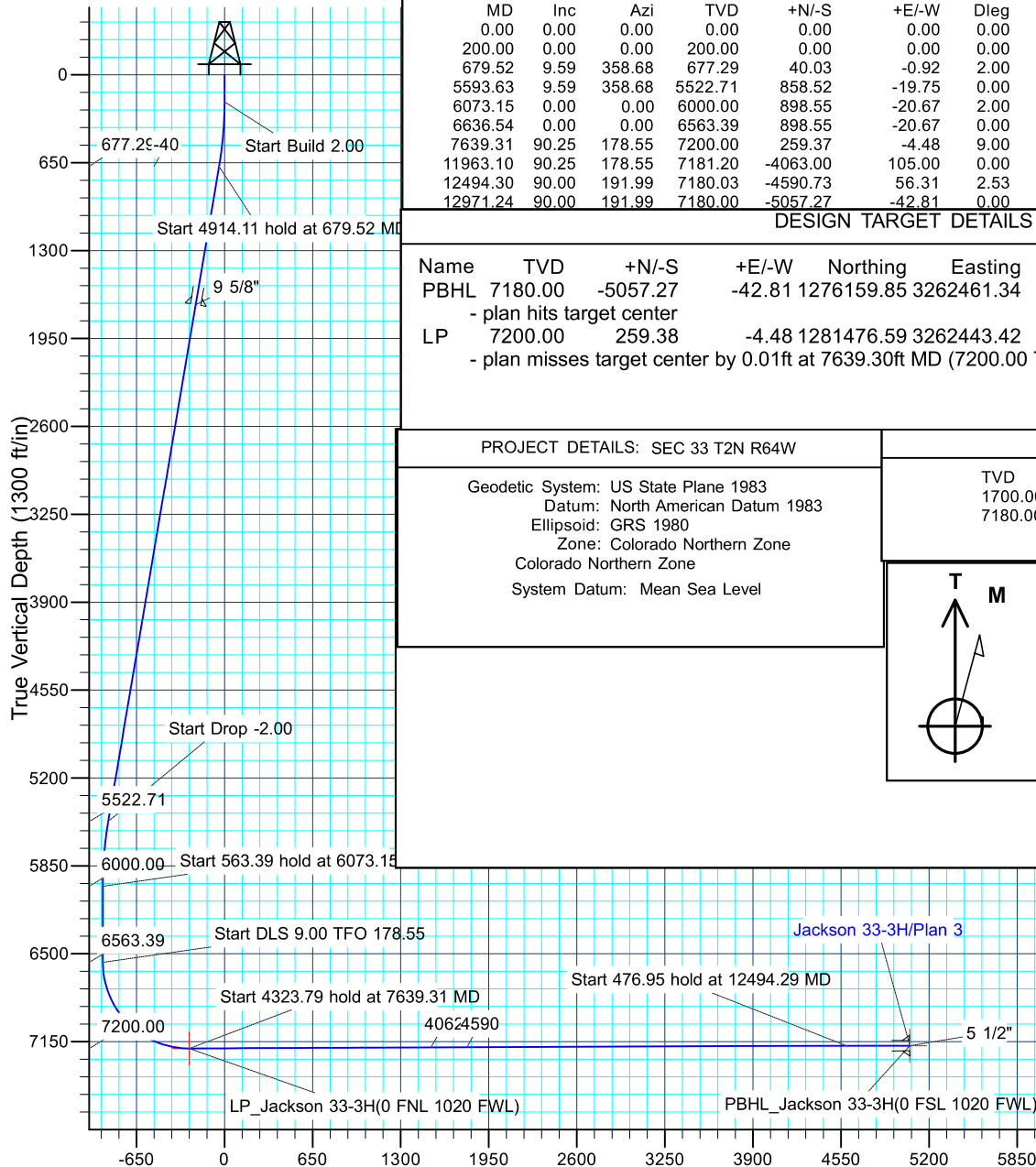

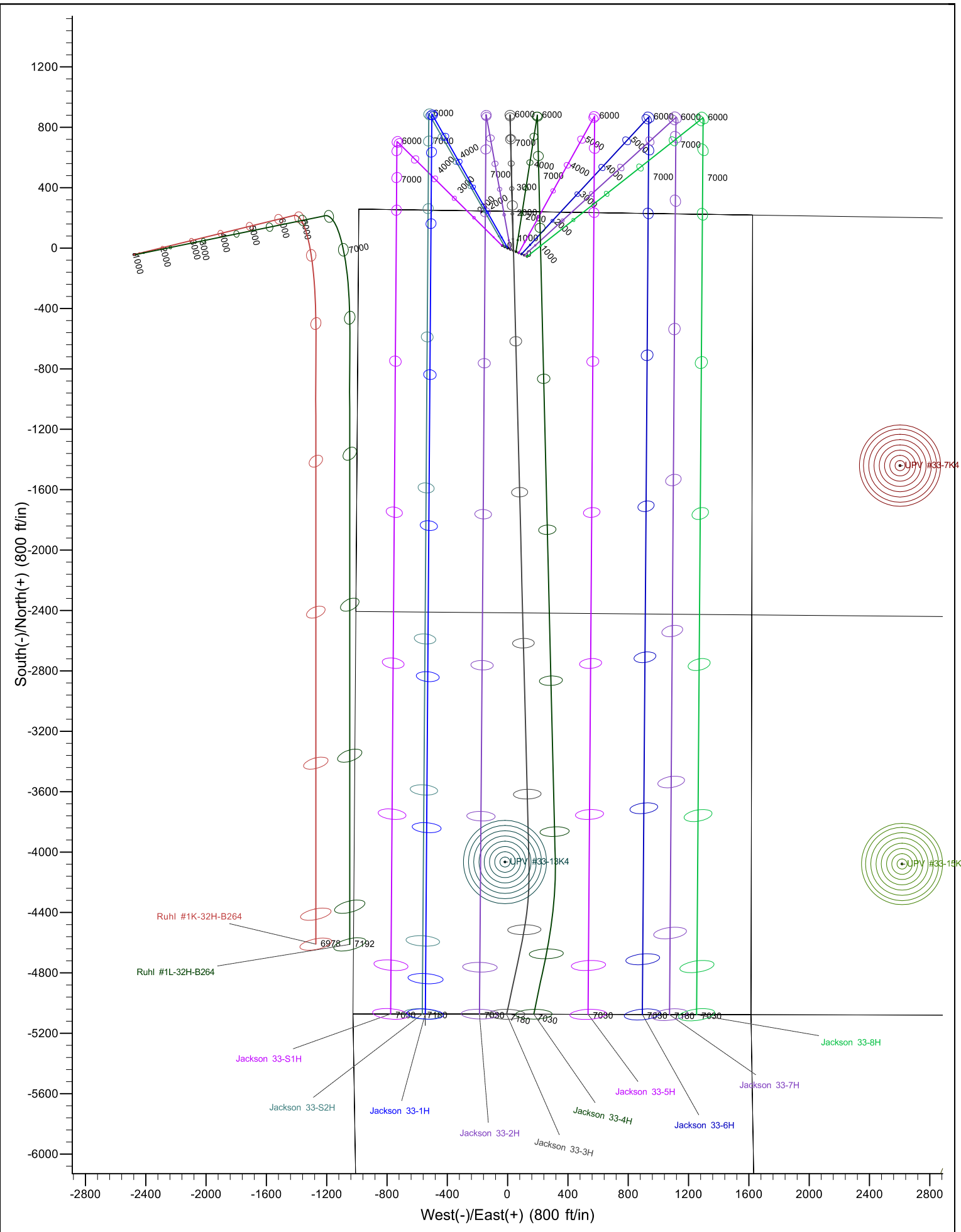



Verdad Resources LLC

SEC 33 T2N R64W

Jackson 02N-64W-33 Pad

Jackson 33-3H

OH

Plan: Plan 3

Standard Planning Report

28 December, 2017





Database:	EDM 5000.14 Single User Db	Local Co-ordinate Reference:	Well Jackson 33-3H
Company:	Verdad Resources LLC	TVD Reference:	WELL @ 5017.00ft (Original Well Elev)
Project:	SEC 33 T2N R64W	MD Reference:	WELL @ 5017.00ft (Original Well Elev)
Site:	Jackson 02N-64W-33 Pad	North Reference:	True
Well:	Jackson 33-3H	Survey Calculation Method:	Minimum Curvature
Wellbore:	OH		
Design:	Plan 3		

Project	SEC 33 T2N R64W		
Map System:	US State Plane 1983	System Datum:	Mean Sea Level
Geo Datum:	North American Datum 1983		
Map Zone:	Colorado Northern Zone		

Site	Jackson 02N-64W-33 Pad			
Site Position:		Northing:	1,281,248.57 usft	Latitude: 40.1016100
From:	Lat/Long	Easting:	3,262,377.29 usft	Longitude: -104.5620370
Position Uncertainty:	3.28 ft	Slot Radius:	13.200 in	Grid Convergence: 0.61 °

Well	Jackson 33-3H, 244 FNL 990 FWL			
Well Position	+N/-S	-32.07 ft	Northing:	1,281,217.27 usft
	+E/-W	73.01 ft	Easting:	3,262,450.64 usft
Position Uncertainty		3.28 ft	Wellhead Elevation:	Ground Level: 5,017.00 ft

Wellbore	OH				
Magnetics	Model Name	Sample Date	Declination (°)	Dip Angle (°)	Field Strength (nT)
	IGRF2015	5/24/2017	8.08	66.65	52,264

Design	Plan 3			
Audit Notes:				
Version:	Phase:	PLAN	Tie On Depth:	0.00
Vertical Section:	Depth From (TVD) (ft)	+N/-S (ft)	+E/-W (ft)	Direction (°)
	0.00	0.00	0.00	180.49

Plan Survey Tool Program	Date	12/22/2017		
Depth From (ft)	Depth To (ft)	Survey (Wellbore)	Tool Name	Remarks
1	0.00	12,971.13 Plan 3 (OH)	MWD	
			OWSG MWD - Standard	



Database:	EDM 5000.14 Single User Db	Local Co-ordinate Reference:	Well Jackson 33-3H
Company:	Verdad Resources LLC	TVD Reference:	WELL @ 5017.00ft (Original Well Elev)
Project:	SEC 33 T2N R64W	MD Reference:	WELL @ 5017.00ft (Original Well Elev)
Site:	Jackson 02N-64W-33 Pad	North Reference:	True
Well:	Jackson 33-3H	Survey Calculation Method:	Minimum Curvature
Wellbore:	OH		
Design:	Plan 3		

Plan Sections										
Measured Depth (ft)	Inclination (°)	Azimuth (°)	Vertical Depth (ft)	+N/-S (ft)	+E/-W (ft)	Dogleg Rate (°/100ft)	Build Rate (°/100ft)	Turn Rate (°/100ft)	TFO (°)	Target
0.00	0.00	0.00	0.00	0.00	0.00	0.00	0.00	0.00	0.00	
200.00	0.00	0.00	200.00	0.00	0.00	0.00	0.00	0.00	0.00	
679.52	9.59	358.68	677.29	40.03	-0.92	2.00	2.00	0.00	358.68	
5,593.63	9.59	358.68	5,522.71	858.52	-19.75	0.00	0.00	0.00	0.00	
6,073.15	0.00	0.00	6,000.00	898.55	-20.67	2.00	-2.00	0.00	180.00	
6,636.54	0.00	0.00	6,563.39	898.55	-20.67	0.00	0.00	0.00	0.00	
7,639.31	90.25	178.55	7,200.00	259.37	-4.48	9.00	9.00	17.81	178.55	
11,963.10	90.25	178.55	7,181.20	-4,063.00	105.00	0.00	0.00	0.00	0.00	
12,494.30	90.00	191.99	7,180.03	-4,590.73	56.31	2.53	-0.05	2.53	91.03	
12,971.24	90.00	191.99	7,180.00	-5,057.27	-42.81	0.00	0.00	0.00	0.00	PBHL_Jackson 33-3H



Database: EDM 5000.14 Single User Db
Company: Verdad Resources LLC
Project: SEC 33 T2N R64W
Site: Jackson 02N-64W-33 Pad
Well: Jackson 33-3H
Wellbore: OH
Design: Plan 3

Local Co-ordinate Reference: Well Jackson 33-3H
TVD Reference: WELL @ 5017.00ft (Original Well Elev)
MD Reference: WELL @ 5017.00ft (Original Well Elev)
North Reference: True
Survey Calculation Method: Minimum Curvature

Planned Survey

Measured Depth (ft)	Inclination (°)	Azimuth (°)	Vertical Depth (ft)	+N/-S (ft)	+E/-W (ft)	Vertical Section (ft)	Dogleg Rate (°/100ft)	Build Rate (°/100ft)	Turn Rate (°/100ft)
0.00	0.00	0.00	0.00	0.00	0.00	0.00	0.00	0.00	0.00
100.00	0.00	0.00	100.00	0.00	0.00	0.00	0.00	0.00	0.00
200.00	0.00	0.00	200.00	0.00	0.00	0.00	0.00	0.00	0.00
300.00	2.00	358.68	299.98	1.74	-0.04	-1.74	2.00	2.00	0.00
400.00	4.00	358.68	399.84	6.98	-0.16	-6.98	2.00	2.00	0.00
500.00	6.00	358.68	499.45	15.69	-0.36	-15.69	2.00	2.00	0.00
600.00	8.00	358.68	598.70	27.87	-0.64	-27.87	2.00	2.00	0.00
679.52	9.59	358.68	677.29	40.03	-0.92	-40.02	2.00	2.00	0.00
700.00	9.59	358.68	697.48	43.44	-1.00	-43.43	0.00	0.00	0.00
800.00	9.59	358.68	796.08	60.10	-1.38	-60.08	0.00	0.00	0.00
900.00	9.59	358.68	894.68	76.75	-1.77	-76.73	0.00	0.00	0.00
1,000.00	9.59	358.68	993.29	93.41	-2.15	-93.39	0.00	0.00	0.00
1,100.00	9.59	358.68	1,091.89	110.06	-2.53	-110.04	0.00	0.00	0.00
1,200.00	9.59	358.68	1,190.49	126.72	-2.92	-126.69	0.00	0.00	0.00
1,300.00	9.59	358.68	1,289.09	143.38	-3.30	-143.34	0.00	0.00	0.00
1,400.00	9.59	358.68	1,387.70	160.03	-3.68	-159.99	0.00	0.00	0.00
1,500.00	9.59	358.68	1,486.30	176.69	-4.06	-176.65	0.00	0.00	0.00
1,600.00	9.59	358.68	1,584.90	193.34	-4.45	-193.30	0.00	0.00	0.00
1,700.00	9.59	358.68	1,683.51	210.00	-4.83	-209.95	0.00	0.00	0.00
1,716.73	9.59	358.68	1,700.00	212.79	-4.89	-212.74	0.00	0.00	0.00
9 5/8"									
1,800.00	9.59	358.68	1,782.11	226.66	-5.21	-226.60	0.00	0.00	0.00
1,900.00	9.59	358.68	1,880.71	243.31	-5.60	-243.26	0.00	0.00	0.00
2,000.00	9.59	358.68	1,979.31	259.97	-5.98	-259.91	0.00	0.00	0.00
2,100.00	9.59	358.68	2,077.92	276.62	-6.36	-276.56	0.00	0.00	0.00
2,200.00	9.59	358.68	2,176.52	293.28	-6.75	-293.21	0.00	0.00	0.00
2,300.00	9.59	358.68	2,275.12	309.94	-7.13	-309.86	0.00	0.00	0.00
2,400.00	9.59	358.68	2,373.72	326.59	-7.51	-326.52	0.00	0.00	0.00
2,500.01	9.59	358.68	2,472.33	343.25	-7.90	-343.17	0.00	0.00	0.00
2,600.01	9.59	358.68	2,570.93	359.90	-8.28	-359.82	0.00	0.00	0.00
2,700.01	9.59	358.68	2,669.53	376.56	-8.66	-376.47	0.00	0.00	0.00
2,800.01	9.59	358.68	2,768.13	393.22	-9.05	-393.12	0.00	0.00	0.00
2,900.01	9.59	358.68	2,866.74	409.87	-9.43	-409.78	0.00	0.00	0.00
3,000.01	9.59	358.68	2,965.34	426.53	-9.81	-426.43	0.00	0.00	0.00
3,100.01	9.59	358.68	3,063.94	443.18	-10.19	-443.08	0.00	0.00	0.00
3,200.01	9.59	358.68	3,162.54	459.84	-10.58	-459.73	0.00	0.00	0.00
3,300.01	9.59	358.68	3,261.15	476.50	-10.96	-476.39	0.00	0.00	0.00
3,400.01	9.59	358.68	3,359.75	493.15	-11.34	-493.04	0.00	0.00	0.00
3,500.01	9.59	358.68	3,458.35	509.81	-11.73	-509.69	0.00	0.00	0.00
3,600.01	9.59	358.68	3,556.95	526.46	-12.11	-526.34	0.00	0.00	0.00
3,700.01	9.59	358.68	3,655.56	543.12	-12.49	-542.99	0.00	0.00	0.00
3,800.01	9.59	358.68	3,754.16	559.78	-12.88	-559.65	0.00	0.00	0.00
3,900.01	9.59	358.68	3,852.76	576.43	-13.26	-576.30	0.00	0.00	0.00
4,000.01	9.59	358.68	3,951.36	593.09	-13.64	-592.95	0.00	0.00	0.00
4,100.01	9.59	358.68	4,049.97	609.74	-14.03	-609.60	0.00	0.00	0.00
4,200.01	9.59	358.68	4,148.57	626.40	-14.41	-626.26	0.00	0.00	0.00
4,300.01	9.59	358.68	4,247.17	643.06	-14.79	-642.91	0.00	0.00	0.00
4,400.01	9.59	358.68	4,345.77	659.71	-15.18	-659.56	0.00	0.00	0.00
4,500.01	9.59	358.68	4,444.38	676.37	-15.56	-676.21	0.00	0.00	0.00
4,600.01	9.59	358.68	4,542.98	693.02	-15.94	-692.86	0.00	0.00	0.00
4,700.01	9.59	358.68	4,641.58	709.68	-16.33	-709.52	0.00	0.00	0.00
4,800.01	9.59	358.68	4,740.19	726.34	-16.71	-726.17	0.00	0.00	0.00
4,900.01	9.59	358.68	4,838.79	742.99	-17.09	-742.82	0.00	0.00	0.00
5,000.01	9.59	358.68	4,937.39	759.65	-17.47	-759.47	0.00	0.00	0.00



Database:	EDM 5000.14 Single User Db	Local Co-ordinate Reference:	Well Jackson 33-3H
Company:	Verdad Resources LLC	TVD Reference:	WELL @ 5017.00ft (Original Well Elev)
Project:	SEC 33 T2N R64W	MD Reference:	WELL @ 5017.00ft (Original Well Elev)
Site:	Jackson 02N-64W-33 Pad	North Reference:	True
Well:	Jackson 33-3H	Survey Calculation Method:	Minimum Curvature
Wellbore:	OH		
Design:	Plan 3		

Planned Survey									
Measured Depth (ft)	Inclination (°)	Azimuth (°)	Vertical Depth (ft)	+N/-S (ft)	+E/-W (ft)	Vertical Section (ft)	Dogleg Rate (°/100ft)	Build Rate (°/100ft)	Turn Rate (°/100ft)
5,100.01	9.59	358.68	5,035.99	776.30	-17.86	-776.13	0.00	0.00	0.00
5,200.01	9.59	358.68	5,134.60	792.96	-18.24	-792.78	0.00	0.00	0.00
5,300.01	9.59	358.68	5,233.20	809.62	-18.62	-809.43	0.00	0.00	0.00
5,400.01	9.59	358.68	5,331.80	826.27	-19.01	-826.08	0.00	0.00	0.00
5,500.01	9.59	358.68	5,430.40	842.93	-19.39	-842.73	0.00	0.00	0.00
5,593.63	9.59	358.68	5,522.71	858.52	-19.75	-858.32	0.00	0.00	0.00
5,600.01	9.46	358.68	5,529.01	859.58	-19.77	-859.38	2.00	-2.00	0.00
5,700.01	7.46	358.68	5,627.91	874.29	-20.11	-874.09	2.00	-2.00	0.00
5,800.01	5.46	358.68	5,727.27	885.54	-20.37	-885.34	2.00	-2.00	0.00
5,900.01	3.46	358.68	5,826.97	893.32	-20.55	-893.11	2.00	-2.00	0.00
6,000.01	1.46	358.68	5,926.87	897.62	-20.65	-897.41	2.00	-2.00	0.00
6,073.15	0.00	0.00	6,000.00	898.55	-20.67	-898.34	2.00	-2.00	0.00
6,100.01	0.00	0.00	6,026.86	898.55	-20.67	-898.34	0.00	0.00	0.00
6,200.01	0.00	0.00	6,126.86	898.55	-20.67	-898.34	0.00	0.00	0.00
6,300.01	0.00	0.00	6,226.86	898.55	-20.67	-898.34	0.00	0.00	0.00
6,400.01	0.00	0.00	6,326.86	898.55	-20.67	-898.34	0.00	0.00	0.00
6,500.01	0.00	0.00	6,426.86	898.55	-20.67	-898.34	0.00	0.00	0.00
6,600.01	0.00	0.00	6,526.86	898.55	-20.67	-898.34	0.00	0.00	0.00
6,636.54	0.00	0.00	6,563.39	898.55	-20.67	-898.34	0.00	0.00	0.00
6,700.01	5.71	178.55	6,626.76	895.39	-20.59	-895.18	9.00	9.00	0.00
6,800.01	14.71	178.55	6,725.07	877.68	-20.14	-877.48	9.00	9.00	0.00
6,900.01	23.71	178.55	6,819.40	844.82	-19.31	-844.63	9.00	9.00	0.00
7,000.01	32.71	178.55	6,907.43	797.61	-18.11	-797.43	9.00	9.00	0.00
7,100.01	41.71	178.55	6,986.99	737.21	-16.58	-737.05	9.00	9.00	0.00
7,200.01	50.71	178.55	7,056.12	665.12	-14.76	-664.97	9.00	9.00	0.00
7,300.01	59.71	178.55	7,113.11	583.10	-12.68	-582.98	9.00	9.00	0.00
7,400.01	68.71	178.55	7,156.57	493.18	-10.40	-493.08	9.00	9.00	0.00
7,500.02	77.71	178.55	7,185.43	397.57	-7.98	-397.49	9.00	9.00	0.00
7,600.02	86.71	178.55	7,198.96	298.63	-5.47	-298.57	9.00	9.00	0.00
7,639.30	90.25	178.55	7,200.00	259.38	-4.48	-259.33	9.00	9.00	0.00
LP_Jackson 33-3H(0 FNL 1020 FWL)									
7,639.31	90.25	178.55	7,200.00	259.37	-4.48	-259.32	9.00	9.00	0.00
7,700.02	90.25	178.55	7,199.74	198.68	-2.94	-198.65	0.00	0.00	0.00
7,800.02	90.25	178.55	7,199.31	98.71	-0.41	-98.71	0.00	0.00	0.00
7,900.02	90.25	178.55	7,198.87	-1.25	2.12	1.23	0.00	0.00	0.00
8,000.02	90.25	178.55	7,198.44	-101.22	4.65	101.18	0.00	0.00	0.00
8,100.02	90.25	178.55	7,198.00	-201.19	7.18	201.12	0.00	0.00	0.00
8,200.02	90.25	178.55	7,197.57	-301.15	9.72	301.06	0.00	0.00	0.00
8,300.02	90.25	178.55	7,197.13	-401.12	12.25	401.00	0.00	0.00	0.00
8,400.02	90.25	178.55	7,196.70	-501.09	14.78	500.94	0.00	0.00	0.00
8,500.02	90.25	178.55	7,196.26	-601.06	17.31	600.89	0.00	0.00	0.00
8,600.02	90.25	178.55	7,195.83	-701.02	19.85	700.83	0.00	0.00	0.00
8,700.02	90.25	178.55	7,195.39	-800.99	22.38	800.77	0.00	0.00	0.00
8,800.02	90.25	178.55	7,194.96	-900.96	24.91	900.71	0.00	0.00	0.00
8,900.02	90.25	178.55	7,194.52	-1,000.92	27.44	1,000.66	0.00	0.00	0.00
9,000.02	90.25	178.55	7,194.09	-1,100.89	29.97	1,100.60	0.00	0.00	0.00
9,100.02	90.25	178.55	7,193.65	-1,200.86	32.51	1,200.54	0.00	0.00	0.00
9,200.02	90.25	178.55	7,193.22	-1,300.83	35.04	1,300.48	0.00	0.00	0.00
9,300.02	90.25	178.55	7,192.78	-1,400.79	37.57	1,400.42	0.00	0.00	0.00
9,400.02	90.25	178.55	7,192.35	-1,500.76	40.10	1,500.37	0.00	0.00	0.00
9,500.02	90.25	178.55	7,191.91	-1,600.73	42.63	1,600.31	0.00	0.00	0.00
9,600.02	90.25	178.55	7,191.48	-1,700.69	45.17	1,700.25	0.00	0.00	0.00
9,700.02	90.25	178.55	7,191.04	-1,800.66	47.70	1,800.19	0.00	0.00	0.00



Database:	EDM 5000.14 Single User Db	Local Co-ordinate Reference:	Well Jackson 33-3H
Company:	Verdad Resources LLC	TVD Reference:	WELL @ 5017.00ft (Original Well Elev)
Project:	SEC 33 T2N R64W	MD Reference:	WELL @ 5017.00ft (Original Well Elev)
Site:	Jackson 02N-64W-33 Pad	North Reference:	True
Well:	Jackson 33-3H	Survey Calculation Method:	Minimum Curvature
Wellbore:	OH		
Design:	Plan 3		

Planned Survey										
Measured Depth (ft)	Inclination (°)	Azimuth (°)	Vertical Depth (ft)	+N/-S (ft)	+E/-W (ft)	Vertical Section (ft)	Dogleg Rate (°/100ft)	Build Rate (°/100ft)	Turn Rate (°/100ft)	
9,800.02	90.25	178.55	7,190.61	-1,900.63	50.23	1,900.13	0.00	0.00	0.00	
9,900.02	90.25	178.55	7,190.17	-2,000.60	52.76	2,000.08	0.00	0.00	0.00	
10,000.02	90.25	178.55	7,189.74	-2,100.56	55.29	2,100.02	0.00	0.00	0.00	
10,100.02	90.25	178.55	7,189.30	-2,200.53	57.83	2,199.96	0.00	0.00	0.00	
10,200.02	90.25	178.55	7,188.87	-2,300.50	60.36	2,299.90	0.00	0.00	0.00	
10,300.02	90.25	178.55	7,188.43	-2,400.46	62.89	2,399.84	0.00	0.00	0.00	
10,400.02	90.25	178.55	7,188.00	-2,500.43	65.42	2,499.79	0.00	0.00	0.00	
10,500.02	90.25	178.55	7,187.56	-2,600.40	67.95	2,599.73	0.00	0.00	0.00	
10,600.02	90.25	178.55	7,187.13	-2,700.37	70.49	2,699.67	0.00	0.00	0.00	
10,700.02	90.25	178.55	7,186.69	-2,800.33	73.02	2,799.61	0.00	0.00	0.00	
10,800.02	90.25	178.55	7,186.26	-2,900.30	75.55	2,899.56	0.00	0.00	0.00	
10,900.02	90.25	178.55	7,185.82	-3,000.27	78.08	2,999.50	0.00	0.00	0.00	
11,000.02	90.25	178.55	7,185.39	-3,100.24	80.61	3,099.44	0.00	0.00	0.00	
11,100.02	90.25	178.55	7,184.95	-3,200.20	83.15	3,199.38	0.00	0.00	0.00	
11,200.02	90.25	178.55	7,184.52	-3,300.17	85.68	3,299.32	0.00	0.00	0.00	
11,300.02	90.25	178.55	7,184.08	-3,400.14	88.21	3,399.27	0.00	0.00	0.00	
11,400.02	90.25	178.55	7,183.65	-3,500.10	90.74	3,499.21	0.00	0.00	0.00	
11,500.02	90.25	178.55	7,183.21	-3,600.07	93.27	3,599.15	0.00	0.00	0.00	
11,600.02	90.25	178.55	7,182.78	-3,700.04	95.81	3,699.09	0.00	0.00	0.00	
11,700.02	90.25	178.55	7,182.34	-3,800.01	98.34	3,799.03	0.00	0.00	0.00	
11,800.02	90.25	178.55	7,181.91	-3,899.97	100.87	3,898.98	0.00	0.00	0.00	
11,900.02	90.25	178.55	7,181.47	-3,999.94	103.40	3,998.92	0.00	0.00	0.00	
11,963.10	90.25	178.55	7,181.20	-4,063.00	105.00	4,061.96	0.00	0.00	0.00	
12,000.02	90.23	179.48	7,181.05	-4,099.91	105.63	4,098.87	2.53	-0.05	2.53	
12,100.02	90.19	182.01	7,180.68	-4,199.90	104.33	4,198.86	2.53	-0.05	2.53	
12,200.02	90.14	184.55	7,180.39	-4,299.72	98.60	4,298.73	2.53	-0.05	2.53	
12,300.02	90.09	187.08	7,180.19	-4,399.20	88.48	4,398.29	2.53	-0.05	2.53	
12,400.03	90.05	189.61	7,180.07	-4,498.14	73.97	4,497.35	2.53	-0.05	2.53	
12,494.30	90.00	191.99	7,180.03	-4,590.73	56.31	4,590.09	2.53	-0.05	2.53	
12,500.03	90.00	191.99	7,180.03	-4,596.33	55.12	4,595.70	0.00	0.00	0.00	
12,600.03	90.00	191.99	7,180.02	-4,694.15	34.34	4,693.69	0.00	0.00	0.00	
12,700.03	90.00	191.99	7,180.01	-4,791.97	13.55	4,791.68	0.00	0.00	0.00	
12,800.03	90.00	191.99	7,180.01	-4,889.79	-7.23	4,889.67	0.00	0.00	0.00	
12,900.03	90.00	191.99	7,180.00	-4,987.60	-28.01	4,987.66	0.00	0.00	0.00	
12,971.24	90.00	191.99	7,180.00	-5,057.27	-42.81	5,057.45	0.00	0.00	0.00	
PBHL_Jackson 33-3H(0 FSL 1020 FWL)										

Design Targets										
Target Name	Dip Angle (°)	Dip Dir. (°)	TVD (ft)	+N/-S (ft)	+E/-W (ft)	Northing (usft)	Easting (usft)	Latitude		Longitude
PBHL_Jackson 33-3H(0 - hit/miss target - Shape - Point	0.00	0.00	7,180.00	-5,057.27	-42.81	1,276,159.85	3,262,461.34	40.0876390		-104.5619290
LP_Jackson 33-3H(0 FN - plan misses target center by 0.01ft at 7639.30ft MD (7200.00 TVD, 259.38 N, -4.48 E) - Point	0.00	0.00	7,200.00	259.38	-4.48	1,281,476.59	3,262,443.42	40.1022340		-104.5617920



Database:	EDM 5000.14 Single User Db	Local Co-ordinate Reference:	Well Jackson 33-3H
Company:	Verdad Resources LLC	TVD Reference:	WELL @ 5017.00ft (Original Well Elev)
Project:	SEC 33 T2N R64W	MD Reference:	WELL @ 5017.00ft (Original Well Elev)
Site:	Jackson 02N-64W-33 Pad	North Reference:	True
Well:	Jackson 33-3H	Survey Calculation Method:	Minimum Curvature
Wellbore:	OH		
Design:	Plan 3		

Casing Points					
Measured Depth (ft)	Vertical Depth (ft)		Name	Casing Diameter (in)	Hole Diameter (in)
1,716.73	1,700.00	9 5/8"		9.625	13.500
12,971.25	7,180.00	5 1/2"		5.500	8.500

Plan Annotations					
Measured Depth (ft)	Vertical Depth (ft)	Local Coordinates			
		+N/-S (ft)	+E/-W (ft)	Comment	
200.00	200.00	0.00	0.00	Start Build 2.00	
679.52	677.29	40.03	-0.92	Start 4914.11 hold at 679.52 MD	
5,593.63	5,522.71	858.52	-19.75	Start Drop -2.00	
6,073.15	6,000.00	898.55	-20.67	Start 563.39 hold at 6073.15 MD	
6,636.54	6,563.39	898.55	-20.67	Start DLS 9.00 TFO 178.55	
7,639.31	7,200.00	259.37	-4.48	Start 4323.79 hold at 7639.31 MD	
11,963.10	7,181.20	-4,063.00	105.00	Start DLS 2.53 TFO 91.03	
12,494.29	7,180.03	-4,590.73	56.31	Start 476.95 hold at 12494.29 MD	
12,971.24	7,180.00	-5,057.27	-42.81	TD at 12971.25	