

# KERR-MCGEE OIL & GAS ONSHORE LP (WA)

Location: COLORADO Slot: SLOT#45 CANNON 26N-9HZ(521'FNL & 387'FEL,SEC.33)  
 Field: WELD COUNTY (UTM/TRUE NORTH) Well: CANNON 26N-9HZ  
 Facility: SEC.33-T3N-R65W Wellbore: CANNON 26N-9HZ PWB

Plot reference wellpath is CANNON 26N-9HZ PWP Rev-A.0	Grid System: NAD83 / UTM Zone 13 North, US feet
True vertical depths are referenced to PD 564 (26') (RT)	* = Wellpath was transformed from a different geodetic datum
Measured depths are referenced to PD 564 (26') (RT)	North Reference: True north
PD 564 (26') (RT) to Mean Sea Level: 4862 feet	Scale: True distance
Mean Sea Level to Mud line (At Slot: SLOT#45 CANNON 26N-9HZ(521'FNL & 387'FEL,SEC.33)): 0 feet	Depths are in feet
Coordinates are in feet referenced to Slot	Created by: painsetr on 2017-09-22
	Database: WA_DEN_Anadarko_Defn

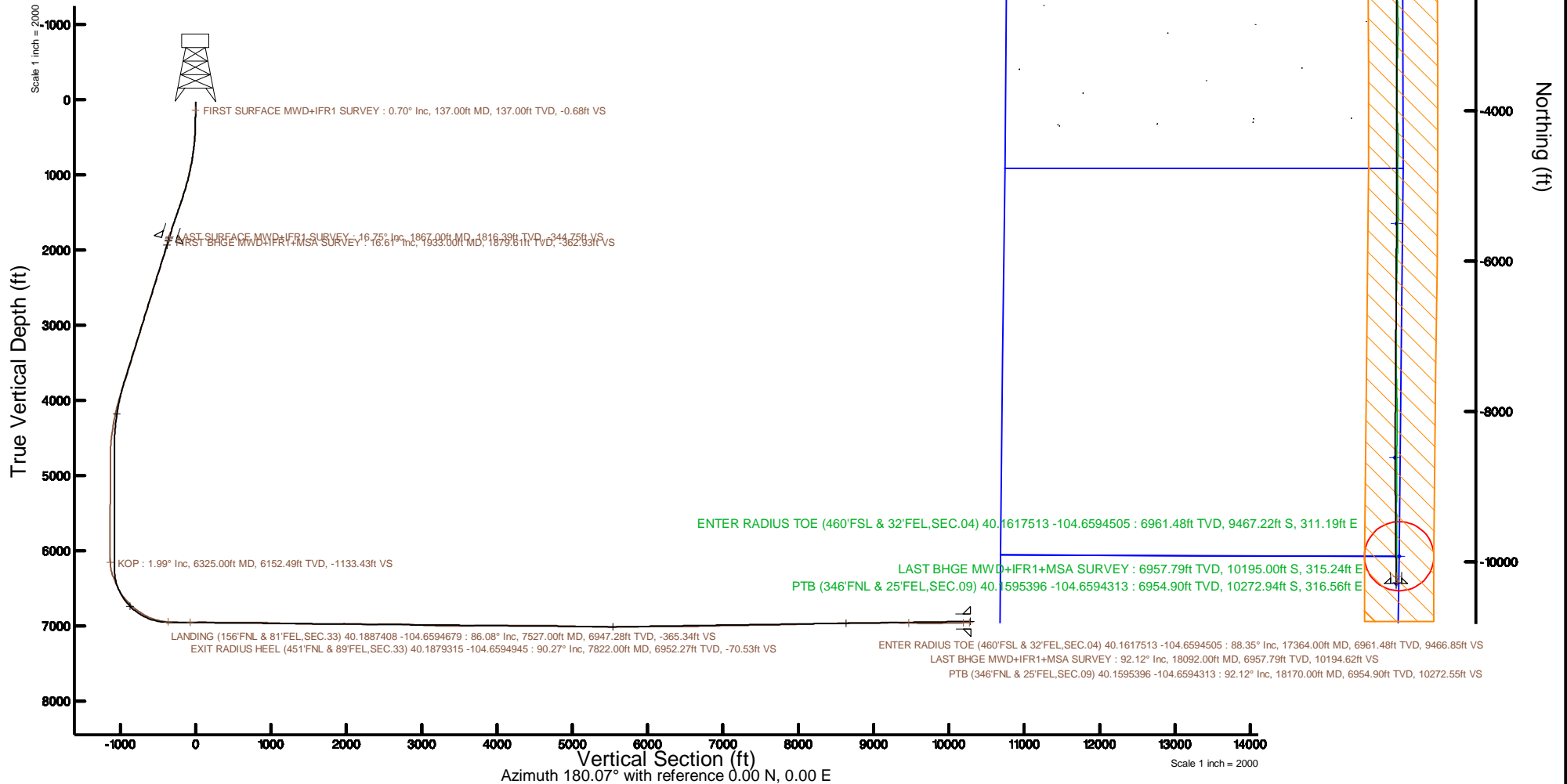

REFERENCE WELLPATH IDENTIFICATION			
Operator	KERR-MCGEE OIL & GAS ONSHORE LP (WA)	Slot	SLOT#45 CANNON 26N-9HZ(521'FNL & 387'FEL,SEC.33)
Area	COLORADO	Well	CANNON 26N-9HZ
Field	WELD COUNTY (UTM/TRUE NORTH)	Wellbore	CANNON 26N-9HZ AWB
Facility	SEC.33-T3N-R65W		

REPORT SETUP INFORMATION			
Projection System	NAD83 / UTM Zone 13 North, US feet	Software System	WellArchitect® 5.0
North Reference	True	User	Painsetr
Scale	0.999610	Report Generated	9/22/2017 at 8:30 AM
Convergence at slot	0.22° East	Database/Source file	WA_DEN_Anadarko_Defn/CANNON_26N-9HZ_AWP.xml

WELLPATH LOCATION						
	Local coordinates		Grid coordinates		Geographic coordinates	
	North[ft]	East[ft]	Easting[US ft]	Northing[US ft]	Latitude	Longitude
Slot Location	1438.63	1714.40	1735215.32	14595279.11	40°11'15.860"N	104°39'38.030"W
Facility Reference Pt			1733507.01	14593834.61	40°11'01.644"N	104°40'00.120"W
Field Reference Pt			1698235.31	14552047.82	40°04'09.600"N	104°47'36.000"W

WELLPATH DATUM			
Calculation method	Minimum curvature	PD 564 (26') (RT) to Facility Vertical Datum	4862.00ft
Horizontal Reference Pt	Slot	PD 564 (26') (RT) to Mean Sea Level	4862.00ft
Vertical Reference Pt	PD 564 (26') (RT)	PD 564 (26') (RT) to Mud Line at Slot (SLOT#45 CANNON 26N-9HZ(521'FNL & 387'FEL,SEC.33))	4862.00ft
MD Reference Pt	PD 564 (26') (RT)	Section Origin	N 0.00, E 0.00 ft
Field Vertical Reference	Mean Sea Level	Section Azimuth	180.07°

REFERENCE WELLPATH IDENTIFICATION			
Operator	KERR-MCGEE OIL & GAS ONSHORE LP (WA)	Slot	SLOT#45 CANNON 26N-9HZ(521'FNL & 387'FEL,SEC.33)
Area	COLORADO	Well	CANNON 26N-9HZ
Field	WELD COUNTY (UTM/TRUE NORTH)	Wellbore	CANNON 26N-9HZ AWB
Facility	SEC.33-T3N-R65W		

WELLPATH DATA (240 stations) † = interpolated/extrapolated station												
MD [ft]	Inclination [°]	Azimuth [°]	TVD [ft]	Vert Sect [ft]	North [ft]	East [ft]	Grid East [US ft]	Grid North [US ft]	Latitude	Longitude	DLS [°/100ft]	Comments
0.00†	0.000	4.700	0.00	0.00	0.00	0.00	1735215.32	14595279.11	40°11'15.860"N	104°39'38.030"W	0.00	
26.00	0.000	4.700	26.00	0.00	0.00	0.00	1735215.32	14595279.11	40°11'15.860"N	104°39'38.030"W	0.00	
137.00	0.700	4.700	137.00	-0.68	0.68	0.06	1735215.37	14595279.78	40°11'15.867"N	104°39'38.029"W	0.63	FIRST SURFACE MWD+IFR1 SURVEY
169.00	1.050	3.820	168.99	-1.16	1.16	0.09	1735215.41	14595280.27	40°11'15.871"N	104°39'38.029"W	1.09	
200.00	0.970	23.600	199.99	-1.69	1.69	0.22	1735215.53	14595280.79	40°11'15.877"N	104°39'38.027"W	1.15	
232.00	0.830	1.710	231.98	-2.17	2.17	0.33	1735215.64	14595281.27	40°11'15.881"N	104°39'38.026"W	1.15	
264.00	0.970	7.430	263.98	-2.67	2.67	0.37	1735215.68	14595281.77	40°11'15.886"N	104°39'38.025"W	0.52	
296.00	1.050	33.350	295.98	-3.18	3.18	0.57	1735215.88	14595282.29	40°11'15.891"N	104°39'38.023"W	1.44	
327.00	1.270	22.020	326.97	-3.74	3.74	0.85	1735216.16	14595282.84	40°11'15.897"N	104°39'38.019"W	1.02	
359.00	1.530	28.260	358.96	-4.44	4.44	1.19	1735216.49	14595283.55	40°11'15.904"N	104°39'38.015"W	0.94	
422.00	2.500	19.120	421.92	-6.48	6.48	2.04	1735217.33	14595285.59	40°11'15.924"N	104°39'38.004"W	1.62	
454.00	2.990	21.050	453.88	-7.92	7.92	2.57	1735217.86	14595287.03	40°11'15.938"N	104°39'37.997"W	1.56	
486.00	3.740	14.370	485.83	-9.71	9.71	3.12	1735218.41	14595288.82	40°11'15.956"N	104°39'37.990"W	2.64	
518.00	4.750	15.860	517.74	-12.00	11.99	3.75	1735219.02	14595291.11	40°11'15.979"N	104°39'37.982"W	3.17	
550.00	5.580	14.810	549.61	-14.78	14.77	4.51	1735219.77	14595293.89	40°11'16.006"N	104°39'37.972"W	2.61	
580.00	6.060	18.330	579.46	-17.69	17.69	5.38	1735220.63	14595296.81	40°11'16.035"N	104°39'37.961"W	1.99	
612.00	6.680	16.220	611.26	-21.08	21.08	6.43	1735221.67	14595300.20	40°11'16.068"N	104°39'37.947"W	2.07	
644.00	7.120	16.830	643.03	-24.77	24.76	7.52	1735222.75	14595303.89	40°11'16.105"N	104°39'37.933"W	1.39	
707.00	8.260	17.620	705.46	-32.82	32.81	10.02	1735225.21	14595311.94	40°11'16.184"N	104°39'37.901"W	1.82	
739.00	9.140	15.340	737.09	-37.47	37.45	11.39	1735226.56	14595316.59	40°11'16.230"N	104°39'37.883"W	2.95	
771.00	9.540	16.660	768.67	-42.46	42.45	12.82	1735227.98	14595321.58	40°11'16.279"N	104°39'37.865"W	1.42	
802.00	10.200	19.200	799.21	-47.52	47.50	14.46	1735229.60	14595326.64	40°11'16.329"N	104°39'37.844"W	2.55	
834.00	10.940	19.030	830.66	-53.07	53.05	16.38	1735231.50	14595332.19	40°11'16.384"N	104°39'37.819"W	2.31	
866.00	11.510	20.430	862.05	-58.93	58.91	18.49	1735233.58	14595338.06	40°11'16.442"N	104°39'37.792"W	1.97	
897.00	11.820	19.030	892.41	-64.83	64.81	20.60	1735235.67	14595343.97	40°11'16.500"N	104°39'37.765"W	1.35	
929.00	12.300	17.890	923.70	-71.18	71.15	22.72	1735237.76	14595350.31	40°11'16.563"N	104°39'37.737"W	1.67	
960.00	13.050	17.360	953.95	-77.66	77.63	24.78	1735239.79	14595356.80	40°11'16.627"N	104°39'37.711"W	2.45	
992.00	13.230	16.740	985.11	-84.62	84.59	26.91	1735241.90	14595363.76	40°11'16.696"N	104°39'37.683"W	0.71	
1024.00	14.150	16.920	1016.20	-91.87	91.84	29.10	1735244.06	14595371.02	40°11'16.768"N	104°39'37.655"W	2.88	
1055.00	14.590	16.390	1046.23	-99.24	99.21	31.31	1735246.24	14595378.39	40°11'16.840"N	104°39'37.627"W	1.48	
1087.00	15.340	16.220	1077.15	-107.18	107.14	33.63	1735248.53	14595386.33	40°11'16.919"N	104°39'37.597"W	2.35	
1150.00	16.130	17.090	1137.79	-123.55	123.51	38.53	1735253.36	14595402.71	40°11'17.080"N	104°39'37.534"W	1.31	
1182.00	16.480	17.620	1168.50	-132.13	132.08	41.21	1735256.01	14595411.29	40°11'17.165"N	104°39'37.499"W	1.19	
1213.00	17.620	17.010	1198.14	-140.81	140.76	43.91	1735258.68	14595419.98	40°11'17.251"N	104°39'37.464"W	3.72	
1245.00	17.890	16.130	1228.61	-150.17	150.11	46.69	1735261.42	14595429.34	40°11'17.343"N	104°39'37.428"W	1.19	
1309.00	18.720	17.710	1289.37	-169.40	169.34	52.55	1735267.20	14595448.58	40°11'17.533"N	104°39'37.353"W	1.51	
1340.00	19.250	18.590	1318.69	-178.99	178.92	55.69	1735270.31	14595458.17	40°11'17.628"N	104°39'37.312"W	1.94	
1372.00	19.860	17.450	1348.84	-189.18	189.11	59.00	1735273.58	14595468.36	40°11'17.729"N	104°39'37.270"W	2.25	
1403.00	20.040	16.480	1377.98	-199.30	199.22	62.09	1735276.62	14595478.49	40°11'17.829"N	104°39'37.230"W	1.22	
1435.00	20.480	15.950	1408.00	-209.94	209.86	65.18	1735279.68	14595489.13	40°11'17.934"N	104°39'37.190"W	1.49	
1467.00	19.860	17.360	1438.04	-220.51	220.43	68.34	1735282.79	14595499.71	40°11'18.038"N	104°39'37.149"W	2.46	
1498.00	19.200	18.060	1467.25	-230.39	230.31	71.49	1735285.91	14595509.59	40°11'18.136"N	104°39'37.109"W	2.26	
1530.00	19.560	17.710	1497.44	-240.50	240.41	74.75	1735289.13	14595519.71	40°11'18.236"N	104°39'37.067"W	1.18	
1562.00	19.820	16.570	1527.57	-250.81	250.71	77.93	1735292.26	14595530.02	40°11'18.338"N	104°39'37.026"W	1.45	
1594.00	20.080	16.300	1557.65	-261.28	261.19	81.02	1735295.31	14595540.50	40°11'18.441"N	104°39'36.986"W	0.86	

REFERENCE WELLPATH IDENTIFICATION			
Operator	KERR-MCGEE OIL & GAS ONSHORE LP (WA)	Slot	SLOT#45 CANNON 26N-9HZ(521'FNL & 387'FEL,SEC.33)
Area	COLORADO	Well	CANNON 26N-9HZ
Field	WELD COUNTY (UTM/TRUE NORTH)	Wellbore	CANNON 26N-9HZ AWB
Facility	SEC.33-T3N-R65W		

WELLPATH DATA (240 stations)												
MD [ft]	Inclination [°]	Azimuth [°]	TVD [ft]	Vert Sect [ft]	North [ft]	East [ft]	Grid East [US ft]	Grid North [US ft]	Latitude	Longitude	DLS [°/100ft]	Comments
1625.00	19.510	17.530	1586.82	-271.33	271.23	84.07	1735298.32	14595550.55	40°11'18.540"N	104°39'36.947"W	2.28	
1656.00	19.340	18.330	1616.05	-281.14	281.04	87.25	1735301.46	14595560.37	40°11'18.637"N	104°39'36.906"W	1.02	
1688.00	19.250	17.090	1646.26	-291.22	291.11	90.46	1735304.64	14595570.45	40°11'18.737"N	104°39'36.864"W	1.31	
1719.00	18.810	15.250	1675.56	-300.93	300.82	93.28	1735307.41	14595580.16	40°11'18.833"N	104°39'36.828"W	2.40	
1751.00	18.500	13.760	1705.88	-310.84	310.73	95.84	1735309.94	14595590.07	40°11'18.931"N	104°39'36.795"W	1.78	
1783.00	18.060	15.690	1736.27	-320.55	320.43	98.39	1735312.45	14595599.79	40°11'19.027"N	104°39'36.762"W	2.34	
1815.00	17.710	16.570	1766.72	-329.99	329.87	101.12	1735315.14	14595609.23	40°11'19.120"N	104°39'36.727"W	1.38	
1846.00	17.140	16.920	1796.30	-338.89	338.76	103.80	1735317.78	14595618.13	40°11'19.208"N	104°39'36.693"W	1.87	
1867.00	16.750	16.660	1816.39	-344.75	344.62	105.56	1735319.53	14595623.99	40°11'19.266"N	104°39'36.670"W	1.89	LAST SURFACE MWD+IFR1 SURVEY
1933.00	16.610	16.030	1879.61	-362.93	362.80	110.90	1735324.79	14595642.18	40°11'19.445"N	104°39'36.601"W	0.35	FIRST BHGE MWD+IFR1+MSA SURVEY
2023.00	17.850	16.890	1965.57	-388.50	388.36	118.46	1735332.25	14595667.77	40°11'19.698"N	104°39'36.504"W	1.41	
2112.00	18.640	15.960	2050.09	-415.24	415.09	126.33	1735340.02	14595694.51	40°11'19.962"N	104°39'36.402"W	0.95	
2201.00	17.790	14.050	2134.63	-442.11	441.96	133.54	1735347.12	14595721.40	40°11'20.227"N	104°39'36.309"W	1.17	
2291.00	18.040	11.100	2220.27	-469.13	468.97	139.56	1735353.04	14595748.42	40°11'20.494"N	104°39'36.232"W	1.05	
2380.00	18.620	13.330	2304.76	-496.49	496.32	145.49	1735358.86	14595775.78	40°11'20.765"N	104°39'36.155"W	1.02	
2469.00	18.390	15.590	2389.16	-523.85	523.67	152.54	1735365.80	14595803.15	40°11'21.035"N	104°39'36.064"W	0.85	
2559.00	17.460	18.510	2474.79	-550.34	550.14	160.64	1735373.80	14595829.65	40°11'21.297"N	104°39'35.960"W	1.44	
2648.00	17.610	18.650	2559.65	-575.76	575.56	169.19	1735382.24	14595855.08	40°11'21.548"N	104°39'35.850"W	0.18	
2738.00	18.560	13.650	2645.21	-602.59	602.38	176.92	1735389.87	14595881.92	40°11'21.813"N	104°39'35.750"W	2.02	
2827.00	17.280	12.750	2729.89	-629.26	629.04	183.18	1735396.03	14595908.59	40°11'22.076"N	104°39'35.670"W	1.47	
2917.00	18.310	21.610	2815.60	-655.45	655.23	191.34	1735404.08	14595934.80	40°11'22.335"N	104°39'35.565"W	3.22	
3006.00	17.870	21.740	2900.20	-681.15	680.91	201.55	1735414.19	14595960.51	40°11'22.589"N	104°39'35.433"W	0.50	
3096.00	18.450	23.540	2985.72	-707.04	706.79	212.35	1735424.89	14595986.43	40°11'22.844"N	104°39'35.294"W	0.90	
3186.00	17.880	22.630	3071.23	-732.86	732.60	223.35	1735435.79	14596012.27	40°11'23.100"N	104°39'35.152"W	0.71	
3275.00	18.720	17.340	3155.74	-759.12	758.85	232.87	1735445.20	14596038.54	40°11'23.359"N	104°39'35.029"W	2.09	
3365.00	18.690	17.730	3240.98	-786.65	786.37	241.56	1735453.78	14596066.08	40°11'23.631"N	104°39'34.917"W	0.14	
3454.00	16.710	16.890	3325.77	-812.49	812.20	249.62	1735461.74	14596091.93	40°11'23.886"N	104°39'34.813"W	2.24	
3543.00	17.080	19.800	3410.93	-837.04	836.74	257.77	1735469.79	14596116.49	40°11'24.129"N	104°39'34.709"W	1.04	
3632.00	17.570	18.090	3495.89	-862.12	861.80	266.37	1735478.29	14596141.58	40°11'24.376"N	104°39'34.598"W	0.79	
3722.00	17.910	18.330	3581.61	-888.18	887.85	274.94	1735486.76	14596167.65	40°11'24.634"N	104°39'34.487"W	0.39	
3811.00	17.600	14.730	3666.37	-914.19	913.86	282.66	1735494.38	14596193.68	40°11'24.891"N	104°39'34.388"W	1.28	
3901.00	18.710	7.670	3751.90	-941.67	941.33	288.05	1735499.66	14596221.16	40°11'25.162"N	104°39'34.318"W	2.74	
3990.00	18.040	6.520	3836.36	-969.51	969.17	291.52	1735503.02	14596249.00	40°11'25.437"N	104°39'34.274"W	0.86	
4080.00	16.910	5.650	3922.21	-996.39	996.04	294.39	1735505.79	14596275.87	40°11'25.703"N	104°39'34.237"W	1.29	
4169.00	16.740	5.350	4007.40	-1022.03	1021.68	296.86	1735508.16	14596301.51	40°11'25.956"N	104°39'34.205"W	0.21	
4258.00	13.970	3.690	4093.21	-1045.52	1045.17	298.75	1735509.96	14596325.00	40°11'26.188"N	104°39'34.180"W	3.15	
4348.00	11.820	11.310	4180.94	-1065.41	1065.05	301.26	1735512.39	14596344.88	40°11'26.385"N	104°39'34.148"W	3.04	
4438.00	10.670	11.240	4269.21	-1082.62	1082.26	304.69	1735515.75	14596362.10	40°11'26.555"N	104°39'34.104"W	1.28	
4527.00	8.750	17.810	4356.94	-1097.15	1096.79	308.36	1735519.37	14596376.64	40°11'26.698"N	104°39'34.057"W	2.49	
4617.00	8.510	20.450	4445.92	-1109.92	1109.55	312.78	1735523.74	14596389.40	40°11'26.825"N	104°39'34.000"W	0.51	
4706.00	6.330	7.100	4534.18	-1120.96	1120.59	315.69	1735526.61	14596400.45	40°11'26.934"N	104°39'33.962"W	3.11	
4796.00	4.100	30.420	4623.81	-1128.66	1128.29	317.94	1735528.82	14596408.16	40°11'27.010"N	104°39'33.933"W	3.37	
4886.00	1.280	86.010	4713.71	-1131.51	1131.13	320.57	1735531.44	14596411.01	40°11'27.038"N	104°39'33.899"W	3.93	
5000.00	1.370	97.490	4827.68	-1131.43	1131.04	323.19	1735534.06	14596410.93	40°11'27.037"N	104°39'33.866"W	0.25	
5090.00	1.170	83.230	4917.66	-1131.40	1131.01	325.17	1735536.04	14596410.91	40°11'27.037"N	104°39'33.840"W	0.41	

REFERENCE WELLPATH IDENTIFICATION			
Operator	KERR-MCGEE OIL & GAS ONSHORE LP (WA)	Slot	SLOT#45 CANNON 26N-9HZ(521'FNL & 387'FEL,SEC.33)
Area	COLORADO	Well	CANNON 26N-9HZ
Field	WELD COUNTY (UTM/TRUE NORTH)	Wellbore	CANNON 26N-9HZ AWB
Facility	SEC.33-T3N-R65W		

WELLPATH DATA (240 stations) † = interpolated/extrapolated station												
MD (ft)	Inclination (°)	Azimuth (°)	TVD (ft)	Vert Sect (ft)	North (ft)	East (ft)	Grid East (US ft)	Grid North (US ft)	Latitude	Longitude	DLS (°/100ft)	Comments
5179.00	1.270	80.070	5006.64	-1131.68	1131.29	327.04	1735537.91	14596411.19	40°11'27.039"N	104°39'33.816"W	0.14	
5269.00	1.050	74.920	5096.62	-1132.06	1131.68	328.82	1735539.69	14596411.59	40°11'27.043"N	104°39'33.793"W	0.27	
5358.00	1.220	81.260	5185.60	-1132.42	1132.03	330.54	1735541.41	14596411.95	40°11'27.047"N	104°39'33.771"W	0.24	
5448.00	0.980	73.940	5275.58	-1132.78	1132.39	332.23	1735543.09	14596412.31	40°11'27.050"N	104°39'33.749"W	0.31	
5537.00	1.390	62.700	5364.57	-1133.49	1133.10	333.92	1735544.78	14596413.03	40°11'27.057"N	104°39'33.727"W	0.53	
5627.00	0.290	24.650	5454.55	-1134.20	1133.80	334.99	1735545.84	14596413.74	40°11'27.064"N	104°39'33.713"W	1.31	
5717.00	0.470	32.660	5544.55	-1134.72	1134.32	335.28	1735546.13	14596414.26	40°11'27.069"N	104°39'33.710"W	0.21	
5806.00	0.250	201.800	5633.55	-1134.85	1134.45	335.41	1735546.26	14596414.38	40°11'27.071"N	104°39'33.708"W	0.81	
5895.00	0.600	52.380	5722.55	-1134.95	1134.55	335.70	1735546.56	14596414.49	40°11'27.072"N	104°39'33.704"W	0.93	
5985.00	1.230	44.210	5812.54	-1135.93	1135.53	336.75	1735547.60	14596415.47	40°11'27.081"N	104°39'33.691"W	0.71	
6074.00	1.090	84.800	5901.52	-1136.69	1136.29	338.26	1735549.10	14596416.24	40°11'27.089"N	104°39'33.671"W	0.92	
6164.00	0.820	200.990	5991.52	-1136.17	1135.77	338.88	1735549.73	14596415.72	40°11'27.084"N	104°39'33.663"W	1.81	
6253.00	0.660	193.950	6080.51	-1135.08	1134.68	338.53	1735549.38	14596414.62	40°11'27.073"N	104°39'33.668"W	0.21	
6325.00†	1.985	182.845	6152.49	-1133.43	1133.03	338.37	1735549.22	14596412.98	40°11'27.057"N	104°39'33.670"W	1.87	KOP
6343.00	2.320	182.060	6170.47	-1132.75	1132.35	338.34	1735549.20	14596412.30	40°11'27.050"N	104°39'33.670"W	1.87	
6432.00	12.450	187.480	6258.62	-1121.41	1121.01	337.02	1735547.93	14596400.96	40°11'26.938"N	104°39'33.687"W	11.40	
6522.00	21.830	188.740	6344.53	-1095.19	1094.80	333.21	1735544.21	14596374.74	40°11'26.679"N	104°39'33.736"W	10.43	
6611.00	24.080	187.680	6426.48	-1060.83	1060.44	328.27	1735539.40	14596340.38	40°11'26.339"N	104°39'33.800"W	2.57	
6701.00	26.040	183.720	6508.01	-1022.91	1022.53	324.53	1735535.81	14596302.46	40°11'25.965"N	104°39'33.848"W	2.87	
6791.00	33.560	183.250	6586.05	-978.29	977.91	321.83	1735533.29	14596257.86	40°11'25.524"N	104°39'33.883"W	8.36	
6880.00	40.970	183.280	6656.83	-924.53	924.15	318.77	1735530.43	14596204.10	40°11'24.992"N	104°39'33.923"W	8.33	
6970.00	47.030	181.430	6721.54	-862.09	861.71	316.25	1735528.16	14596141.68	40°11'24.375"N	104°39'33.955"W	6.88	
7059.00	52.350	179.340	6779.10	-794.25	793.88	315.85	1735528.01	14596073.88	40°11'23.705"N	104°39'33.960"W	6.24	
7149.00	58.580	180.370	6830.10	-720.15	719.78	316.01	1735528.45	14595999.80	40°11'22.973"N	104°39'33.958"W	6.99	
7239.00	62.160	183.460	6874.60	-641.99	641.62	313.36	1735526.10	14595921.66	40°11'22.200"N	104°39'33.992"W	4.97	
7328.00	72.700	181.330	6908.71	-559.99	559.63	309.99	1735523.05	14595839.69	40°11'21.390"N	104°39'34.036"W	12.05	
7418.00	77.060	180.860	6932.18	-473.14	472.78	308.33	1735521.72	14595752.87	40°11'20.532"N	104°39'34.057"W	4.87	
7507.00	85.340	181.280	6945.78	-385.28	384.92	306.69	1735520.42	14595665.04	40°11'19.664"N	104°39'34.078"W	9.32	
7527.00†	86.082	181.494	6947.28	-365.34	364.98	306.20	1735520.01	14595645.11	40°11'19.467"N	104°39'34.085"W	3.86	LANDING (156'FNL & 81'FEL,SEC.33) 40.1887408 -104.6594679
7597.00	88.680	182.240	6950.48	-295.46	295.10	303.93	1735518.00	14595575.25	40°11'18.776"N	104°39'34.114"W	3.86	
7686.00	89.420	181.300	6951.95	-206.51	206.15	301.18	1735515.59	14595486.33	40°11'17.897"N	104°39'34.149"W	1.34	
7776.00	90.030	181.030	6952.39	-116.53	116.17	299.35	1735514.11	14595396.38	40°11'17.008"N	104°39'34.173"W	0.74	
7822.00†	90.265	180.371	6952.27	-70.53	70.18	298.78	1735513.72	14595350.40	40°11'16.553"N	104°39'34.180"W	1.52	EXIT RADIUS HEEL (451'FNL & 89'FEL,SEC.33) 40.1879315 -104.6594945
7866.00	90.490	179.740	6951.98	-26.53	26.18	298.74	1735513.84	14595306.42	40°11'16.119"N	104°39'34.181"W	1.52	
7955.00	90.280	179.680	6951.38	62.46	-62.82	299.19	1735514.64	14595217.46	40°11'15.239"N	104°39'34.175"W	0.25	
8045.00	89.290	180.400	6951.72	152.46	-152.82	299.13	1735514.92	14595127.49	40°11'14.350"N	104°39'34.176"W	1.36	
8135.00	88.580	180.780	6953.39	242.44	-242.80	298.20	1735514.33	14595037.55	40°11'13.461"N	104°39'34.188"W	0.89	
8224.00	88.980	180.910	6955.29	331.41	-331.77	296.89	1735513.36	14594948.61	40°11'12.581"N	104°39'34.205"W	0.47	
8314.00	89.110	180.140	6956.79	421.40	-421.75	296.07	1735512.88	14594858.66	40°11'11.692"N	104°39'34.215"W	0.87	
8404.00	89.850	180.880	6957.60	511.39	-511.74	295.27	1735512.43	14594768.70	40°11'10.803"N	104°39'34.226"W	1.16	
8493.00	90.620	179.650	6957.24	600.39	-600.74	294.85	1735512.35	14594679.74	40°11'09.924"N	104°39'34.231"W	1.63	
8583.00	90.150	178.860	6956.63	690.37	-690.73	296.02	1735513.87	14594589.79	40°11'09.034"N	104°39'34.216"W	1.02	
8672.00	89.850	178.940	6956.63	779.35	-779.71	297.73	1735515.92	14594500.85	40°11'08.155"N	104°39'34.194"W	0.35	
8761.00	90.180	178.300	6956.61	868.33	-868.68	299.88	1735518.40	14594411.92	40°11'07.276"N	104°39'34.166"W	0.81	
8851.00	87.510	178.330	6958.42	958.26	-958.62	302.52	1735521.39	14594322.03	40°11'06.387"N	104°39'34.132"W	2.97	

REFERENCE WELLPATH IDENTIFICATION			
Operator	KERR-MCGEE OIL & GAS ONSHORE LP (WA)	Slot	SLOT#45 CANNON 26N-9HZ(521'FNL & 387'FEL,SEC.33)
Area	COLORADO	Well	CANNON 26N-9HZ
Field	WELD COUNTY (UTM/TRUE NORTH)	Wellbore	CANNON 26N-9HZ AWB
Facility	SEC.33-T3N-R65W		

WELLPATH DATA (240 stations)												
MD (ft)	Inclination (°)	Azimuth (°)	TVD (ft)	Vert Sect (ft)	North (ft)	East (ft)	Grid East (US ft)	Grid North (US ft)	Latitude	Longitude	DLS (°/100ft)	Comments
8940.00	87.630	177.510	6962.20	1047.11	-1047.48	305.75	1735524.95	14594233.21	40°11'05.509"N	104°39'34.091"W	0.93	
9030.00	87.690	177.490	6965.87	1136.95	-1137.32	309.67	1735529.22	14594143.43	40°11'04.621"N	104°39'34.040"W	0.07	
9120.00	88.250	180.420	6969.06	1226.86	-1227.24	311.31	1735531.20	14594053.55	40°11'03.732"N	104°39'34.019"W	3.31	
9209.00	88.550	179.890	6971.54	1315.83	-1316.20	311.07	1735531.30	14593964.62	40°11'02.853"N	104°39'34.022"W	0.68	
9299.00	88.830	181.730	6973.60	1405.79	-1406.16	309.80	1735530.37	14593874.69	40°11'01.964"N	104°39'34.038"W	2.07	
9388.00	89.050	181.490	6975.25	1494.75	-1495.11	307.30	1735528.21	14593785.76	40°11'01.085"N	104°39'34.071"W	0.37	
9478.00	90.180	182.590	6975.85	1584.69	-1585.05	304.09	1735525.35	14593695.85	40°11'00.197"N	104°39'34.112"W	1.75	
9567.00	91.230	183.550	6974.76	1673.56	-1673.91	299.33	1735520.93	14593607.00	40°10'59.318"N	104°39'34.173"W	1.60	
9657.00	91.170	180.400	6972.87	1763.48	-1763.83	296.23	1735518.17	14593517.11	40°10'58.430"N	104°39'34.213"W	3.50	
9746.00	89.880	177.180	6972.06	1852.44	-1852.79	298.11	1735520.39	14593428.19	40°10'57.551"N	104°39'34.189"W	3.90	
9836.00	90.590	177.160	6971.69	1942.32	-1942.68	302.55	1735525.18	14593338.36	40°10'56.662"N	104°39'34.132"W	0.79	
9925.00	88.340	177.760	6972.52	2031.22	-2031.58	306.50	1735529.46	14593249.50	40°10'55.784"N	104°39'34.081"W	2.62	
10015.00	88.370	178.150	6975.10	2121.12	-2121.49	309.71	1735533.01	14593159.65	40°10'54.895"N	104°39'34.040"W	0.43	
10105.00	88.770	177.950	6977.35	2211.04	-2211.41	312.77	1735536.41	14593069.77	40°10'54.007"N	104°39'34.000"W	0.50	
10194.00	89.350	178.130	6978.81	2299.97	-2300.34	315.81	1735539.80	14592980.89	40°10'53.128"N	104°39'33.961"W	0.68	
10283.00	90.710	178.250	6978.76	2388.92	-2389.30	318.62	1735542.95	14592891.98	40°10'52.249"N	104°39'33.925"W	1.53	
10373.00	91.480	178.850	6977.04	2478.87	-2479.25	320.90	1735545.57	14592802.07	40°10'51.360"N	104°39'33.896"W	1.08	
10462.00	89.720	178.030	6976.11	2567.82	-2568.21	323.32	1735548.33	14592713.16	40°10'50.481"N	104°39'33.864"W	2.18	
10552.00	89.910	177.950	6976.40	2657.76	-2658.15	326.48	1735551.83	14592623.26	40°10'49.592"N	104°39'33.824"W	0.23	
10641.00	87.570	178.520	6978.36	2746.69	-2747.08	329.22	1735554.91	14592534.38	40°10'48.713"N	104°39'33.788"W	2.71	
10731.00	87.470	178.470	6982.25	2836.57	-2836.97	331.58	1735557.61	14592444.54	40°10'47.825"N	104°39'33.758"W	0.12	
10821.00	86.980	181.520	6986.61	2926.46	-2926.85	331.59	1735557.96	14592354.69	40°10'46.937"N	104°39'33.758"W	3.43	
10910.00	86.980	181.580	6991.30	3015.30	-3015.70	329.18	1735555.90	14592265.87	40°10'46.059"N	104°39'33.789"W	0.07	
11000.00	87.320	181.640	6995.77	3105.16	-3105.55	326.66	1735553.72	14592176.04	40°10'45.171"N	104°39'33.822"W	0.38	
11089.00	89.290	181.360	6998.41	3194.09	-3194.47	324.33	1735551.73	14592087.15	40°10'44.292"N	104°39'33.852"W	2.24	
11179.00	88.830	180.530	6999.88	3284.06	-3284.45	322.85	1735550.59	14591997.20	40°10'43.403"N	104°39'33.871"W	1.05	
11268.00	89.170	180.800	7001.44	3373.05	-3373.43	321.81	1735549.90	14591908.25	40°10'42.524"N	104°39'33.884"W	0.49	
11358.00	90.180	180.660	7001.95	3463.04	-3463.42	320.67	1735549.10	14591818.29	40°10'41.634"N	104°39'33.899"W	1.13	
11448.00	90.860	180.040	7001.13	3553.03	-3553.41	320.12	1735548.89	14591728.33	40°10'40.745"N	104°39'33.906"W	1.02	
11537.00	91.390	179.300	6999.38	3642.01	-3642.39	320.63	1735549.74	14591639.39	40°10'39.866"N	104°39'33.899"W	1.02	
11627.00	90.220	180.440	6998.12	3732.00	-3732.38	320.83	1735550.29	14591549.44	40°10'38.977"N	104°39'33.897"W	1.81	
11716.00	90.590	180.370	6997.49	3820.99	-3821.38	320.20	1735550.00	14591460.48	40°10'38.097"N	104°39'33.905"W	0.42	
11808.00	91.020	179.700	6996.20	3912.98	-3913.37	320.15	1735550.30	14591368.52	40°10'37.188"N	104°39'33.906"W	0.87	
11902.00	91.260	179.060	6994.33	4006.96	-4007.34	321.16	1735551.67	14591274.59	40°10'36.259"N	104°39'33.892"W	0.73	
11994.00	90.520	180.250	6992.90	4098.94	-4099.33	321.72	1735552.58	14591182.64	40°10'35.350"N	104°39'33.885"W	1.52	
12085.00	89.230	177.040	6993.10	4189.90	-4190.29	323.87	1735555.08	14591091.73	40°10'34.452"N	104°39'33.858"W	3.80	
12178.00	89.780	176.880	6993.90	4282.76	-4283.15	328.80	1735560.36	14590998.92	40°10'33.534"N	104°39'33.794"W	0.62	
12268.00	88.430	178.400	6995.31	4372.66	-4373.06	332.51	1735564.41	14590909.06	40°10'32.645"N	104°39'33.746"W	2.26	
12362.00	89.260	181.650	6997.20	4466.63	-4467.03	332.47	1735564.73	14590815.13	40°10'31.717"N	104°39'33.747"W	3.57	
12453.00	90.030	181.050	6997.76	4557.61	-4558.00	330.32	1735562.93	14590724.19	40°10'30.818"N	104°39'33.775"W	1.07	
12545.00	90.800	180.800	6997.10	4649.59	-4649.99	328.84	1735561.80	14590632.23	40°10'29.909"N	104°39'33.794"W	0.88	
12637.00	88.950	180.670	6997.30	4741.58	-4741.97	327.66	1735560.97	14590540.28	40°10'29.000"N	104°39'33.809"W	2.02	
12727.00	89.350	180.570	6998.63	4831.57	-4831.96	326.68	1735560.34	14590450.32	40°10'28.111"N	104°39'33.821"W	0.46	
12817.00	87.900	179.350	7000.79	4921.54	-4921.93	326.75	1735560.75	14590360.39	40°10'27.221"N	104°39'33.821"W	2.11	
12906.00	87.970	179.190	7004.00	5010.47	-5010.86	327.88	1735562.22	14590271.50	40°10'26.343"N	104°39'33.806"W	0.20	

REFERENCE WELLPATH IDENTIFICATION			
Operator	KERR-MCGEE OIL & GAS ONSHORE LP (WA)	Slot	SLOT#45 CANNON 26N-9HZ(521'FNL & 387'FEL,SEC.33)
Area	COLORADO	Well	CANNON 26N-9HZ
Field	WELD COUNTY (UTM/TRUE NORTH)	Wellbore	CANNON 26N-9HZ AWP
Facility	SEC.33-T3N-R65W		

WELLPATH DATA (240 stations)												
MD [ft]	Inclination [°]	Azimuth [°]	TVD [ft]	Vert Sect [ft]	North [ft]	East [ft]	Grid East [US ft]	Grid North [US ft]	Latitude	Longitude	DLS [°/100ft]	Comments
12996.00	88.180	179.150	7007.02	5100.41	-5100.80	329.18	1735563.86	14590181.60	40°10'25.454"N	104°39'33.789"W	0.24	
13086.00	88.460	178.860	7009.66	5190.35	-5190.75	330.74	1735565.77	14590091.69	40°10'24.565"N	104°39'33.769"W	0.45	
13175.00	88.150	180.510	7012.30	5279.31	-5279.71	331.23	1735566.60	14590002.77	40°10'23.686"N	104°39'33.763"W	1.89	
13264.00	88.460	180.240	7014.93	5368.27	-5368.67	330.65	1735566.36	14589913.85	40°10'22.807"N	104°39'33.770"W	0.46	
13354.00	89.040	181.030	7016.89	5458.24	-5458.64	329.65	1735565.70	14589823.91	40°10'21.918"N	104°39'33.783"W	1.09	
13443.00	89.690	181.220	7017.88	5547.22	-5547.61	327.91	1735564.30	14589734.96	40°10'21.038"N	104°39'33.806"W	0.76	
13533.00	90.680	180.490	7017.59	5637.21	-5637.60	326.56	1735563.30	14589645.00	40°10'20.149"N	104°39'33.823"W	1.37	
13622.00	90.990	180.770	7016.29	5726.20	-5726.59	325.59	1735562.66	14589556.05	40°10'19.270"N	104°39'33.836"W	0.47	
13712.00	91.760	180.900	7014.13	5816.16	-5816.55	324.27	1735561.69	14589466.11	40°10'18.381"N	104°39'33.853"W	0.87	
13801.00	92.400	181.240	7010.90	5905.09	-5905.48	322.61	1735560.37	14589377.22	40°10'17.502"N	104°39'33.874"W	0.81	
13891.00	90.000	181.450	7009.02	5995.04	-5995.43	320.50	1735558.61	14589287.30	40°10'16.613"N	104°39'33.901"W	2.68	
13980.00	90.220	181.650	7008.84	6084.01	-6084.39	318.09	1735556.54	14589198.36	40°10'15.734"N	104°39'33.932"W	0.33	
14070.00	89.970	181.380	7008.70	6173.98	-6174.36	315.71	1735554.51	14589108.42	40°10'14.845"N	104°39'33.963"W	0.41	
14159.00	89.880	181.660	7008.81	6262.95	-6263.33	313.35	1735552.49	14589019.47	40°10'13.966"N	104°39'33.993"W	0.33	
14248.00	89.690	181.780	7009.15	6351.92	-6352.29	310.68	1735550.16	14588930.54	40°10'13.087"N	104°39'34.028"W	0.25	
14338.00	90.280	181.130	7009.17	6441.89	-6442.26	308.40	1735548.21	14588840.60	40°10'12.197"N	104°39'34.057"W	0.98	
14427.00	90.770	181.020	7008.35	6530.87	-6531.24	306.73	1735546.89	14588751.65	40°10'11.318"N	104°39'34.079"W	0.56	
14517.00	91.320	180.790	7006.71	6620.85	-6621.21	305.31	1735545.81	14588661.70	40°10'10.429"N	104°39'34.097"W	0.66	
14606.00	91.910	180.440	7004.20	6709.81	-6710.17	304.35	1735545.19	14588572.78	40°10'09.550"N	104°39'34.109"W	0.77	
14696.00	92.800	180.010	7000.51	6799.73	-6800.09	304.00	1735545.18	14588482.89	40°10'08.661"N	104°39'34.114"W	1.10	
14786.00	89.940	180.050	6998.35	6889.69	-6890.06	303.95	1735545.48	14588392.96	40°10'07.772"N	104°39'34.115"W	3.18	
14875.00	90.280	180.140	6998.18	6978.69	-6979.06	303.80	1735545.67	14588303.99	40°10'06.893"N	104°39'34.117"W	0.40	
14964.00	90.650	179.500	6997.46	7067.69	-7068.05	304.08	1735546.29	14588215.03	40°10'06.013"N	104°39'34.113"W	0.83	
15054.00	91.230	179.270	6995.98	7157.67	-7158.04	305.05	1735547.60	14588125.09	40°10'05.124"N	104°39'34.101"W	0.69	
15144.00	91.110	179.490	6994.15	7247.64	-7248.01	306.02	1735548.92	14588035.16	40°10'04.235"N	104°39'34.088"W	0.28	
15233.00	91.780	179.830	6991.90	7336.61	-7336.98	306.55	1735549.79	14587946.22	40°10'03.356"N	104°39'34.081"W	0.84	
15323.00	92.030	179.660	6988.91	7426.56	-7426.93	306.95	1735550.53	14587856.31	40°10'02.467"N	104°39'34.076"W	0.34	
15412.00	90.030	178.540	6987.31	7515.53	-7515.90	308.35	1735552.27	14587767.38	40°10'01.588"N	104°39'34.058"W	2.58	
15502.00	90.310	178.460	6987.04	7605.49	-7605.87	310.70	1735554.97	14587677.46	40°10'00.699"N	104°39'34.028"W	0.32	
15591.00	90.710	178.360	6986.25	7694.45	-7694.83	313.17	1735557.78	14587588.54	40°09'59.820"N	104°39'33.996"W	0.46	
15681.00	92.060	178.680	6984.08	7784.39	-7784.77	315.50	1735560.44	14587498.65	40°09'58.931"N	104°39'33.966"W	1.54	
15770.00	91.290	179.980	6981.48	7873.34	-7873.73	316.54	1735561.82	14587409.73	40°09'58.052"N	104°39'33.953"W	1.70	
15860.00	91.910	180.120	6978.96	7963.31	-7963.69	316.46	1735562.09	14587319.80	40°09'57.163"N	104°39'33.954"W	0.71	
15949.00	92.370	179.960	6975.64	8052.25	-8052.63	316.40	1735562.37	14587230.90	40°09'56.284"N	104°39'33.954"W	0.55	
16039.00	91.080	180.010	6972.93	8142.20	-8142.58	316.42	1735562.73	14587140.98	40°09'55.395"N	104°39'33.954"W	1.43	
16128.00	91.570	179.970	6970.87	8231.18	-8231.56	316.44	1735563.09	14587052.04	40°09'54.516"N	104°39'33.954"W	0.55	
16218.00	91.850	179.680	6968.19	8321.14	-8321.52	316.71	1735563.71	14586962.12	40°09'53.627"N	104°39'33.950"W	0.45	
16307.00	90.370	180.550	6966.46	8410.12	-8410.50	316.53	1735563.87	14586873.17	40°09'52.747"N	104°39'33.953"W	1.93	
16397.00	91.260	180.440	6965.18	8500.11	-8500.49	315.75	1735563.43	14586783.22	40°09'51.858"N	104°39'33.963"W	1.00	
16487.00	91.450	180.050	6963.05	8590.08	-8590.46	315.37	1735563.39	14586693.28	40°09'50.969"N	104°39'33.968"W	0.48	
16576.00	92.090	179.970	6960.30	8679.04	-8679.42	315.35	1735563.72	14586604.36	40°09'50.090"N	104°39'33.968"W	0.72	
16666.00	89.230	180.210	6959.27	8769.02	-8769.40	315.21	1735563.92	14586514.41	40°09'49.201"N	104°39'33.970"W	3.19	
16755.00	89.350	180.910	6960.37	8858.01	-8858.39	314.34	1735563.39	14586425.45	40°09'48.321"N	104°39'33.981"W	0.80	
16845.00	89.690	180.310	6961.12	8948.00	-8948.38	313.39	1735562.78	14586335.49	40°09'47.432"N	104°39'33.993"W	0.77	
16934.00	90.460	180.900	6961.01	9037.00	-9037.37	312.45	1735562.18	14586246.53	40°09'46.552"N	104°39'34.005"W	1.09	

REFERENCE WELLPATH IDENTIFICATION			
Operator	KERR-MCGEE OIL & GAS ONSHORE LP (WA)	Slot	SLOT#45 CANNON 26N-9HZ(521'FNL & 387'FEL,SEC.33)
Area	COLORADO	Well	CANNON 26N-9HZ
Field	WELD COUNTY (UTM/TRUE NORTH)	Wellbore	CANNON 26N-9HZ AWB
Facility	SEC.33-T3N-R65W		

WELLPATH DATA (240 stations) † = interpolated/extrapolated station												
MD [ft]	Inclination [°]	Azimuth [°]	TVD [ft]	Vert Sect [ft]	North [ft]	East [ft]	Grid East [US ft]	Grid North [US ft]	Latitude	Longitude	DLS [°/100ft]	Comments
17024.00	90.830	180.830	6960.00	9126.98	-9127.36	311.09	1735561.16	14586156.58	40°09'45.663"N	104°39'34.023"W	0.42	
17113.00	91.880	181.510	6957.89	9215.94	-9216.31	309.27	1735559.69	14586067.65	40°09'44.784"N	104°39'34.046"W	1.41	
17202.00	88.770	179.240	6957.39	9304.92	-9305.29	308.69	1735559.45	14585978.71	40°09'43.905"N	104°39'34.054"W	4.33	
17292.00	88.520	178.960	6959.51	9394.88	-9395.26	310.10	1735561.20	14585888.78	40°09'43.016"N	104°39'34.036"W	0.42	
17364.00†	88.350	179.308	6961.48	9466.85	-9467.22	311.19	1735562.57	14585816.85	40°09'42.305"N	104°39'34.022"W	0.54	ENTER RADIUS TOE (460'FSL & 32'FEL,SEC.04) 40.1617513 -104.6594505
17381.00	88.310	179.390	6961.98	9483.84	-9484.21	311.38	1735562.82	14585799.87	40°09'42.137"N	104°39'34.019"W	0.54	
17471.00	88.120	179.230	6964.78	9573.79	-9574.16	312.47	1735564.25	14585709.96	40°09'41.248"N	104°39'34.005"W	0.28	
17560.00	89.170	180.080	6966.88	9662.76	-9663.13	313.00	1735565.13	14585621.02	40°09'40.369"N	104°39'33.998"W	1.52	
17650.00	90.430	180.410	6967.20	9752.75	-9753.13	312.62	1735565.08	14585531.06	40°09'39.479"N	104°39'34.003"W	1.45	
17739.00	90.920	180.110	6966.15	9841.75	-9842.12	312.21	1735565.02	14585442.10	40°09'38.600"N	104°39'34.009"W	0.65	
17829.00	91.080	179.910	6964.58	9931.73	-9932.11	312.20	1735565.35	14585352.15	40°09'37.711"N	104°39'34.009"W	0.28	
17918.00	91.290	179.250	6962.74	10020.71	-10021.09	312.85	1735566.34	14585263.21	40°09'36.831"N	104°39'34.000"W	0.78	
18008.00	91.570	179.280	6960.49	10110.67	-10111.05	314.00	1735567.84	14585173.29	40°09'35.942"N	104°39'33.986"W	0.31	
18092.00	92.120	179.030	6957.79	10194.62	-10195.00	315.24	1735569.40	14585089.38	40°09'35.113"N	104°39'33.970"W	0.72	LAST BHGE MWD+IFR1+MSA SURVEY
18170.00	92.120	179.030	6954.90	10272.55	-10272.94	316.56	1735571.01	14585011.48	40°09'34.343"N	104°39'33.953"W	0.00	PTB (346'FNL & 25'FEL,SEC.09) 40.1595396 -104.6594313

TARGETS								
Name	TVD [ft]	North [ft]	East [ft]	Grid East [US ft]	Grid North [US ft]	Latitude	Longitude	Shape
SEC.04-T2N-R65W	-26.00	150.07	-3860.98	1731355.31	14595414.36	40°11'17.340"N	104°40'27.779"W	polygon
SEC.33-T3N-R65W	-26.00	150.07	-3860.98	1731355.31	14595414.36	40°11'17.340"N	104°40'27.779"W	polygon
SEC.09-T2N-R65W	0.00	-0.30	29.88	1735245.19	14595278.92	40°11'15.857"N	104°39'37.645"W	polygon
CANNON 26N-9HZ BHL REV-1(361'FNL & 37'FEL,SEC.09)	6940.00	-10288.46	305.46	1735559.98	14584995.92	40°09'34.189"N	104°39'34.096"W	point
CANNON 26N-9HZ HEEL REV-1(152'FNL & 68'FEL,SEC.33)	6952.00	369.08	318.19	1735531.98	14595649.25	40°11'19.507"N	104°39'33.930"W	point
CANNON 26N-9HZ LANDBOX	6952.00	0.00	0.00	1735215.32	14595279.11	40°11'15.860"N	104°39'38.030"W	polygon
CANNON 26N-9HZ RADIUS 1	6952.00	521.13	385.72	1735598.90	14595801.50	40°11'21.010"N	104°39'33.060"W	polygon
CANNON 26N-9HZ RADIUS 2	6952.00	-9925.49	346.29	1735599.40	14585358.90	40°09'37.776"N	104°39'33.570"W	polygon
CANNON 26N-9HZ LAT TARGET	6965.54	-8612.86	292.46	1735540.58	14586670.80	40°09'50.748"N	104°39'34.263"W	point
CANNON 26N-9HZ INT. TARGET@5500'VS	7012.00	-5500.37	311.18	1735547.40	14589782.12	40°10'21.505"N	104°39'34.021"W	point

REFERENCE WELLPATH IDENTIFICATION			
Operator	KERR-MCGEE OIL & GAS ONSHORE LP (WA)	Slot	SLOT#45 CANNON 26N-9HZ(521'FNL & 387'FEL,SEC.33)
Area	COLORADO	Well	CANNON 26N-9HZ
Field	WELD COUNTY (UTM/TRUE NORTH)	Wellbore	CANNON 26N-9HZ AWB
Facility	SEC.33-T3N-R65W		

WELLPATH COMPOSITION - Ref Wellbore: CANNON 26N-9HZ AWB    Ref Wellpath: CANNON 26N-9HZ AWP				
Start MD [ft]	End MD [ft]	Positional Uncertainty Model	Log Name/Comment	Wellbore
26.00	1867.00	Custom APC_ISCWSA REV 2 MWD+IFR1 (approximation)	Custom APC_ISCWSA Rev-2 MWD+IFR1 <137 - 1867>	CANNON 26N-9HZ AWB
1867.00	18092.00	Custom APC_ISCWSA REV 2 MWD+IFR1+MSA (approximation)	BHGE Custom APC_ISCWSA Rev-2 MWD+IFR1+MSA <1933 - 18092>	CANNON 26N-9HZ AWB
18092.00	18170.00	Blind Drilling (std)	Projection to bit	CANNON 26N-9HZ AWB

REFERENCE WELLPATH IDENTIFICATION			
Operator	KERR-MCGEE OIL & GAS ONSHORE LP (WA)	Slot	SLOT#45 CANNON 26N-9HZ(521'FNL & 387'FEL,SEC.33)
Area	COLORADO	Well	CANNON 26N-9HZ
Field	WELD COUNTY (UTM/TRUE NORTH)	Wellbore	CANNON 26N-9HZ AWB
Facility	SEC.33-T3N-R65W		

WELLPATH COMMENTS				
MD [ft]	Inclination [°]	Azimuth [°]	TVD [ft]	Comment
137.00	0.700	4.700	137.00	FIRST SURFACE MWD+IFR1 SURVEY
1867.00	16.750	16.660	1816.39	LAST SURFACE MWD+IFR1 SURVEY
1933.00	16.610	16.030	1879.61	FIRST BHGE MWD+IFR1+MSA SURVEY
6325.00	1.985	182.845	6152.49	KOP
7527.00	86.082	181.494	6947.28	LANDING (156'FNL & 81'FEL,SEC.33) 40.1887408 -104.6594679
7822.00	90.265	180.371	6952.27	EXIT RADIUS HEEL (451'FNL & 89'FEL,SEC.33) 40.1879315 -104.6594945
17364.00	88.350	179.308	6961.48	ENTER RADIUS TOE (460'FSL & 32'FEL,SEC.04) 40.1617513 -104.6594505
18092.00	92.120	179.030	6957.79	LAST BHGE MWD+IFR1+MSA SURVEY
18170.00	92.120	179.030	6954.90	PTB (346'FNL & 25'FEL,SEC.09) 40.1595396 -104.6594313