



Lat40°, Inc. 6250 W. 10th Street, Unit 2, Greeley, CO 970-515-5294

HYDROLOGY MAP

LORY 4N65W33 1-12 PAD

SECTION: 33
TOWNSHIP: 4N
RANGE: 65W
6TH. P.M.
WELD COUNTY, CO

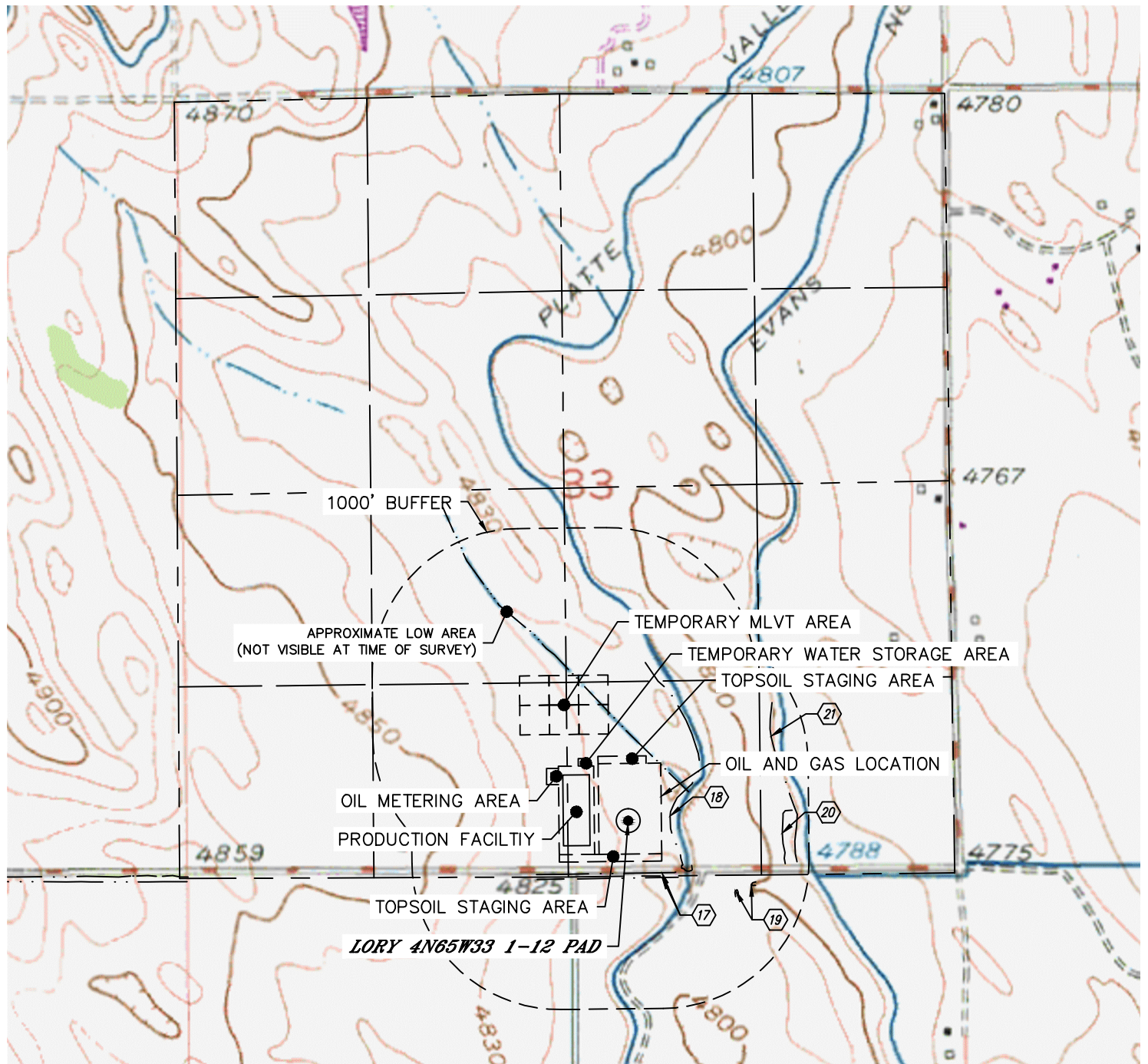

DISTANCES MEASURED FROM THE EDGE OF THE OIL AND GAS LOCATION.

- (17) BORROW DITCH 79' & 112' S
- (18) PLATTE VALLEY CANAL 59' E
- (19) DITCH 539' & 629' SE
- (20) POND 819' E
- (21) EVANS #2 DITCH 770' SE

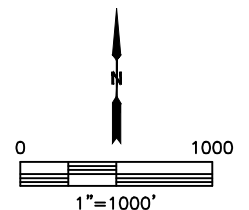

NEAREST DOWN GRADIENT SURFACE WATER: PLATTE VALLEY CANAL 59' E

DATE: 12/5/2017
PROJECT#: 2017110