



Lat40°, Inc. 6250 W. 10th Street, Unit 2, Greeley, CO 970-515-5294

HYDROLOGY MAP

POPHAM 4N64W03 1-20 PAD

SECTION: 3
TOWNSHIP: 4N
RANGE: 64W
6TH. P.M.
WELD COUNTY, CO

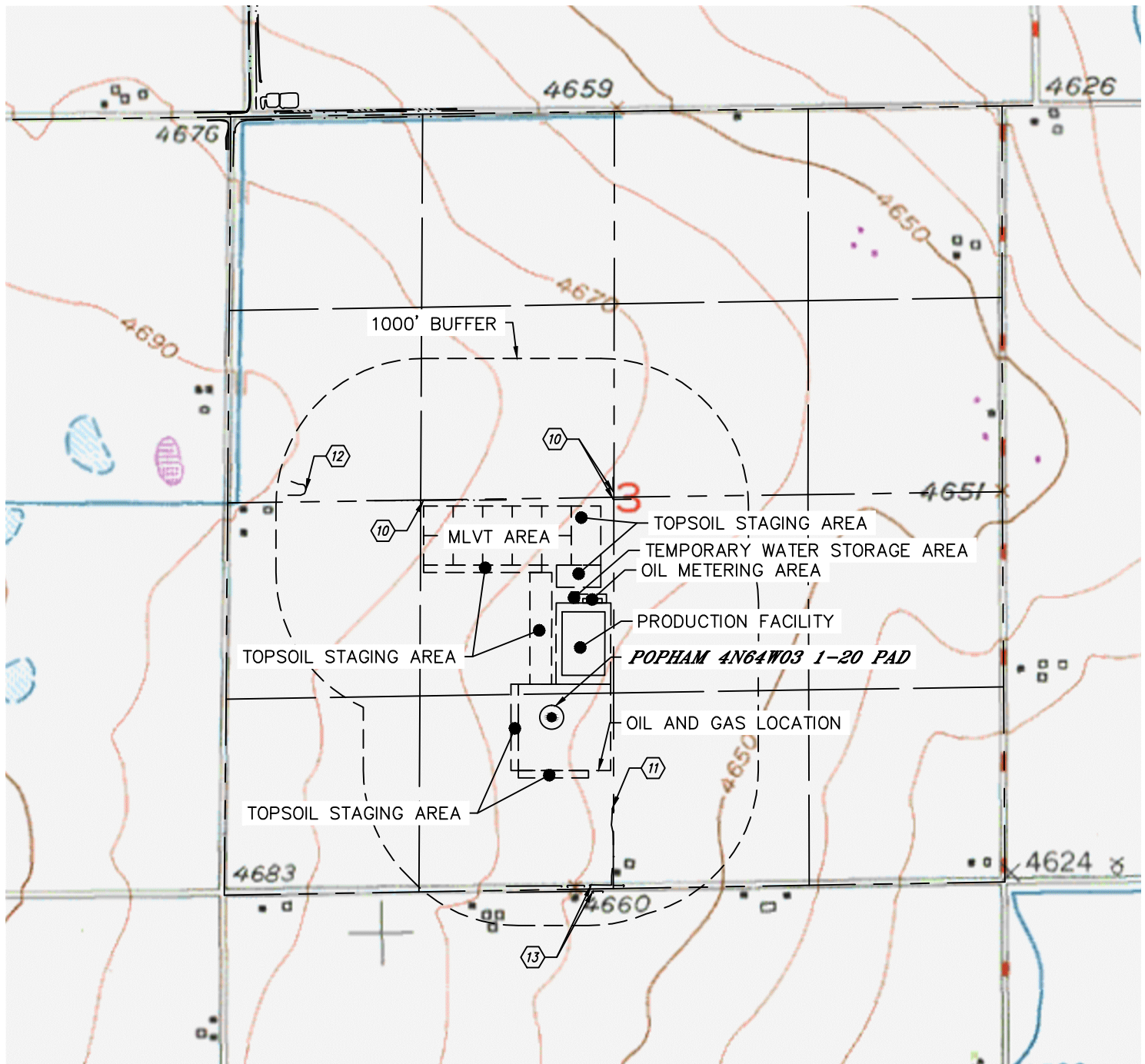

DISTANCES MEASURED FROM THE EDGE OF THE OIL AND GAS LOCATION.

- ⑩ DITCH 38' N, 96' & 128' NE
- ⑪ LOW AREA 256' S
- ⑫ POND 805' NW
- ⑬ BORROW DITCH 725' & 768' S

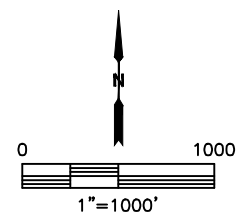

NEAREST DOWN GRADIENT SURFACE WATER: LOW AREA 256' S

DATE: 7/31/2017
PROJECT#: 2015075