

# SRC ENERGY

Location: COLORADO Slot: SLOT#21 GREELEY-ROTHER FEDERAL 13N-2B-L (1003'FSL & 294'FEL, SEC.01)  
Field: WELD COUNTY (NAD83, TRUE NORTH) Well: GREELEY-ROTHER FEDERAL 13N-2B-L  
Facility: SEC.01-T05N-R67W Wellbore: GREELEY-ROTHER FEDERAL 13N-2B-L PWB

|  |  |
|--|--|
| Pilot reference wellpath is GREELEY-ROTHER FEDERAL 13N-2B-L PWP (REV-A.0)  | Grid System: NAD83 / Lambert Colorado SP, Northern Zone (501), US feet |
| True vertical depths are referenced to PRECISION 462 (20) (RKB)  | * = Wellpath was transformed from a different geodetic datum           |
| Measured depths are referenced to PRECISION 462 (20) (RKB)   | North Reference: True north  |
| PRECISION 462 (20) (RKB) to Mean Sea Level: 4893 feet  | Scale: True distance   |
| Mean Sea Level to Mud line (At Slot: SLOT#21 GREELEY-ROTHER FEDERAL 13N-2B-L (1003'FSL & 294'FEL, SEC.01)): 0 feet | Depths are in feet   |
| Coordinates are in feet referenced to Slot   | Created by: doddiana on 2017-10-04                                     |
|  | Database: WellArcheoIDB  |

## Location Information

|  |                   |                    |                   |                    |
|--|-------------------|--------------------|-------------------|--------------------|
| Facility Name  | Grid East (US ft) | Grid North (US ft) | Latitude          | Longitude          |
| SEC.01-T05N-R67W   | 3185545.499       | 1399477.355        | 40°25'40.991"N    | 104°50'00.640"W    |
| Slot   | Local N (ft)      | Local E (ft)       | Grid East (US ft) | Grid North (US ft) |
| SLOT#21 GREELEY-ROTHER FEDERAL 13N-2B-L (1003'FSL & 294'FEL, SEC.01)   | -1364.76          | 2.01               | 3185557.766       | 1399112.754        |
|  |                   |                    | 40°25'27.505"N    | 104°50'00.614"W    |
| PRECISION 462 (20) (RKB) to Mud line (At Slot: SLOT#21 GREELEY-ROTHER FEDERAL 13N-2B-L (1003'FSL & 294'FEL, SEC.01)) |                   |                    |                   | 4893ft             |
| Mean Sea Level to Mud line (At Slot: SLOT#21 GREELEY-ROTHER FEDERAL 13N-2B-L (1003'FSL & 294'FEL, SEC.01))           |                   |                    |                   | 0ft                |
| PRECISION 462 (20) (RKB) to Mean Sea Level   |                   |                    |                   | 4893ft             |

## Survey Program

| Start MD (ft) | End MD (ft) | Tool               | Model  | Log Name/Comment | Wellbore                            |
|---------------|-------------|--------------------|--|------------------|-------------------------------------|
| 20.00         | 1750.00     | BHI NavTrak        | Custom BHI NavTrak (Standard Rotating+Aerial Conn) (Rockies 0.03G model) |                  | GREELEY-ROTHER FEDERAL 13N-2B-L PWB |
| 1750.00       | 17356.82    | BHI AutoTrak Curve | Custom BHI AutoTrak Curve (FR1, Short) (Rockies 0.03G model)             |                  | GREELEY-ROTHER FEDERAL 13N-2B-L PWB |



SRC ENERGY

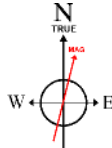

BGGM (1900.0 to 2018.0) Dip: 66.87° Field: 52416.1 nT  
Magnetic North is 8.39 degrees East of True North (at 9/22/2017)

To correct azimuth from Magnetic to True add 8.39 degrees

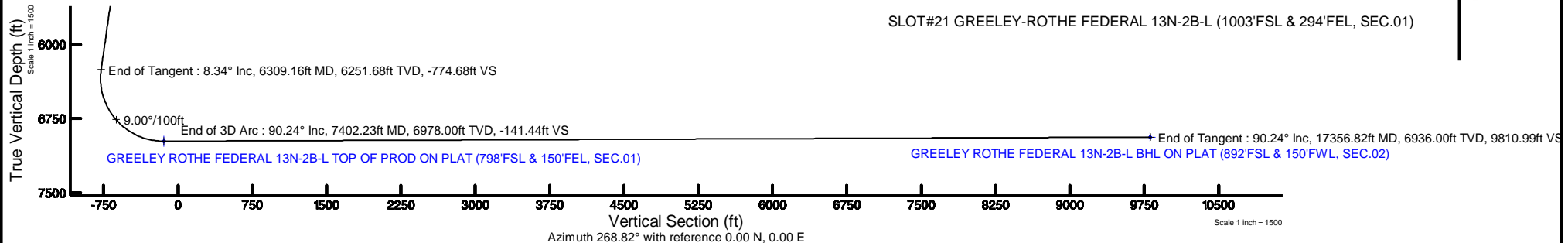

## Targets

| Name   | MD (ft) | TVD (ft) | Local N (ft) | Local E (ft) | Grid East (US ft) | Grid North (US ft) | Latitude        | Longitude       |
|--|---------|----------|--------------|--------------|-------------------|--------------------|-----------------|-----------------|
| SEC.01-T05N-R67W   |         | 23.00    | 1364.76      | -2.01        | 3185545.50        | 1399477.36         | 40°25'40.991"N  | 104°50'00.640"W |
| SEC.02-T05N-R67W   |         | 23.00    | 1364.76      | -2.01        | 3185545.50        | 1399477.36         | 40°25'40.991"N  | 104°50'00.640"W |
| GREELEY ROTHE FEDERAL 13N-2B-L BHL ON PLAT (892'FSL & 150'FWL, SEC.02)         | 6936.00 | -202.07  | -9808.88     | 3175751.08   | 1397636.93        | 40°25'25.489"N     | 104°52'07.442"W |                 |
| GREELEY ROTHE FEDERAL 13N-2B-L TOP OF PROD ON PLAT (798'FSL & 150'FEL, SEC.01) | 6978.00 | -190.97  | -145.55      | 3185704.81   | 1397913.94        | 40°25'25.520"N     | 104°49'58.732"W |                 |

## Hole and Casing Sections

| Name                   | Start MD (ft) | End MD (ft) | Interval (ft) | Start TVD (ft) | End TVD (ft) | Start Local N (ft) | Start Local E (ft) | End Local N (ft) | End Local E (ft) | Wellbore                            |
|------------------------|---------------|-------------|---------------|----------------|--------------|--------------------|--------------------|------------------|------------------|-------------------------------------|
| 13.5in Open Hole       | 20.00         | 1750.00     | 1730.00       | 20.00          | 1740.77      | 0.00               | 0.00               | -30.17           | 133.28           | GREELEY-ROTHER FEDERAL 13N-2B-L PWB |
| 9.625in Casing Surface | 20.00         | 1750.00     | 1730.00       | 20.00          | 1740.77      | 0.00               | 0.00               | -30.17           | 133.28           | GREELEY-ROTHER FEDERAL 13N-2B-L PWB |
| 8.5in Open Hole        | 1750.00       | 17356.82    | 15606.82      | 1740.77        | N/A          | -30.17             | 133.28             | N/A              | N/A              | GREELEY-ROTHER FEDERAL 13N-2B-L PWB |

## Well Profile Data

| Design Comment | MD (ft)  | Inc (°) | Az (°)  | TVD (ft) | Local N (ft) | Local E (ft) | DLS (°/100ft) | VS (ft) |
|----------------|----------|---------|---------|----------|--------------|--------------|---------------|---------|
| Tie On         | 20.00    | 0.000   | 102.755 | 20.00    | 0.00         | 0.00         | 0.00          | 0.00    |
| End of Tangent | 600.00   | 0.000   | 102.755 | 600.00   | 0.00         | 0.00         | 0.00          | 0.00    |
| End of Build   | 1017.15  | 8.343   | 102.755 | 1015.67  | -6.69        | 29.57        | 2.00          | -29.42  |
| End of Tangent | 6309.16  | 8.343   | 102.755 | 6251.68  | -176.22      | 778.48       | 0.00          | -774.68 |
| End of 3D Arc  | 7402.23  | 90.242  | 269.988 | 6978.00  | -199.99      | 145.58       | 9.00          | -141.44 |
| End of Tangent | 17356.82 | 90.242  | 269.988 | 6936.00  | -202.05      | -9808.91     | 0.00          | 9810.99 |

GREELEY-ROTHE\_FEDERAL\_13N-2B-L\_PWP\_\_REV-A.0\_.las

~VERSION INFORMATION

VERS. 2.0 : CWLS LOG ASCII STANDARD-VERSION 2.0

WRAP. NO : ASCII DATA SECTION CONTAINS ONE ROW PER WELLPATH STATION

~WELL INFORMATION

| #MNEM | .UNITS | DATA                           | :DESCRIPTION                  |
|-------|--------|--------------------------------|-------------------------------|
| #---- | .----- | ----                           | :-----                        |
| STRT  | .ft    | 0.00                           | :START MD                     |
| STOP  | .ft    | 17356.82                       | :STOP MD                      |
| STEP  | .ft    | 0.0                            | :STEP (non-uniform increment) |
| NULL  | .      | -999.99                        | :NULL                         |
| COMP  | .      | SRC ENERGY                     | :OPERATOR                     |
| WELL  | .      | GREELEY-ROTHE FEDERAL 13N-2B-L | :WELL                         |
| FLD   | .      | WELD COUNTY (NAD83,TRUE NORTH) | :FIELD                        |
| LOC   | .      | COLORADO                       | :AREA (aka: Location)         |
| CNTY  | .      | N/A                            | :COUNTY                       |
| STAT  | .      | N/A                            | :STATE                        |
| CTRY  | .      | N/A                            | :COUNTRY                      |
| SRVC  | .      | Baker Hughes                   | :CONTRACTOR                   |
| DATE  | .      | 10/04/2017                     | :LOG REV DATE                 |
| API   | .      |                                | :API NUMBER                   |

~OTHER INFORMATION

#Software: WellArchitect(R) Version 5.0

| #MNEM    | .UNITS | DATA  | :DESCRIPTION                   |
|----------|--------|---|--------------------------------|
| #----    | .----- | ----  | :-----                         |
| WPTYPE   | .      | PLANNED WELLPATH  | :WELLPATH TYPE                 |
| FACILITY | .      | SEC.01-T05N-R67W  | :FACILITY                      |
| SLOT     | .      | SLOT#21 GREELEY-ROTHE FEDERAL 13N-2B-L (1003'FSL & 294'FEL, SEC.01) | :SLOT                          |
| WELLBORE | .      | GREELEY-ROTHE FEDERAL 13N-2B-L PWB                                  | :WELLBORE                      |
| WELLPATH | .      | GREELEY-ROTHE FEDERAL 13N-2B-L PWP (REV-A.0)                        | :WELLPATH                      |
| MDREFPT  | .      | PRECISION 462 (20') (RKB)   | :MD REFERENCE POINT            |
| TVDREFPT | .      | PRECISION 462 (20') (RKB)   | :TVD REFERENCE POINT           |
| LCLREFPT | .      | Slot  | :LOCAL COORDINATE REFERENCE PT |

GREELEY-ROTHE\_FEDERAL\_13N-2B-L\_PWP\_\_REV-A.0\_.las

VSAZIMUTH.deg      268.82      :VERTICAL SECTION AZIMUTH  
 VSORIGN .ft      0.00      :VERTICAL SECTION ORIGIN NORTH  
 VSORIGE .ft      0.00      :VERTICAL SECTION ORIGIN EAST

~CURVE (WELLPATH) INFORMATION

#MNEM .UNITS :DESCRIPTION  
 #---- .----- :-----  
 DEPT .ft :MEASURED DEPTH  
 INC .deg :INCLINATION  
 AZI .deg :AZIMUTH  
 TVD .ft :TRUE VERTICAL DEPTH  
 SECT .ft :CROSS SECTION (CURTAIN/VERTICAL)  
 LOCALN .ft :LOCAL NORTH  
 LOCALE .ft :LOCAL EAST  
 LAT .deg :LATITUDE  
 LONG .deg :LONGITUDE  
 DLS .deg/100ft :DOGLEG SEVERITY

~ASCII DATA

|         |      |        |         |        |       |       |            |              |      |
|---------|------|--------|---------|--------|-------|-------|------------|--------------|------|
| 0.00    | 0.00 | 102.76 | 0.00    | 0.00   | 0.00  | 0.00  | 40.4243069 | -104.8335039 | 0.00 |
| 20.00   | 0.00 | 102.76 | 20.00   | 0.00   | 0.00  | 0.00  | 40.4243069 | -104.8335039 | 0.00 |
| 120.00  | 0.00 | 102.76 | 120.00  | 0.00   | 0.00  | 0.00  | 40.4243069 | -104.8335039 | 0.00 |
| 220.00  | 0.00 | 102.76 | 220.00  | 0.00   | 0.00  | 0.00  | 40.4243069 | -104.8335039 | 0.00 |
| 320.00  | 0.00 | 102.76 | 320.00  | 0.00   | 0.00  | 0.00  | 40.4243069 | -104.8335039 | 0.00 |
| 420.00  | 0.00 | 102.76 | 420.00  | 0.00   | 0.00  | 0.00  | 40.4243069 | -104.8335039 | 0.00 |
| 520.00  | 0.00 | 102.76 | 520.00  | 0.00   | 0.00  | 0.00  | 40.4243069 | -104.8335039 | 0.00 |
| 600.00  | 0.00 | 102.76 | 600.00  | 0.00   | 0.00  | 0.00  | 40.4243069 | -104.8335039 | 0.00 |
| 620.00  | 0.40 | 102.76 | 620.00  | -0.07  | -0.02 | 0.07  | 40.4243069 | -104.8335036 | 2.00 |
| 720.00  | 2.40 | 102.76 | 719.96  | -2.44  | -0.55 | 2.45  | 40.4243054 | -104.8334951 | 2.00 |
| 820.00  | 4.40 | 102.76 | 819.78  | -8.19  | -1.86 | 8.23  | 40.4243018 | -104.8334743 | 2.00 |
| 920.00  | 6.40 | 102.76 | 919.33  | -17.33 | -3.94 | 17.41 | 40.4242961 | -104.8334413 | 2.00 |
| 1017.15 | 8.34 | 102.76 | 1015.67 | -29.42 | -6.69 | 29.57 | 40.4242886 | -104.8333977 | 2.00 |
| 1020.00 | 8.34 | 102.76 | 1018.50 | -29.83 | -6.78 | 29.97 | 40.4242883 | -104.8333962 | 0.00 |
| 1120.00 | 8.34 | 102.76 | 1117.44 | -43.91 | -9.99 | 44.12 | 40.4242795 | -104.8333454 | 0.00 |

GREELEY-ROTHE\_FEDERAL\_13N-2B-L\_PWP\_\_REV-A.0\_.las

|         |      |        |         |         |         |        |            |              |      |
|---------|------|--------|---------|---------|---------|--------|------------|--------------|------|
| 1220.00 | 8.34 | 102.76 | 1216.38 | -57.99  | -13.19  | 58.28  | 40.4242707 | -104.8332946 | 0.00 |
| 1320.00 | 8.34 | 102.76 | 1315.32 | -72.07  | -16.39  | 72.43  | 40.4242619 | -104.8332438 | 0.00 |
| 1420.00 | 8.34 | 102.76 | 1414.26 | -86.16  | -19.60  | 86.58  | 40.4242531 | -104.8331929 | 0.00 |
| 1520.00 | 8.34 | 102.76 | 1513.21 | -100.24 | -22.80  | 100.73 | 40.4242444 | -104.8331421 | 0.00 |
| 1620.00 | 8.34 | 102.76 | 1612.15 | -114.32 | -26.01  | 114.88 | 40.4242356 | -104.8330913 | 0.00 |
| 1720.00 | 8.34 | 102.76 | 1711.09 | -128.41 | -29.21  | 129.03 | 40.4242268 | -104.8330404 | 0.00 |
| 1820.00 | 8.34 | 102.76 | 1810.03 | -142.49 | -32.41  | 143.19 | 40.4242180 | -104.8329896 | 0.00 |
| 1920.00 | 8.34 | 102.76 | 1908.97 | -156.57 | -35.62  | 157.34 | 40.4242092 | -104.8329388 | 0.00 |
| 2020.00 | 8.34 | 102.76 | 2007.91 | -170.65 | -38.82  | 171.49 | 40.4242004 | -104.8328880 | 0.00 |
| 2120.00 | 8.34 | 102.76 | 2106.86 | -184.74 | -42.02  | 185.64 | 40.4241916 | -104.8328371 | 0.00 |
| 2220.00 | 8.34 | 102.76 | 2205.80 | -198.82 | -45.23  | 199.79 | 40.4241828 | -104.8327863 | 0.00 |
| 2320.00 | 8.34 | 102.76 | 2304.74 | -212.90 | -48.43  | 213.94 | 40.4241740 | -104.8327355 | 0.00 |
| 2420.00 | 8.34 | 102.76 | 2403.68 | -226.98 | -51.63  | 228.10 | 40.4241652 | -104.8326846 | 0.00 |
| 2520.00 | 8.34 | 102.76 | 2502.62 | -241.07 | -54.84  | 242.25 | 40.4241564 | -104.8326338 | 0.00 |
| 2620.00 | 8.34 | 102.76 | 2601.57 | -255.15 | -58.04  | 256.40 | 40.4241476 | -104.8325830 | 0.00 |
| 2720.00 | 8.34 | 102.76 | 2700.51 | -269.23 | -61.24  | 270.55 | 40.4241388 | -104.8325322 | 0.00 |
| 2820.00 | 8.34 | 102.76 | 2799.45 | -283.32 | -64.45  | 284.70 | 40.4241300 | -104.8324813 | 0.00 |
| 2920.00 | 8.34 | 102.76 | 2898.39 | -297.40 | -67.65  | 298.85 | 40.4241212 | -104.8324305 | 0.00 |
| 3020.00 | 8.34 | 102.76 | 2997.33 | -311.48 | -70.85  | 313.01 | 40.4241125 | -104.8323797 | 0.00 |
| 3120.00 | 8.34 | 102.76 | 3096.27 | -325.56 | -74.06  | 327.16 | 40.4241037 | -104.8323288 | 0.00 |
| 3220.00 | 8.34 | 102.76 | 3195.22 | -339.65 | -77.26  | 341.31 | 40.4240949 | -104.8322780 | 0.00 |
| 3320.00 | 8.34 | 102.76 | 3294.16 | -353.73 | -80.46  | 355.46 | 40.4240861 | -104.8322272 | 0.00 |
| 3420.00 | 8.34 | 102.76 | 3393.10 | -367.81 | -83.67  | 369.61 | 40.4240773 | -104.8321764 | 0.00 |
| 3520.00 | 8.34 | 102.76 | 3492.04 | -381.89 | -86.87  | 383.76 | 40.4240685 | -104.8321255 | 0.00 |
| 3620.00 | 8.34 | 102.76 | 3590.98 | -395.98 | -90.07  | 397.92 | 40.4240597 | -104.8320747 | 0.00 |
| 3720.00 | 8.34 | 102.76 | 3689.92 | -410.06 | -93.28  | 412.07 | 40.4240509 | -104.8320239 | 0.00 |
| 3820.00 | 8.34 | 102.76 | 3788.87 | -424.14 | -96.48  | 426.22 | 40.4240421 | -104.8319731 | 0.00 |
| 3920.00 | 8.34 | 102.76 | 3887.81 | -438.23 | -99.68  | 440.37 | 40.4240333 | -104.8319222 | 0.00 |
| 4020.00 | 8.34 | 102.76 | 3986.75 | -452.31 | -102.89 | 454.52 | 40.4240245 | -104.8318714 | 0.00 |
| 4120.00 | 8.34 | 102.76 | 4085.69 | -466.39 | -106.09 | 468.68 | 40.4240157 | -104.8318206 | 0.00 |
| 4220.00 | 8.34 | 102.76 | 4184.63 | -480.47 | -109.29 | 482.83 | 40.4240069 | -104.8317697 | 0.00 |
| 4320.00 | 8.34 | 102.76 | 4283.57 | -494.56 | -112.50 | 496.98 | 40.4239981 | -104.8317189 | 0.00 |
| 4420.00 | 8.34 | 102.76 | 4382.52 | -508.64 | -115.70 | 511.13 | 40.4239893 | -104.8316681 | 0.00 |
| 4520.00 | 8.34 | 102.76 | 4481.46 | -522.72 | -118.90 | 525.28 | 40.4239806 | -104.8316173 | 0.00 |

GREELEY-ROTHE\_FEDERAL\_13N-2B-L\_PWP\_\_REV-A.0\_.las

|         |       |        |         |         |         |         |            |              |      |
|---------|-------|--------|---------|---------|---------|---------|------------|--------------|------|
| 4620.00 | 8.34  | 102.76 | 4580.40 | -536.80 | -122.11 | 539.43  | 40.4239718 | -104.8315664 | 0.00 |
| 4720.00 | 8.34  | 102.76 | 4679.34 | -550.89 | -125.31 | 553.59  | 40.4239630 | -104.8315156 | 0.00 |
| 4820.00 | 8.34  | 102.76 | 4778.28 | -564.97 | -128.51 | 567.74  | 40.4239542 | -104.8314648 | 0.00 |
| 4920.00 | 8.34  | 102.76 | 4877.23 | -579.05 | -131.72 | 581.89  | 40.4239454 | -104.8314139 | 0.00 |
| 5020.00 | 8.34  | 102.76 | 4976.17 | -593.14 | -134.92 | 596.04  | 40.4239366 | -104.8313631 | 0.00 |
| 5120.00 | 8.34  | 102.76 | 5075.11 | -607.22 | -138.12 | 610.19  | 40.4239278 | -104.8313123 | 0.00 |
| 5220.00 | 8.34  | 102.76 | 5174.05 | -621.30 | -141.33 | 624.34  | 40.4239190 | -104.8312615 | 0.00 |
| 5320.00 | 8.34  | 102.76 | 5272.99 | -635.38 | -144.53 | 638.50  | 40.4239102 | -104.8312106 | 0.00 |
| 5420.00 | 8.34  | 102.76 | 5371.93 | -649.47 | -147.74 | 652.65  | 40.4239014 | -104.8311598 | 0.00 |
| 5520.00 | 8.34  | 102.76 | 5470.88 | -663.55 | -150.94 | 666.80  | 40.4238926 | -104.8311090 | 0.00 |
| 5620.00 | 8.34  | 102.76 | 5569.82 | -677.63 | -154.14 | 680.95  | 40.4238838 | -104.8310582 | 0.00 |
| 5720.00 | 8.34  | 102.76 | 5668.76 | -691.71 | -157.35 | 695.10  | 40.4238750 | -104.8310073 | 0.00 |
| 5820.00 | 8.34  | 102.76 | 5767.70 | -705.80 | -160.55 | 709.25  | 40.4238662 | -104.8309565 | 0.00 |
| 5920.00 | 8.34  | 102.76 | 5866.64 | -719.88 | -163.75 | 723.41  | 40.4238574 | -104.8309057 | 0.00 |
| 6020.00 | 8.34  | 102.76 | 5965.58 | -733.96 | -166.96 | 737.56  | 40.4238486 | -104.8308548 | 0.00 |
| 6120.00 | 8.34  | 102.76 | 6064.53 | -748.05 | -170.16 | 751.71  | 40.4238398 | -104.8308040 | 0.00 |
| 6220.00 | 8.34  | 102.76 | 6163.47 | -762.13 | -173.36 | 765.86  | 40.4238311 | -104.8307532 | 0.00 |
| 6309.16 | 8.34  | 102.76 | 6251.68 | -774.68 | -176.22 | 778.48  | 40.4238232 | -104.8307079 | 0.00 |
| 6320.00 | 7.40  | 104.45 | 6262.42 | -776.12 | -176.57 | 779.92  | 40.4238223 | -104.8307027 | 9.00 |
| 6420.00 | 2.62  | 224.74 | 6362.16 | -780.69 | -179.80 | 784.56  | 40.4238134 | -104.8306860 | 9.00 |
| 6520.00 | 11.00 | 260.38 | 6461.39 | -769.59 | -183.02 | 773.52  | 40.4238045 | -104.8307257 | 9.00 |
| 6620.00 | 19.92 | 264.85 | 6557.68 | -743.11 | -186.15 | 747.10  | 40.4237959 | -104.8308206 | 9.00 |
| 6720.00 | 28.90 | 266.61 | 6648.65 | -701.88 | -189.12 | 705.92  | 40.4237878 | -104.8309685 | 9.00 |
| 6820.00 | 37.88 | 267.59 | 6732.06 | -646.93 | -191.84 | 651.02  | 40.4237803 | -104.8311657 | 9.00 |
| 6920.00 | 46.87 | 268.24 | 6805.86 | -579.61 | -194.26 | 583.74  | 40.4237737 | -104.8314073 | 9.00 |
| 7020.00 | 55.86 | 268.72 | 6868.23 | -501.58 | -196.30 | 505.73  | 40.4237681 | -104.8316875 | 9.00 |
| 7120.00 | 64.86 | 269.11 | 6917.64 | -414.76 | -197.94 | 418.92  | 40.4237636 | -104.8319993 | 9.00 |
| 7220.00 | 73.85 | 269.44 | 6952.87 | -321.28 | -199.11 | 325.45  | 40.4237604 | -104.8323350 | 9.00 |
| 7320.00 | 82.85 | 269.75 | 6973.04 | -223.45 | -199.80 | 227.61  | 40.4237585 | -104.8326864 | 9.00 |
| 7402.23 | 90.24 | 269.99 | 6978.00 | -141.44 | -199.99 | 145.58  | 40.4237580 | -104.8329810 | 9.00 |
| 7420.00 | 90.24 | 269.99 | 6977.93 | -123.67 | -199.99 | 127.82  | 40.4237580 | -104.8330448 | 0.00 |
| 7520.00 | 90.24 | 269.99 | 6977.50 | -23.70  | -200.01 | 27.82   | 40.4237579 | -104.8334040 | 0.00 |
| 7620.00 | 90.24 | 269.99 | 6977.08 | 76.28   | -200.03 | -72.18  | 40.4237579 | -104.8337631 | 0.00 |
| 7720.00 | 90.24 | 269.99 | 6976.66 | 176.26  | -200.05 | -172.18 | 40.4237578 | -104.8341223 | 0.00 |

GREELEY-ROTHE\_FEDERAL\_13N-2B-L\_PWP\_\_REV-A.0\_.las

|          |       |        |         |         |         |          |            |              |      |
|----------|-------|--------|---------|---------|---------|----------|------------|--------------|------|
| 7820.00  | 90.24 | 269.99 | 6976.24 | 276.24  | -200.07 | -272.18  | 40.4237578 | -104.8344815 | 0.00 |
| 7920.00  | 90.24 | 269.99 | 6975.82 | 376.22  | -200.09 | -372.18  | 40.4237577 | -104.8348406 | 0.00 |
| 8020.00  | 90.24 | 269.99 | 6975.39 | 476.20  | -200.12 | -472.18  | 40.4237576 | -104.8351998 | 0.00 |
| 8120.00  | 90.24 | 269.99 | 6974.97 | 576.17  | -200.14 | -572.17  | 40.4237576 | -104.8355589 | 0.00 |
| 8220.00  | 90.24 | 269.99 | 6974.55 | 676.15  | -200.16 | -672.17  | 40.4237575 | -104.8359181 | 0.00 |
| 8320.00  | 90.24 | 269.99 | 6974.13 | 776.13  | -200.18 | -772.17  | 40.4237574 | -104.8362773 | 0.00 |
| 8420.00  | 90.24 | 269.99 | 6973.71 | 876.11  | -200.20 | -872.17  | 40.4237574 | -104.8366364 | 0.00 |
| 8520.00  | 90.24 | 269.99 | 6973.28 | 976.09  | -200.22 | -972.17  | 40.4237573 | -104.8369956 | 0.00 |
| 8620.00  | 90.24 | 269.99 | 6972.86 | 1076.07 | -200.24 | -1072.17 | 40.4237572 | -104.8373547 | 0.00 |
| 8720.00  | 90.24 | 269.99 | 6972.44 | 1176.04 | -200.26 | -1172.17 | 40.4237572 | -104.8377139 | 0.00 |
| 8820.00  | 90.24 | 269.99 | 6972.02 | 1276.02 | -200.28 | -1272.17 | 40.4237571 | -104.8380731 | 0.00 |
| 8920.00  | 90.24 | 269.99 | 6971.60 | 1376.00 | -200.30 | -1372.17 | 40.4237570 | -104.8384322 | 0.00 |
| 9020.00  | 90.24 | 269.99 | 6971.17 | 1475.98 | -200.32 | -1472.17 | 40.4237570 | -104.8387914 | 0.00 |
| 9120.00  | 90.24 | 269.99 | 6970.75 | 1575.96 | -200.34 | -1572.17 | 40.4237569 | -104.8391505 | 0.00 |
| 9220.00  | 90.24 | 269.99 | 6970.33 | 1675.94 | -200.36 | -1672.16 | 40.4237568 | -104.8395097 | 0.00 |
| 9320.00  | 90.24 | 269.99 | 6969.91 | 1775.91 | -200.38 | -1772.16 | 40.4237567 | -104.8398689 | 0.00 |
| 9420.00  | 90.24 | 269.99 | 6969.49 | 1875.89 | -200.40 | -1872.16 | 40.4237567 | -104.8402280 | 0.00 |
| 9520.00  | 90.24 | 269.99 | 6969.06 | 1975.87 | -200.43 | -1972.16 | 40.4237566 | -104.8405872 | 0.00 |
| 9620.00  | 90.24 | 269.99 | 6968.64 | 2075.85 | -200.45 | -2072.16 | 40.4237565 | -104.8409464 | 0.00 |
| 9720.00  | 90.24 | 269.99 | 6968.22 | 2175.83 | -200.47 | -2172.16 | 40.4237564 | -104.8413055 | 0.00 |
| 9820.00  | 90.24 | 269.99 | 6967.80 | 2275.81 | -200.49 | -2272.16 | 40.4237563 | -104.8416647 | 0.00 |
| 9920.00  | 90.24 | 269.99 | 6967.38 | 2375.78 | -200.51 | -2372.16 | 40.4237563 | -104.8420238 | 0.00 |
| 10020.00 | 90.24 | 269.99 | 6966.96 | 2475.76 | -200.53 | -2472.16 | 40.4237562 | -104.8423830 | 0.00 |
| 10120.00 | 90.24 | 269.99 | 6966.53 | 2575.74 | -200.55 | -2572.16 | 40.4237561 | -104.8427422 | 0.00 |
| 10220.00 | 90.24 | 269.99 | 6966.11 | 2675.72 | -200.57 | -2672.16 | 40.4237560 | -104.8431013 | 0.00 |
| 10320.00 | 90.24 | 269.99 | 6965.69 | 2775.70 | -200.59 | -2772.15 | 40.4237559 | -104.8434605 | 0.00 |
| 10420.00 | 90.24 | 269.99 | 6965.27 | 2875.68 | -200.61 | -2872.15 | 40.4237558 | -104.8438196 | 0.00 |
| 10520.00 | 90.24 | 269.99 | 6964.85 | 2975.65 | -200.63 | -2972.15 | 40.4237557 | -104.8441788 | 0.00 |
| 10620.00 | 90.24 | 269.99 | 6964.42 | 3075.63 | -200.65 | -3072.15 | 40.4237556 | -104.8445380 | 0.00 |
| 10720.00 | 90.24 | 269.99 | 6964.00 | 3175.61 | -200.67 | -3172.15 | 40.4237556 | -104.8448971 | 0.00 |
| 10820.00 | 90.24 | 269.99 | 6963.58 | 3275.59 | -200.69 | -3272.15 | 40.4237555 | -104.8452563 | 0.00 |
| 10920.00 | 90.24 | 269.99 | 6963.16 | 3375.57 | -200.72 | -3372.15 | 40.4237554 | -104.8456154 | 0.00 |
| 11020.00 | 90.24 | 269.99 | 6962.74 | 3475.55 | -200.74 | -3472.15 | 40.4237553 | -104.8459746 | 0.00 |
| 11120.00 | 90.24 | 269.99 | 6962.31 | 3575.52 | -200.76 | -3572.15 | 40.4237552 | -104.8463338 | 0.00 |

GREELEY-ROTHE\_FEDERAL\_13N-2B-L\_PWP\_\_REV-A.0\_.las

|          |       |        |         |         |         |          |            |              |      |
|----------|-------|--------|---------|---------|---------|----------|------------|--------------|------|
| 11220.00 | 90.24 | 269.99 | 6961.89 | 3675.50 | -200.78 | -3672.15 | 40.4237551 | -104.8466929 | 0.00 |
| 11320.00 | 90.24 | 269.99 | 6961.47 | 3775.48 | -200.80 | -3772.15 | 40.4237550 | -104.8470521 | 0.00 |
| 11420.00 | 90.24 | 269.99 | 6961.05 | 3875.46 | -200.82 | -3872.15 | 40.4237549 | -104.8474113 | 0.00 |
| 11520.00 | 90.24 | 269.99 | 6960.63 | 3975.44 | -200.84 | -3972.14 | 40.4237548 | -104.8477704 | 0.00 |
| 11620.00 | 90.24 | 269.99 | 6960.20 | 4075.42 | -200.86 | -4072.14 | 40.4237547 | -104.8481296 | 0.00 |
| 11720.00 | 90.24 | 269.99 | 6959.78 | 4175.39 | -200.88 | -4172.14 | 40.4237546 | -104.8484887 | 0.00 |
| 11820.00 | 90.24 | 269.99 | 6959.36 | 4275.37 | -200.90 | -4272.14 | 40.4237545 | -104.8488479 | 0.00 |
| 11920.00 | 90.24 | 269.99 | 6958.94 | 4375.35 | -200.92 | -4372.14 | 40.4237544 | -104.8492071 | 0.00 |
| 12020.00 | 90.24 | 269.99 | 6958.52 | 4475.33 | -200.94 | -4472.14 | 40.4237543 | -104.8495662 | 0.00 |
| 12120.00 | 90.24 | 269.99 | 6958.09 | 4575.31 | -200.96 | -4572.14 | 40.4237542 | -104.8499254 | 0.00 |
| 12220.00 | 90.24 | 269.99 | 6957.67 | 4675.29 | -200.98 | -4672.14 | 40.4237541 | -104.8502845 | 0.00 |
| 12320.00 | 90.24 | 269.99 | 6957.25 | 4775.26 | -201.00 | -4772.14 | 40.4237539 | -104.8506437 | 0.00 |
| 12420.00 | 90.24 | 269.99 | 6956.83 | 4875.24 | -201.03 | -4872.14 | 40.4237538 | -104.8510029 | 0.00 |
| 12520.00 | 90.24 | 269.99 | 6956.41 | 4975.22 | -201.05 | -4972.14 | 40.4237537 | -104.8513620 | 0.00 |
| 12620.00 | 90.24 | 269.99 | 6955.99 | 5075.20 | -201.07 | -5072.13 | 40.4237536 | -104.8517212 | 0.00 |
| 12720.00 | 90.24 | 269.99 | 6955.56 | 5175.18 | -201.09 | -5172.13 | 40.4237535 | -104.8520803 | 0.00 |
| 12820.00 | 90.24 | 269.99 | 6955.14 | 5275.16 | -201.11 | -5272.13 | 40.4237534 | -104.8524395 | 0.00 |
| 12920.00 | 90.24 | 269.99 | 6954.72 | 5375.13 | -201.13 | -5372.13 | 40.4237533 | -104.8527987 | 0.00 |
| 13020.00 | 90.24 | 269.99 | 6954.30 | 5475.11 | -201.15 | -5472.13 | 40.4237531 | -104.8531578 | 0.00 |
| 13120.00 | 90.24 | 269.99 | 6953.88 | 5575.09 | -201.17 | -5572.13 | 40.4237530 | -104.8535170 | 0.00 |
| 13220.00 | 90.24 | 269.99 | 6953.45 | 5675.07 | -201.19 | -5672.13 | 40.4237529 | -104.8538762 | 0.00 |
| 13320.00 | 90.24 | 269.99 | 6953.03 | 5775.05 | -201.21 | -5772.13 | 40.4237528 | -104.8542353 | 0.00 |
| 13420.00 | 90.24 | 269.99 | 6952.61 | 5875.03 | -201.23 | -5872.13 | 40.4237527 | -104.8545945 | 0.00 |
| 13520.00 | 90.24 | 269.99 | 6952.19 | 5975.00 | -201.25 | -5972.13 | 40.4237525 | -104.8549536 | 0.00 |
| 13620.00 | 90.24 | 269.99 | 6951.77 | 6074.98 | -201.27 | -6072.13 | 40.4237524 | -104.8553128 | 0.00 |
| 13720.00 | 90.24 | 269.99 | 6951.34 | 6174.96 | -201.29 | -6172.12 | 40.4237523 | -104.8556720 | 0.00 |
| 13820.00 | 90.24 | 269.99 | 6950.92 | 6274.94 | -201.32 | -6272.12 | 40.4237522 | -104.8560311 | 0.00 |
| 13920.00 | 90.24 | 269.99 | 6950.50 | 6374.92 | -201.34 | -6372.12 | 40.4237520 | -104.8563903 | 0.00 |
| 14020.00 | 90.24 | 269.99 | 6950.08 | 6474.90 | -201.36 | -6472.12 | 40.4237519 | -104.8567494 | 0.00 |
| 14120.00 | 90.24 | 269.99 | 6949.66 | 6574.87 | -201.38 | -6572.12 | 40.4237518 | -104.8571086 | 0.00 |
| 14220.00 | 90.24 | 269.99 | 6949.23 | 6674.85 | -201.40 | -6672.12 | 40.4237517 | -104.8574678 | 0.00 |
| 14320.00 | 90.24 | 269.99 | 6948.81 | 6774.83 | -201.42 | -6772.12 | 40.4237515 | -104.8578269 | 0.00 |
| 14420.00 | 90.24 | 269.99 | 6948.39 | 6874.81 | -201.44 | -6872.12 | 40.4237514 | -104.8581861 | 0.00 |
| 14520.00 | 90.24 | 269.99 | 6947.97 | 6974.79 | -201.46 | -6972.12 | 40.4237513 | -104.8585452 | 0.00 |

GREELEY-ROTHER\_FEDERAL\_13N-2B-L\_PWP\_\_REV-A.0\_.las

|          |       |        |         |         |         |          |            |              |      |
|----------|-------|--------|---------|---------|---------|----------|------------|--------------|------|
| 14620.00 | 90.24 | 269.99 | 6947.55 | 7074.77 | -201.48 | -7072.12 | 40.4237511 | -104.8589044 | 0.00 |
| 14720.00 | 90.24 | 269.99 | 6947.13 | 7174.74 | -201.50 | -7172.12 | 40.4237510 | -104.8592636 | 0.00 |
| 14820.00 | 90.24 | 269.99 | 6946.70 | 7274.72 | -201.52 | -7272.11 | 40.4237508 | -104.8596227 | 0.00 |
| 14920.00 | 90.24 | 269.99 | 6946.28 | 7374.70 | -201.54 | -7372.11 | 40.4237507 | -104.8599819 | 0.00 |
| 15020.00 | 90.24 | 269.99 | 6945.86 | 7474.68 | -201.56 | -7472.11 | 40.4237506 | -104.8603411 | 0.00 |
| 15120.00 | 90.24 | 269.99 | 6945.44 | 7574.66 | -201.58 | -7572.11 | 40.4237504 | -104.8607002 | 0.00 |
| 15220.00 | 90.24 | 269.99 | 6945.02 | 7674.64 | -201.60 | -7672.11 | 40.4237503 | -104.8610594 | 0.00 |
| 15320.00 | 90.24 | 269.99 | 6944.59 | 7774.61 | -201.63 | -7772.11 | 40.4237501 | -104.8614185 | 0.00 |
| 15420.00 | 90.24 | 269.99 | 6944.17 | 7874.59 | -201.65 | -7872.11 | 40.4237500 | -104.8617777 | 0.00 |
| 15520.00 | 90.24 | 269.99 | 6943.75 | 7974.57 | -201.67 | -7972.11 | 40.4237499 | -104.8621369 | 0.00 |
| 15620.00 | 90.24 | 269.99 | 6943.33 | 8074.55 | -201.69 | -8072.11 | 40.4237497 | -104.8624960 | 0.00 |
| 15720.00 | 90.24 | 269.99 | 6942.91 | 8174.53 | -201.71 | -8172.11 | 40.4237496 | -104.8628552 | 0.00 |
| 15820.00 | 90.24 | 269.99 | 6942.48 | 8274.51 | -201.73 | -8272.11 | 40.4237494 | -104.8632143 | 0.00 |
| 15920.00 | 90.24 | 269.99 | 6942.06 | 8374.48 | -201.75 | -8372.10 | 40.4237493 | -104.8635735 | 0.00 |
| 16020.00 | 90.24 | 269.99 | 6941.64 | 8474.46 | -201.77 | -8472.10 | 40.4237491 | -104.8639327 | 0.00 |
| 16120.00 | 90.24 | 269.99 | 6941.22 | 8574.44 | -201.79 | -8572.10 | 40.4237490 | -104.8642918 | 0.00 |
| 16220.00 | 90.24 | 269.99 | 6940.80 | 8674.42 | -201.81 | -8672.10 | 40.4237488 | -104.8646510 | 0.00 |
| 16320.00 | 90.24 | 269.99 | 6940.37 | 8774.40 | -201.83 | -8772.10 | 40.4237487 | -104.8650101 | 0.00 |
| 16420.00 | 90.24 | 269.99 | 6939.95 | 8874.38 | -201.85 | -8872.10 | 40.4237485 | -104.8653693 | 0.00 |
| 16520.00 | 90.24 | 269.99 | 6939.53 | 8974.35 | -201.87 | -8972.10 | 40.4237483 | -104.8657285 | 0.00 |
| 16620.00 | 90.24 | 269.99 | 6939.11 | 9074.33 | -201.89 | -9072.10 | 40.4237482 | -104.8660876 | 0.00 |
| 16720.00 | 90.24 | 269.99 | 6938.69 | 9174.31 | -201.92 | -9172.10 | 40.4237480 | -104.8664468 | 0.00 |
| 16820.00 | 90.24 | 269.99 | 6938.26 | 9274.29 | -201.94 | -9272.10 | 40.4237479 | -104.8668060 | 0.00 |
| 16920.00 | 90.24 | 269.99 | 6937.84 | 9374.27 | -201.96 | -9372.10 | 40.4237477 | -104.8671651 | 0.00 |
| 17020.00 | 90.24 | 269.99 | 6937.42 | 9474.25 | -201.98 | -9472.10 | 40.4237476 | -104.8675243 | 0.00 |
| 17120.00 | 90.24 | 269.99 | 6937.00 | 9574.22 | -202.00 | -9572.09 | 40.4237474 | -104.8678834 | 0.00 |
| 17220.00 | 90.24 | 269.99 | 6936.58 | 9674.20 | -202.02 | -9672.09 | 40.4237472 | -104.8682426 | 0.00 |
| 17320.00 | 90.24 | 269.99 | 6936.16 | 9774.18 | -202.04 | -9772.09 | 40.4237471 | -104.8686018 | 0.00 |
| 17356.82 | 90.24 | 269.99 | 6936.00 | 9810.99 | -202.05 | -9808.91 | 40.4237470 | -104.8687340 | 0.00 |





# Planned Wellpath Report

## GREELEY-ROTHER FEDERAL 13N-2B-L PWP (REV-A.0)

Page 1 of 7



### REFERENCE WELLPATH IDENTIFICATION

|          |                                |          |  |
|----------|--------------------------------|----------|--|
| Operator | SRC ENERGY                     | Slot     | SLOT#21 GREELEY-ROTHER FEDERAL 13N-2B-L (1003'FSL & 294'FEL, SEC.01) |
| Area     | COLORADO                       | Well     | GREELEY-ROTHER FEDERAL 13N-2B-L                                      |
| Field    | WELD COUNTY (NAD83,TRUE NORTH) | Wellbore | GREELEY-ROTHER FEDERAL 13N-2B-L PWB                                  |
| Facility | SEC.01-T05N-R67W               |          |  |

### REPORT SETUP INFORMATION

|                     |   |                      |   |
|---------------------|---|----------------------|---|
| Projection System   | NAD83 / Lambert Colorado SP, Northern Zone (501), US feet | Software System      | WellArchitect® 5.0  |
| North Reference     | True  | User                 | Doddanna  |
| Scale               | 0.999961  | Report Generated     | 10/4/2017 at 2:45:14 PM   |
| Convergence at slot | 0.43° East  | Database/Source file | WellArchitectDB/GREELEY-ROTHER FEDERAL_13N-2B-L_PWP__REV-A.0_.xml |

### WELLPATH LOCATION

|                       | Local coordinates |          | Grid coordinates |                 | Geographic coordinates |                 |
|-----------------------|-------------------|----------|------------------|-----------------|------------------------|-----------------|
|                       | North[ft]         | East[ft] | Easting[US ft]   | Northing[US ft] | Latitude               | Longitude       |
| Slot Location         | -1364.76          | 2.01     | 3185557.77       | 1398112.70      | 40°25'27.505"N         | 104°50'00.614"W |
| Facility Reference Pt |                   |          | 3185545.50       | 1399477.36      | 40°25'40.991"N         | 104°50'00.640"W |
| Field Reference Pt    |                   |          | 3171284.48       | 1426358.81      | 40°30'07.643"N         | 104°53'02.634"W |

### WELLPATH DATUM

|                          |                           |  |                   |
|--------------------------|---------------------------|--|-------------------|
| Calculation method       | Minimum curvature         | PRECISION 462 (20') (RKB) to Facility Vertical Datum   | 4893.00ft         |
| Horizontal Reference Pt  | Slot                      | PRECISION 462 (20') (RKB) to Mean Sea Level  | 4893.00ft         |
| Vertical Reference Pt    | PRECISION 462 (20') (RKB) | PRECISION 462 (20') (RKB) to Mud Line at Slot (SLOT#21 GREELEY-ROTHER FEDERAL 13N-2B-L (1003'FSL & 294'FEL, SEC.01)) | 4893.00ft         |
| MD Reference Pt          | PRECISION 462 (20') (RKB) | Section Origin   | N 0.00, E 0.00 ft |
| Field Vertical Reference | Mean Sea Level            | Section Azimuth  | 268.82°           |



# Planned Wellpath Report

## GREELEY-ROTHER FEDERAL 13N-2B-L PWP (REV-A.0)

Page 2 of 7



| REFERENCE WELLPATH IDENTIFICATION |                                |          |  |
|-----------------------------------|--------------------------------|----------|--|
| Operator                          | SRC ENERGY                     | Slot     | SLOT#21 GREELEY-ROTHER FEDERAL 13N-2B-L (1003'FSL & 294'FEL, SEC.01) |
| Area                              | COLORADO                       | Well     | GREELEY-ROTHER FEDERAL 13N-2B-L                                      |
| Field                             | WELD COUNTY (NAD83,TRUE NORTH) | Wellbore | GREELEY-ROTHER FEDERAL 13N-2B-L PWB                                  |
| Facility                          | SEC.01-T05N-R67W               |          |  |

| WELLPATH DATA (180 stations) † = interpolated/extrapolated station |                    |                |             |                   |               |              |                  |                |
|--|--------------------|----------------|-------------|-------------------|---------------|--------------|------------------|----------------|
| MD<br>[ft]   | Inclination<br>[°] | Azimuth<br>[°] | TVD<br>[ft] | Vert Sect<br>[ft] | North<br>[ft] | East<br>[ft] | DLS<br>[°/100ft] | Comments       |
| 0.00†  | 0.000              | 102.755        | 0.00        | 0.00              | 0.00          | 0.00         | 0.00             |                |
| 20.00  | 0.000              | 102.755        | 20.00       | 0.00              | 0.00          | 0.00         | 0.00             | Tie On         |
| 120.00†  | 0.000              | 102.755        | 120.00      | 0.00              | 0.00          | 0.00         | 0.00             |                |
| 220.00†  | 0.000              | 102.755        | 220.00      | 0.00              | 0.00          | 0.00         | 0.00             |                |
| 320.00†  | 0.000              | 102.755        | 320.00      | 0.00              | 0.00          | 0.00         | 0.00             |                |
| 420.00†  | 0.000              | 102.755        | 420.00      | 0.00              | 0.00          | 0.00         | 0.00             |                |
| 520.00†  | 0.000              | 102.755        | 520.00      | 0.00              | 0.00          | 0.00         | 0.00             |                |
| 600.00   | 0.000              | 102.755        | 600.00      | 0.00              | 0.00          | 0.00         | 0.00             | End of Tangent |
| 620.00†  | 0.400              | 102.755        | 620.00      | -0.07             | -0.02         | 0.07         | 2.00             |                |
| 720.00†  | 2.400              | 102.755        | 719.96      | -2.44             | -0.55         | 2.45         | 2.00             |                |
| 820.00†  | 4.400              | 102.755        | 819.78      | -8.19             | -1.86         | 8.23         | 2.00             |                |
| 920.00†  | 6.400              | 102.755        | 919.33      | -17.33            | -3.94         | 17.41        | 2.00             |                |
| 1017.15  | 8.343              | 102.755        | 1015.67     | -29.42            | -6.69         | 29.57        | 2.00             | End of Build   |
| 1020.00†   | 8.343              | 102.755        | 1018.50     | -29.83            | -6.78         | 29.97        | 0.00             |                |
| 1120.00†   | 8.343              | 102.755        | 1117.44     | -43.91            | -9.99         | 44.12        | 0.00             |                |
| 1220.00†   | 8.343              | 102.755        | 1216.38     | -57.99            | -13.19        | 58.28        | 0.00             |                |
| 1320.00†   | 8.343              | 102.755        | 1315.32     | -72.07            | -16.39        | 72.43        | 0.00             |                |
| 1420.00†   | 8.343              | 102.755        | 1414.26     | -86.16            | -19.60        | 86.58        | 0.00             |                |
| 1520.00†   | 8.343              | 102.755        | 1513.21     | -100.24           | -22.80        | 100.73       | 0.00             |                |
| 1620.00†   | 8.343              | 102.755        | 1612.15     | -114.32           | -26.01        | 114.88       | 0.00             |                |
| 1720.00†   | 8.343              | 102.755        | 1711.09     | -128.41           | -29.21        | 129.03       | 0.00             |                |
| 1820.00†   | 8.343              | 102.755        | 1810.03     | -142.49           | -32.41        | 143.19       | 0.00             |                |
| 1920.00†   | 8.343              | 102.755        | 1908.97     | -156.57           | -35.62        | 157.34       | 0.00             |                |
| 2020.00†   | 8.343              | 102.755        | 2007.91     | -170.65           | -38.82        | 171.49       | 0.00             |                |
| 2120.00†   | 8.343              | 102.755        | 2106.86     | -184.74           | -42.02        | 185.64       | 0.00             |                |
| 2220.00†   | 8.343              | 102.755        | 2205.80     | -198.82           | -45.23        | 199.79       | 0.00             |                |
| 2320.00†   | 8.343              | 102.755        | 2304.74     | -212.90           | -48.43        | 213.94       | 0.00             |                |
| 2420.00†   | 8.343              | 102.755        | 2403.68     | -226.98           | -51.63        | 228.10       | 0.00             |                |
| 2520.00†   | 8.343              | 102.755        | 2502.62     | -241.07           | -54.84        | 242.25       | 0.00             |                |
| 2620.00†   | 8.343              | 102.755        | 2601.57     | -255.15           | -58.04        | 256.40       | 0.00             |                |



# Planned Wellpath Report

## GREELEY-ROTHER FEDERAL 13N-2B-L PWP (REV-A.0)

Page 3 of 7



| REFERENCE WELLPATH IDENTIFICATION |                                |          |  |
|-----------------------------------|--------------------------------|----------|--|
| Operator                          | SRC ENERGY                     | Slot     | SLOT#21 GREELEY-ROTHER FEDERAL 13N-2B-L (1003'FSL & 294'FEL, SEC.01) |
| Area                              | COLORADO                       | Well     | GREELEY-ROTHER FEDERAL 13N-2B-L                                      |
| Field                             | WELD COUNTY (NAD83,TRUE NORTH) | Wellbore | GREELEY-ROTHER FEDERAL 13N-2B-L PWB                                  |
| Facility                          | SEC.01-T05N-R67W               |          |  |

| WELLPATH DATA (180 stations) † = interpolated/extrapolated station |                    |                |             |                   |               |              |                  |          |
|--|--------------------|----------------|-------------|-------------------|---------------|--------------|------------------|----------|
| MD<br>[ft]   | Inclination<br>[°] | Azimuth<br>[°] | TVD<br>[ft] | Vert Sect<br>[ft] | North<br>[ft] | East<br>[ft] | DLS<br>[°/100ft] | Comments |
| 2720.00†   | 8.343              | 102.755        | 2700.51     | -269.23           | -61.24        | 270.55       | 0.00             |          |
| 2820.00†   | 8.343              | 102.755        | 2799.45     | -283.32           | -64.45        | 284.70       | 0.00             |          |
| 2920.00†   | 8.343              | 102.755        | 2898.39     | -297.40           | -67.65        | 298.85       | 0.00             |          |
| 3020.00†   | 8.343              | 102.755        | 2997.33     | -311.48           | -70.85        | 313.01       | 0.00             |          |
| 3120.00†   | 8.343              | 102.755        | 3096.27     | -325.56           | -74.06        | 327.16       | 0.00             |          |
| 3220.00†   | 8.343              | 102.755        | 3195.22     | -339.65           | -77.26        | 341.31       | 0.00             |          |
| 3320.00†   | 8.343              | 102.755        | 3294.16     | -353.73           | -80.46        | 355.46       | 0.00             |          |
| 3420.00†   | 8.343              | 102.755        | 3393.10     | -367.81           | -83.67        | 369.61       | 0.00             |          |
| 3520.00†   | 8.343              | 102.755        | 3492.04     | -381.89           | -86.87        | 383.76       | 0.00             |          |
| 3620.00†   | 8.343              | 102.755        | 3590.98     | -395.98           | -90.07        | 397.92       | 0.00             |          |
| 3720.00†   | 8.343              | 102.755        | 3689.92     | -410.06           | -93.28        | 412.07       | 0.00             |          |
| 3820.00†   | 8.343              | 102.755        | 3788.87     | -424.14           | -96.48        | 426.22       | 0.00             |          |
| 3920.00†   | 8.343              | 102.755        | 3887.81     | -438.23           | -99.68        | 440.37       | 0.00             |          |
| 4020.00†   | 8.343              | 102.755        | 3986.75     | -452.31           | -102.89       | 454.52       | 0.00             |          |
| 4120.00†   | 8.343              | 102.755        | 4085.69     | -466.39           | -106.09       | 468.68       | 0.00             |          |
| 4220.00†   | 8.343              | 102.755        | 4184.63     | -480.47           | -109.29       | 482.83       | 0.00             |          |
| 4320.00†   | 8.343              | 102.755        | 4283.57     | -494.56           | -112.50       | 496.98       | 0.00             |          |
| 4420.00†   | 8.343              | 102.755        | 4382.52     | -508.64           | -115.70       | 511.13       | 0.00             |          |
| 4520.00†   | 8.343              | 102.755        | 4481.46     | -522.72           | -118.90       | 525.28       | 0.00             |          |
| 4620.00†   | 8.343              | 102.755        | 4580.40     | -536.80           | -122.11       | 539.43       | 0.00             |          |
| 4720.00†   | 8.343              | 102.755        | 4679.34     | -550.89           | -125.31       | 553.59       | 0.00             |          |
| 4820.00†   | 8.343              | 102.755        | 4778.28     | -564.97           | -128.51       | 567.74       | 0.00             |          |
| 4920.00†   | 8.343              | 102.755        | 4877.23     | -579.05           | -131.72       | 581.89       | 0.00             |          |
| 5020.00†   | 8.343              | 102.755        | 4976.17     | -593.14           | -134.92       | 596.04       | 0.00             |          |
| 5120.00†   | 8.343              | 102.755        | 5075.11     | -607.22           | -138.12       | 610.19       | 0.00             |          |
| 5220.00†   | 8.343              | 102.755        | 5174.05     | -621.30           | -141.33       | 624.34       | 0.00             |          |
| 5320.00†   | 8.343              | 102.755        | 5272.99     | -635.38           | -144.53       | 638.50       | 0.00             |          |
| 5420.00†   | 8.343              | 102.755        | 5371.93     | -649.47           | -147.74       | 652.65       | 0.00             |          |
| 5520.00†   | 8.343              | 102.755        | 5470.88     | -663.55           | -150.94       | 666.80       | 0.00             |          |
| 5620.00†   | 8.343              | 102.755        | 5569.82     | -677.63           | -154.14       | 680.95       | 0.00             |          |



# Planned Wellpath Report

## GREELEY-ROTHER FEDERAL 13N-2B-L PWP (REV-A.0)

Page 4 of 7



| REFERENCE WELLPATH IDENTIFICATION |                                |          |  |
|-----------------------------------|--------------------------------|----------|--|
| Operator                          | SRC ENERGY                     | Slot     | SLOT#21 GREELEY-ROTHER FEDERAL 13N-2B-L (1003'FSL & 294'FEL, SEC.01) |
| Area                              | COLORADO                       | Well     | GREELEY-ROTHER FEDERAL 13N-2B-L                                      |
| Field                             | WELD COUNTY (NAD83,TRUE NORTH) | Wellbore | GREELEY-ROTHER FEDERAL 13N-2B-L PWB                                  |
| Facility                          | SEC.01-T05N-R67W               |          |  |

| WELLPATH DATA (180 stations) † = interpolated/extrapolated station |                    |                |                      |                   |               |              |                  |                |
|--|--------------------|----------------|----------------------|-------------------|---------------|--------------|------------------|----------------|
| MD<br>[ft]   | Inclination<br>[°] | Azimuth<br>[°] | TVD<br>[ft]          | Vert Sect<br>[ft] | North<br>[ft] | East<br>[ft] | DLS<br>[°/100ft] | Comments       |
| 5720.00†   | 8.343              | 102.755        | 5668.76              | -691.71           | -157.35       | 695.10       | 0.00             |                |
| 5820.00†   | 8.343              | 102.755        | 5767.70              | -705.80           | -160.55       | 709.25       | 0.00             |                |
| 5920.00†   | 8.343              | 102.755        | 5866.64              | -719.88           | -163.75       | 723.41       | 0.00             |                |
| 6020.00†   | 8.343              | 102.755        | 5965.58              | -733.96           | -166.96       | 737.56       | 0.00             |                |
| 6120.00†   | 8.343              | 102.755        | 6064.53              | -748.05           | -170.16       | 751.71       | 0.00             |                |
| 6220.00†   | 8.343              | 102.755        | 6163.47              | -762.13           | -173.36       | 765.86       | 0.00             |                |
| 6309.16  | 8.343              | 102.755        | 6251.68              | -774.68           | -176.22       | 778.48       | 0.00             | End of Tangent |
| 6320.00†   | 7.395              | 104.448        | 6262.42              | -776.12           | -176.57       | 779.92       | 9.00             |                |
| 6420.00†   | 2.615              | 224.741        | 6362.16              | -780.69           | -179.80       | 784.56       | 9.00             |                |
| 6520.00†   | 10.997             | 260.375        | 6461.39              | -769.59           | -183.02       | 773.52       | 9.00             |                |
| 6620.00†   | 19.924             | 264.848        | 6557.68              | -743.11           | -186.15       | 747.10       | 9.00             |                |
| 6720.00†   | 28.895             | 266.612        | 6648.65              | -701.88           | -189.12       | 705.92       | 9.00             |                |
| 6820.00†   | 37.880             | 267.591        | 6732.06              | -646.93           | -191.84       | 651.02       | 9.00             |                |
| 6920.00†   | 46.869             | 268.240        | 6805.86              | -579.61           | -194.26       | 583.74       | 9.00             |                |
| 7020.00†   | 55.861             | 268.720        | 6868.23              | -501.58           | -196.30       | 505.73       | 9.00             |                |
| 7120.00†   | 64.855             | 269.108        | 6917.64              | -414.76           | -197.94       | 418.92       | 9.00             |                |
| 7220.00†   | 73.850             | 269.442        | 6952.87              | -321.28           | -199.11       | 325.45       | 9.00             |                |
| 7320.00†   | 82.845             | 269.747        | 6973.04              | -223.45           | -199.80       | 227.61       | 9.00             |                |
| 7402.23  | 90.242             | 269.988        | 6978.00 <sup>†</sup> | -141.44           | -199.99       | 145.58       | 9.00             | End of 3D Arc  |
| 7420.00†   | 90.242             | 269.988        | 6977.93              | -123.67           | -199.99       | 127.82       | 0.00             |                |
| 7520.00†   | 90.242             | 269.988        | 6977.50              | -23.70            | -200.01       | 27.82        | 0.00             |                |
| 7620.00†   | 90.242             | 269.988        | 6977.08              | 76.28             | -200.03       | -72.18       | 0.00             |                |
| 7720.00†   | 90.242             | 269.988        | 6976.66              | 176.26            | -200.05       | -172.18      | 0.00             |                |
| 7820.00†   | 90.242             | 269.988        | 6976.24              | 276.24            | -200.07       | -272.18      | 0.00             |                |
| 7920.00†   | 90.242             | 269.988        | 6975.82              | 376.22            | -200.09       | -372.18      | 0.00             |                |
| 8020.00†   | 90.242             | 269.988        | 6975.39              | 476.20            | -200.12       | -472.18      | 0.00             |                |
| 8120.00†   | 90.242             | 269.988        | 6974.97              | 576.17            | -200.14       | -572.17      | 0.00             |                |
| 8220.00†   | 90.242             | 269.988        | 6974.55              | 676.15            | -200.16       | -672.17      | 0.00             |                |
| 8320.00†   | 90.242             | 269.988        | 6974.13              | 776.13            | -200.18       | -772.17      | 0.00             |                |
| 8420.00†   | 90.242             | 269.988        | 6973.71              | 876.11            | -200.20       | -872.17      | 0.00             |                |



# Planned Wellpath Report

## GREELEY-ROTHER FEDERAL 13N-2B-L PWP (REV-A.0)

Page 5 of 7



| REFERENCE WELLPATH IDENTIFICATION |                                |          |  |
|-----------------------------------|--------------------------------|----------|--|
| Operator                          | SRC ENERGY                     | Slot     | SLOT#21 GREELEY-ROTHER FEDERAL 13N-2B-L (1003'FSL & 294'FEL, SEC.01) |
| Area                              | COLORADO                       | Well     | GREELEY-ROTHER FEDERAL 13N-2B-L                                      |
| Field                             | WELD COUNTY (NAD83,TRUE NORTH) | Wellbore | GREELEY-ROTHER FEDERAL 13N-2B-L PWB                                  |
| Facility                          | SEC.01-T05N-R67W               |          |  |

| WELLPATH DATA (180 stations) † = interpolated/extrapolated station |                    |                |             |                   |               |              |                  |          |
|--|--------------------|----------------|-------------|-------------------|---------------|--------------|------------------|----------|
| MD<br>[ft]   | Inclination<br>[°] | Azimuth<br>[°] | TVD<br>[ft] | Vert Sect<br>[ft] | North<br>[ft] | East<br>[ft] | DLS<br>[°/100ft] | Comments |
| 8520.00†   | 90.242             | 269.988        | 6973.28     | 976.09            | -200.22       | -972.17      | 0.00             |          |
| 8620.00†   | 90.242             | 269.988        | 6972.86     | 1076.07           | -200.24       | -1072.17     | 0.00             |          |
| 8720.00†   | 90.242             | 269.988        | 6972.44     | 1176.04           | -200.26       | -1172.17     | 0.00             |          |
| 8820.00†   | 90.242             | 269.988        | 6972.02     | 1276.02           | -200.28       | -1272.17     | 0.00             |          |
| 8920.00†   | 90.242             | 269.988        | 6971.60     | 1376.00           | -200.30       | -1372.17     | 0.00             |          |
| 9020.00†   | 90.242             | 269.988        | 6971.17     | 1475.98           | -200.32       | -1472.17     | 0.00             |          |
| 9120.00†   | 90.242             | 269.988        | 6970.75     | 1575.96           | -200.34       | -1572.17     | 0.00             |          |
| 9220.00†   | 90.242             | 269.988        | 6970.33     | 1675.94           | -200.36       | -1672.16     | 0.00             |          |
| 9320.00†   | 90.242             | 269.988        | 6969.91     | 1775.91           | -200.38       | -1772.16     | 0.00             |          |
| 9420.00†   | 90.242             | 269.988        | 6969.49     | 1875.89           | -200.40       | -1872.16     | 0.00             |          |
| 9520.00†   | 90.242             | 269.988        | 6969.06     | 1975.87           | -200.43       | -1972.16     | 0.00             |          |
| 9620.00†   | 90.242             | 269.988        | 6968.64     | 2075.85           | -200.45       | -2072.16     | 0.00             |          |
| 9720.00†   | 90.242             | 269.988        | 6968.22     | 2175.83           | -200.47       | -2172.16     | 0.00             |          |
| 9820.00†   | 90.242             | 269.988        | 6967.80     | 2275.81           | -200.49       | -2272.16     | 0.00             |          |
| 9920.00†   | 90.242             | 269.988        | 6967.38     | 2375.78           | -200.51       | -2372.16     | 0.00             |          |
| 10020.00†  | 90.242             | 269.988        | 6966.96     | 2475.76           | -200.53       | -2472.16     | 0.00             |          |
| 10120.00†  | 90.242             | 269.988        | 6966.53     | 2575.74           | -200.55       | -2572.16     | 0.00             |          |
| 10220.00†  | 90.242             | 269.988        | 6966.11     | 2675.72           | -200.57       | -2672.16     | 0.00             |          |
| 10320.00†  | 90.242             | 269.988        | 6965.69     | 2775.70           | -200.59       | -2772.15     | 0.00             |          |
| 10420.00†  | 90.242             | 269.988        | 6965.27     | 2875.68           | -200.61       | -2872.15     | 0.00             |          |
| 10520.00†  | 90.242             | 269.988        | 6964.85     | 2975.65           | -200.63       | -2972.15     | 0.00             |          |
| 10620.00†  | 90.242             | 269.988        | 6964.42     | 3075.63           | -200.65       | -3072.15     | 0.00             |          |
| 10720.00†  | 90.242             | 269.988        | 6964.00     | 3175.61           | -200.67       | -3172.15     | 0.00             |          |
| 10820.00†  | 90.242             | 269.988        | 6963.58     | 3275.59           | -200.69       | -3272.15     | 0.00             |          |
| 10920.00†  | 90.242             | 269.988        | 6963.16     | 3375.57           | -200.72       | -3372.15     | 0.00             |          |
| 11020.00†  | 90.242             | 269.988        | 6962.74     | 3475.55           | -200.74       | -3472.15     | 0.00             |          |
| 11120.00†  | 90.242             | 269.988        | 6962.31     | 3575.52           | -200.76       | -3572.15     | 0.00             |          |
| 11220.00†  | 90.242             | 269.988        | 6961.89     | 3675.50           | -200.78       | -3672.15     | 0.00             |          |
| 11320.00†  | 90.242             | 269.988        | 6961.47     | 3775.48           | -200.80       | -3772.15     | 0.00             |          |
| 11420.00†  | 90.242             | 269.988        | 6961.05     | 3875.46           | -200.82       | -3872.15     | 0.00             |          |



# Planned Wellpath Report

## GREELEY-ROTHER FEDERAL 13N-2B-L PWP (REV-A.0)

Page 6 of 7



| REFERENCE WELLPATH IDENTIFICATION |                                |          |  |
|-----------------------------------|--------------------------------|----------|--|
| Operator                          | SRC ENERGY                     | Slot     | SLOT#21 GREELEY-ROTHER FEDERAL 13N-2B-L (1003'FSL & 294'FEL, SEC.01) |
| Area                              | COLORADO                       | Well     | GREELEY-ROTHER FEDERAL 13N-2B-L                                      |
| Field                             | WELD COUNTY (NAD83,TRUE NORTH) | Wellbore | GREELEY-ROTHER FEDERAL 13N-2B-L PWB                                  |
| Facility                          | SEC.01-T05N-R67W               |          |  |

| WELLPATH DATA (180 stations) † = interpolated/extrapolated station |                    |                |             |                   |               |              |                  |          |
|--|--------------------|----------------|-------------|-------------------|---------------|--------------|------------------|----------|
| MD<br>[ft]   | Inclination<br>[°] | Azimuth<br>[°] | TVD<br>[ft] | Vert Sect<br>[ft] | North<br>[ft] | East<br>[ft] | DLS<br>[°/100ft] | Comments |
| 11520.00†  | 90.242             | 269.988        | 6960.63     | 3975.44           | -200.84       | -3972.14     | 0.00             |          |
| 11620.00†  | 90.242             | 269.988        | 6960.20     | 4075.42           | -200.86       | -4072.14     | 0.00             |          |
| 11720.00†  | 90.242             | 269.988        | 6959.78     | 4175.39           | -200.88       | -4172.14     | 0.00             |          |
| 11820.00†  | 90.242             | 269.988        | 6959.36     | 4275.37           | -200.90       | -4272.14     | 0.00             |          |
| 11920.00†  | 90.242             | 269.988        | 6958.94     | 4375.35           | -200.92       | -4372.14     | 0.00             |          |
| 12020.00†  | 90.242             | 269.988        | 6958.52     | 4475.33           | -200.94       | -4472.14     | 0.00             |          |
| 12120.00†  | 90.242             | 269.988        | 6958.09     | 4575.31           | -200.96       | -4572.14     | 0.00             |          |
| 12220.00†  | 90.242             | 269.988        | 6957.67     | 4675.29           | -200.98       | -4672.14     | 0.00             |          |
| 12320.00†  | 90.242             | 269.988        | 6957.25     | 4775.26           | -201.00       | -4772.14     | 0.00             |          |
| 12420.00†  | 90.242             | 269.988        | 6956.83     | 4875.24           | -201.03       | -4872.14     | 0.00             |          |
| 12520.00†  | 90.242             | 269.988        | 6956.41     | 4975.22           | -201.05       | -4972.14     | 0.00             |          |
| 12620.00†  | 90.242             | 269.988        | 6955.99     | 5075.20           | -201.07       | -5072.13     | 0.00             |          |
| 12720.00†  | 90.242             | 269.988        | 6955.56     | 5175.18           | -201.09       | -5172.13     | 0.00             |          |
| 12820.00†  | 90.242             | 269.988        | 6955.14     | 5275.16           | -201.11       | -5272.13     | 0.00             |          |
| 12920.00†  | 90.242             | 269.988        | 6954.72     | 5375.13           | -201.13       | -5372.13     | 0.00             |          |
| 13020.00†  | 90.242             | 269.988        | 6954.30     | 5475.11           | -201.15       | -5472.13     | 0.00             |          |
| 13120.00†  | 90.242             | 269.988        | 6953.88     | 5575.09           | -201.17       | -5572.13     | 0.00             |          |
| 13220.00†  | 90.242             | 269.988        | 6953.45     | 5675.07           | -201.19       | -5672.13     | 0.00             |          |
| 13320.00†  | 90.242             | 269.988        | 6953.03     | 5775.05           | -201.21       | -5772.13     | 0.00             |          |
| 13420.00†  | 90.242             | 269.988        | 6952.61     | 5875.03           | -201.23       | -5872.13     | 0.00             |          |
| 13520.00†  | 90.242             | 269.988        | 6952.19     | 5975.00           | -201.25       | -5972.13     | 0.00             |          |
| 13620.00†  | 90.242             | 269.988        | 6951.77     | 6074.98           | -201.27       | -6072.13     | 0.00             |          |
| 13720.00†  | 90.242             | 269.988        | 6951.34     | 6174.96           | -201.29       | -6172.12     | 0.00             |          |
| 13820.00†  | 90.242             | 269.988        | 6950.92     | 6274.94           | -201.32       | -6272.12     | 0.00             |          |
| 13920.00†  | 90.242             | 269.988        | 6950.50     | 6374.92           | -201.34       | -6372.12     | 0.00             |          |
| 14020.00†  | 90.242             | 269.988        | 6950.08     | 6474.90           | -201.36       | -6472.12     | 0.00             |          |
| 14120.00†  | 90.242             | 269.988        | 6949.66     | 6574.87           | -201.38       | -6572.12     | 0.00             |          |
| 14220.00†  | 90.242             | 269.988        | 6949.23     | 6674.85           | -201.40       | -6672.12     | 0.00             |          |
| 14320.00†  | 90.242             | 269.988        | 6948.81     | 6774.83           | -201.42       | -6772.12     | 0.00             |          |
| 14420.00†  | 90.242             | 269.988        | 6948.39     | 6874.81           | -201.44       | -6872.12     | 0.00             |          |





# Planned Wellpath Report

## GREELEY-ROTHER FEDERAL 13N-2B-L PWP (REV-A.0)

Page 7 of 7



| REFERENCE WELLPATH IDENTIFICATION |                                |          |  |
|-----------------------------------|--------------------------------|----------|--|
| Operator                          | SRC ENERGY                     | Slot     | SLOT#21 GREELEY-ROTHER FEDERAL 13N-2B-L (1003'FSL & 294'FEL, SEC.01) |
| Area                              | COLORADO                       | Well     | GREELEY-ROTHER FEDERAL 13N-2B-L                                      |
| Field                             | WELD COUNTY (NAD83,TRUE NORTH) | Wellbore | GREELEY-ROTHER FEDERAL 13N-2B-L PWB                                  |
| Facility                          | SEC.01-T05N-R67W               |          |  |

| WELLPATH DATA (180 stations) † = interpolated/extrapolated station |                    |                |                      |                   |               |              |                  |                |
|--|--------------------|----------------|----------------------|-------------------|---------------|--------------|------------------|----------------|
| MD<br>[ft]   | Inclination<br>[°] | Azimuth<br>[°] | TVD<br>[ft]          | Vert Sect<br>[ft] | North<br>[ft] | East<br>[ft] | DLS<br>[°/100ft] | Comments       |
| 14520.00†  | 90.242             | 269.988        | 6947.97              | 6974.79           | -201.46       | -6972.12     | 0.00             |                |
| 14620.00†  | 90.242             | 269.988        | 6947.55              | 7074.77           | -201.48       | -7072.12     | 0.00             |                |
| 14720.00†  | 90.242             | 269.988        | 6947.13              | 7174.74           | -201.50       | -7172.12     | 0.00             |                |
| 14820.00†  | 90.242             | 269.988        | 6946.70              | 7274.72           | -201.52       | -7272.11     | 0.00             |                |
| 14920.00†  | 90.242             | 269.988        | 6946.28              | 7374.70           | -201.54       | -7372.11     | 0.00             |                |
| 15020.00†  | 90.242             | 269.988        | 6945.86              | 7474.68           | -201.56       | -7472.11     | 0.00             |                |
| 15120.00†  | 90.242             | 269.988        | 6945.44              | 7574.66           | -201.58       | -7572.11     | 0.00             |                |
| 15220.00†  | 90.242             | 269.988        | 6945.02              | 7674.64           | -201.60       | -7672.11     | 0.00             |                |
| 15320.00†  | 90.242             | 269.988        | 6944.59              | 7774.61           | -201.63       | -7772.11     | 0.00             |                |
| 15420.00†  | 90.242             | 269.988        | 6944.17              | 7874.59           | -201.65       | -7872.11     | 0.00             |                |
| 15520.00†  | 90.242             | 269.988        | 6943.75              | 7974.57           | -201.67       | -7972.11     | 0.00             |                |
| 15620.00†  | 90.242             | 269.988        | 6943.33              | 8074.55           | -201.69       | -8072.11     | 0.00             |                |
| 15720.00†  | 90.242             | 269.988        | 6942.91              | 8174.53           | -201.71       | -8172.11     | 0.00             |                |
| 15820.00†  | 90.242             | 269.988        | 6942.48              | 8274.51           | -201.73       | -8272.11     | 0.00             |                |
| 15920.00†  | 90.242             | 269.988        | 6942.06              | 8374.48           | -201.75       | -8372.10     | 0.00             |                |
| 16020.00†  | 90.242             | 269.988        | 6941.64              | 8474.46           | -201.77       | -8472.10     | 0.00             |                |
| 16120.00†  | 90.242             | 269.988        | 6941.22              | 8574.44           | -201.79       | -8572.10     | 0.00             |                |
| 16220.00†  | 90.242             | 269.988        | 6940.80              | 8674.42           | -201.81       | -8672.10     | 0.00             |                |
| 16320.00†  | 90.242             | 269.988        | 6940.37              | 8774.40           | -201.83       | -8772.10     | 0.00             |                |
| 16420.00†  | 90.242             | 269.988        | 6939.95              | 8874.38           | -201.85       | -8872.10     | 0.00             |                |
| 16520.00†  | 90.242             | 269.988        | 6939.53              | 8974.35           | -201.87       | -8972.10     | 0.00             |                |
| 16620.00†  | 90.242             | 269.988        | 6939.11              | 9074.33           | -201.89       | -9072.10     | 0.00             |                |
| 16720.00†  | 90.242             | 269.988        | 6938.69              | 9174.31           | -201.92       | -9172.10     | 0.00             |                |
| 16820.00†  | 90.242             | 269.988        | 6938.26              | 9274.29           | -201.94       | -9272.10     | 0.00             |                |
| 16920.00†  | 90.242             | 269.988        | 6937.84              | 9374.27           | -201.96       | -9372.10     | 0.00             |                |
| 17020.00†  | 90.242             | 269.988        | 6937.42              | 9474.25           | -201.98       | -9472.10     | 0.00             |                |
| 17120.00†  | 90.242             | 269.988        | 6937.00              | 9574.22           | -202.00       | -9572.09     | 0.00             |                |
| 17220.00†  | 90.242             | 269.988        | 6936.58              | 9674.20           | -202.02       | -9672.09     | 0.00             |                |
| 17320.00†  | 90.242             | 269.988        | 6936.16              | 9774.18           | -202.04       | -9772.09     | 0.00             |                |
| 17356.82   | 90.242             | 269.988        | 6936.00 <sup>2</sup> | 9810.99           | -202.05       | -9808.91     | 0.00             | End of Tangent |

| HOLE & CASING SECTIONS   |                  |                |                  |                   |                 |                   |                   |                 |                 |
|--|------------------|----------------|------------------|-------------------|-----------------|-------------------|-------------------|-----------------|-----------------|
| - Ref Wellbore: GREELEY-ROTHER FEDERAL 13N-2B-L PWB      Ref Wellpath: GREELEY-ROTHER FEDERAL 13N-2B-L PWP (REV-A.0) |                  |                |                  |                   |                 |                   |                   |                 |                 |
| String/Diameter  | Start MD<br>[ft] | End MD<br>[ft] | Interval<br>[ft] | Start TVD<br>[ft] | End TVD<br>[ft] | Start N/S<br>[ft] | Start E/W<br>[ft] | End N/S<br>[ft] | End E/W<br>[ft] |
| 13.5in Open Hole   | 20.00            | 1750.00        | 1730.00          | 20.00             | 1740.77         | 0.00              | 0.00              | -30.17          | 133.28          |
| 9.625in Casing Surface   | 20.00            | 1750.00        | 1730.00          | 20.00             | 1740.77         | 0.00              | 0.00              | -30.17          | 133.28          |
| 8.5in Open Hole  | 1750.00          | 17356.82       | 15606.82         | 1740.77           | N/A             | -30.17            | 133.28            | N/A             | N/A             |

| TARGETS   |            |             |               |              |                      |                       |                |                 |         |
|---|------------|-------------|---------------|--------------|----------------------|-----------------------|----------------|-----------------|---------|
| Name  | MD<br>[ft] | TVD<br>[ft] | North<br>[ft] | East<br>[ft] | Grid East<br>[US ft] | Grid North<br>[US ft] | Latitude       | Longitude       | Shape   |
| SEC.01-T05N-R67W  |            | 23.00       | 1364.76       | -2.01        | 3185545.50           | 1399477.36            | 40°25'40.991"N | 104°50'00.640"W | polygon |
|   |            |             |               |              |                      |                       |                |                 |         |
| SEC.02-T05N-R67W  |            | 23.00       | 1364.76       | -2.01        | 3185545.50           | 1399477.36            | 40°25'40.991"N | 104°50'00.640"W | polygon |
|   |            |             |               |              |                      |                       |                |                 |         |
| 2) GREELEY ROTHE FEDERAL 13N-2B-L<br>BHL ON PLAT (892'FSL & 150'FWL,<br>SEC.02)         |            | 6936.00     | -202.07       | -9808.88     | 3175751.08           | 1397836.93            | 40°25'25.489"N | 104°52'07.442"W | circle  |
|   |            |             |               |              |                      |                       |                |                 |         |
| 1) GREELEY ROTHE FEDERAL 13N-2B-L<br>TOP OF PROD ON PLAT (798'FSL &<br>150'FEL, SEC.01) |            | 6978.00     | -199.97       | 145.55       | 3185704.81           | 1397913.84            | 40°25'25.529"N | 104°49'58.732"W | circle  |
|   |            |             |               |              |                      |                       |                |                 |         |

| SURVEY PROGRAM -                                  |                |   |                     |  |
|---|----------------|---|---------------------|--|
| Ref Wellbore: GREELEY-ROTHER FEDERAL 13N-2B-L PWB |                | Ref Wellpath: GREELEY-ROTHER FEDERAL 13N-2B-L PWP (REV-A.0)               |                     |  |
| Start MD<br>[ft]                                  | End MD<br>[ft] | Positional Uncertainty Model  | Log<br>Name/Comment | Wellbore                               |
| 20.00   | 1750.00        | Custom BHI NaviTrak (Standard Rotating+Axial Corr) (Rockies 0.03Gt model) |                     | GREELEY-ROTHER FEDERAL<br>13N-2B-L PWB |
| 1750.00   | 17356.82       | Custom BHI AutoTrak Curve (IFR1, Short) (Rockies 0.03Gt model)            |                     | GREELEY-ROTHER FEDERAL<br>13N-2B-L PWB |