

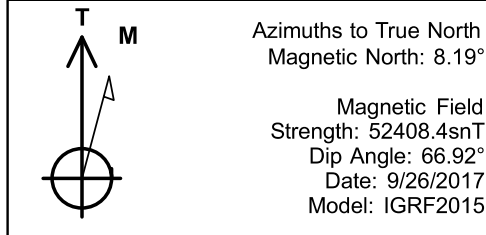

Project: SECTION 15, T6N, R66W
Site: HARVESTERS STATE 7-15 PAD
Well: HARVESTERS STATE 30N-16B-M
Wellbore: OH
Design: PLAN #1
Lat: 40.4911760
Long: -104.7625060

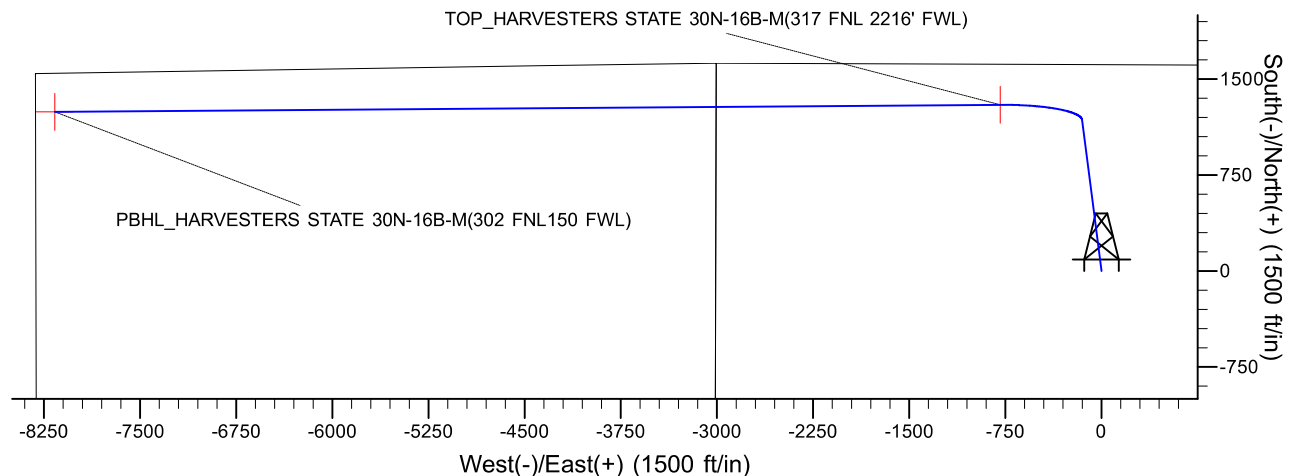

Azimuths to True North
Magnetic North: 8.19°
Magnetic Field
Strength: 52408.4snT
Dip Angle: 66.92°
Date: 9/26/2017
Model: IGRF2015



DESIGN TARGET DETAILS									
Name	TVD	+N/-S	+E/-W	Northing	Easting	Latitude	Longitude	Shape	
PBHL	7051.00	1243.28	-8165.67	1423804.17	3196945.39	40.4945850	-104.7918660	Point	
TOP	- plan hits target center								
	7072.00	1298.77	-790.42	1423920.99	3204319.91	40.4947410	-104.7653480	Point	
- plan hits target center									
SECTION DETAILS									
MD	Inc	Azi	TVD	+N/-S	+E/-W	Dleg	TFace	VSect	Target
0.00	0.00	0.00	0.00	0.00	0.00	0.00	0.00	0.00	
300.00	0.00	0.00	300.00	0.00	0.00	0.00	0.00	0.00	
872.63	11.45	352.70	868.83	56.58	-7.25	2.00	352.70	6.82	
6580.23	11.45	352.70	6462.78	1180.68	-151.30	0.00	0.00	142.41	
7566.88	90.16	269.57	7072.00	1298.77	-790.42	9.00	-83.23	780.63	
14942.37	90.16	269.57	7051.00	1243.28	-8165.67	0.00	0.00	8156.09	PBHL
CASING DETAILS						PROJECT DETAILS: SECTION 15, T6N, R66W			
TVD	MD	Name	Size	Geodetic System: US State Plane 1983 Datum: North American Datum 1983 Ellipsoid: GRS 1980 Zone: Colorado Northern Zone Colorado Northern Zone System Datum: Mean Sea Level					
1750.00	1771.71	9 5/8"	9.625						

N-16B-M/PLAN #1

Vertical Section at 269.57° (1500 ft/in)



SRC ENERGY

**SECTION 15, T6N, R66W
HARVESTERS STATE 7-15 PAD
HARVESTERS STATE 30N-16B-M**

OH

Plan: PLAN #1

Standard Planning Report

02 October, 2017





Database:	EDM 5000.14 Single User Db	Local Co-ordinate Reference:	Well HARVESTERS STATE 30N-16B-
Company:	SRC ENERGY	TVD Reference:	M KB @ 4822.00ft
Project:	SECTION 15, T6N, R66W	MD Reference:	KB @ 4822.00ft
Site:	HARVESTERS STATE 7-15 PAD	North Reference:	True
Well:	HARVESTERS STATE 30N-16B-	Survey Calculation Method:	Minimum Curvature
Wellbore:	M OH		
Design:	PLAN #1		

Project	SECTION 15, T6N, R66W		
Map System:	US State Plane 1983	System Datum:	Mean Sea Level
Geo Datum:	North American Datum 1983		
Map Zone:	Colorado Northern Zone		

Site	HARVESTERS STATE 7-15 PAD			
Site Position:		Northing:	1,422,648.53 usft	Latitude: 40.4912300
From:	Lat/Long	Easting:	3,205,120.94 usft	Longitude: -104.7625060
Position Uncertainty:	3.28 ft	Slot Radius:	13.200 in	Grid Convergence: 0.48 °

Well	HARVESTERS STATE 30N-16B-M, 1613' FNL & 2333' FEL			
Well Position	+N/-S	-19.68 ft	Northing:	1,422,628.85 usft
	+E/-W	0.00 ft	Easting:	3,205,121.11 usft
Position Uncertainty		3.28 ft	Wellhead Elevation:	Ground Level: 4,802.00 ft

Wellbore	OH				
Magnetics	Model Name	Sample Date	Declination (°)	Dip Angle (°)	Field Strength (nT)
	IGRF2015	9/26/2017	8.19	66.92	52,408

Design	PLAN #1			
Audit Notes:				
Version:	Phase:	PLAN	Tie On Depth:	0.00
Vertical Section:	Depth From (TVD) (ft)	+N/-S (ft)	+E/-W (ft)	Direction (°)
	0.00	0.00	0.00	269.57

Plan Survey Tool Program	Date	10/2/2017		
Depth From (ft)	Depth To (ft)	Survey (Wellbore)	Tool Name	Remarks
1	0.00	14,942.02 PLAN #1 (OH)	MWD+IFR1	
			OWSG MWD + IFR1	

Plan Sections										
Measured Depth (ft)	Inclination (°)	Azimuth (°)	Vertical Depth (ft)	+N/-S (ft)	+E/-W (ft)	Dogleg Rate (°/100ft)	Build Rate (°/100ft)	Turn Rate (°/100ft)	TFO (°)	Target
0.00	0.00	0.00	0.00	0.00	0.00	0.00	0.00	0.00	0.00	
300.00	0.00	0.00	300.00	0.00	0.00	0.00	0.00	0.00	0.00	
872.64	11.45	352.70	868.83	56.58	-7.25	2.00	2.00	0.00	352.70	
6,580.23	11.45	352.70	6,462.78	1,180.68	-151.30	0.00	0.00	0.00	0.00	
7,566.88	90.16	269.57	7,072.00	1,298.77	-790.42	9.00	7.98	-8.43	-83.23	
14,942.37	90.16	269.57	7,051.00	1,243.28	-8,165.67	0.00	0.00	0.00	0.00	PBHL_HARVESTERS



Database:	EDM 5000.14 Single User Db	Local Co-ordinate Reference:	Well HARVESTERS STATE 30N-16B-
Company:	SRC ENERGY	TVD Reference:	M KB @ 4822.00ft
Project:	SECTION 15, T6N, R66W	MD Reference:	KB @ 4822.00ft
Site:	HARVESTERS STATE 7-15 PAD	North Reference:	True
Well:	HARVESTERS STATE 30N-16B-	Survey Calculation Method:	Minimum Curvature
Wellbore:	M OH		
Design:	PLAN #1		

Planned Survey									
Measured Depth (ft)	Inclination (°)	Azimuth (°)	Vertical Depth (ft)	+N/-S (ft)	+E/-W (ft)	Vertical Section (ft)	Dogleg Rate (°/100ft)	Build Rate (°/100ft)	Turn Rate (°/100ft)
0.00	0.00	0.00	0.00	0.00	0.00	0.00	0.00	0.00	0.00
100.00	0.00	0.00	100.00	0.00	0.00	0.00	0.00	0.00	0.00
200.00	0.00	0.00	200.00	0.00	0.00	0.00	0.00	0.00	0.00
300.00	0.00	0.00	300.00	0.00	0.00	0.00	0.00	0.00	0.00
Start Build 2.00									
400.00	2.00	352.70	399.98	1.73	-0.22	0.21	2.00	2.00	0.00
500.00	4.00	352.70	499.84	6.92	-0.89	0.83	2.00	2.00	0.00
600.00	6.00	352.70	599.45	15.57	-1.99	1.88	2.00	2.00	0.00
700.00	8.00	352.70	698.70	27.65	-3.54	3.34	2.00	2.00	0.00
800.00	10.00	352.70	797.47	43.17	-5.53	5.21	2.00	2.00	0.00
872.64	11.45	352.70	868.83	56.58	-7.25	6.82	2.00	2.00	0.00
Start 5707.59 hold at 872.63 MD									
900.00	11.45	352.70	895.65	61.97	-7.94	7.47	0.00	0.00	0.00
1,000.00	11.45	352.70	993.66	81.66	-10.46	9.85	0.00	0.00	0.00
1,100.00	11.45	352.70	1,091.67	101.36	-12.99	12.23	0.00	0.00	0.00
1,200.00	11.45	352.70	1,189.68	121.05	-15.51	14.60	0.00	0.00	0.00
1,300.00	11.45	352.70	1,287.69	140.75	-18.04	16.98	0.00	0.00	0.00
1,400.00	11.45	352.70	1,385.69	160.44	-20.56	19.35	0.00	0.00	0.00
1,500.00	11.45	352.70	1,483.70	180.14	-23.08	21.73	0.00	0.00	0.00
1,600.00	11.45	352.70	1,581.71	199.83	-25.61	24.10	0.00	0.00	0.00
1,700.00	11.45	352.70	1,679.72	219.53	-28.13	26.48	0.00	0.00	0.00
1,771.71	11.45	352.70	1,750.00	233.65	-29.94	28.18	0.00	0.00	0.00
9 5/8"									
1,800.00	11.45	352.70	1,777.73	239.22	-30.65	28.85	0.00	0.00	0.00
1,900.00	11.45	352.70	1,875.74	258.92	-33.18	31.23	0.00	0.00	0.00
2,000.00	11.45	352.70	1,973.75	278.61	-35.70	33.60	0.00	0.00	0.00
2,100.00	11.45	352.70	2,071.76	298.31	-38.23	35.98	0.00	0.00	0.00
2,200.00	11.45	352.70	2,169.77	318.00	-40.75	38.36	0.00	0.00	0.00
2,300.00	11.45	352.70	2,267.77	337.70	-43.27	40.73	0.00	0.00	0.00
2,400.00	11.45	352.70	2,365.78	357.39	-45.80	43.11	0.00	0.00	0.00
2,500.00	11.45	352.70	2,463.79	377.09	-48.32	45.48	0.00	0.00	0.00
2,600.00	11.45	352.70	2,561.80	396.78	-50.84	47.86	0.00	0.00	0.00
2,700.00	11.45	352.70	2,659.81	416.48	-53.37	50.23	0.00	0.00	0.00
2,800.00	11.45	352.70	2,757.82	436.17	-55.89	52.61	0.00	0.00	0.00
2,900.00	11.45	352.70	2,855.83	455.86	-58.42	54.98	0.00	0.00	0.00
3,000.00	11.45	352.70	2,953.84	475.56	-60.94	57.36	0.00	0.00	0.00
3,100.00	11.45	352.70	3,051.85	495.25	-63.46	59.74	0.00	0.00	0.00
3,200.00	11.45	352.70	3,149.85	514.95	-65.99	62.11	0.00	0.00	0.00
3,300.00	11.45	352.70	3,247.86	534.64	-68.51	64.49	0.00	0.00	0.00
3,400.00	11.45	352.70	3,345.87	554.34	-71.04	66.86	0.00	0.00	0.00
3,500.00	11.45	352.70	3,443.88	574.03	-73.56	69.24	0.00	0.00	0.00
3,600.00	11.45	352.70	3,541.89	593.73	-76.08	71.61	0.00	0.00	0.00
3,700.00	11.45	352.70	3,639.90	613.42	-78.61	73.99	0.00	0.00	0.00
3,800.00	11.45	352.70	3,737.91	633.12	-81.13	76.36	0.00	0.00	0.00
3,900.00	11.45	352.70	3,835.92	652.81	-83.65	78.74	0.00	0.00	0.00
4,000.00	11.45	352.70	3,933.93	672.51	-86.18	81.12	0.00	0.00	0.00
4,100.00	11.45	352.70	4,031.93	692.20	-88.70	83.49	0.00	0.00	0.00
4,200.00	11.45	352.70	4,129.94	711.90	-91.23	85.87	0.00	0.00	0.00
4,300.00	11.45	352.70	4,227.95	731.59	-93.75	88.24	0.00	0.00	0.00
4,400.00	11.45	352.70	4,325.96	751.29	-96.27	90.62	0.00	0.00	0.00
4,500.00	11.45	352.70	4,423.97	770.98	-98.80	92.99	0.00	0.00	0.00
4,600.00	11.45	352.70	4,521.98	790.68	-101.32	95.37	0.00	0.00	0.00
4,700.00	11.45	352.70	4,619.99	810.37	-103.84	97.74	0.00	0.00	0.00

Database:	EDM 5000.14 Single User Db	Local Co-ordinate Reference:	Well HARVESTERS STATE 30N-16B-
Company:	SRC ENERGY	TVD Reference:	M KB @ 4822.00ft
Project:	SECTION 15, T6N, R66W	MD Reference:	KB @ 4822.00ft
Site:	HARVESTERS STATE 7-15 PAD	North Reference:	True
Well:	HARVESTERS STATE 30N-16B-	Survey Calculation Method:	Minimum Curvature
Wellbore:	M OH		
Design:	PLAN #1		

Planned Survey									
Measured Depth (ft)	Inclination (°)	Azimuth (°)	Vertical Depth (ft)	+N/-S (ft)	+E/-W (ft)	Vertical Section (ft)	Dogleg Rate (°/100ft)	Build Rate (°/100ft)	Turn Rate (°/100ft)
4,800.00	11.45	352.70	4,718.00	830.07	-106.37	100.12	0.00	0.00	0.00
4,900.00	11.45	352.70	4,816.01	849.76	-108.89	102.49	0.00	0.00	0.00
5,000.00	11.45	352.70	4,914.01	869.46	-111.42	104.87	0.00	0.00	0.00
5,100.00	11.45	352.70	5,012.02	889.15	-113.94	107.25	0.00	0.00	0.00
5,200.00	11.45	352.70	5,110.03	908.85	-116.46	109.62	0.00	0.00	0.00
5,300.00	11.45	352.70	5,208.04	928.54	-118.99	112.00	0.00	0.00	0.00
5,400.00	11.45	352.70	5,306.05	948.24	-121.51	114.37	0.00	0.00	0.00
5,500.00	11.45	352.70	5,404.06	967.93	-124.03	116.75	0.00	0.00	0.00
5,600.00	11.45	352.70	5,502.07	987.63	-126.56	119.12	0.00	0.00	0.00
5,700.00	11.45	352.70	5,600.08	1,007.32	-129.08	121.50	0.00	0.00	0.00
5,800.00	11.45	352.70	5,698.09	1,027.02	-131.61	123.87	0.00	0.00	0.00
5,900.00	11.45	352.70	5,796.09	1,046.71	-134.13	126.25	0.00	0.00	0.00
6,000.00	11.45	352.70	5,894.10	1,066.40	-136.65	128.63	0.00	0.00	0.00
6,100.00	11.45	352.70	5,992.11	1,086.10	-139.18	131.00	0.00	0.00	0.00
6,200.00	11.45	352.70	6,090.12	1,105.79	-141.70	133.38	0.00	0.00	0.00
6,300.00	11.45	352.70	6,188.13	1,125.49	-144.22	135.75	0.00	0.00	0.00
6,400.00	11.45	352.70	6,286.14	1,145.18	-146.75	138.13	0.00	0.00	0.00
6,500.00	11.45	352.70	6,384.15	1,164.88	-149.27	140.50	0.00	0.00	0.00
6,580.23	11.45	352.70	6,462.78	1,180.68	-151.30	142.41	0.00	0.00	0.00
Start DLS 9.00 TFO -83.23									
6,600.00	11.79	344.02	6,482.15	1,184.57	-152.10	143.19	9.00	1.72	-43.89
6,700.00	16.58	312.09	6,579.21	1,204.00	-165.53	156.47	9.00	4.79	-31.93
6,800.00	23.89	296.61	6,673.04	1,222.67	-194.28	185.07	9.00	7.31	-15.48
6,900.00	32.03	288.35	6,761.33	1,240.13	-237.64	228.30	9.00	8.14	-8.26
7,000.00	40.51	283.22	6,841.90	1,255.94	-294.54	285.09	9.00	8.48	-5.14
7,100.00	49.15	279.62	6,912.77	1,269.71	-363.59	354.03	9.00	8.64	-3.60
7,200.00	57.87	276.86	6,972.19	1,281.11	-443.08	433.43	9.00	8.72	-2.76
7,300.00	66.64	274.58	7,018.70	1,289.85	-531.06	521.34	9.00	8.77	-2.27
7,400.00	75.45	272.60	7,051.15	1,295.72	-625.36	615.59	9.00	8.80	-1.99
7,500.00	84.26	270.76	7,068.75	1,298.58	-723.65	713.86	9.00	8.82	-1.84
7,566.88	90.16	269.57	7,072.00	1,298.77	-790.42	780.63	9.00	8.82	-1.78
Start 7375.49 hold at 7566.88 MD - TOP HARVESTERS STATE 30N-16B-M(317 FNL 2216' FWL)									
7,600.00	90.16	269.57	7,071.91	1,298.52	-823.54	813.74	0.00	0.00	0.00
7,700.00	90.16	269.57	7,071.62	1,297.77	-923.53	913.74	0.00	0.00	0.00
7,800.00	90.16	269.57	7,071.34	1,297.02	-1,023.53	1,013.74	0.00	0.00	0.00
7,900.00	90.16	269.57	7,071.05	1,296.26	-1,123.53	1,113.74	0.00	0.00	0.00
8,000.00	90.16	269.57	7,070.77	1,295.51	-1,223.52	1,213.74	0.00	0.00	0.00
8,100.00	90.16	269.57	7,070.48	1,294.76	-1,323.52	1,313.74	0.00	0.00	0.00
8,200.00	90.16	269.57	7,070.20	1,294.01	-1,423.52	1,413.74	0.00	0.00	0.00
8,300.00	90.16	269.57	7,069.92	1,293.25	-1,523.51	1,513.74	0.00	0.00	0.00
8,400.00	90.16	269.57	7,069.63	1,292.50	-1,623.51	1,613.74	0.00	0.00	0.00
8,500.00	90.16	269.57	7,069.35	1,291.75	-1,723.51	1,713.74	0.00	0.00	0.00
8,600.00	90.16	269.57	7,069.06	1,291.00	-1,823.50	1,813.74	0.00	0.00	0.00
8,700.00	90.16	269.57	7,068.78	1,290.24	-1,923.50	1,913.74	0.00	0.00	0.00
8,800.00	90.16	269.57	7,068.49	1,289.49	-2,023.50	2,013.74	0.00	0.00	0.00
8,900.00	90.16	269.57	7,068.21	1,288.74	-2,123.49	2,113.74	0.00	0.00	0.00
9,000.00	90.16	269.57	7,067.92	1,287.99	-2,223.49	2,213.74	0.00	0.00	0.00
9,100.00	90.16	269.57	7,067.64	1,287.23	-2,323.49	2,313.74	0.00	0.00	0.00
9,200.00	90.16	269.57	7,067.35	1,286.48	-2,423.49	2,413.74	0.00	0.00	0.00
9,300.00	90.16	269.57	7,067.07	1,285.73	-2,523.48	2,513.74	0.00	0.00	0.00
9,400.00	90.16	269.57	7,066.78	1,284.98	-2,623.48	2,613.74	0.00	0.00	0.00
9,500.00	90.16	269.57	7,066.50	1,284.23	-2,723.48	2,713.74	0.00	0.00	0.00
9,600.00	90.16	269.57	7,066.21	1,283.47	-2,823.47	2,813.74	0.00	0.00	0.00
9,700.00	90.16	269.57	7,065.93	1,282.72	-2,923.47	2,913.74	0.00	0.00	0.00

Database:	EDM 5000.14 Single User Db	Local Co-ordinate Reference:	Well HARVESTERS STATE 30N-16B-
Company:	SRC ENERGY	TVD Reference:	M KB @ 4822.00ft
Project:	SECTION 15, T6N, R66W	MD Reference:	KB @ 4822.00ft
Site:	HARVESTERS STATE 7-15 PAD	North Reference:	True
Well:	HARVESTERS STATE 30N-16B-	Survey Calculation Method:	Minimum Curvature
Wellbore:	M OH		
Design:	PLAN #1		

Planned Survey									
Measured Depth (ft)	Inclination (°)	Azimuth (°)	Vertical Depth (ft)	+N/-S (ft)	+E/-W (ft)	Vertical Section (ft)	Dogleg Rate (°/100ft)	Build Rate (°/100ft)	Turn Rate (°/100ft)
9,800.00	90.16	269.57	7,065.64	1,281.97	-3,023.47	3,013.73	0.00	0.00	0.00
9,900.00	90.16	269.57	7,065.36	1,281.22	-3,123.46	3,113.73	0.00	0.00	0.00
10,000.00	90.16	269.57	7,065.07	1,280.46	-3,223.46	3,213.73	0.00	0.00	0.00
10,100.00	90.16	269.57	7,064.79	1,279.71	-3,323.46	3,313.73	0.00	0.00	0.00
10,200.00	90.16	269.57	7,064.50	1,278.96	-3,423.45	3,413.73	0.00	0.00	0.00
10,300.00	90.16	269.57	7,064.22	1,278.21	-3,523.45	3,513.73	0.00	0.00	0.00
10,400.00	90.16	269.57	7,063.94	1,277.45	-3,623.45	3,613.73	0.00	0.00	0.00
10,500.00	90.16	269.57	7,063.65	1,276.70	-3,723.44	3,713.73	0.00	0.00	0.00
10,600.00	90.16	269.57	7,063.37	1,275.95	-3,823.44	3,813.73	0.00	0.00	0.00
10,700.00	90.16	269.57	7,063.08	1,275.20	-3,923.44	3,913.73	0.00	0.00	0.00
10,800.00	90.16	269.57	7,062.80	1,274.44	-4,023.43	4,013.73	0.00	0.00	0.00
10,900.00	90.16	269.57	7,062.51	1,273.69	-4,123.43	4,113.73	0.00	0.00	0.00
11,000.00	90.16	269.57	7,062.23	1,272.94	-4,223.43	4,213.73	0.00	0.00	0.00
11,100.00	90.16	269.57	7,061.94	1,272.19	-4,323.42	4,313.73	0.00	0.00	0.00
11,200.00	90.16	269.57	7,061.66	1,271.43	-4,423.42	4,413.73	0.00	0.00	0.00
11,300.00	90.16	269.57	7,061.37	1,270.68	-4,523.42	4,513.73	0.00	0.00	0.00
11,400.00	90.16	269.57	7,061.09	1,269.93	-4,623.41	4,613.73	0.00	0.00	0.00
11,500.00	90.16	269.57	7,060.80	1,269.18	-4,723.41	4,713.73	0.00	0.00	0.00
11,600.00	90.16	269.57	7,060.52	1,268.42	-4,823.41	4,813.73	0.00	0.00	0.00
11,700.00	90.16	269.57	7,060.23	1,267.67	-4,923.40	4,913.73	0.00	0.00	0.00
11,800.00	90.16	269.57	7,059.95	1,266.92	-5,023.40	5,013.73	0.00	0.00	0.00
11,900.00	90.16	269.57	7,059.66	1,266.17	-5,123.40	5,113.73	0.00	0.00	0.00
12,000.00	90.16	269.57	7,059.38	1,265.42	-5,223.39	5,213.73	0.00	0.00	0.00
12,100.00	90.16	269.57	7,059.09	1,264.66	-5,323.39	5,313.73	0.00	0.00	0.00
12,200.00	90.16	269.57	7,058.81	1,263.91	-5,423.39	5,413.72	0.00	0.00	0.00
12,300.00	90.16	269.57	7,058.52	1,263.16	-5,523.38	5,513.72	0.00	0.00	0.00
12,400.00	90.16	269.57	7,058.24	1,262.41	-5,623.38	5,613.72	0.00	0.00	0.00
12,500.00	90.16	269.57	7,057.96	1,261.65	-5,723.38	5,713.72	0.00	0.00	0.00
12,600.00	90.16	269.57	7,057.67	1,260.90	-5,823.38	5,813.72	0.00	0.00	0.00
12,700.00	90.16	269.57	7,057.39	1,260.15	-5,923.37	5,913.72	0.00	0.00	0.00
12,800.00	90.16	269.57	7,057.10	1,259.40	-6,023.37	6,013.72	0.00	0.00	0.00
12,900.00	90.16	269.57	7,056.82	1,258.64	-6,123.37	6,113.72	0.00	0.00	0.00
13,000.00	90.16	269.57	7,056.53	1,257.89	-6,223.36	6,213.72	0.00	0.00	0.00
13,100.00	90.16	269.57	7,056.25	1,257.14	-6,323.36	6,313.72	0.00	0.00	0.00
13,200.00	90.16	269.57	7,055.96	1,256.39	-6,423.36	6,413.72	0.00	0.00	0.00
13,300.00	90.16	269.57	7,055.68	1,255.63	-6,523.35	6,513.72	0.00	0.00	0.00
13,400.00	90.16	269.57	7,055.39	1,254.88	-6,623.35	6,613.72	0.00	0.00	0.00
13,500.00	90.16	269.57	7,055.11	1,254.13	-6,723.35	6,713.72	0.00	0.00	0.00
13,600.00	90.16	269.57	7,054.82	1,253.38	-6,823.34	6,813.72	0.00	0.00	0.00
13,700.00	90.16	269.57	7,054.54	1,252.62	-6,923.34	6,913.72	0.00	0.00	0.00
13,800.00	90.16	269.57	7,054.25	1,251.87	-7,023.34	7,013.72	0.00	0.00	0.00
13,900.00	90.16	269.57	7,053.97	1,251.12	-7,123.33	7,113.72	0.00	0.00	0.00
14,000.00	90.16	269.57	7,053.68	1,250.37	-7,223.33	7,213.72	0.00	0.00	0.00
14,100.00	90.16	269.57	7,053.40	1,249.62	-7,323.33	7,313.72	0.00	0.00	0.00
14,200.00	90.16	269.57	7,053.11	1,248.86	-7,423.32	7,413.72	0.00	0.00	0.00
14,300.00	90.16	269.57	7,052.83	1,248.11	-7,523.32	7,513.72	0.00	0.00	0.00
14,400.00	90.16	269.57	7,052.54	1,247.36	-7,623.32	7,613.72	0.00	0.00	0.00
14,500.00	90.16	269.57	7,052.26	1,246.61	-7,723.31	7,713.72	0.00	0.00	0.00
14,600.00	90.16	269.57	7,051.98	1,245.85	-7,823.31	7,813.72	0.00	0.00	0.00
14,700.00	90.16	269.57	7,051.69	1,245.10	-7,923.31	7,913.71	0.00	0.00	0.00
14,800.00	90.16	269.57	7,051.41	1,244.35	-8,023.30	8,013.71	0.00	0.00	0.00
14,900.00	90.16	269.57	7,051.12	1,243.60	-8,123.30	8,113.71	0.00	0.00	0.00
14,942.37	90.16	269.57	7,051.00	1,243.28	-8,165.67	8,156.09	0.00	0.00	0.00
TD at 14942.37 - PBHL HARVESTERS STATE 30N-16B-M(302 FNL150 FWL)									

Database:	EDM 5000.14 Single User Db	Local Co-ordinate Reference:	Well HARVESTERS STATE 30N-16B-
Company:	SRC ENERGY	TVD Reference:	M KB @ 4822.00ft
Project:	SECTION 15, T6N, R66W	MD Reference:	KB @ 4822.00ft
Site:	HARVESTERS STATE 7-15 PAD	North Reference:	True
Well:	HARVESTERS STATE 30N-16B-	Survey Calculation Method:	Minimum Curvature
Wellbore:	M OH		
Design:	PLAN #1		

Planned Survey									
Measured Depth (ft)	Inclination (°)	Azimuth (°)	Vertical Depth (ft)	+N/-S (ft)	+E/-W (ft)	Vertical Section (ft)	Dogleg Rate (°/100ft)	Build Rate (°/100ft)	Turn Rate (°/100ft)

Design Targets									
Target Name	Dip Angle (°)	Dip Dir. (°)	TVD (ft)	+N/-S (ft)	+E/-W (ft)	Northing (usft)	Easting (usft)	Latitude	Longitude
- hit/miss target									
- Shape									
PBHL_HARVESTERS S	0.00	0.00	7,051.00	1,243.28	-8,165.67	1,423,804.17	3,196,945.39	40.4945850	-104.7918660
- plan hits target center									
- Point									
TOP_HARVESTERS ST	0.00	0.00	7,072.00	1,298.77	-790.42	1,423,921.00	3,204,319.91	40.4947410	-104.7653480
- plan hits target center									
- Point									

Casing Points					
Measured Depth (ft)	Vertical Depth (ft)	Name	Casing Diameter (in)	Hole Diameter (in)	
1,771.71	1,750.00	9 5/8"	9.625	13.500	

Plan Annotations				
Measured Depth (ft)	Vertical Depth (ft)	Local Coordinates		Comment
		+N/-S (ft)	+E/-W (ft)	
300.00	300.00	0.00	0.00	Start Build 2.00
872.64	868.83	56.58	-7.25	Start 5707.59 hold at 872.63 MD
6,580.23	6,462.78	1,180.68	-151.30	Start DLS 9.00 TFO -83.23
7,566.88	7,072.00	1,298.77	-790.42	Start 7375.49 hold at 7566.88 MD
14,942.37	7,051.00	1,243.28	-8,165.67	TD at 14942.37