



November 28, 2017

Mr. Matt Lepore, Director  
Colorado Oil and Gas Conservation Commission  
1120 Lincoln Street, Suite 801  
Denver, Colorado 80203

**RE: COGCC Rule 318A.e.: Proposed Spacing Unit  
G & D Hanks TA-27-28HN Well: SWSE Section 27, Township 7 North, Range 66 West  
Weld County, Colorado**

Dear Mr. Lepore:

Bayswater Exploration & Production, LLC (Bayswater) is planning to drill the above referenced well in accordance with the provisions set out in Colorado Oil and Gas Conservation Commission (COGCC) Rule 318A.e. Bayswater's Proposed Spacing Unit consists of:

S½ of Section 27 & 28, Township 7 North, Range 66 West  
E½SE¼ of Section 29, Township 7 North, Range 66 West  
Containing 720.00 acres, more or less

Bayswater is not the only owner within the Proposed Spacing Unit and has provided notice to the remaining owners, as required by COGCC Rule 318A.e.(6). Copies of the required notification letters are on file at Bayswater's office. The required thirty (30) day notice period has elapsed absent the receipt by Bayswater of any objection to their proposal by the owners within the Proposed Spacing Unit for the subject well.

Enclosed is the Proposed Spacing Unit Exhibit to assist in your review and approval of Bayswater's proposed Application for Permit to Drill for the G & D Hanks TA-27-28HN Well. Many thanks for your attention to this matter.

Respectfully,

A handwritten signature in black ink, appearing to read 'Justin Garrett', written over a light blue circular background.

Justin Garrett  
Regulatory Analyst  
Agent for Bayswater Exploration & Production, LLC

:jg

Enclosure: Proposed Spacing Unit Exhibit

**G & D HANKS 27-N PAD**  
**PROPOSED 318A.a.(4)D. SPACING UNIT**  
**SEC 27, T7N, R66W: S2**  
**SEC 28, T7N, R66W: S2**  
**SEC 29, T7N, R66W: E2SE4**

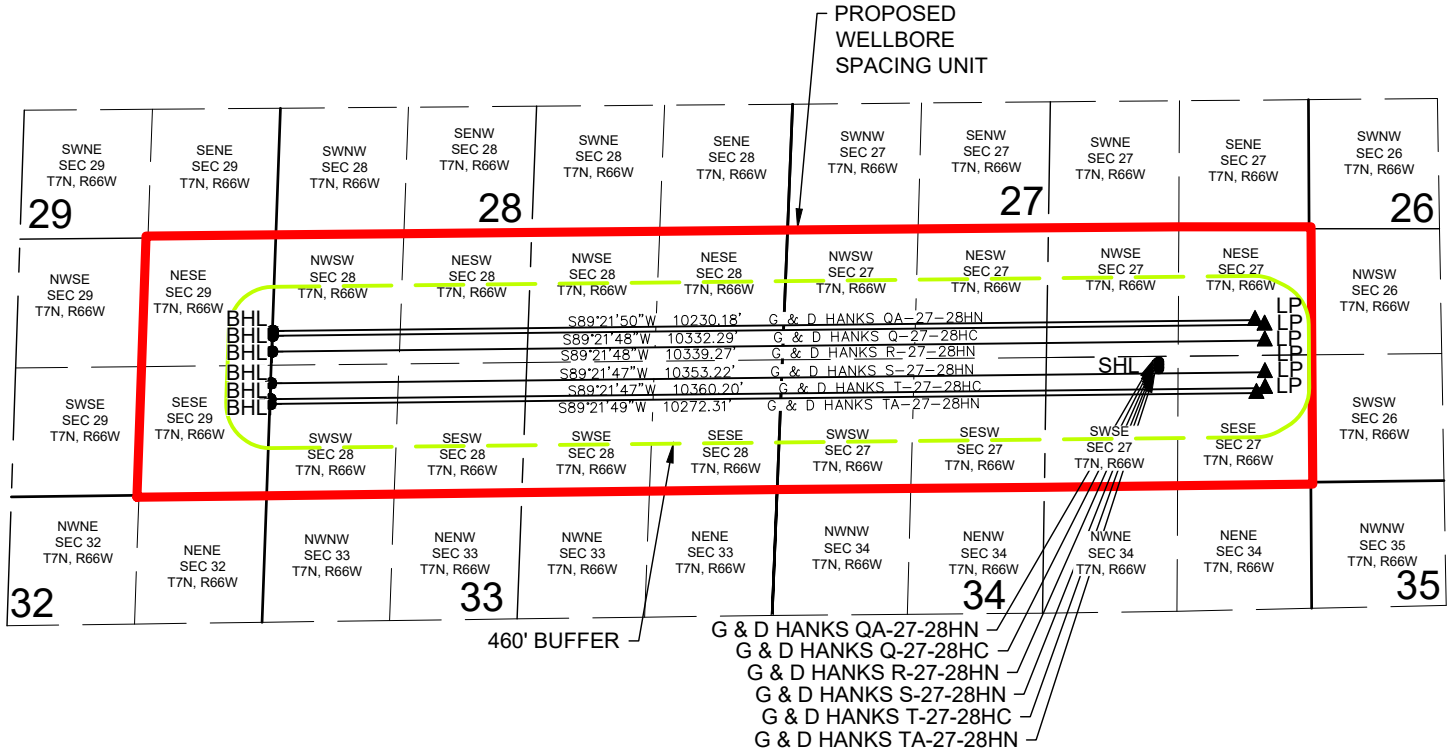

**G & D HANKS QA-27-28HN WELL TO BE LOCATED 1273' FSL AND 1574' FEL, SEC 27, T7N, R66W**  
**G & D HANKS Q-27-28HC WELL TO BE LOCATED 1258' FSL AND 1574' FEL, SEC 27, T7N, R66W**  
**G & D HANKS R-27-28HN WELL TO BE LOCATED 1243' FSL AND 1574' FEL, SEC 27, T7N, R66W**  
**G & D HANKS S-27-28HN WELL TO BE LOCATED 1228' FSL AND 1575' FEL, SEC 27, T7N, R66W**  
**G & D HANKS T-27-28HC WELL TO BE LOCATED 1213' FSL AND 1575' FEL, SEC 27, T7N, R66W**  
**G & D HANKS TA-27-28HN WELL TO BE LOCATED 1198' FSL AND 1575' FEL, SEC 27, T7N, R66W**

**LEGEND**

● = PROPOSED WELL  
 ● = BOTTOM HOLE  
 ▲ = LANDING POINT  
 SHL = SURFACE HOLE LOCATION  
 BHL = BOTTOM HOLE LOCATION  
 LP = LANDING POINT

DISCLAIMER:  
 THIS PLOT DOES NOT REPRESENT A MONUMENTED LAND SURVEY AND SHOULD NOT BE  
 RELIED UPON TO DETERMINE BOUNDARY LINES, PROPERTY OWNERSHIP OR OTHER  
 PROPERTY INTERESTS. PARCEL LINES, IF DEPICTED HAVE NOT BEEN FIELD VERIFIED AND  
 MAY BE BASED UPON PUBLICLY AVAILABLE DATA THAT ALSO HAS NOT BEEN  
 INDEPENDENTLY VERIFIED.

